

05/08/99

TIP PROJECT: B-4503

STATE OF NORTH CAROLINA
DIVISION OF HIGHWAYS

| | |
|------------|-----------|
| T.I.P. NO. | SHEET NO. |
| B-4503 | UC-1 |

**UTILITY CONSTRUCTION PLANS
EDGEcombe COUNTY**

**LOCATION: BRIDGE NO. 7 OVER THE TAR RIVER
ON SR-1250 (SPRINGFIELD DR.)**
TYPE OF WORK: WATER RELOCATION

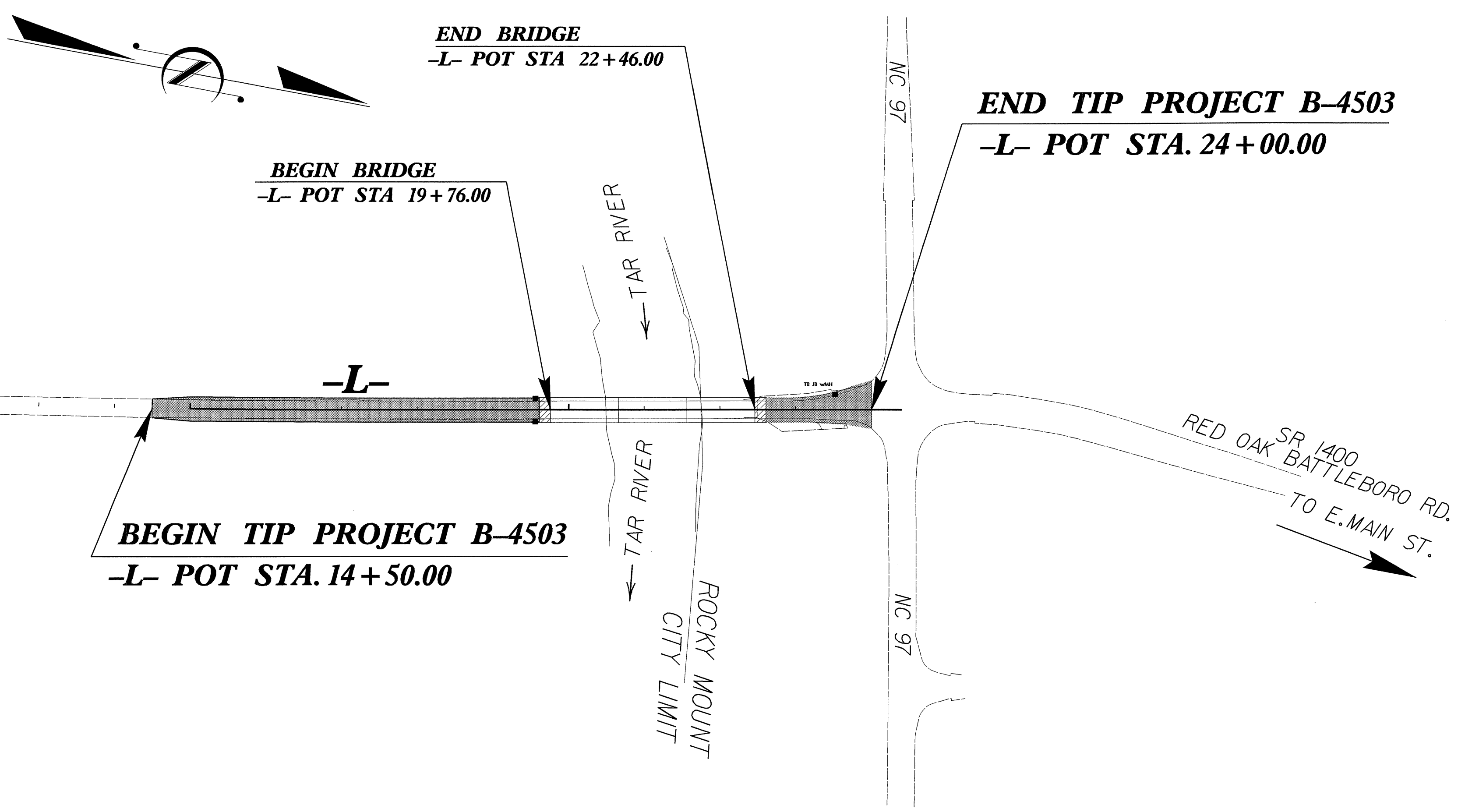
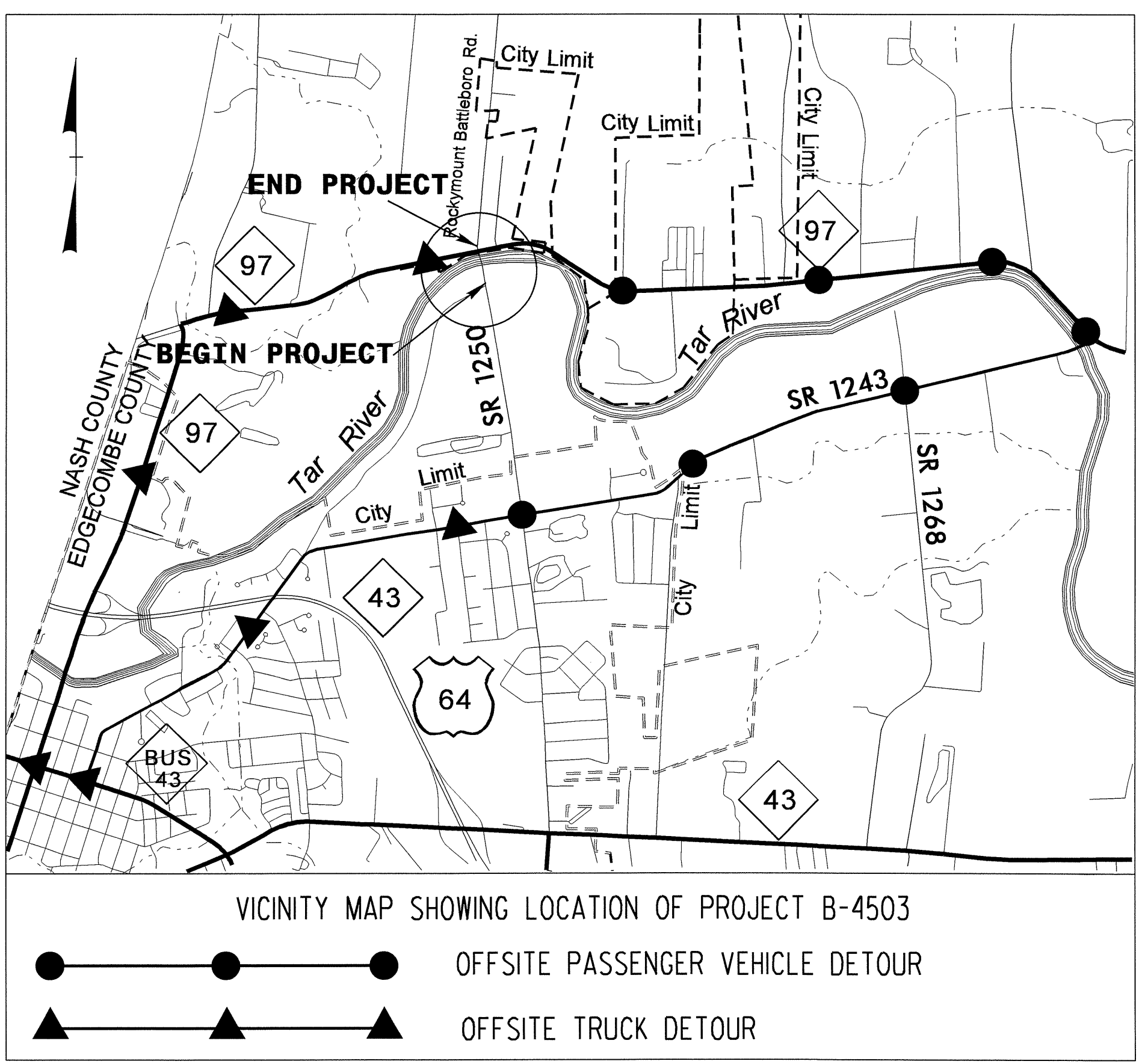

25-JUL-2011 16:25
R:\Utilities\RDg\UT\Proj\B4503_UT_+sh_UC1_psh.dgn
\$\$\$\$\$USERNAME\$\$\$\$\$

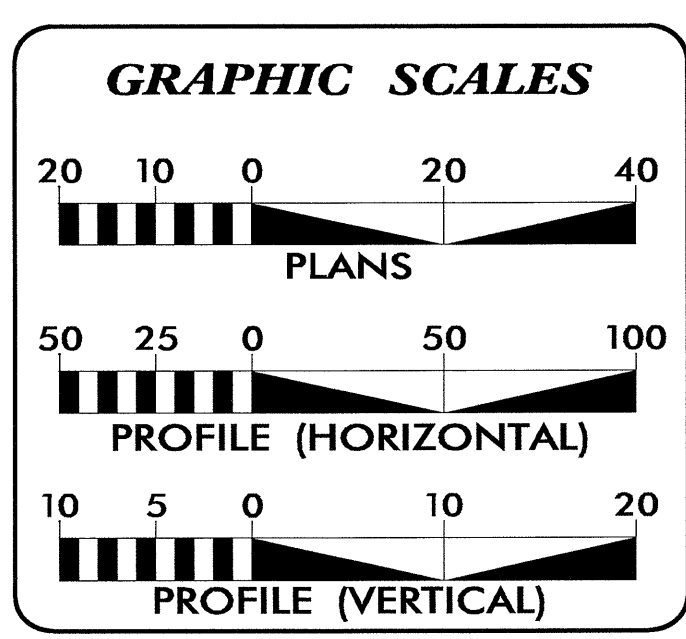

INDEX OF SHEETS

| SHEET NO. | DESCRIPTION |
|-----------|---------------------------------|
| UC-1 | TITLE SHEET |
| UC-2 | UTILITY CONSTRUCTION PLAN SHEET |

WATER AND SEWER OWNERS ON PROJECT

(1) WATER...CITY OF ROCKY MOUNT

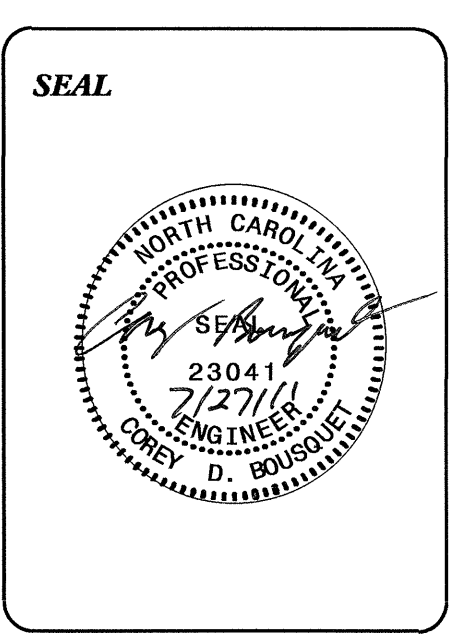

PREPARED IN THE OFFICE OF:
**DIVISION OF HIGHWAYS
UTILITIES ENGINEERING
SECTION**

1591 MAIL SERVICES CENTER
RALEIGH NC 27699-1591
PHONE (919) 250-4128
FAX (919) 250-4119

Roger Worthington, P.E. UTILITIES SECTION ENGINEER
Corey Bousquet, P.E. UTILITIES SQUAD LEADER PROJECT ENGINEER
Eric Haugaard UTILITIES PROJECT DESIGNER

5/14/99

| | |
|---|-----------|
| PROJECT REFERENCE NO. | SHEET NO. |
| B-4503 | UC-2 |
| DESIGNED BY: EWH | |
| DRAWN BY: EWH | |
| CHECKED BY: CDB | |
| APPROVED BY: CDB | |
| REVISED: | |
| NORTH CAROLINA DEPARTMENT OF TRANSPORTATION UTILITIES ENGINEERING SEC. PHONE: (919) 250-4128 FAX: (919) 250-4119 | |
| UTILITY CONSTRUCTION PLANS ONLY | |

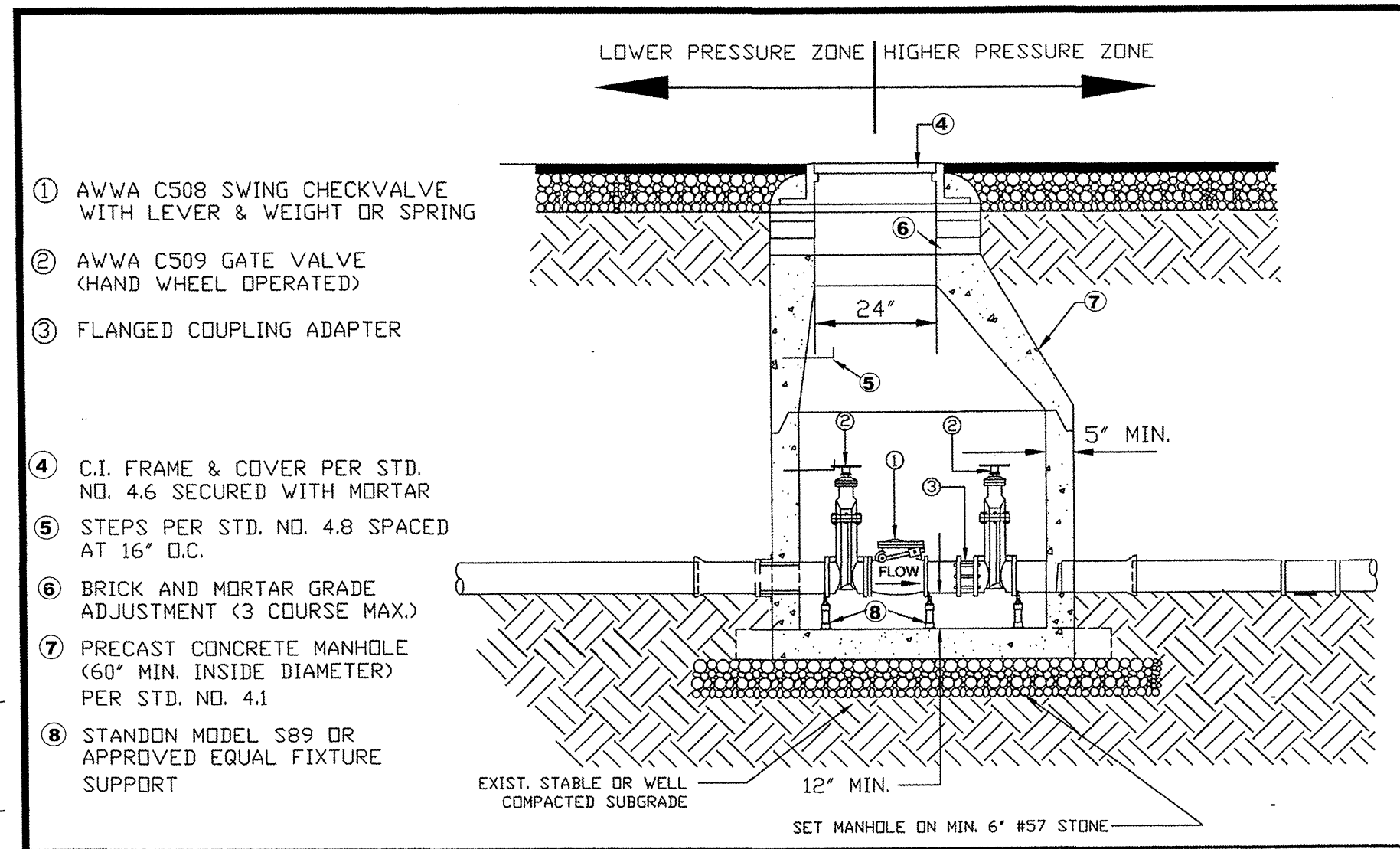

CHECK VALVE VAULT FOR 6" & 8" MAINS

| | | |
|---------------------|----------|----------|
| REVISED | APPROVED | STD. NO. |
| NO DATE DESCRIPTION | DATE | REVISION |
| | 07-19-01 | 5.28 |

CITY OF ROCKY MOUNT
DEPT. OF ENGINEERING

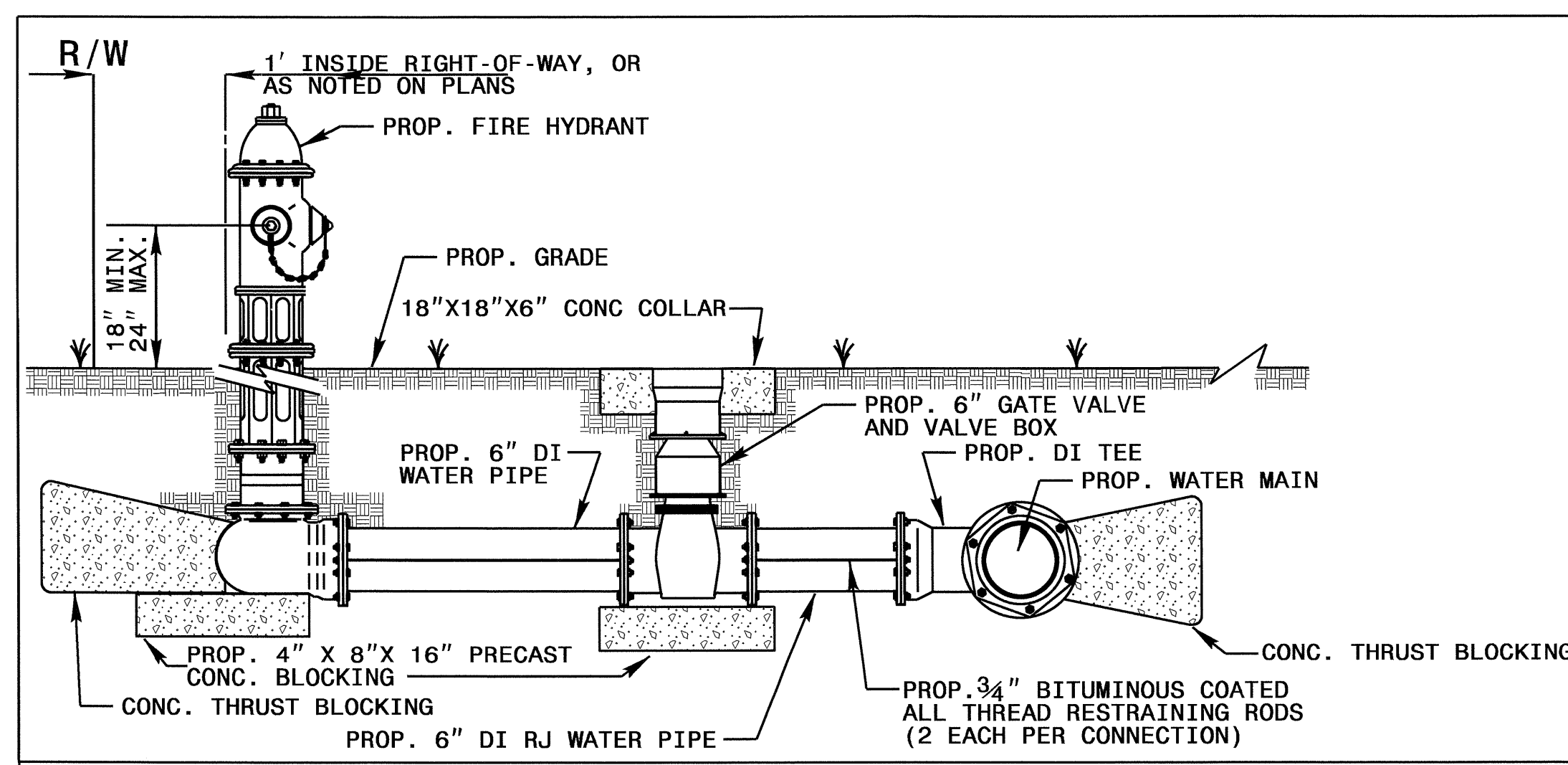

FIRE HYDRANT INSTALLATION DETAIL (UNPAVED AREAS)

UTILITY CONSTRUCTION

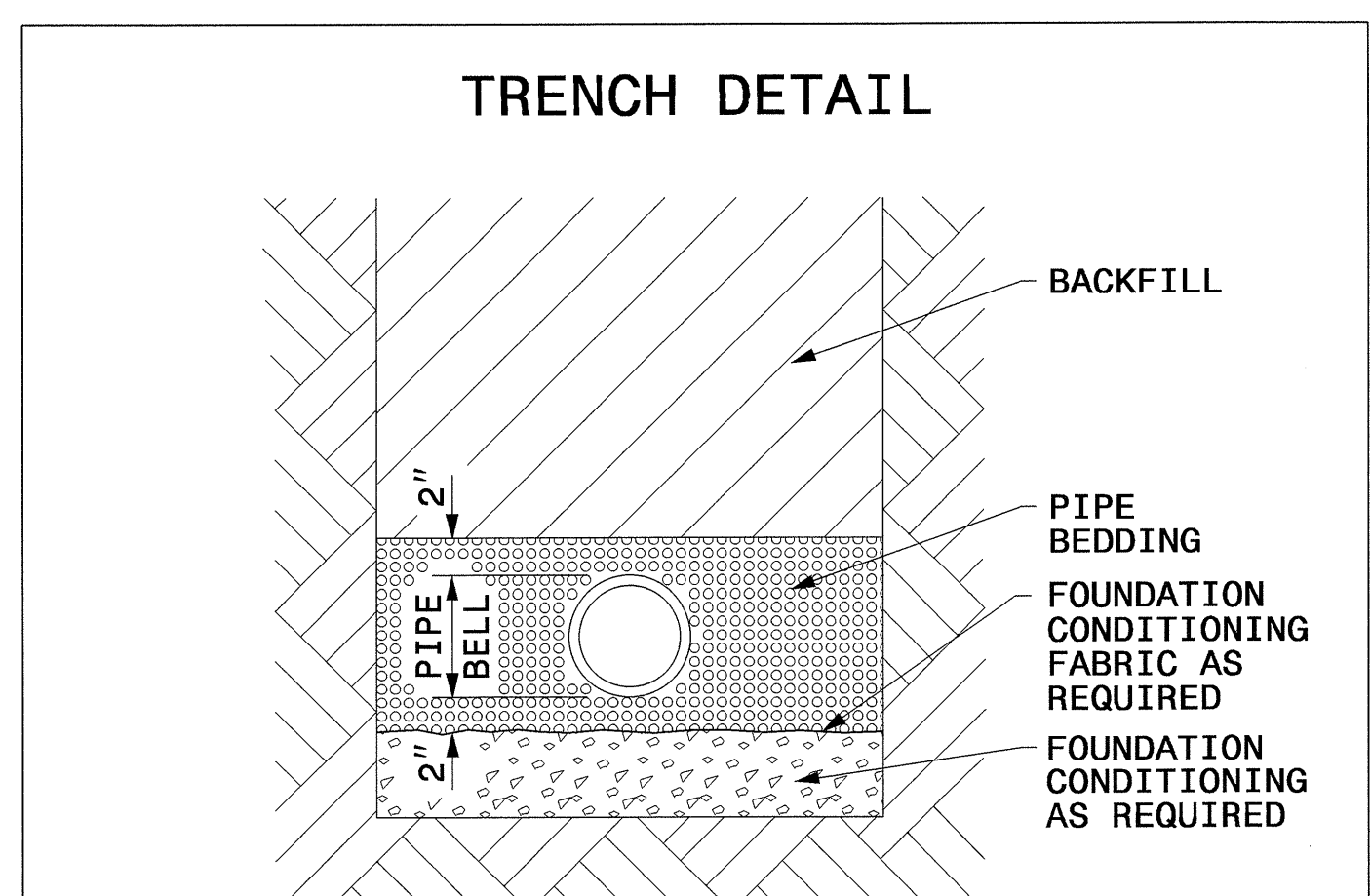
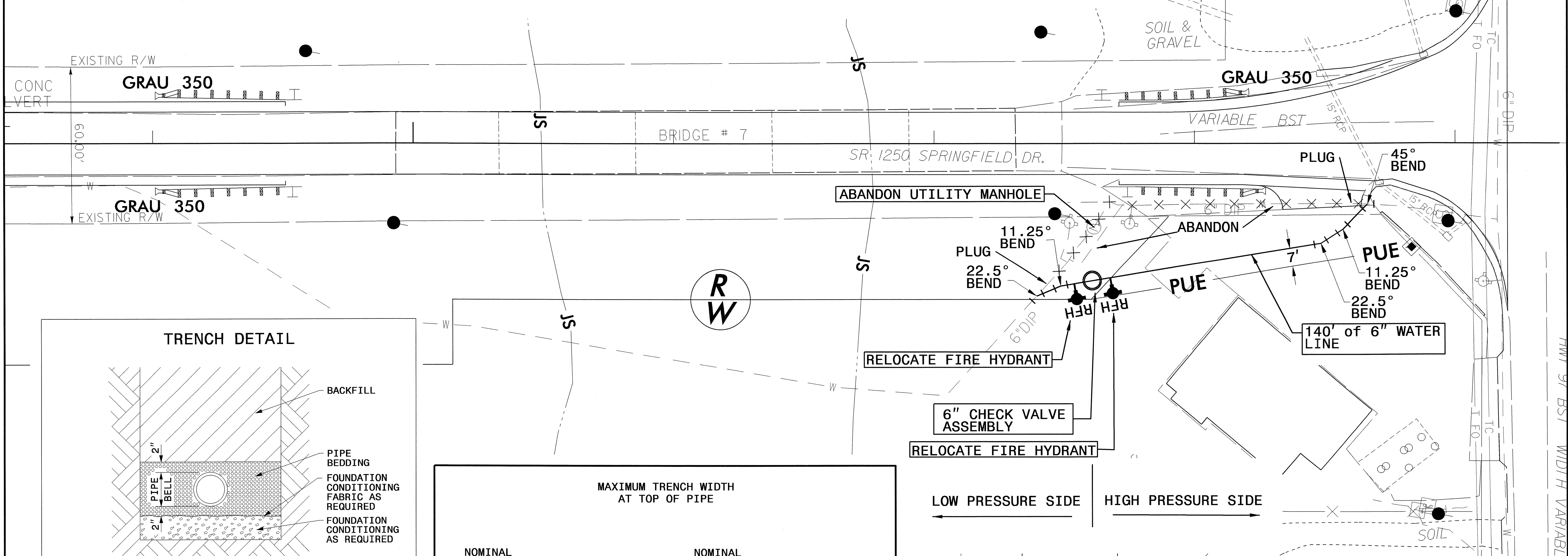

PLACE FOUNDATION CONDITIONING MATERIAL BELOW BEDDING IF REQUIRED, AS DIRECTED BY ENGINEER. PIPE BEDDED IN SELECT MATERIAL, CLASS II (TYPE 1) OR CLASS III. TRENCH BACKFILLED IN LOOSE 6" LAYERS COMPACTED TO TOP OF TRENCH USING LOCAL EXCAVATED MATERIAL IF APPROVED BY THE ENGINEER, OR SELECT MATERIAL. ALL MATERIAL SHALL BE FREE OF ROCKS, FOREIGN MATERIAL, AND FROZEN EARTH. COMPACTION SHALL BE TO APPROXIMATELY 95% DENSITY IN ACCORDANCE WITH AASHTO T-99 AS MODIFIED BY THE DEPARTMENT OF TRANSPORTATION.

MAXIMUM TRENCH WIDTH AT TOP OF PIPE

| NOMINAL PIPE SIZE (INCHES) | TRENCH WIDTH (INCHES) | NOMINAL PIPE SIZE (INCHES) | TRENCH WIDTH (INCHES) |
|----------------------------|-----------------------|----------------------------|-----------------------|
| 4 | 28 | 20 | 44 |
| 6 | 30 | 24 | 48 |
| 8 | 32 | 30 | 54 |
| 10 | 34 | 36 | 60 |
| 12 | 36 | 42 | 66 |
| 14 | 38 | 48 | 72 |
| 16 | 40 | 54 | 78 |
| 18 | 42 | | |

USE 6" RESTRAINED JOINT DI WATER PIPE

PLAN SCALE:
1"=20' (FULL-SIZE)
1"=40' (HALF-SIZE)

25-JUL-2011 6:18 AM AB_4503_Ut_rdy4_UC2_psh.dgn

| | |
|------------|-----------|
| T.I.P. NO. | SHEET NO. |
| B-4503 | UO-1 |

STATE OF NORTH CAROLINA
DIVISION OF HIGHWAYS

**UTILITIES BY OTHERS PLANS
EDGEcombe COUNTY**

**LOCATION: BRIDGE NO.7 OVER THE TAR RIVER
ON SR 1250 (SPRINGFIELD DR.)**

TYPE OF WORK: UTILITY BY OTHERS RELOCATION

TIP PROJECT: B-4503

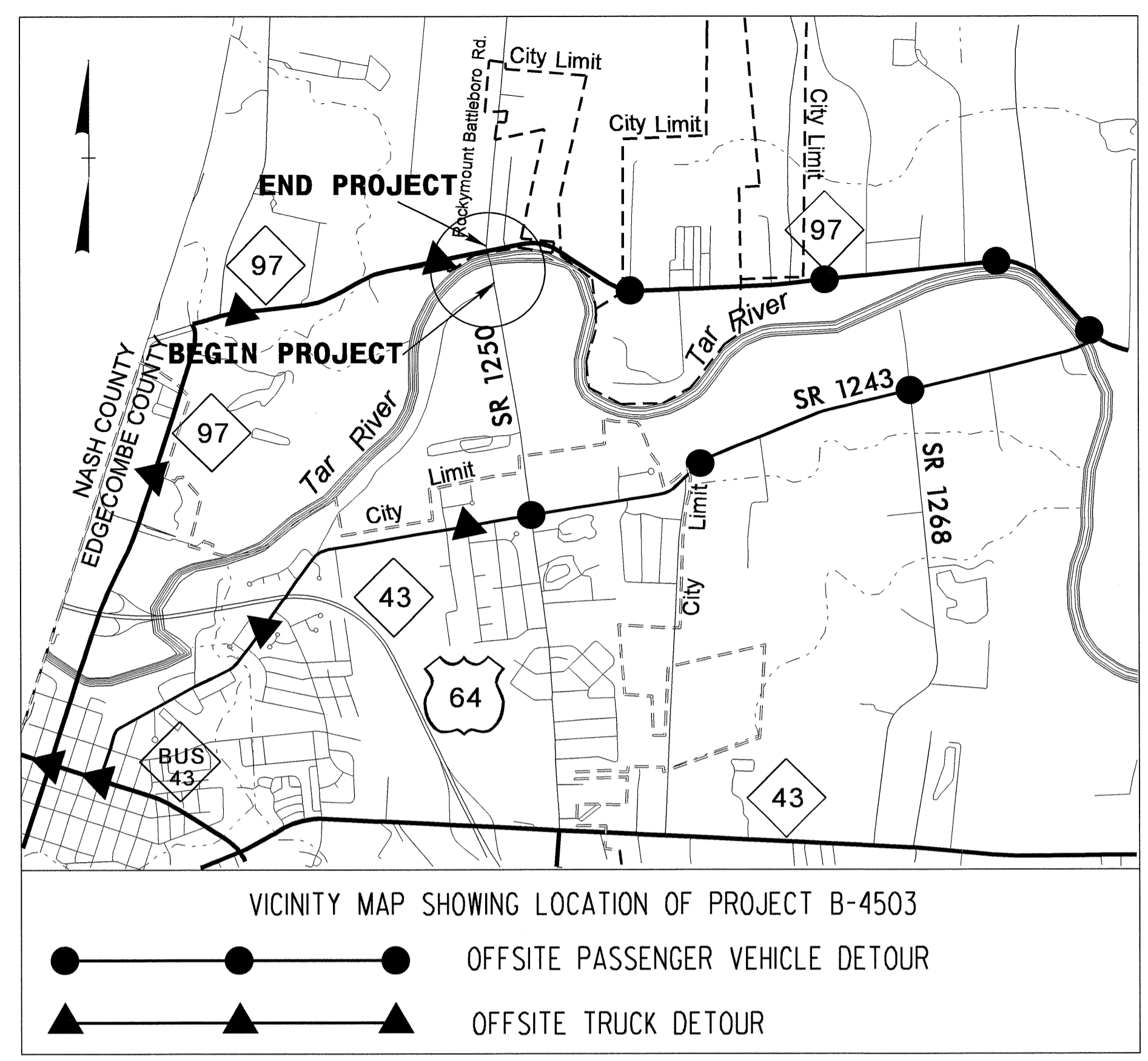

THIS PROJECT WAS DESIGNED USING THE SUB REGIONAL TIER DESIGN GUIDELINES FOR BRIDGE PROJECTS

THERE IS NO CONTROL OF ACCESS ON THIS PROJECT

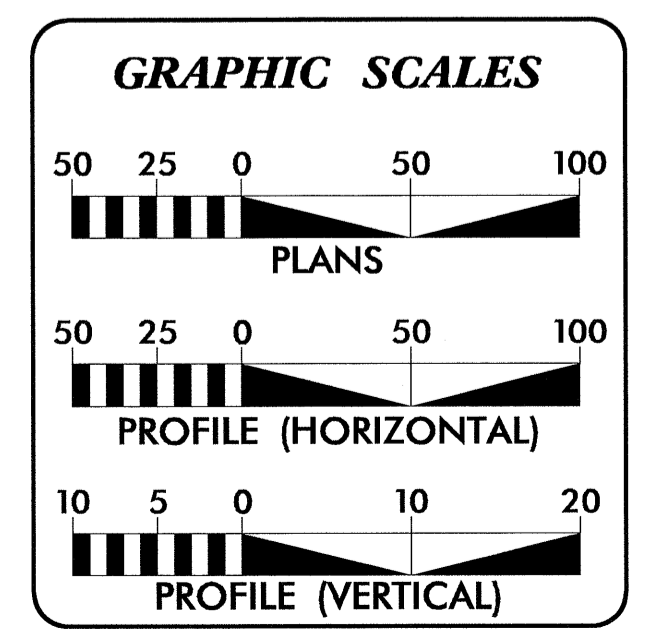
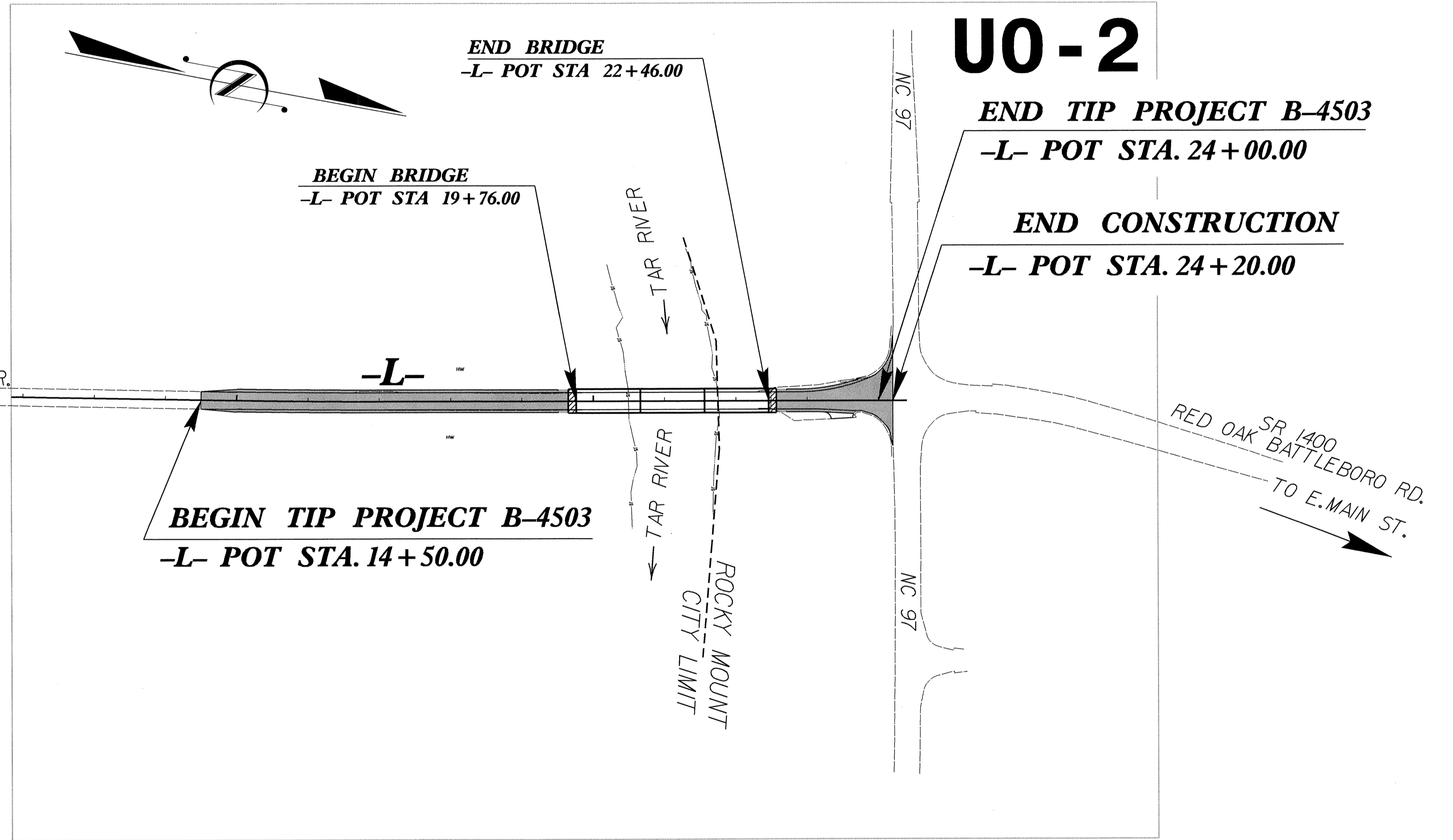

INDEX OF SHEETS

| SHEET NO. | DESCRIPTION |
|-----------|------------------------------|
| UO-1 | TITLE SHEET |
| UO-2 | UTILITY BY OTHERS PLAN SHEET |

UTILITY OWNERS ON PROJECT

- (1) POWER - EDGEcombe-MARTIN EMC
- (2) POWER - CITY OF ROCKY MOUNT

PREPARED IN THE OFFICE OF:
**DIVISION OF HIGHWAYS
UTILITIES ENGINEERING
SECTION**

1591 MAIL SERVICES CENTER
RALEIGH NC 27699-1591
PHONE (919) 250-4128
FAX (919) 250-4119

Roger Worthington, P.E. UTILITIES SECTION ENGINEER
Corey Bousquet, P.E. UTILITIES SQUAD LEADER PROJECT ENGINEER
Stephanie Athey UTILITIES PROJECT DESIGNER

29-SEP-2011 09:39
R:\Utilities\Proj\U01\Proj\B4503_U01_tsh_u01_psh.dgn
\$\$\$\$\$USERNAME\$\$\$\$\$

UTILITIES BY OTHERS

NOTE:
ALL PROPOSED UTILITY WORK
SHOWN ON THIS SHEET WILL
BE DONE BY OTHERS

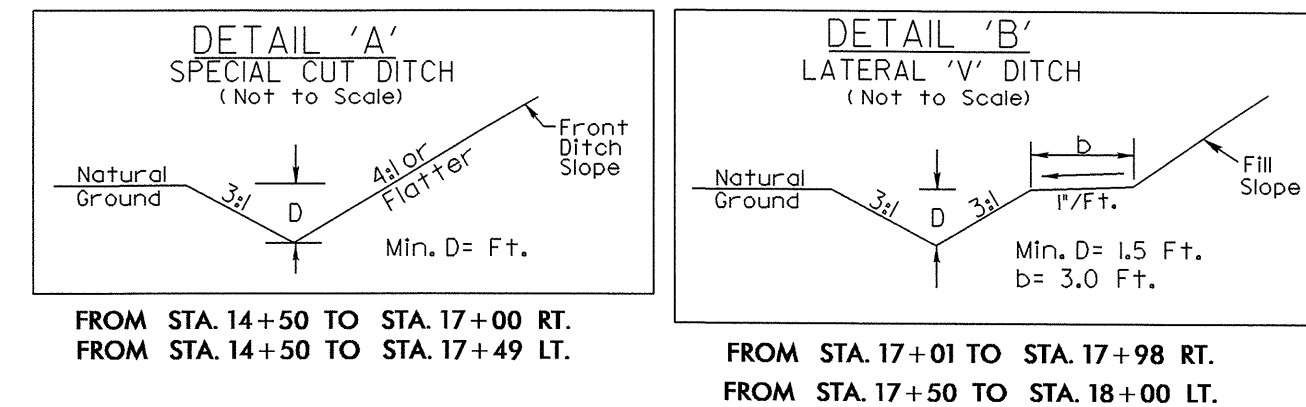
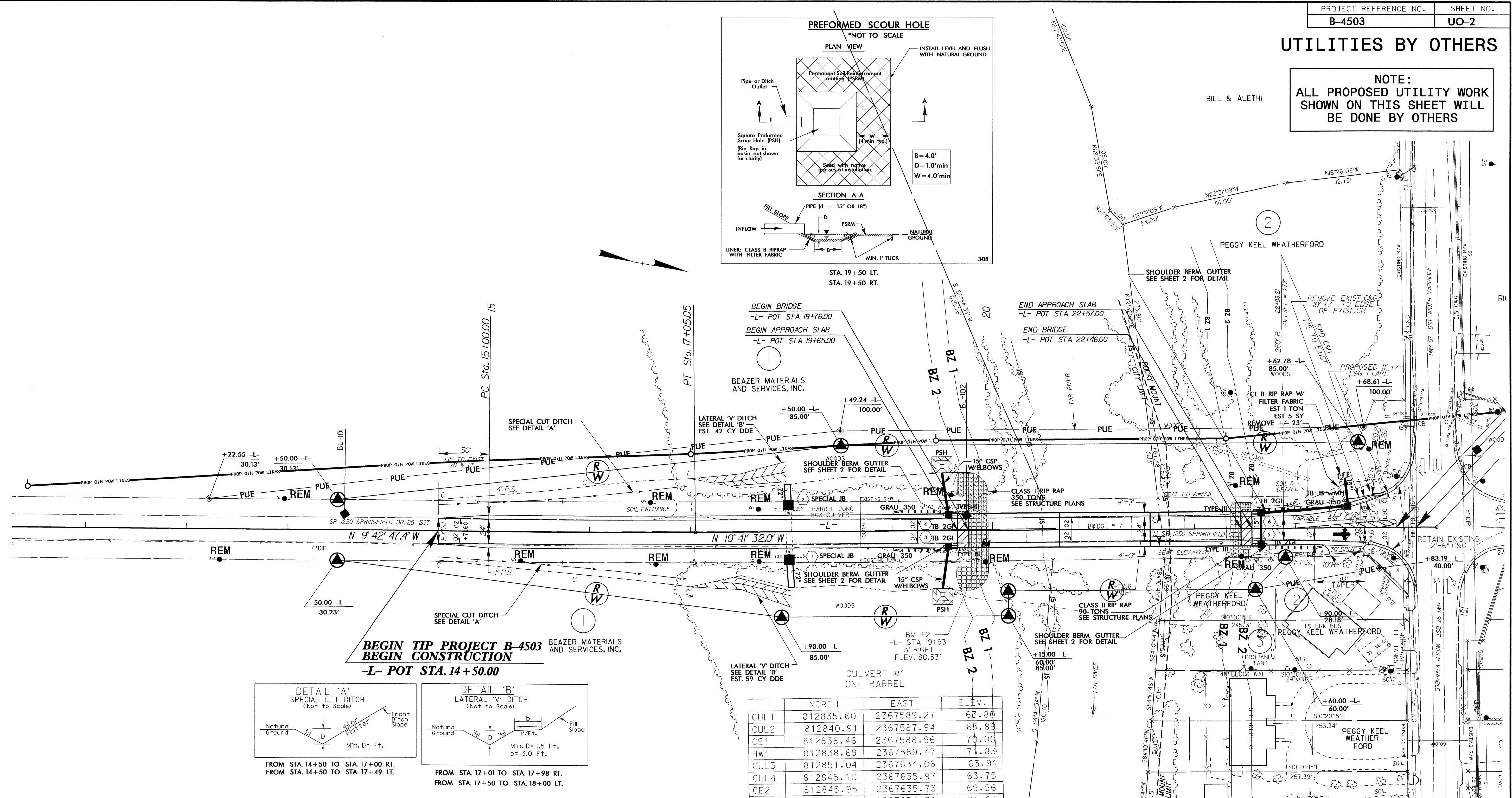
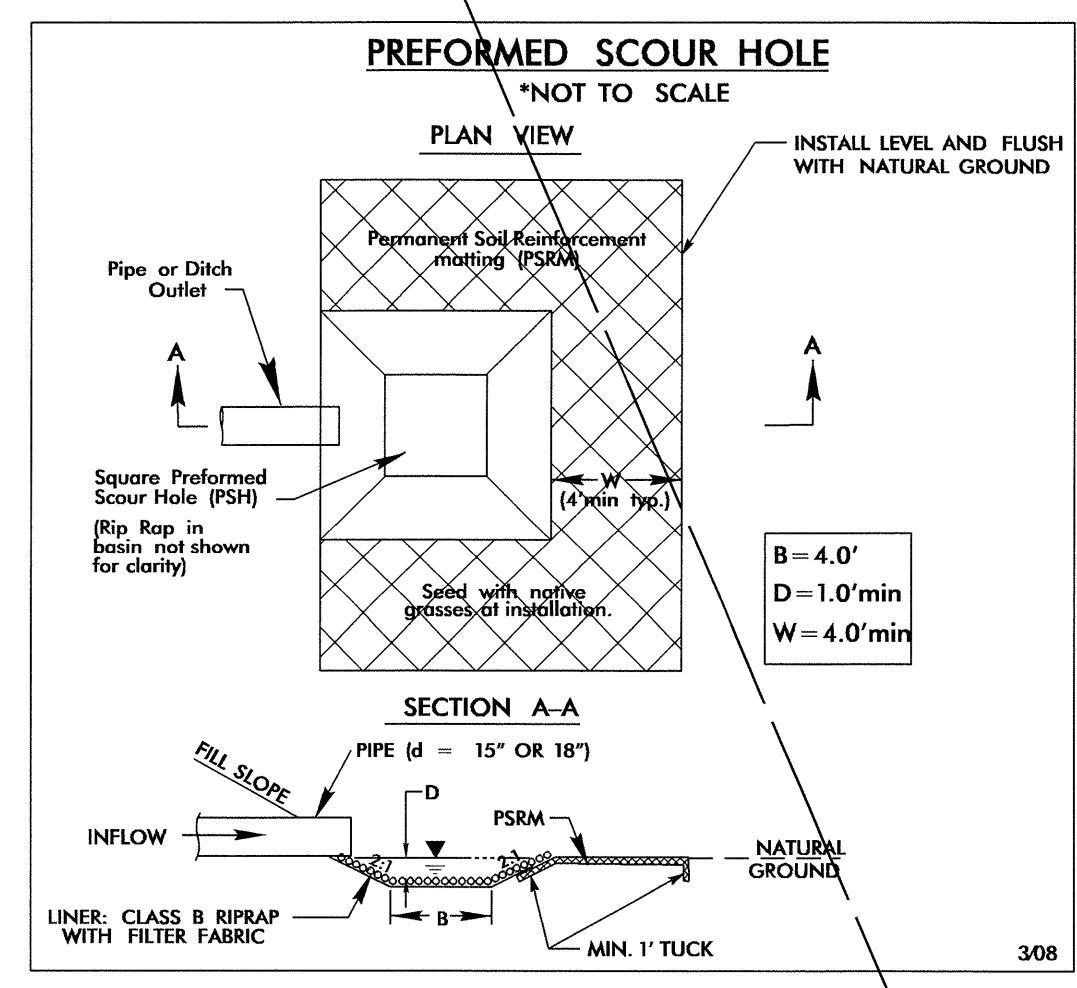

| | NORTH | EAST | ELEV. |
|------|-----------|------------|-------|
| CUL1 | 812835.60 | 2367589.27 | 63.80 |
| CUL2 | 812840.91 | 2367587.94 | 63.89 |
| CE1 | 812838.46 | 2367588.96 | 70.00 |
| HW1 | 812838.69 | 2367589.47 | 71.83 |
| CUL3 | 812851.04 | 2367634.06 | 63.91 |
| CUL4 | 812845.10 | 2367635.97 | 63.75 |
| CE2 | 812845.95 | 2367635.73 | 69.96 |
| HW2 | 812847.48 | 2367634.70 | 71.64 |

SKETCH SHOWING BRIDGE /PAVEMENT RELATIONSHIP

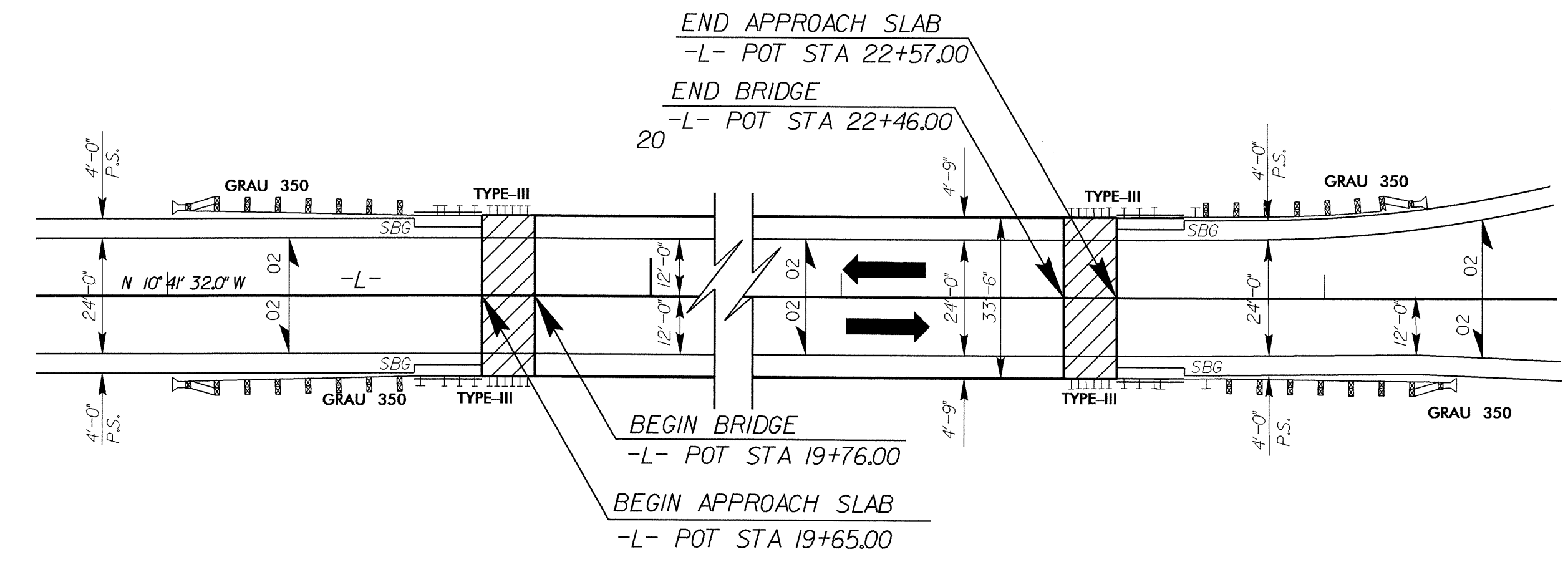

-L-
PI Sta 16+02.53
 $\Delta = 0^\circ 58' 44.6''$ (LT)
 $D = 0' 28' 38.9''$
 $L = 205.05'$
 $T = 102.53'$
 $R = 12,000.00'$
SE = NC

SHOULDER BERM GUTTER LOCATIONS:
* SEE SHEET 2 FOR DETAIL
-L- STA. 19+51 to 19+65 Rt. and Lt.
-L- STA. 22+57 to 22+71 Rt. and Lt.

