

STATE OF NORTH CAROLINA  
DIVISION OF HIGHWAYS

**TRANSPORTATION MANAGEMENT PLAN**

**COLUMBUS COUNTY**

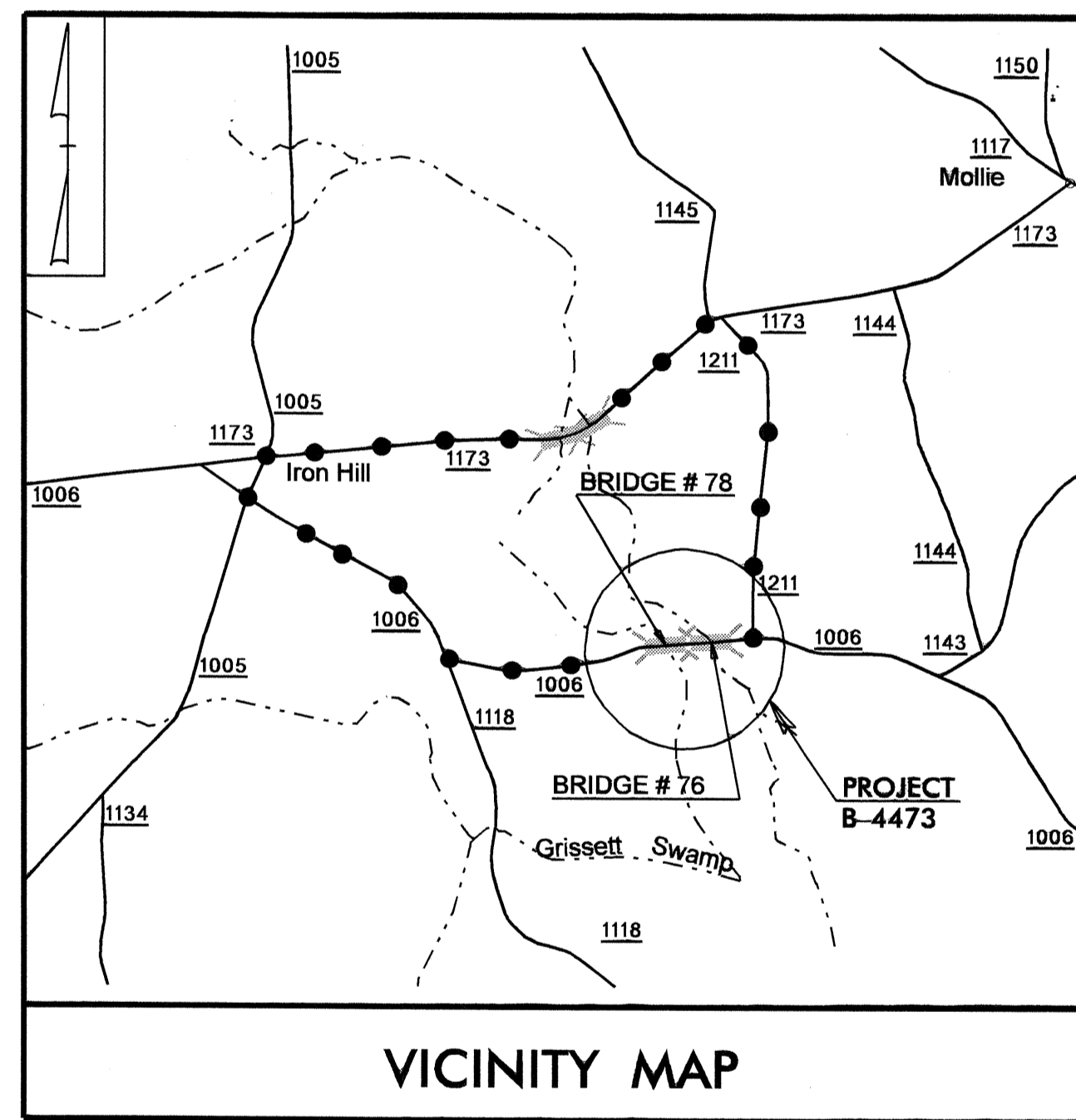
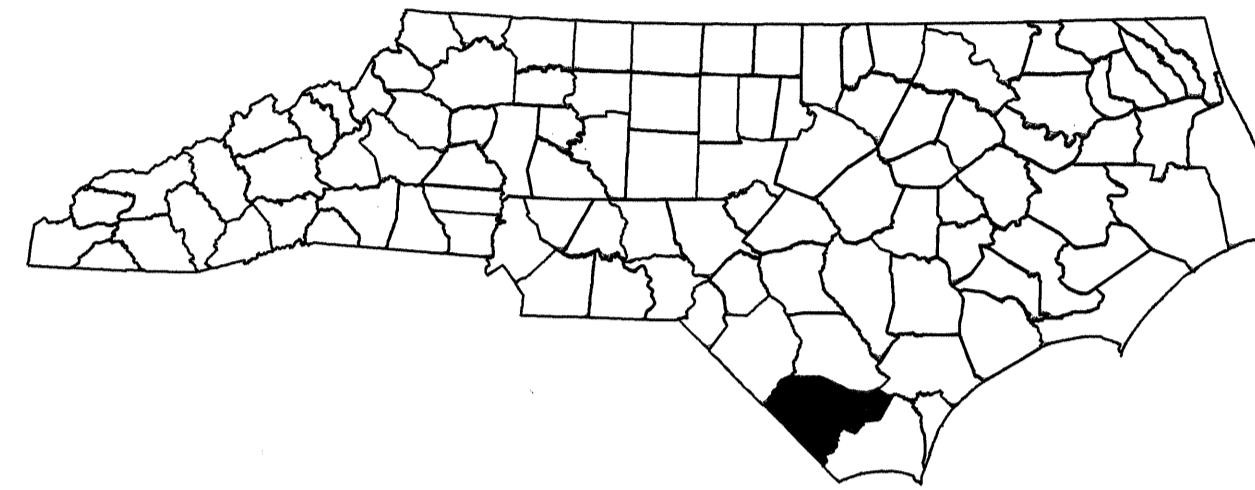

VICINITY MAP  
OFF-SITE DETOUR ROUTE ●●●●

**LOCATION: BRIDGE NO. 76 AND 78 ON SR 1006 OVER GRISSETT SWAMP**

**INDEX OF SHEETS**

| SHEET NO. | TITLE  |
|-----------|--|
| TMP-1     | TITLE SHEET, AND INDEX OF SHEETS   |
| TMP-1A    | LIST OF APPLICABLE ROADWAY STANDARD DRAWINGS, LEGEND, AND TEMPORARY PAVEMENT MARKING |
| TMP-1B    | TRANSPORTATION OPERATIONS PLAN AND PROJECT NOTES                                     |
| TMP-2A    | DETOUR SIGN DETAIL   |
| TMP-3     | TEMPORARY TRAFFIC CONTROL PHASING AND DETAIL   |

SHEET NO.  
TMP-1

**B-4473**

**TIP PROJECT:**

29-JUL-2010 13:30 \\dot\dfsroot\Proj\TIP\Projects-B\B4473\Traffic\TrafficControl\TCP\B4473.TC-TMP-1.dgn snigreen AT WZTC24733

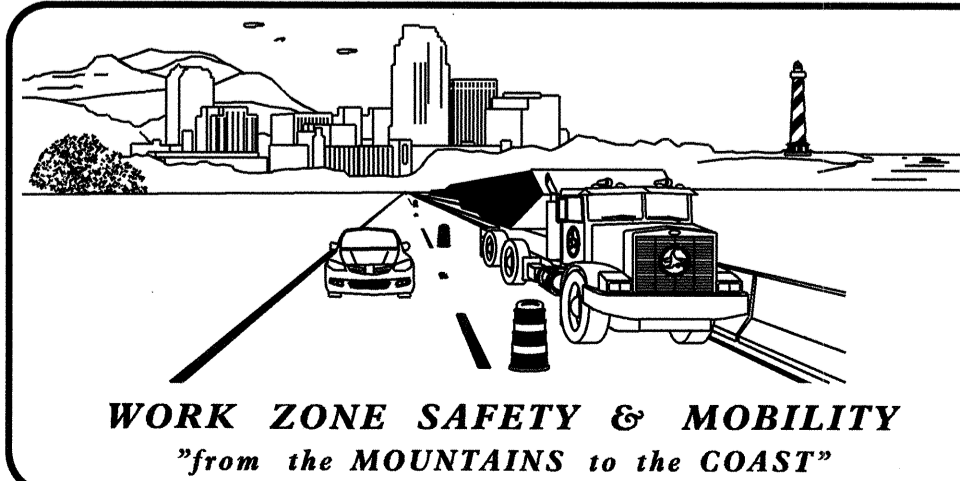

**N.C.D.O.T. WORK ZONE TRAFFIC CONTROL**  
1580 MAIL SERVICE CENTER (MSC) RALEIGH, NC 27699-1580  
1020 BIRCH RIDGE DRIVE, RALEIGH, NC 27610 (DELIVERY)  
PHONE: (919) 250-4094 FAX: (919) 250-4098

J. S. BOURNE, P.E. STATE TRAFFIC MANAGEMENT ENGINEER  
G. L. GETTIER, P.E. TRAFFIC CONTROL PROJECT ENGINEER  
J. W. GILSTRAP, P.E. TRAFFIC CONTROL PROJECT DESIGN ENGINEER  
J. D. GREEN TRAFFIC CONTROL DESIGN ENGINEER

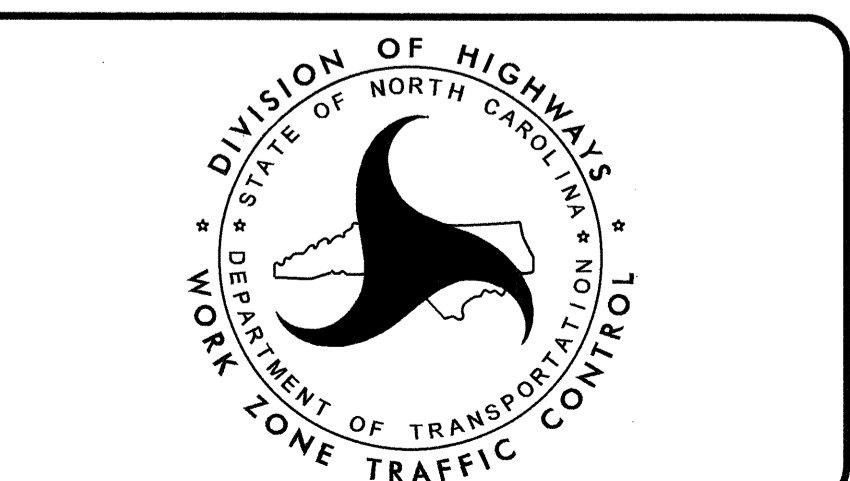

APPROVED: \_\_\_\_\_  
DATE: \_\_\_\_\_

SEAL

## ROADWAY STANDARD DRAWINGS

THE FOLLOWING ROADWAY STANDARDS AS SHOWN IN "ROADWAY STANDARD DRAWINGS" - PROJECT SERVICES UNIT - N.C. DEPARTMENT OF TRANSPORTATION - RALEIGH, N.C., DATED JULY 2006 ARE APPLICABLE TO THIS PROJECT AND BY REFERENCE HEREBY ARE CONSIDERED A PART OF THESE PLANS:

| <u>STD. NO.</u> | <u>TITLE</u>                  |
|-----------------|-------------------------------|
| 1101.03         | TEMPORARY ROAD CLOSURES       |
| 1101.05         | WORK ZONE VEHICLE ACCESSES    |
| 1101.11         | TRAFFIC CONTROL DESIGN TABLES |
| 1110.01         | STATIONARY WORK ZONE SIGNS    |
| 1145.01         | BARRICADES - TYPE III         |

## LEGEND

### GENERAL

- DIRECTION OF TRAFFIC FLOW
- NORTH ARROW

### TRAFFIC CONTROL DEVICES

- BARRICADE (TYPE III)



### TEMPORARY SIGNING

- STATIONARY SIGN

### TEMPORARY PAVEMENT MARKING

NONE

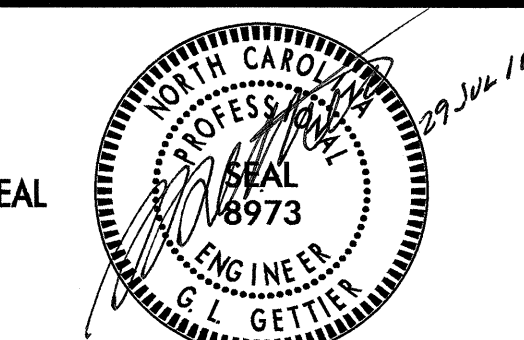
29-JUL-2010 13:31  
 \\dot\dfsroot\01\Prj\TIPPr\jects-B\B4473\Traffic\TrafficControl\TCP\B4473\_TC-TMP-1A.dgn  
 sngreen AT WZTC24733

|  |   |   |
|--|---|---|
| APPROVED: _____ DATE: _____<br> |  | <b>ROADWAY STANDARD<br/>DRAWINGS, LEGEND &amp;<br/>TEMPORARY PAVEMENT<br/>MARKING</b> |
|--|---|---|

# TRANSPORTATION OPERATIONS

## CONSTRUCTION

REMOVE AND REPLACE EXISTING STRUCTURE AND APPROACHES ALONG THE EXISTING ROADWAY ALIGNMENT AS SHOWN IN THE CONSTRUCTION PLANS.

## TMP DESIGN PARAMETERS

TRAFFIC WILL BE DETOURED OFF-SITE DURING THE CONSTRUCTION PERIOD.

THE OFF-SITE DETOUR WILL INCLUDE SR 1006, SR 1005, SR 1173 AND SR 1211. (SEE SHEET TMP-3).

# GENERAL NOTES

CHANGES MAY BE REQUIRED WHEN PHYSICAL DIMENSIONS IN THE DETAIL DRAWINGS, STANDARD DETAILS AND ROADWAY DETAILS ARE NOT ATTAINABLE TO MEET FIELD CONDITIONS, OR RESULT IN DUPLICATE, OR UNDESIRE OVERLAPPING OF DEVICES. MODIFICATION MAY INCLUDE: MOVING, SUPPLEMENTING, COVERING, OF REMOVAL OF DEVICES, AS DIRECTED BY THE ENGINEER.

THE FOLLOWING GENERAL NOTES APPLY AT ALL TIMES FOR THE DURATION OF THE CONSTRUCTION PROJECT EXCEPT WHEN OTHERWISE NOTED IN THE PLAN OR AS DIRECTED BY THE ENGINEER.

## TRAFFIC PATTERN ALTERATIONS

- A) NOTIFY THE ENGINEER TWENTY ONE (21) CALENDAR DAYS PRIOR TO ANY TRAFFIC PATTERN ALTERATION.

## SIGNING

- B) PROVIDE PERMANENT SIGNING.
- C) PROVIDE SIGNING AND DEVICES REQUIRED TO CLOSE THE ROAD ACCORDING TO THE ROADWAY STANDARD DRAWINGS AND TRAFFIC CONTROL PLANS.
- PROVIDE SIGNING REQUIRED FOR THE OFF-SITE DETOUR ROUTE AS SHOWN IN THE TRAFFIC CONTROL PLANS.
- D) COVER OR REMOVE ALL SIGNS AND DEVICES REQUIRED TO CLOSE THE ROAD WHEN ROAD CLOSURE IS NOT IN OPERATION.
- COVER OR REMOVE ALL SIGNS REQUIRED FOR THE OFF-SITE DETOUR WHEN THE DETOUR IS NOT IN OPERATION.
- E) ENSURE ALL NECESSARY SIGNING IS IN PLACE PRIOR TO ALTERING ANY TRAFFIC PATTERN.

## TRAFFIC CONTROL DEVICES

- F) PLACE TYPE III BARRICADES WITH "ROAD CLOSED" SIGN R-11-2 ATTACHED OF SUFFICIENT LENGTH TO CLOSE ENTIRE ROADWAY.

## PAVEMENT MARKINGS AND MARKERS

- G) INSTALL PAVEMENT MARKINGS AND PAVEMENT MARKERS ON THE FINAL SURFACE AS SHOWN IN THE PAVEMENT MARKING PLAN.
- H) TIE PROPOSED PAVEMENT MARKING LINES TO EXISTING PAVEMENT MARKING LINES.

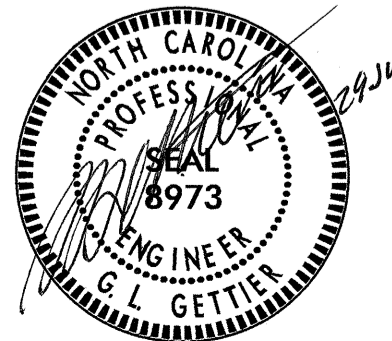
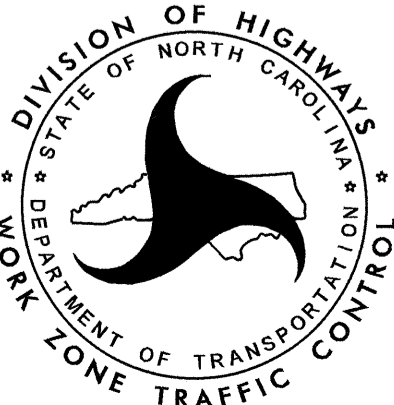
|                             |   |   |  |
|-----------------------------|---|---|--|
| APPROVED: _____ DATE: _____ |  |  | <h2>TRANSPORTATION<br/>OPERATIONS &amp;<br/>PROJECT NOTES</h2> |
| SEAL                        |   |   |  |

| <b>SIGN NUMBER:</b> SPO214<br><b>TYPE:</b> STATIONARY<br><b>QUANTITY:</b> SEE PLANS<br><b>SIGN WIDTH:</b> 3'-6"<br><b>HEIGHT:</b> 2'-0"<br><b>TOTAL AREA:</b> 7.0 Sq.Ft.<br><b>BORDER TYPE:</b> INSET<br><b>RECESS:</b> 0.47"<br><b>WIDTH:</b> 0.63"<br><b>RADII:</b> 1.5"<br><b>NO. Z BARS:</b><br><b>LENGTH:</b> | <b>BACKG COLOR:</b> Fluorescent Orange<br><b>COPY COLOR:</b> Black<br><table border="1"> <tr> <th>SYMBOL</th> <th>X</th> <th>Y</th> <th>WID</th> <th>HT</th> </tr> <tr><td> </td><td> </td><td> </td><td> </td><td> </td></tr> <tr><td> </td><td> </td><td> </td><td> </td><td> </td></tr> <tr><td> </td><td> </td><td> </td><td> </td><td> </td></tr> <tr><td> </td><td> </td><td> </td><td> </td><td> </td></tr> <tr><td> </td><td> </td><td> </td><td> </td><td> </td></tr> <tr><td> </td><td> </td><td> </td><td> </td><td> </td></tr> <tr><td> </td><td> </td><td> </td><td> </td><td> </td></tr> <tr><td> </td><td> </td><td> </td><td> </td><td> </td></tr> <tr><td> </td><td> </td><td> </td><td> </td><td> </td></tr> </table> | SYMBOL | X | Y   | WID | HT |  |  |  |  |  |  |  |  |  |  |  |  |  |  |  |  |  |  |  |  |  |  |  |  |  |  |  |  |  |  |  |  |  |  |  |  |  |  |  |  |  |  |  |  |  | <b>DESIGN BY:</b> B. Nowlin<br><b>PROJECT ID:</b> B-4473 | <b>CHECKED BY:</b> Ayman Alqudwah, PE<br><b>DIV:</b> WZTC | <b>DATE:</b> Jul 13, 2010 |
|--|---|--------|---|-----|-----|----|--|--|--|--|--|--|--|--|--|--|--|--|--|--|--|--|--|--|--|--|--|--|--|--|--|--|--|--|--|--|--|--|--|--|--|--|--|--|--|--|--|--|--|--|--|--|---|---------------------------|
|  | SYMBOL  | X      | Y | WID | HT  |    |  |  |  |  |  |  |  |  |  |  |  |  |  |  |  |  |  |  |  |  |  |  |  |  |  |  |  |  |  |  |  |  |  |  |  |  |  |  |  |  |  |  |  |  |  |  |   |                           |
|  |   |        |   |     |     |    |  |  |  |  |  |  |  |  |  |  |  |  |  |  |  |  |  |  |  |  |  |  |  |  |  |  |  |  |  |  |  |  |  |  |  |  |  |  |  |  |  |  |  |  |  |  |   |                           |
|  |   |        |   |     |     |    |  |  |  |  |  |  |  |  |  |  |  |  |  |  |  |  |  |  |  |  |  |  |  |  |  |  |  |  |  |  |  |  |  |  |  |  |  |  |  |  |  |  |  |  |  |  |   |                           |
|  |   |        |   |     |     |    |  |  |  |  |  |  |  |  |  |  |  |  |  |  |  |  |  |  |  |  |  |  |  |  |  |  |  |  |  |  |  |  |  |  |  |  |  |  |  |  |  |  |  |  |  |  |   |                           |
|  |   |        |   |     |     |    |  |  |  |  |  |  |  |  |  |  |  |  |  |  |  |  |  |  |  |  |  |  |  |  |  |  |  |  |  |  |  |  |  |  |  |  |  |  |  |  |  |  |  |  |  |  |   |                           |
|  |   |        |   |     |     |    |  |  |  |  |  |  |  |  |  |  |  |  |  |  |  |  |  |  |  |  |  |  |  |  |  |  |  |  |  |  |  |  |  |  |  |  |  |  |  |  |  |  |  |  |  |  |   |                           |
|  |   |        |   |     |     |    |  |  |  |  |  |  |  |  |  |  |  |  |  |  |  |  |  |  |  |  |  |  |  |  |  |  |  |  |  |  |  |  |  |  |  |  |  |  |  |  |  |  |  |  |  |  |   |                           |
|  |   |        |   |     |     |    |  |  |  |  |  |  |  |  |  |  |  |  |  |  |  |  |  |  |  |  |  |  |  |  |  |  |  |  |  |  |  |  |  |  |  |  |  |  |  |  |  |  |  |  |  |  |   |                           |
|  |   |        |   |     |     |    |  |  |  |  |  |  |  |  |  |  |  |  |  |  |  |  |  |  |  |  |  |  |  |  |  |  |  |  |  |  |  |  |  |  |  |  |  |  |  |  |  |  |  |  |  |  |   |                           |
|  |   |        |   |     |     |    |  |  |  |  |  |  |  |  |  |  |  |  |  |  |  |  |  |  |  |  |  |  |  |  |  |  |  |  |  |  |  |  |  |  |  |  |  |  |  |  |  |  |  |  |  |  |   |                           |
| <b>USE NOTES:</b> 1,2<br>1. Legend and border shall be direct applied black non-reflective sheeting.<br>2. Background shall be Type VII, VIII, or IX (prismatic) fluorescent orange retroreflective sheeting.  |   |        |   |     |     |    |  |  |  |  |  |  |  |  |  |  |  |  |  |  |  |  |  |  |  |  |  |  |  |  |  |  |  |  |  |  |  |  |  |  |  |  |  |  |  |  |  |  |  |  |  |  |   |                           |

**LETTER POSITIONS**

Letter locations are panel edge to lower left corner

|      |      |      |      |    |      |      |  |  |  |  |  | Series/Size<br>Text Length |
|------|------|------|------|----|------|------|--|--|--|--|--|----------------------------|
| M    |      | M    |      | R  | A    | Y    |  |  |  |  |  | C 2000                     |
| 5.1  | 9    | 15   | 19   | 25 | 28.9 | 33.1 |  |  |  |  |  | 31.9                       |
| R    | O    | A    | D    |    |      |      |  |  |  |  |  | C 2000                     |
| 15.1 | 19.4 | 23.6 | 28.3 |    |      |      |  |  |  |  |  | 16.6                       |
|      |      |      |      |    |      |      |  |  |  |  |  |                            |
|      |      |      |      |    |      |      |  |  |  |  |  |                            |
|      |      |      |      |    |      |      |  |  |  |  |  |                            |
|      |      |      |      |    |      |      |  |  |  |  |  |                            |
|      |      |      |      |    |      |      |  |  |  |  |  |                            |
|      |      |      |      |    |      |      |  |  |  |  |  |                            |
|      |      |      |      |    |      |      |  |  |  |  |  |                            |
|      |      |      |      |    |      |      |  |  |  |  |  |                            |
|      |      |      |      |    |      |      |  |  |  |  |  |                            |
|      |      |      |      |    |      |      |  |  |  |  |  |                            |

FILENAME: B-4473\_Sgn\_SGN\_SS NORTH CAROLINA D.O.T. SIGN DETAIL

03-AUG-2011 15:50  
\\dot\dfsroot\proj\IPProjects-B4473\TrafficControl\TCP\B4473\_TC-TMP-2A.dgn  
sngrreen AT TE244733

|                                 |  |                               |
|---------------------------------|--|-------------------------------|
| APPROVED: _____ DATE: _____<br> |  | <b>DETOUR SIGN<br/>DETAIL</b> |
|---------------------------------|--|-------------------------------|

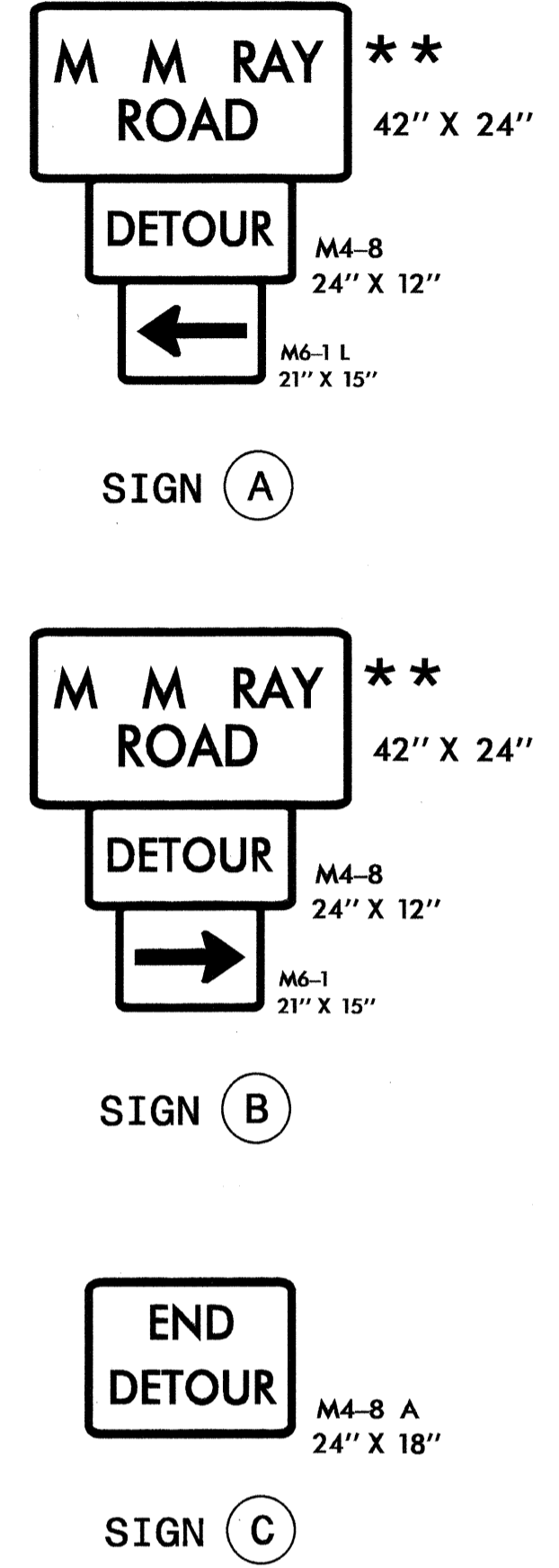
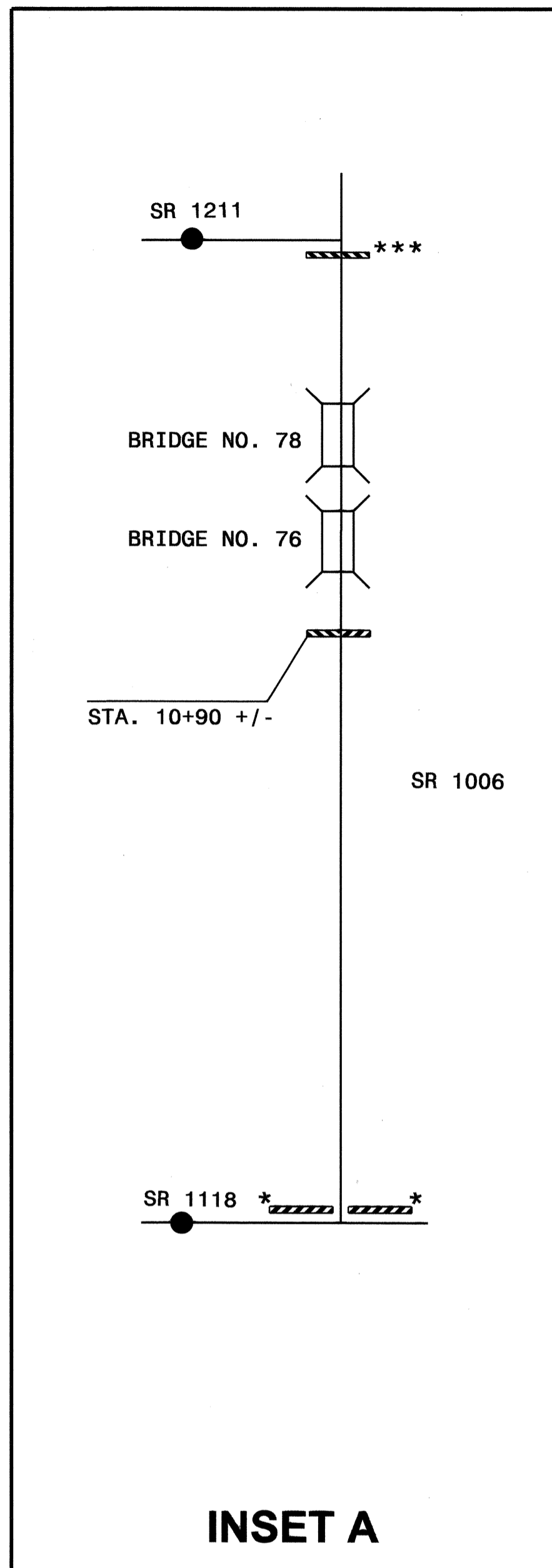
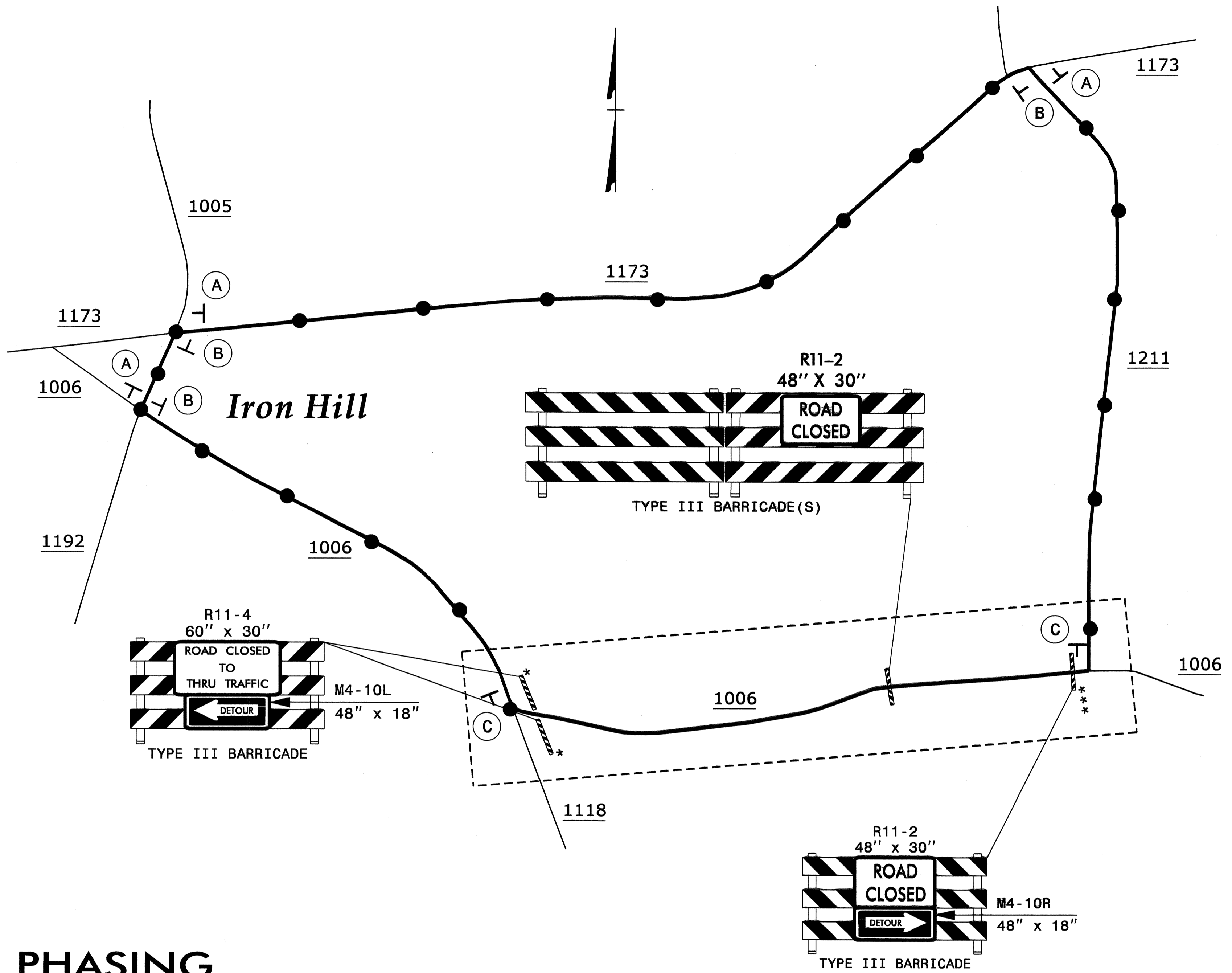

### PHASING

- STEP 1: - INSTALL OFF-SITE DETOUR ROUTE SIGN ASSEMBLIES FOR THE CLOSING OF SR 1006 (M M RAY ROAD, -L-).
- USING ROADWAY STANDARD DRAWING NO. 1101.03, SHEETS 1 OF 9 AND 2 OF 9, CLOSE SR 1006 (M M RAY RD., -L-) TO THRU TRAFFIC.
- STEP 2: - REMOVE THE EXISTING STRUCTURE AND CONSTRUCT THE PROPOSED STRUCTURE AND ROADWAY UP TO AND INCLUDING THE FINAL LAYER OF SURFACE COURSE AND PLACE FINAL PAVEMENT MARKINGS AND MARKERS ON SR 1006 (M M RAY ROAD, -L-) FROM STATION 10+90 +/- -L- TO STATION 21+95 +/- -L-. (SEE CONSTRUCTION PLANS AND PAVEMENT MARKING PLAN).
- STEP 3: - REMOVE ALL TRAFFIC CONTROL DEVICES, SIGNING AND DETOUR ROUTE SIGNING.
- OPEN TO FINAL TRAFFIC PATTERN.

- NOTES:
- ALL DETOUR SIGN LOCATIONS ARE APPROXIMATE.
  - ALL DETOUR SIGNS ARE BLACK ON ORANGE UNLESS OTHERWISE NOTED.
  - \* SEE ROADWAY STANDARD DRAWING NO. 1101.03, SHEET 1 OF 9, FOR ADDITIONAL WORK ZONE SIGNS.
  - \*\* SEE TMP-2A FOR SIGN DESIGN.
  - \*\*\* SEE ROADWAY STANDARD DRAWING NO. 1101.03, SHEET 2 OF 9, FOR ADDITIONAL WORK ZONE SIGNS.

29-JUL-2010 13:38  
 \\dot\dfs\00101\Proj\TIP\Projects-B\B4473\TrafficControl\TOP\B4473\_TC-TMP-3.dgn  
 sngreen AT WTC244733

APPROVED: \_\_\_\_\_ DATE: \_\_\_\_\_

**TEMPORARY TRAFFIC CONTROL PHASING AND DETAIL**