

STATE OF NORTH CAROLINA  
DIVISION OF HIGHWAYS

**TRANSPORTATION MANAGEMENT PLAN**

**CHOWAN COUNTY**

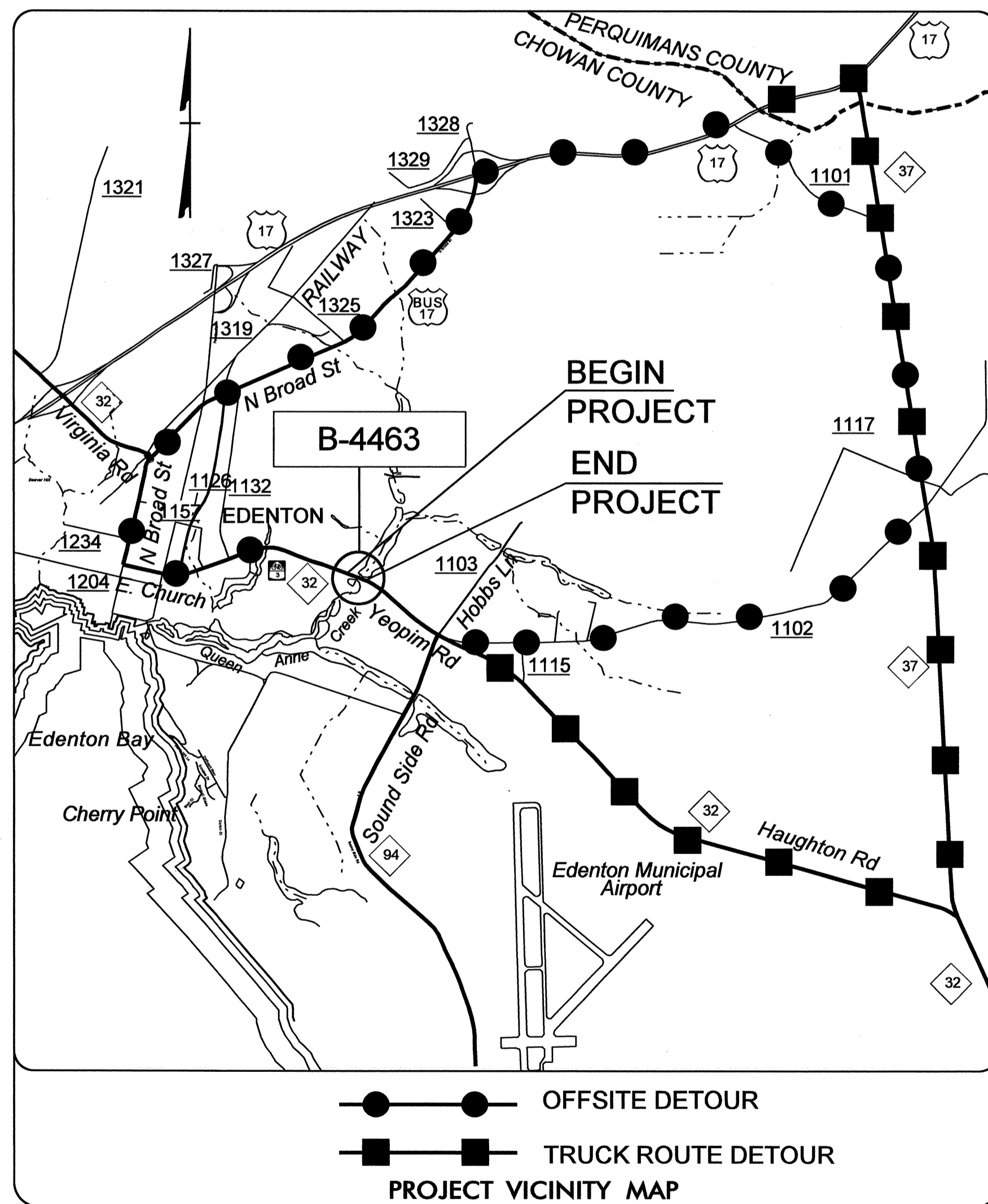

**INDEX OF SHEETS**

SHEET NO.	TITLE
TMP-1	TITLE SHEET, LEGEND AND INDEX OF SHEETS
TMP-1A	LIST OF APPLICABLE ROADWAY STANDARD DRAWINGS, GENERAL NOTES AND PROJECT PHASING
TMP-2	DETOUR ADVANCED WARNING SIGNS

**LEGEND**

- GENERAL**
- NORTH ARROW
  - WORK AREA
- TRAFFIC CONTROL DEVICES**
- BARRICADE (TYPE III)
  - CHANGEABLE MESSAGE SIGN
- TEMPORARY SIGNING**
- STATIONARY SIGN

SHEET NO.  
TMP-1

**B-4463**

**TIP PROJECT:**

30-JUN-2011 07:51  
\\dot.dfsr001\prj\TIP\projects-B\B4463\TrafficControl\TCP\B4463.TC.TMP1.A.dgn  
AT 12:44:49  
dougjoynes

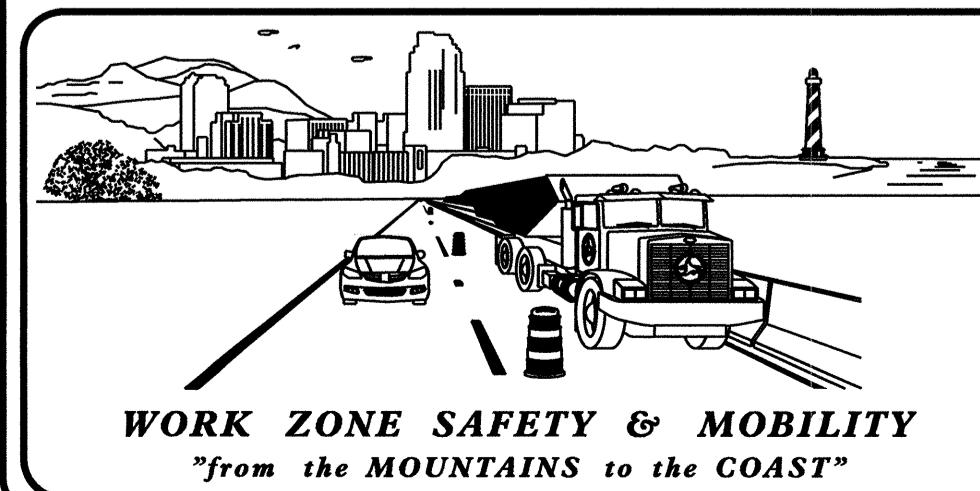

**N.C.D.O.T. WORK ZONE TRAFFIC CONTROL**  
1580 MAIL SERVICE CENTER (MSC) RALEIGH, NC 27699-1580  
1020 BIRCH RIDGE DRIVE, RALEIGH, NC 27610 (DELIVERY)  
PHONE: (919) 250-4094 FAX: (919) 250-4098

J. S. BOURNE, P.E. STATE TRAFFIC MANAGEMENT ENGINEER  
STEVE KITE, P.E. TRAFFIC CONTROL PROJECT ENGINEER  
DON PARKER TRAFFIC CONTROL PROJECT DESIGN ENGINEER  
ASHVIN PATEL, P.E. TRAFFIC CONTROL DESIGN ENGINEER

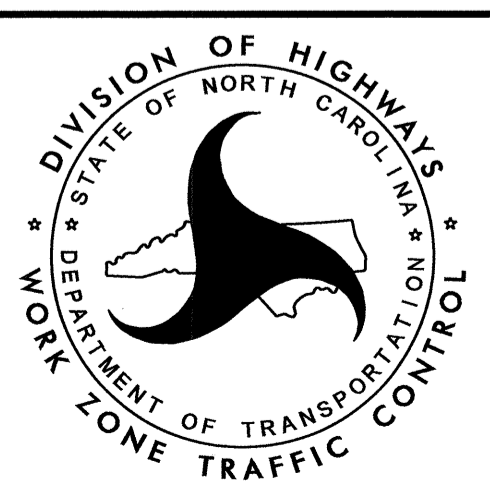

APPROVED: *[Signature]*  
DATE: June 30, 2011

SEAL

## ROADWAY STANDARD DRAWINGS

THE FOLLOWING ROADWAY STANDARDS AS SHOWN IN "ROADWAY STANDARD DRAWINGS" - PROJECT SERVICES UNIT - N.C. DEPARTMENT OF TRANSPORTATION - RALEIGH, N.C., DATED JULY 2006 ARE APPLICABLE TO THIS PROJECT AND BY REFERENCE HEREBY ARE CONSIDERED A PART OF THESE PLANS:

STD. NO.	TITLE
1101.02	TEMPORARY LANE CLOSURES
1101.03	TEMPORARY ROAD CLOSURES
1101.11	TRAFFIC CONTROL DESIGN TABLES
1110.01	STATIONARY WORK ZONE SIGNS
1110.02	PORTABLE WORK ZONE SIGNS
1130.01	DRUMS
1135.01	CONES
1145.01	BARRICADES
1150.01	FLAGGING DEVICES
1180.01	SKINNY-DRUM
1205.01	PAVEMENT MARKINGS - LINE TYPES & OFFSETS
1205.02	PAVEMENT MARKINGS - 2 LANE & MULTILANE ROADWAYS
1205.12	PAVEMENT MARKINGS - BRIDGES
1261.02	GUARDRAIL & BARRIER DELINEATOR TYPES
1262.01	GUARDRAIL END DELINEATION
1264.01	OBJECT MARKERS
1264.02	PLACEMENT OF OBJECT MARKERS

### PROJECT PHASING

STEP 1 -- USING FLAGGERS, CONTRACTOR MAY BEGIN CONSTRUCTION NOT REQUIRING ROAD CLOSURE, AS DIRECTED BY THE ENGINEER. (SEE RSD 1101.02, SHEET 1.)

NOTE: FOR STEPS 2 THRU 4, SEE INTERMEDIATE CONTRACT TIME AND LIQUIDATED DAMAGES.

STEP 2 -- USING RSD 1101.03, SHEET 1 AND TMP-2 INSTALL ADVANCE WARNING SIGNS AND BARRICADES TO CLOSE THE ROAD TO TRAFFIC. (NOTE: DETOUR ROUTE SIGNING OUTSIDE THE PROJECT LIMITS WILL BE INSTALLED BY STATE FORCES. NOTIFY THE ENGINEER TWENTY ONE (21) CALENDAR DAYS PRIOR TO TRAFFIC PATTERN ALTERATIONS.)

STEP 3 -- AWAY FROM TRAFFIC, REMOVE AND REPLACE EXISTING BRIDGE AND APPROACHES, INCLUDING PROPOSED GUARDRAIL AND COMPLETE PAVING AND FINAL PAVEMENT MARKINGS.

STEP 4 -- OPEN THE ROAD TO TWO-LANE TWO-WAY TRAFFIC.

STEP 5 -- USING FLAGGERS, COMPLETE ANY REMAINING WORK. (SEE RSD. 1101.02, SHEET 1)

STEP 6 -- REMOVE ALL TRAFFIC CONTROL DEVICES.

## GENERAL NOTES / LOCAL NOTES

CHANGES MAY BE REQUIRED WHEN PHYSICAL DIMENSIONS IN THE DETAIL DRAWINGS, STANDARD DETAILS, AND ROADWAY DETAILS ARE NOT ATTAINABLE TO MEET FIELD CONDITIONS OR RESULT IN DUPLICATE OR UNDESIRABLE OVERLAPPING OF DEVICES. MODIFICATION MAY INCLUDE: MOVING, SUPPLEMENTING, COVERING, OR REMOVAL OF DEVICES AS DIRECTED BY THE ENGINEER.

THE FOLLOWING GENERAL NOTES APPLY AT ALL TIMES FOR THE DURATION OF THE CONSTRUCTION PROJECT EXCEPT WHEN OTHERWISE NOTED IN THE PLAN OR DIRECTED BY THE ENGINEER.

#### LANE AND SHOULDER CLOSURE REQUIREMENTS

- A) REMOVE LANE CLOSURE DEVICES FROM THE LANE WHEN WORK IS NOT BEING PERFORMED BEHIND THE LANE CLOSURE OR WHEN A LANE CLOSURE IS NO LONGER NEEDED OR AS DIRECTED BY THE ENGINEER.
- B) WHEN PERSONNEL AND/OR EQUIPMENT ARE WORKING ON THE SHOULDER ADJACENT TO AN UNDIVIDED FACILITY AND WITHIN 5 FT OF AN OPEN TRAVEL LANE, CLOSE THE NEAREST OPEN TRAVEL LANE USING ROADWAY STANDARD DRAWING NO. 1101.02 UNLESS THE WORK AREA IS PROTECTED BY BARRIER OR GUARDRAIL.
- C) WHEN PERSONNEL AND/OR EQUIPMENT ARE WORKING WITHIN A LANE OF TRAVEL OF AN UNDIVIDED OR DIVIDED FACILITY, CLOSE THE LANE ACCORDING TO THE TRAFFIC CONTROL PLANS, ROADWAY STANDARD DRAWINGS, OR AS DIRECTED BY THE ENGINEER. CONDUCT THE WORK SO THAT ALL PERSONNEL AND/OR EQUIPMENT REMAIN WITHIN THE CLOSED TRAVEL LANE.
- D) DO NOT WORK SIMULTANEOUSLY WITHIN 15 FT ON BOTH SIDES OF AN OPEN TRAVELWAY, RAMP, OR LOOP WITHIN THE SAME LOCATION UNLESS PROTECTED WITH GUARDRAIL OR BARRIER.

#### PAVEMENT EDGE DROP OFF REQUIREMENTS

- E) BACKFILL AT A 6:1 SLOPE UP TO THE EDGE AND ELEVATION OF EXISTING PAVEMENT IN AREAS ADJACENT TO AN OPENED TRAVEL LANE THAT HAS AN EDGE OF PAVEMENT DROP-OFF AS FOLLOWS:  
  
BACKFILL DROP-OFFS THAT EXCEED 2 INCHES ON ROADWAYS WITH POSTED SPEED LIMITS OF 45 MPH OR GREATER.  
  
BACKFILL DROP-OFFS THAT EXCEED 3 INCHES ON ROADWAYS WITH POSTED SPEED LIMITS LESS THAN 45 MPH.  
  
BACKFILL WITH SUITABLE COMPACTED MATERIAL, AS APPROVED BY THE ENGINEER, AT NO EXPENSE TO THE DEPARTMENT.
- F) DO NOT EXCEED A DIFFERENCE OF 2 INCHES IN ELEVATION BETWEEN OPEN LANES OF TRAFFIC FOR NOMINAL LIFTS OF 1.5 INCHES. INSTALL ADVANCE WARNING "UNEVEN LANES" SIGNS (W8-11) IN ADVANCE.

#### TRAFFIC PATTERN ALTERATIONS

- G) NOTIFY THE ENGINEER TWENTY ONE (21) CALENDAR DAYS PRIOR TO ANY TRAFFIC PATTERN ALTERATION.

#### SIGNING



- H) PROVIDE SIGNING AND DEVICES REQUIRED TO CLOSE THE ROAD ACCORDING TO THE ROADWAY STANDARD DRAWINGS AND TRAFFIC CONTROL PLANS.  
  
STATE FORCES WILL BE RESPONSIBLE FOR PROVIDING SIGNING REQUIRED FOR THE OFF-SITE DETOUR ROUTE AS SHOWN IN THE TRAFFIC CONTROL PLANS.
- I) COVER OR REMOVE ALL SIGNS AND DEVICES REQUIRED TO CLOSE THE ROAD WHEN ROAD CLOSURE IS NOT IN OPERATION.  
  
STATE FORCES WILL COVER OR REMOVE ALL SIGNS REQUIRED FOR THE OFF-SITE DETOUR WHEN THE DETOUR IS NOT IN OPERATION.
- J) ENSURE ALL NECESSARY SIGNING IS IN PLACE PRIOR TO ALTERING ANY TRAFFIC PATTERN.

#### TRAFFIC CONTROL DEVICES

- K) SPACE CHANNELIZING DEVICES IN WORK AREAS NO GREATER IN FEET THAN TWICE THE POSTED SPEED LIMIT (MPH), EXCEPT 10 FT ON-CENTER IN RADII, AND 3 FT OFF THE EDGE OF AN OPEN TRAVELWAY WHEN LANE CLOSURES ARE NOT IN EFFECT. WHEN SKINNY DRUMS ARE ALLOWED REFER TO SECTION 1180 OF STANDARD SPECIFICATIONS FOR ROADS AND STRUCTURES OR AS SHOWN IN THE PLANS.
- L) PLACE TYPE III BARRICADES, WITH "ROAD CLOSED" SIGN R11-2 ATTACHED, OF SUFFICIENT LENGTH TO CLOSE ENTIRE ROADWAY.
- M) PLACE ADDITIONAL SETS OF THREE CHANNELIZING DEVICES DRUMS PERPENDICULAR TO THE EDGE OF TRAVELWAY ON 500 FT CENTERS WHEN UNOPENED LANES ARE CLOSED TO TRAFFIC.

#### PAVEMENT MARKINGS AND MARKERS

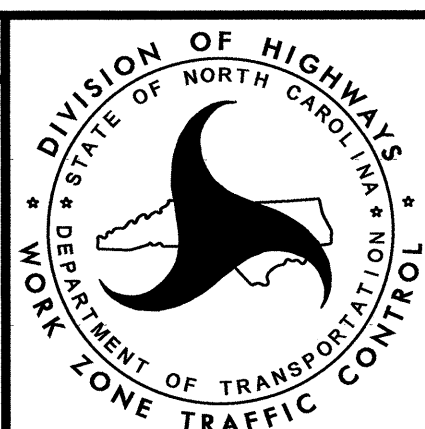
- N) INSTALL PAVEMENT MARKINGS AND PAVEMENT MARKERS ON THE FINAL SURFACE AS SHOWN IN THE PAVEMENT MARKING PLAN.
- O) PLACE ONE APPLICATION OF PAINT FOR TEMPORARY TRAFFIC PATTERNS. PLACE A SECOND APPLICATION OF PAINT SIX (6) MONTHS AFTER THE INITIAL APPLICATION AND EVERY SIX MONTHS AS DIRECTED BY THE ENGINEER.

APPROVED:  DATE: 8/11/11		<b>ROADWAY STANDARD DRAWINGS, GENERAL NOTES AND PROJECT PHASING</b>
		

NOTE: SEE RSD 1101.03, SHEET 1 OF 9 FOR ADDITIONAL NOTES AND DETAILS

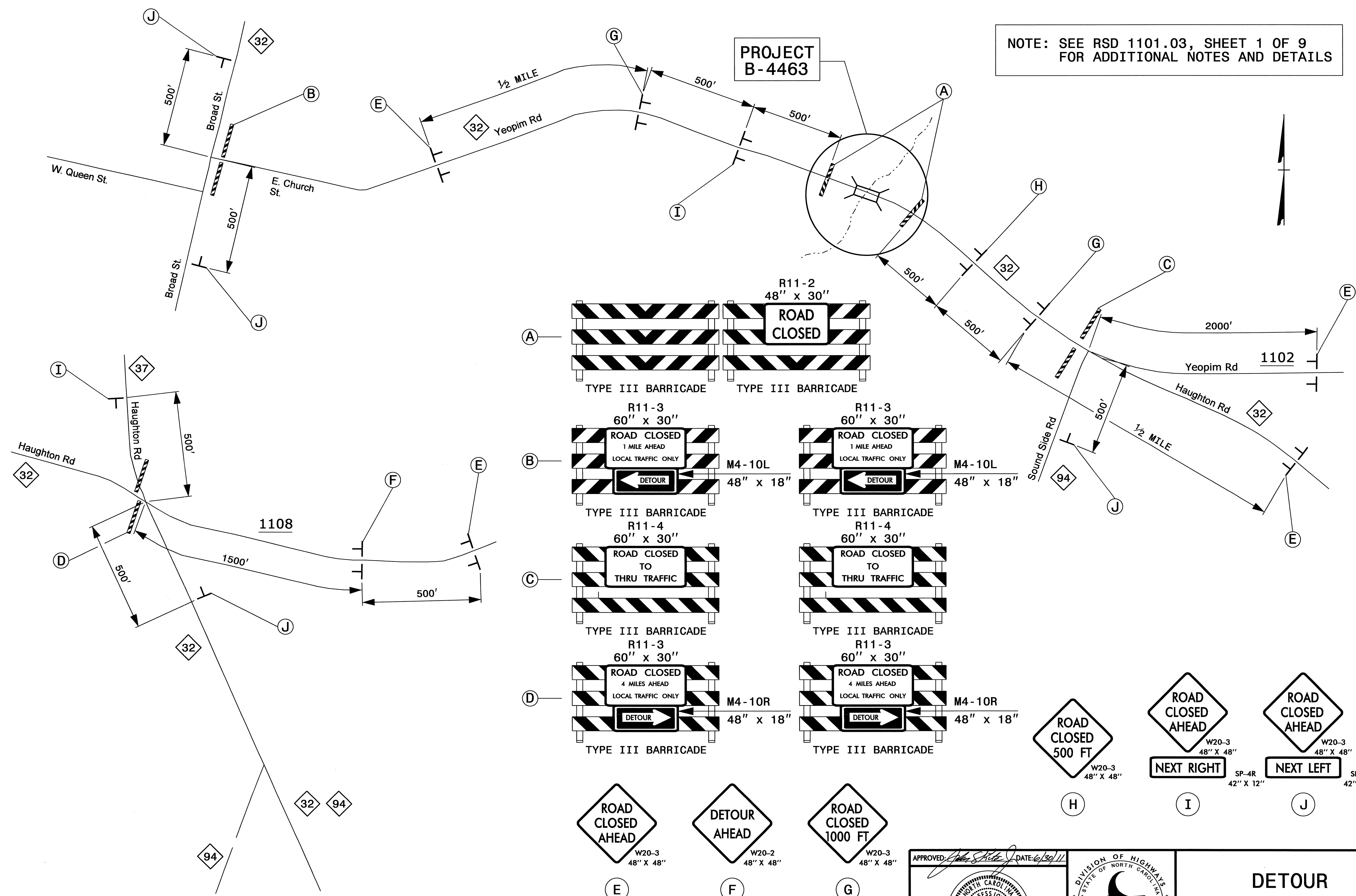

30-JUN-2011 08:21  
 \\dot\dfsroot\p\proj\TIP\Projects-B\B4463\TrafficControl\TCP\B4463.TC.TMP2.TMP3.Detour.dgn  
 AT TE244749  
 douglojner

APPROVED: *[Signature]* DATE: 6/30/11

SEAL

PROFESSIONAL ENGINEER  
 SEAL 022104  
 JOHN S. KITE JR.

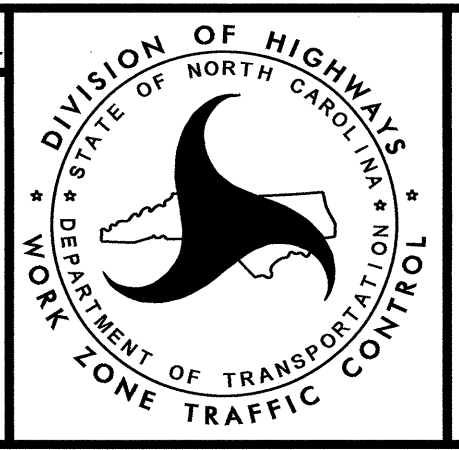

**DETOUR  
 ADVANCE WARNING  
 SIGNS**