

**STATE OF NORTH CAROLINA  
DEPARTMENT OF TRANSPORTATION**

TIP NO. B-4582	SHEET NO. PMP-1
APPROVED: <i>RWF</i>	
DATE: 4/15/11	
SEAL	
	

**PAVEMENT MARKING PLAN  
MONTGOMERY COUNTY**

**LOCATION: BRIDGE 121 OVER DENSONS CREEK ON  
SR 1323 (OKEEWEMEE ROAD)**

**T.I.P.: B-4582**

**CONTRACT: C202439**

**ROADWAY STANDARD DRAWING**

THE FOLLOWING ROADWAY STANDARDS AS APPEAR IN "ROADWAY STANDARD DRAWINGS" - PROJECT SERVICES UNIT - N.C. DEPARTMENT OF TRANSPORTATION - RALEIGH, N.C., DATED JULY 2006 ARE APPLICABLE TO THIS PROJECT AND BY REFERENCE HEREBY ARE CONSIDERED A PART OF THESE PLANS:

STD. NO.	TITLE
1205.01	PAVEMENT MARKINGS - LINE TYPES AND OFFSETS
1205.02	PAVEMENT MARKINGS - 2 LANE AND MULTILANE ROADWAYS
1205.12	PAVEMENT MARKINGS - BRIDGES
1250.01	PAVEMENT MARKER SPACING
1251.01	RAISED PAVEMENT MARKERS - TEMPORARY AND PERMANENT
1261.01	GUARDRAIL AND BARRIER DELINEATOR SPACING
1261.02	GUARDRAIL AND BARRIER DELINEATOR TYPES
1262.01	GUARDRAIL END DELINEATION

**GENERAL NOTES**

THE FOLLOWING GENERAL NOTES APPLY AT ALL TIMES FOR THE DURATION OF THE CONSTRUCTION PROJECT, EXCEPT WHEN OTHERWISE NOTED IN THE PLAN, OR DIRECTED BY THE ENGINEER.

- A) INSTALL PAVEMENT MARKINGS AND PAVEMENT MARKERS ON THE FINAL SURFACE AS FOLLOWS:  
OKEEWEMEE ROAD (SR 1323)                      PAINT                      RAISED
- B) PLACE TWO APPLICATIONS OF PAINT PAVEMENT MARKINGS ON THE FINAL WEARING SURFACE. PLACE THE SECOND APPLICATION OF PAINT UPON SUFFICIENT DRYING TIME OF THE FIRST.
- C) TIE PROPOSED PAVEMENT MARKING LINES TO EXISTING PAVEMENT MARKING LINES.
- D) REMOVE/REPLACE ANY CONFLICTING/DAMAGED PAVEMENT MARKINGS AND MARKERS.
- E) PASSING ZONES WILL BE DETERMINED IN THE FIELD AND MUST BE APPROVED BY THE ENGINEER.
- F) STOPBAR LOCATION AT NON-SIGNALIZED INTERSECTIONS MAY BE ADJUSTED AS DIRECTED BY THE ENGINEER.
- G) REMOVE ALL RESIDUE AND SURFACE LAITANCE BY ACCEPTABLE METHODS ON THE BRIDGE DECK PRIOR TO PLACING PAINT PAVEMENT MARKING.

**PAVEMENT  
MARKING SCHEDULE**

SYMBOL	DESCRIPTION
	PAINT LINES (4")
PI	YELLOW DOUBLE CENTER
PA	WHITE EDGELINE
	MARKERS
	PERMANENT RAISED PAVEMENT MARKERS
MA	YELLOW and YELLOW

PLAN PREPARED BY: N.C.D.O.T. SIGNING AND DELINEATION UNIT

SUSAN B. KUNZ    SIGNING & DELINEATION REGIONAL ENGINEER  
GEORGE TERLIZZI    SIGNING & DELINEATION DESIGN ENGINEER

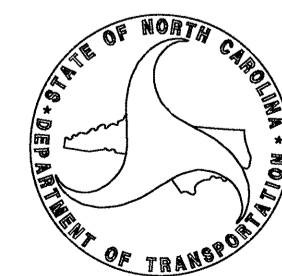

**INDEX**

SHEET NO.	DESCRIPTION
PMP-1	PAVEMENT MARKING PLAN TITLE AND SCHEDULE SHEET
PMP-2	PAVEMENT MARKING DETAIL

TIP NO. B-4582	SHEET NO. PMP-2
APPROVED: <i>R.W.K.</i>	
DATE: 4/15/11	
SEAL	

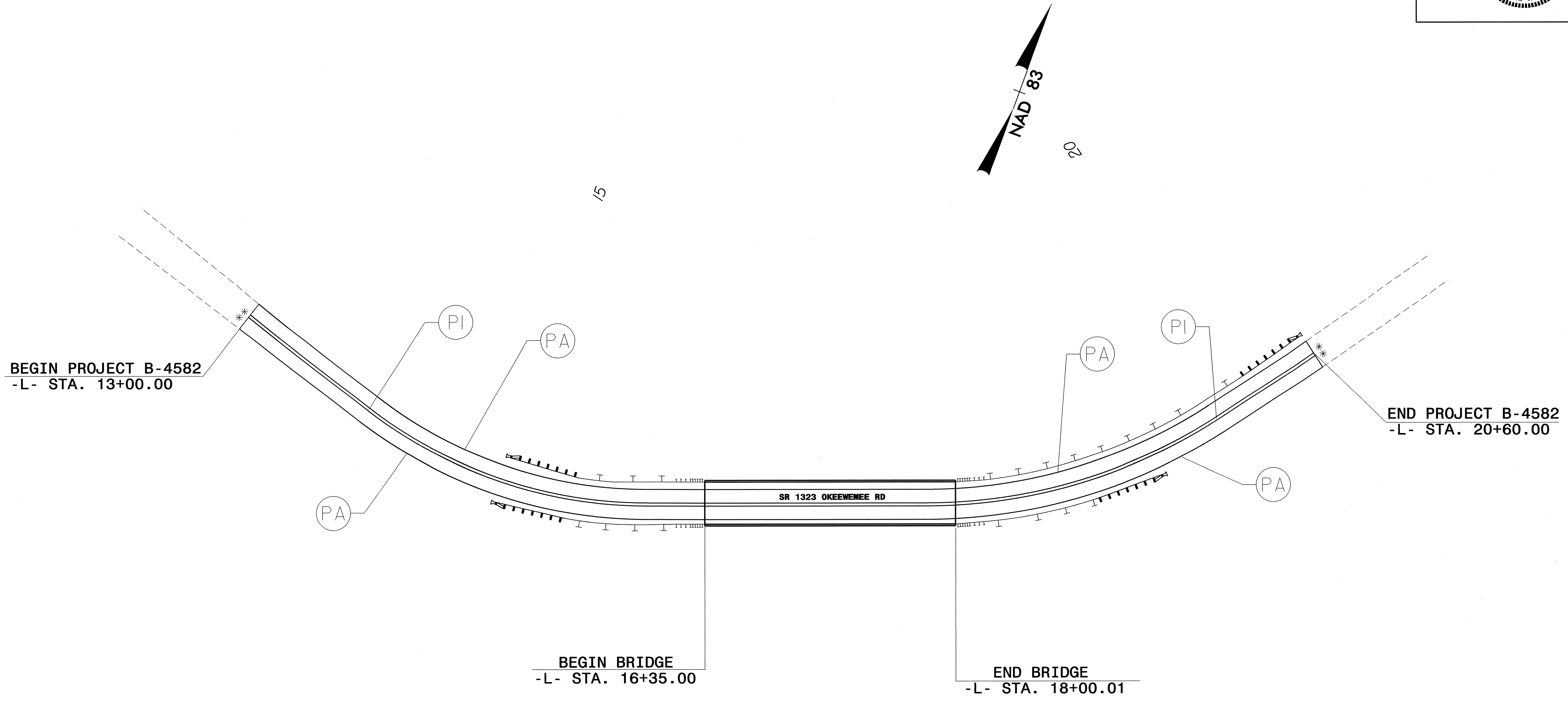

\*\* TIE TO EXISTING PAVEMENT MARKINGS

**PAVEMENT MARKING DETAIL  
SR 1323 (OKEEWEMEE ROAD)**

I:\APR2011\6104\_B-4582\_Traffic\Signing\PM\B-4582\_Sgn\_PMP.dgn  
 5/11/11 11:21 AM 12/17/11