

**STATE OF NORTH CAROLINA  
DIVISION OF HIGHWAYS**

PROJ. REFERENCE NO.	SHEET NO.
B-4034	X-1A

NOTE: EMBANKMENT COLUMN DOES NOT INCLUDE BACKFILL FOR UNDERCUT

**CROSS-SECTION SUMMARY**

**Approximate quantities only. Unclassified excavation, borrow excavation, fine grading, clearing and grubbing, and removal of existing pavement will be paid for at the lump sum price for "Grading".**

Station	Uncl. Exc.	Embt	Station	Uncl. Exc.	Embt										
L	(cu. yd.)	(cu. yd.)	DETOUR	(cu. yd.)	(cu. yd.)										
14+00.000	0	0	10+52.33	0	0										
14+50.000	1	11	10+85.24	2	1										
15+00.000	16	40	11+15.59	6	17										
15+30.000	15	28	11+35.96	6	12										
15+50.000	28	16	11+46.19	2	6										
15+60.000	19	13	11+87.38	3	73										
16+00.000	29	46	12+38.30	0	110										
16+50.000	0	50	12+88.63	0	113										
17+00.000	0	79	13+38.68	0	107										
17+46.000	0	82	13+60.00	0	36										
Station	Uncl. Exc.	Embt	Station	Uncl. Exc.	Embt										
L	(cu. yd.)	(cu. yd.)	DETOUR	(cu. yd.)	(cu. yd.)										
18+31.00	0	0	14+45.00	0	0										
18+47.17	2	38	14+88.72	0	55										
18+50.00	1	10	15+39.05	14	43										
19+00.00	0	213	15+89.98	22	13										
19+50.00	7	155	16+41.39	14	4										
20+00.00	10	88	16+92.12	8	2										
20+50.00	7	36	17+21.36	1	1										
21+00.00	16	10													
21+12.11	3	1													
Station	Uncl. Exc.	Embt	Station	Uncl. Exc.	Embt										
Y1	(cu. yd.)	(cu. yd.)	DETOUR REMOVAL	(cu. yd.)	(cu. yd.)										
10+00.000	0	0	10+52.33	0	0										
10+50.000	10	1	10+85.24	0	0										
11+00.000	27	0	11+15.59	0	0										
11+50.000	42	0	11+35.96	1	0										
12+00.000	44	76	11+46.19	1	0										
12+47.030	19	146	11+87.38	28	0										
			12+38.30	70	0										
			12+88.63	99	0										
			13+38.68	104	0										
			13+60.00	36	0										
Station	Uncl. Exc.	Embt	Station	Uncl. Exc.	Embt										
Y1	(cu. yd.)	(cu. yd.)	DETOUR REMOVAL	(cu. yd.)	(cu. yd.)										
12+65.42	0	0	14+45.00	0	0										
12+85.95	16	65	14+88.72	49	0										
			15+39.05	38	0										
			15+89.98	13	0										
			16+41.39	4	0										
			16+92.12	1	0										
			17+21.36	0	0										
Station	Uncl. Exc.	Embt	Station	Uncl. Exc.	Embt										
Y2Rev	(cu. yd.)	(cu. yd.)													
10+12.000	0	0													
10+25.000	0	93													
10+50.000	0	84													
10+75.000	0	52													
11+00.000	0	37													
11+25.690	0	28													
11+50.000	1	10													
11+73.060	1	1													



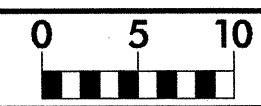

150 140 130 120 110 100 90 80 70 60 50 40 30 20 10 0 10 20 30 40 50 60 70 80 90 100 110 120 130 140 150

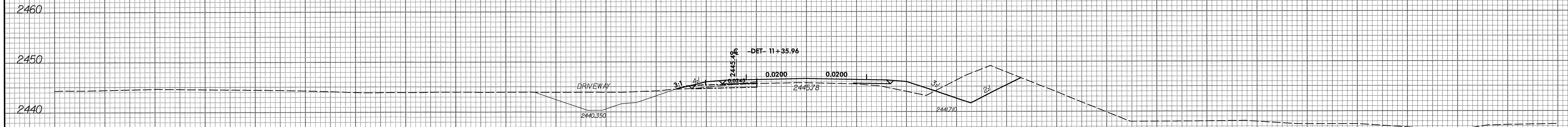

15+50.00

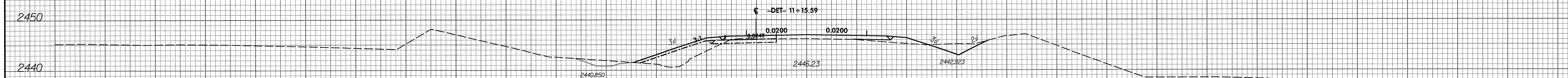

15+30.00

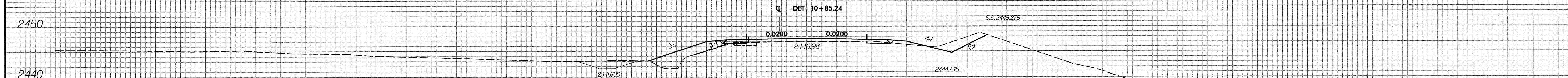

15+00.00

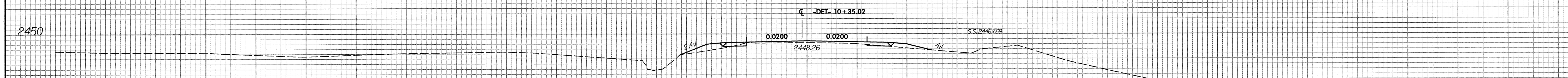

14+50.00

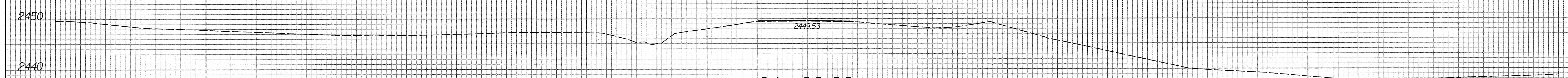

14+00.00

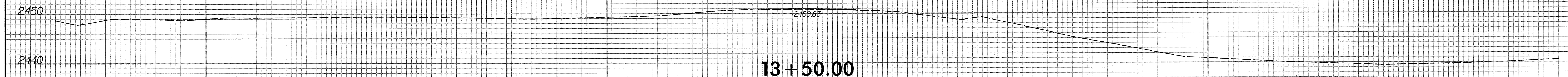

13+50.00

150 140 130 120 110 100 90 80 70 60 50 40 30 20 10 0 10 20 30 40 50 60 70 80 90 100 110 120 130 140 150



150 140 130 120 110 100 90 80 70 60 50 40 30 20 10 0 10 20 30 40 50 60 70 80 90 100 110 120 130 140 150

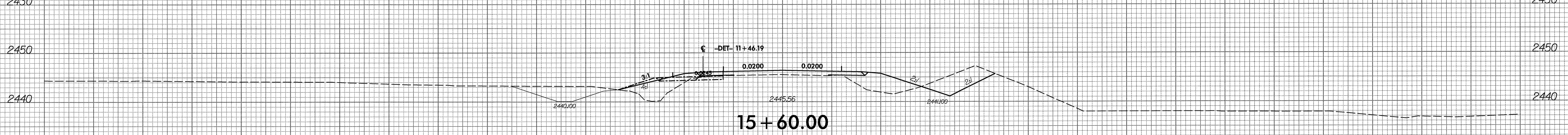
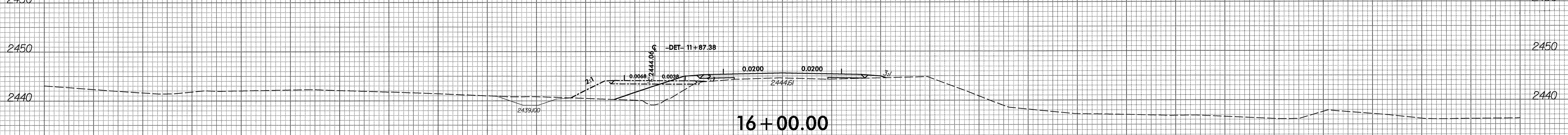
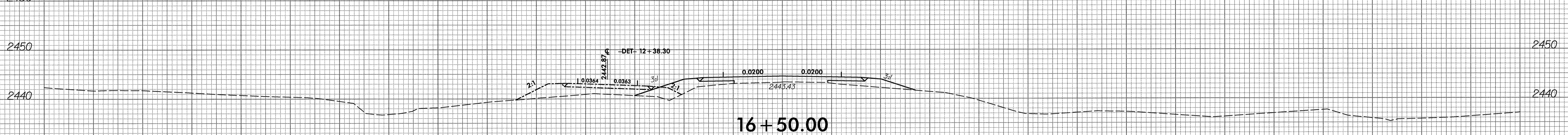
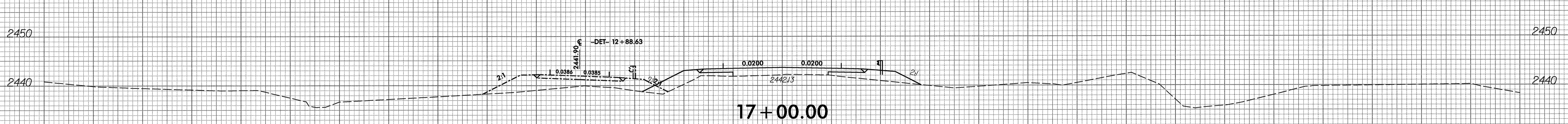
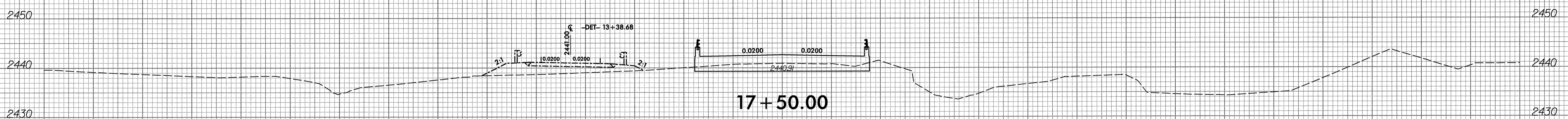
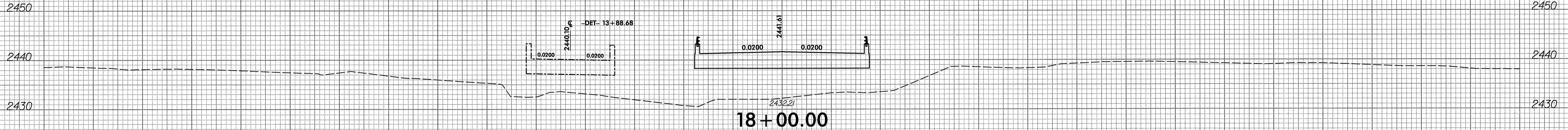

150 140 130 120 110 100 90 80 70 60 50 40 30 20 10 0 10 20 30 40 50 60 70 80 90 100 110 120 130 140 150



8/23/99



PROJ. REFERENCE NO.	SHEET NO.
B-4034	X-3

150 140 130 120 110 100 90 80 70 60 50 40 30 20 10 0 10 20 30 40 50 60 70 80 90 100 110 120 130 140 150

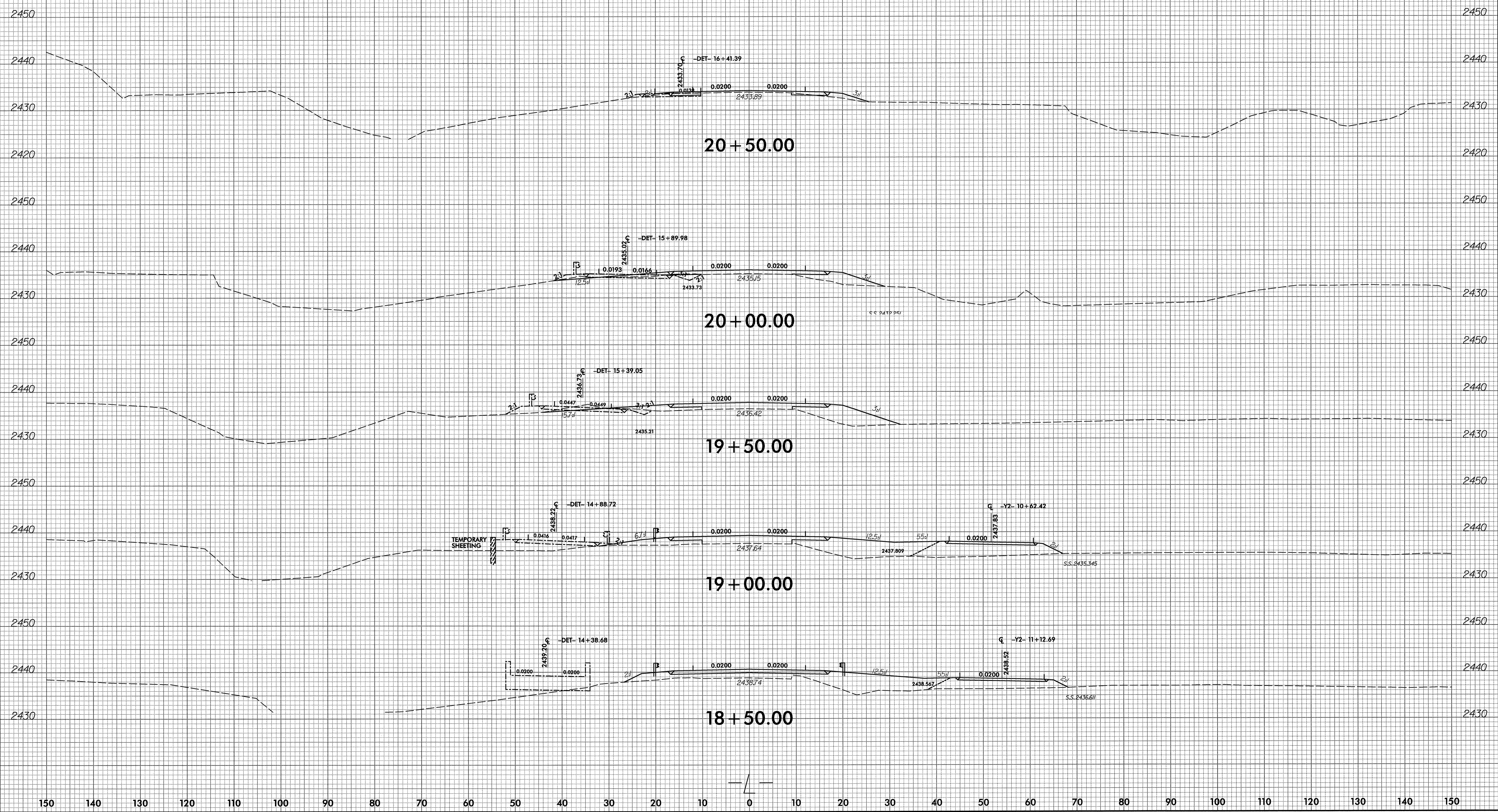

4:20:17 PM  
 8/17/2009  
 C:\Roadway\Xsec\B-4034\_rdy\_xpl\_1.dgn



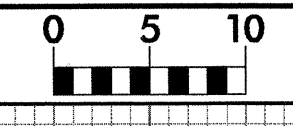

150 140 130 120 110 100 90 80 70 60 50 40 30 20 10 0 10 20 30 40 50 60 70 80 90 100 110 120 130 140 150

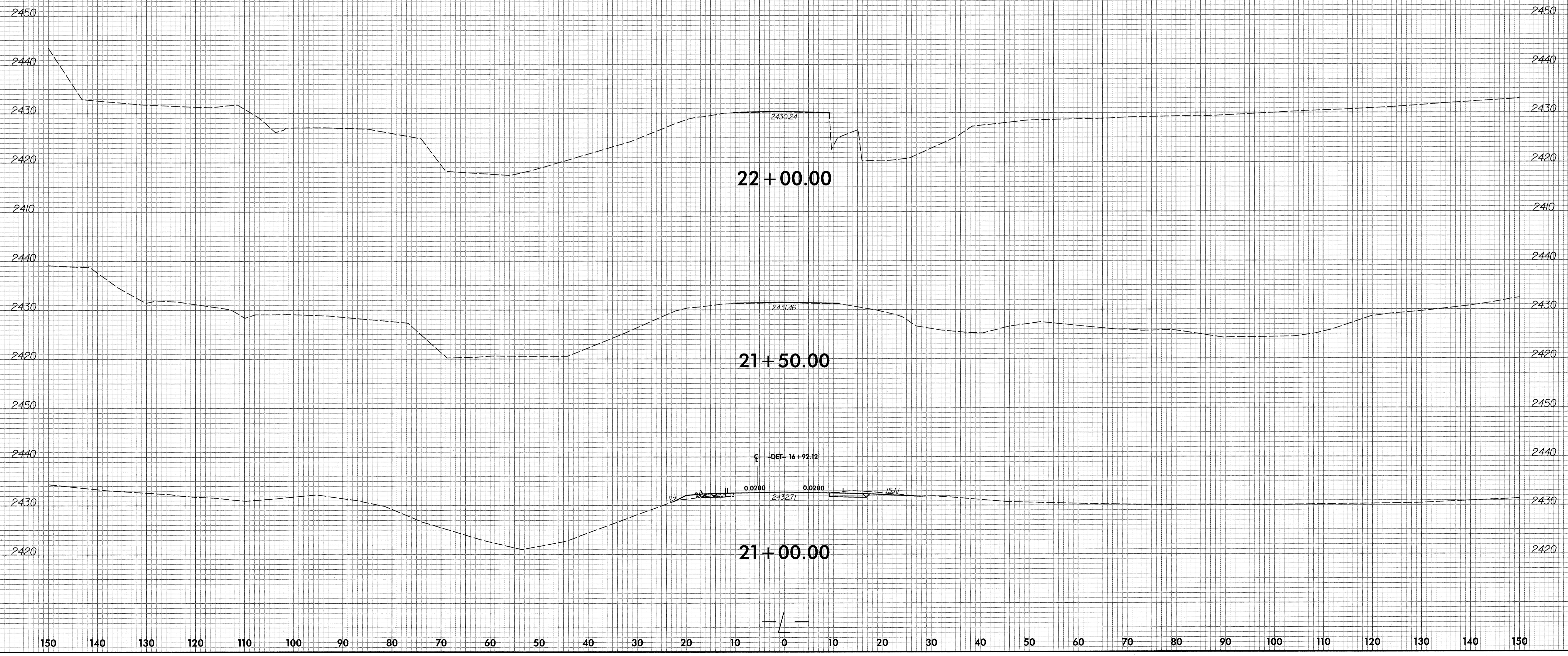

150 140 130 120 110 100 90 80 70 60 50 40 30 20 10 0 10 20 30 40 50 60 70 80 90 100 110 120 130 140 150



8/23/99

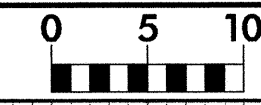

PROJ. REFERENCE NO.	SHEET NO.
B-4034	X-5

150 140 130 120 110 100 90 80 70 60 50 40 30 20 10 0 10 20 30 40 50 60 70 80 90 100 110 120 130 140 150

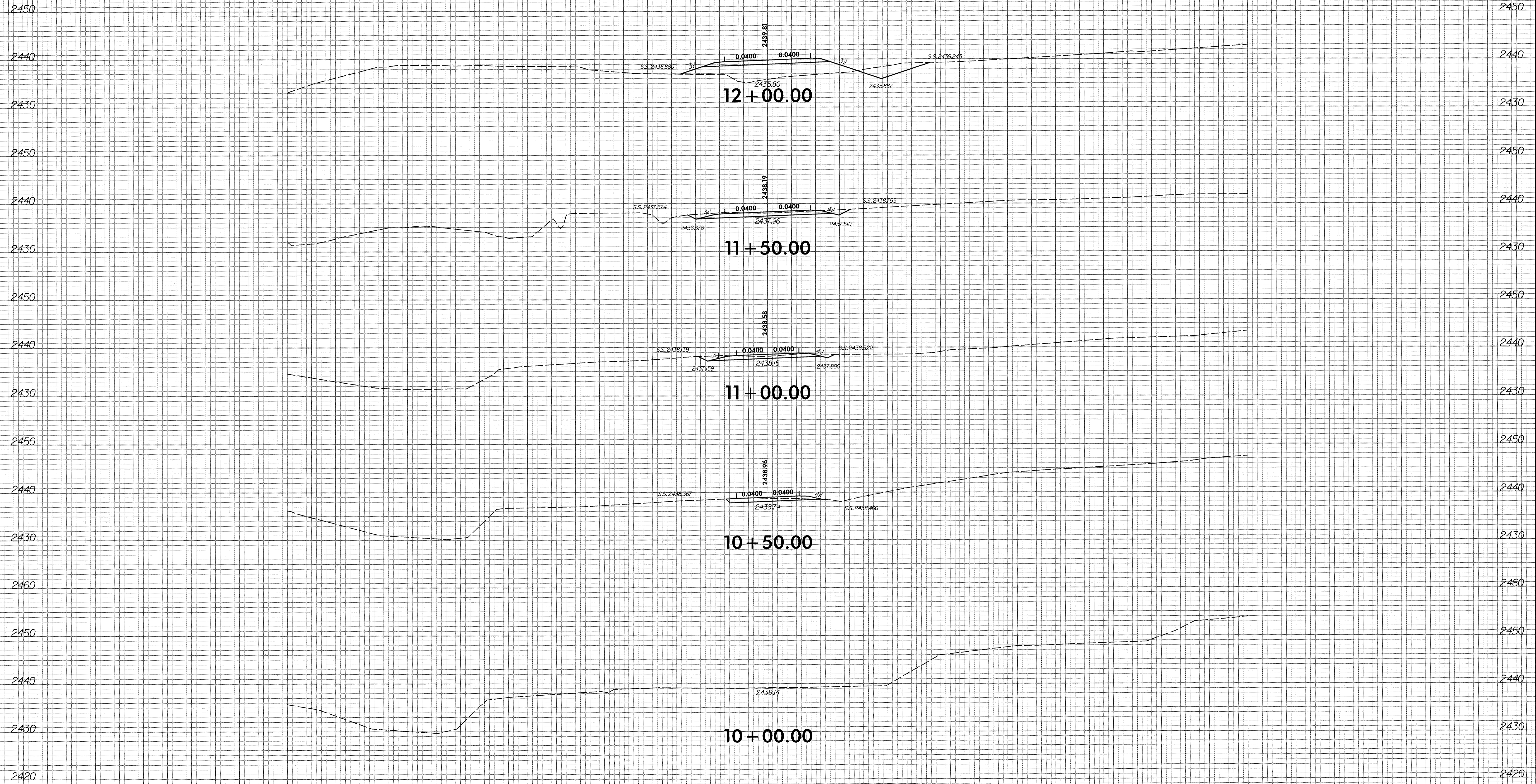

150 140 130 120 110 100 90 80 70 60 50 40 30 20 10 0 10 20 30 40 50 60 70 80 90 100 110 120 130 140 150

4:06:10 PM  
 C:\P\2004\Roadway\Xsc\B-4034\_rdy\_xpl\_1.dgn  
 7/12/2004



8/23/99

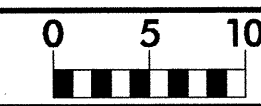

PROJ. REFERENCE NO.	SHEET NO.
B-4034	X-6

150 140 130 120 110 100 90 80 70 60 50 40 30 20 10 0 10 20 30 40 50 60 70 80 90 100 110 120 130 140 150

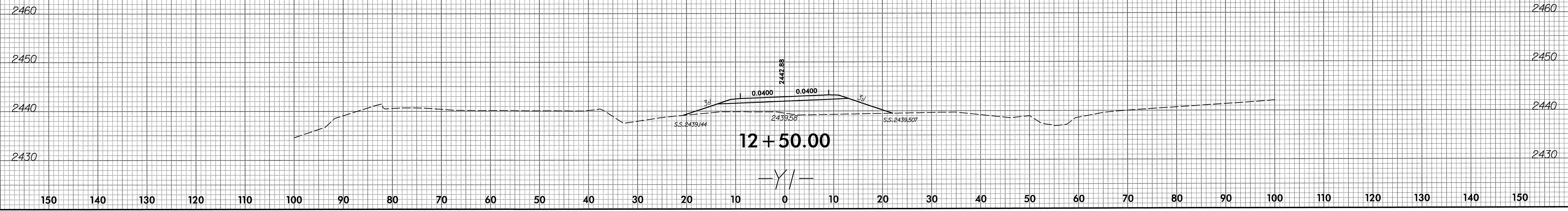

4:06:19 PM  
C:\Users\j2003\Documents\Roadway\Xsec\B-4034\_rdy\_xpl.jl.dgn



8/23/99

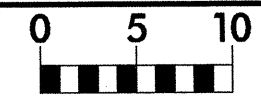

PROJ. REFERENCE NO.  
B-4034

SHEET NO.  
X-7

150 140 130 120 110 100 90 80 70 60 50 40 30 20 10 0 10 20 30 40 50 60 70 80 90 100 110 120 130 140 150

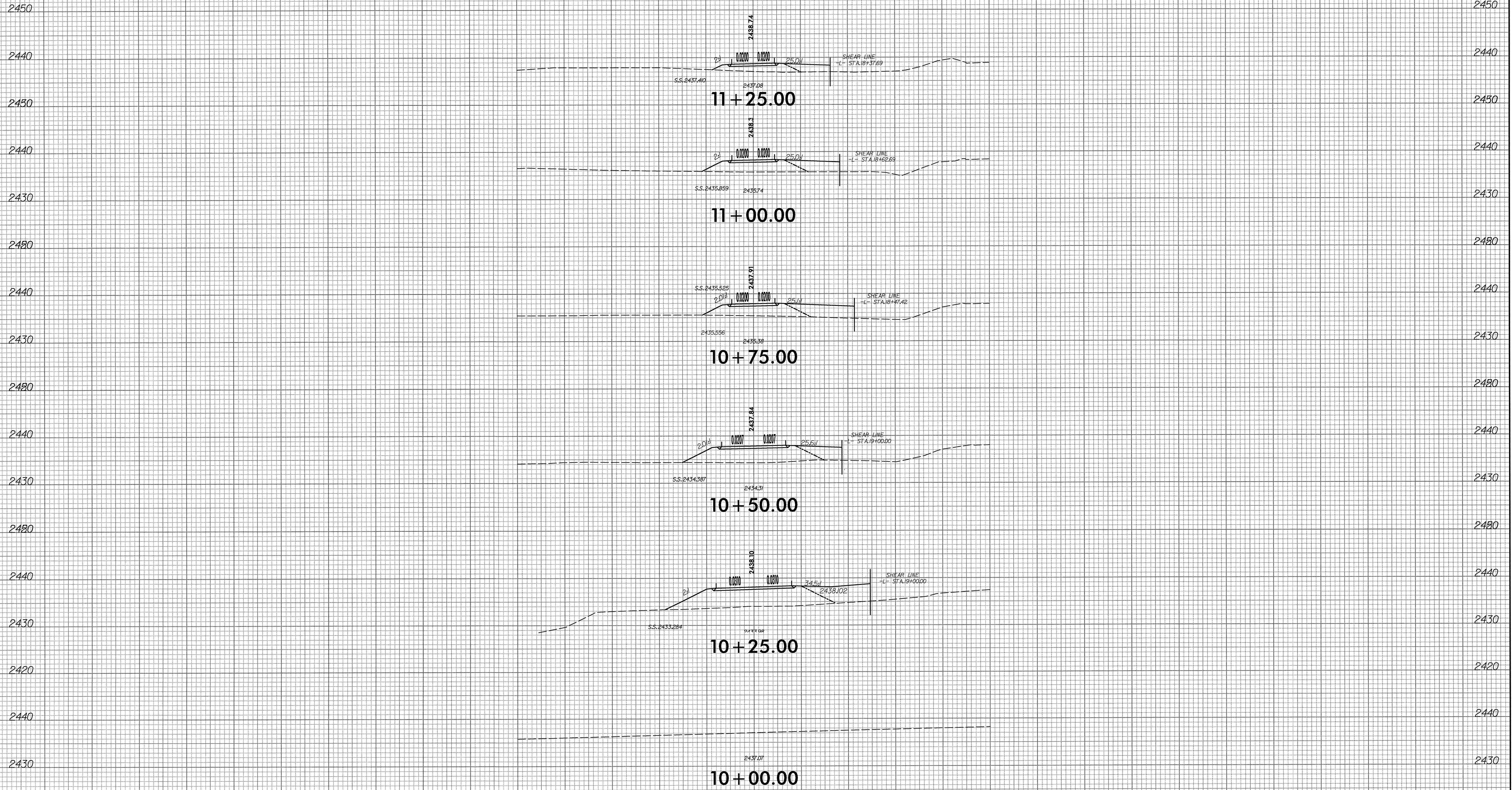

-Y2-

150 140 130 120 110 100 90 80 70 60 50 40 30 20 10 0 10 20 30 40 50 60 70 80 90 100 110 120 130 140 150

4:05:56 PM Roadway\Xsc\B-4034\_rdu\_xpl\_j2.dgn  
 8/23/99



8/23/99

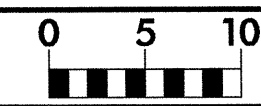

PROJ. REFERENCE NO.  
B-4034

SHEET NO.  
X-8

150 140 130 120 110 100 90 80 70 60 50 40 30 20 10 0 10 20 30 40 50 60 70 80 90 100 110 120 130 140 150



4:07:05 PM  
9/1/2009  
C:\Roadway\Xsec\B-4034\_rdu\_xpl\_12.dgn