

TIP PROJECT: B-4034

STATE OF NORTH CAROLINA
DIVISION OF HIGHWAYS

PLAN FOR PROPOSED
HIGHWAY EROSION CONTROL

BUNCOMBE COUNTY

**LOCATION: BRIDGE NO. 134 OVER STONY FORK CREEK
ON NC 151**

TYPE OF WORK: GRADING, DRAINAGE, PAVING & STRUCTURES

STATE	STATE PROJECT REFERENCE NO.	SHEET NO.	TOTAL SHEETS
N.C.	B-4034	EC-1	
STATE PROJ. NO.	F.A. PROJ. NO.	DESCRIPTION	

EROSION AND SEDIMENT CONTROL MEASURES

Std. #	Description	Symbol
1630.03	Temporary Silt Ditch	
1630.05	Temporary Diversion	
1605.01	Temporary Silt Fence	
1606.01	Special Sediment Control Fence	
1622.01	Temporary Berms and Slope Drains	
	Silt Basin Type B	
1633.01	Temporary Rock Silt Check Type-A	
	Temporary Rock Silt Check Type-A with Matting and Polyacrylamide (PAM)	
	Temporary Rock Silt Check Type-B	
	Wattle	
1634.01	Temporary Rock Sediment Dam Type-A	
1634.02	Temporary Rock Sediment Dam Type-B	
1635.01	Rock Pipe Inlet Sediment Trap Type-A	
1635.02	Rock Pipe Inlet Sediment Trap Type-B	
1630.04	Stilling Basin	
1630.06	Special Stilling Basin	
	Rock Inlet Sediment Trap:	
1632.01	Type A	
1632.02	Type B	
1632.03	Type C	
	Skimmer Basin	
	Tiered Skimmer Basin	
	Infiltration Basin	

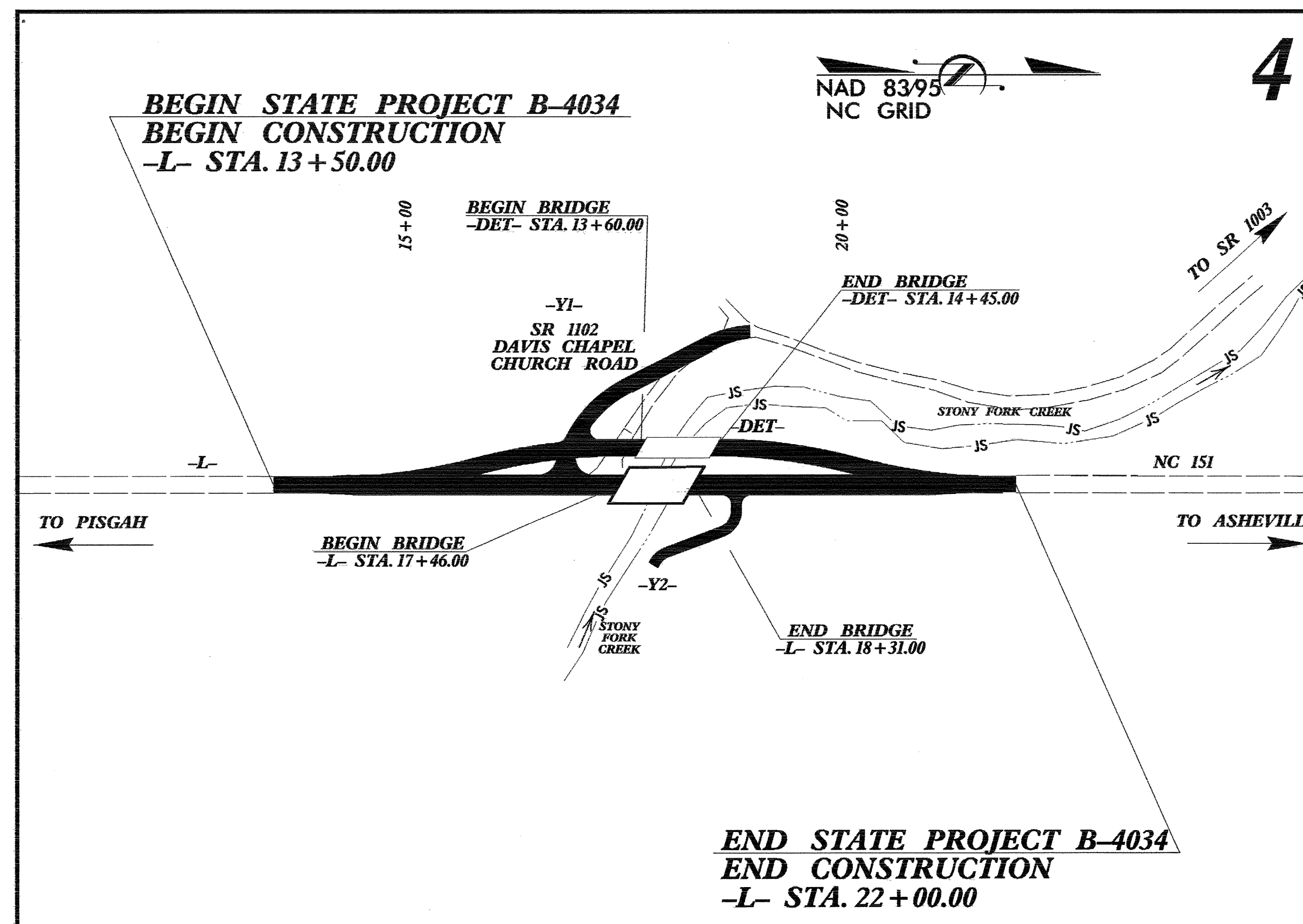

THIS PROJECT CONTAINS
EROSION CONTROL PLANS
FOR CLEARING AND
GRUBBING PHASE OF
CONSTRUCTION.

THIS PROJECT HAS
BEEN DESIGNED TO
SENSITIVE WATERSHED
STANDARDS.

ENVIRONMENTALLY
SENSITIVE AREA(S) EXIST
ON THIS PROJECT

Refer To E. C. Special Provisions
for Special Considerations.

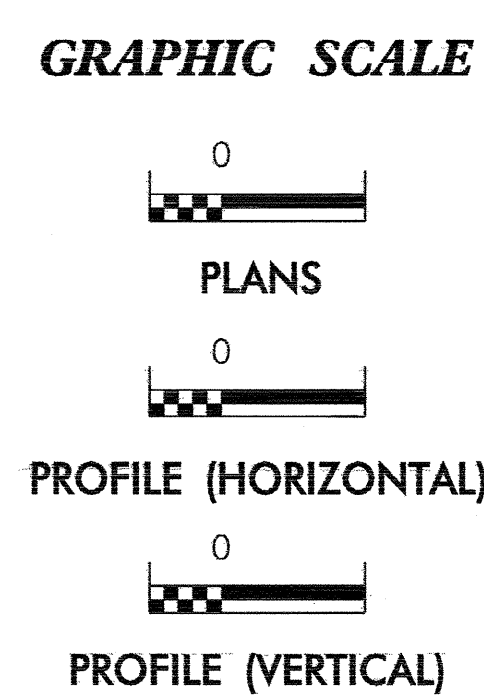

ROADSIDE ENVIRONMENTAL UNIT
DIVISION OF HIGHWAYS
STATE OF NORTH CAROLINA

Prepared in the Office of:
ROADSIDE ENVIRONMENTAL UNIT
1 South Wilmington St.
Raleigh, NC 27611
2006 STANDARD SPECIFICATIONS

Roadway Standard Drawings

The following roadway english standards as appear in "Roadway Standard Drawings"- Roadway Design Unit - N. C. Department of Transportation - Raleigh, N. C., dated July 18, 2006 and the latest revision thereto are applicable to this project and by reference hereby are considered a part of these plans.

1605.01 Temporary Silt Fence	1632.03 Rock Inlet Sediment Trap Type C
1606.01 Special Sediment Control Fence	1633.01 Temporary Rock Silt Check Type A
1607.01 Gravel Construction Entrance	1635.02 Rock Pipe Inlet Sediment Trap Type B
1622.01 Temporary Berms and Slope Drains	

26-JAN-2010 09:07
Project: B-4034, EC-1, tsh.dgn

PROJECT REFERENCE NO. B-4034	SHEET NO. EC-2
RW SHEET NO.	
ROADWAY DESIGN ENGINEER	HYDRAULICS ENGINEER

COIR FIBER BAFFLE DETAIL

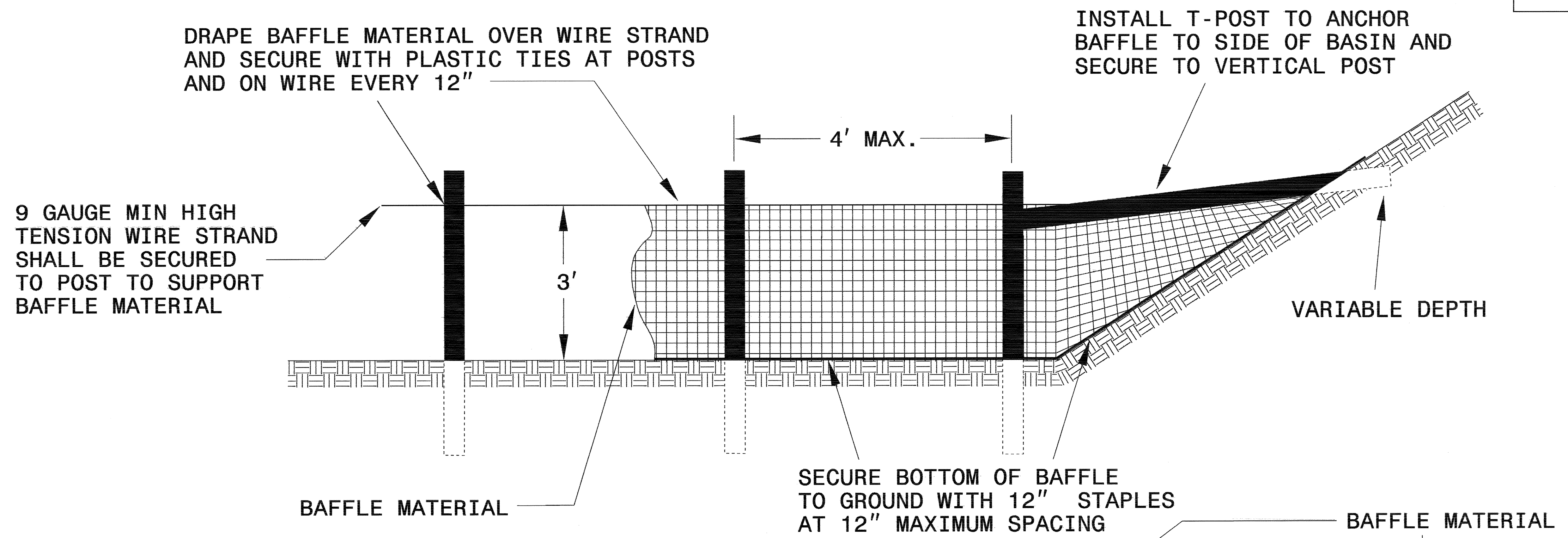

NOTES:

1. INSTALL THREE(3) COIR FIBER BAFFLES IN SILT BASINS AND SEDIMENT DAMS AT DRAINAGE OUTLETS WITH A SPACING OF $\frac{1}{4}$ THE BASIN LENGTH.
2. TWO(2) COIR FIBER BAFFLES CAN BE INSTALLED IN SILT BASINS AND DAMS LESS THAN 20 FT. IN LENGTH WITH A SPACING OF $\frac{1}{3}$ THE BASIN LENGTH.
3. TOP HEIGHT OF COIR FIBER BAFFLES SHALL NOT BE BELOW BASE OF EMERGENCY SPILLWAY ELEVATION.

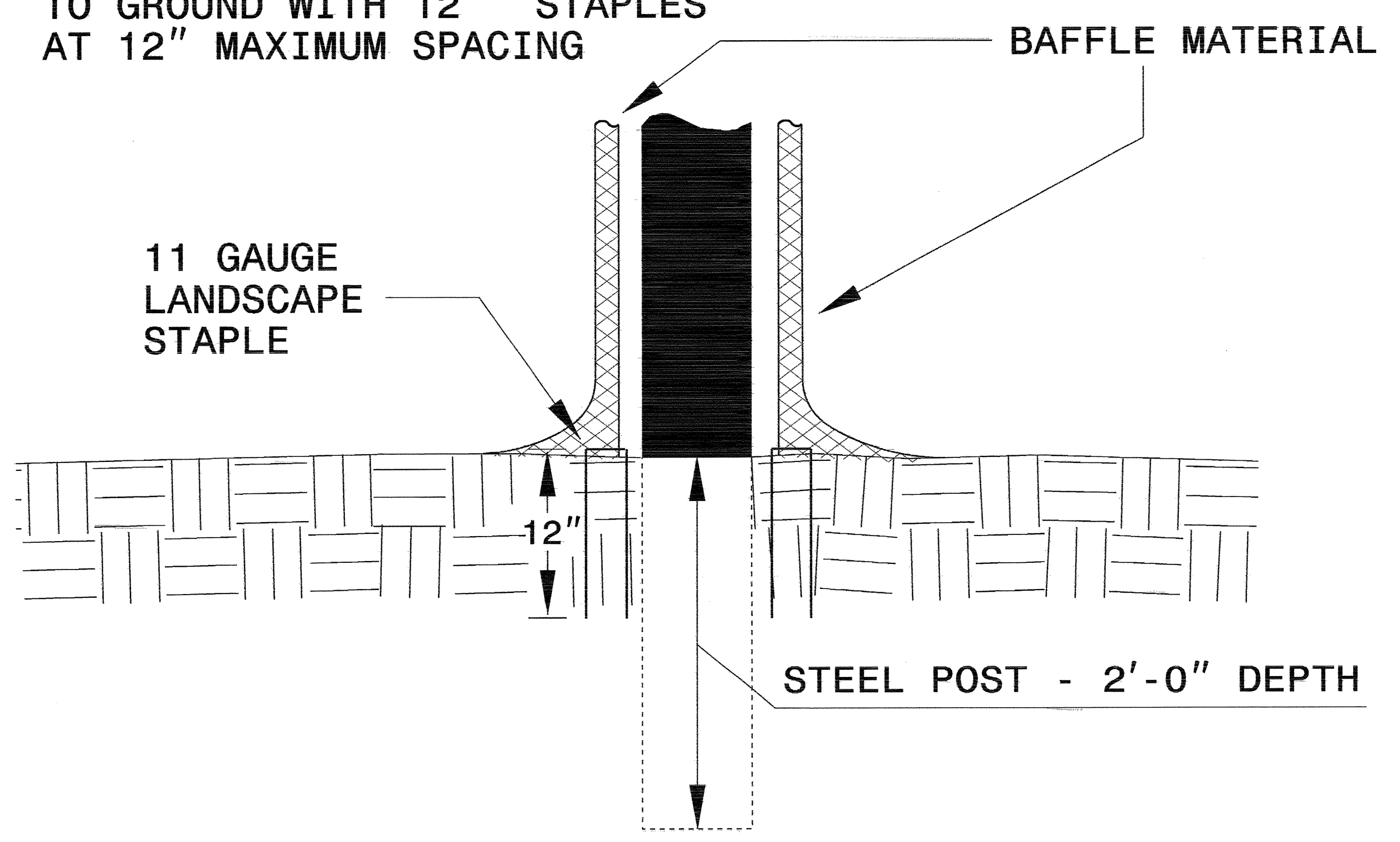

BAFFLE MATERIAL SHALL BE SECURED TO THE BOTTOM AND SIDES OF BASIN USING 12" LANDSCAPE STAPLES

SKIMMER BASIN WITH BAFFLES DETAIL

PROJECT REFERENCE NO. B-4034	SHEET NO. EC-2A
RW SHEET NO.	
ROADWAY DESIGN ENGINEER	HYDRAULICS ENGINEER

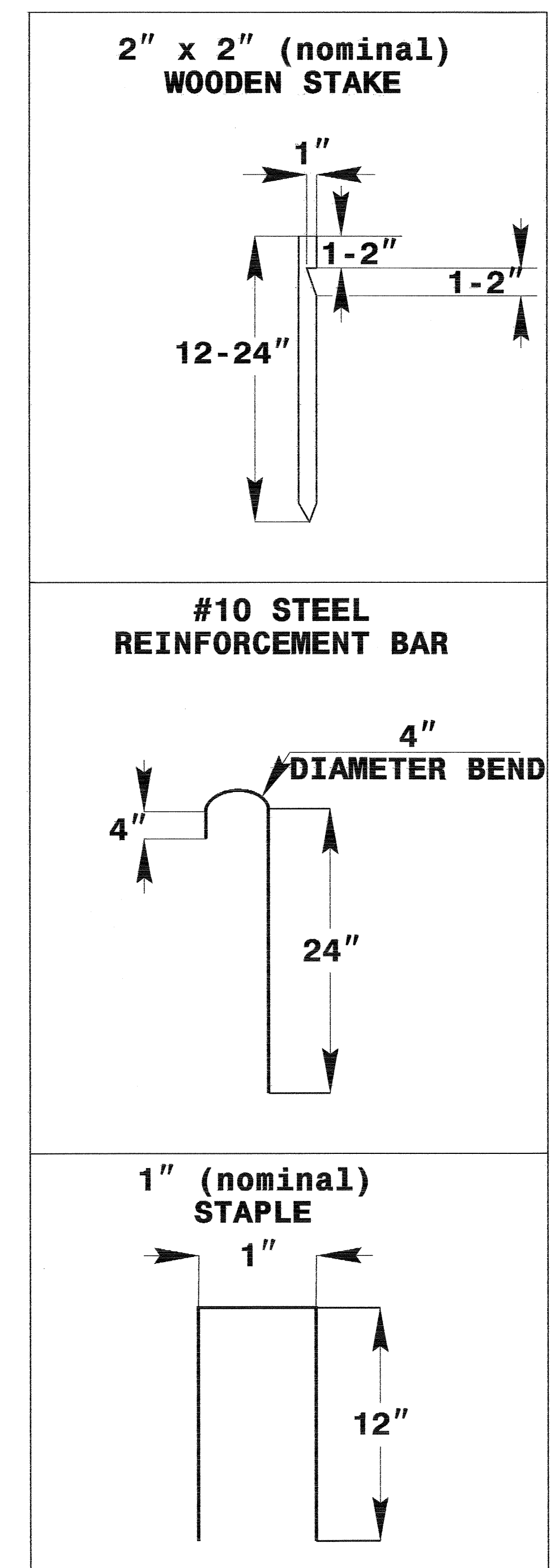
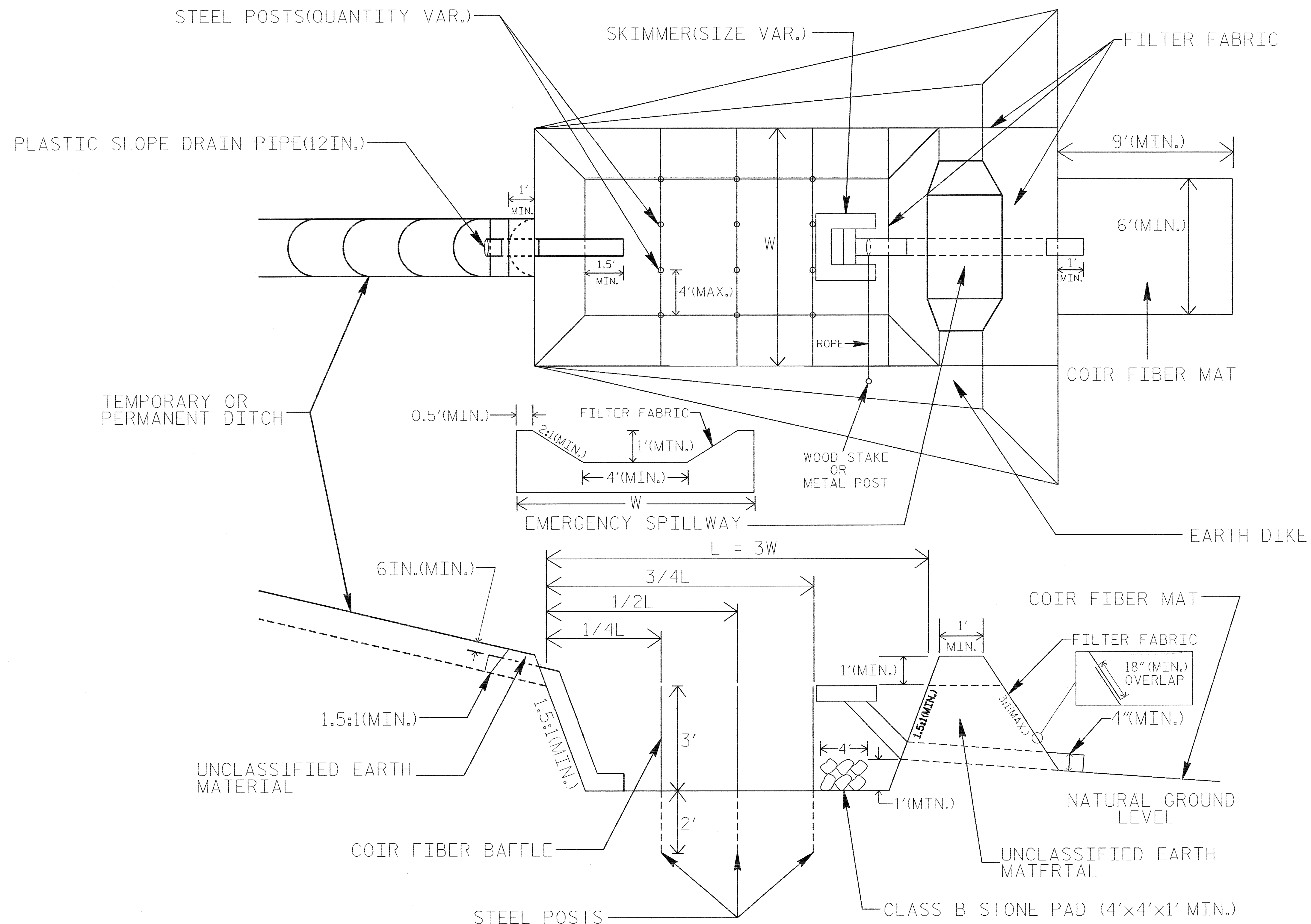

COIR FIBER MAT ANCHOR OPTIONS

NOTES

1. SEED AND PLACE MATTING FOR EROSION CONTROL ON INTERIOR AND EXTERIOR SIDESLOPES.
2. LIMIT EARTH DIKE HEIGHT TO 5 FT.
3. FOR BASIN DEPTH OF 3 FT., THE MINIMUM BASIN WIDTH SHALL BE 9 FT.
4. DETERMINE EMERGENCY SPILLWAY LENGTH (FT.) USING $Q/0.8$, WHERE Q IS FLOW RATE (CFS) INTO BASIN.
5. PLASTIC SLOPE DRAIN PIPE AT INLET OF BASIN MAY BE REPLACED BY FILTER FABRIC AS DIRECTED.
6. FILTER FABRIC FOR EMERGENCY SPILLWAY SHALL BE ONE CONTINUOUS PIECE OF MATERIAL OR OVERLAPPED 18" (MIN.) AS SHOWN.

NOT TO SCALE

PROJECT REFERENCE NO. B-4034	SHEET NO. EC-2B
RW SHEET NO.	
ROADWAY DESIGN ENGINEER	HYDRAULICS ENGINEER

SILT BASIN 'B' DETAIL

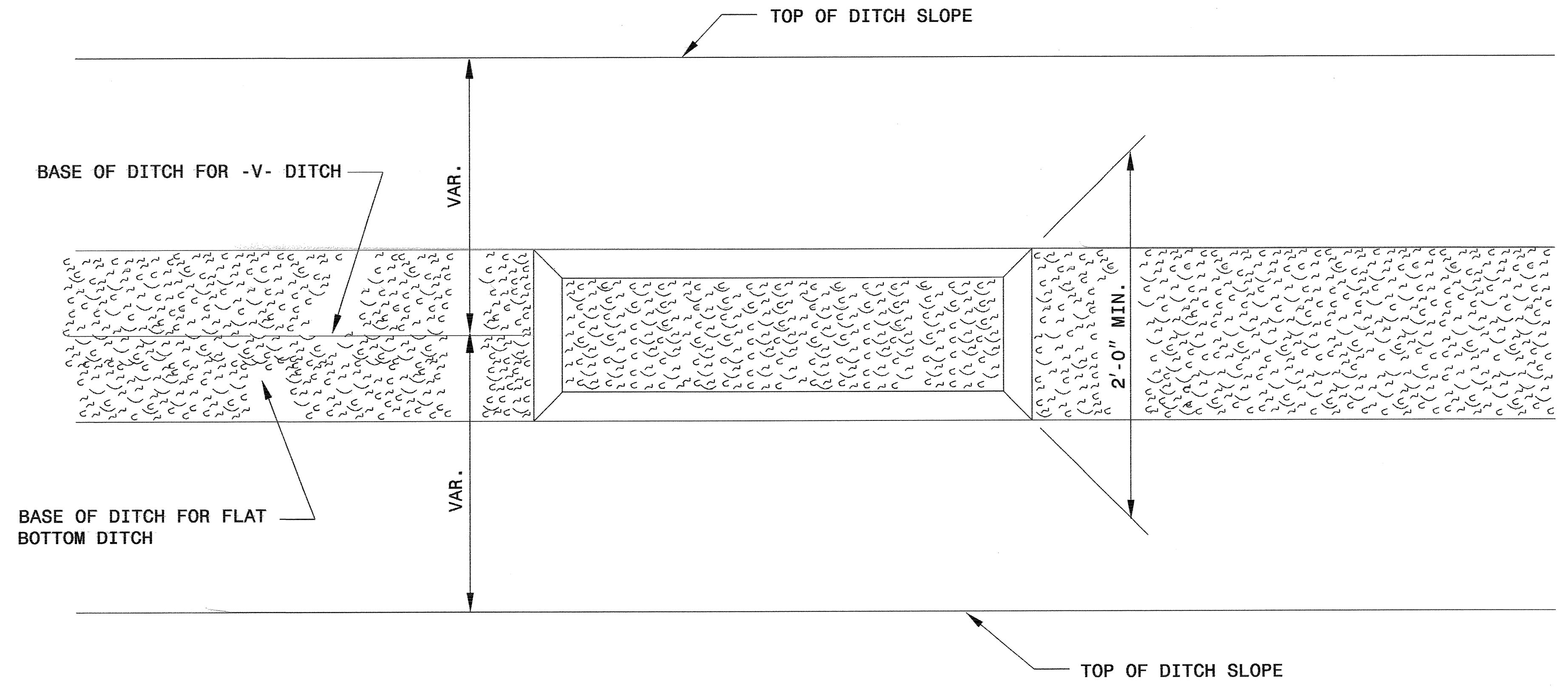

PLAN

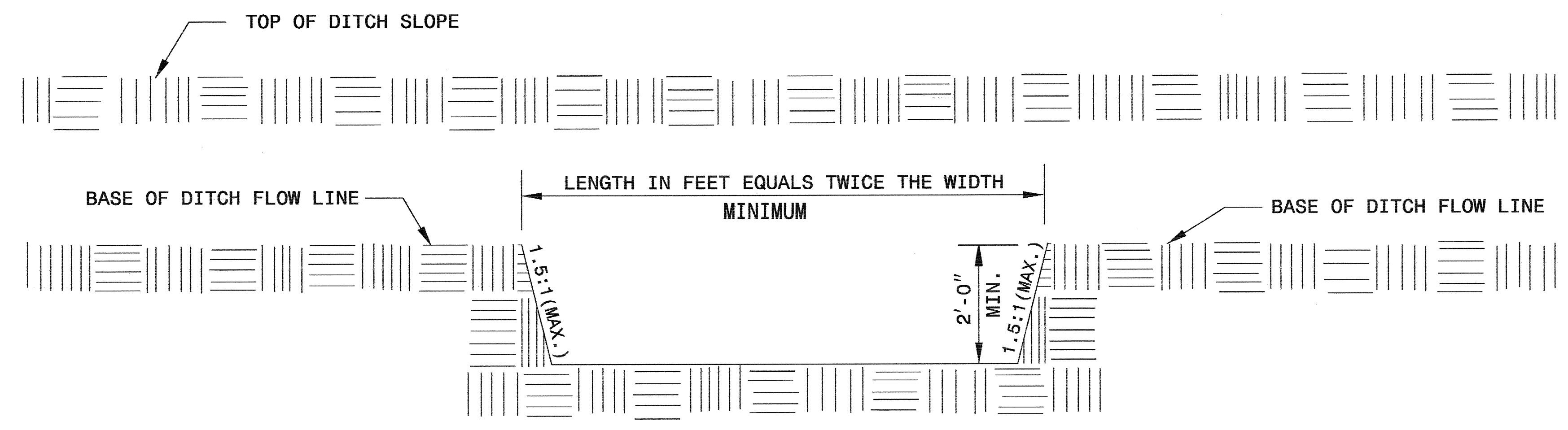

ELEVATION

PROJECT REFERENCE NO. B-4034	SHEET NO. EC-2C
RW SHEET NO.	
ROADWAY DESIGN ENGINEER	HYDRAULICS ENGINEER

MATTING INSTALLATION DETAIL

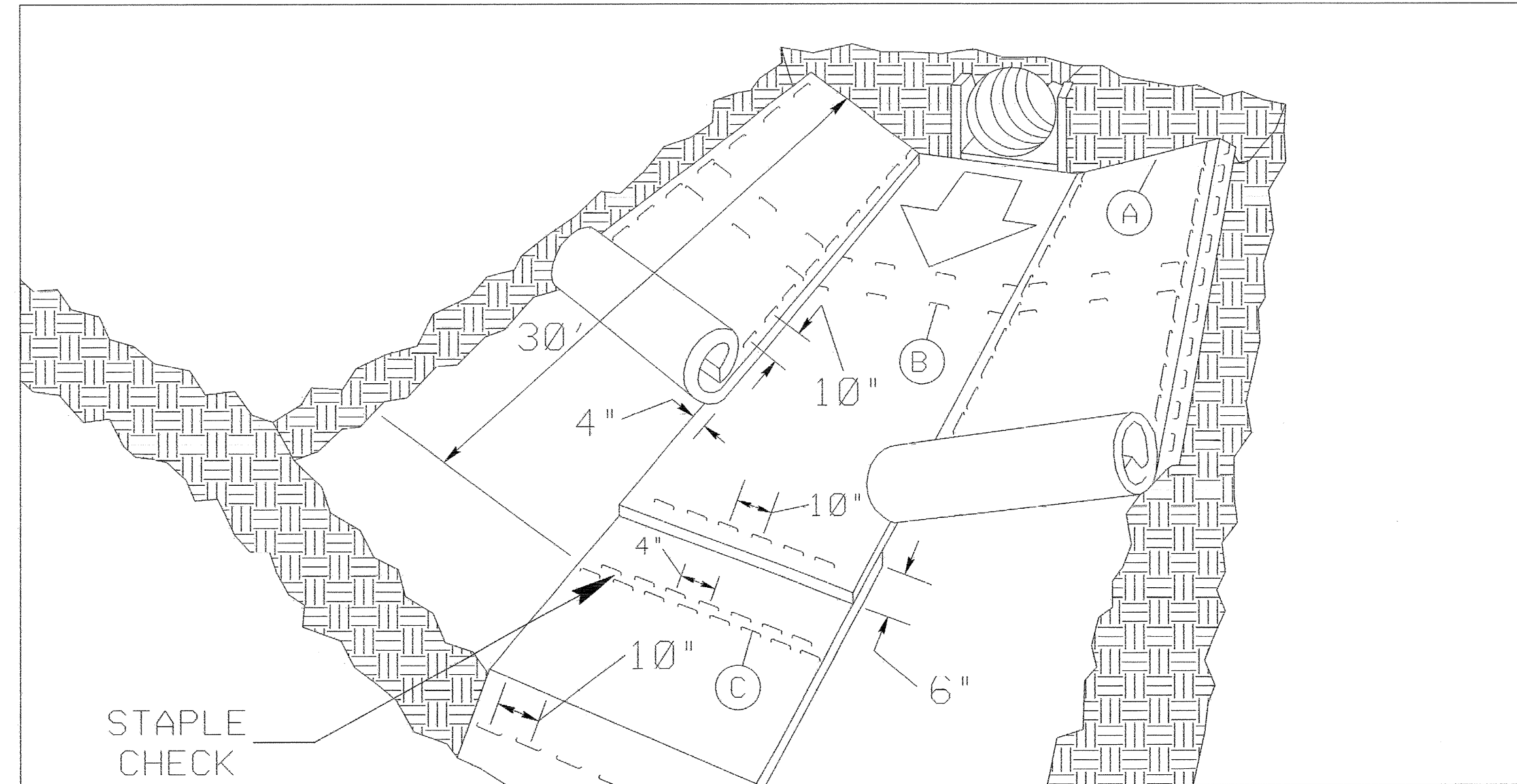

MATTING IN DITCHES

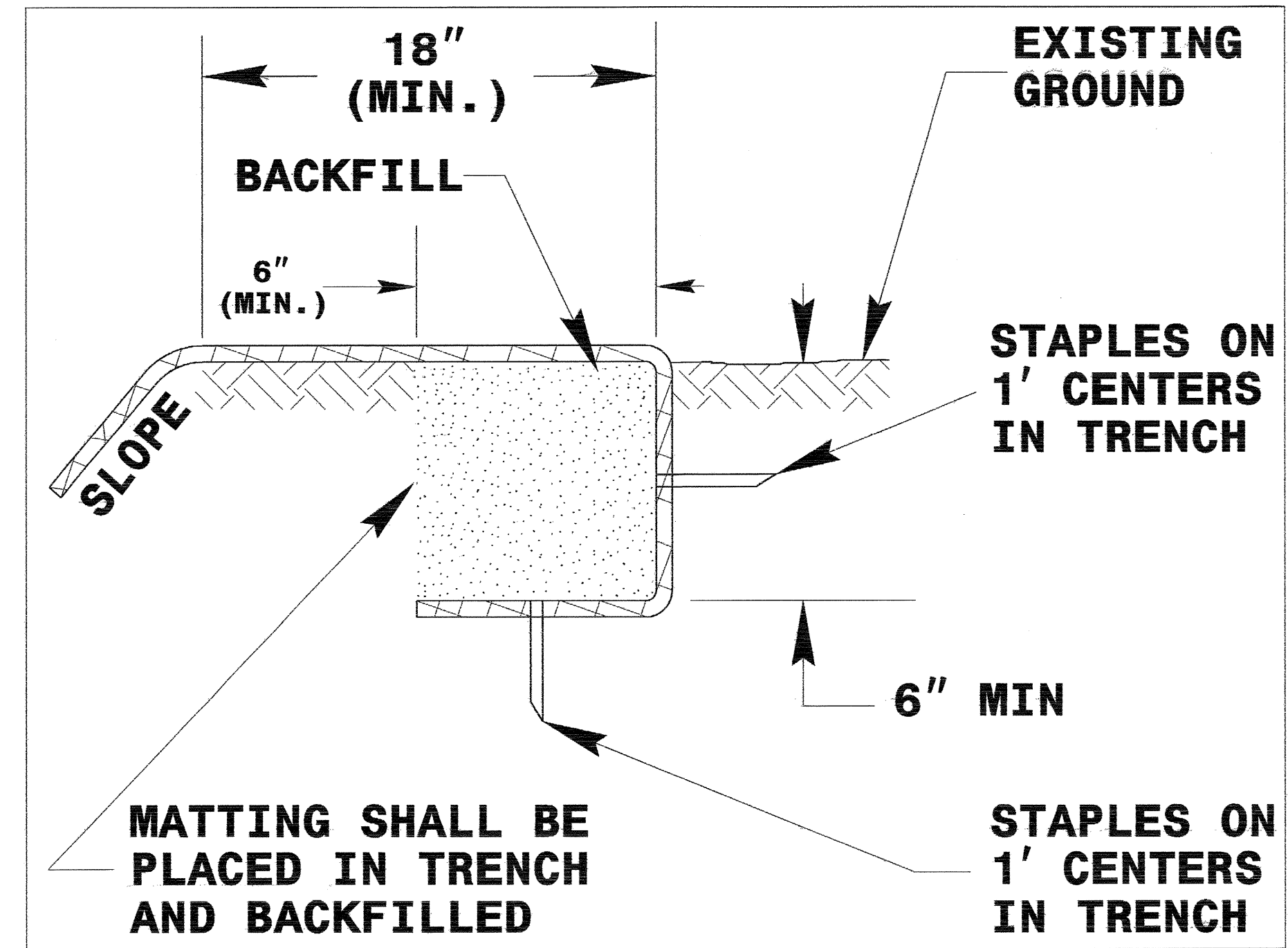
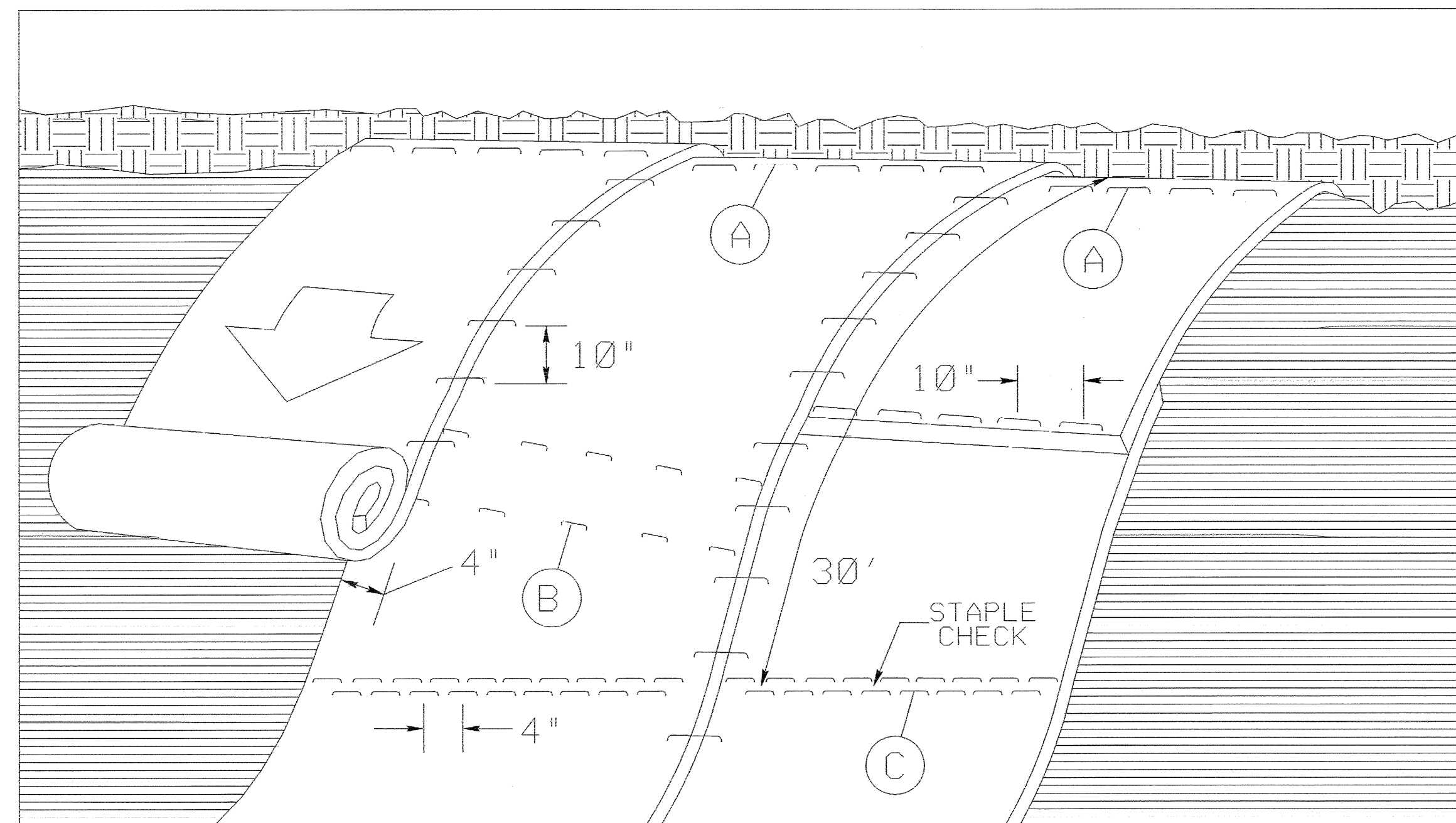

DIAGRAM (A)



MATTING ON SLOPES

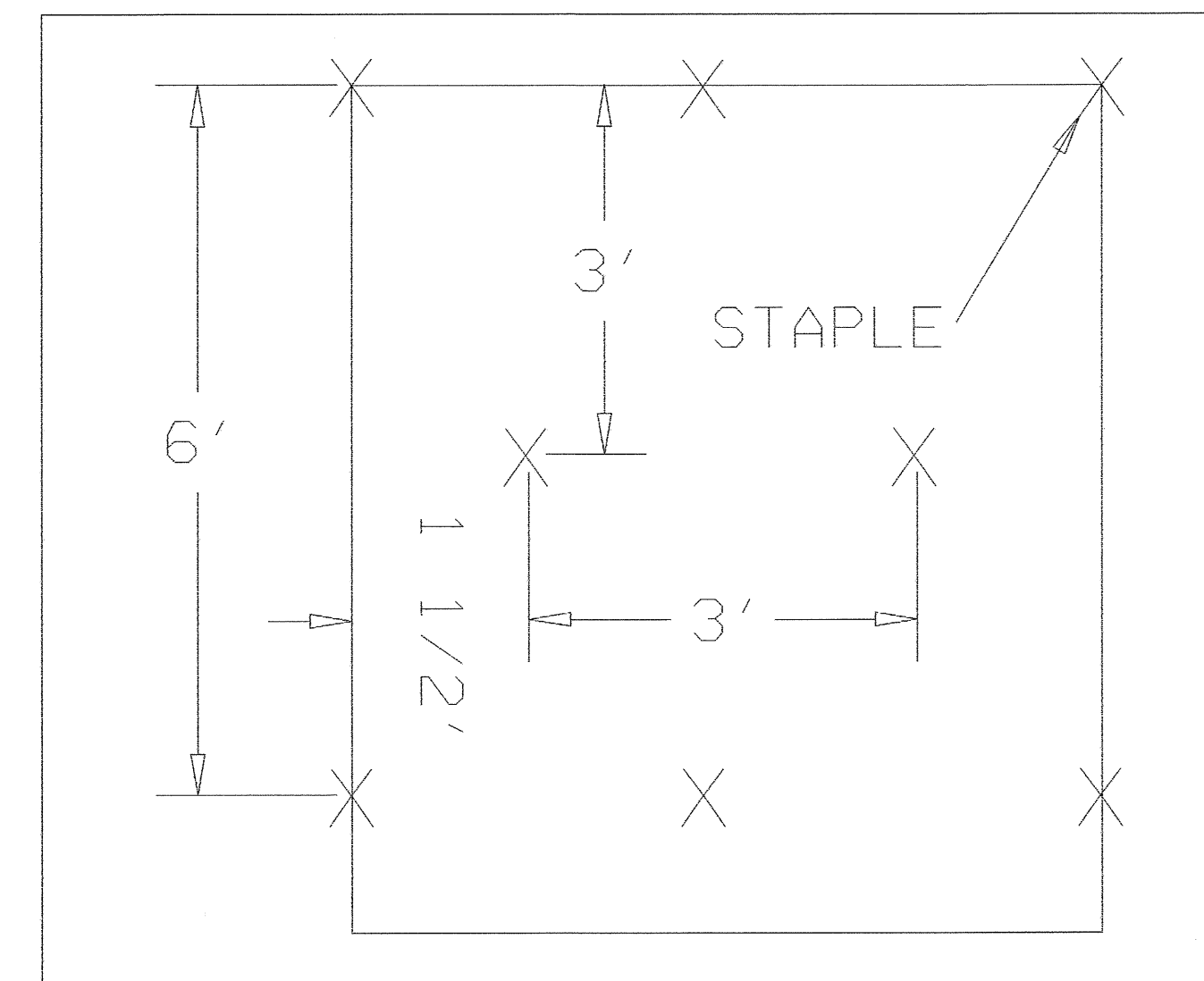

DIAGRAM (B)

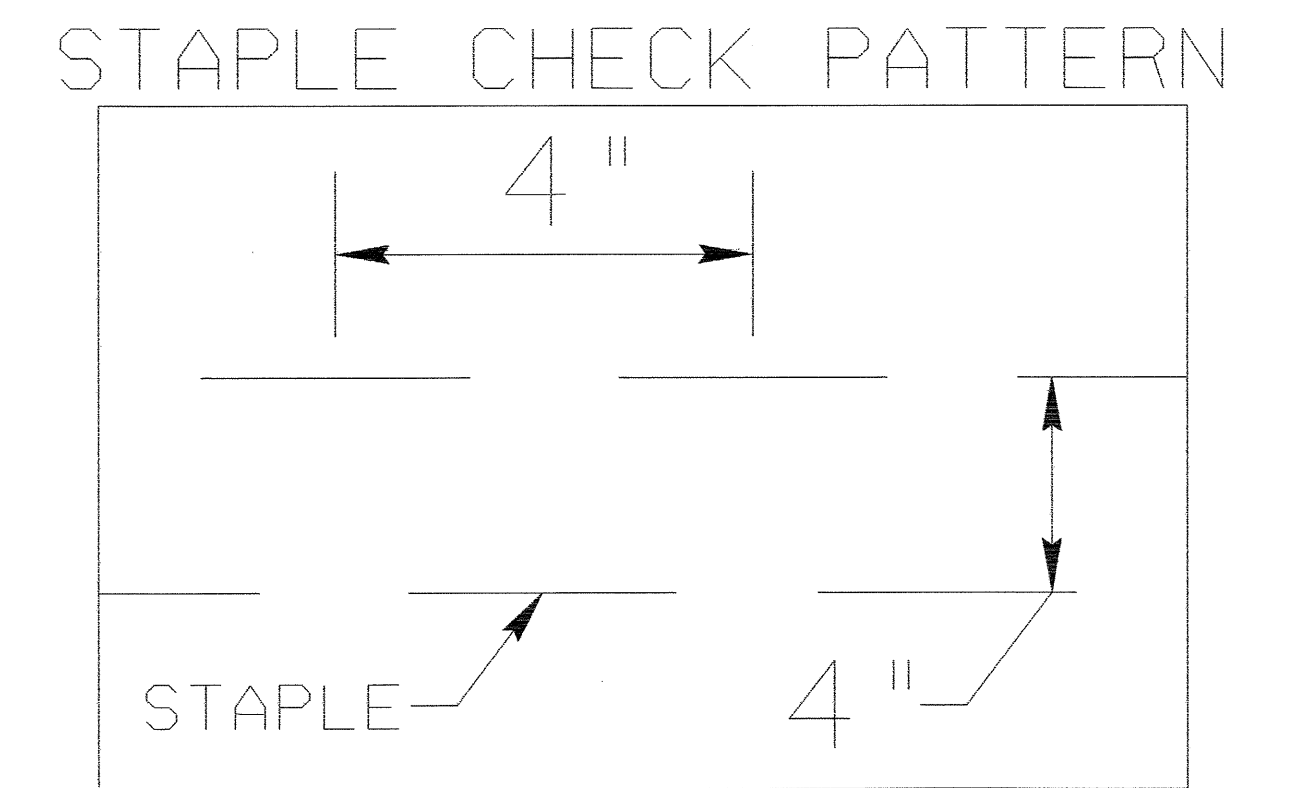

DIAGRAM (C)

NOTES:

THIS DETAIL APPLIES TO STRAW, EXCELSIOR, AND PERMANENT SOIL REINFORCEMENT MAT (PSRM) INSTALLATION.

STAPLES SHALL BE NO. 11 GAUGE STEEL WIRE FORMED INTO A "U" SHAPE WITH A MINIMUM THROAT WIDTH OF 1 INCH AND NOT LESS THAN 6 INCHES IN LENGTH.

NOT TO SCALE

8/17/99

CLEARING AND GRUBBING
EROSION CONTROL FOR
CONSTRUCTION SHEET 4

NOTE:
PLACE TEMPORARY ROCK SEDIMENT DAMS TYPE - B
AND TEMPORARY ROCK SILT CHECKS TYPE - A AT
DRAINAGE OUTLETS.

NAD 8395

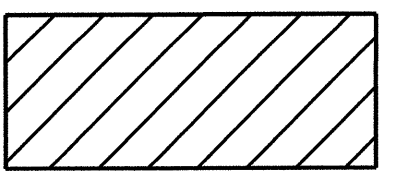
 ENVIRONMENTALLY SENSITIVE AREA
SEE PROJECT SPECIAL PROVISIONS

PROJECT REFERENCE NO. B-4034		SHEET NO. EC-4/CONST.4	
RW SHEET NO.			
ROADWAY DESIGN ENGINEER		HYDRAULICS ENGINEER	

NOTE:
UTILIZE TEMPORARY ROCK SILT CHECK TYPE - A
AND SKIMMER BASIN AS STILLING
WHERE APPLICABLE.

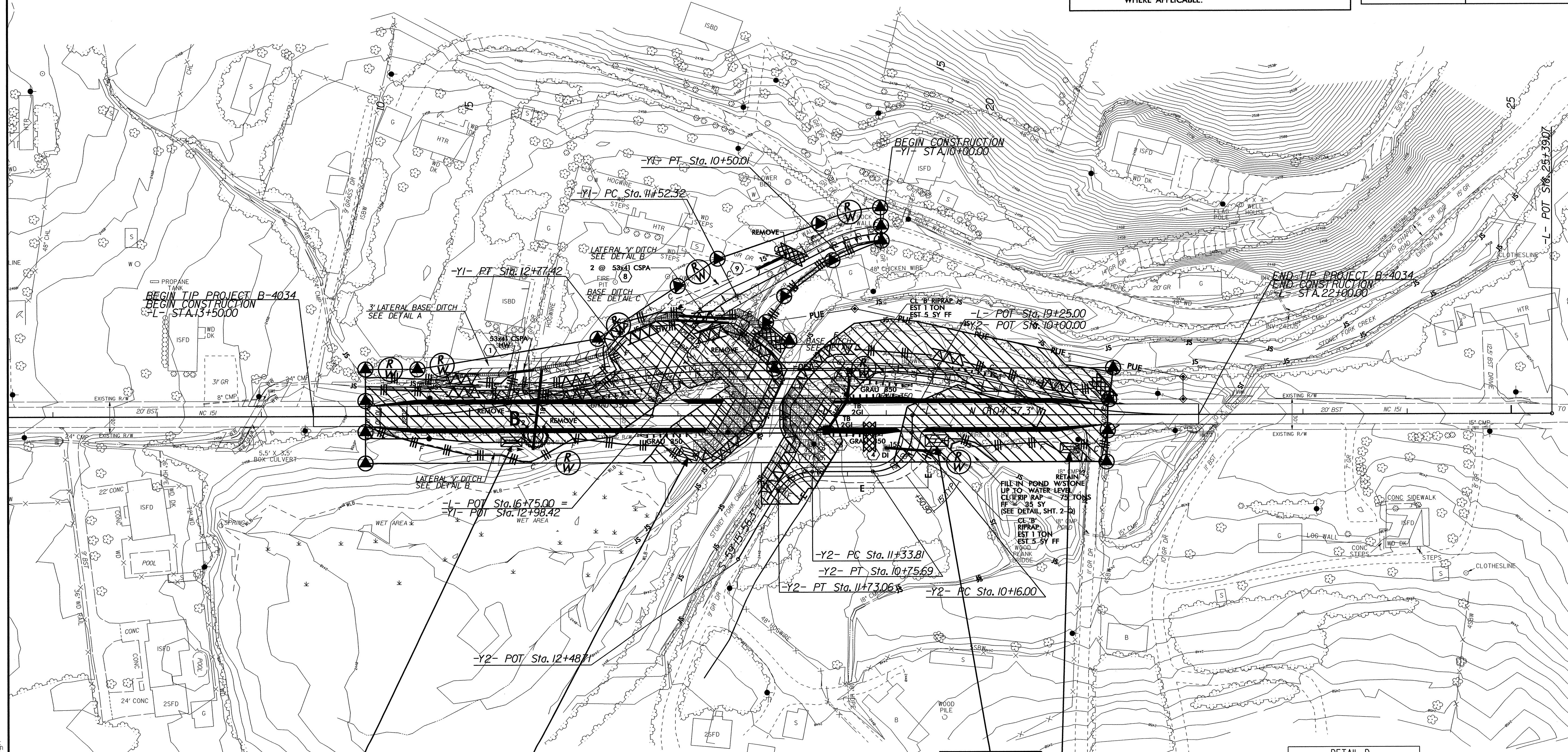

20 x 9 x 3
1.5 inch Skimmer
with 0.125 inch
Orifice Diameter
4 ft. weir
ID 4.1C

18 x 9 x 3
1.5 inch Skimmer
with 0.125 inch
Orifice Diameter
4 ft. weir
ID 4.2B

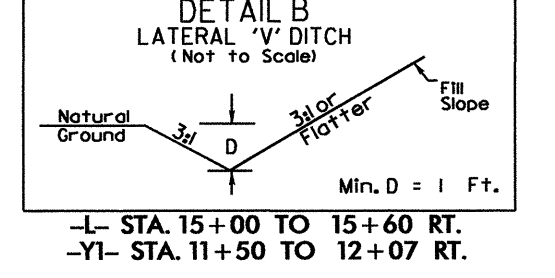
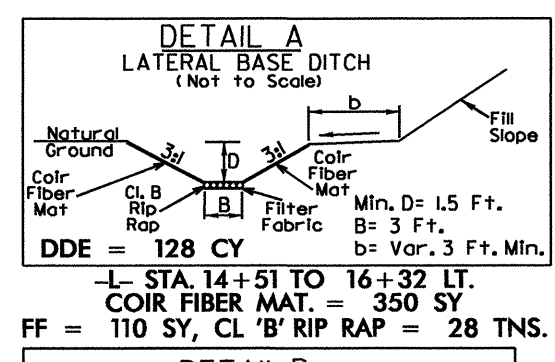

N 89°55'02.7"E
S 0°04'57.3"E
S 75°04'58.1"E
S 27°18'01.5"E

22 x 11 x 3
1.5 inch Skimmer
with 0.25 inch
Orifice Diameter
4 ft. weir
ID 4.5C

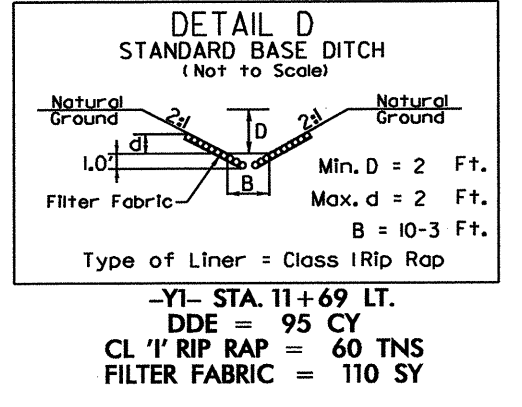
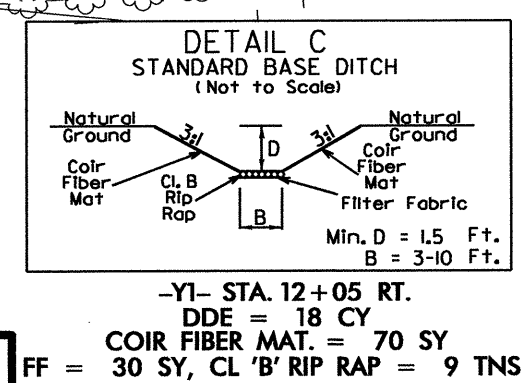

18 x 9 x 3
1.5 inch Skimmer
with 0.125 inch
Orifice Diameter
4 ft. weir
ID 4.6B

NOTE: ALL DRIVES ARE 16' UNLESS
OTHERWISE NOTED

SEE SHEET S-1 THRU S-? FOR
STRUCTURE PLANS

FOR -L- PROFILE, SEE SHEET 5
FOR -Y1- PROFILE, SEE SHEET 5
FOR -Y2- PROFILE, SEE SHEET 5
FOR -DET- PLAN, SEE SHEET 2-B

09-NOV-2010 14:11
R:\Environmental\B-4034_EC-psht.dgn
11/11/2010 10:26:26

8/17/99

PROJECT REFERENCE NO. B-4034		SHEET NO. EC-5/CONST.4	
RW SHEET NO.			
ROADWAY DESIGN ENGINEER		HYDRAULICS ENGINEER	

28 x 10 x 3
1.5 inch Skimmer
with 0.25 inch
Orifice Diameter
4 ft. weir
ID 4.4F

NOTE: UTILIZE TEMPORARY ROCK SILT CHECK TYPE - A AND SKIMMER BASIN AS STILLING WHERE APPLICABLE.

NAD 83/95

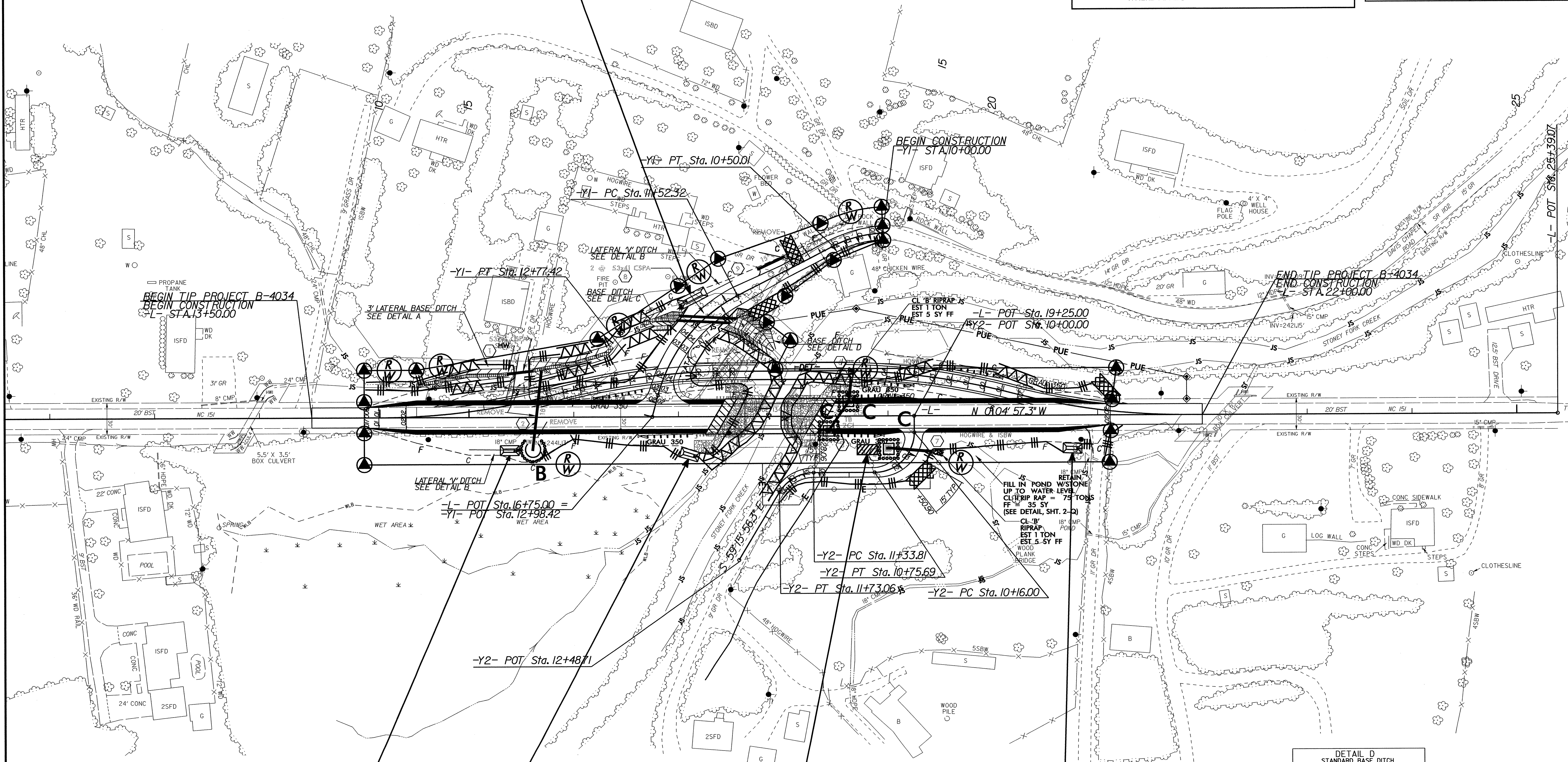

18 x 9 x 3
1.5 inch Skimmer
with 0.125 inch
Orifice Diameter
4 ft. weir
ID 4.3F

18 x 9 x 3
1.5 inch Skimmer
with 0.125 inch
Orifice Diameter
4 ft. weir
ID 4.2B

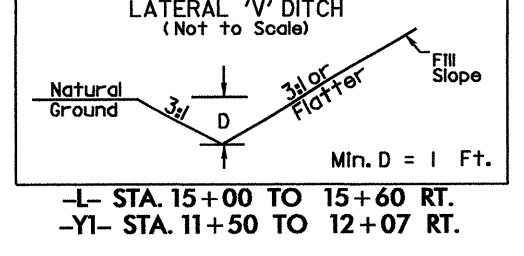
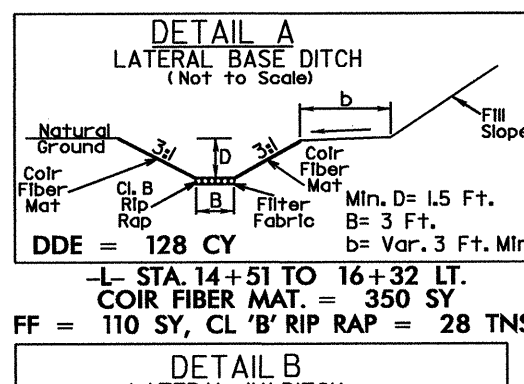

19 x 9 x 3
ID 4.7F

N 89° 55' 02.7" E
S 0° 04' 57.3" E
S 75° 04' 58.1" E
S 27° 18' 01.5" E

18 x 9 x 3
1.5 inch Skimmer
with 0.125 inch
Orifice Diameter
4 ft. weir
ID 4.6B

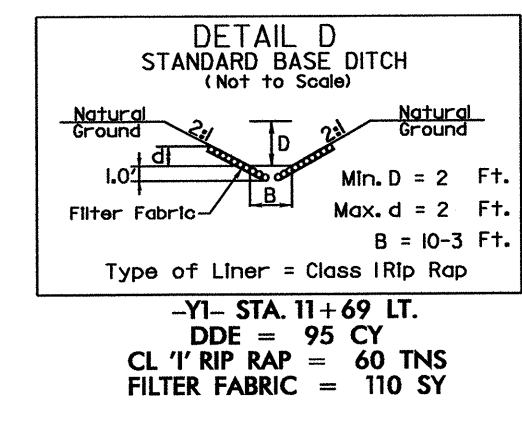
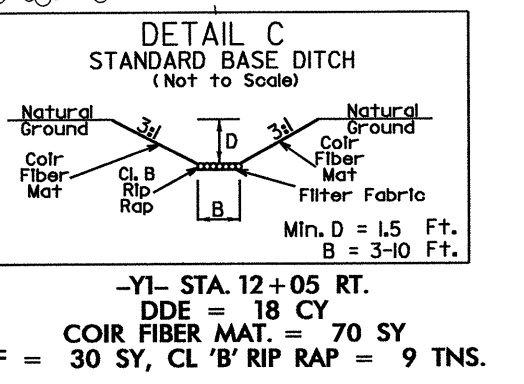

NOTE: ALL DRIVES ARE 16' UNLESS OTHERWISE NOTED
SEE SHEET S-1 THRU S-7 FOR STRUCTURE PLANS

FOR -L- PROFILE, SEE SHEET 5
FOR -Y1- PROFILE, SEE SHEET 5
FOR -Y2- PROFILE, SEE SHEET 5
FOR -DET- PLAN, SEE SHEET 2-B

08 NOV 2010 15:33 \\design\lb-4034_EC_psh.dgn
R:\psh\backburn

8/17/99

PROJECT REFERENCE NO.		SHEET NO.	
B-4034		EC-6/CONST.2B	
RW SHEET NO.			
ROADWAY DESIGN ENGINEER		HYDRAULICS ENGINEER	

NAD 83/95

DETOUR

28 x 10 x 3
1.5 inch Skimmer
with 0.25 inch
Orifice Diameter
4 ft. weir
ID 4.4F

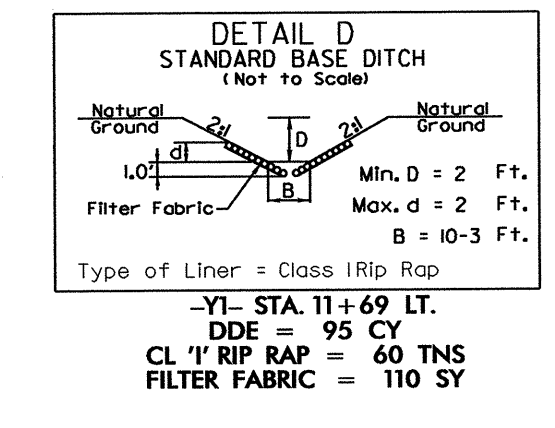
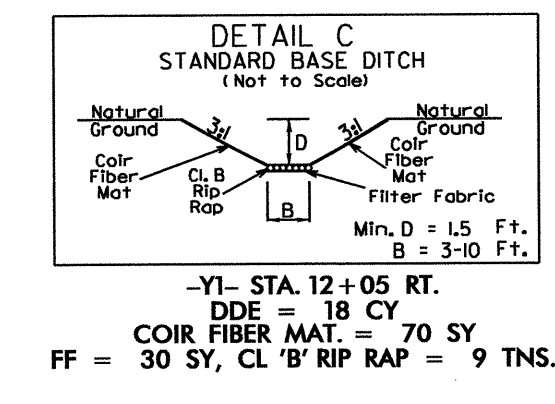
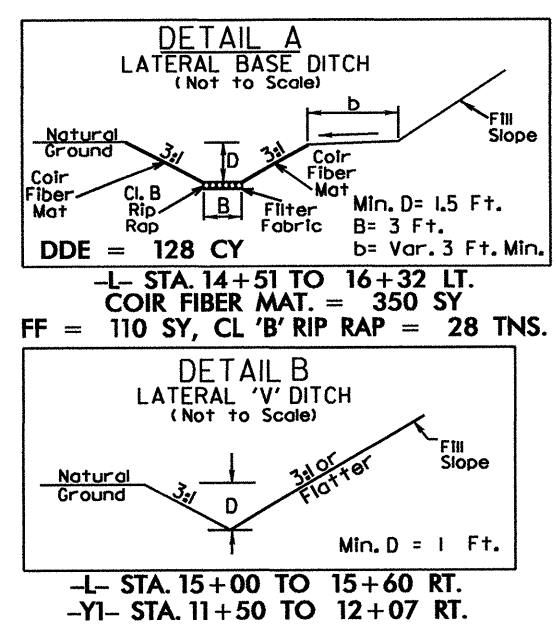
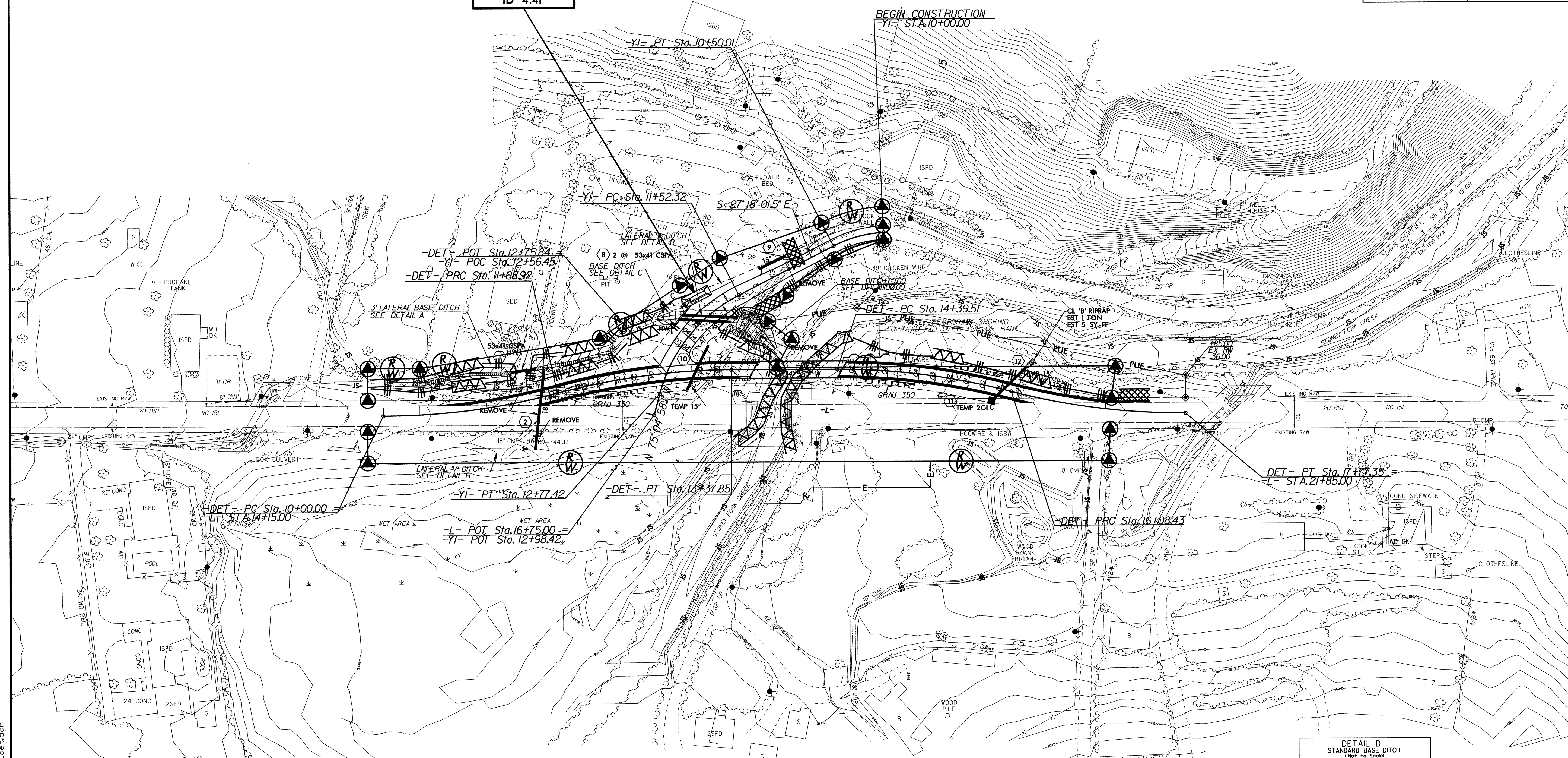

09-NOV-2010 14:47
R:\Environmental\B-4034_EC_psh_det.dgn
Blackburn AT BEN242226

0.16 ACRE STREAMBANK REFORESTATION

PROJECT REFERENCE NO.	SHEET NO.
B-4034	EC-7/CONST.4
RW SHEET NO.	
ROADWAY DESIGN ENGINEER	HYDRAULICS ENGINEER

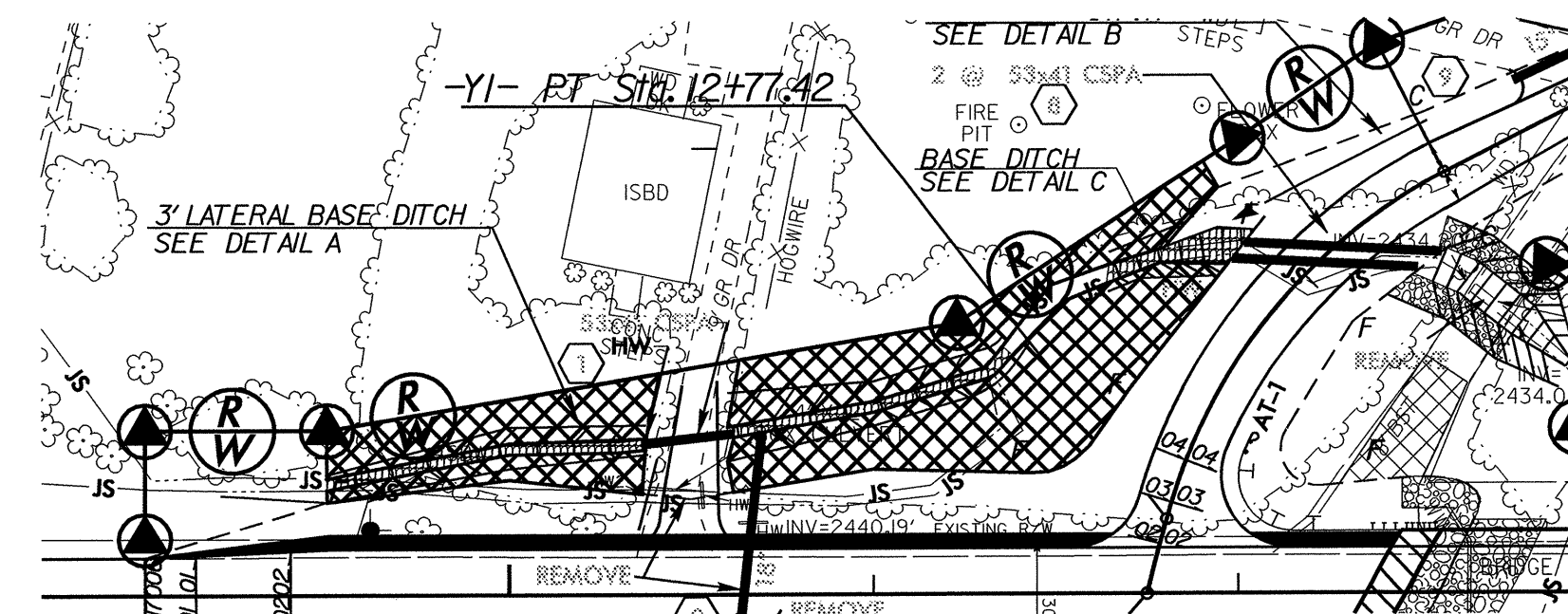

SEE RF-2, RF-3 AND PROJECT SPECIAL PROVISIONS