

# PROPOSED HIGHWAY LANDSCAPE DEVELOPMENT PROJECT

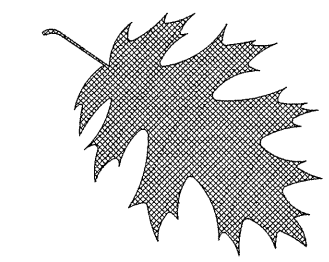

T.I.P. #	STATE PROJECT W.B.S. #	SHEET #	SHEET # TOTAL
B-4820	38590.3.1	L 1	3
FED. PROJ. #	DESCRIPTION	DIVISION	
	Planting and Bench Installation	11	

## Summary of Quantities

DESC	SEC	QUANTITY	UNIT	KEY	Botanical Name	Common Name	Furnish	Size	A.S.N.S
L	1670	11	EA	AK	<i>Abelia x grandiflora</i> 'Kaleidoscope'	Kaleidoscope Abelia	#3 cont	12-15"	4.2.2
L	1670	57	EA	HB	<i>Hemerocallis</i> 'Buttered Popcorn'	Buttered Popcorn Daylily	#1 cont		12.1.3
L	1670	7	EA	LF	<i>Lagerstroemia x faurieri</i> 'Fantasy'	Fantasy Crape Myrtle	B&B	8-10'	1.3.1
L	1670	225	EA	LM	<i>Liriope muscari</i> 'Variegata'	Variegated Liriope	#1 cont		12.1.3
L	1670	7	EA	RS	<i>Raphiolepis umbellata</i> 'Snow White'	Snow White Hawthorne	#3 cont	18-24"	4.2.2
L	1670	7	EA	BW	<i>Buddlea davidii</i> 'White Ball'	White Ball Butterfly Bush	#3 cont	12-15"	4.2.2
L	1670	6	EA	QS	<i>Quercus schumardii</i>	Schumard Oak	B&B	12-14'; 2 1/2"-3" cal.	1.2.1
					<b>Item</b>	<b>Description</b>			
L	1670	15	CY		Mulch for Planting				
L	1670	3	M/G		Water for Planting				
L	SP	1	LS		Landscape Grading				
L	SP	2	EA		6' Park Bench Installation	As provided by Town of Elkin			
L	SP	22	CY		Topsoil for Plant Beds				

### CONVENTIONAL SYMBOLS

County Line.....	-----
City or Town Line.....	-----
Exist. Right of Way Line Marker.....	-----▲-----
Prop. Right of Way Line Marker (By Others).....	-----▲-----
Prop Right of Way Line Marker (By Contract).....	-----▲-----
Exist. Control of Access Line.....	-----○-----
Prop. Control of Access Line.....	-----○-----
Property Line.....	-----
Easement Line.....	-----
Slope Stake Line.....	-----
Exist. Fence.....	-----
Prop. Woven Wire Fence.....	-----
Prop. Chain Link Fence.....	-----
Exist. Road.....	=====
Prop. Road.....	=====
Guardrail.....	-----
Survey Line.....	-----
Denotes Line Equality.....	-----
Bridge.....	-----
Culvert.....	-----
Railroad.....	-----
Woods.....	-----
Exist. Telephone Pole.....	-----
Prop. Telephone Pole.....	-----
Tower Pole and Line.....	-----
Exist. Power Pole.....	-----
Prop. Power Pole.....	-----
Sanitary Sewer Line.....	-----
Water Line.....	-----
Gas Line.....	-----
Picnic Shelter.....	-----
Regeneration.....	-----
Reforestation.....	-----

38590.3.1

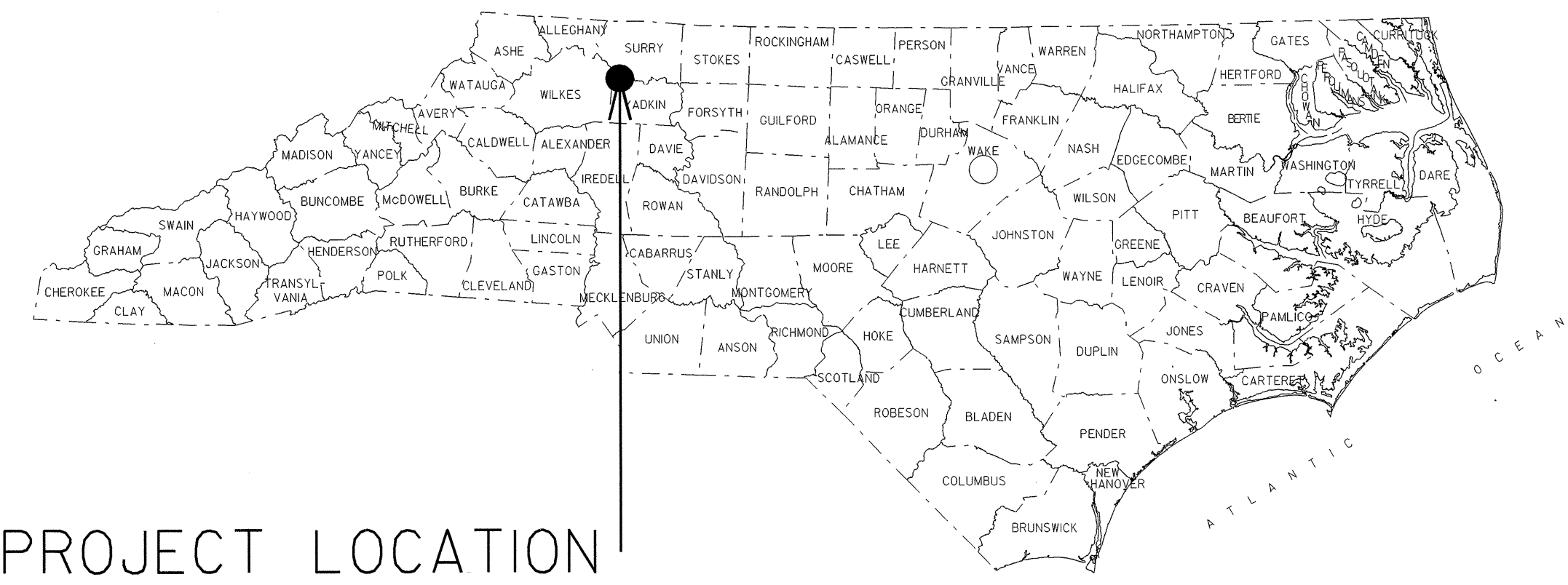

- ### INDEX OF L SHEETS:
- L 1 - TITLE, DESCRIPTION, LOCATION SUMMARY OF QUANTITIES
  - L 2 - LANDSCAPE PLAN
  - L 3 - PLANTING DETAILS

PREPARED BY: *dlw* DATE: 04/08/10

### REVISIONS

DATE	DESCRIPTION

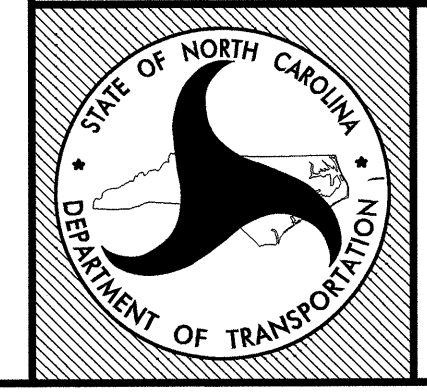

STATE OF  
**NORTH CAROLINA**  
DEPARTMENT OF TRANSPORTATION

LOCATION:	Town of Elkin
TYPE of WORK:	Landscape Planting and Benches
COUNTY:	<b>SURRY COUNTY</b>

**2006 STANDARD SPECIFICATIONS**

PREPARED IN THE OFFICE OF:  
NCDOT- ROADSIDE ENVIRONMENTAL UNIT  
LANDSCAPE DESIGN & DEVELOPMENT SECTION  
1557 MAIL SERVICE CENTER  
RALEIGH NC 27699 919-733-2920

13-APR-2010 08:38 C:\DOCUME\N\J\MORRIS\LOCALS\TEMP\B-4820\_REU\_STAIRWAYLANDSCAPEPLANS\_4-12-10.DGN \*\*\*USERNAME\*\*\*

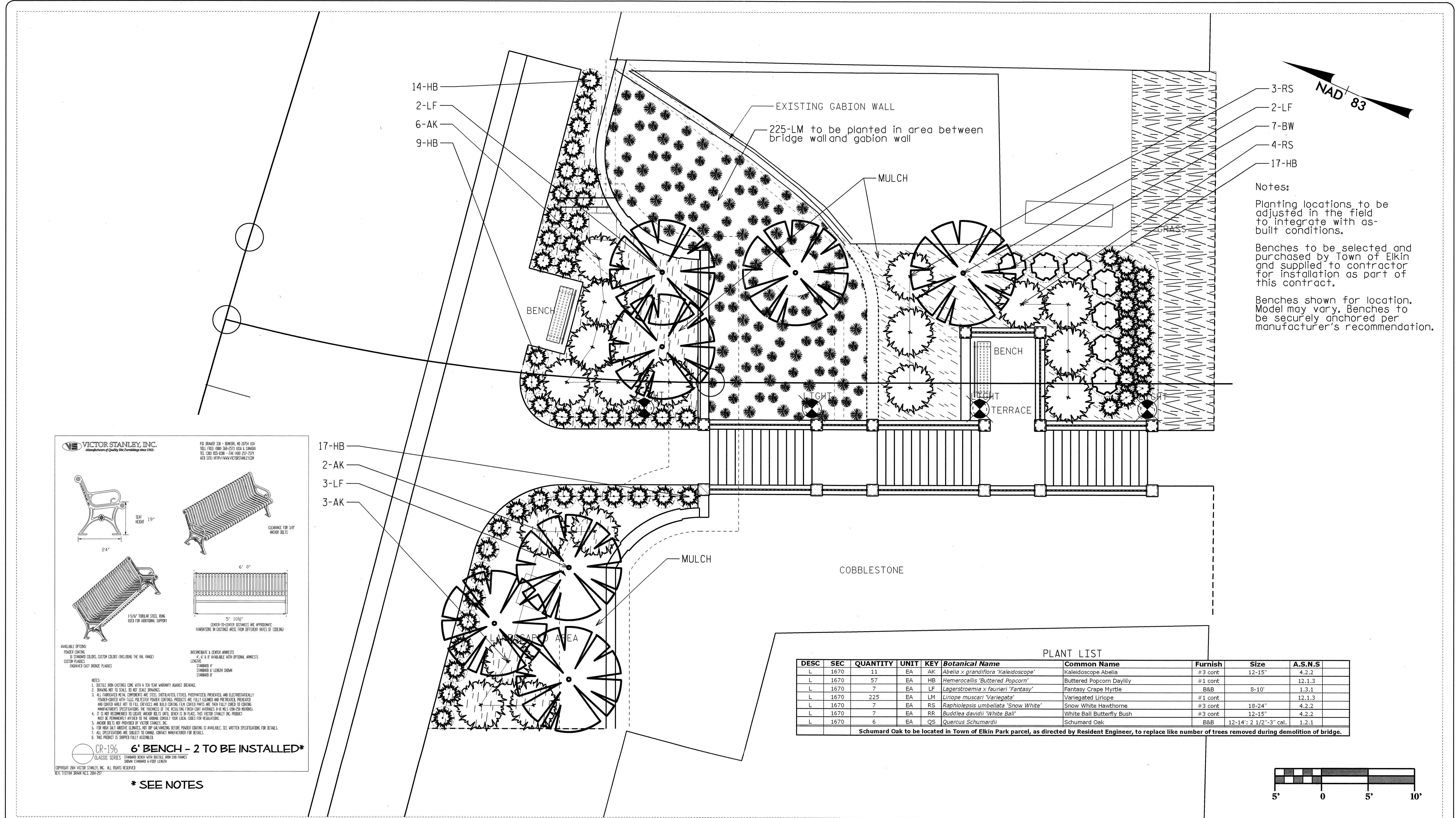

Notes:  
 Planting locations to be adjusted in the field to integrate with as-built conditions.  
 Benches to be selected and purchased by Town of Elkin and supplied to contractor for installation as part of this contract.  
 Benches shown for location. Model may vary. Benches to be securely anchored per manufacturer's recommendation.

**VICTOR STANLEY, INC.**  
 Manufacturers of Quality Site Furnishings Since 1920

PO BOX 208 - BARNOR, MO 63014 USA  
 TEL: 636-398-3000 FAX: 636-398-3000  
 TEL: 800-855-8388 - FAX: 800-237-2529  
 WEB SITE: <http://www.victorstany.com>

AVAILABLE OPTIONS:  
 POWDER COATING  
 10 STANDARD COLORS, CUSTOM COLORS (INCLUDING THE RAL RANGE)  
 CUSTOM FINISHES  
 ENGRAVED CAST BRONZE PLATES

INTERMEDIATE & CENTER ARMRESTS  
 LENGTH: 4', 6' & 8' AVAILABLE WITH OPTIONAL ARMRESTS  
 STANDARD #1  
 STANDARD #2  
 STANDARD #3

**CR-196 6" BENCH - 2 TO BE INSTALLED\***  
 CLASSIC SERIES - STANDARD BENCH WITH BUILT-IN IRON END FRAMES  
 30MM STANDARD 4-POST LEGS

COPYRIGHT 2004 VICTOR STANLEY, INC. ALL RIGHTS RESERVED  
 REV. 7/27/04 DRAWING NO. 204-257

**PLANT LIST**

DESC	SEC	QUANTITY	UNIT	KEY	Botanical Name	Common Name	Furnish	Size	A.S.N.S
L	1670	11	EA	AK	<i>Abelia x grandiflora 'Kaleidoscope'</i>	Kaleidoscope Abelia	#3 cont	12-15"	4.2.2
L	1670	57	EA	HB	<i>Hemerocallis 'Buttered Popcorn'</i>	Buttered Popcorn Daylily	#1 cont		12.1.3
L	1670	7	EA	LF	<i>Lagerstroemia x taurenii 'Fantasy'</i>	Fantasy Crape Myrtle	B&B	8-10'	1.3.1
L	1670	225	EA	LM	<i>Liriope muscari 'Variegata'</i>	Variegated Liriope	#1 cont		12.1.3
L	1670	7	EA	RS	<i>Raphiolepis umbellata 'Snow White'</i>	Snow White Hawthorne	#3 cont	18-24"	4.2.2
L	1670	7	EA	RR	<i>Buddleia davidii 'White Ball'</i>	White Ball Butterfly Bush	#3 cont	12-15"	4.2.2
L	1670	6	EA	QS	<i>Quercus shumardii</i>	Schumard Oak	B&B	12-14": 2 1/2"-3" cal.	1.2.1

Schumard Oak to be located in Town of Elkin Park parcel, as directed by Resident Engineer, to replace like number of trees removed during demolition of bridge.

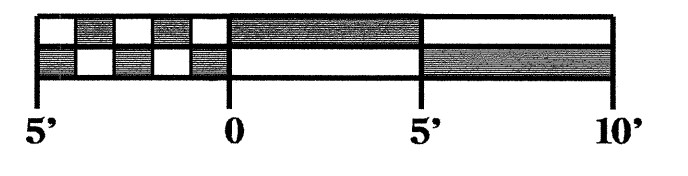

**NCDOT - ROADSIDE ENVIRONMENTAL UNIT**  
 LANDSCAPE DESIGN & DEVELOPMENT  
 1557 MAIL SERVICE CENTER RALEIGH NC 27699-1557  
 PH: 919-733-2920 FAX: 919-733-9810  
[HTTP://WWW.NCDOT.ORG/DOH/OPERATIONS/DP\\_CHIEF\\_ENG/ROADSIDE/](http://www.ncdot.org/DOH/OPERATIONS/DP_CHIEF_ENG/ROADSIDE/)

**SURRY CO**  
**ELKIN BRIDGE REMOVAL**  
 PROJECT #: 38590.31

REU ENGINEER

SHEET DESCRIPTION:

PREL. DESIGN DATE : APR/ 09
CHECKED BY & DATE :
FINAL DESIGN DATE : 04/09/2009

**ELKIN BRIDGE REMOVAL**  
**STAIRWAY LANDSCAPING**

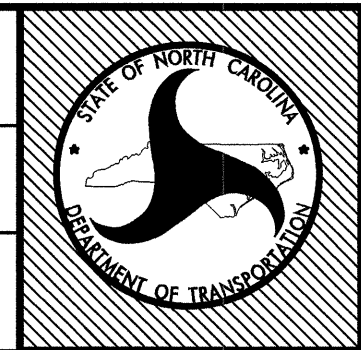

SHEET NO : **L2**  
 TOTAL SHEET NO : 3(L)



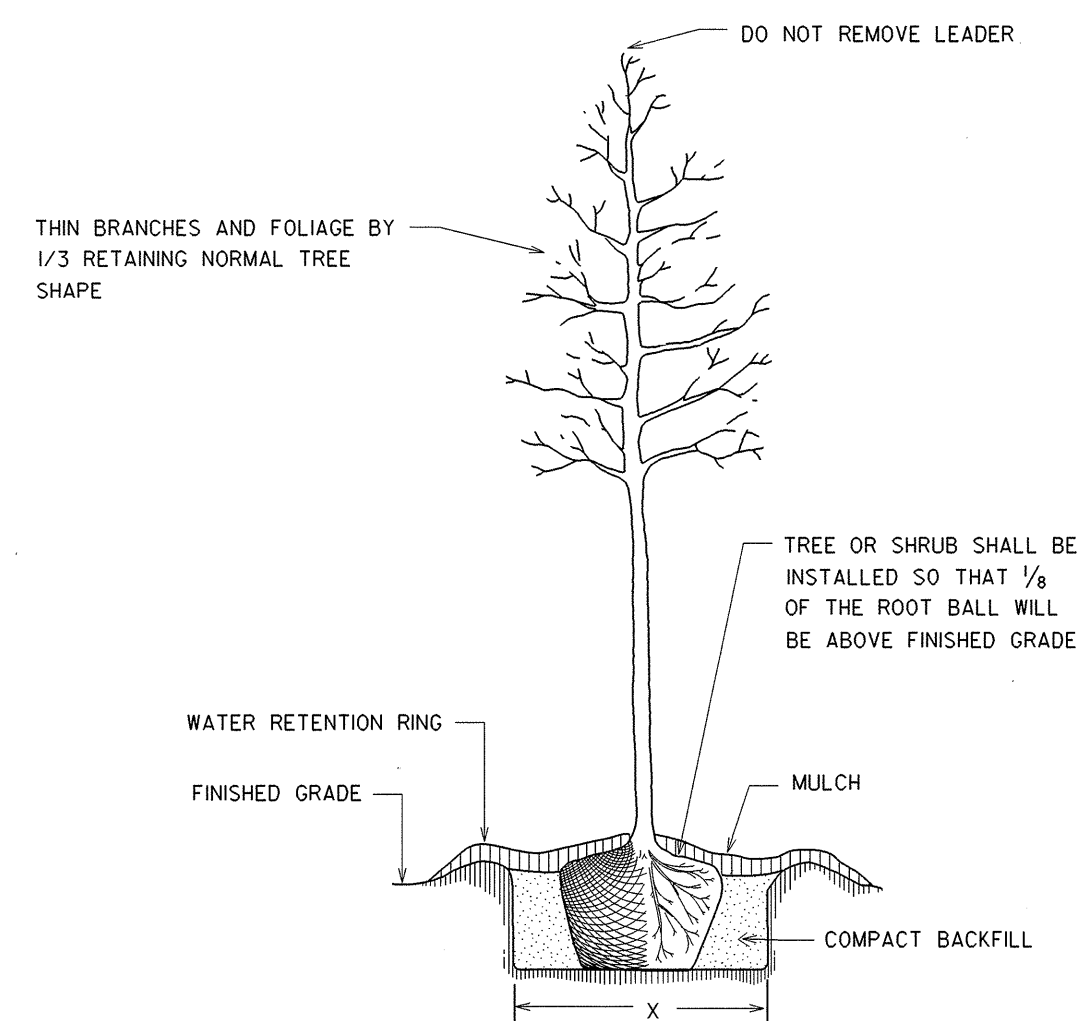

**TREE OR SHRUB PLANTING DETAIL  
(LEVEL GROUND)**

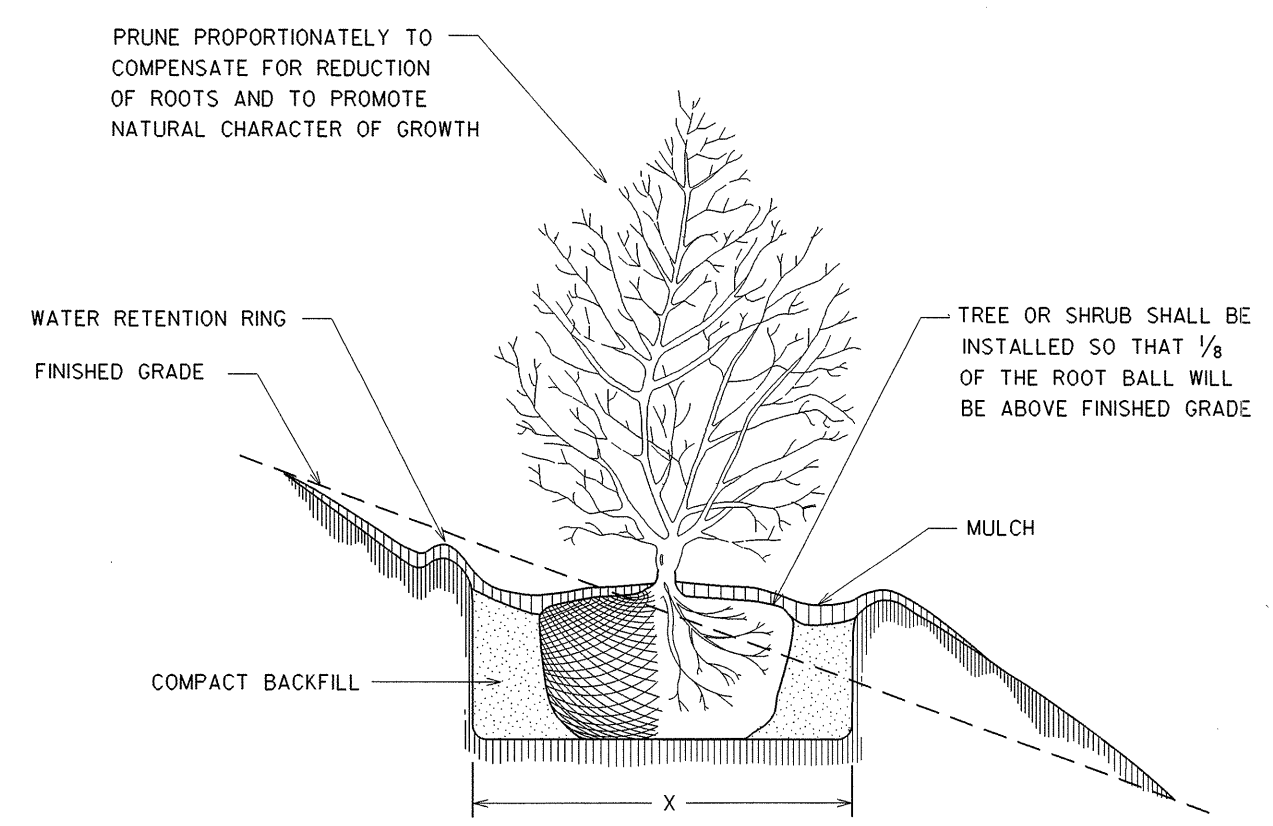

**TREE OR SHRUB PLANTING DETAIL  
(SLOPING GROUND)**

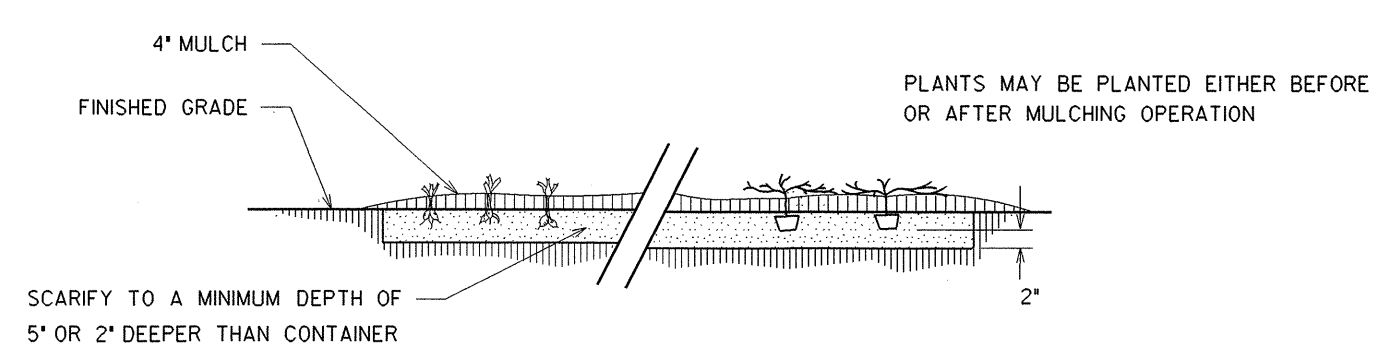

**GROUNDCOVER PLANTING DETAIL**

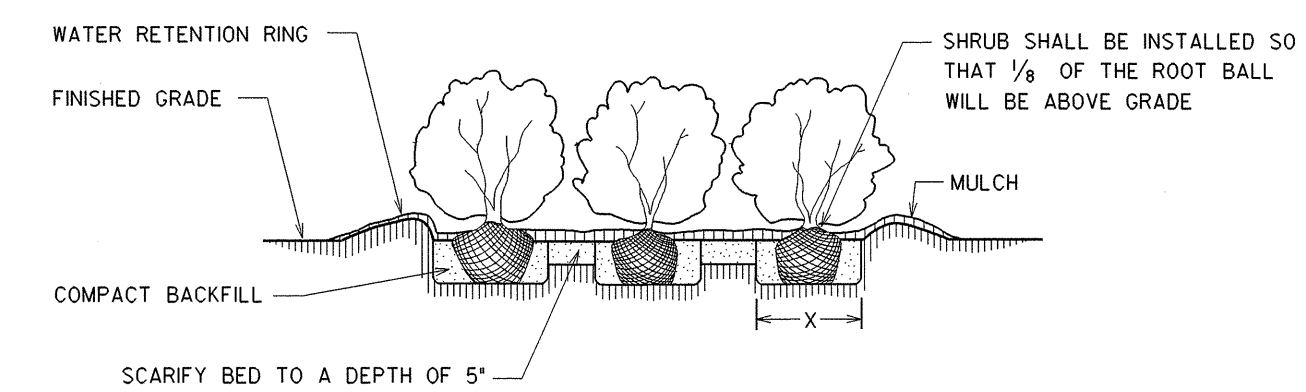

**SHRUB BED PLANTING DETAIL**

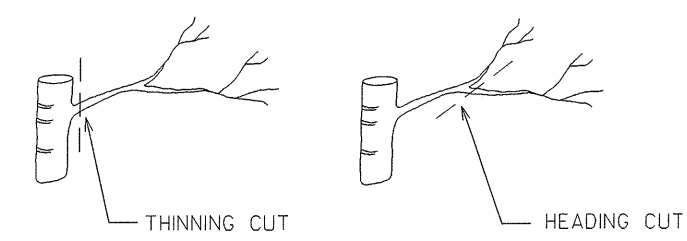

**PRUNING CUTS**

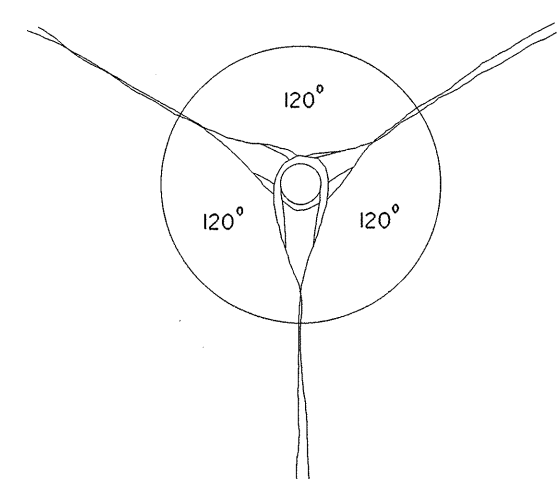

**GUY SPACING DETAIL**

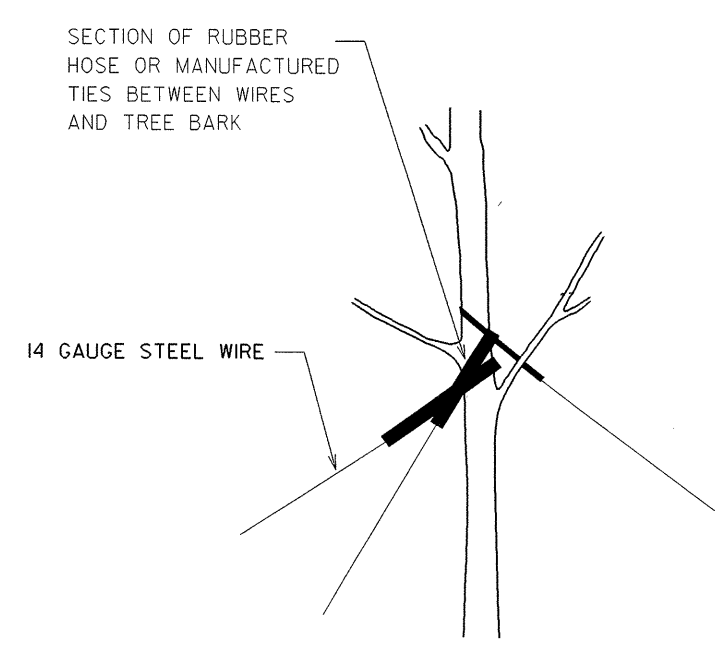

**GUY TYING DETAIL**

\* EXACT LENGTH WITHIN INDICATED RANGE TO BE DETERMINED BY ENGINEER IN THE FIELD

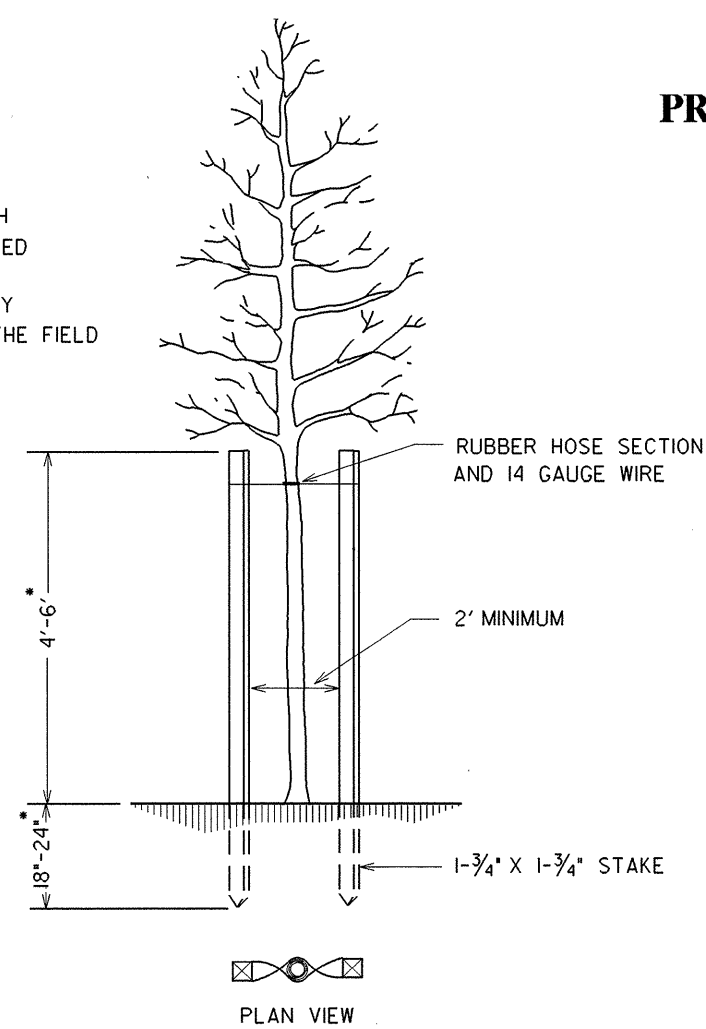

**STAKING DETAIL  
(FOR TREES 6' TO 10')**

\* Utilize staking detail only if requested by the Engineer.

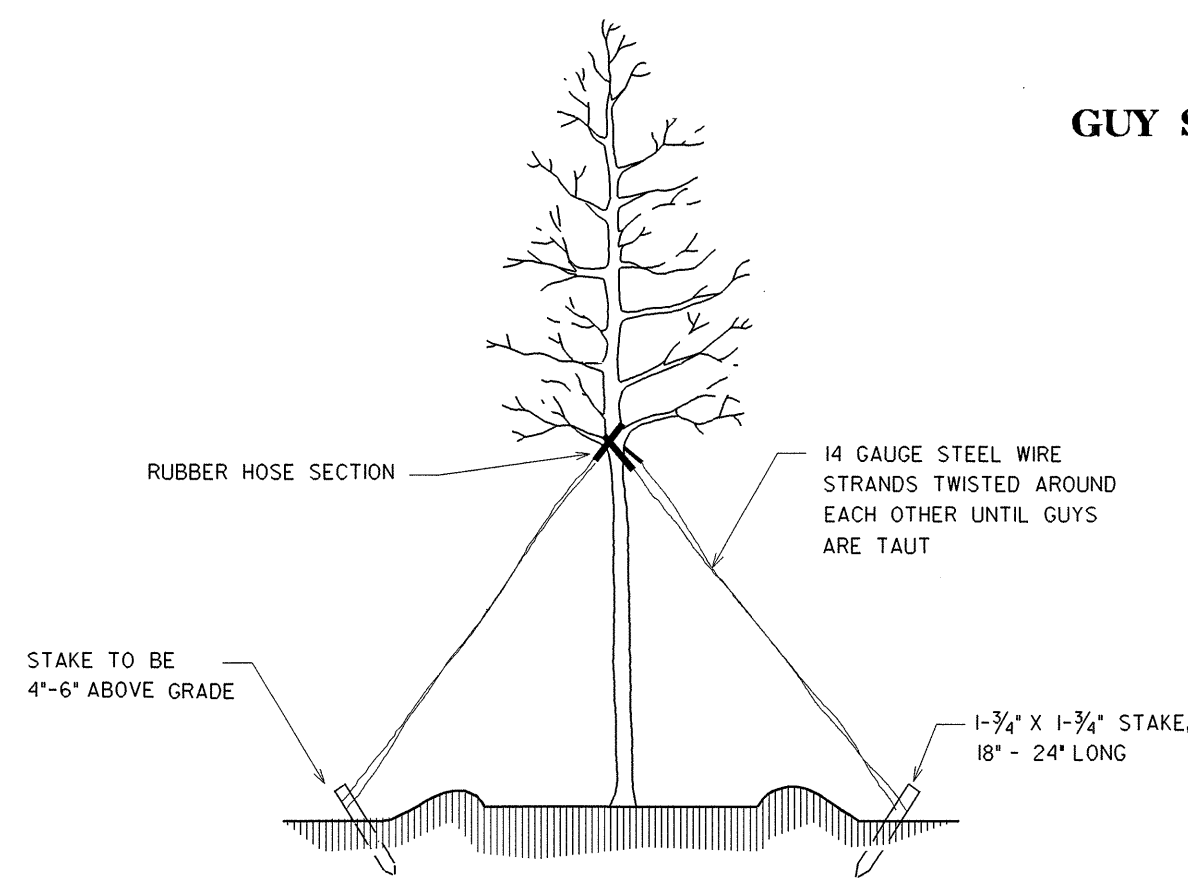

**TREE GUYING DETAIL  
(FOR TREES 10' OR LARGER)**

\* Utilize guying detail only if requested by the Engineer.

**NOTES:**

SCHEDULE FOR PLANT HOLE SIZE:  
CONTAINER OR ROOT BALL SIZE  
X = 2 TIMES THE DIAMETER OF THE CONTAINER OR THE ROOT BALL DIAMETER

FERTILIZER SHALL BE APPLIED AT TIME OF PLANTING.. FERTILIZER SHALL BE A SLOW RELEASE PELLET OR TABLET. FORMULATION SHALL BE APPROVED BY ENGINEER IN THE FIELD.

RATES SHALL BE PER MANUFACTURERS RECOMMENDATIONS AND APPROVED BY THE ENGINEER IN THE FIELD. THOROUGHLY MIX WITH TOPSOIL, BACKFILL OR SCARIFIED SOIL.

REMOVE BURLAP FROM TOP OF BALL BEFORE BACKFILLING AROUND BALL IS COMPLETE

SEE STANDARD SPECIFICATIONS FOR PLANT BED FUMIGATION

**PLANTING DETAILS**  
N.C.D.O.T. - ROADSIDE ENVIRONMENTAL UNIT

NO SCALE

13-APR-2010 08:38 C:\DOCUME~1\JAMORRI~1\LOCALS~1\TEMP~1\NLOCALS~1\TEMPL~1\B-4820\_REU\_STAIRWAY\LANDSCAPEPLANS\_4-12-10.DGN \*\*\*USERNAME\*\*\*

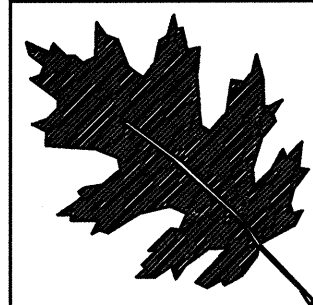

NCDOT - ROADSIDE ENVIRONMENTAL UNIT  
LANDSCAPE DESIGN & DEVELOPMENT  
1557 MAIL SERVICE CENTER RALEIGH NC 27699-1557  
PH: 919-733-2920 FAX: 919-733-9810  
HTTP://WWW.NCDOT.ORG/DOH/OPERATIONS/DP\_CHIEF\_ENG/ROADSIDE/

SURRY CO  
ELKIN BRIDGE REMOVAL  
PROJECT #: 38590.31

REU ENGINEER  
D. Wilson

SHEET DESCRIPTION:  
PREL DESIGN DATE : APR/09  
CHECKED BY & DATE :  
FINAL DESIGN DATE :

ELKIN BRIDGE REMOVAL  
STAIRWAY LANDSCAPING

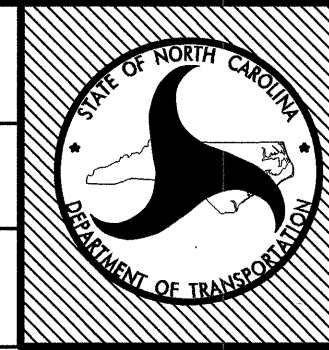

SHEET NO : L3  
TOTAL SHEET NO : 3(L)