

5/14/99

PLANTING PLAN FOR BASIN

PROJECT REFERENCE NO. B-4214	SHEET NO. L-1
RW SHEET NO.	
ROADWAY DESIGN ENGINEER	HYDRAULICS ENGINEER

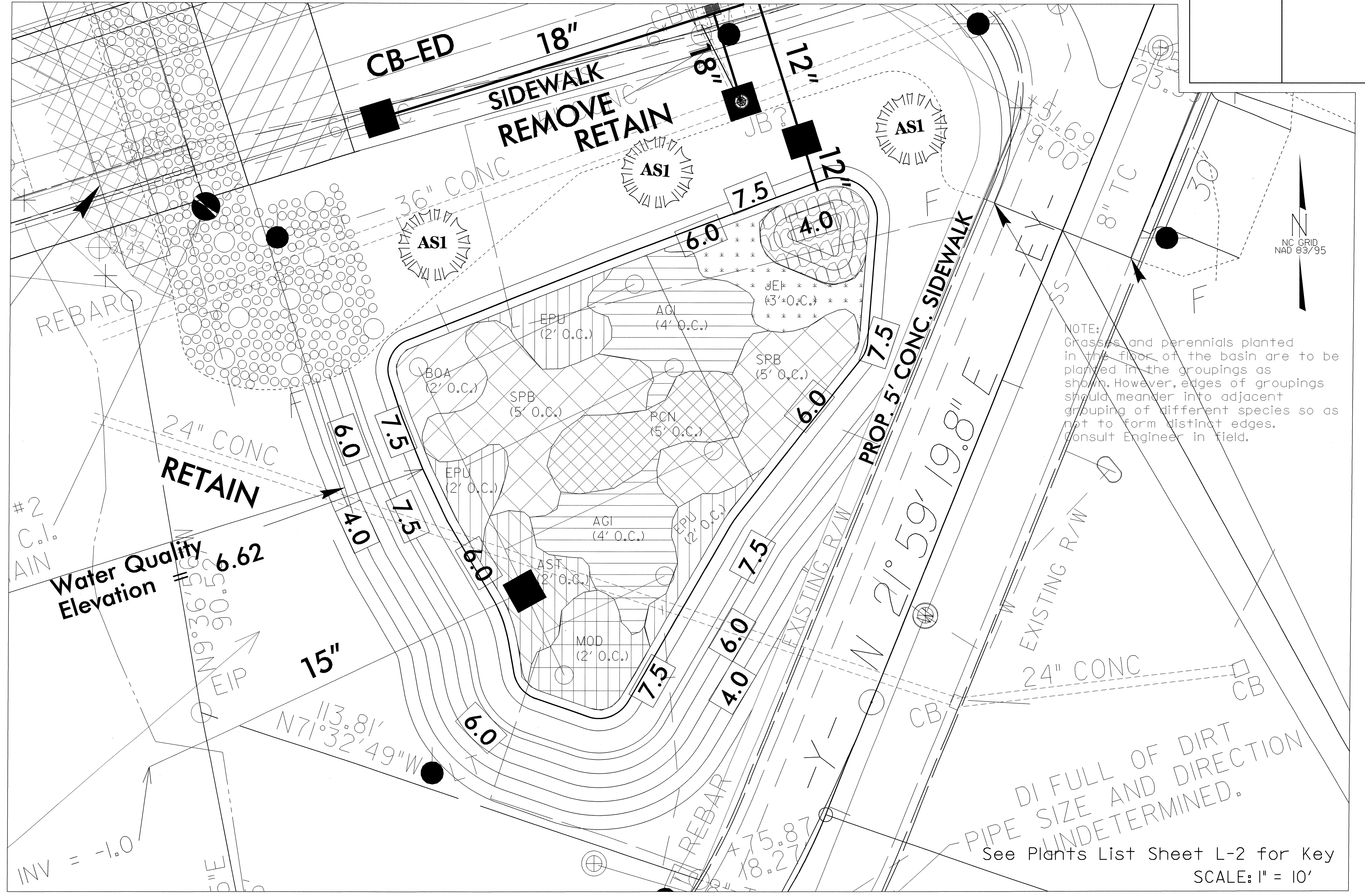

NOTE:
Grasses and perennials planted in this floor of the basin are to be planted in the groupings as shown. However, edges of groupings should meander into adjacent grouping of different species so as not to form distinct edges. Consult Engineer in field.

DI FULL OF DIRT
PIPE SIZE AND DIRECTION
UNDETERMINED.
See Plants List Sheet L-2 for Key
SCALE: 1" = 10'

15-APR-2009 14:52
b:\projects\15-APR-2009\15-APR-2009-1\15-APR-2009-1\15-APR-2009-1.dgn

PROJECT REFERENCE NO. B-4214	SHEET NO. L-2
RW SHEET NO.	
ROADWAY DESIGN ENGINEER	HYDRAULICS ENGINEER

Quantity	Unit	Key	Botanical Name	Common Name	Furnish	ASNS
3	EA	AS1	<i>Acer saccharum</i>	Sugar Maple	6-8', Min. 3/4" Cal., B&B or Cont.	1.2.1
86	EA	AG1	<i>Andropogon glomeratus</i>	Bushy Bluestem	2 1/4" Sq.Pot, Tray of 32	12.4
107	EA	AST	<i>Asclepias tuberosa</i>	Butterfly Weed	4" Pot or Qt. Cont. - Deep	12.3
70	EA	BOA	<i>Boltonia asteroides</i>	False Aster	4" Pot or Qt. Cont. - Deep	12.3
185	EA	EPU	<i>Echinacea purpurea</i>	Purple Coneflower	4" Pot or Qt. Cont. - Deep	12.3
51	EA	JE1	<i>Juncus effusus</i>	Soft Rush	2 1/4" Sq.Pot, Tray of 32	12.4
107	EA	MOD	<i>Monarda didyma</i>	Bee-balm	4" Pot or Qt. Cont. - Deep	12.3
24	EA	PCN	<i>Panicum virgatum 'Cloud Nine'</i>	Switchgrass	3 1/2" - 4" Pot, Tray of 18	12.4
66	EA	SPB	<i>Spartina bakeri</i>	Cord Grass	2 1/4" Sq.Pot, Tray of 32	12.4