

TIP PROJECT: B-3335

CONTRACT: C202428

T.I.P. NO.	SHEET NO.
B-3335	UO-1

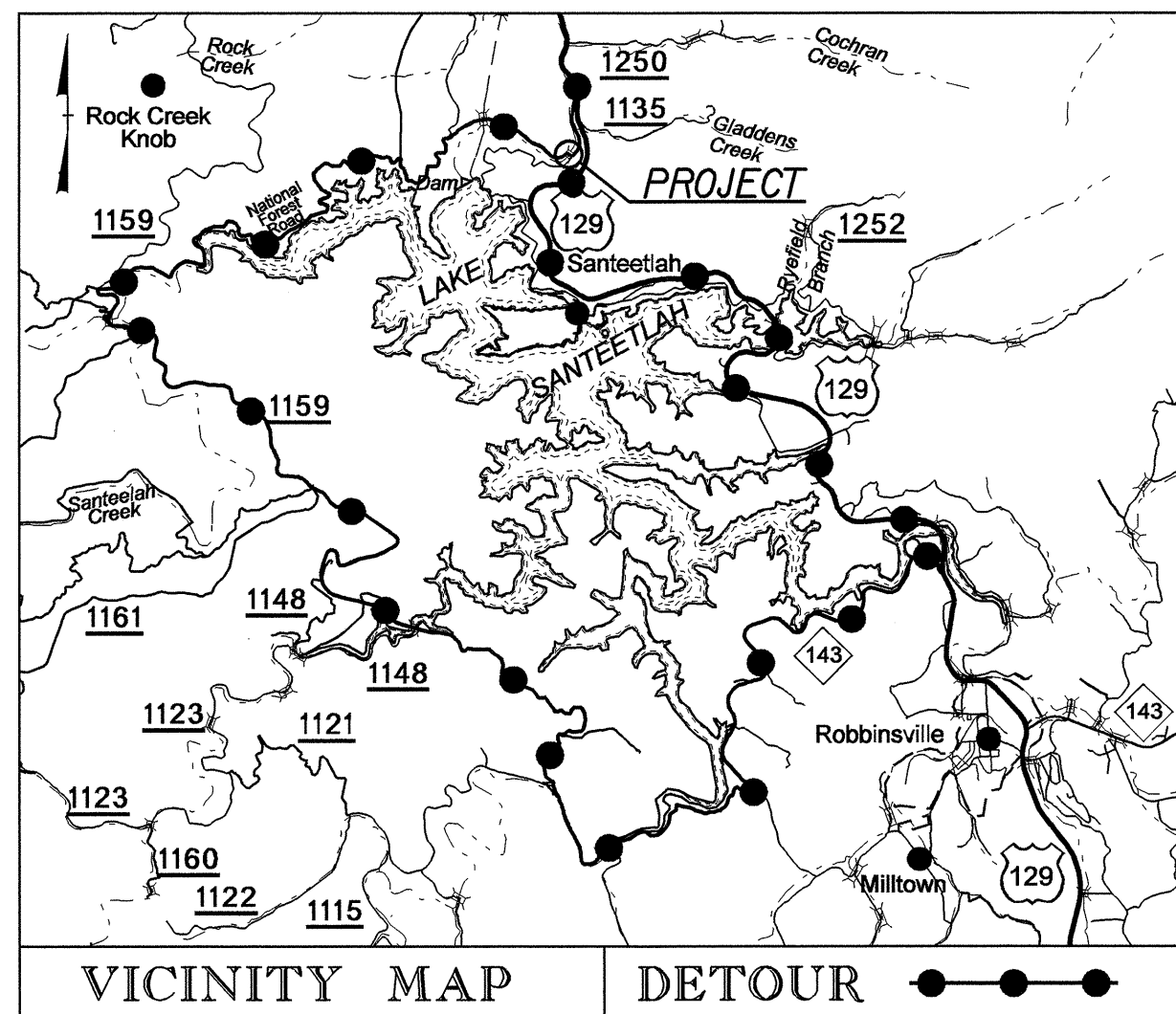

STATE OF NORTH CAROLINA
DIVISION OF HIGHWAYS

**UTILITIES BY OTHERS PLANS
GRAHAM COUNTY**

LOCATION: BRIDGE No. 70 OVER CHEOAH RIVER ON SR 1134
TYPE OF WORK: UTILITY RELOCATION

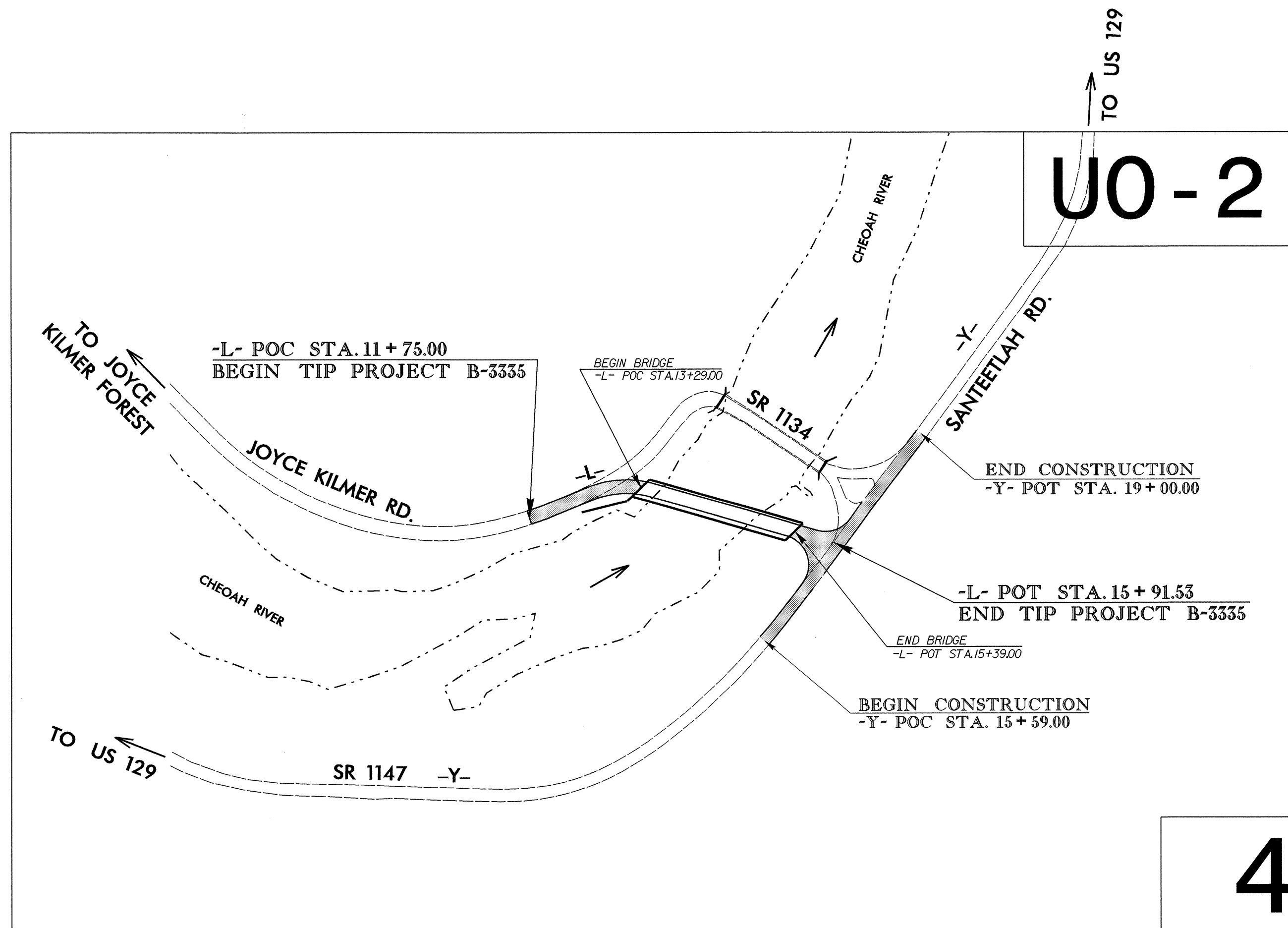
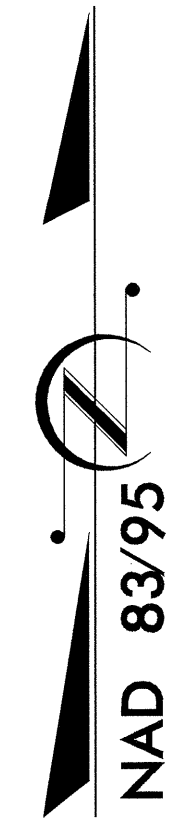

NOTES: (1) CLEARING ON THIS PROJECT SHALL BE PERFORMED TO THE LIMITS ESTABLISHED BY METHOD II
(2) THIS PROJECT IS NOT WITHIN ANY MUNICIPAL BOUNDARIES.

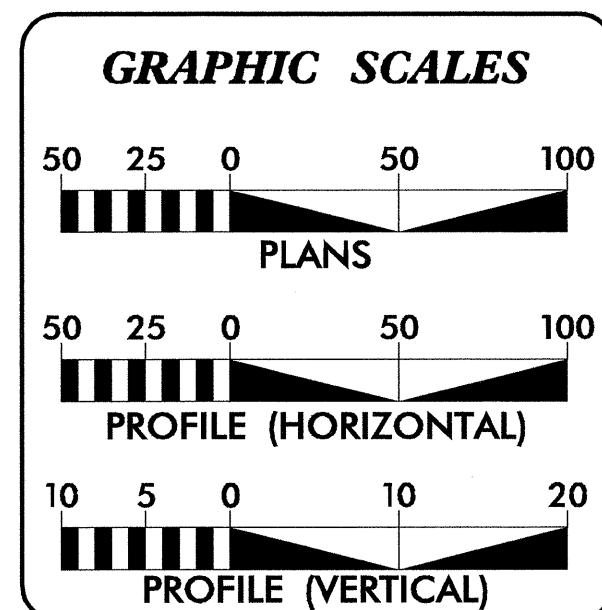

INDEX OF SHEETS	
SHEET NO.	DESCRIPTION
UO-1	TITLE SHEET
UO-2	UTILITY BY OTHERS PLAN SHEET

UTILITY OWNERS ON PROJECT
(1) DUKE ENERGY - POWER
(2) VERIZON - TELEPHONE

PREPARED IN THE OFFICE OF:
**DIVISION OF HIGHWAYS
UTILITIES ENGINEERING
SECTION**

1591 MAIL SERVICES CENTER
RALEIGH NC 27699-1591
PHONE (919) 250-4128
FAX (919) 250-4119

<i>Roger Worthington, P.E.</i>	UTILITIES SECTION ENGINEER
<i>Steve McKee, P.E.</i>	UTILITIES SQUAD LEADER PROJECT ENGINEER
<i>Donald Proper</i>	UTILITIES PROJECT DESIGNER

UTILITIES BY OTHERS

NOTE:
ALL PROPOSED UTILITY WORK
SHOWN ON THIS SHEET WILL
BE DONE BY OTHERS

NAD 83/95

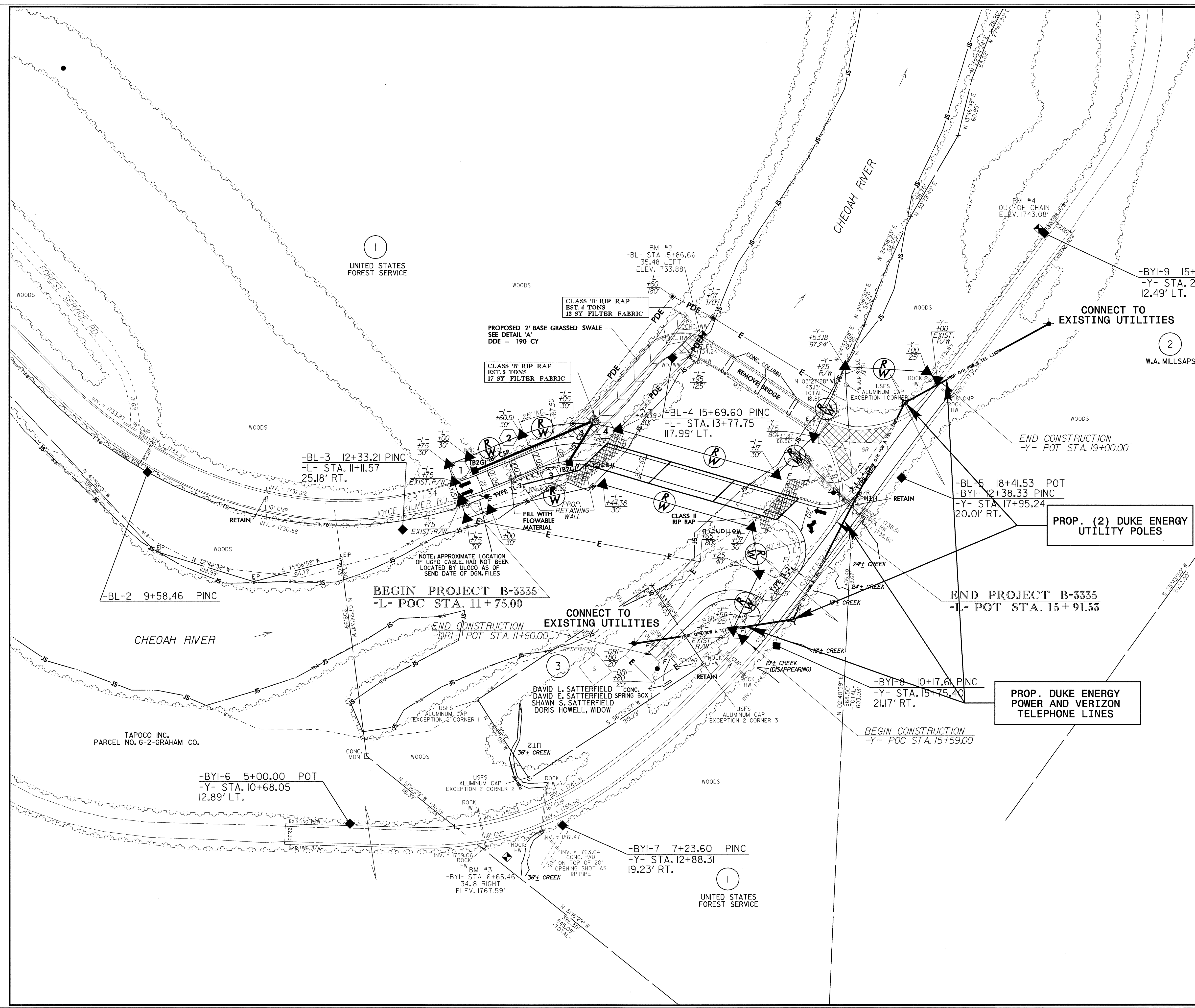

CONNECT TO EXISTING UTILITIES

PROP. (2) DUKE ENERGY UTILITY POLES

PROP. DUKE ENERGY POWER AND VERIZON TELEPHONE LINES

BEGIN PROJECT B-3335
-L- POC STA. 11+75.00

END PROJECT B-3335
-L- POT STA. 15+91.53

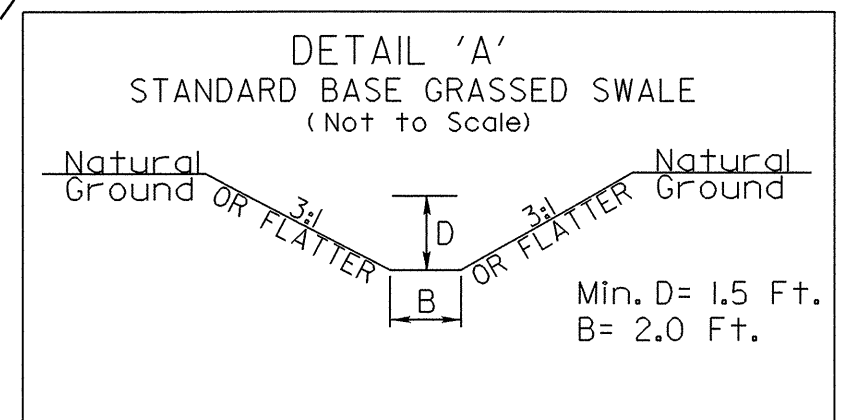

UNITED STATES FOREST SERVICE

UNITED STATES FOREST SERVICE

TAPOCO INC.
PARCEL NO. G-2-GRAHAM CO.

DAVID L. SATTERFIELD
DAVID E. SATTERFIELD SPRING BOX
SHAWN S. SATTERFIELD
DORIS HOWELL, WIDOW

NOTE: APPROXIMATE LOCATION OF ULOFO CABLE, HAD NOT BEEN LOCATED BY ULOCO AS OF SEND DATE OF DGN FILES

PROPOSED 2' BASE GRASSED SWALE
SEE DETAIL 'A'
DDE = 190 CY

CLASS 'B' RIP RAP
EST. 4 TONS
12 SY FILTER FABRIC

CLASS 'B' RIP RAP
EST. 3 TONS
17 SY FILTER FABRIC

-BL-4 15+69.60 PINC
-L- STA. 13+77.75
17.99' LT.

-BL-3 12+33.21 PINC
-L- STA. 11+11.57
25.18' RT.

-BL-2 9+58.46 PINC

-BL-5 18+41.53 POT
-BYI- 12+38.33 PINC
-Y- STA. 17+95.24
20.01' RT.

-BYI-6 5+00.00 POT
-Y- STA. 10+68.05
12.89' LT.

-BYI-7 7+23.60 PINC
-Y- STA. 12+88.31
19.23' RT.

-BYI-8 10+17.61 PINC
-Y- STA. 15+75.40
21.17' RT.

-BYI-9 15+35.15 POT
-Y- STA. 20+90.27
12.49' LT.

BM #3
-BYI- STA. 6+65.46
34.18 RIGHT
ELEV. 1767.59'

BM #2
-BL- STA. 15+86.66
35.48 LEFT
ELEV. 1733.88'

BM #4
OUT OF CHAIN
ELEV. 1743.08'

W.A. MILLSAPS

