

T.I.P.: B-4117

**STATE OF NORTH CAROLINA
DEPARTMENT OF TRANSPORTATION**

**PAVEMENT MARKING PLAN
GASTON COUNTY**

**LOCATION: BRIDGE No. 173 OVER SAILOR'S BRANCH CREEK
ON SR 1820**

TIP NO. B-4117	SHEET NO. PMP-1
APPROVED:	
DATE: 3/24/10	
SEAL 	

ROADWAY STANDARD DRAWING

THE FOLLOWING ROADWAY STANDARDS AS APPEAR IN "ROADWAY STANDARD DRAWINGS" - PROJECT SERVICES UNIT - N.C. DEPARTMENT OF TRANSPORTATION - RALEIGH, N.C., DATED JULY 2006 ARE APPLICABLE TO THIS PROJECT AND BY REFERENCE HEREBY ARE CONSIDERED A PART OF THESE PLANS:

STD. NO.	TITLE
1205.01	PAVEMENT MARKINGS - LINE TYPES AND OFFSETS
1205.02	PAVEMENT MARKINGS - 2 LANE AND MULTILANE ROADWAYS
1261.01	GUARDRAIL AND BARRIER DELINEATOR SPACING
1261.02	GUARDRAIL AND BARRIER DELINEATOR TYPES
1262.01	GUARDRAIL END DELINEATION

GENERAL NOTES

THE FOLLOWING GENERAL NOTES APPLY AT ALL TIMES FOR THE DURATION OF THE CONSTRUCTION PROJECT, EXCEPT WHEN OTHERWISE NOTED IN THE PLAN, OR DIRECTED BY THE ENGINEER.

- A) INSTALL PAVEMENT MARKINGS AND PAVEMENT MARKERS ON THE FINAL SURFACE AS FOLLOWS:

ROAD NAME	MARKING	MARKER
SR 1820 ALEXIS HIGH SHOALS RD.	PAINT	
- B) PLACE TWO APPLICATIONS OF PAINT PAVEMENT MARKINGS ON THE FINAL WEARING SURFACE. PLACE THE SECOND APPLICATION OF PAINT UPON SUFFICIENT DRYING TIME OF THE FIRST.
- C) TIE PROPOSED PAVEMENT MARKING LINES TO EXISTING PAVEMENT MARKING LINES.
- D) REMOVE/REPLACE ANY CONFLICTING/DAMAGED PAVEMENT MARKINGS AND MARKERS.
- E) PASSING ZONES WILL BE DETERMINED IN THE FIELD AND MUST BE APPROVED BY THE ENGINEER.

B-4117 FINAL PAVEMENT MARKING SCHEDULE

SYMBOL	DESCRIPTION	FINAL PAVEMENT MARKINGS	PAY ITEM QUANTITY	TOTAL
PA	WHITE EDGELINE	PAINT (4")	2000 LF	
PI	YELLOW DOUBLE CENTER		2000 LF	
			TOTAL	4000 LF

PLAN PREPARED BY: N.C.D.O.T. SIGNING AND DELINEATION UNIT

AYMAN I. ALQUDWAH, P.E.	SIGNING & DELINEATION REGIONAL ENGINEER
DERRICK BEARD	SIGNING & DELINEATION PROJECT DESIGN ENGINEER

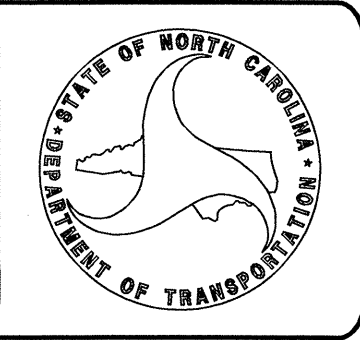

INDEX

SHEET NO.	DESCRIPTION
PMP-1	PAVEMENT MARKING PLAN TITLE SHEET AND PAVEMENT MARKING SCHEDULE
PMP-2	PAVEMENT MARKING DETAIL

24-MAR-2010 09:54
R:\Traffic\Signing\CADD\PM\B-4117_Sgn_PMP_1.dgn
dhbeard

TIP NO.	SHEET NO.
B-4117	PMP-2
APPROVED: <i>[Signature]</i>	
DATE: 3/24/10	
SEAL	

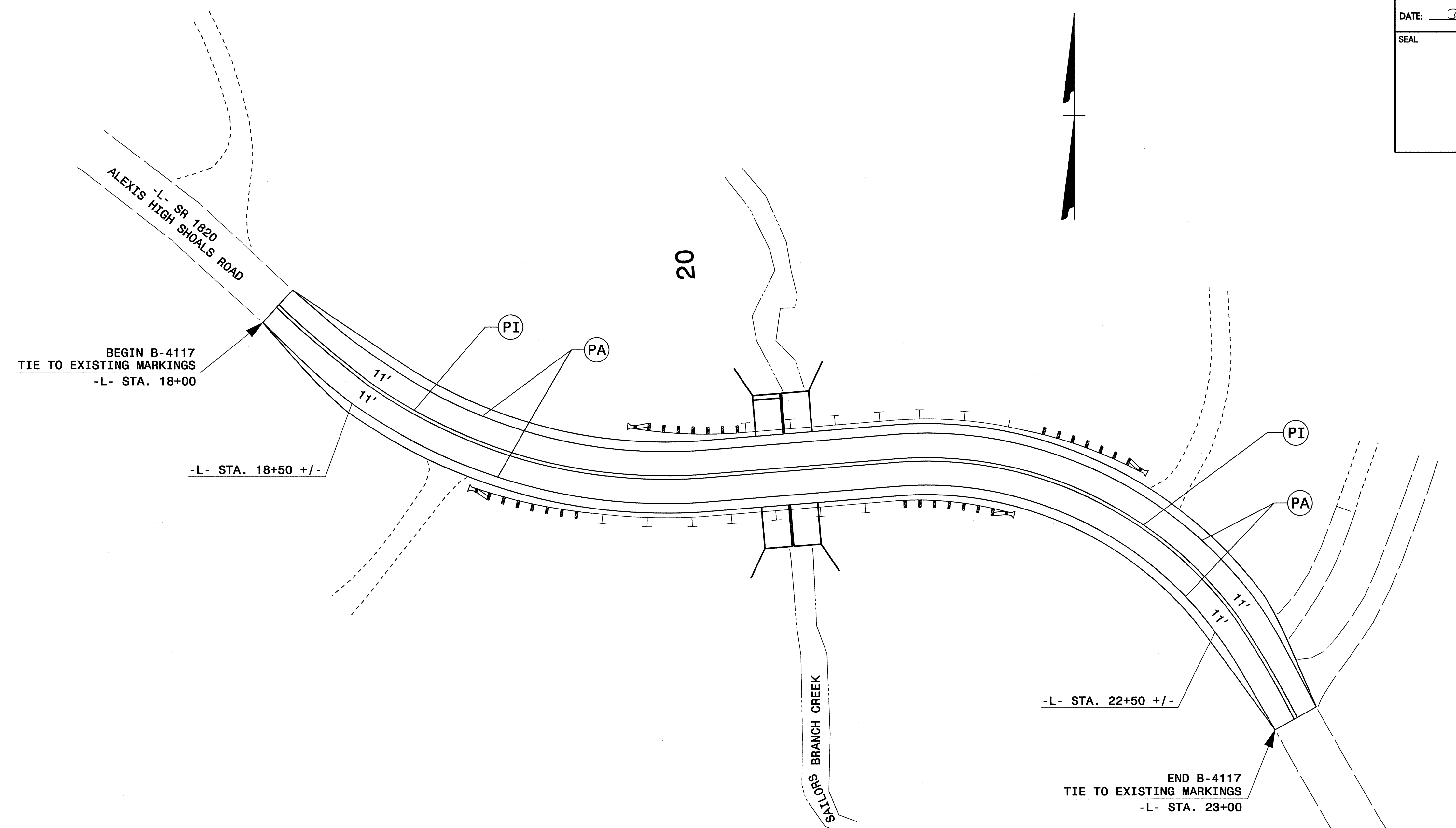

PAVEMENT MARKING DETAIL

24-MAR-2010 08:59
 C:\Users\alqudmani\Documents\CADD\PM\B-4117_Sgn_PMP-2.dgn
 alqudmani