

Project: B-4517

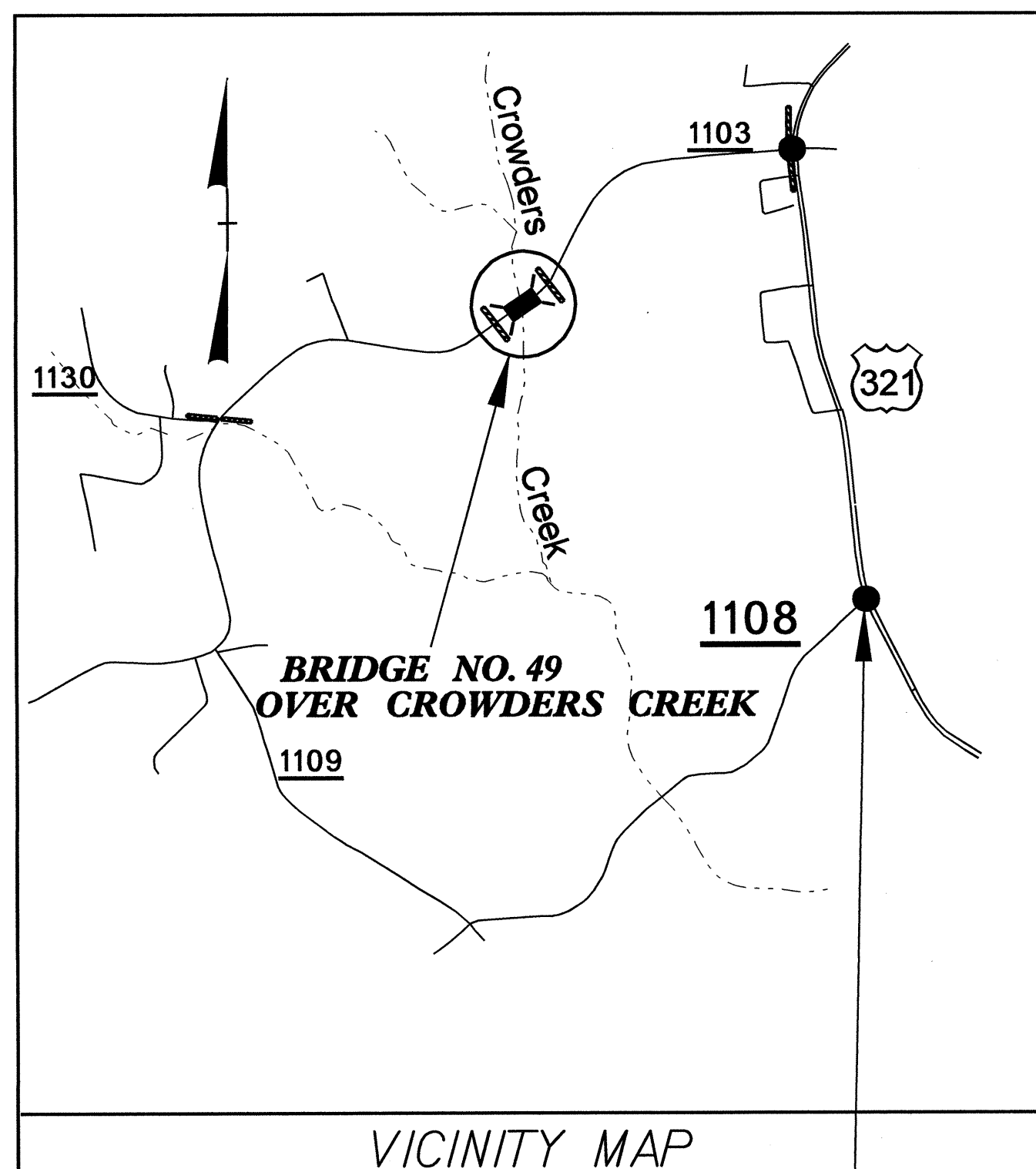

VICINITY MAP

12-1771
TEMPOARY SIGNAL
US 321 at SR 1108

STATE OF NORTH CAROLINA
DIVISION OF HIGHWAYS

GASTON COUNTY

LOCATION: BRIDGE NO. 49 OVER CROWDERS CREEK ON SR 1103 (CRAWFORD RD.)

TYPE OF WORK: TEMPORARY TRAFFIC SIGNAL

TYPE OF WORK: TRAFFIC SIGNALS

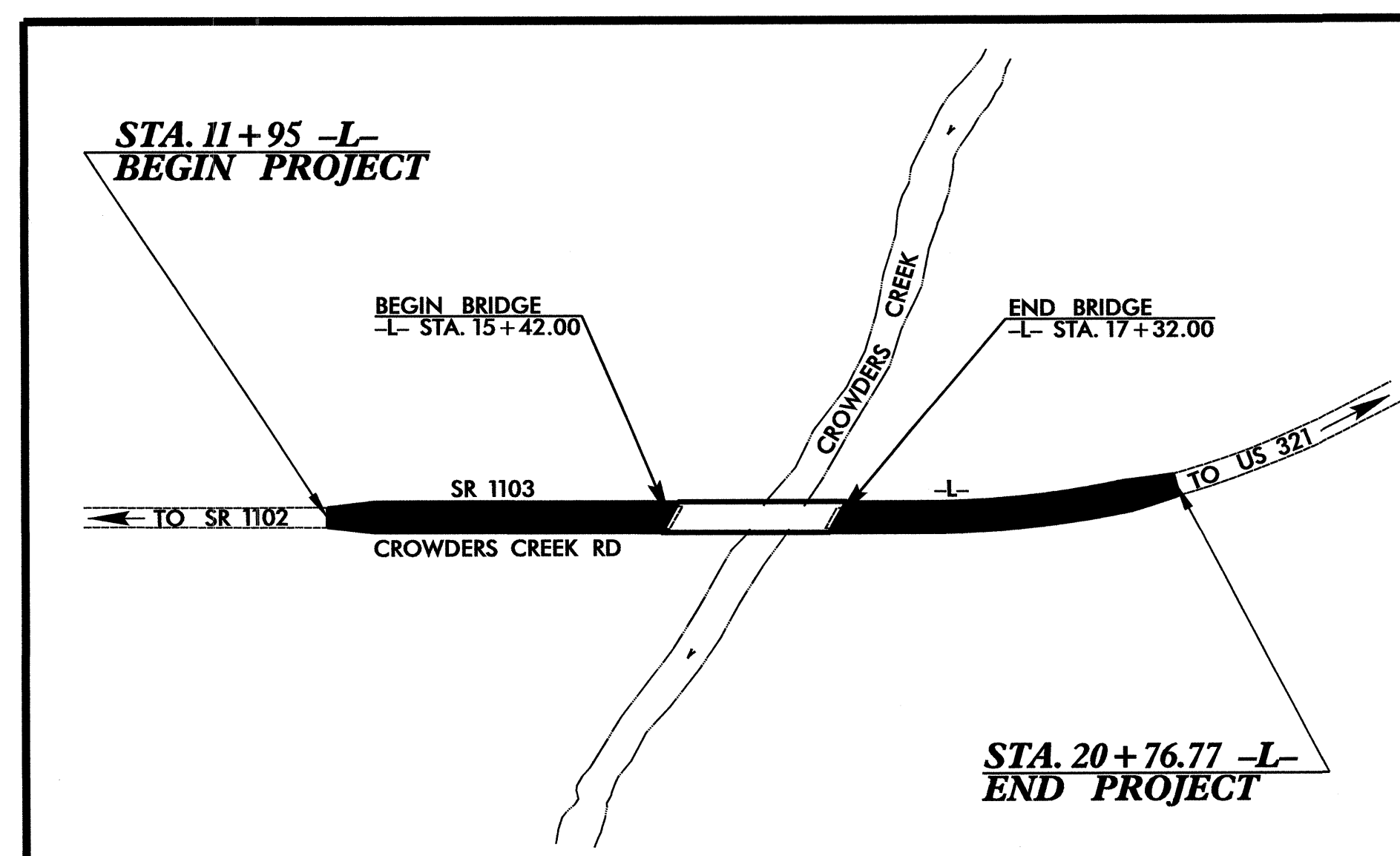

Refer to "Roadway Standard Drawings NCDOT" dated January 2006 and "Standard Specifications for Roads and Structures" dated January 2006.

Sheet #	Reference #	Index of Plans	Location/Description
Sig. 1	N/A		Title Sheet
Sig. 2-3	12-1771		US 321 (York Hwy.) at SR 1108 (Crawford Rd.)

INTELLIGENT TRANSPORTATION AND SIGNALS UNIT

Contacts:
Timothy J. Williams, PE - Western Region Signals Engineer
John T. Rowe, Jr., PE - Signal Equipment Design Engineer

Prepared in the Office of:
DIVISION OF HIGHWAYS
TRANSPORTATION MOBILITY AND SAFETY
DIVISION

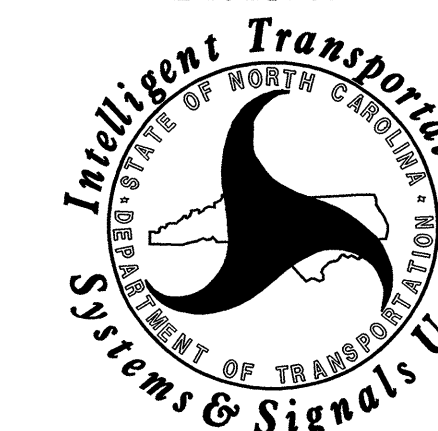

EDI MODEL 2010ECL-NC CONFLICT MONITOR PROGRAMMING DETAIL

(remove jumpers and set switches as shown)

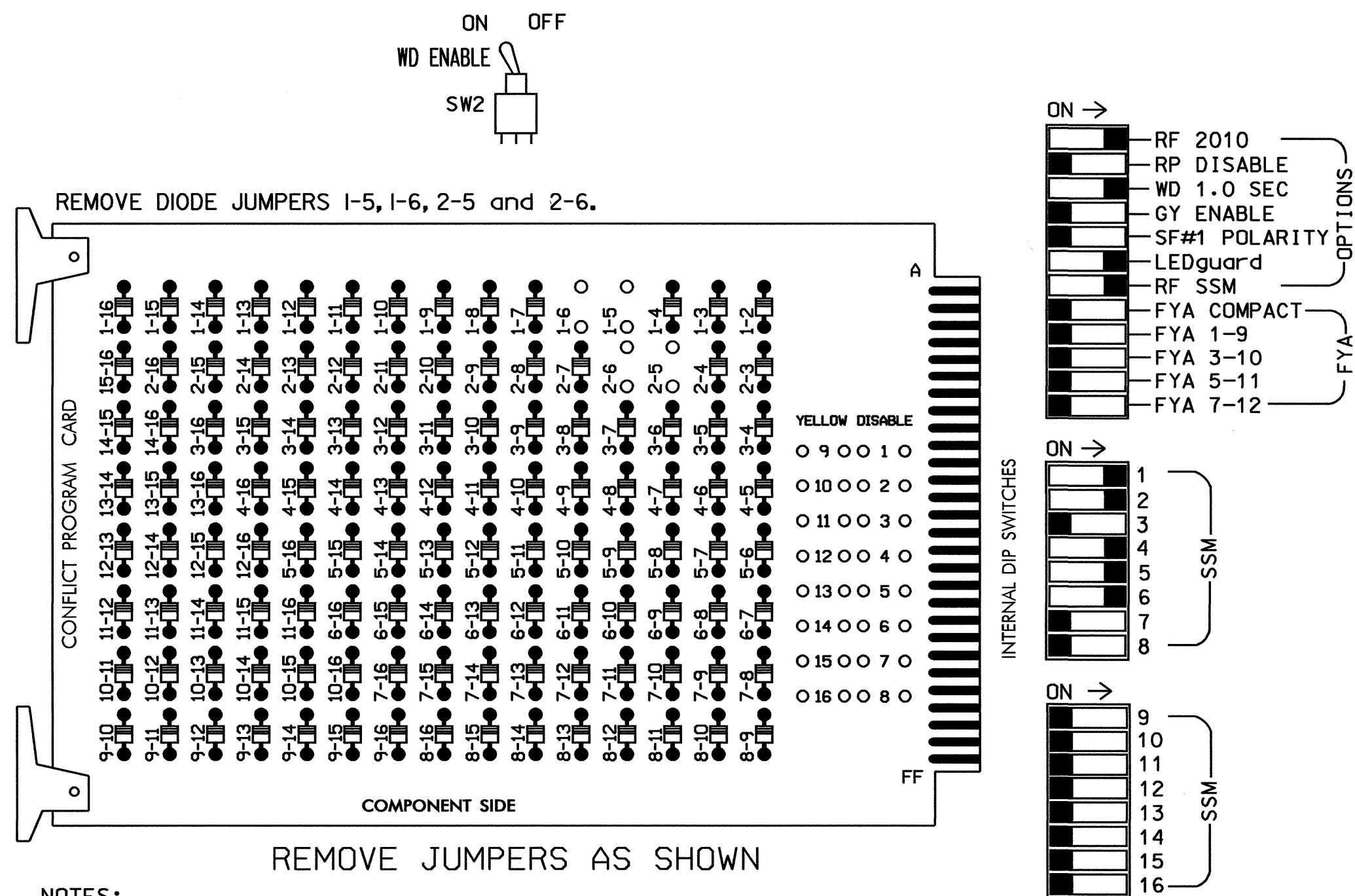

NOTES:

- Card is provided with all diode jumpers in place. Removal of any jumper allows its channels to run concurrently.
- Make sure jumpers SEL2-SEL5 are present on the monitor board.

NOTES

- To prevent "flash-conflict" problems, insert red flash program blocks for all unused vehicle load switches in the output file. The installer shall verify that signal heads flash in accordance with the Signal Plans.
- Ensure that Red Enable is active at all times during normal operation. To prevent Red Failures on unused monitor channels, tie unused red monitor inputs 3,7,8, 9,10,11,12,13,14,15 & 16 to load switch AC+ per the cabinet manufacturer's instructions.
- Enable Simultaneous Gap-Out for all phases.
- Program phases 2 and 6, on the controller unit, for Variable Initial and Gap Reduction.
- Program phases 2 and 6 for Start Up In Green.
- Program phases 2 and 6 for Yellow Flash.

EQUIPMENT INFORMATION

CONTROLLER.....2070L
 CABINET.....336
 SOFTWARE.....ECONOLITE OASIS
 CABINET MOUNT.....POLE
 OUTPUT FILE POSITIONS...12
 LOAD SWITCHES USED.....S1,S2,S4,S5,S6
 PHASES USED.....1,2,4,5,6
 OVERLAPS.....NONE

SIGNAL HEAD HOOK-UP CHART

LOAD SWITCH NO.	S1	S2	S2P	S3	S4	S4P	S5	S6	S6P	S7	S8	S8P
PHASE	1	2	2 PED	3	4	4 PED	5	6	6 PED	7	8	8 PED
SIGNAL HEAD NO.	11	21,22	NU	NU	41 42,43	62	NU	51	61,62	NU	NU	NU
RED		128			101				134			
YELLOW		129			102				135			
GREEN		130			103				136			
RED ARROW	125							131				
YELLOW ARROW	126				102			132				
GREEN ARROW	127				103			133				

NU = Not Used

INPUT FILE POSITION LAYOUT

(front view)

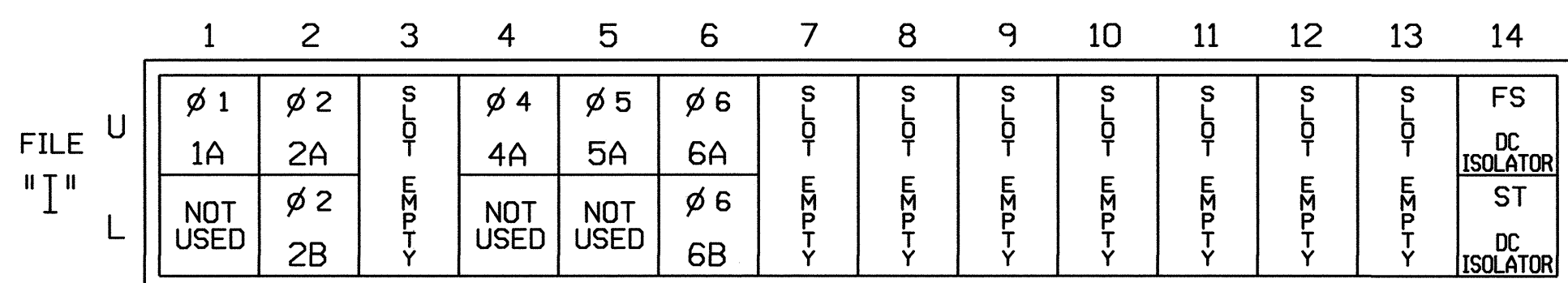

EX. : 1A, 2A, ETC. = LOOP NO.'S

FS = FLASH SENSE
 ST = STOP TIME

INPUT FILE CONNECTION & PROGRAMMING CHART

LOOP NO.	LOOP TERMINAL	INPUT FILE POS.	PIN NO.	INPUT ASSIGNMENT NO.	DETECTOR NO.	NEMA PHASE	CALL	EXTEND	FULL TIME DELAY	STRETCH TIME	DELAY TIME
1A	TB21-1,2	I1U	56	18	1	1	Y	Y			
2A	TB21-3,4	I2U	39	1	2	2	Y	Y			
2B	TB23-3,4	I2L	43	5	12	2	Y	Y			
4A	TB21-7,8	I4U	41	3	4	4	Y	Y			10
5A	TB21-9,10	I5U	55	17	5	5	Y	Y			
6A	TB21-11,12	I6U	40	2	6	6	Y	Y			
6B	TB23-11,12	I6L	44	6	16	6	Y	Y			

INPUT FILE POSITION LEGEND: I2L

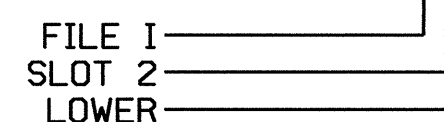

THIS ELECTRICAL DETAIL IS FOR THE SIGNAL DESIGN: 12-1771
 DESIGNED: January 2010
 SEALED: 01-21-10
 REVISED: N/A

Temporary Signal

ELECTRICAL AND PROGRAMMING DETAILS FOR:

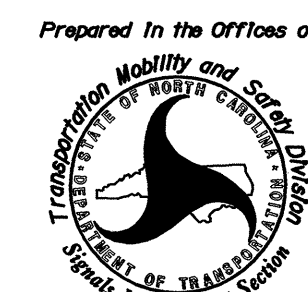

750 N. Greenfield Pkwy, Garner, NC 27529

US 321 (York-Hwy)
 at
 SR 1108 (Crawford Road)

Division 12 Gaston County Gastonia

PLAN DATE: January 2010 REVIEWED BY: JTR

PREPARED BY: James Peterson REVIEWED BY:

REVISIONS INIT. DATE

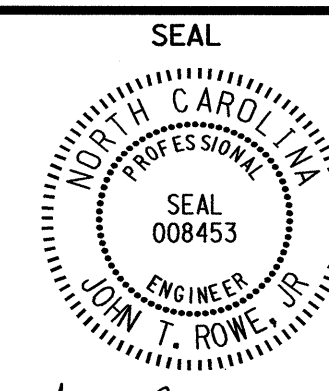

John T. Rowe 1-25-10
 SIGNATURE DATE

SIG. INVENTORY NO. 12-1771