

09/08/99

See Sheet 1-A For Index of Sheets  
See Sheet 1-B For Conventional Symbols

STATE OF NORTH CAROLINA  
DIVISION OF HIGHWAYS

STATE	STATE PROJECT REFERENCE NO.	SHEET NO.	TOTAL SHEETS
N.C.	R-5202	1	
STATE PROJ. NO.	F.A. PROJ. NO.	DESCRIPTION	
42803.1.ST1	STM-0107(11)	P.E.	
42803.3.ST1	STM-0107(11)	CONST.	

# JACKSON COUNTY

LOCATION: NC 107 FROM JUST SOUTH OF SR 1142 (LAUREL KNOB ROAD) TO JUST NORTH OF SR 1145 (NORTH NORTON ROAD)

TYPE OF WORK: UTILITY CONFLICTS

UO-1

PROJECT: R-5202

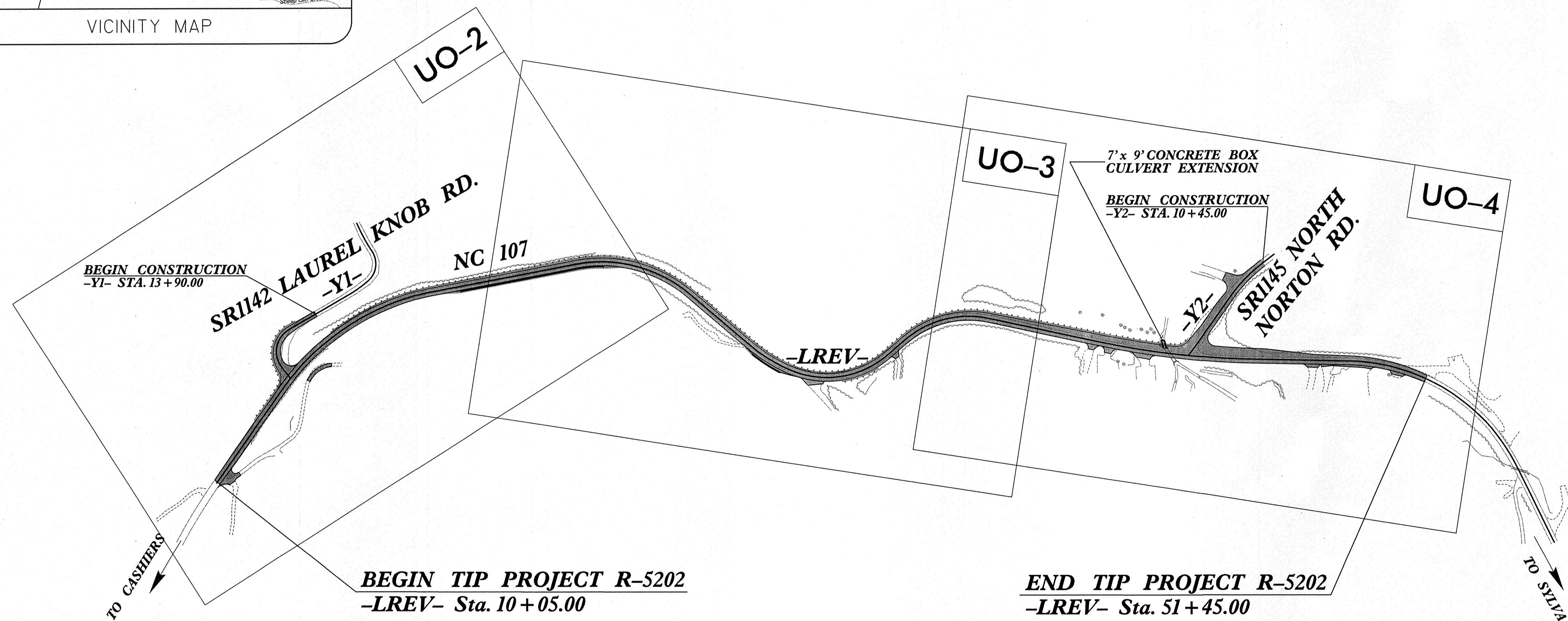
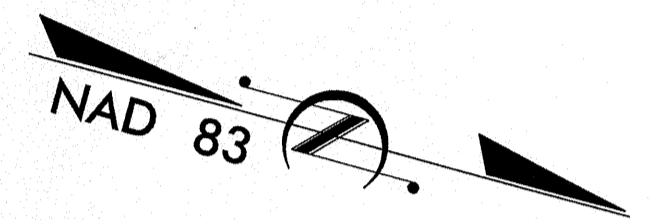
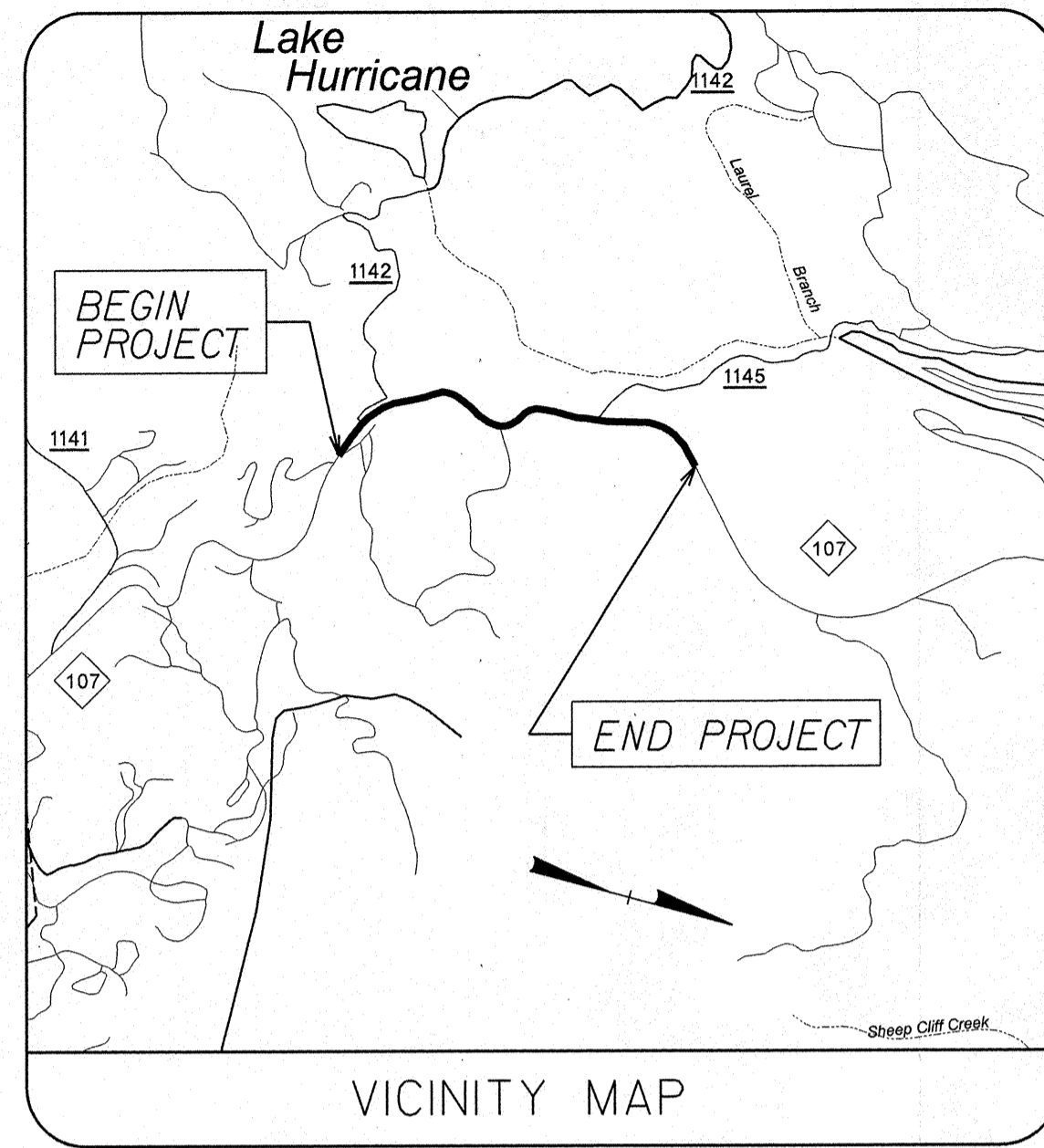

DESIGN EXCEPTION REQUIRED FOR HORIZONTAL ALIGNMENT, VERTICAL ALIGNMENT, SHOULDER WIDTH, AND STOPPING SIGHT DISTANCE.

CONTRACT: C202251

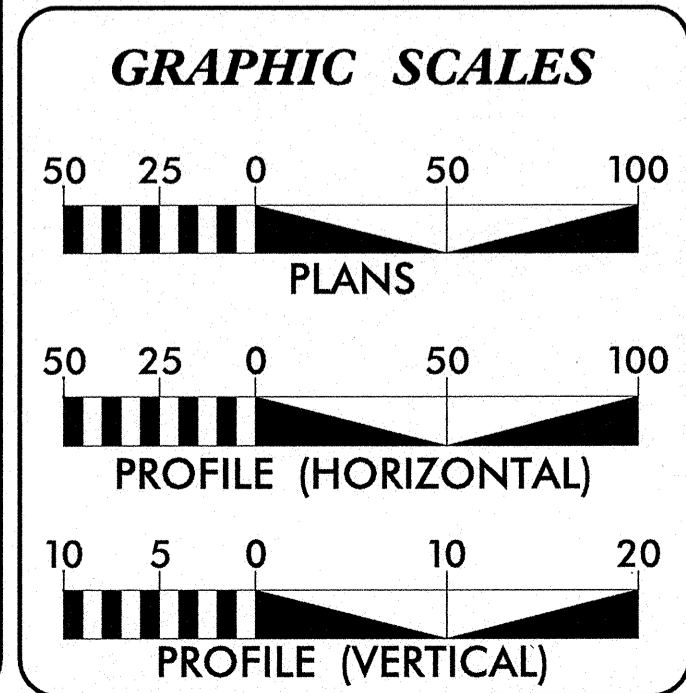

**DESIGN DATA**

ADT 2005 =	6700
V =	50 MPH

**PROJECT LENGTH**

Length Roadway	
TIP Project R-5202	0.784 Mi.
<b>TOTAL LENGTH</b>	
TIP Project R-5202	0.784 Mi.

**UTILITY OWNERS ON PROJECT**

- DUKE ENERGY - POWER
- VERIZON - TELECOMMUNICATIONS

PLANS PREPARED BY :

**RK&K** RUMMEL, KLEPPER & KAHL, LLP  
900 RIDGEFIELD DRIVE, SUITE 350  
RALEIGH, NORTH CAROLINA 27609  
NC LICENSE NO. F-0112

FOR  
**DIVISION OF HIGHWAYS**

2006 STANDARD SPECIFICATIONS	B. Keith Skinner, P.E. PROJECT ENGINEER
ROW DATE: April 16, 2007	
LETTING DATE: February 16, 2010	Brandon J. McInnis, P.E. PROJECT DESIGN ENGINEER

DIVISION OF HIGHWAYS  
STATE OF NORTH CAROLINA

12/17/09 09:54:06  
F:\utilities\ydy-ut\proj\mal4029r\_utl\_tsh.dgn  
jbeauchaine

**UTILITY CONFLICTS**

**DATUM DESCRIPTION**  
 THE LOCALIZED COORDINATE SYSTEM DEVELOPED FOR THIS PROJECT IS BASED ON THE STATE PLANE COORDINATES ESTABLISHED BY NCDOT FOR MONUMENT "R2224A-A5" WITH NAD 1983 STATE PLANE GROUND COORDINATES OF NORTHING: 531164.0779(ft.) EASTING: 770135.60221(ft.) ALL LINEAR DISTANCES ARE LOCALIZED HORIZONTAL DISTANCES. THE VERTICAL DATUM IS BASED ON NCGS (TVA) MONUMENT "LHT-1655" (ELEV. 3638.10') (NAVD 88) THE N.C. LAMBERT GRID BEARING AND LOCALIZED HORIZONTAL GROUND DISTANCE FROM "R2224A-A5" TO -LREV- STATION 10+05.00 IS S 3° 17' 30.2" W 6.037.07' ALL LINEAR DIMENSIONS ARE LOCALIZED HORIZONTAL DISTANCES VERTICAL DATUM USED IS NAVD 88

-LREV-		-YI-		-YI-		-YI-	
PI Sta 16+50.01	PI Sta 25+60.52	PI Sta 10+49.47	PI Sta 11+59.57	PI Sta 12+35.33	PI Sta 15+74.72		
$\Delta = 43^\circ 58' 09.1''$ (RT)	$\Delta = 51^\circ 24' 09.9''$ (RT)	$\Delta = 10^\circ 34' 00.3''$ (LT)	$\Delta = 82^\circ 02' 49.1''$ (RT)	$\Delta = 1^\circ 52' 57.5''$ (RT)	$\Delta = 98^\circ 02' 20.0''$ (LT)		
D = 7' 47' 43.2"	D = 13' 48' 22.4"	D = 10' 42' 34.2"	D = 81' 51' 04.0"	D = 16' 22' 12.8"	D = 71' 37' 11.0"		
L = 564.04'	L = 372.32'	L = 98.67'	L = 100.24'	L = 72.59'	L = 136.89'		
T = 296.73'	T = 199.74'	T = 49.47'	T = 60.90'	T = 36.42'	T = 92.09'		
R = 735.00'	R = 415.00'	R = 535.00'	R = 70.00'	R = 350.00'	R = 80.00'		
Se = 0.06	Se = 0.08				Se = 0.08		
Ro = 110'					Ro = 130'		

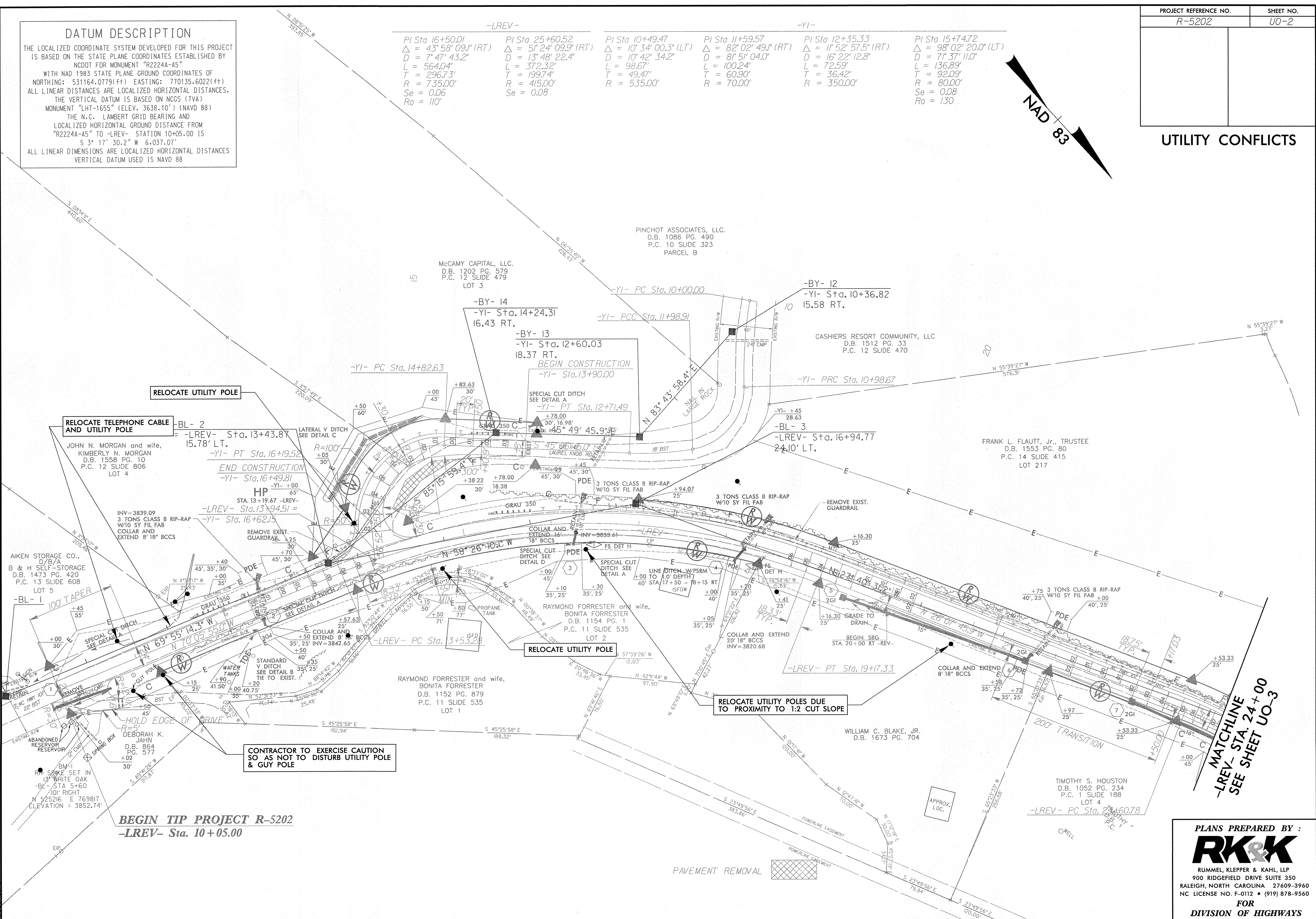
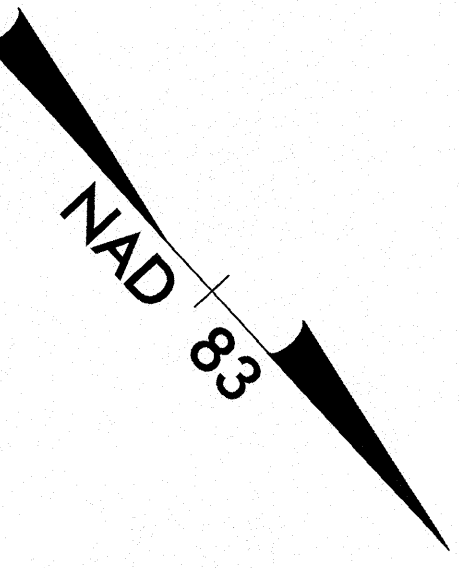

**BEGIN TIP PROJECT R-5202**  
 -LREV- Sta. 10+05.00

**MATCHLINE**  
 -LREV- STA. 24+00  
 SEE SHEET UO-3

**PLANS PREPARED BY :**  
**RK&K**  
 RUMMEL, KLEPPER & KAHL, LLP  
 900 RIDGEFIELD DRIVE SUITE 350  
 RALEIGH, NORTH CAROLINA 27609-3960  
 NC LICENSE NO. F-0112 • (919) 878-9560  
**FOR**  
**DIVISION OF HIGHWAYS**

8/17/99  
 12/17/09 09:54:36  
 Utilities\vdj\ut.prj\mal4029r-ut1.psh002.dgn  
 locustlake

PROJECT REFERENCE NO. R-5202	SHEET NO. UO-3
---------------------------------	-------------------

UTILITY CONFLICTS

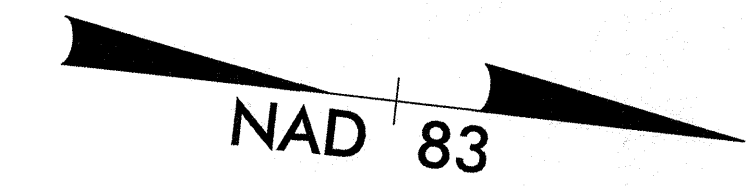

-LREV-

PI Sta 25+60.52 Δ = 51° 24' 09.9" (RT) D = 13' 48' 22.4" L = 372.32' T = 199.74' R = 415.00' Se = 0.08 Ro = SEE PLANS	PI Sta 30+65.06 Δ = 20° 13' 19.3" (LT) D = 13' 28' 52.9" L = 150.00' T = 75.79' R = 425.00' Se = 0.08 Ro = SEE PLANS	PI Sta 33+10.43 Δ = 61° 58' 22.0" (LT) D = 20' 06' 13.6" L = 308.26' T = 171.15' R = 285.00' Se = 0.12 Ro = SEE PLANS	PI Sta 36+58.27 Δ = 53° 51' 39.4" (RT) D = 19' 05' 54.9" L = 282.02' T = 152.40' R = 300.00' Se = 0.10 Ro = SEE PLANS
--	---	--	--

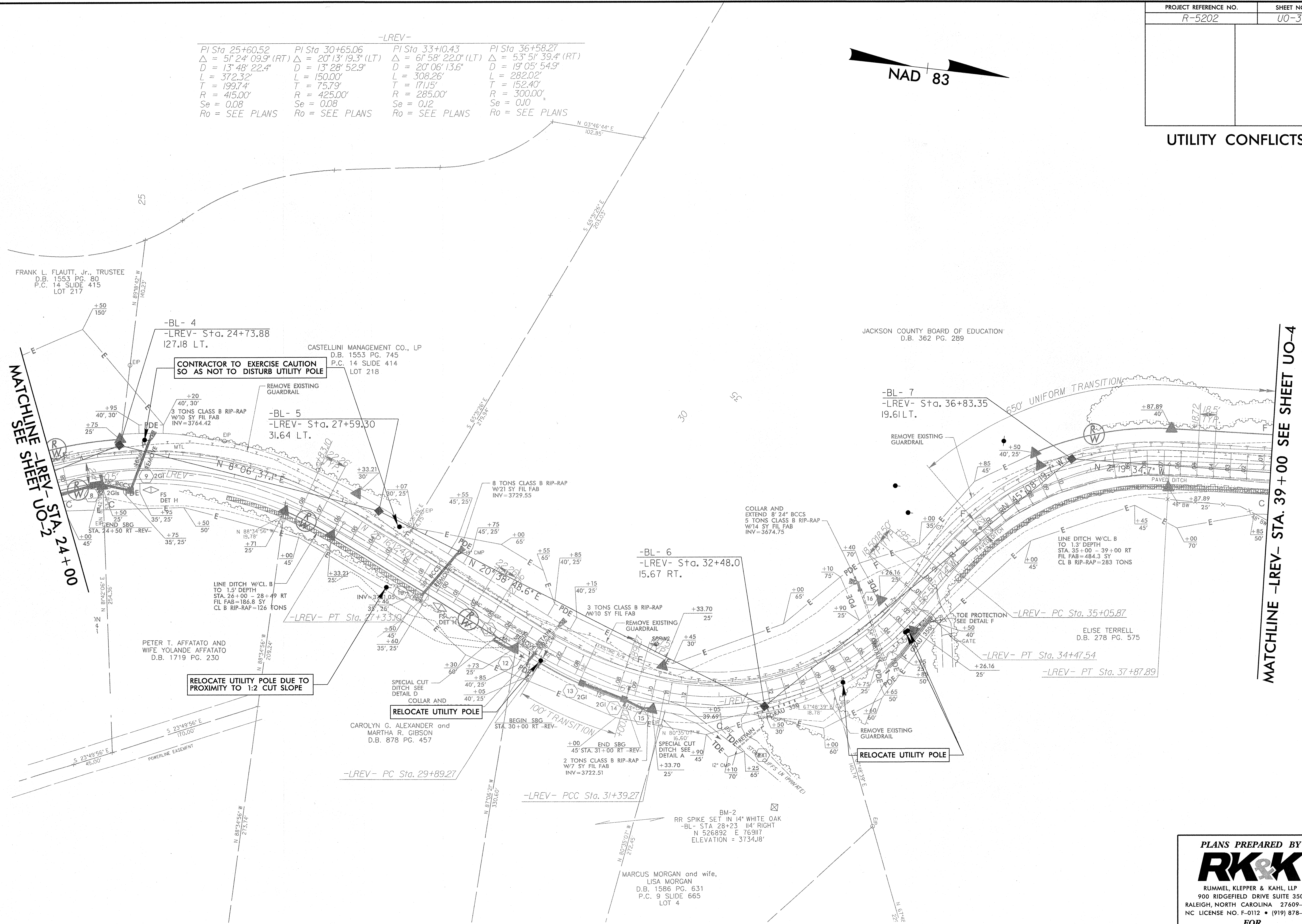

MATCHLINE -LREV- STA. 24+00  
SEE SHEET UO-2

MATCHLINE -LREV- STA. 39+00  
SEE SHEET UO-4

PLANS PREPARED BY :

**RK&K**

RUMMEL, KLEPPER & KAHL, LLP  
 900 RIDGEFIELD DRIVE SUITE 350  
 RALEIGH, NORTH CAROLINA 27609-3960  
 NC LICENSE NO. F-0112 • (919) 878-9560

FOR  
 DIVISION OF HIGHWAYS

8/17/99  
 I:\17\09 0915456  
 r:\utilities\vdj-ut\proj\m14029r-ut\_l\_psh003.dgn  
 lcc:\csh\m

8/17/99

PROJECT REFERENCE NO. R-5202	SHEET NO. U0-4
---------------------------------	-------------------

**-LREV-**  
 PI Sta 43+77.24  
 $\Delta = 10^{\circ} 58' 46.0''$  (LT)  
 $D = 2^{\circ} 21' 28.3''$   
 $L = 465.65'$   
 $T = 233.54'$   
 $R = 2,430.00'$   
 $Se = 0.044$   
 $Ro = 110.00'$

**-Y2-**  
 PI Sta 52+59.19  
 $\Delta = 62^{\circ} 34' 53.0''$  (RT)  
 $D = 9^{\circ} 47' 38.9''$   
 $L = 638.97'$   
 $T = 355.56'$   
 $R = 585.00'$   
 $Se = EXIST.$

**-Y2-**  
 PI Sta 11+15.97  
 $\Delta = 16^{\circ} 53' 40.0''$  (LT)  
 $D = 12^{\circ} 43' 56.6''$   
 $L = 132.69'$   
 $T = 66.83'$   
 $R = 450.00'$   
 $Se = NC$   
 $Ro = 160.00'$

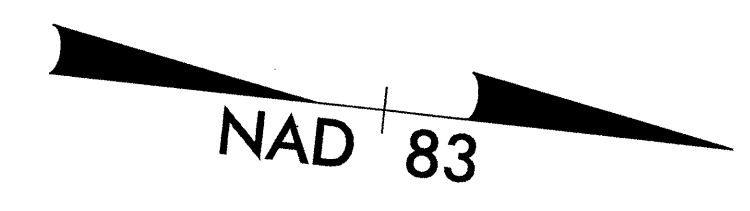

**UTILITY CONFLICTS**

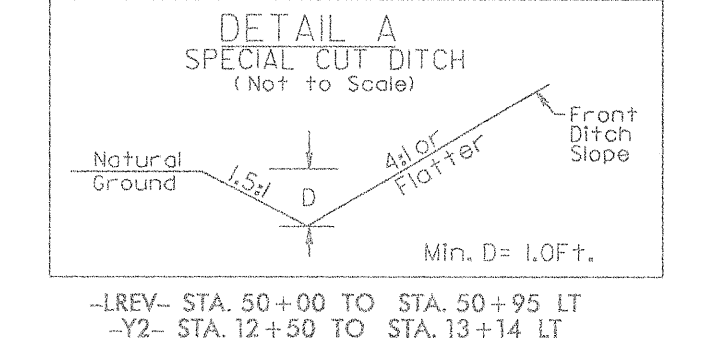

MATCHLINE -LREV- STA. 39+00 SEE SHEET OU-3

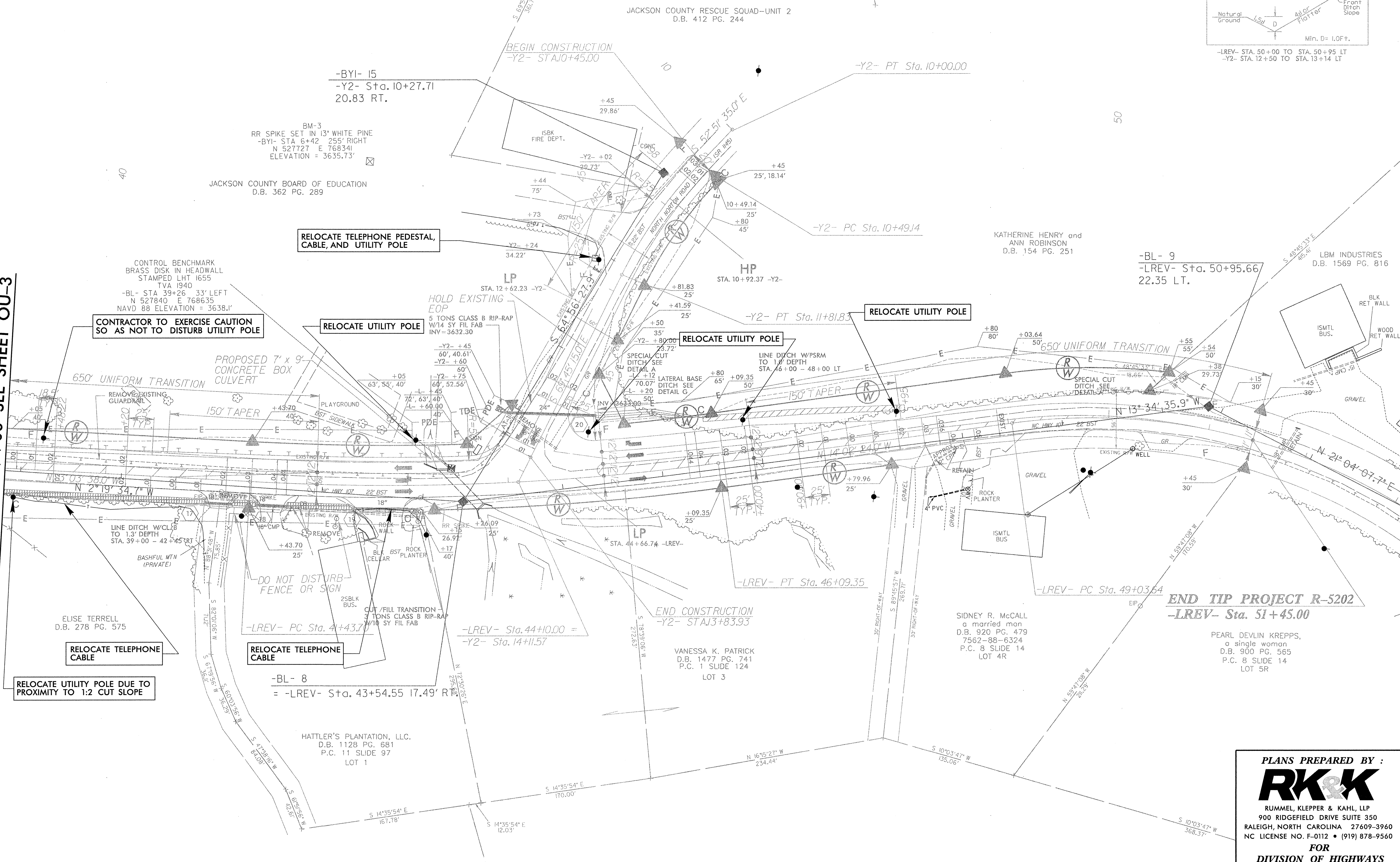

I:\N\09\_09\55\88\Utilities\rdy-ut\proj\ma14029r-ut1.psh001.dgn

**PLANS PREPARED BY :**  
**RK&K**  
 RUMMEL, KLEPPER & KAHL, LLP  
 900 RIDGEMOUNT DRIVE SUITE 350  
 RALEIGH, NORTH CAROLINA 27609-3960  
 NC LICENSE NO. F-0112 • (919) 878-9560  
**FOR**  
**DIVISION OF HIGHWAYS**