

STATE OF NORTH CAROLINA
DIVISION OF HIGHWAYS

STATE PROJECT REFERENCE NO. B-3809 SHEET NO. TCP-01

**PLAN FOR PROPOSED
TRAFFIC CONTROL, MARKING & DELINEATION
BEAUFORT COUNTY**

B-3809

ROADWAY STANDARD DRAWINGS

THE FOLLOWING ROADWAY STANDARDS AS APPEAR IN "ROADWAY STANDARD DRAWINGS" - PROJECT SERVICES UNIT - N.C. DEPARTMENT OF TRANSPORTATION - RALEIGH, N.C., DATED JULY 2006 ARE APPLICABLE TO THIS PROJECT AND BY REFERENCE HEREBY ARE CONSIDERED A PART OF THESE PLANS:

STD. NO.	TITLE
1101.02	TEMPORARY LANE CLOSURES
1101.03	TEMPORARY ROAD CLOSURES
1110.01	STATIONARY WORK ZONE SIGNS
1110.02	PORTABLE WORK ZONE SIGNS
1145.01	BARRICADES
1150.01	FLAGGING DEVICES
1205.01	PAVEMENT MARKINGS - LINE TYPES & OFFSETS
1205.02	PAVEMENT MARKINGS - 2 LANE & MULTILANE ROADWAYS

INDEX OF SHEETS

SHEET NO.	TITLE
TCP-1	LIST OF APPLICABLE ROADWAY STANDARD DRAWINGS, LEGEND AND INDEX OF SHEETS
TCP-2	GENERAL NOTES AND PHASING
TCP-3	OFFSITE DETOUR SIGNING AND ROAD CLOSURE SIGNING

LEGEND

GENERAL

- DIRECTION OF TRAFFIC FLOW
- NORTH ARROW
- PROPOSED PVMT. EXIST. PVMT.
- WORK AREA
- REMOVAL OF EXISTING PAVEMENT

TRAFFIC CONTROL DEVICES

- TYPE I BARRICADE
- TYPE II BARRICADE
- TYPE III BARRICADE
- CONE
- DRUM SKINNY DRUM
- FLASHING ARROW PANEL (TYPE C)
- STATIONARY SIGN
- PORTABLE SIGN
- STATIONARY OR PORTABLE SIGN
- CRASH CUSHION
- CHANGEABLE MESSAGE SIGN
- TRUCK MOUNTED IMPACT ATTENUATOR (TMIA)
- POLICE
- FLAGGER

PAVEMENT MARKINGS

- CRYSTAL/CRYSTAL PAVEMENT MARKER
- YELLOW/YELLOW PAVEMENT MARKER
- CRYSTAL/RED PAVEMENT MARKER
- PAVEMENT MARKING SYMBOLS

TEMP. PAVEMENT MARKING SCHEDULE

DESCRIPTION	QUANTITY BREAKDOWN	TOTAL QUANTITY
	PAINT (4")	
WHITE EDGELINE	10400 LF	
DOUBLE YELLOW CENTERLINE	10400 LF	20800 LF
	TEMPORARY RAISED PAVEMENT MARKERS	
YELLOW/YELLOW	35 EA	35 EA

APPROVED:
DATE: January 11, 2010

SEAL



PLAN PREPARED BY: N.C.D.O.T. WORK ZONE TRAFFIC CONTROL UNIT

- J. S. BOURNE, P.E. **TRAFFIC CONTROL ENGINEER**
- J. S. KITE, P.E. **TRAFFIC CONTROL PROJECT ENGINEER**
- D. A. PARKER **TRAFFIC CONTROL PROJECT DESIGN ENGINEER**
- D. V. JOYNER **TRAFFIC CONTROL DESIGN ENGINEER / TECHNICIAN**

TIP PROJECT:

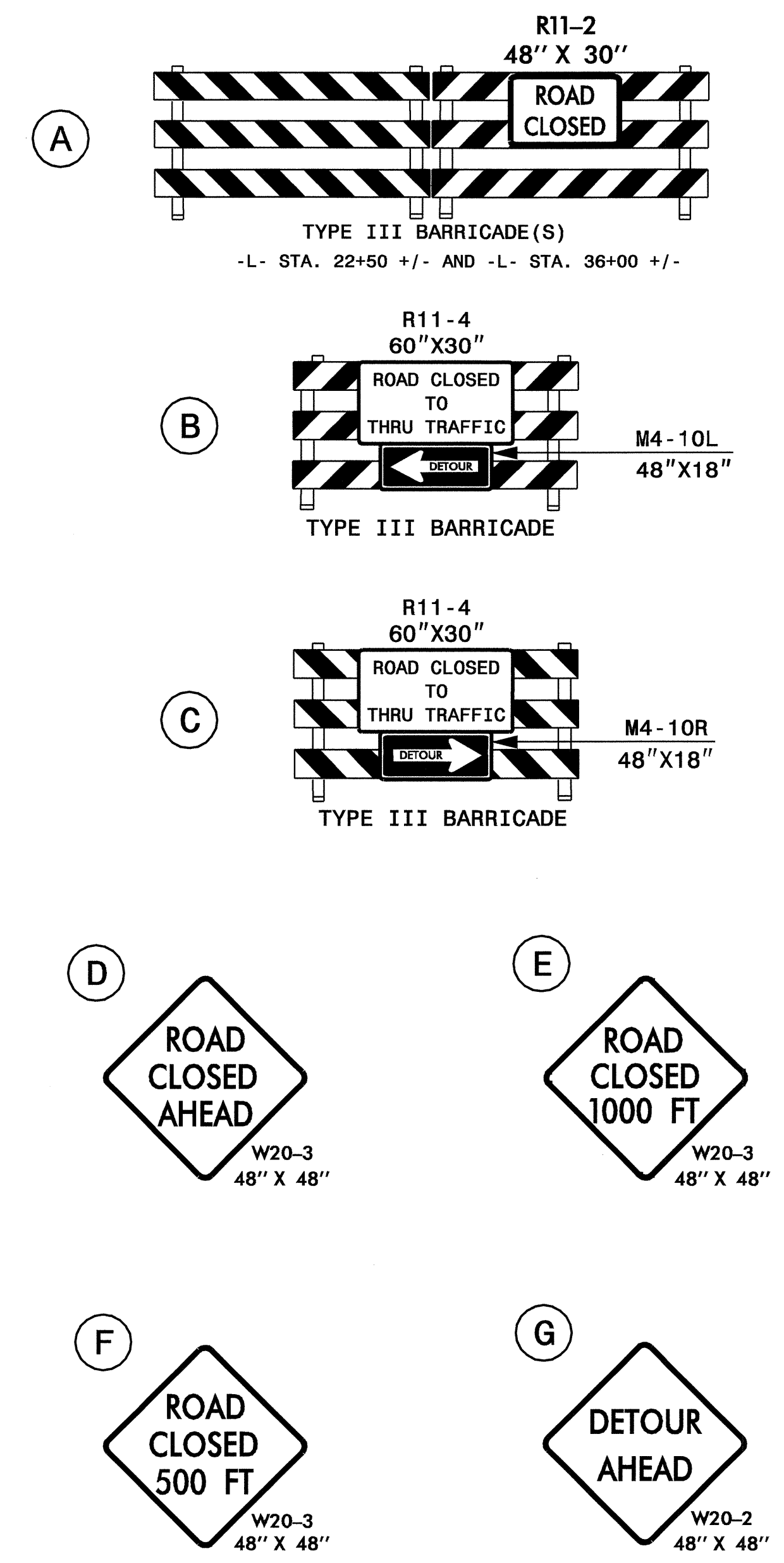
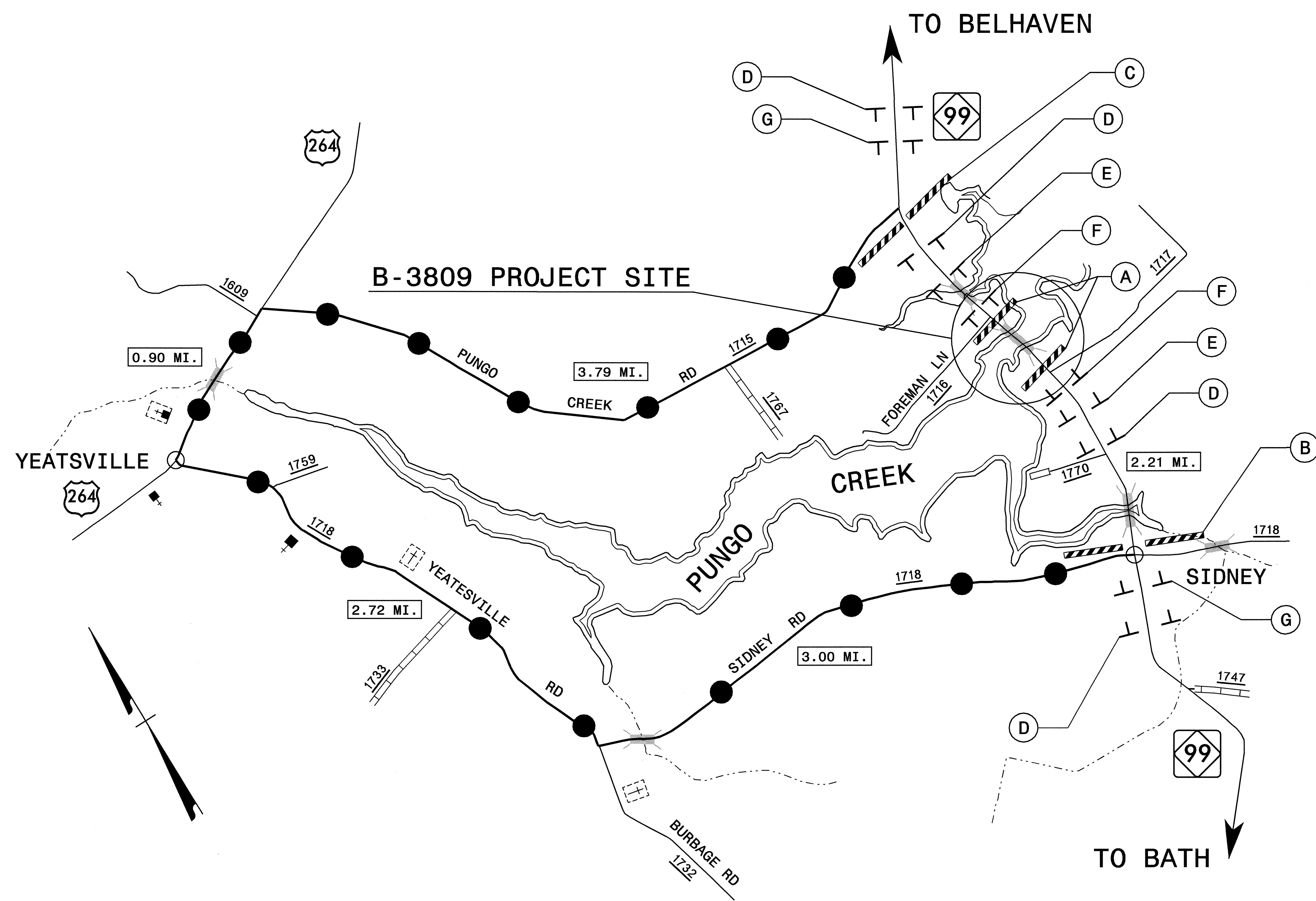

NOTES:

TRAFFIC CONTROL DEVICES (A) THRU (I) SHALL BE INSTALLED ACCORDING TO ROADWAY STANDARD DRAWING NO. 1101.03, SHEET 1 OF 9 BY CONTRACTOR.

STATE FORCES WILL PROVIDE OFF-SITE DETOUR ROUTE SIGNING. (TRAILBLAZING)

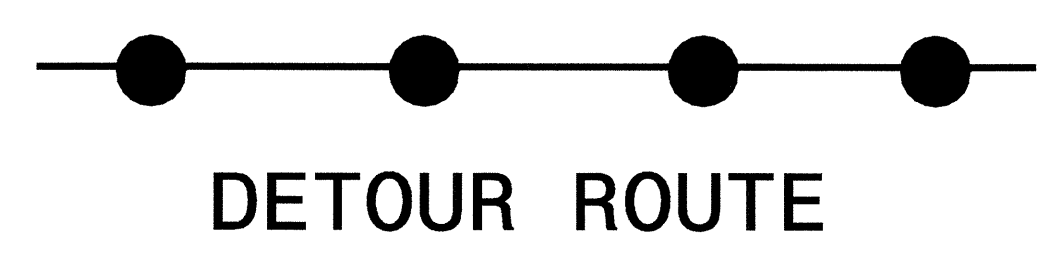

30-OCT-2009 14:20 \\dot\offsite\top\proj\traffic\tr\aff\control\top\b-3809_top_3.dgn dougjoynes AT WZTC244749

APPROVED:	DATE: 11/2/09	OFFSITE DETOUR SIGNING AND ROAD CLOSURE SIGNING	
		DATE: OCT 2009	REVISIONS
DESIGN BY: DVJ			
REVIEWED BY: DAP			