

STATE	STATE PROJECT REFERENCE NO.	SHEET NO.	TOTAL SHEETS
N.C.	U-3100B	EC-1	
STATE PROJ. NO.	F.A. PROJ. NO.	DESCRIPTION	

STATE OF NORTH CAROLINA  
 DIVISION OF HIGHWAYS  
 PLAN FOR PROPOSED  
 HIGHWAY EROSION CONTROL  
**ORANGE COUNTY**

**LOCATION:** Carrboro- Old Fayetteville Road from NC 54 to McDougle Middle School  
**TYPE OF WORK:** Grading, Widening, Paving, Resurfacing, Signal, and Drainage

**EROSION AND SEDIMENT CONTROL MEASURES**

Std. #	Description	Symbol
1630.05	Temporary Silt Ditch	
1630.05	Temporary Diversion	
1605.01	Temporary Silt Fence	
1606.01	Special Sediment Control Fence	
1622.01	Temporary Berms and Slope Drains	
1630.01	Riser Basin	
	Silt Basin Type B	
1633.01	Temporary Rock Silt Check Type-A	
	Temporary Rock Silt Check Type-B	
	Wattle	
1634.01	Temporary Rock Sediment Dam Type-A	
1634.02	Temporary Rock Sediment Dam Type-B	
1635.01	Rock Pipe Inlet Sediment Trap Type-A	
1635.02	Rock Pipe Inlet Sediment Trap Type-B	
1630.04	Stilling Basin	
1630.06	Special Stilling Basin	
	Rock Inlet Sediment Trap:	
1632.01	Type A	
1632.02	Type B	
1632.03	Type C	
	Skimmer Basin	
	Tiered Skimmer Basin	
	Infiltration Basin	

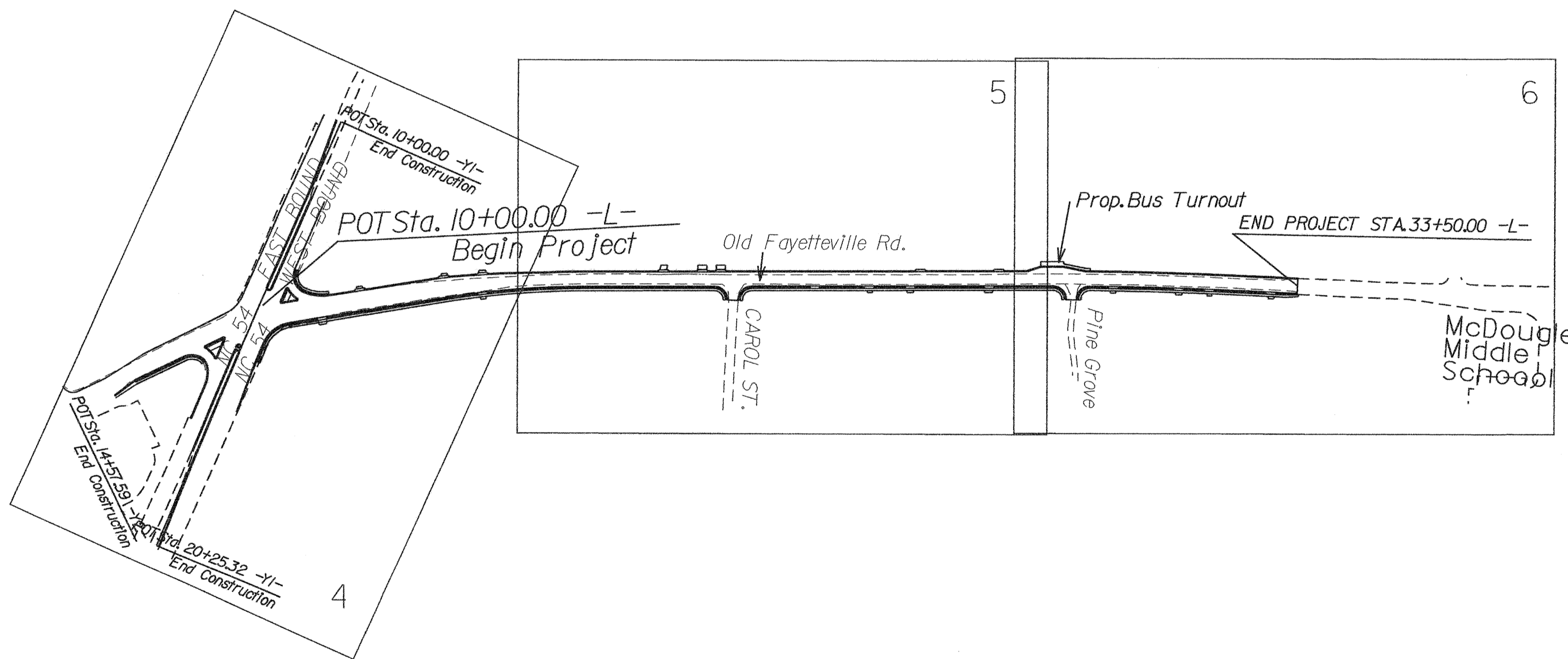

**THIS PROJECT CONTAINS  
 EROSION CONTROL PLANS  
 FOR CLEARING AND  
 GRUBBING PHASE OF  
 CONSTRUCTION.**

**THIS PROJECT HAS  
 BEEN DESIGNED TO  
 SENSITIVE WATERSHED  
 STANDARDS.**

**TIP PROJECT: U-3100B**

**GRAPHIC SCALE**

0  
  
**PLANS**

0  
  
**PROFILE (HORIZONTAL)**

0  
  
**PROFILE (VERTICAL)**

ROADSIDE ENVIRONMENTAL UNIT  
 DIVISION OF HIGHWAYS  
 STATE OF NORTH CAROLINA

Prepared in the Office of:  
**ROADSIDE ENVIRONMENTAL UNIT**  
 1 South Wilmington St.  
 Raleigh, NC 27611  
**2006 STANDARD SPECIFICATIONS**

Roadway Standard Drawings

The following roadway english standards as appear in "Roadway Standard Drawings"- Roadway Design Unit - N. C. Department of Transportation - Raleigh, N. C., dated July 18, 2006 and the latest revision thereto are applicable to this project and by reference hereby are considered a part of these plans.

1605.01 Temporary Silt Fence	1632.02 Rock Inlet Sediment Trap Type B
1606.01 Special Sediment Control Fence	1632.03 Rock Inlet Sediment Trap Type C
1607.01 Gravel Construction Entrance	1633.01 Temporary Rock Silt Check Type A

\\fd\p2009\_10\2009\roadside\erosion\_control\10102b.eco.tah.dgn  
 10/20/09 11:11 AM BIPED240318

PROJECT REFERENCE NO. U-3100B	SHEET NO. EC-2
RW SHEET NO.	
ROADWAY DESIGN ENGINEER	HYDRAULICS ENGINEER

# TEMPORARY ROCK SILT CHECK TYPE 'B' DETAIL

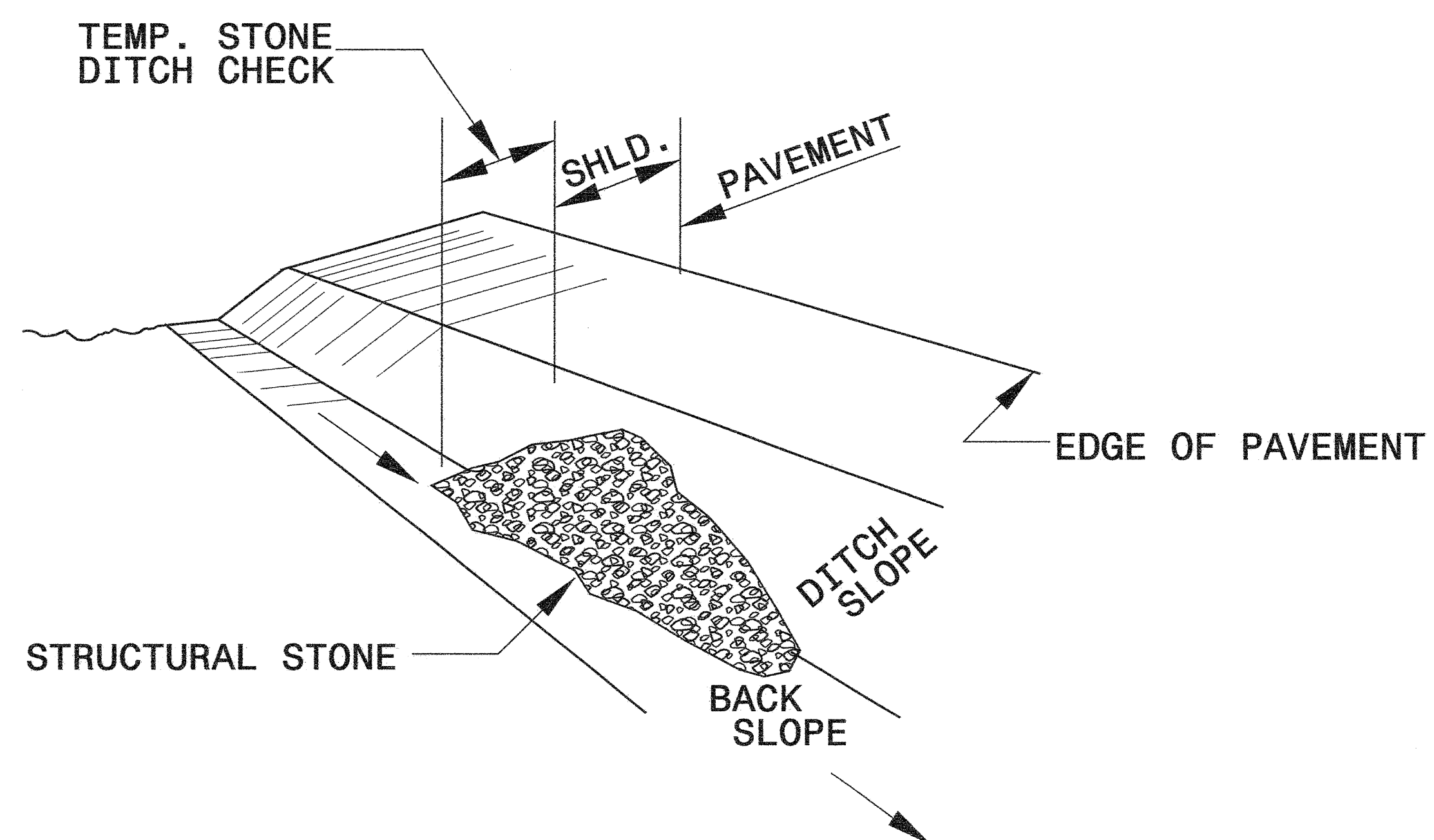

**ISOMETRIC VIEW**

**NOTES:**

USE CLASS 'B' EROSION CONTROL STONE FOR STRUCTURAL STONE.

THE ENGINEER MAY DIRECT THE OPTION OF CLASS "A" STONE FOR SITES HAVING LESS THAN ONE (1) ACRE DRAINAGE AREA AND A DITCH GRADE LESS THAN 3%.

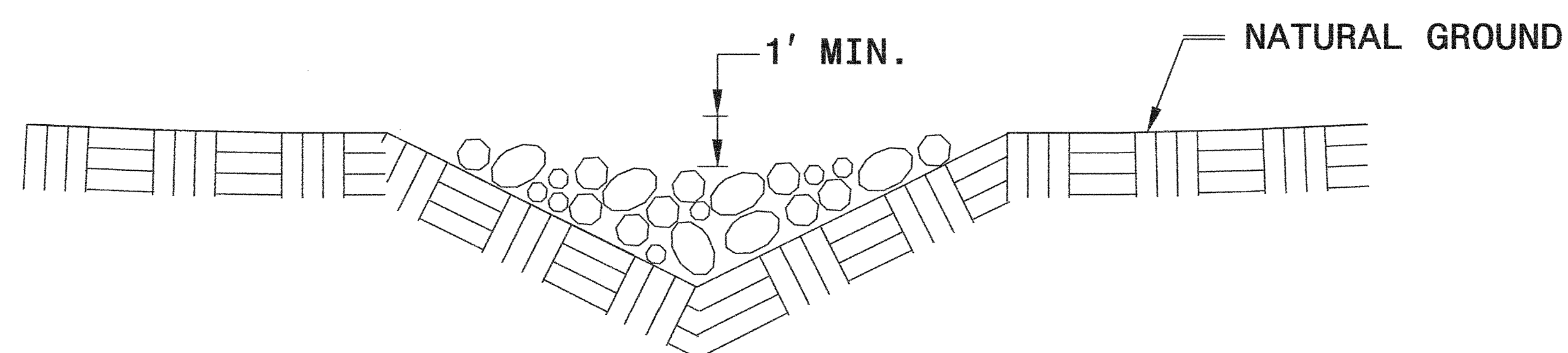

**CROSS SECTION VEE DITCH**

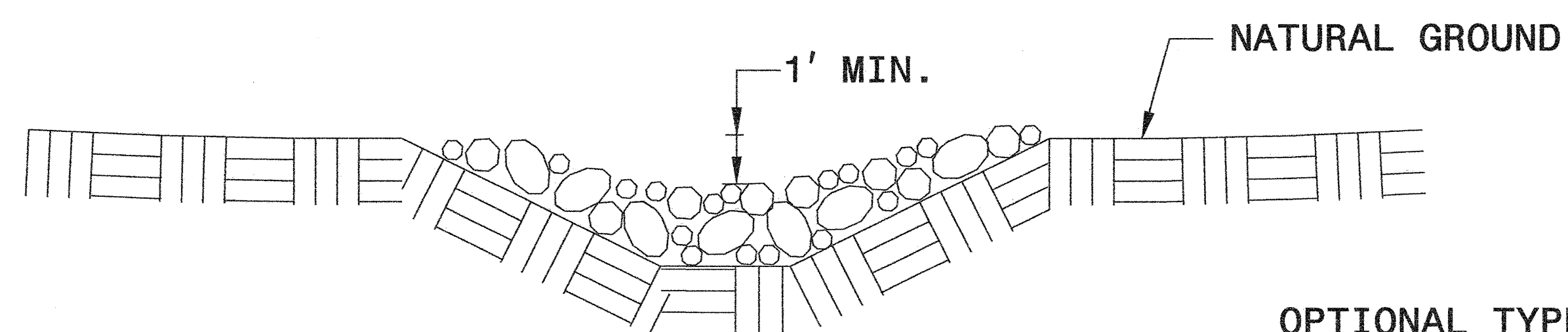

**CROSS SECTION TRAPEZOIDAL DITCH**

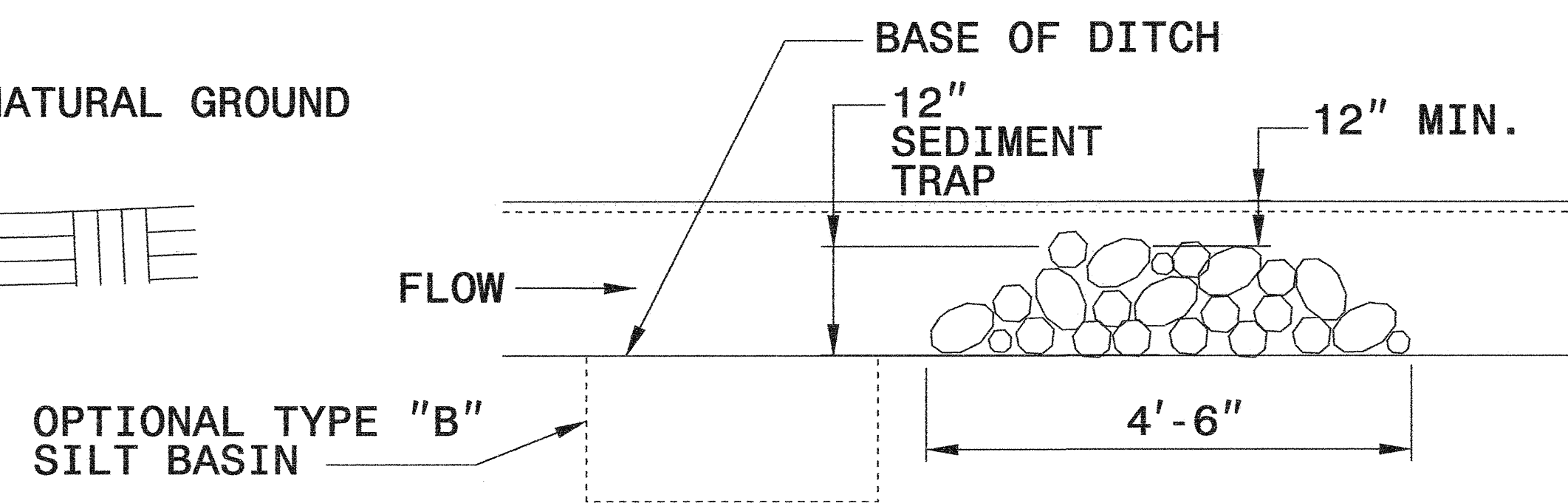

**ELEVATION VIEW**

PROJECT REFERENCE NO. U-3100B	SHEET NO. EC-2A
RW SHEET NO.	
ROADWAY DESIGN ENGINEER	HYDRAULICS ENGINEER

# COIR FIBER BAFFLE DETAIL

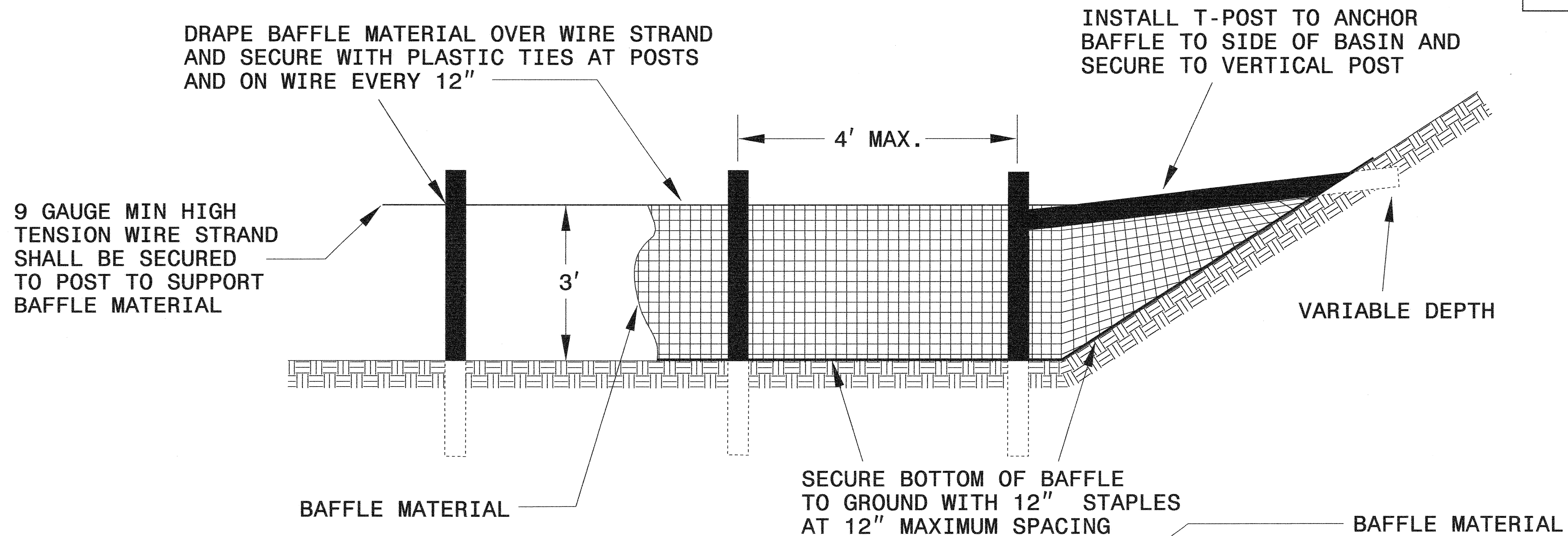

## NOTES:

1. INSTALL THREE(3) COIR FIBER BAFFLES IN SILT BASINS AND SEDIMENT DAMS AT DRAINAGE OUTLETS WITH A SPACING OF  $\frac{1}{4}$  THE BASIN LENGTH.
2. TWO(2) COIR FIBER BAFFLES CAN BE INSTALLED IN SILT BASINS AND DAMS LESS THAN 20 FT. IN LENGTH WITH A SPACING OF  $\frac{1}{3}$  THE BASIN LENGTH.
3. TOP HEIGHT OF COIR FIBER BAFFLES SHALL NOT BE BELOW BASE OF EMERGENCY SPILLWAY ELEVATION.

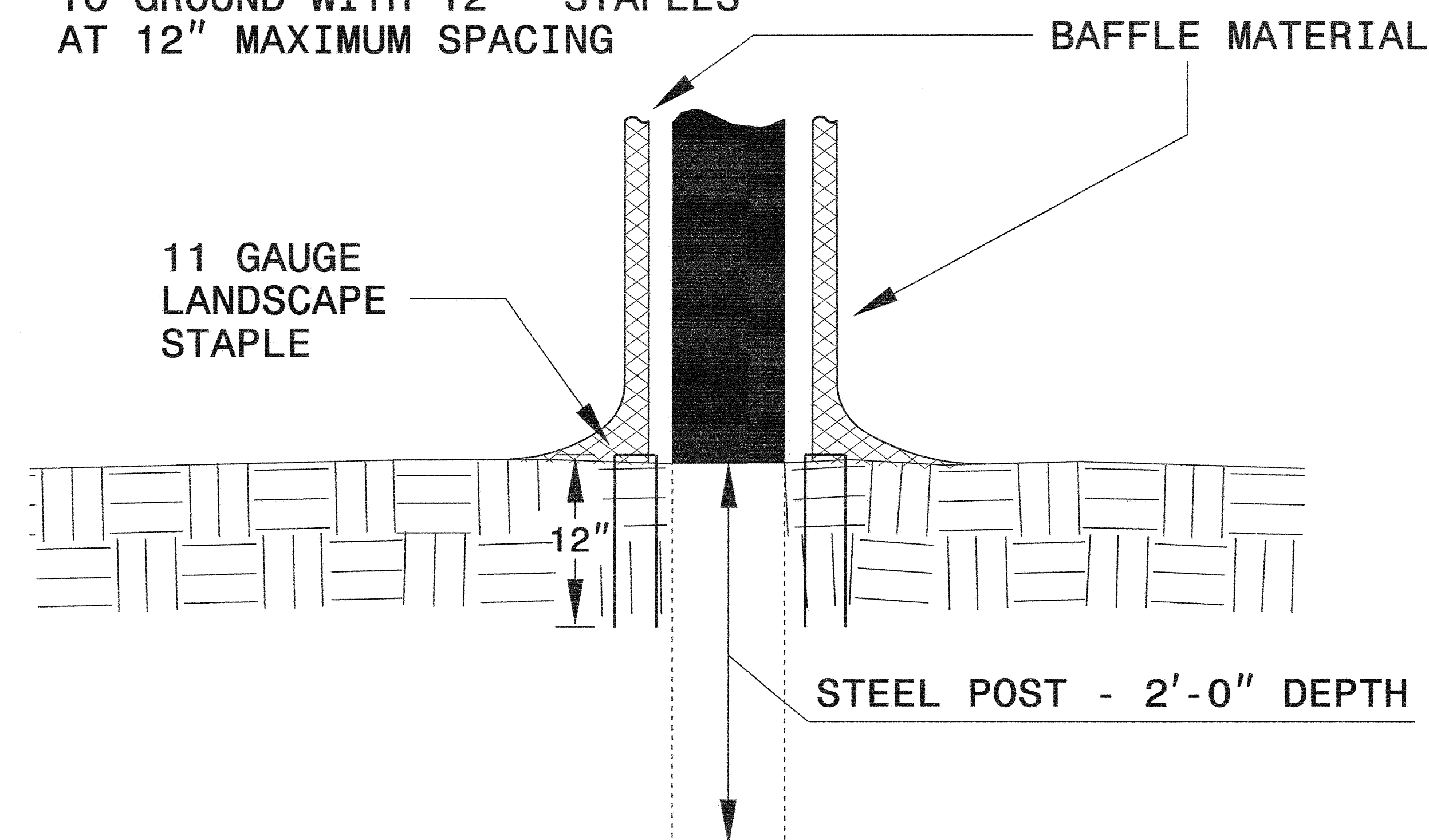

BAFFLE MATERIAL SHALL BE SECURED TO THE BOTTOM AND SIDES OF BASIN USING 12" LANDSCAPE STAPLES

# SILT BASIN 'B' DETAIL

PROJECT REFERENCE NO. U-3100B	SHEET NO. EC-2B
RW SHEET NO.	
ROADWAY DESIGN ENGINEER	HYDRAULICS ENGINEER

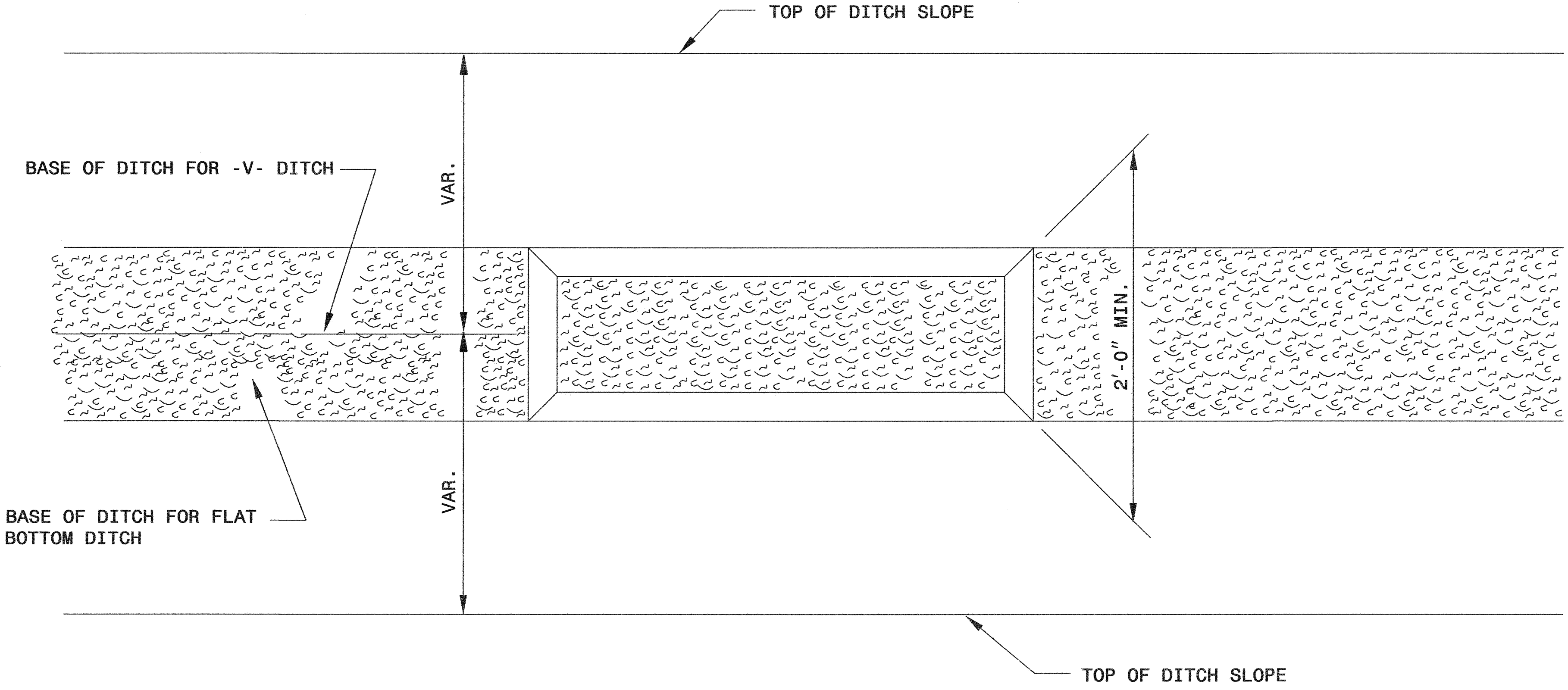

PLAN

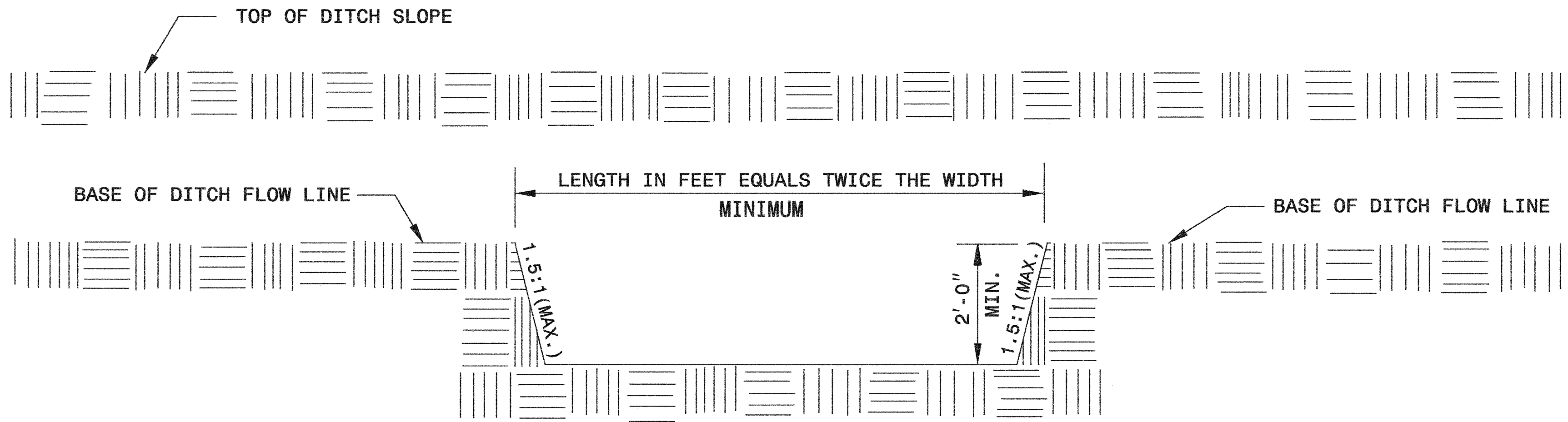

ELEVATION

8/17/98  
 G:\Projects\3100b\3100b.kumar\3100b.ec\_clearing&grubbing.s4.dgn

PROJECT REFERENCE NO.		SHEET NO.	
U-3100B		EC-3/CONST.4	
RW SHEET NO.			
ROADWAY DESIGN ENGINEER		HYDRAULICS ENGINEER	

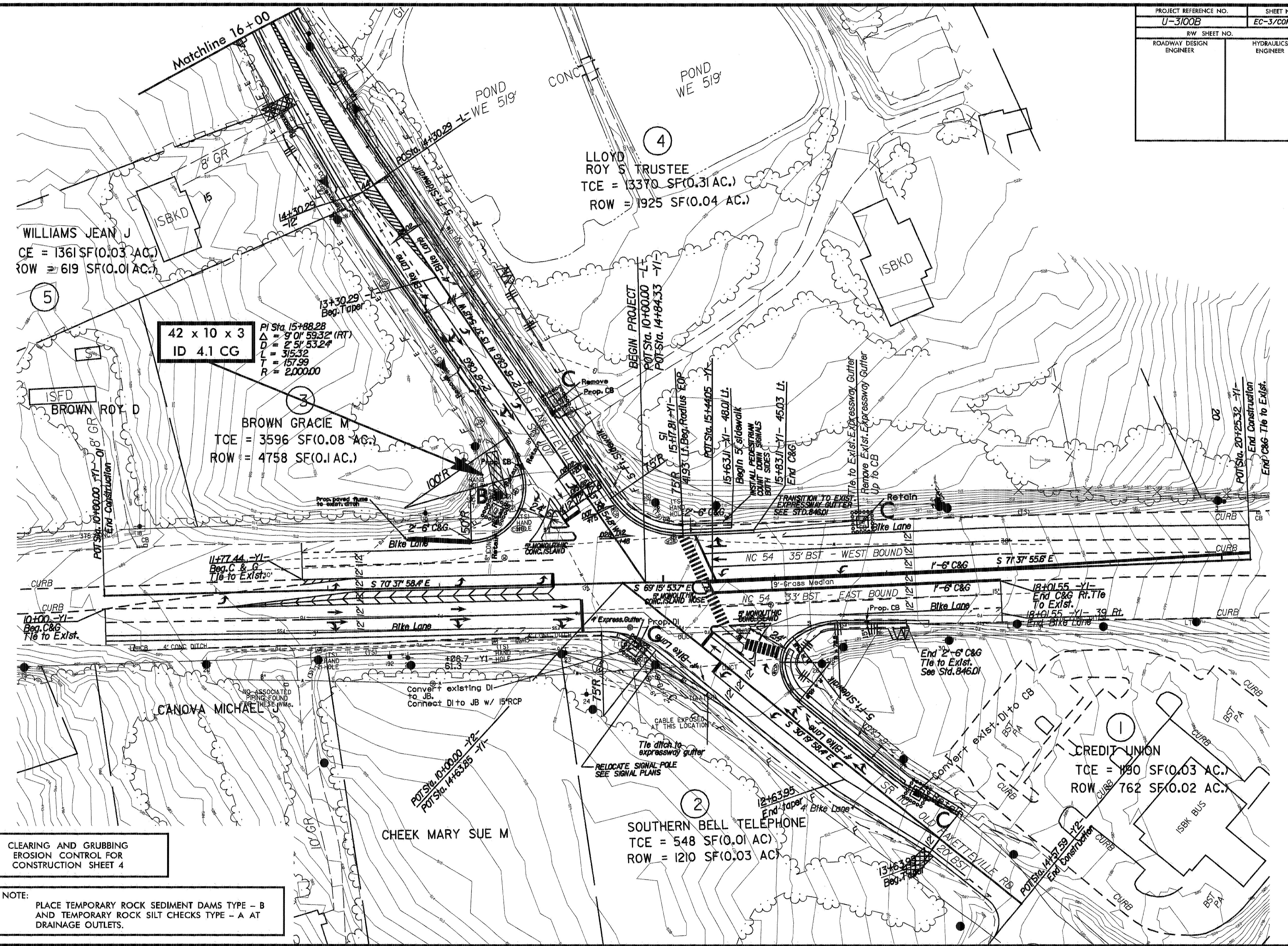

WILLIAMS JEAN J  
 CE = 1361 SF (0.03 AC.)  
 ROW = 619 SF (0.01 AC.)

42 x 10 x 3  
 ID 4.1 CG

BROWN GRACIE M  
 TCE = 3596 SF (0.08 AC.)  
 ROW = 4758 SF (0.1 AC.)

CANOVA MICHAEL J

CHEEK MARY SUE M

SOUTHERN BELL TELEPHONE  
 TCE = 548 SF (0.01 AC.)  
 ROW = 1210 SF (0.03 AC.)

CREDIT UNION  
 TCE = 1190 SF (0.03 AC.)  
 ROW = 762 SF (0.02 AC.)

CLEARING AND GRUBBING  
 EROSION CONTROL FOR  
 CONSTRUCTION SHEET 4

NOTE:  
 PLACE TEMPORARY ROCK SEDIMENT DAMS TYPE - B  
 AND TEMPORARY ROCK SILT CHECKS TYPE - A AT  
 DRAINAGE OUTLETS.

PROJECT REFERENCE NO. <b>U-3100B</b>		SHEET NO. <b>EC-4/CONST.5</b>	
RW SHEET NO.		HYDRAULICS ENGINEER	
ROADWAY DESIGN ENGINEER			

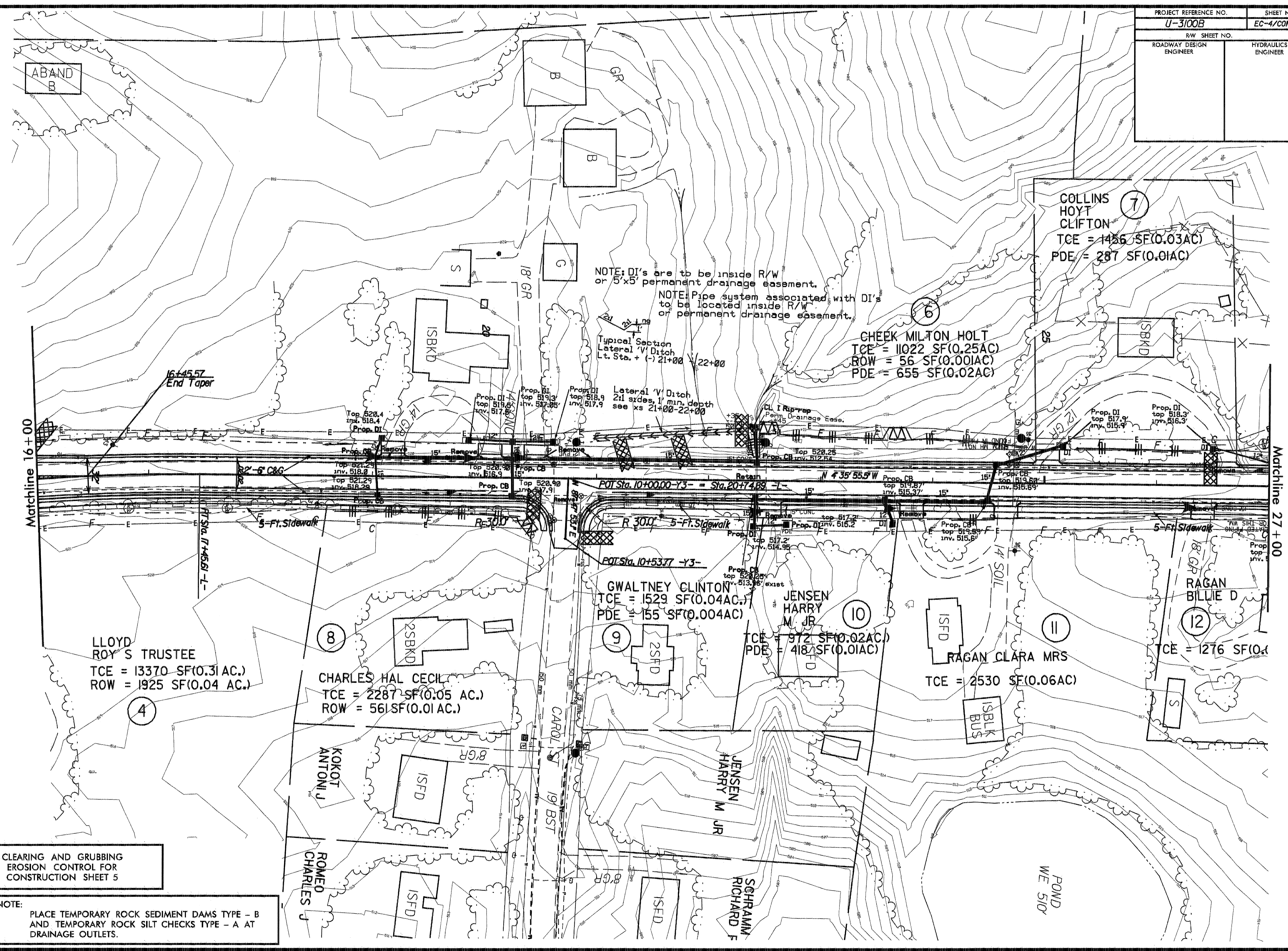

NOTE: DI's are to be inside R/W or 5'x5' permanent drainage easement.

NOTE: Pipe system associated with DI's to be located inside R/W or permanent drainage easement.

Typical Section Lateral V Ditch Lt. Sta. + (-) 21+00 - 22+00

Lateral V Ditch 2:1 sides, 1' min. depth see xs 21+00-22+00

**7**  
COLLINS HOYT CLIFTON  
TCE = 1456 SF(0.03AC)  
PDE = 287 SF(0.01AC)

**6**  
CHEEK MILTON HOLT  
TCE = 11022 SF(0.25AC)  
ROW = 56 SF(0.001AC)  
PDE = 655 SF(0.02AC)

**9**  
GWALTNEY CLINTON  
TCE = 1529 SF(0.04AC)  
PDE = 155 SF(0.004AC)

**10**  
JENSEN HARRY M JR  
TCE = 972 SF(0.02AC)  
PDE = 418 SF(0.01AC)

**11**  
RAGAN CLARA MRS  
TCE = 2530 SF(0.06AC)

**12**  
RAGAN BILLIE D  
TCE = 1276 SF(0.03AC)

**8**  
CHARLES HAL CECIL  
TCE = 2287 SF(0.05 AC.)  
ROW = 56 SF(0.01 AC.)

**4**  
LLOYD ROY'S TRUSTEE  
TCE = 13370 SF(0.31 AC.)  
ROW = 1925 SF(0.04 AC.)

CLEARING AND GRUBBING EROSION CONTROL FOR CONSTRUCTION SHEET 5

NOTE: PLACE TEMPORARY ROCK SEDIMENT DAMS TYPE - B AND TEMPORARY ROCK SILT CHECKS TYPE - A AT DRAINAGE OUTLETS.

8/17/99  
I:\Projects\U-3100B\EC-4\CONST.5\DWG\EC-4-CONST.5.DWG

Matchline 16+00

Matchline 27+00

**CLEARING AND GRUBBING  
EROSION CONTROL FOR  
CONSTRUCTION SHEET 6**

**NOTE:**  
PLACE TEMPORARY ROCK SEDIMENT DAMS TYPE - B  
AND TEMPORARY ROCK SILT CHECKS TYPE - A AT  
DRAINAGE OUTLETS.

PROJECT REFERENCE NO. U-3100B	SHEET NO. EC-5/CONST.6
ROADWAY DESIGN ENGINEER	HYDRAULICS ENGINEER

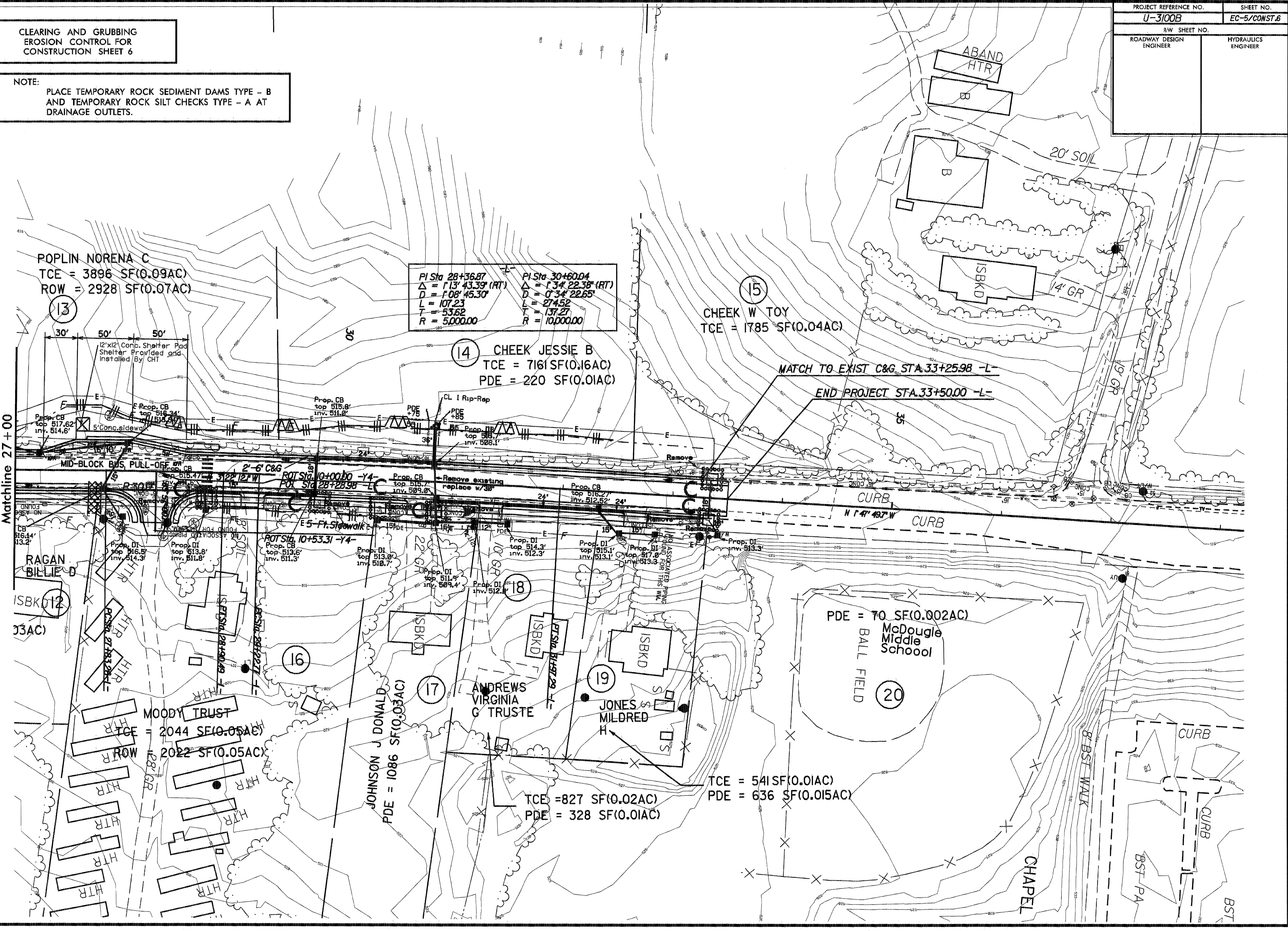

8/17/99  
04 View for Objects: 1, 2, 3, 4, 5, 6, 7, 8, 9, 10, 11, 12, 13, 14, 15, 16, 17, 18, 19, 20, 21, 22, 23, 24, 25, 26, 27, 28, 29, 30, 31, 32, 33, 34, 35, 36, 37, 38, 39, 40, 41, 42, 43, 44, 45, 46, 47, 48, 49, 50, 51, 52, 53, 54, 55, 56, 57, 58, 59, 60, 61, 62, 63, 64, 65, 66, 67, 68, 69, 70, 71, 72, 73, 74, 75, 76, 77, 78, 79, 80, 81, 82, 83, 84, 85, 86, 87, 88, 89, 90, 91, 92, 93, 94, 95, 96, 97, 98, 99, 100, 101, 102, 103, 104, 105, 106, 107, 108, 109, 110, 111, 112, 113, 114, 115, 116, 117, 118, 119, 120, 121, 122, 123, 124, 125, 126, 127, 128, 129, 130, 131, 132, 133, 134, 135, 136, 137, 138, 139, 140, 141, 142, 143, 144, 145, 146, 147, 148, 149, 150, 151, 152, 153, 154, 155, 156, 157, 158, 159, 160, 161, 162, 163, 164, 165, 166, 167, 168, 169, 170, 171, 172, 173, 174, 175, 176, 177, 178, 179, 180, 181, 182, 183, 184, 185, 186, 187, 188, 189, 190, 191, 192, 193, 194, 195, 196, 197, 198, 199, 200, 201, 202, 203, 204, 205, 206, 207, 208, 209, 210, 211, 212, 213, 214, 215, 216, 217, 218, 219, 220, 221, 222, 223, 224, 225, 226, 227, 228, 229, 230, 231, 232, 233, 234, 235, 236, 237, 238, 239, 240, 241, 242, 243, 244, 245, 246, 247, 248, 249, 250, 251, 252, 253, 254, 255, 256, 257, 258, 259, 260, 261, 262, 263, 264, 265, 266, 267, 268, 269, 270, 271, 272, 273, 274, 275, 276, 277, 278, 279, 280, 281, 282, 283, 284, 285, 286, 287, 288, 289, 290, 291, 292, 293, 294, 295, 296, 297, 298, 299, 300, 301, 302, 303, 304, 305, 306, 307, 308, 309, 310, 311, 312, 313, 314, 315, 316, 317, 318, 319, 320, 321, 322, 323, 324, 325, 326, 327, 328, 329, 330, 331, 332, 333, 334, 335, 336, 337, 338, 339, 340, 341, 342, 343, 344, 345, 346, 347, 348, 349, 350, 351, 352, 353, 354, 355, 356, 357, 358, 359, 360, 361, 362, 363, 364, 365, 366, 367, 368, 369, 370, 371, 372, 373, 374, 375, 376, 377, 378, 379, 380, 381, 382, 383, 384, 385, 386, 387, 388, 389, 390, 391, 392, 393, 394, 395, 396, 397, 398, 399, 400, 401, 402, 403, 404, 405, 406, 407, 408, 409, 410, 411, 412, 413, 414, 415, 416, 417, 418, 419, 420, 421, 422, 423, 424, 425, 426, 427, 428, 429, 430, 431, 432, 433, 434, 435, 436, 437, 438, 439, 440, 441, 442, 443, 444, 445, 446, 447, 448, 449, 450, 451, 452, 453, 454, 455, 456, 457, 458, 459, 460, 461, 462, 463, 464, 465, 466, 467, 468, 469, 470, 471, 472, 473, 474, 475, 476, 477, 478, 479, 480, 481, 482, 483, 484, 485, 486, 487, 488, 489, 490, 491, 492, 493, 494, 495, 496, 497, 498, 499, 500, 501, 502, 503, 504, 505, 506, 507, 508, 509, 510, 511, 512, 513, 514, 515, 516, 517, 518, 519, 520, 521, 522, 523, 524, 525, 526, 527, 528, 529, 530, 531, 532, 533, 534, 535, 536, 537, 538, 539, 540, 541, 542, 543, 544, 545, 546, 547, 548, 549, 550, 551, 552, 553, 554, 555, 556, 557, 558, 559, 560, 561, 562, 563, 564, 565, 566, 567, 568, 569, 570, 571, 572, 573, 574, 575, 576, 577, 578, 579, 580, 581, 582, 583, 584, 585, 586, 587, 588, 589, 590, 591, 592, 593, 594, 595, 596, 597, 598, 599, 600, 601, 602, 603, 604, 605, 606, 607, 608, 609, 610, 611, 612, 613, 614, 615, 616, 617, 618, 619, 620, 621, 622, 623, 624, 625, 626, 627, 628, 629, 630, 631, 632, 633, 634, 635, 636, 637, 638, 639, 640, 641, 642, 643, 644, 645, 646, 647, 648, 649, 650, 651, 652, 653, 654, 655, 656, 657, 658, 659, 660, 661, 662, 663, 664, 665, 666, 667, 668, 669, 670, 671, 672, 673, 674, 675, 676, 677, 678, 679, 680, 681, 682, 683, 684, 685, 686, 687, 688, 689, 690, 691, 692, 693, 694, 695, 696, 697, 698, 699, 700, 701, 702, 703, 704, 705, 706, 707, 708, 709, 710, 711, 712, 713, 714, 715, 716, 717, 718, 719, 720, 721, 722, 723, 724, 725, 726, 727, 728, 729, 730, 731, 732, 733, 734, 735, 736, 737, 738, 739, 740, 741, 742, 743, 744, 745, 746, 747, 748, 749, 750, 751, 752, 753, 754, 755, 756, 757, 758, 759, 760, 761, 762, 763, 764, 765, 766, 767, 768, 769, 770, 771, 772, 773, 774, 775, 776, 777, 778, 779, 780, 781, 782, 783, 784, 785, 786, 787, 788, 789, 790, 791, 792, 793, 794, 795, 796, 797, 798, 799, 800, 801, 802, 803, 804, 805, 806, 807, 808, 809, 810, 811, 812, 813, 814, 815, 816, 817, 818, 819, 820, 821, 822, 823, 824, 825, 826, 827, 828, 829, 830, 831, 832, 833, 834, 835, 836, 837, 838, 839, 840, 841, 842, 843, 844, 845, 846, 847, 848, 849, 850, 851, 852, 853, 854, 855, 856, 857, 858, 859, 860, 861, 862, 863, 864, 865, 866, 867, 868, 869, 870, 871, 872, 873, 874, 875, 876, 877, 878, 879, 880, 881, 882, 883, 884, 885, 886, 887, 888, 889, 890, 891, 892, 893, 894, 895, 896, 897, 898, 899, 900, 901, 902, 903, 904, 905, 906, 907, 908, 909, 910, 911, 912, 913, 914, 915, 916, 917, 918, 919, 920, 921, 922, 923, 924, 925, 926, 927, 928, 929, 930, 931, 932, 933, 934, 935, 936, 937, 938, 939, 940, 941, 942, 943, 944, 945, 946, 947, 948, 949, 950, 951, 952, 953, 954, 955, 956, 957, 958, 959, 960, 961, 962, 963, 964, 965, 966, 967, 968, 969, 970, 971, 972, 973, 974, 975, 976, 977, 978, 979, 980, 981, 982, 983, 984, 985, 986, 987, 988, 989, 990, 991, 992, 993, 994, 995, 996, 997, 998, 999, 1000.

8/17/99

PROJECT REFERENCE NO. <b>U-3100B</b>		SHEET NO. <b>EC-6/CONST.4</b>	
RW SHEET NO.		HYDRAULICS ENGINEER	
ROADWAY DESIGN ENGINEER		HYDRAULICS ENGINEER	

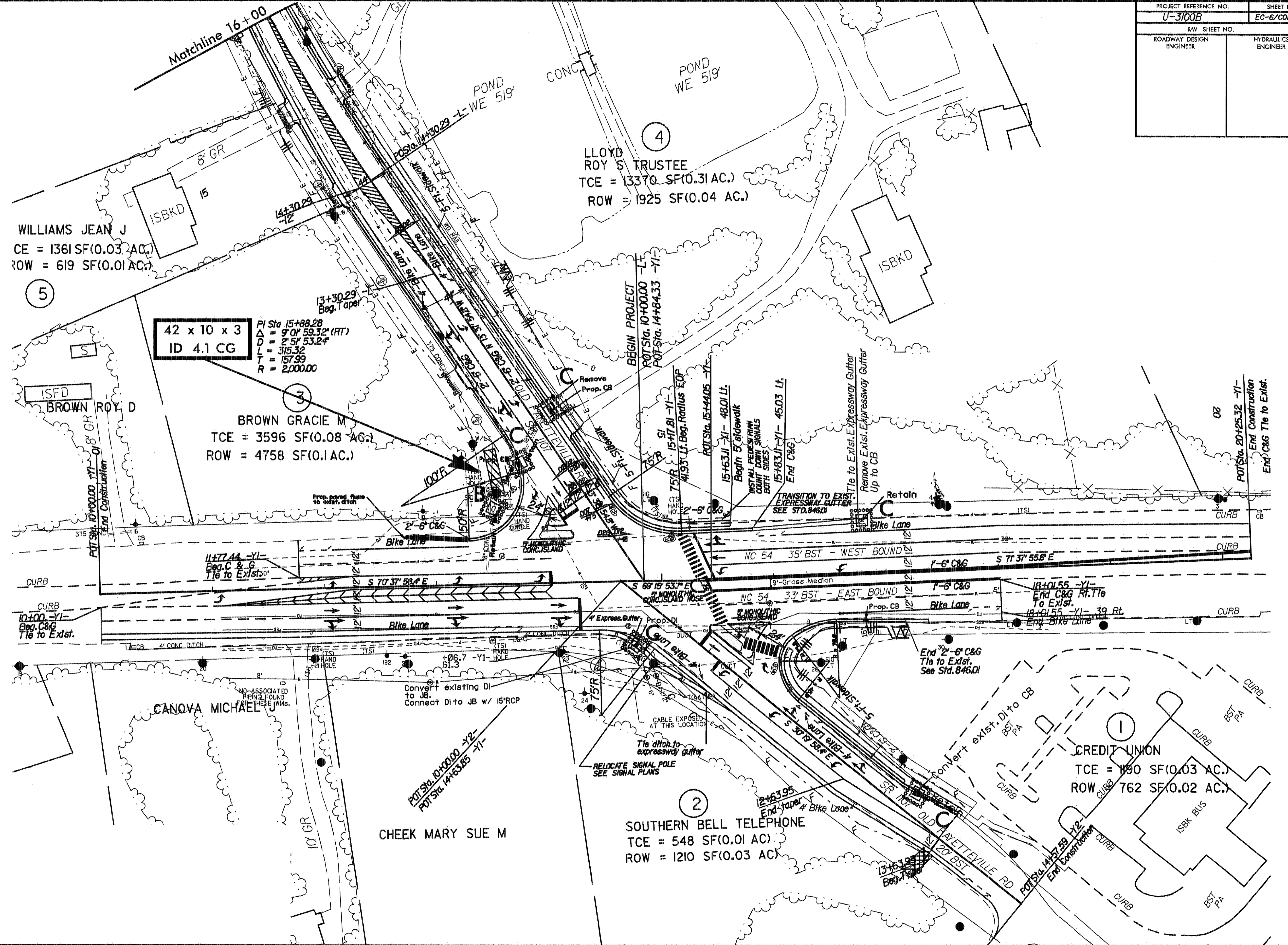

8/17/99



PROJECT REFERENCE NO. <b>U-3100B</b>	SHEET NO. <b>EC-7/CONST.5</b>
R/W SHEET NO.	
ROADWAY DESIGN ENGINEER	HYDRAULICS ENGINEER

ABAND  
B

COLLINS HOYT CLIFTON  
TCE = 1456 SF(0.03AC)  
PDE = 287 SF(0.01AC)

CHEEK MILTON HOLT  
TCE = 11022 SF(0.25AC)  
ROW = 56 SF(0.001AC)  
PDE = 655 SF(0.02AC)

NOTE: DI's are to be inside R/W or 5'x5' permanent drainage easement.  
NOTE: Pipe system associated with DI's to be located inside R/W or permanent drainage easement.

Typical Section Lateral 'V' Ditch Lt. Sta. + (-) 21+00 - 22+00

Lateral 'V' Ditch 21' sides, 1' min. depth see xs 21+00-22+00

Matchline 16+00

Matchline 27+00

LLOYD ROY S TRUSTEE  
TCE = 13370 SF(0.31AC.)  
ROW = 1925 SF(0.04 AC.)

CHARLES HAL CECIL  
TCE = 2287 SF(0.05 AC.)  
ROW = 561 SF(0.01 AC.)

GWALTNEY CLINTON  
TCE = 1529 SF(0.04AC.)  
PDE = 155 SF(0.004AC)

JENSEN HARRY M. JR.  
TCE = 972 SF(0.02AC.)  
PDE = 418 SF(0.01AC)

RAGAN CLARA MRS  
TCE = 2530 SF(0.06AC)

RAGAN BILLIE D  
TCE = 1276 SF(0.03AC)

KOKOT ANTON J

JENSEN HARRY M JR

SCHRAM RICHARD F

POND WE 510'

8/17/99

8/17/99

PROJECT REFERENCE NO. <b>U-3100B</b>	SHEET NO. <b>EC-8/CONST.6</b>
R/W SHEET NO.	
ROADWAY DESIGN ENGINEER	HYDRAULICS ENGINEER

POPLIN NORENA C  
TCE = 3896 SF(0.09AC)  
ROW = 2928 SF(0.07AC)

PI Sta 28+36.87 Δ = 1°13' 43.39" (RT) D = 1°08' 45.30" L = 107.23 T = 53.62 R = 5,000.00	PI Sta 30+60.04 Δ = 1°34' 22.38" (RT) D = 0°34' 22.65" L = 274.52 T = 137.27 R = 10,000.00
---	---

15  
CHEEK W TOY  
TCE = 1785 SF(0.04AC)

14  
CHEEK JESSIE B  
TCE = 7161 SF(0.16AC)  
PDE = 220 SF(0.01AC)

MATCH TO EXIST C&G STA.33+25.98 -L-  
END PROJECT STA.33+50.00 -L-

Matchline 27+00

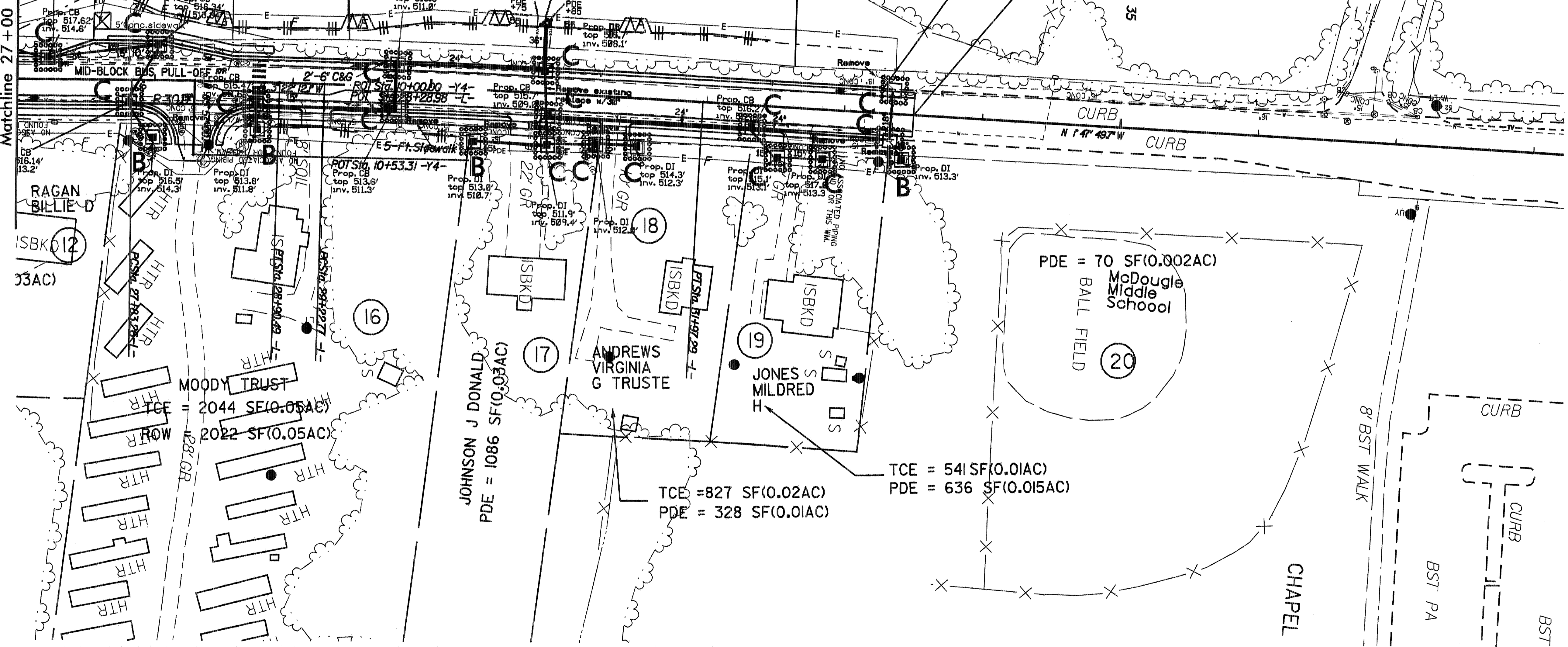

12  
RAGAN BILLIE D  
TCE = 2044 SF(0.05AC)  
ROW = 2022 SF(0.05AC)

17  
JOHNSON J DONALD  
PDE = 1086 SF(0.03AC)

18  
ANDREWS VIRGINIA G TRUSTE

TCE = 827 SF(0.02AC)  
PDE = 328 SF(0.01AC)

TCE = 541 SF(0.01AC)  
PDE = 636 SF(0.015AC)

PDE = 70 SF(0.002AC)  
McDougale Middle School  
BALL FIELD

CHAPEL

8' BST WALK

BST PA

BST