

09/08/99

15-OCT-2009 13:19
C:\Users\jhaugard\Documents\proj\15-09\15-09\15-09.dgn
\$\$\$\$\$USERNAME\$\$\$\$\$

TIP PROJECT: B-4465

STATE OF NORTH CAROLINA
DIVISION OF HIGHWAYS

T.I.P. NO.	SHEET NO.
B-4465	UC-1

**UTILITY CONSTRUCTION PLANS
CHOWAN COUNTY**

**LOCATION: SR-1208 OVER PEMBROKE CREEK
TYPE OF WORK: UTILITY RELOCATION**

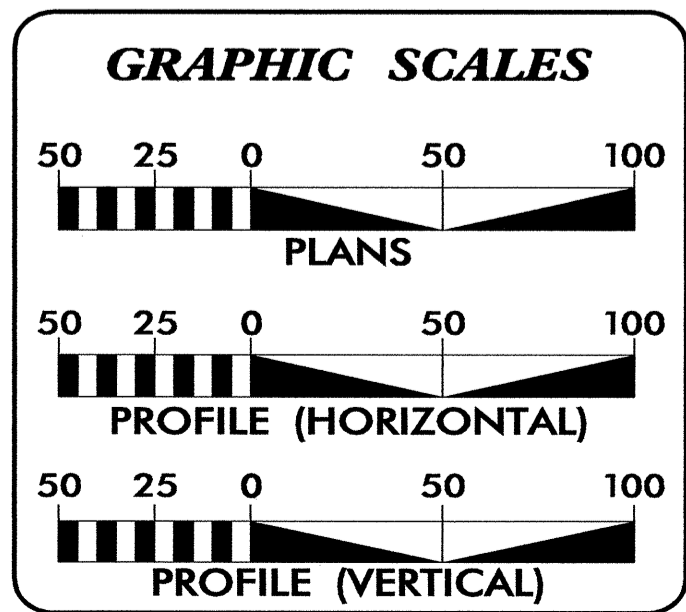
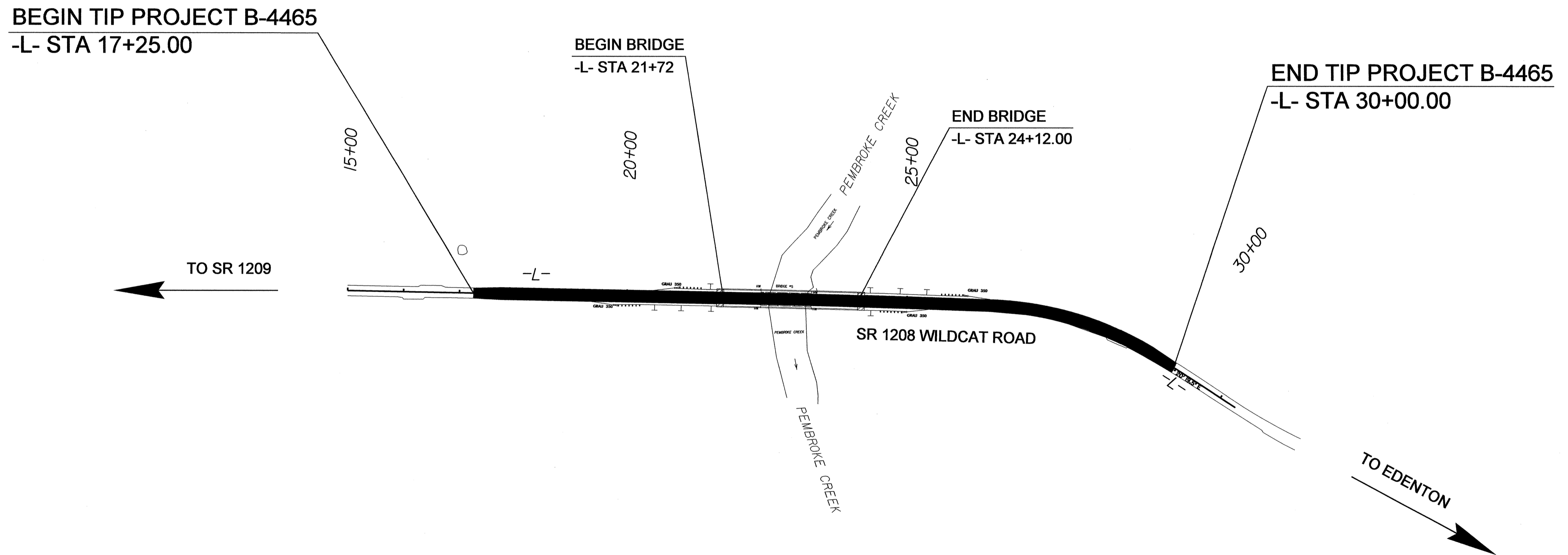

INDEX OF SHEETS

SHEET NO.	DESCRIPTION
UC-1	TITLE SHEET
UC-2	PLAN SHEET

WATER OWNER ON PROJECT

(1) WATER: CHOWAN COUNTY

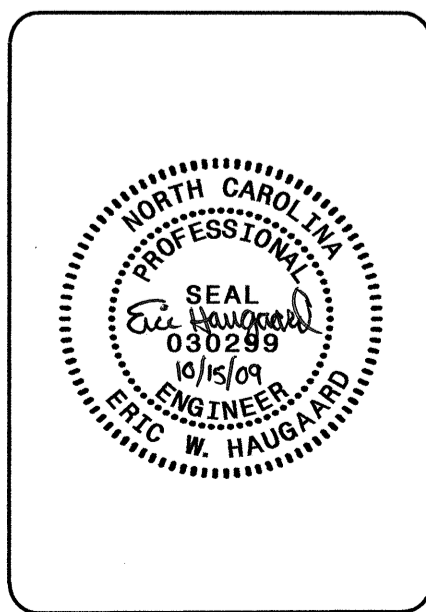

PREPARED IN THE OFFICE OF:
**DIVISION OF HIGHWAYS
UTILITIES ENGINEERING
SECTION**

1591 MAIL SERVICES CENTER
RALEIGH NC 27699-1591
PHONE (919) 259-4128
FAX (919) 250-4119

Roger Worthington, P.E. UTILITIES SECTION ENGINEER
Corey Bousquet, P.E. UTILITIES SQUAD LEADER PROJECT ENGINEER
Eric Haugaard, P.E. UTILITIES PROJECT DESIGNER

UTILITY CONSTRUCTION

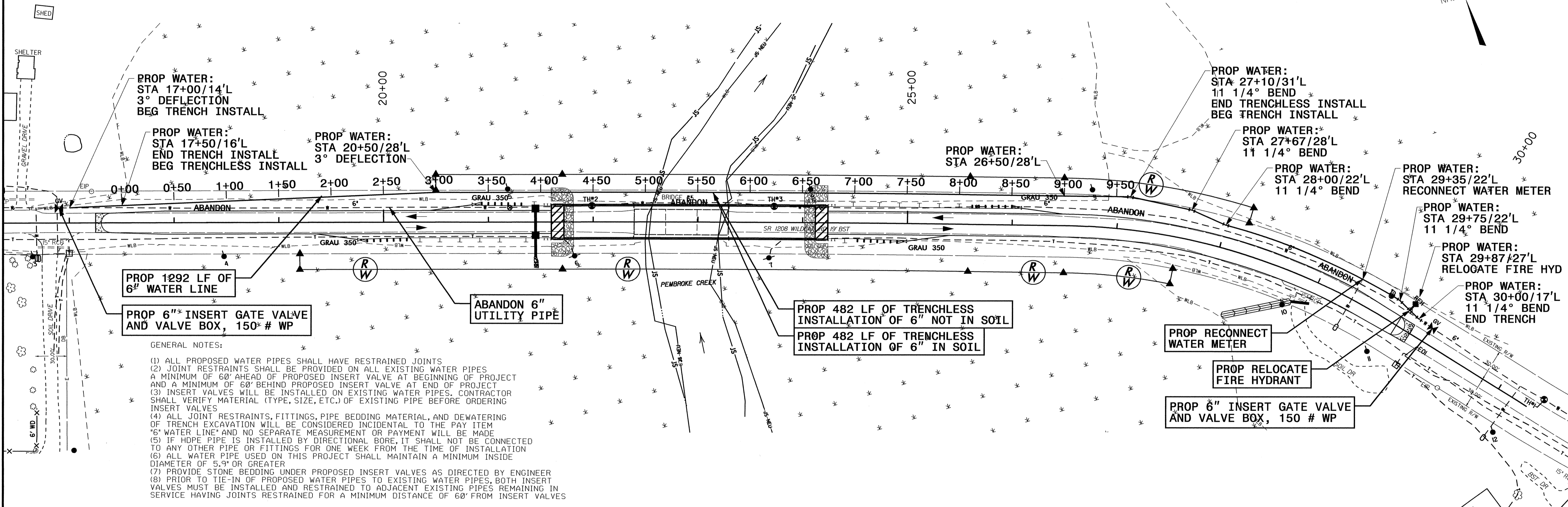
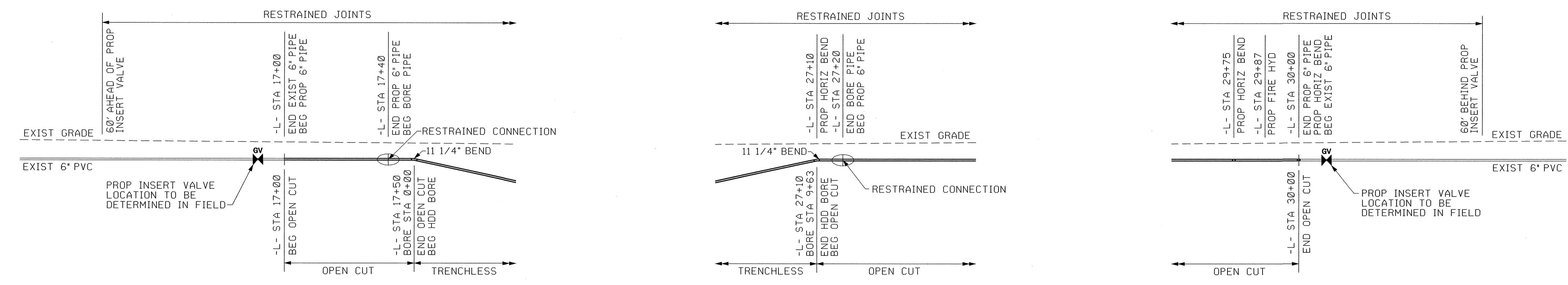

- GENERAL NOTES:**
- (1) ALL PROPOSED WATER PIPES SHALL HAVE RESTRAINED JOINTS
 - (2) JOINT RESTRAINTS SHALL BE PROVIDED ON ALL EXISTING WATER PIPES A MINIMUM OF 60' AHEAD OF PROPOSED INSERT VALVE AT BEGINNING OF PROJECT AND A MINIMUM OF 60' BEHIND PROPOSED INSERT VALVE AT END OF PROJECT
 - (3) INSERT VALVES WILL BE INSTALLED ON EXISTING WATER PIPES. CONTRACTOR SHALL VERIFY MATERIAL (TYPE, SIZE, ETC.) OF EXISTING PIPE BEFORE ORDERING INSERT VALVES
 - (4) ALL JOINT RESTRAINTS, FITTINGS, PIPE BEDDING MATERIAL, AND DEWATERING OF TRENCH EXCAVATION WILL BE CONSIDERED INCIDENTAL TO THE PAY ITEM "6\"/>

MAXIMUM TRENCH WIDTH AT TOP OF PIPE	
NOMINAL PIPE SIZE (INCHES)	TRENCH WIDTH (INCHES)
4	28
6	30
8	32
10	34
12	36
14	38
16	40
18	42

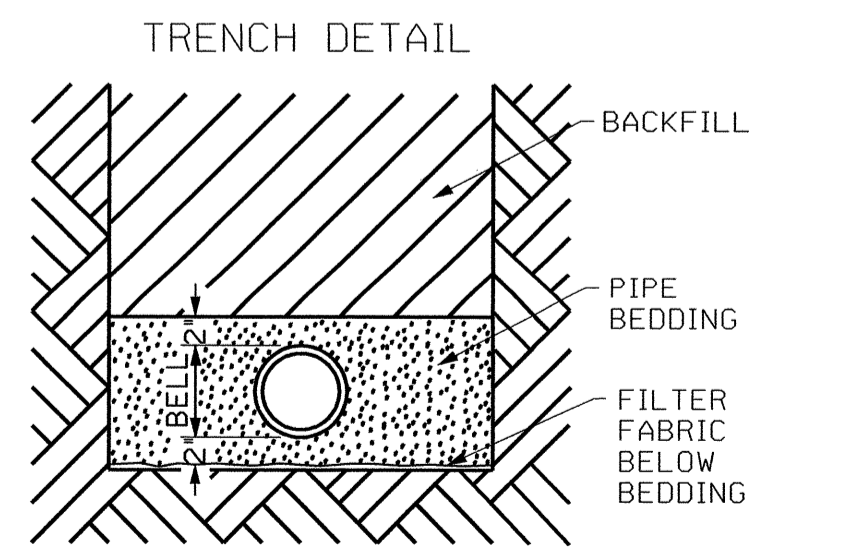
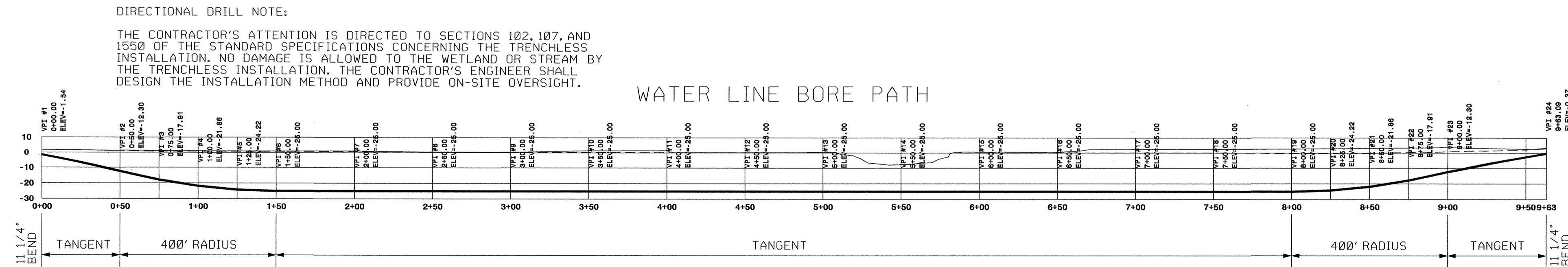

PLACE FOUNDATION CONDITIONING MATERIAL BELOW BEDDING IF REQUIRED, AS DIRECTED BY ENGINEER. PIPE BEDDED IN SELECT MATERIAL, CLASS IV. TRENCH BACKFILLED IN LOOSE 6\"/>

B-4465 (SR-1208 OVER PEMBROKE CREEK) WATER RELOCATION PLAN

09-DEC-2009, 17:11
t:\es\td\p\c\1208\B-4465_ehw_uc_plan_sheet (12-07-09).dgn

09/28/99

T.I.P. NO.	SHEET NO.
B-4465	UO-1

STATE OF NORTH CAROLINA
DIVISION OF HIGHWAYS

**UTILITIES BY OTHERS PLANS
CHOWAN COUNTY**

LOCATION: SR-1208 OVER PEMBROKE CREEK
TYPE OF WORK: UTILITY RELOCATION



TIP PROJECT: B-4465

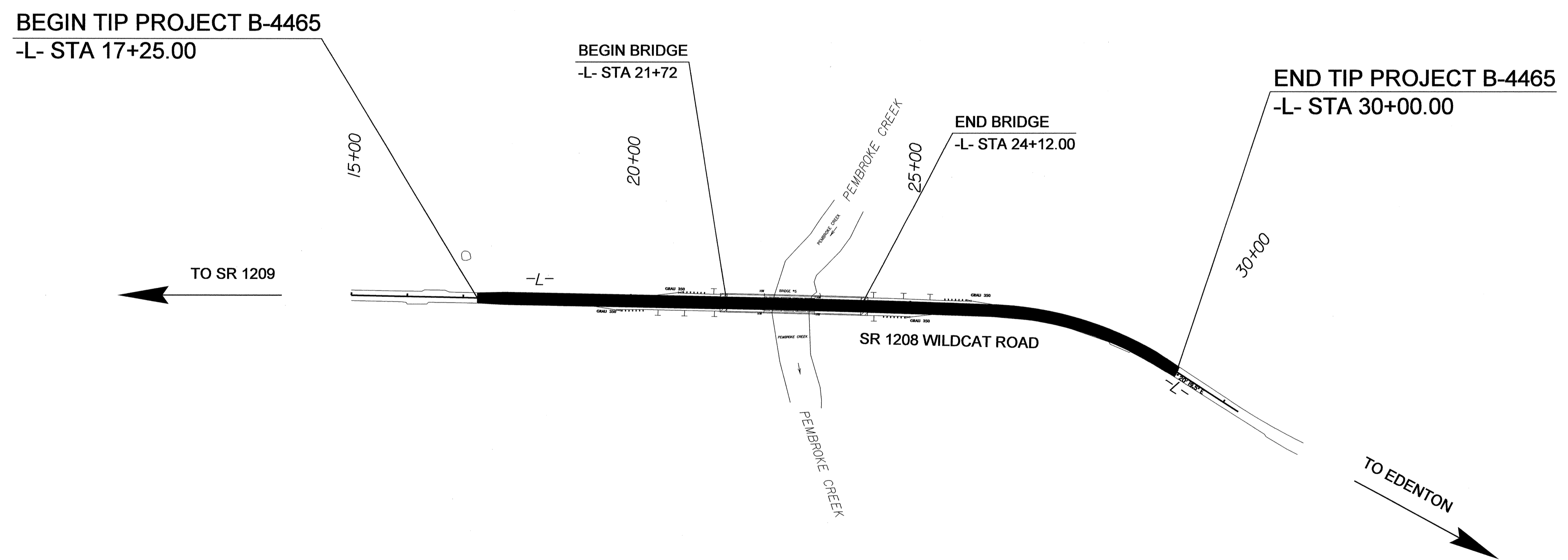

24-SEP-2009 09:22
Z:\UTILITIES\CHOWAN\proj\b-4465_ewh_ubo_title_sheet (09-24-09).dgn
\$\$\$\$\$USERNAME\$\$\$\$\$

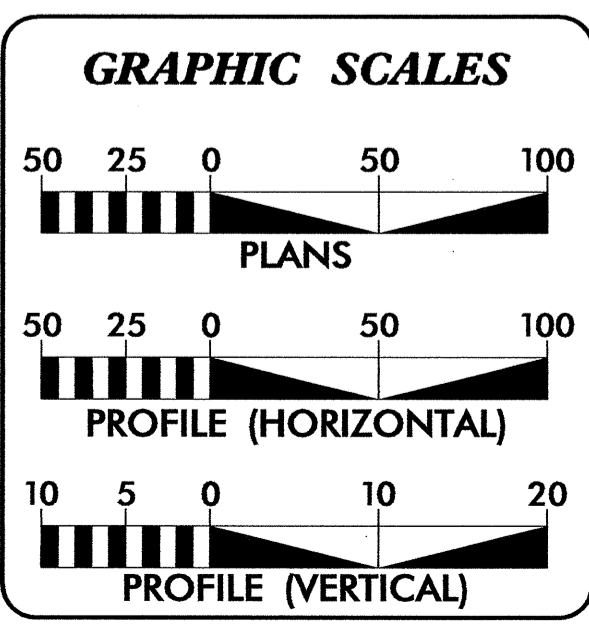

INDEX OF SHEETS

SHEET NO.	DESCRIPTION
UO-1	TITLE SHEET
UO-2	PLAN SHEET

UTILITY OWNERS ON PROJECT

(1) ALBEMARLE EMC: POWER
(2) EMBARQ TELEPHONE: TELEPHONE



PREPARED IN THE OFFICE OF:
**DIVISION OF HIGHWAYS
UTILITIES ENGINEERING
SECTION**

1591 MAIL SERVICES CENTER
RALEIGH NC 27699-1591
PHONE (919) 250-4128
FAX (919) 250-4119

Roger Worthington, P.E. UTILITIES SECTION ENGINEER
Corey Bousquet, P.E. UTILITIES SQUAD LEADER PROJECT ENGINEER
Eric Hangaard, P.E. UTILITIES PROJECT DESIGNER

B-4465 (SR-1208 OVER POLLOCK SWAMP) POWER AND TELEPHONE RELOCATION PLAN

UTILITIES BY OTHERS

NOTE:
ALL PROPOSED UTILITY WORK
SHOWN ON THIS SHEET WILL
BE DONE BY OTHERS

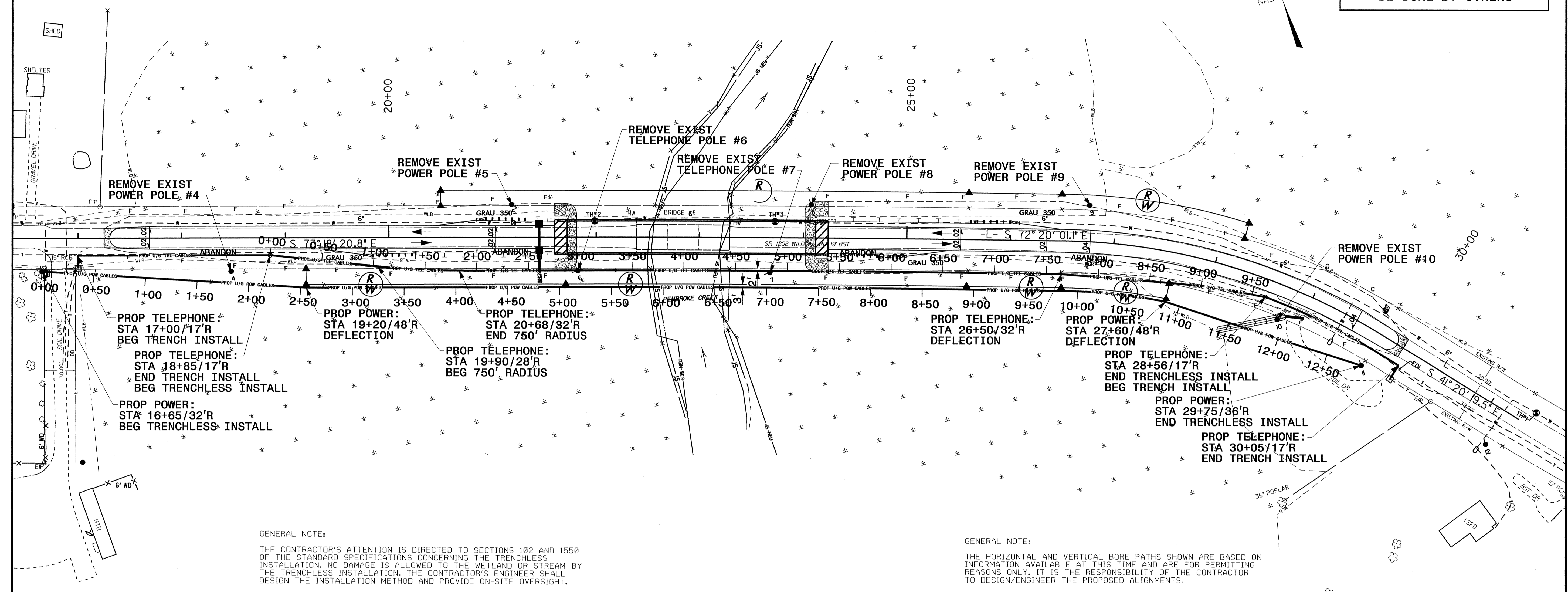

GENERAL NOTE:
THE CONTRACTOR'S ATTENTION IS DIRECTED TO SECTIONS 102 AND 1550 OF THE STANDARD SPECIFICATIONS CONCERNING THE TRENCHLESS INSTALLATION. NO DAMAGE IS ALLOWED TO THE WETLAND OR STREAM BY THE TRENCHLESS INSTALLATION. THE CONTRACTOR'S ENGINEER SHALL DESIGN THE INSTALLATION METHOD AND PROVIDE ON-SITE OVERSIGHT.

GENERAL NOTE:
THE HORIZONTAL AND VERTICAL BORE PATHS SHOWN ARE BASED ON INFORMATION AVAILABLE AT THIS TIME AND ARE FOR PERMITTING REASONS ONLY. IT IS THE RESPONSIBILITY OF THE CONTRACTOR TO DESIGN/ENGINEER THE PROPOSED ALIGNMENTS.

TELEPHONE LINE BORE PROFILE

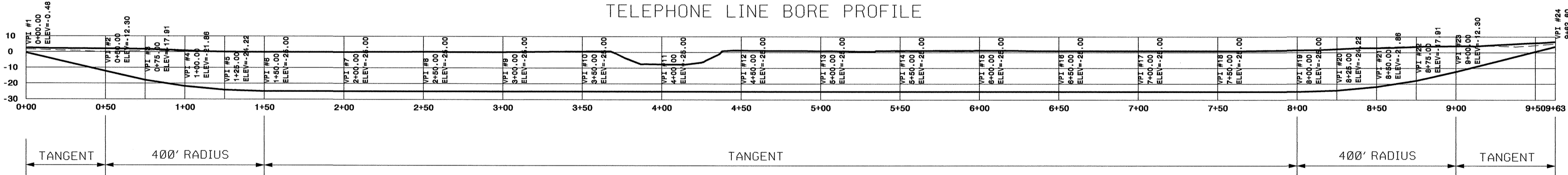

POWER LINE BORE PROFILE

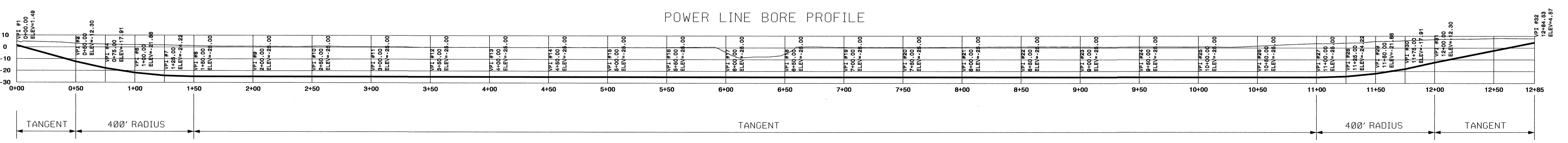

NOTE: 50 YEAR SCOUR ELEVATION = -18 BELOW MEAN SEA LEVEL
NOTE: MAXIMUM DEPTH OF BORE ESTABLISHED FROM SOIL BORINGS

5/14/99
24-SEP-2009 09:20
litte\y-dh\ut\proj\B-4465_ewh\bo-plans\09-24-09.dgn