

09/28/09

See Sheet 1-A For Index of Sheets

T.I.P. NO.	SHEET NO.
B-4646	UO-1

TIP PROJECT: B-4646

STATE OF NORTH CAROLINA
DIVISION OF HIGHWAYS

**UTILITY BY OTHERS PLANS
SURRY COUNTY**

LOCATION: BRIDGE NO. 132 ON SR 2024 OVER TOMS CREEK

TYPE OF WORK: UTILITY RELOCATION

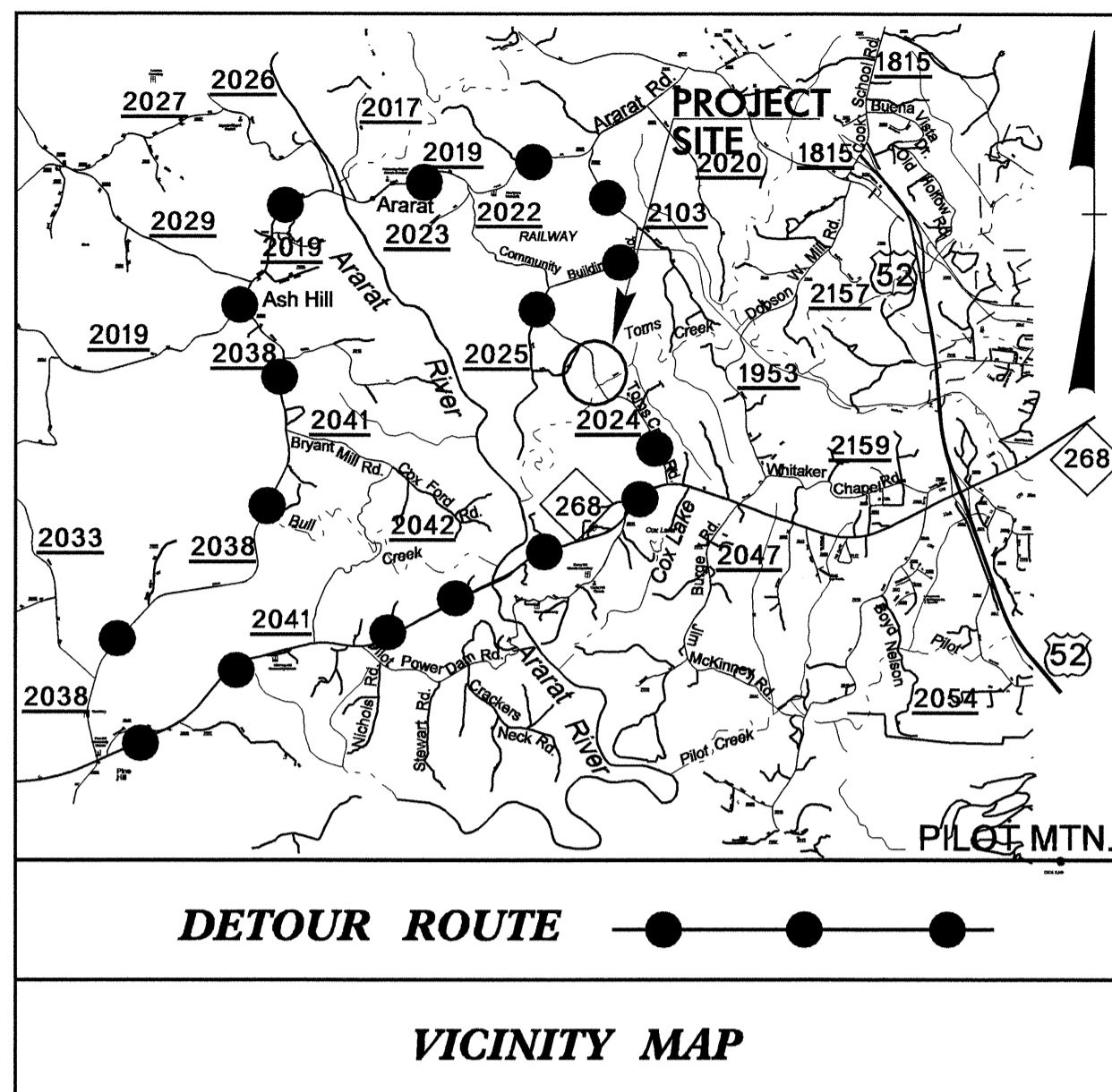

-L- STA. 16+00.00 BEGIN TIP PROJECT B-4646

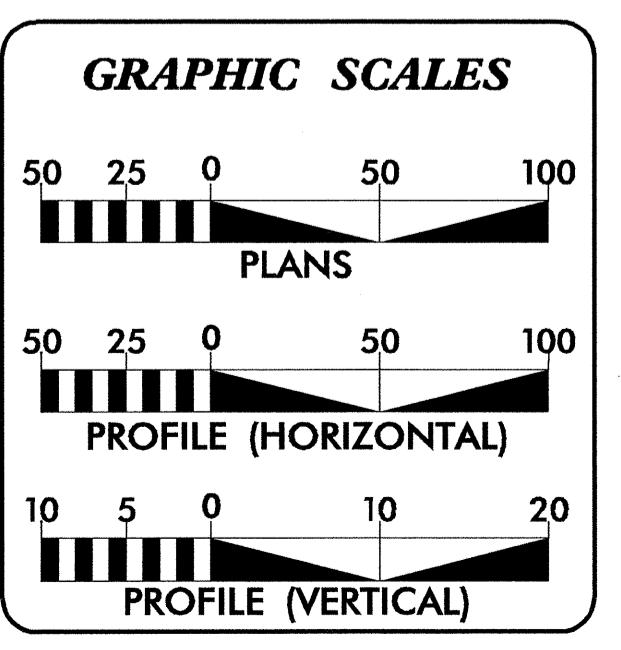
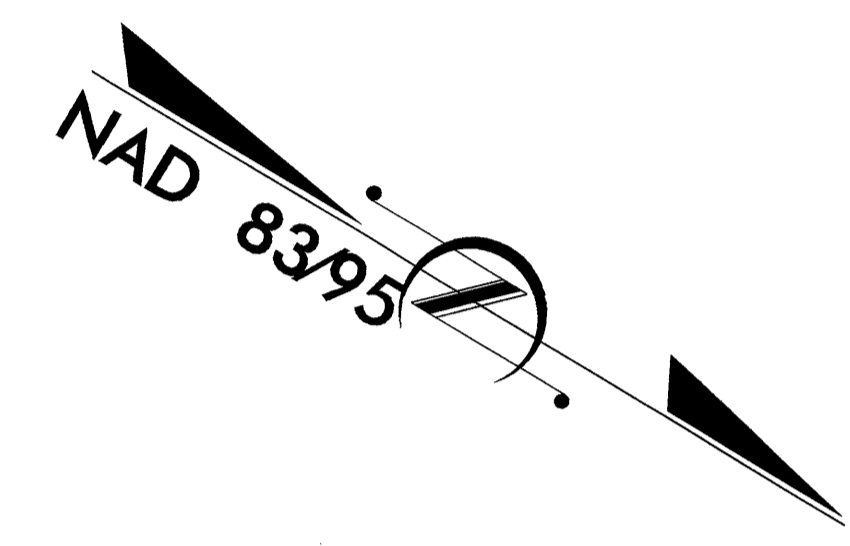
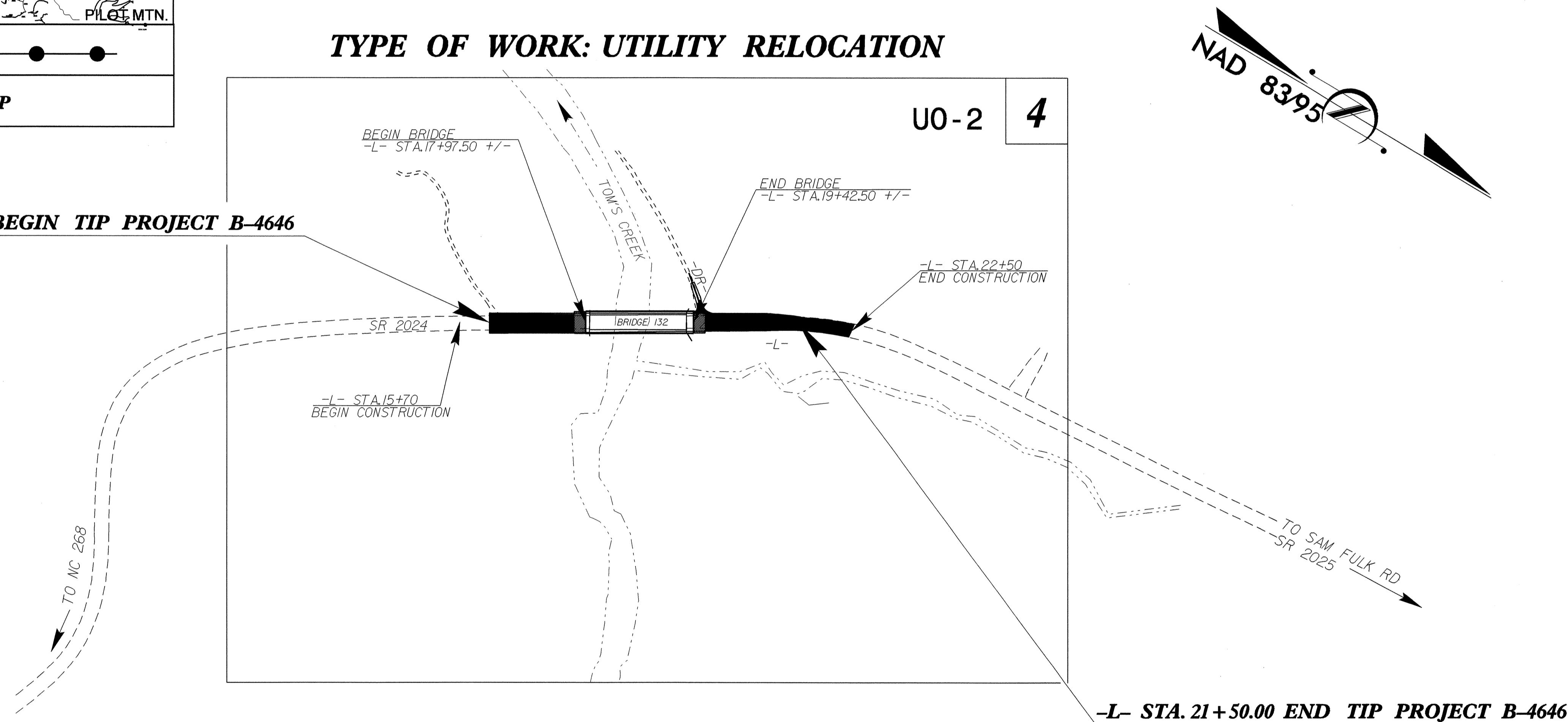

INDEX OF SHEETS

SHEET NO.	DESCRIPTION
UO-1	TITLE SHEET
UO-2	UTILITY BY OTHERS PLAN SHEETS

UTILITY OWNERS ON PROJECT

- (1) Surry Yadkin EMC
- (2) Surry TMC

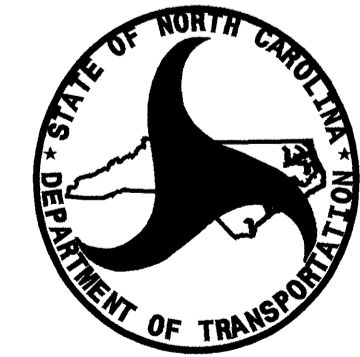

PREPARED IN THE OFFICE OF:
**DIVISION OF HIGHWAYS
DESIGN SERVICES
UTILITY SECTION**

1591 MAIL SERVICES CENTER
RALEIGH NC 27699-1591
PHONE (919) 250-4128
FAX (919) 250-4119

Roger Worthington, P.E. UTILITIES SECTION ENGINEER
Corey Bousquet, P.E. UTILITIES SQUAD LEADER PROJECT ENGINEER
Stephanie Athey UTILITIES PROJECT DESIGNER

12-AUG-2008 13:30
F:\utilities\proj\ut\proj\B4646-ut_uo_tsh.dgn
USER:NAME

UTILITIES BY OTHERS

NOTE:
ALL PROPOSED UTILITY WORK
SHOWN ON THIS SHEET WILL
BE DONE BY OTHERS

FOR PROFILE OF LINE -L- & -DR-
SEE SHEET 5

FOR STRUCTURE PLANS
SEE SHEET S-1 THRU ??

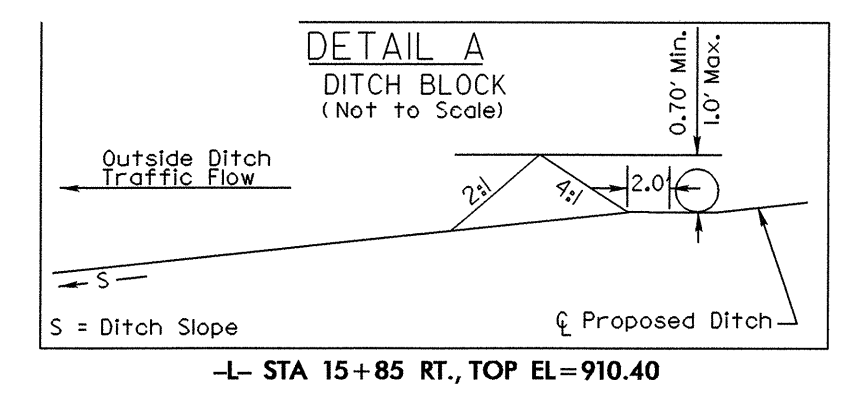
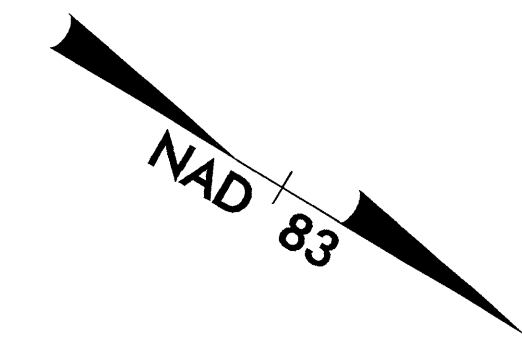

-L-		
PI Sta 12+06.56 Δ = 73°15'49.9" (RT) D = 35'48'35.5" L = 204.59' T = 118.96' R = 160.00' e = EXISTING	PI Sta 13+60.33 Δ = 9°58'10.9" (RT) D = 20'06'13.6" L = 49.59' T = 24.86' R = 285.00' e = EXISTING	PI Sta 15+42.26 Δ = 5°02'01.8" (RT) D = 3°00'56.0" L = 166.93' T = 83.52' R = 1,900.00' e = SEE PLANS

-L-
PI Sta 21+56.05 Δ = 26°25'35.1" (RT) D = 11°27'33.0" L = 230.61' T = 117.40' R = 500.00' e = SEE PLANS

-DR-
PI Sta 10+54.39 Δ = 8°55'19.7" (RT) D = 76°23'39.7" L = 11.68' T = 5.85' R = 75.00'

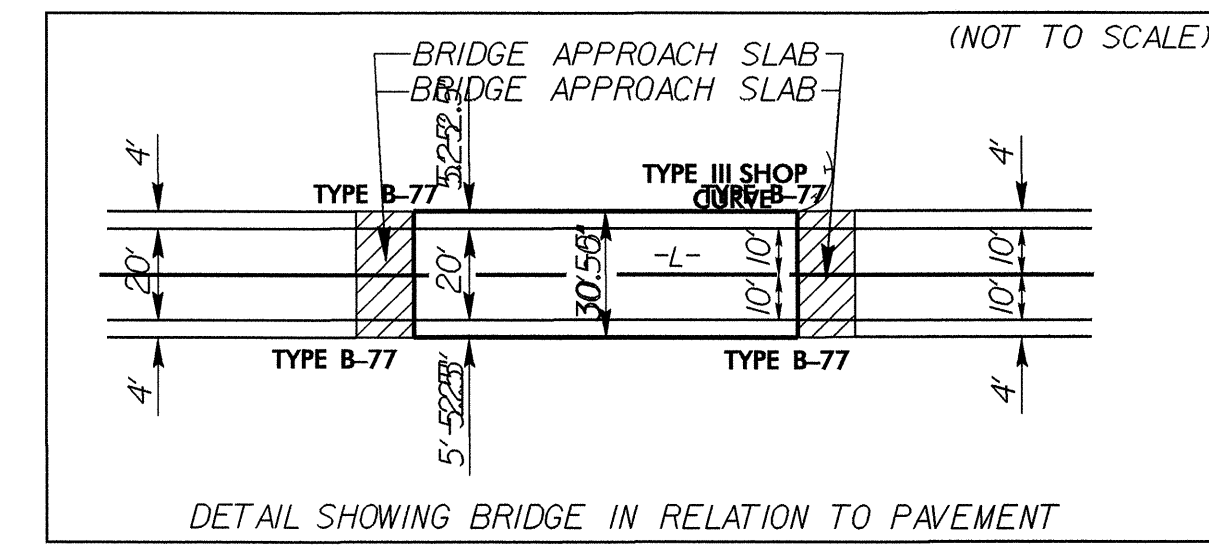
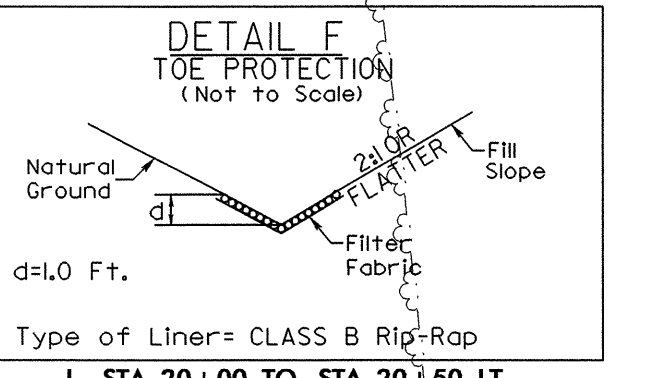
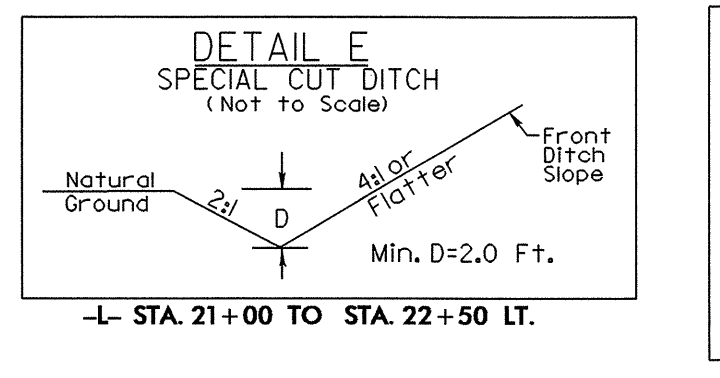
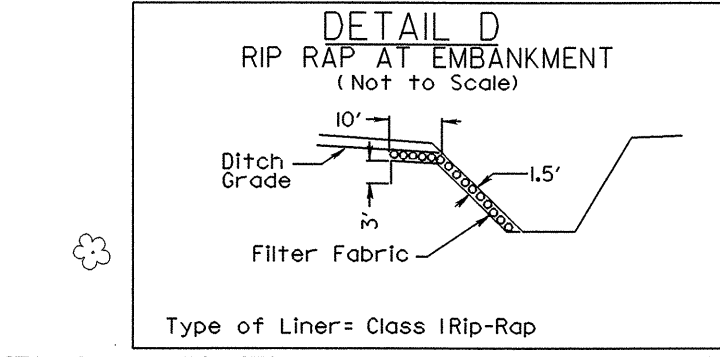
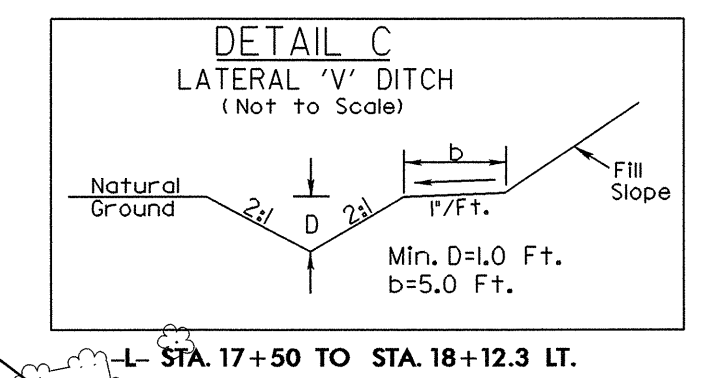
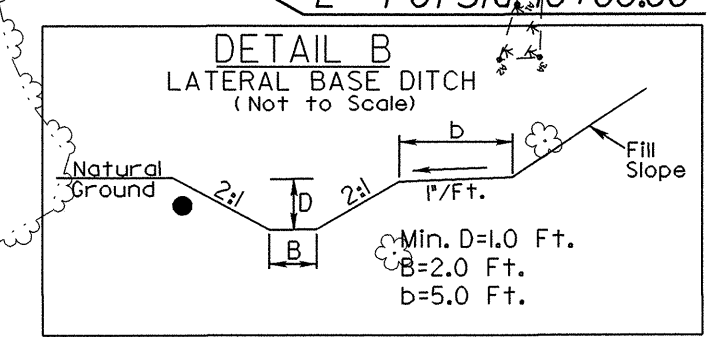
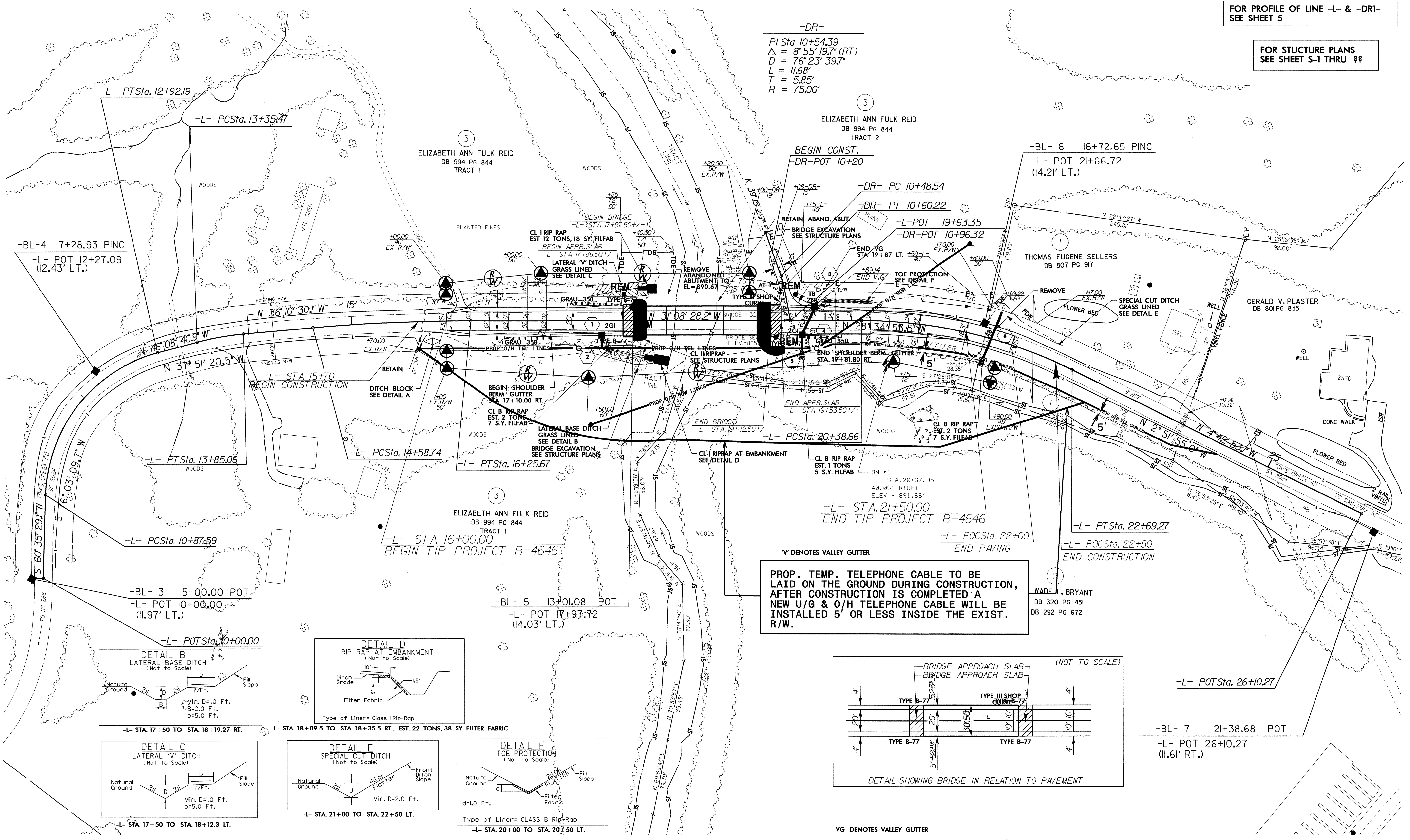

5/14/99
12-AUG-2008 13:24
\\s01\proj\B-4646\rdj\psh4.dgn