

NOTE: USE COLD APPLIED TAPE, TYPE III FOR BRIDGE PAVEMENT MARKINGS.

PAVEMENT MARKING SCHEDULE	
PAVEMENT MARKING LINES	
CA	COLD APPLIED TAPE, TYPE III WHITE EDGELINE
CB	COLD APPLIED TAPE, TYPE III YELLOW EDGELINE
CC	COLD APPLIED TAPE, TYPE III 10' WHITE SKIP LINE
TA	THERMOPLASTIC WHITE EDGELINE (4", 90 MILS)
TB	THERMOPLASTIC YELLOW EDGELINE (4", 90 MILS)
TC	THERMOPLASTIC 10' WHITE SKIP LINE (4", 120 MILS)
TD	THERMOPLASTIC 2' WHITE MINISKIP (4", 120 MILS)
TE	THERMOPLASTIC WHITE SOLID LANE LINE (4", 120 MILS)
TP	THERMOPLASTIC WHITE GORE LINE (8", 90 MILS)
TI	THERMOPLASTIC YELLOW DOUBLE CENTER LINE (4", 120 MILS)
TT	THERMOPLASTIC YELLOW DIAGONAL (8", 90 MILS)
T2	THERMOPLASTIC WHITE STOP BAR (24", 120 MILS)
PAVEMENT MARKING SYMBOLS	
UA	THERMOPLASTIC LEFT TURN ARROW (90 MILS)
UB	THERMOPLASTIC RIGHT TURN ARROW (90 MILS)
UC	THERMOPLASTIC STRAIGHT ARROW (90 MILS)
UD	THERMOPLASTIC COMBINATION STRAIGHT/LEFT TURN ARROW (90 MILS)
UE	THERMOPLASTIC COMBINATION STRAIGHT/RIGHT TURN ARROW (90 MILS)
UF	THERMOPLASTIC COMBINATION LEFT/RIGHT TURN ARROW (90 MILS)
UG	THERMOPLASTIC COMBINATION STRAIGHT/LEFT/RIGHT TURN ARROW (90 MILS)
UH	THERMOPLASTIC YIELD TRIANGLE (2' BASE, 3' HEIGHT, 90 MILS)
U2	BIKE LANE SYMBOL (90 MILS)
U3	BIKE LANE ARROW (90 MILS)

SEE NCDOT STD. DRAWINGS FOR PAVT. MARKINGS

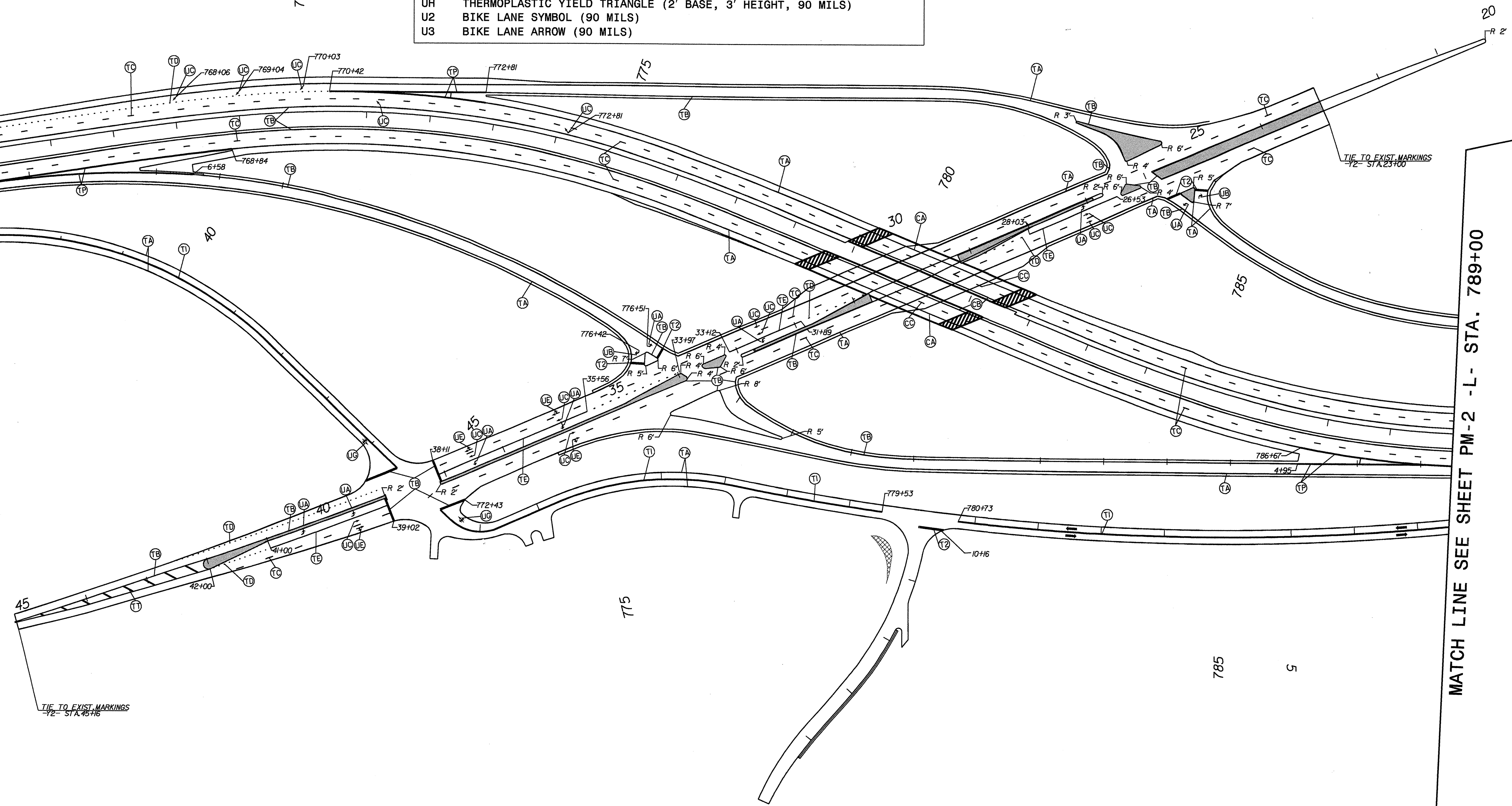

MATCH LINE SEE SHEET PM-2 -L- STA. 789+00

05-JAN-2009 13:56:58 R-505 Tr-offic\Signing\RS05_rdy_pm_s08.dgn
Combs CA W-CHL-CWO



PB AMERICAS
909 AVIATION PARKWAY
SUITE 1500
MORRISVILLE, NC 27560

APPROVED: *[Signature]* DATE: 1/5/08

PAVEMENT MARKING PLAN

SCALE:	NONE	REVISIONS
DATE:	7/25/08	
DWG. BY:	RCC	
DESIGN BY:	RCC	
REVIEWED BY:	DHB	

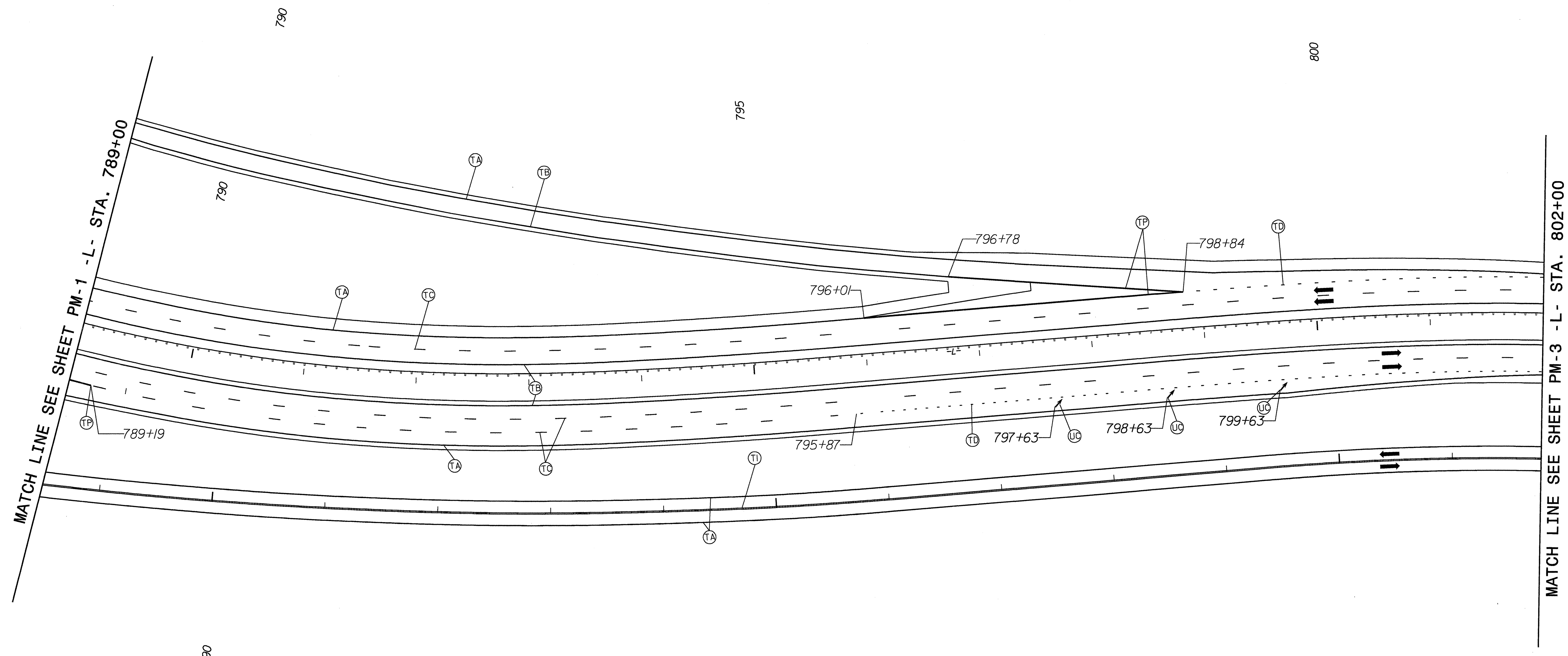
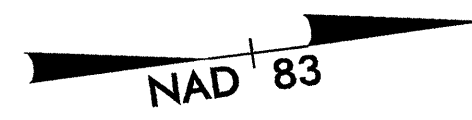

PAVEMENT MARKING SCHEDULE	
PAVEMENT MARKING LINES	
TA	THERMOPLASTIC WHITE EDGELINE (4", 90 MILS)
TB	THERMOPLASTIC YELLOW EDGELINE (4", 90 MILS)
TC	THERMOPLASTIC 10' WHITE SKIP LINE (4", 120 MILS)
TD	THERMOPLASTIC 2' WHITE MINISKIP (4", 120 MILS)
TE	THERMOPLASTIC WHITE SOLID LANE LINE (4", 120 MILS)
TP	THERMOPLASTIC WHITE GORE LINE (8", 90 MILS)
TI	THERMOPLASTIC YELLOW DOUBLE CENTER LINE (4", 120 MILS)
TT	THERMOPLASTIC YELLOW DIAGONAL (8", 90 MILS)
T2	THERMOPLASTIC WHITE STOP BAR (24", 120 MILS)
PAVEMENT MARKING SYMBOLS	
UA	THERMOPLASTIC LEFT TURN ARROW (90 MILS)
UB	THERMOPLASTIC RIGHT TURN ARROW (90 MILS)
UC	THERMOPLASTIC STRAIGHT ARROW (90 MILS)
UD	THERMOPLASTIC COMBINATION STRAIGHT/LEFT TURN ARROW (90 MILS)
UE	THERMOPLASTIC COMBINATION STRAIGHT/RIGHT TURN ARROW (90 MILS)
UF	THERMOPLASTIC COMBINATION LEFT/RIGHT TURN ARROW (90 MILS)
UG	THERMOPLASTIC COMBINATION STRAIGHT/LEFT/RIGHT TURN ARROW (90 MILS)
UH	THERMOPLASTIC YIELD TRIANGLE (2' BASE, 3' HEIGHT, 90 MILS)
U2	BIKE LANE SYMBOL (90 MILS)
U3	BIKE LANE ARROW (90 MILS)

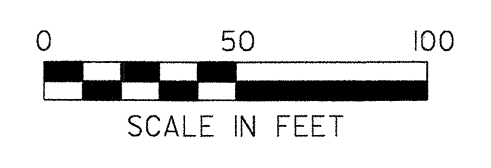

PB AMERICAS
 909 AVIATION PARKWAY
 SUITE 1500
 MORRISVILLE, NC 27560

APPROVED: *[Signature]* DATE: 1/6/08

PAVEMENT MARKING PLAN		REVISIONS
SCALE:	NONE	
DATE:	7/25/08	
DWG. BY:	RCC	
DESIGN BY:	RCC	
REVIEWED BY:	DHB	

05-JAN-2009 13:56 C:\Projects\505-Traffic\Signing\RS05_rdy_pm.s08.dgn
 Combs AT WCHL-C101

