

STATE OF NORTH CAROLINA
DIVISION OF HIGHWAYS

**UTILITY CONSTRUCTION PLANS
WARREN COUNTY**

**LOCATION: BRIDGE NO. 20 OVER FISHING CREEK
ON SR 1100 (MANSON-AXTELL ROAD)**

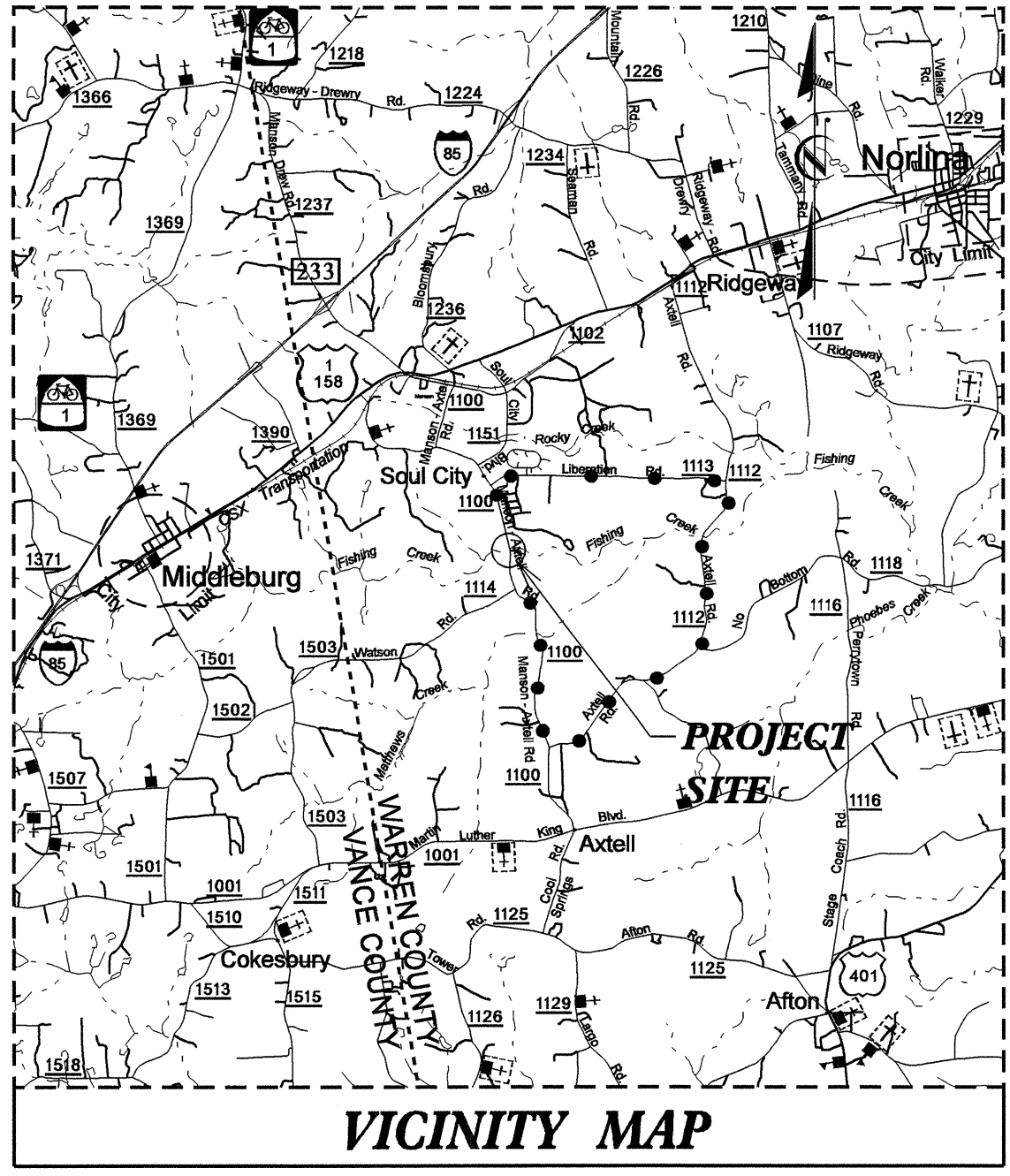

OFFSITE DETOUR ROUTE —●—●—●—●—
THIS PROJECT IS NOT WITHIN ANY
MUNICIPAL BOUNDARIES.

TYPE OF WORK: UTILITIES

UC-2
4
25+00

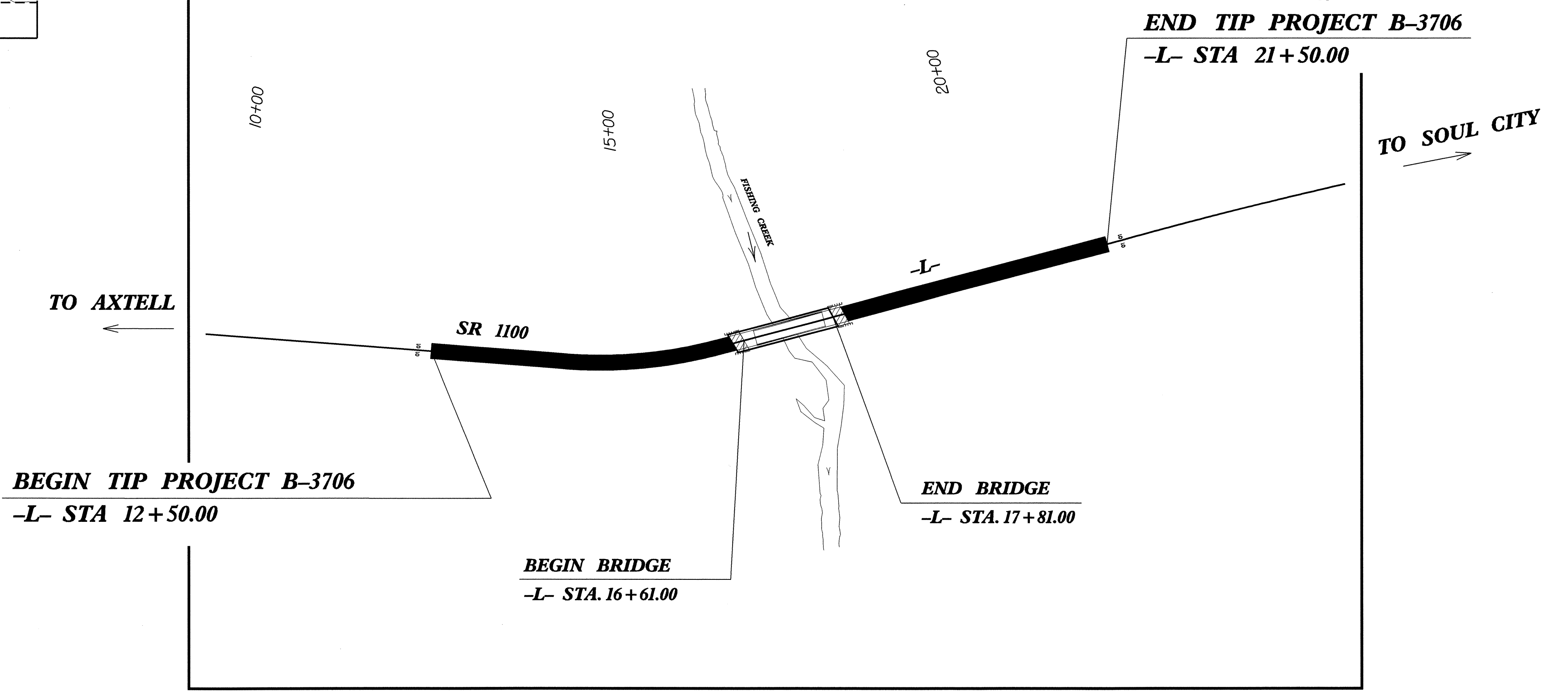

TIP B-3706

INDEX OF SHEETS	
SHEET NO.	DESCRIPTION
UC-1	TITLE SHEET
UC-2	UTILITY CONSTRUCTION PLAN SHEET
UC-3	DETAILS SHEET

WATER AND SEWER OWNERS ON PROJECT

(1) WARREN COUNTY PUBLIC WORKS

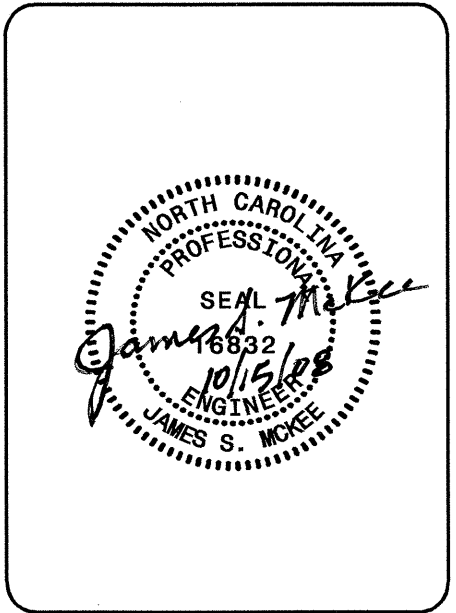

PREPARED IN THE OFFICE OF:
**DIVISION OF HIGHWAYS
UTILITIES ENGINEERING
SECTION**

1591 MAIL SERVICES CENTER
RALEIGH, NC 27699-1591
PHONE (919) 250-4128
FAX (919) 250-4119

Roger Worthington, P.E. UTILITIES SECTION ENGINEER
Steve Mckee, P.E. UTILITIES SQUAD LEADER PROJECT ENGINEER
Alonza Yancey UTILITIES PROJECT DESIGNER

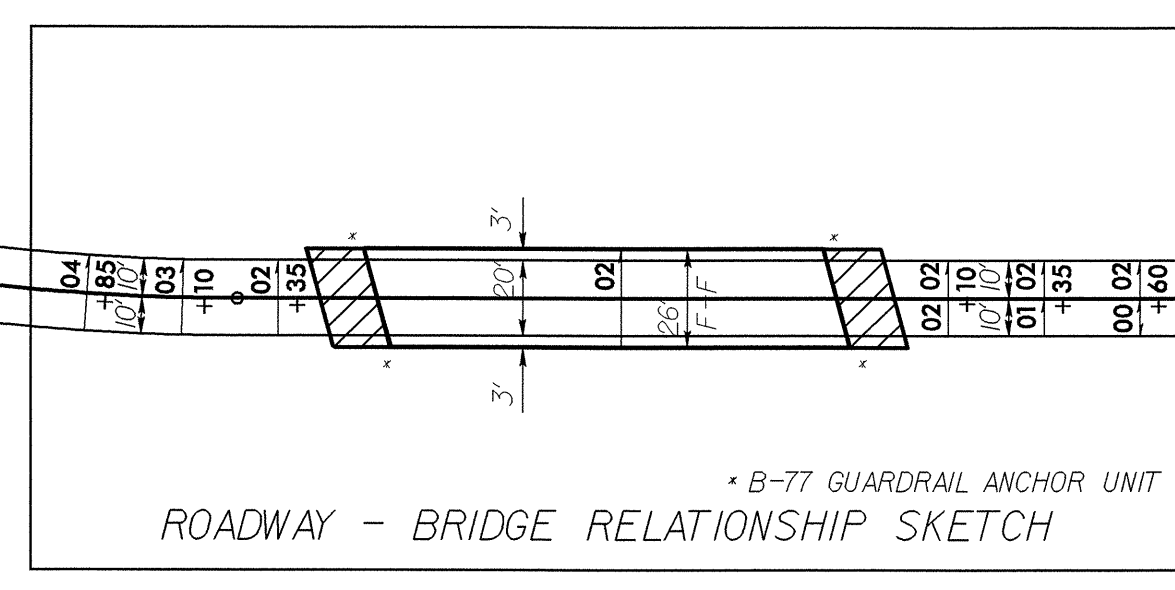
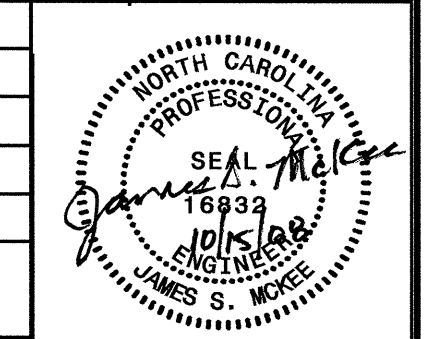

PI Sta 15+25.26 Δ = 19° 06' 29.8" (LT)
 D = 32° 57.5'
 L = 200.10'
 T = 100.99'
 *R = 600.00'
 SE = .04
 DS = 40 mph

PI Sta 22+71.61 Δ = 2° 23' 59.4" (RT)
 D = 1° 03' 39.7'
 L = 226.18'
 T = 113.11'
 R = 5,400.00'

* DESIGN EXCEPTION REQUIRED

UTILITY CONSTRUCTION

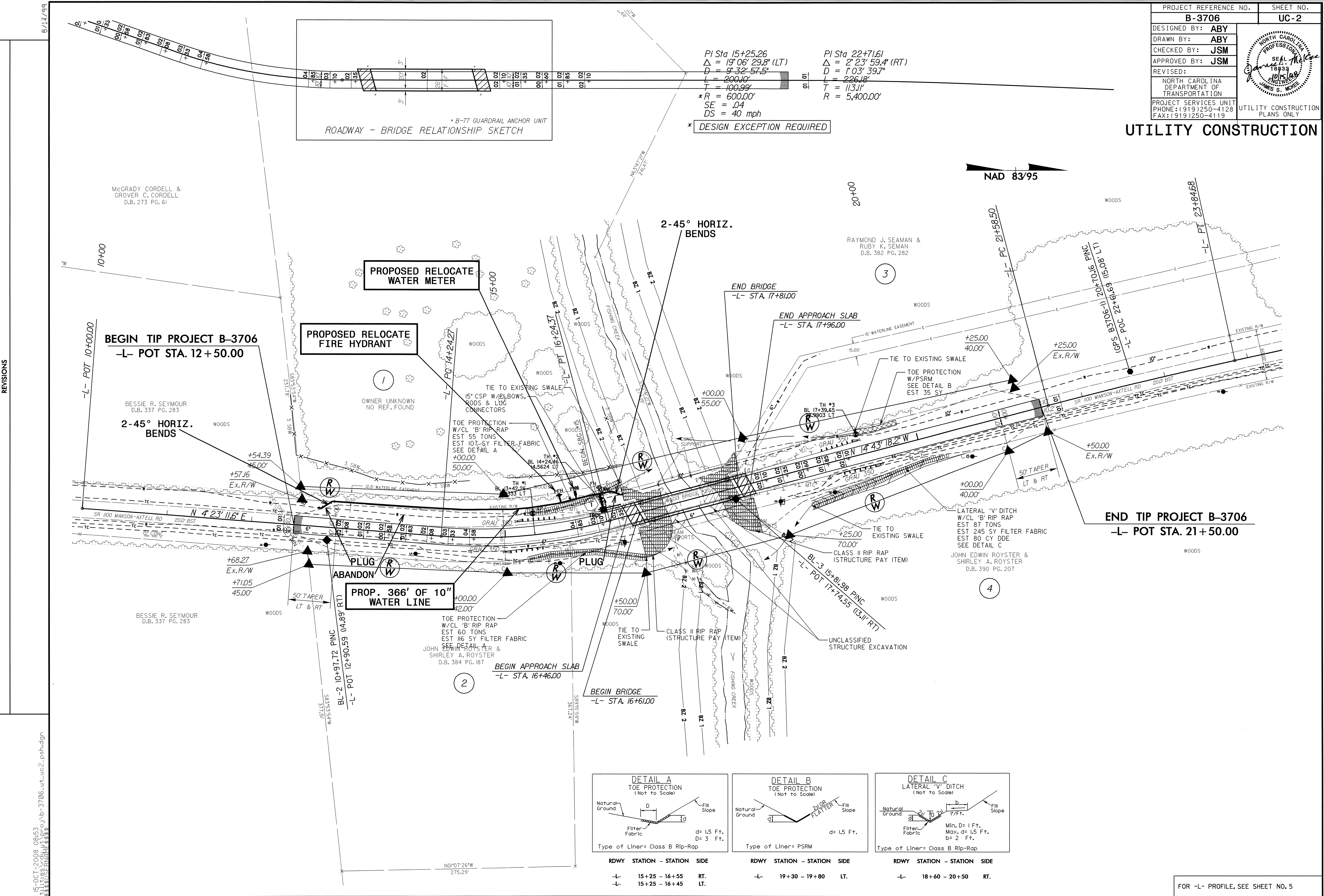

REVISIONS

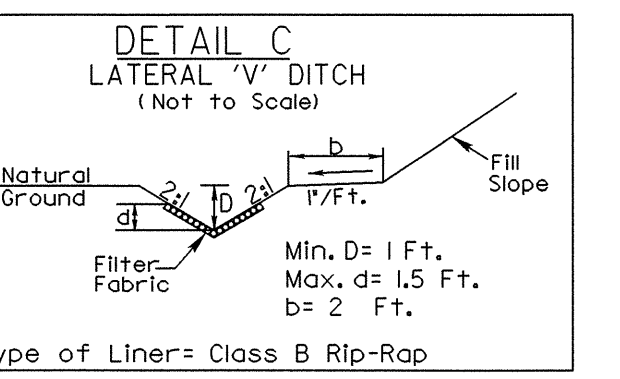
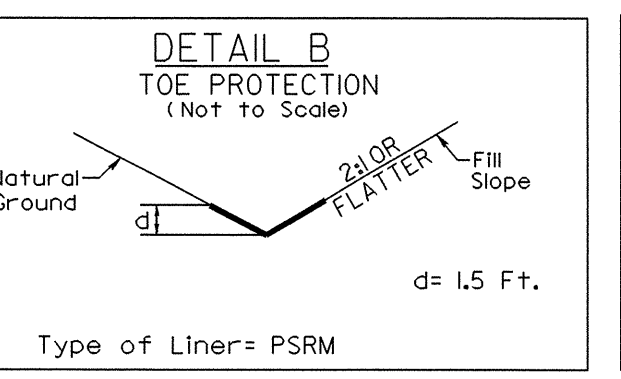
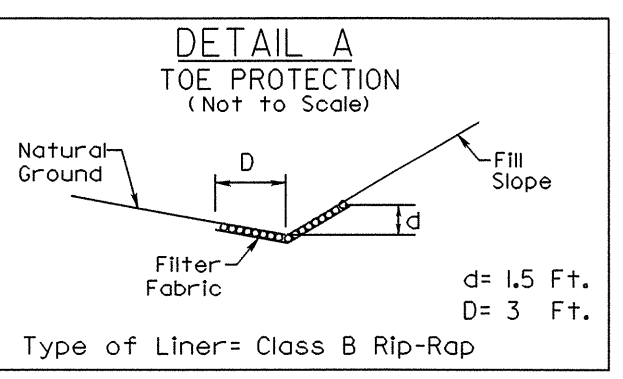

FOR -L- PROFILE, SEE SHEET NO. 5

15-OCT-2008 08:53
 P:\06\3706\utility\B-3706-ut.uc2.psh.dgn

UTILITY CONSTRUCTION

**MAXIMUM TRENCH WIDTH
AT TOP OF PIPE**

NOMINAL PIPE SIZE (INCHES)	TRENCH WIDTH (INCHES)	NOMINAL PIPE SIZE (INCHES)	TRENCH WIDTH (INCHES)
4	28	20	44
6	30	24	48
8	32	30	54
10	34	36	60
12	36	42	66
14	38	48	72
16	40	54	78
18	42		

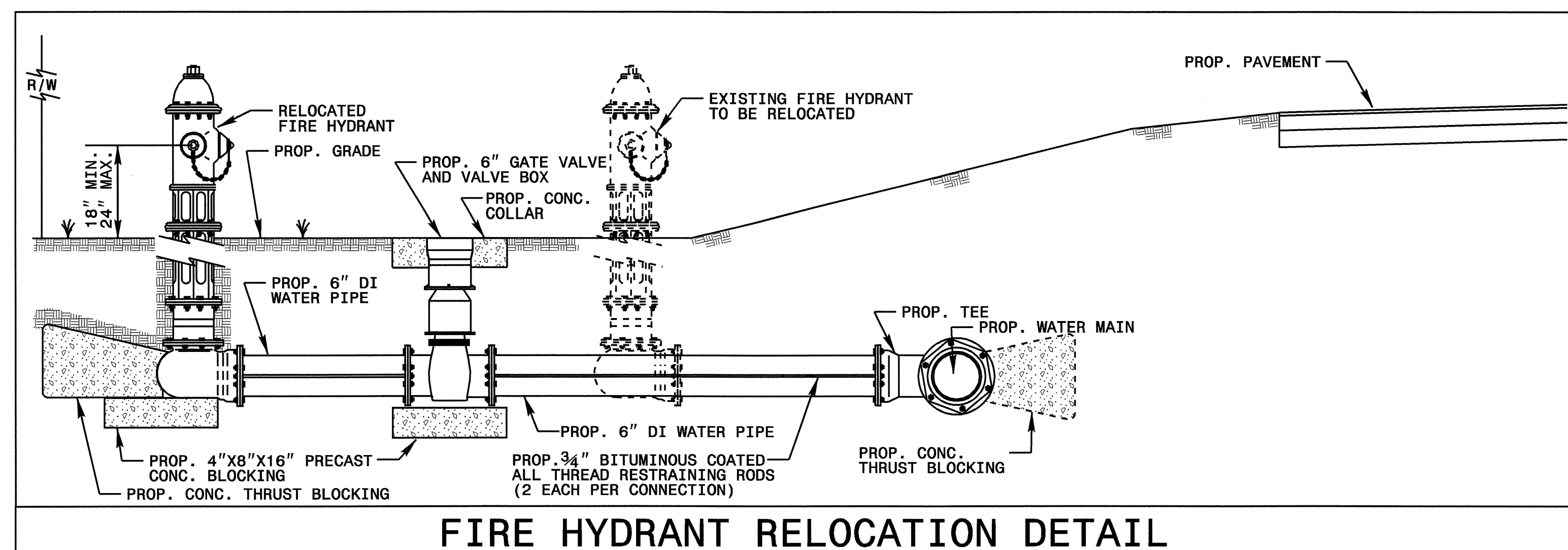
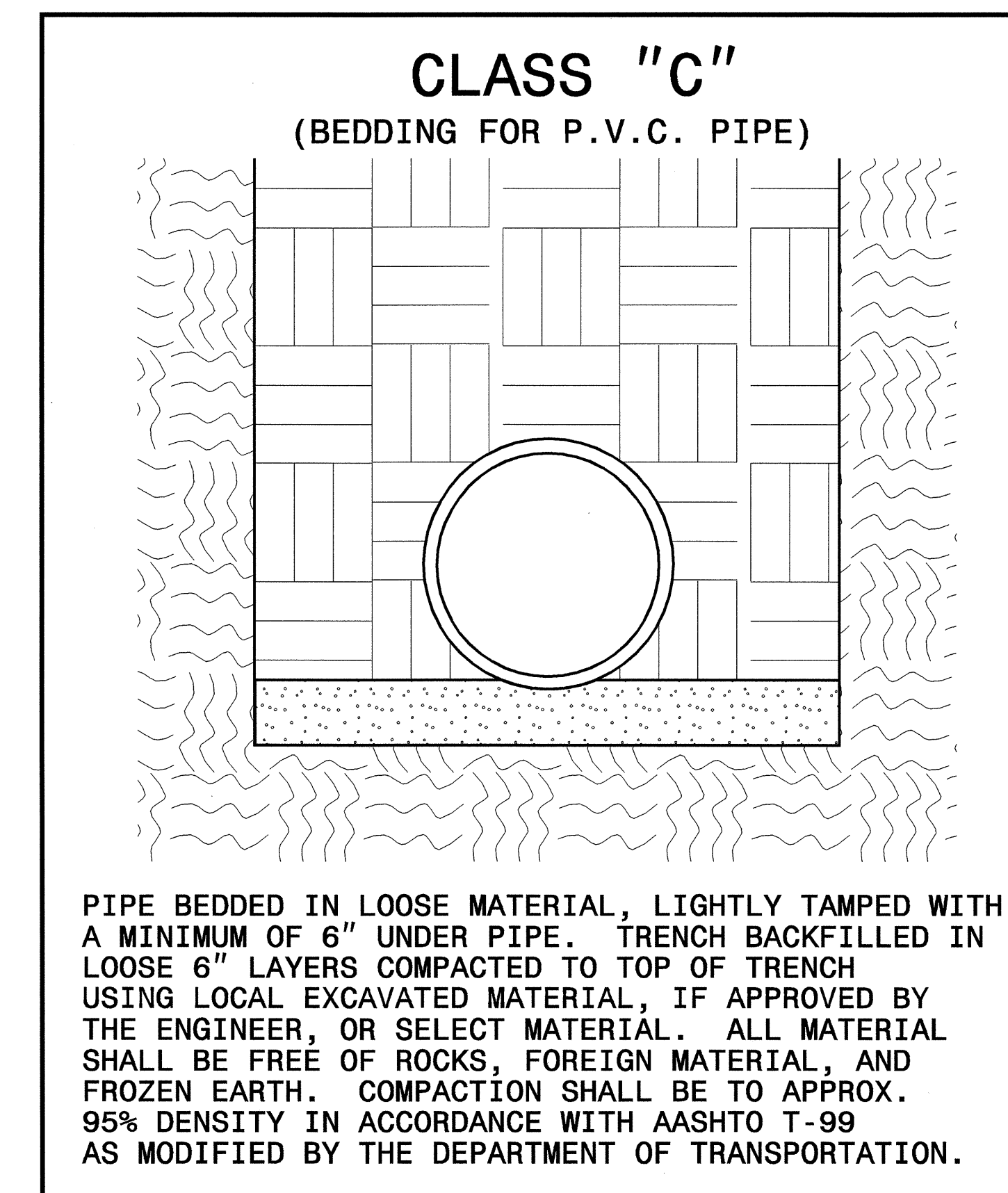
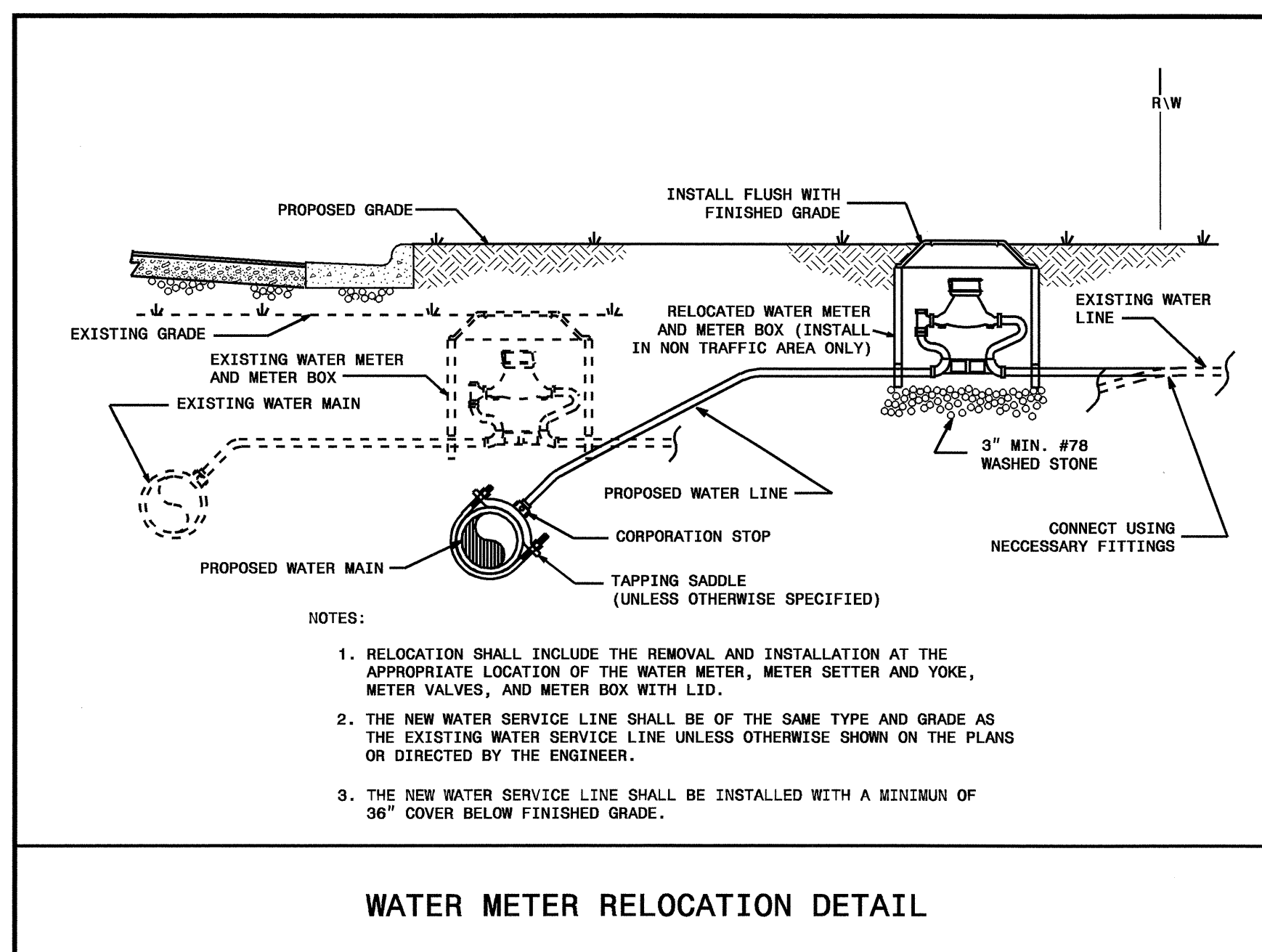
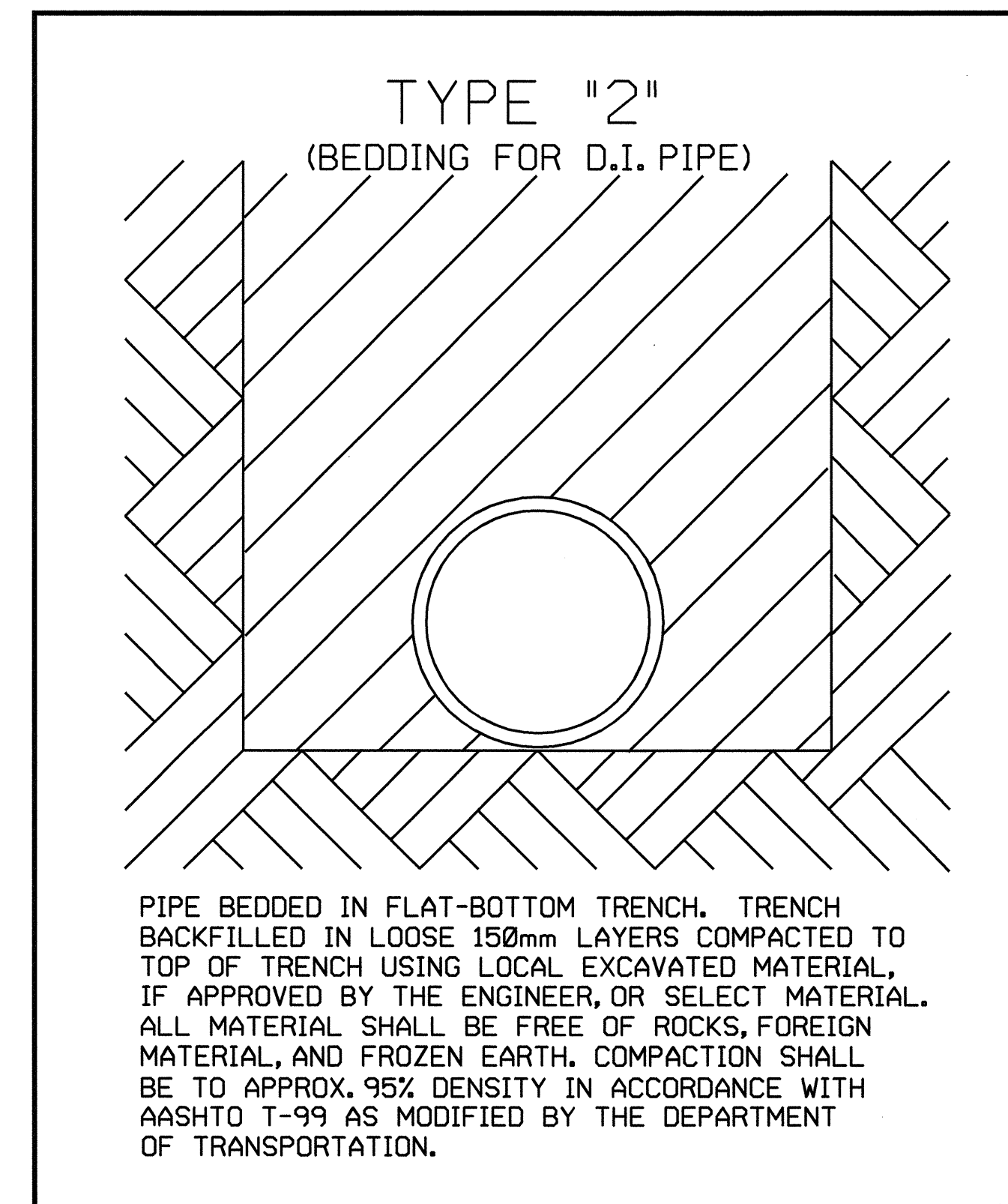

STATE OF NORTH CAROLINA
DIVISION OF HIGHWAYS

**UTILITIES BY OTHERS PLANS
WARREN COUNTY**

**LOCATION: BRIDGE NO. 20 OVER FISHING CREEK
ON SR 1100 (MANSON-AXTELL ROAD)**

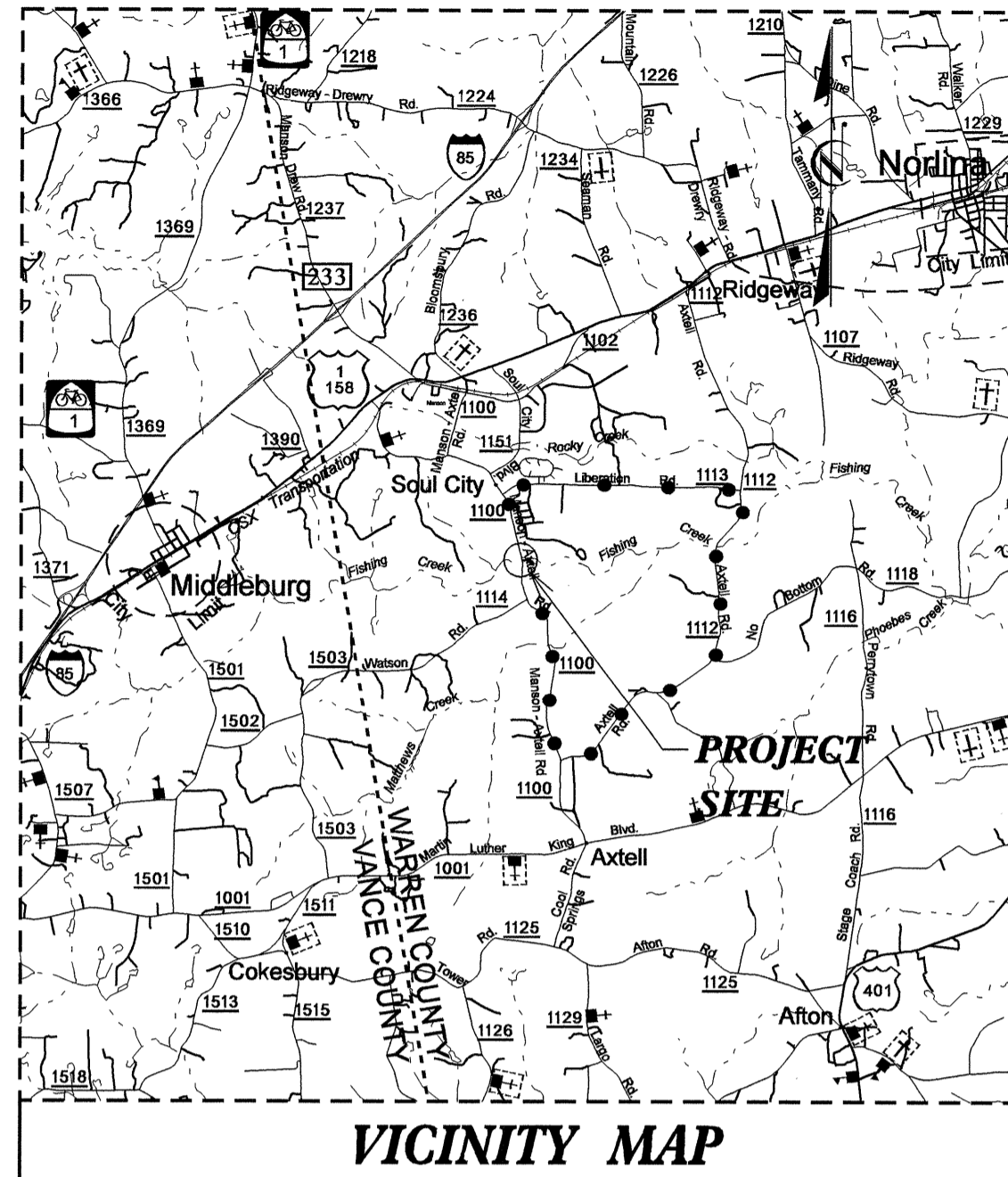

OFFSITE DETOUR ROUTE —●—●—●—●—
THIS PROJECT IS NOT WITHIN ANY
MUNICIPAL BOUNDARIES.

TIP B-3706

TYPE OF WORK: UTILITIES

UO-2

4
25+00

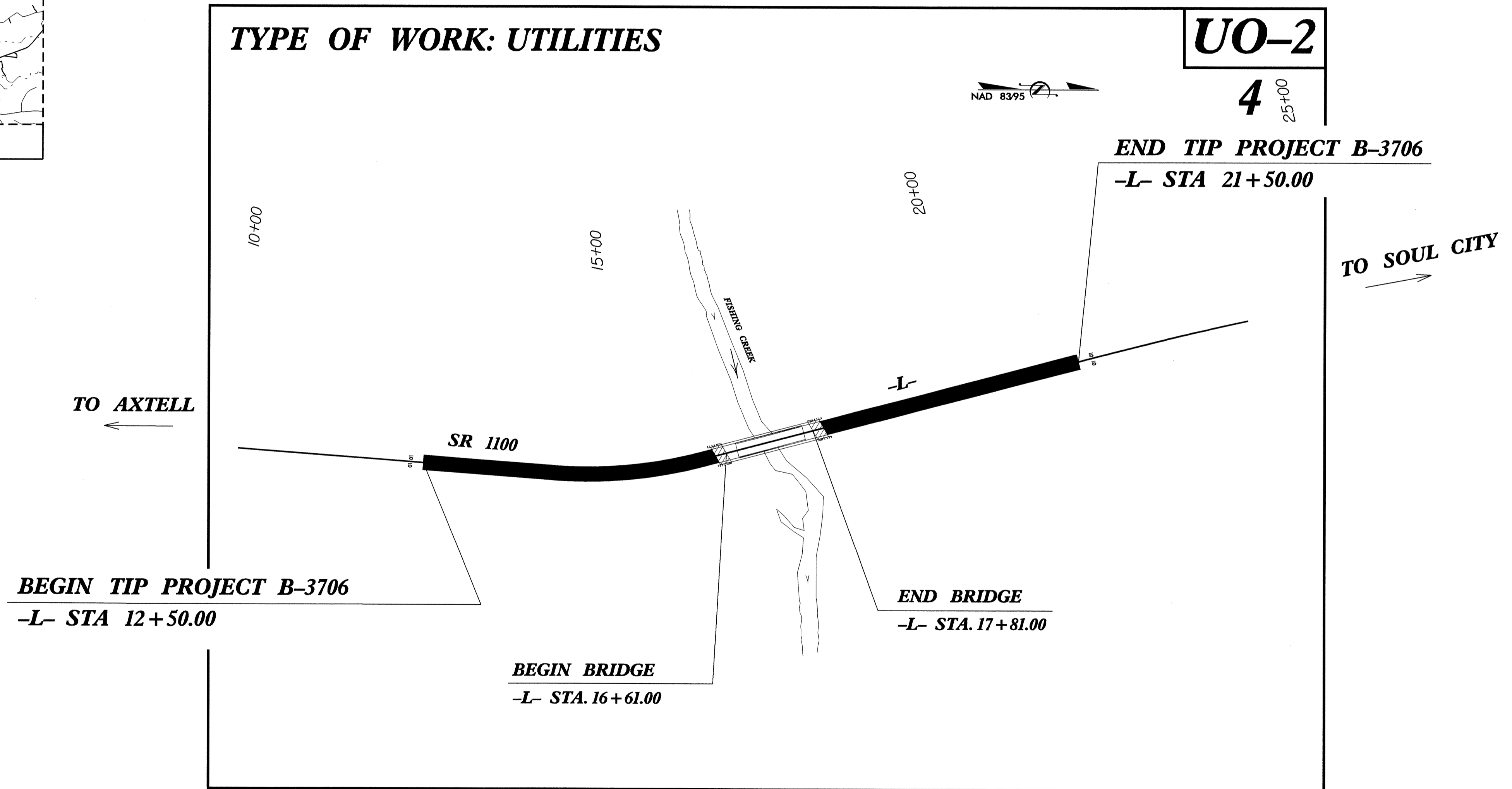

TO AXTELL
←

TO SOUL CITY
→

BEGIN TIP PROJECT B-3706
-L- STA 12+50.00

BEGIN BRIDGE
-L- STA. 16+61.00

END BRIDGE
-L- STA. 17+81.00

END TIP PROJECT B-3706
-L- STA 21+50.00

INDEX OF SHEETS

SHEET NO.	DESCRIPTION
UO-1	TITLE SHEET
UO-2	UTILITY BY OTHERS PLAN SHEETS

UTILITY OWNERS ON PROJECT

- (1) PROGRESS ENERGY
- (2) EMBARQ

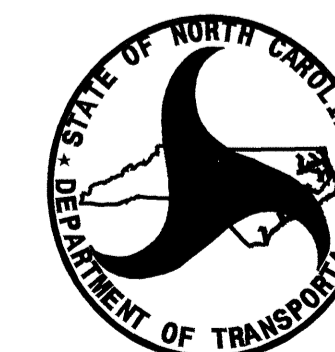

PREPARED IN THE OFFICE OF:
**DIVISION OF HIGHWAYS
UTILITIES ENGINEERING
SECTION**

1591 MAIL SERVICES CENTER
RALEIGH NC 27699-1591
PHONE (919) 256-4128
FAX (919) 256-4119

Roger Worthington, P.E. UTILITIES SECTION ENGINEER
Steve McKee, P.E. UTILITIES SQUAD LEADER PROJECT ENGINEER
Alonza Yancey UTILITIES PROJECT DESIGNER

UTILITIES BY OTHERS

NOTE:
ALL PROPOSED UTILITY WORK
SHOWN ON THIS SHEET WILL
BE DONE BY OTHERS

NAD 83/95

PI Sta 15+25.26
Δ = 19° 06' 29.8" (LT)
D = 9' 32' 57.5"
L = 200.10'
T = 100.99'
*R = 600.00'
SE = .04
DS = 40 mph

PI Sta 22+71.61
Δ = 2° 23' 59.4" (RT)
D = 1' 03' 39.7"
L = 226.18'
T = 113.11'
R = 5,400.00'

* DESIGN EXCEPTION REQUIRED

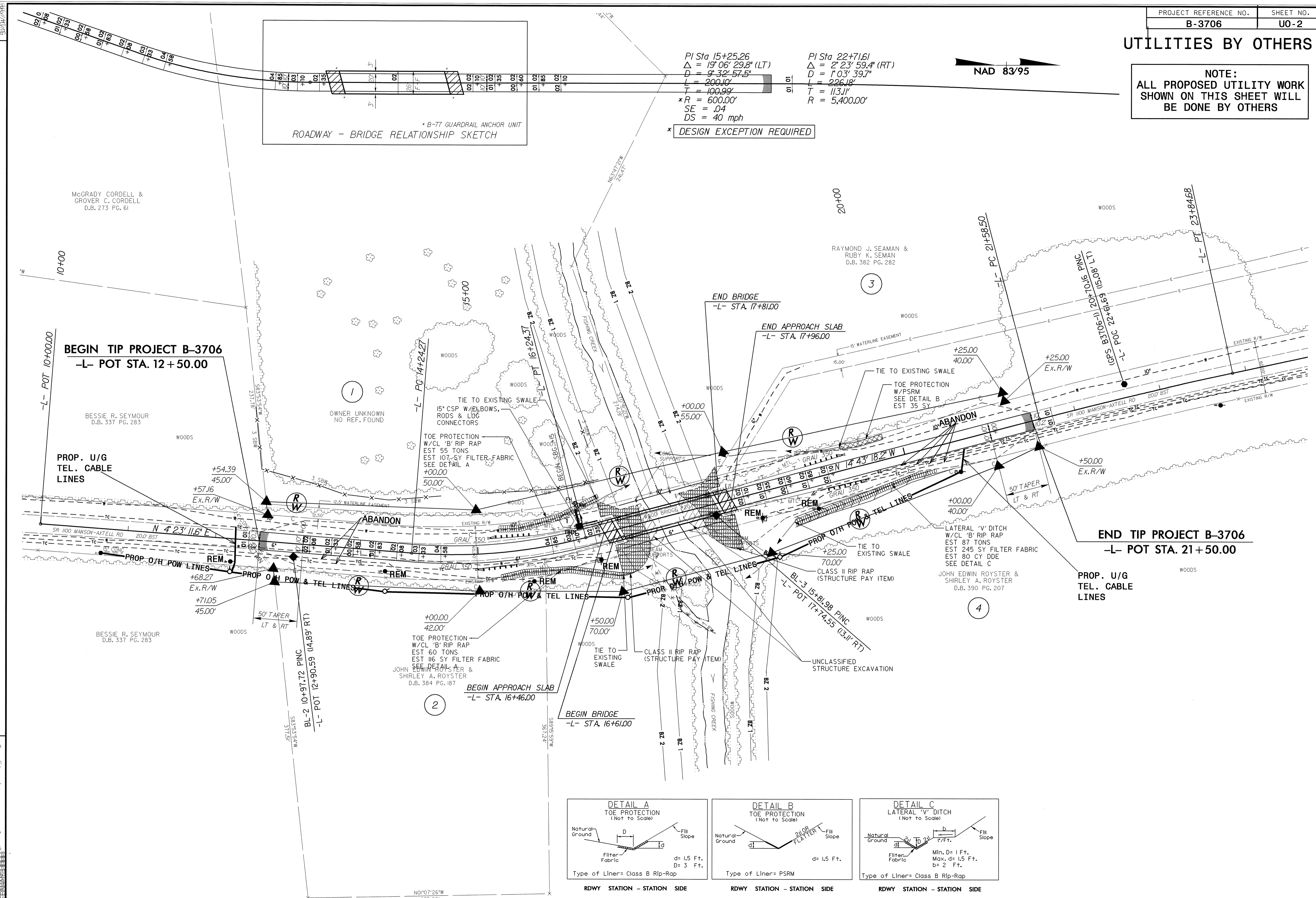
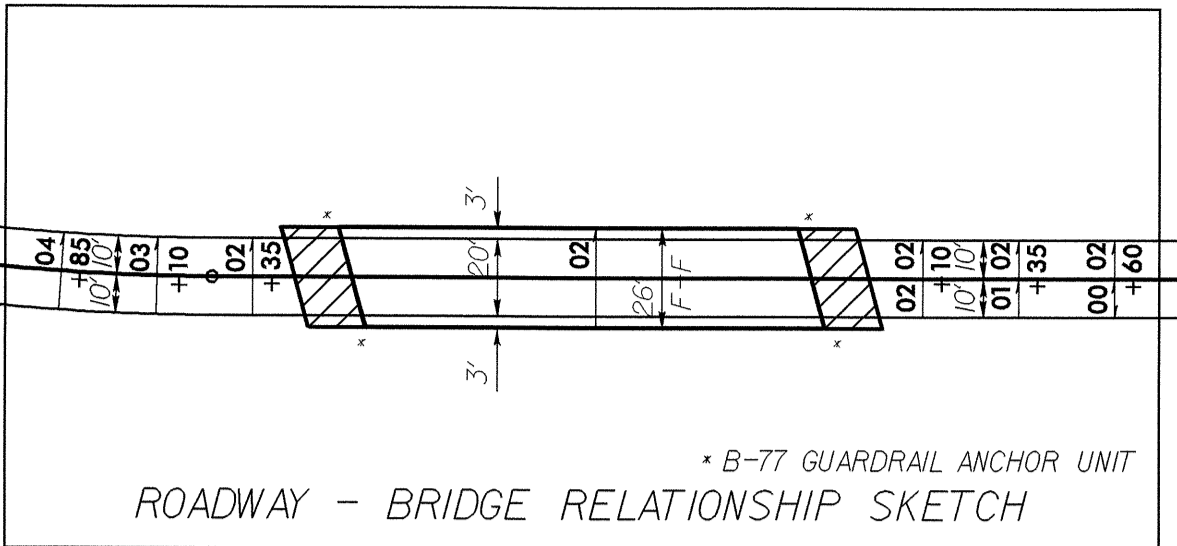

BEGIN TIP PROJECT B-3706
-L- POT STA. 12+50.00

END TIP PROJECT B-3706
-L- POT STA. 21+50.00

BEGIN APPROACH SLAB
-L- STA. 16+46.00

BEGIN BRIDGE
-L- STA. 16+61.00

END BRIDGE
-L- STA. 17+81.00

END APPROACH SLAB
-L- STA. 17+96.00

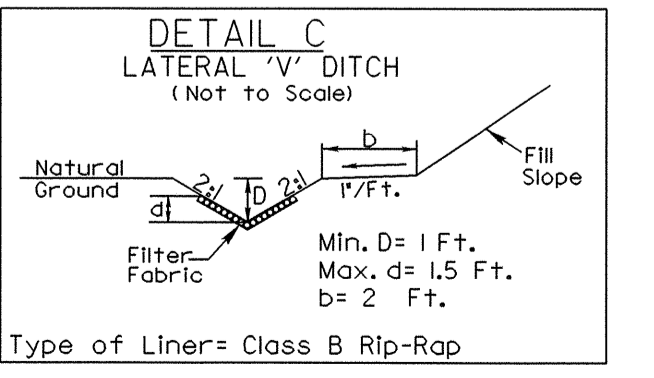
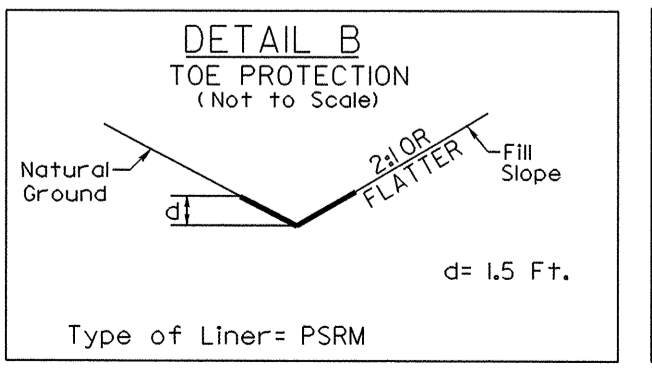
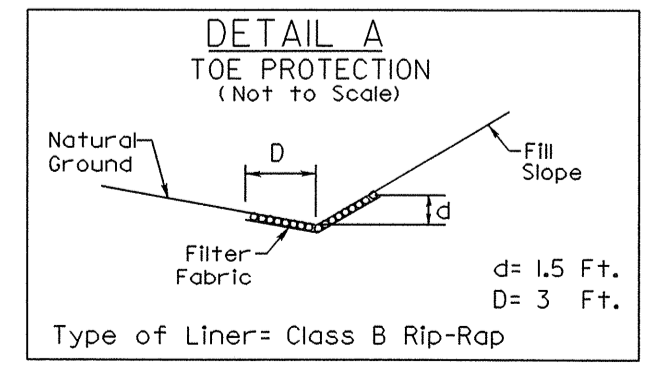

RDWY	STATION - STATION	SIDE
-L-	15+25 - 16+55	RT.
-L-	15+25 - 16+45	LT.

RDWY	STATION - STATION	SIDE
-L-	19+30 - 19+80	LT.

RDWY	STATION - STATION	SIDE
-L-	18+60 - 20+50	RT.

FOR -L- PROFILE, SEE SHEET NO. 5

REVISIONS

04-MDW-2008 08:31 jbo3785706loc2_pos8.dwg