

Approximate quantities only. Unclassified excavation, borrow excavation, fine grading, clearing and grubbing, breaking of existing pavement and removal of existing pavement will be paid for at the lump sum price for "Grading".

## STATE OF NORTH CAROLINA DIVISION OF HIGHWAYS CROSS-SECTION SUMMARY

\*NOTE: EMBANKMENT COLUMN DOES NOT INCLUDE BACKFILL FOR UNDERCUT

Station	Uncl. Exc.	Embt	Station	Uncl. Exc.	Embt
L	(cu. yd.)	(cu. yd.)	DETOUR REM	(cu. yd.)	(cu. yd.)
10+00.00	0	0	10+49.94	0	0
10+50.00	1	35	10+99.99	6	6
10+70.26	0	22	11+20.30	11	5
11+00.00	0	32	11+50.69	48	13
11+50.00	0	55	12+02.45	155	27
12+00.00	0	106	12+53.37	293	18
12+50.00	0	170	13+03.65	433	12
13+00.00	0	199	13+53.68	471	14
13+50.00	0	212	14+03.68	450	16
14+00.00	0	188	14+53.68	356	23
14+23.00	0	73	15+03.68	317	32
			15+53.68	332	17
			15+57.00	20	0
Station	Uncl. Exc.	Embt	Station	Uncl. Exc.	Embt
L	(cu. yd.)	(cu. yd.)	DETOUR REM	(cu. yd.)	(cu. yd.)
16+03.00	0	0	16+27.00	0	0
16+50.00	0	31	16+53.68	240	0
17+00.00	1	40	17+03.69	444	3
17+50.00	2	37	17+53.91	429	3
18+00.00	4	27	18+04.69	292	0
18+50.00	3	29	18+56.33	86	0
19+00.00	1	22	19+07.47	7	0
Station	Uncl. Exc.	Embt	Station	Uncl. Exc.	Embt
DETOUR	(cu. yd.)	(cu. yd.)			
10+49.94	0	0			
10+99.99	1	32			
11+20.30	0	34			
11+50.69	1	93			
12+02.45	1	236			
12+53.37	0	336			
13+03.65	0	462			
13+53.68	0	514			
14+03.68	0	496			
14+53.68	0	380			
15+03.68	0	317			
15+53.68	0	332			
15+57.00	0	332			
Station	Uncl. Exc.	Embt	Station	Uncl. Exc.	Embt
DETOUR	(cu. yd.)	(cu. yd.)			
16+27.00	0	0			
16+53.68	0	240			
17+03.69	0	444			
17+53.91	0	429			
18+04.69	0	293			
18+56.33	3	88			
19+07.47	5	7			

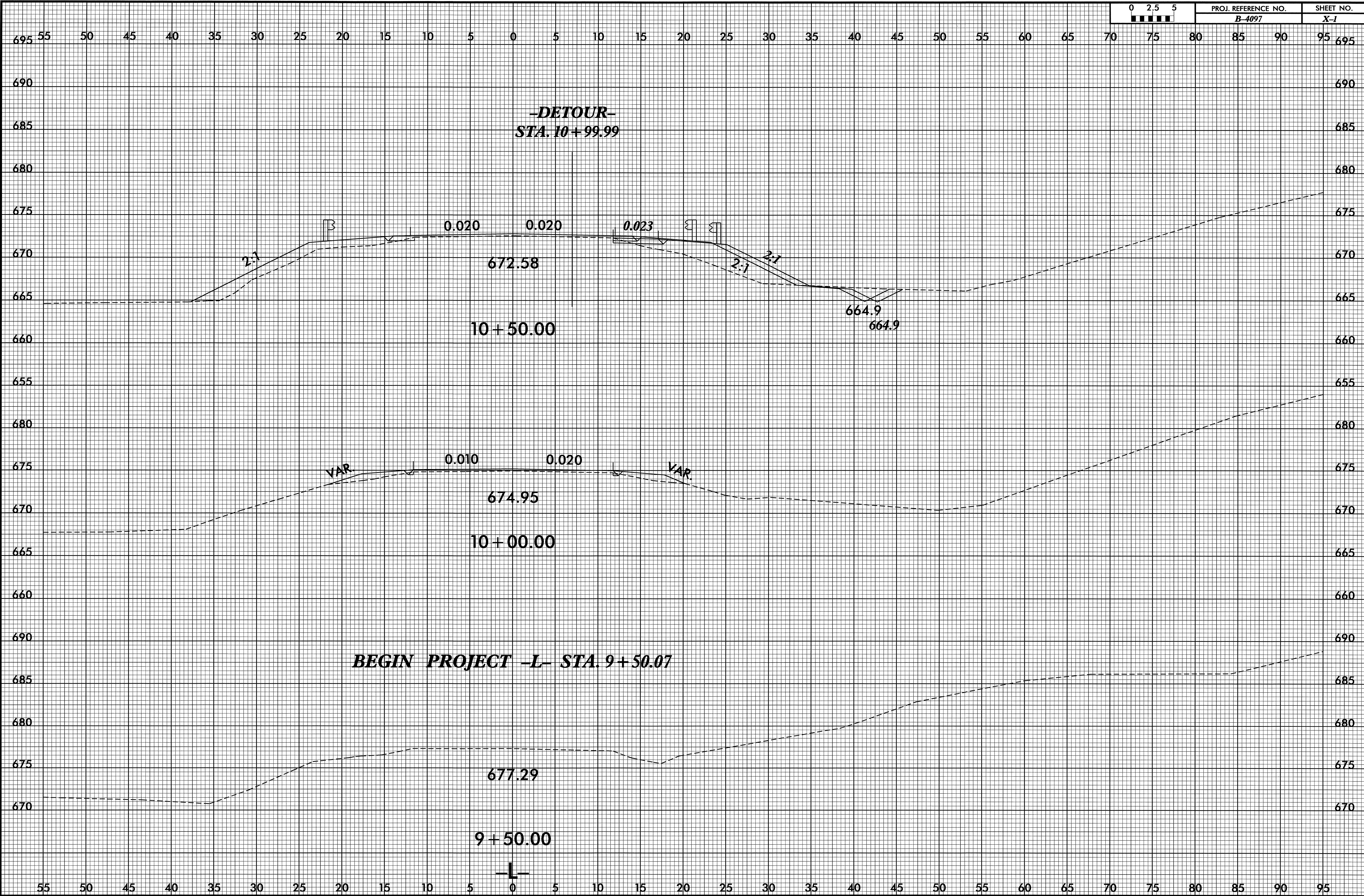

55 50 45 40 35 30 25 20 15 10 5 0 5 10 15 20 25 30 35 40 45 50 55 60 65 70 75 80 85 90 95

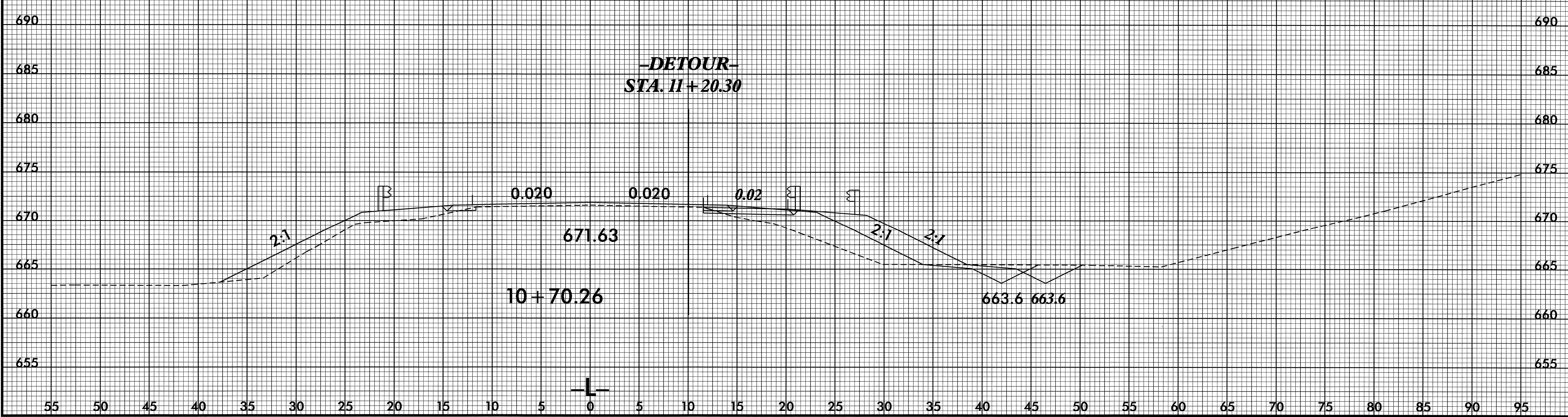
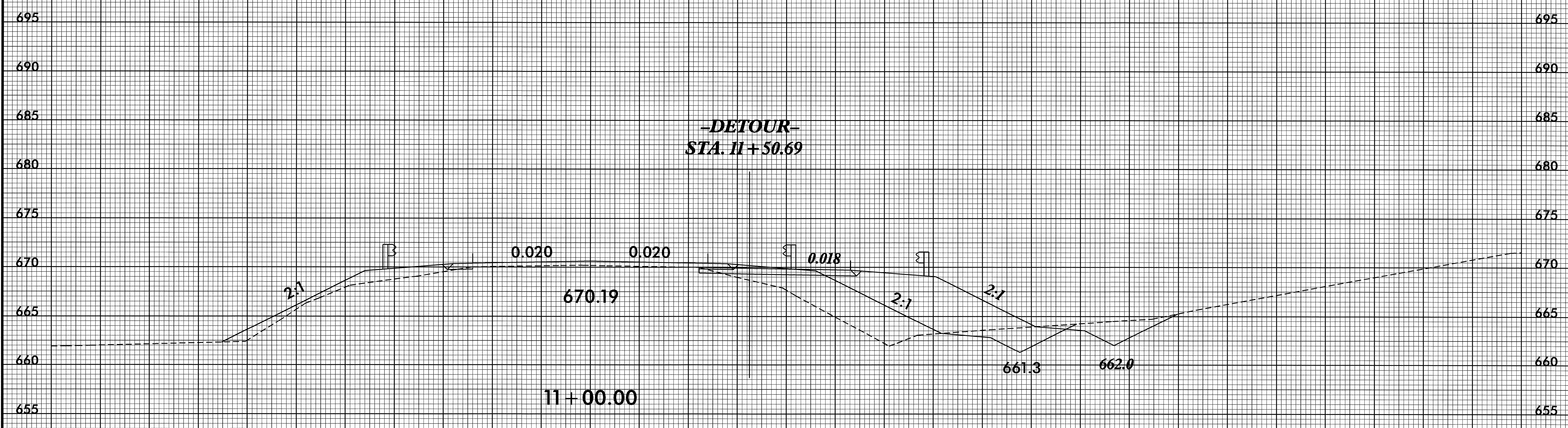

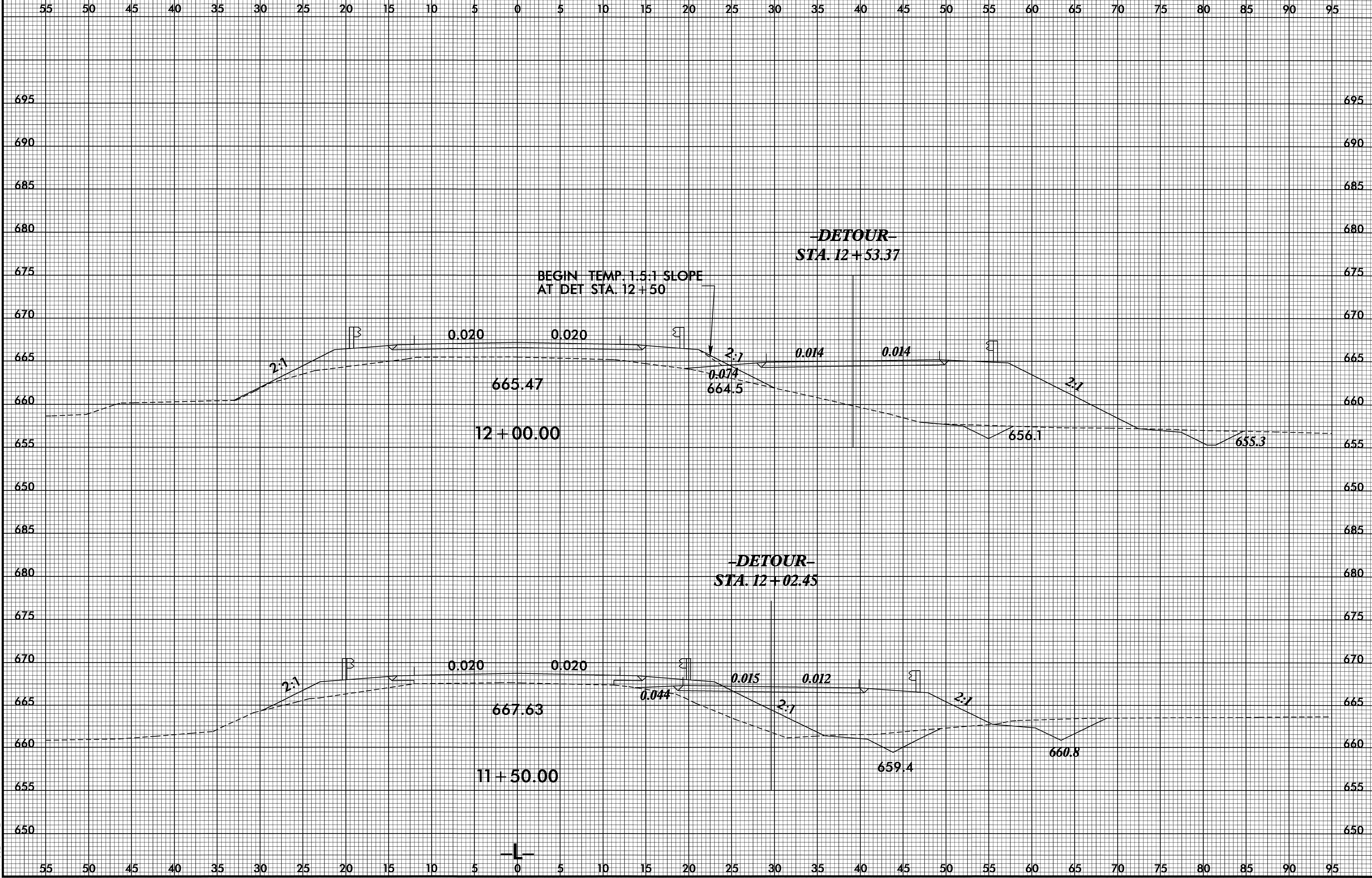

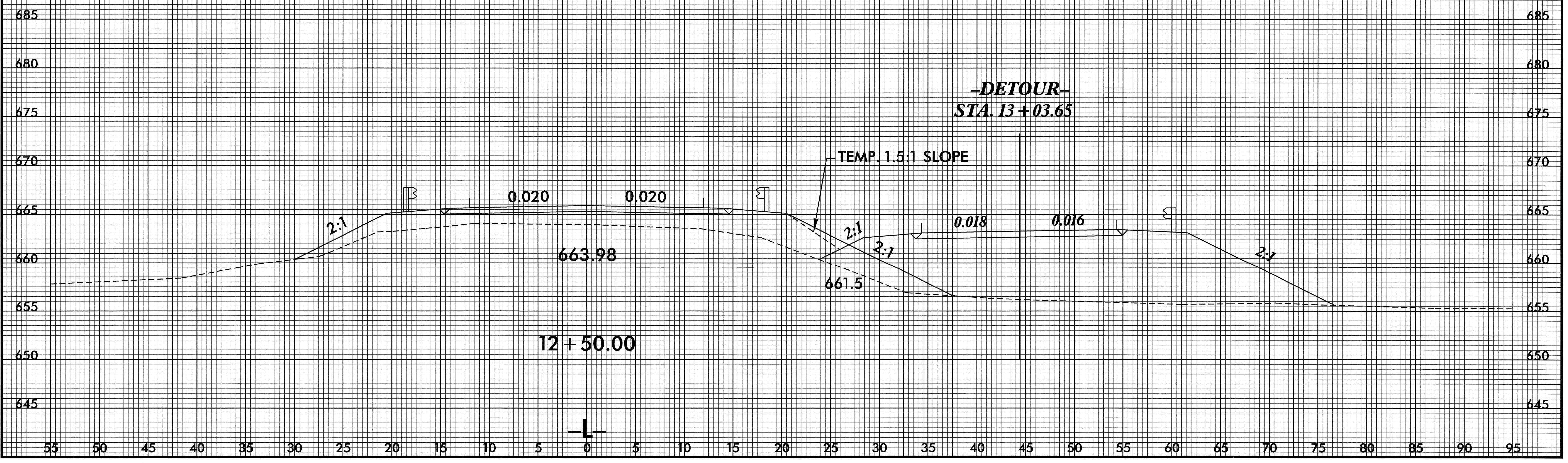
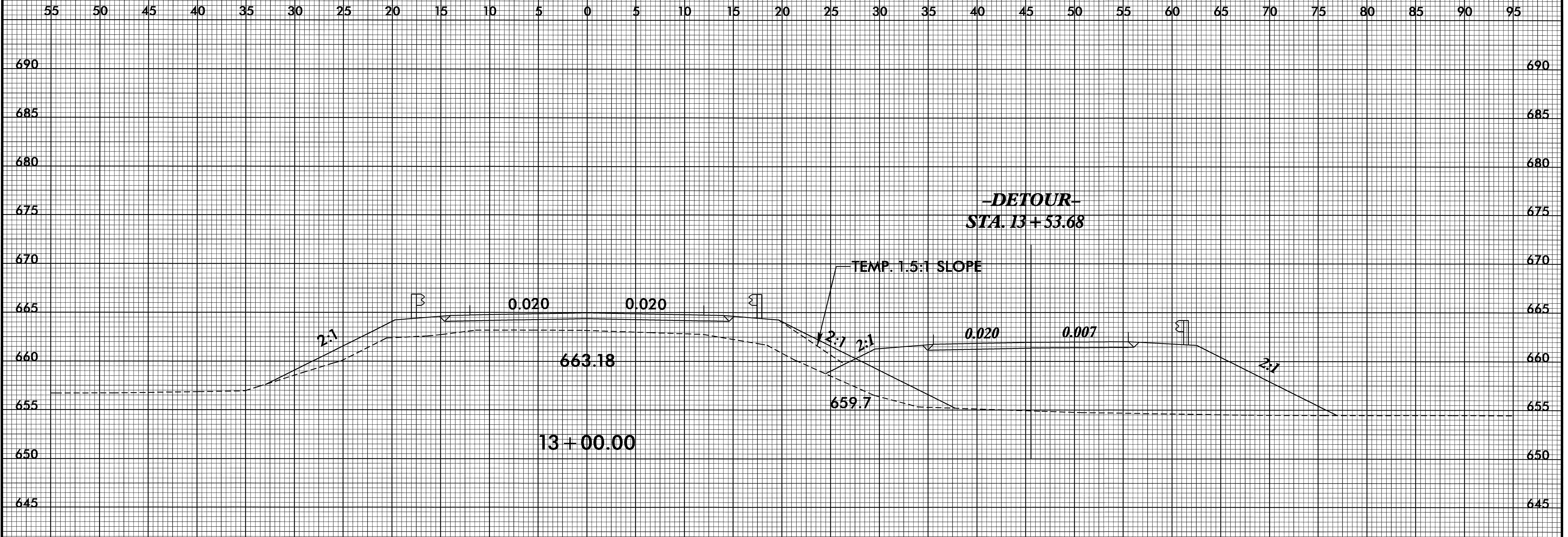

55 50 45 40 35 30 25 20 15 10 5 0 5 10 15 20 25 30 35 40 45 50 55 60 65 70 75 80 85 90 95

