

PROJECT SPECIAL PROVISION

(10-18-95)

Z-1

PERMITS

The Contractor's attention is directed to the following permits, which have been issued to the Department of Transportation by the authority granting the permit.

<u>PERMIT</u>	<u>AUTHORITY GRANTING THE PERMIT</u>
Dredge and Fill and/or Work in Navigable Waters (404)	U. S. Army Corps of Engineers
Water Quality (401)	Division of Environmental Management, DENR State of North Carolina

The Contractor shall comply with all applicable permit conditions during construction of this project. Those conditions marked by * are the responsibility of the department and the Contractor has no responsibility in accomplishing those conditions.

Agents of the permitting authority will periodically inspect the project for adherence to the permits.

The Contractor's attention is also directed to Articles 107-10 and 107-14 of the *Standard Specifications* and the following:

Should the Contractor propose to utilize construction methods (such as temporary structures or fill in waters and/or wetlands for haul roads, work platforms, cofferdams, etc.) not specifically identified in the permit (individual, general, or nationwide) authorizing the project it shall be the Contractor's responsibility to coordinate with the Engineer to determine what, if any, additional permit action is required. The Contractor shall also be responsible for initiating the request for the authorization of such construction method by the permitting agency. The request shall be submitted through the Engineer. The Contractor shall not utilize the construction method until it is approved by the permitting agency. The request normally takes approximately 60 days to process; however, no extensions of time or additional compensation will be granted for delays resulting from the Contractor's request for approval of construction methods not specifically identified in the permit.

Where construction moratoriums are contained in a permit condition which restricts the Contractor's activities to certain times of the year, those moratoriums will apply only to the portions of the work taking place in the waters or wetlands provided that activities outside those areas is done in such a manner as to not affect the waters or wetlands.



REPLY TO
ATTENTION OF:

115

DEPARTMENT OF THE ARMY
WILMINGTON DISTRICT, CORPS OF ENGINEERS
69 DARLINGTON AVENUE
WILMINGTON, NORTH CAROLINA 28403-1343

January 13, 2009

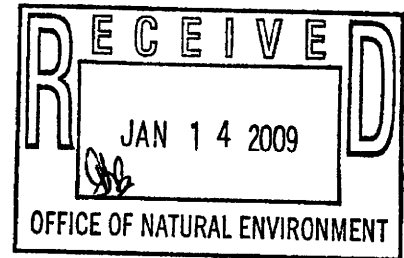

Regulatory Division

Action ID No. SAW-2008-01454

Mr. Gregory J. Thorpe, Ph.D.
Environmental Management Director, PDEA
NC Department of Transportation
1548 Mail Service Center
Raleigh, North Carolina 27699-1548

Dear Mr. Thorpe:

In accordance with the written request of April 16, 2008, and the ensuing administrative record, enclosed are two copies of a permit to authorize the proposed permanent placement of fill material into 0.01 acre of jurisdictional riparian wetland, 317 linear feet of perennial stream channel, and 151 linear feet of intermittent stream channel lacking important aquatic functions. Also included within the permit is the temporary impact of 0.02 acre of jurisdictional riparian wetland and 125 linear feet of jurisdictional stream channels. These impacts are associated with the roadway widening project identified as U-3303A and U-3303B. The project site is located along SR 1306 (South Mebane Street) from the existing SR 1158 (Huffman Mill Road) to NC 54 (Chapel Hill Road), in Burlington, Alamance County, North Carolina.

You should acknowledge that you accept the terms and conditions of the enclosed permit by signing and dating each copy in the spaces provided ("Permittee" on page 3). Your signature, as permittee, indicates that, as consideration for the issuance of this permit, you voluntarily accept and agree to comply with all of the terms and conditions of this permit. All pages of both copies of the signed permit with drawings and exhibits should then be returned to this office for final authorization. A self-addressed envelope is enclosed for your convenience.

This correspondence contains a proffered permit for the above described site. If you object to this decision, you may request an administrative appeal under Corps regulations at 33 CFR Part 331. Enclosed you will find a Notification of Appeal Process (NAP) fact sheet and request

for appeal (RFA) form. If you request to appeal this decision you must submit a completed RFA form to the District Commander, Wilmington District at the following address:

Col. Jefferson M. Ryscavage
Department of the Army
US AED, Wilmington District
Corps of Engineers
69 Darlington Avenue
Wilmington, NC 28403

In order for an RFA to be accepted by the Corps, the Corps must determine that it is complete, that it meets the criteria for appeal under 33 CFR part 331.5, and that it has been received by the District Office within 60 days of the date of the NAP. Should you decide to submit an RFA form, it must be received at the above address by March 12, 2009.

****It is not necessary to submit an RFA form to the District Office if you do not object to the decision in contained in this correspondence.****

After the permit is authorized in this office, the original copy will be returned to you and the duplicate copy will be permanently retained in this office. Should you have questions, please contact Mr. Andrew Williams, Raleigh Regulatory Field Office, at telephone (919) 554-4884, extension 26.

Sincerely,

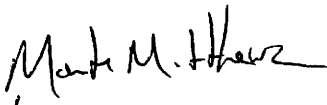
for / Jean B. Manuele
Chief, Raleigh Regulatory
Field Office

Enclosures

DEPARTMENT OF THE ARMY PERMIT**Permittee: NORTH CAROLINA DEPARTMENT OF TRANSPORTATION****Permit No: SAW-2008-01454****Issuing Office: USAED, WILMINGTON**

NOTE: The term "you" and its derivatives, as used in this permit, means the permittee or any future transferee. The term "this office" refers to the appropriate district or division office of the Corps of Engineers having jurisdiction over the permitted activity or the appropriate official of the office acting under the authority of the commanding officer.

You are authorized to perform work in the accordance with the terms and conditions specified below.

Project Description: The project, identified as U-3303A and U-3303B, consists of widening the existing 2.4 miles of SR 1306 (South Mebane Street) from SR 1158 (Huffman Mill Road) to NC 54 (Chapel Hill Road) from two lanes to a four-lane divided median section. The roadway improvements require the placement of fill material into a single wetland and streams for construction. Total permanent impacts for construction of this project are 0.01 acre of riparian wetland, 317 linear feet of perennial stream channel, and 151 linear feet of intermittent stream channels lacking important aquatic function. Temporary impacts total 0.02 acre of riparian wetland and 125 linear feet of stream channel associated with equipment and construction access. The applicant will mitigate for unavoidable impacts to streams and wetlands by payment into the North Carolina Ecosystem Enhancement Program in the amount necessary to perform the restoration of 317 linear feet of stream restoration (1:1 ratio) within the Cape Fear River Basin (HUC 03030002).

Project Location: The project, known as the U-3303A and U-3303B, is located along 2.4 miles of SR 1306 (South Mebane Street) from SR 1158 (Huffman Mill Road) to NC 54 (Chapel Hill Road) in Burlington, Alamance County, North Carolina. Coordinates (in decimal degrees) for the center of the site are 36.0699° N, 79.4667° W. The site contains stream channels and an adjacent wetland that form the headwaters of first order tributaries that flow into Gum Creek and Little Alamance Creek downstream of the project site. Gum Creek and Little Alamance Creek are tributaries to the Haw River which flows to the Cape Fear River, a navigable water of the United States.

Permit Conditions:**General Conditions:**

1. The time Limit for completing the work authorized ends on DECEMBER 31, 2014 If you find that you need more time to complete the authorized activity, submit your request for a time extension to this office for consideration at least one month before the above date is reached.

2. You must maintain the activity authorized by this permit in good condition and in conformance with the terms and conditions of this permit. You are not relieved of this requirement if you abandon the permitted activity, although you may make a good faith transfer to a third party in compliance with General Conditions 4 below. Should you wish to cease to maintain the authorized activity or should you desire to abandon it without a good faith transfer, you must obtain a modification of this permit from this office, which may require restoration of the area.
3. If you discover any previously unknown historic or archeological remains while accomplishing the activity authorized by this permit, you must immediately notify this office of what you have found. We will initiate the Federal and state coordination required to determine if the remains warrant a recovery effort or if the site eligible for listing in the National Register of Historic Places.
4. If you sell the property associated with this permit, you must obtain the signature of the new owner in the space provided and forward a copy of the permit to this office to validate the transfer of this authorization.
5. If a conditioned water quality certification has been issued for your project, you must comply with the conditions specified in the certification as special conditions to this permit. For your convenience, a copy of the certification is attached if it contains such conditions.
6. You must allow representatives from this office to inspect the authorized activity at any time deemed necessary to ensure that it is being or has been accomplished in accordance with the terms and conditions of your permit.

Special Conditions:

*SEE ATTACHED SPECIAL CONDITIONS

Further Information:

1. Congressional Authorities: You have been authorized to undertake the activity described above pursuant to:
 - () Section 10 of the Rivers and Harbors Act of 1899 (33 U.S. C. 403).
 - (X) Section 404 of the clean Water Act (33 U.S.C. 1344).
 - () Section 103 of the Marine Protection, Research and Sanctuaries Act of 1972 (33 U.S.C. 1413).
2. Limits of this authorization.
 - a. This permit does not obviate the need to obtain other Federal, state, or local authorizations required by law.
 - b. This permit does not grant any property rights or exclusive privileges.
 - c. This permit does not authorize any injury to the property or rights of others.
 - d. This permit does not authorize interference with any existing or proposed Federal project.
3. Limits of Federal Liability. In issuing this permit, the Federal Government does not assume any liability for the following:
 - a. Damages to the permitted project or uses thereof as a result of other permitted or unpermitted activities or from natural causes.
 - b. Damages to the permitted project or uses thereof as a result of current or future activities undertaken by or on behalf of the United states in the public interest.

c. Damages to persons, property, or to other permitted or unpermitted activities or structures caused by the activity authorized by this permit.

d. Design or construction deficiencies associated with the permitted work.

e. Damage claims associated with any future modification, suspension, or revocation of this permit.

4. Reliance on Applicant's Data: The determination of this office that issuance of this permit is not contrary to the public interest was made in reliance on the information you provided.

5. Reevaluation of Permit Decision. This office may reevaluate its decision on this permit at any time the circumstances warrant. Circumstances that could require a reevaluation include, but are not limited to, the following:

- a. You fail to comply with the terms and conditions of this permit.
- b. The information provided by you in support of your permit application proves to have been false, incomplete, or inaccurate (see 4 above).
- c. Significant new information surfaces which this office did not consider in reaching the original public interest decision.

Such a reevaluation may result in a determination that it is appropriate to use the suspension, modification, and revocation procedures contained in 33 CFR 325.7 or enforcement procedures such as those contained in 33CFR 326.4 and 326.5. The referenced enforcement procedures provide for the issuance of an administrative order requiring you to comply with the terms and conditions of your permit and for the initiation of legal action where appropriate. You will be required to pay for any corrective measures ordered by this office, and if you fail to comply with such directive, this office may in certain situations (such as those specified in 33 CFR 209.170) accomplish the corrective measure by contract or otherwise and bill you for the cost.

6. Extensions. General condition 1 establishes a time limit for the completion of the activity authorized by this permit. Unless there are circumstances requiring either a prompt completion of the authorized activity or a reevaluation of the public interest decision, the Corps will normally give favorable consideration to a request for an extension of this time limit.

Your signature below, as permittee, indicates that you accept and agree to comply with the terms and conditions of this permit.

E. L. Lusk

Jan 15, 2009

(PERMITTEE) NORTH CAROLINA DEPARTMENT OF TRANSPORTATION

(DATE)

This permit becomes effective when the Federal official, designated to act for the Secretary of the Army, has signed below.

(DISTRICT Engineer) JEFFERSON RYSCAVAGE, COLONEL

(DATE)

When the structures or work authorized by this permit are still in existence at the time the property is transferred, the terms and conditions of this permit will continue to be binding on the new owner(s) of the property. To validate the transfer of this permit and the associated liabilities associated with compliance with its terms and conditions, have the transferee sign and date below.

(Transferee)

(Date)

SPECIAL CONDITIONS (Action ID. 2008-01454); NC Department of Transportation/TIP U3303AB)

Work Limits

1. All work authorized by this permit must be performed in strict compliance with the attached plans, which are a part of this permit. Any modification to these plans must be approved by the US Army Corps of Engineers (USACE) prior to implementation.

2. Except as authorized by this permit or any USACE approved modification to this permit, no excavation, fill or mechanized land-clearing activities shall take place at any time in the construction or maintenance of this project, within waters or wetlands. This permit does not authorize temporary placement or double handling of excavated or fill material within waters or wetlands outside the permitted area. This prohibition applies to all borrow and fill activities connected with this project.

3. Except as specified in the plans attached to this permit, no excavation, fill or mechanized land-clearing activities shall take place at any time in the construction or maintenance of this project, in such a manner as to impair normal flows and circulation patterns within waters or wetlands or to reduce the reach of waters or wetlands.

Related Laws

4. All mechanized equipment will be regularly inspected and maintained to prevent contamination of waters and wetlands from fuels, lubricants, hydraulic fluids, or other toxic materials. In the event of a spill of petroleum products or any other hazardous waste, the permittee shall immediately report it to the N.C. Division of Water Quality at (919) 733-5083, Ext. 526 or (800) 662-7956 and provisions of the North Carolina Oil Pollution and Hazardous Substances Control Act will be followed.

Project Maintenance

5. The permittee shall advise the Corps in writing prior to beginning the work authorized by this permit and again upon completion of the work authorized by this permit.

6. Unless otherwise authorized by this permit, all fill material placed in waters or wetlands shall be generated from an upland source and will be clean and free of any pollutants except in trace quantities. Metal products, organic materials (including debris from land clearing activities), or unsightly debris will not be used.

7. The permittee shall require its contractors and/or agents to comply with the terms and conditions of this permit in the construction and maintenance of this project, and shall provide each of its contractors and/or agents associated with the construction or maintenance of this project with a copy of this permit. A copy of this permit, including all conditions, shall be available at the project site during construction and maintenance of this project

**SPECIAL CONDITIONS (Action ID. 2008-01454); NC Department of Transportation/TIP
U3303A&B**

8. The permittee shall employ all sedimentation and erosion control measures necessary to prevent an increase in sedimentation or turbidity within waters and wetlands outside the permit area. This shall include, but is not limited to, the immediate installation of silt fencing or similar appropriate devices around all areas subject to soil disturbance or the movement of earthen fill, and the immediate stabilization of all disturbed areas. Additionally, the project must remain in full compliance with all aspects of the Sedimentation Pollution Control Act of 1973 (North Carolina General Statutes Chapter 113A Article 4).

9. The permittee, upon receipt of a notice of revocation of this permit or upon its expiration before completion of the work will, without expense to the United States and in such time and manner as the Secretary of the Army or his authorized representative may direct, restore the water or wetland to its pre-project condition.

Enforcement

10. Violations of these conditions or violations of Section 404 of the Clean Water Act or Section 10 of the Rivers and Harbors Act must be reported in writing to the Wilmington District U.S. Army Corps of Engineers within 24 hours of the permittee's discovery of the violation.

Culverts

11. All authorized culverts will be installed to allow the passage of low stream flows and the continued movement of fish and other aquatic life as well as to prevent headcutting of the streambed. For all box culverts and for pipes greater than 48 inches in diameter, the bottom of the pipe will be buried at least one foot below the bed of the stream unless burial would be impractical and the Corps of Engineers has waived this requirement. For culverts 48 inches in diameter or smaller, the bottom of the pipe must be buried below the bed of the stream to a depth equal to or greater than 20 percent of the diameter of the culvert. Design and placement of culverts and other structures including temporary erosion control measures shall not be conducted in a manner that may result in disequilibrium of wetlands or streambeds or banks, adjacent to, upstream or downstream of the structures. In order to allow for the continued movement of bed load and aquatic organisms, existing stream channel widths and depths will be maintained at the inlet and outlet ends of culverts. Riprap armoring of streams at culvert inlets and outlets shall be minimized above the ordinary high water elevation in favor of bioengineering techniques such as bank sloping, erosion control matting and revegetation with deep-rooted, woody plants.

SPECIAL CONDITIONS (Action ID. 2008-01454); NC Department of Transportation/TIP U3303A&B)

Pre-Construction Meeting

12. The permittee shall schedule a preconstruction meeting between its representatives, the contractor's representatives, and the Corps of Engineers, Raleigh Regulatory Field Office, NCDOT Regulatory Project Manager, prior to any work within jurisdictional waters and wetlands to ensure that there is a mutual understanding of all of the terms and conditions contained within this Department of the Army Permit. The permittee shall provide the USACE, Raleigh Regulatory Field Office, NCDOT Regulatory Project Manager, with a copy of the final plans at least two weeks prior to the preconstruction meeting along with a description of any changes that have been made to the project's design, construction methodology or construction timeframe. The permittee shall schedule the preconstruction meeting for a time when the USACE and North Carolina Division of Water Quality (NCDWQ) Project Managers can attend. The permittee shall invite the Corps and NCDWQ Project Managers a minimum of thirty (30) days in advance of the scheduled meeting in order to provide those individuals with ample opportunity to schedule and participate in the required meeting.

Borrow and Waste

13. To ensure that all borrow and waste activities occur on high ground and do not result in the degradation of adjacent wetlands and streams, except as authorized by this permit, the permittee shall require its contractors and/or agents to identify all areas to be used to borrow material, or to dispose of dredged, fill, or waste material. The permittee shall provide the USACE with appropriate maps indicating the locations of proposed borrow or waste sites as soon as the permittee has that information. The permittee will coordinate with the USACE before approving any borrow or waste sites that are within 400 feet of any streams or wetlands. All jurisdictional wetland lines on borrow and waste sites shall be verified by the Corps of Engineers and shown on the approved reclamation plans. The permittee shall ensure that all such areas comply with Special Condition b) of this permit, and shall require and maintain documentation of the location and characteristics of all borrow and disposal sites associated with this project. This information will include data regarding soils, vegetation and hydrology sufficient to clearly demonstrate compliance with the Special Condition b). All information will be available to the USACE upon request. NCDOT shall require its contractors to complete and execute reclamation plans for each waste and borrow site and provide written documentation that the reclamation plans have been implemented and all work is completed. This documentation will be provided to the Corps of Engineers within 30 days of the completion of the reclamation work.

**SPECIAL CONDITIONS (Action ID. 2008-01454); NC Department of Transportation/TIP
U3303A&B)**

EEP Mitigation

14. NC-EEP STREAM MITIGATION: Compensatory mitigation for the loss of 317 linear feet of stream, associated with the proposed project, shall be provided by the Ecosystem Enhancement Program (EEP), as outlined in the letter dated December 10, 2007 from William D. Gilmore, EEP Director. Pursuant to the EEP Memorandum of Agreement (MOA) between the State of North Carolina and the US Army Corps of Engineers signed on July 22, 2003, the EEP will provide 317 linear feet of warm-water restoration equivalent stream mitigation in the Haw River basin (Hydrologic Cataloging Unit 03030002) by one year of the date of this permit. The NCDOT shall, within 30 days of the issue date of this permit, certify that sufficient funds have been provided to EEP to complete the required mitigation, pursuant to Paragraph V. of the MOA.

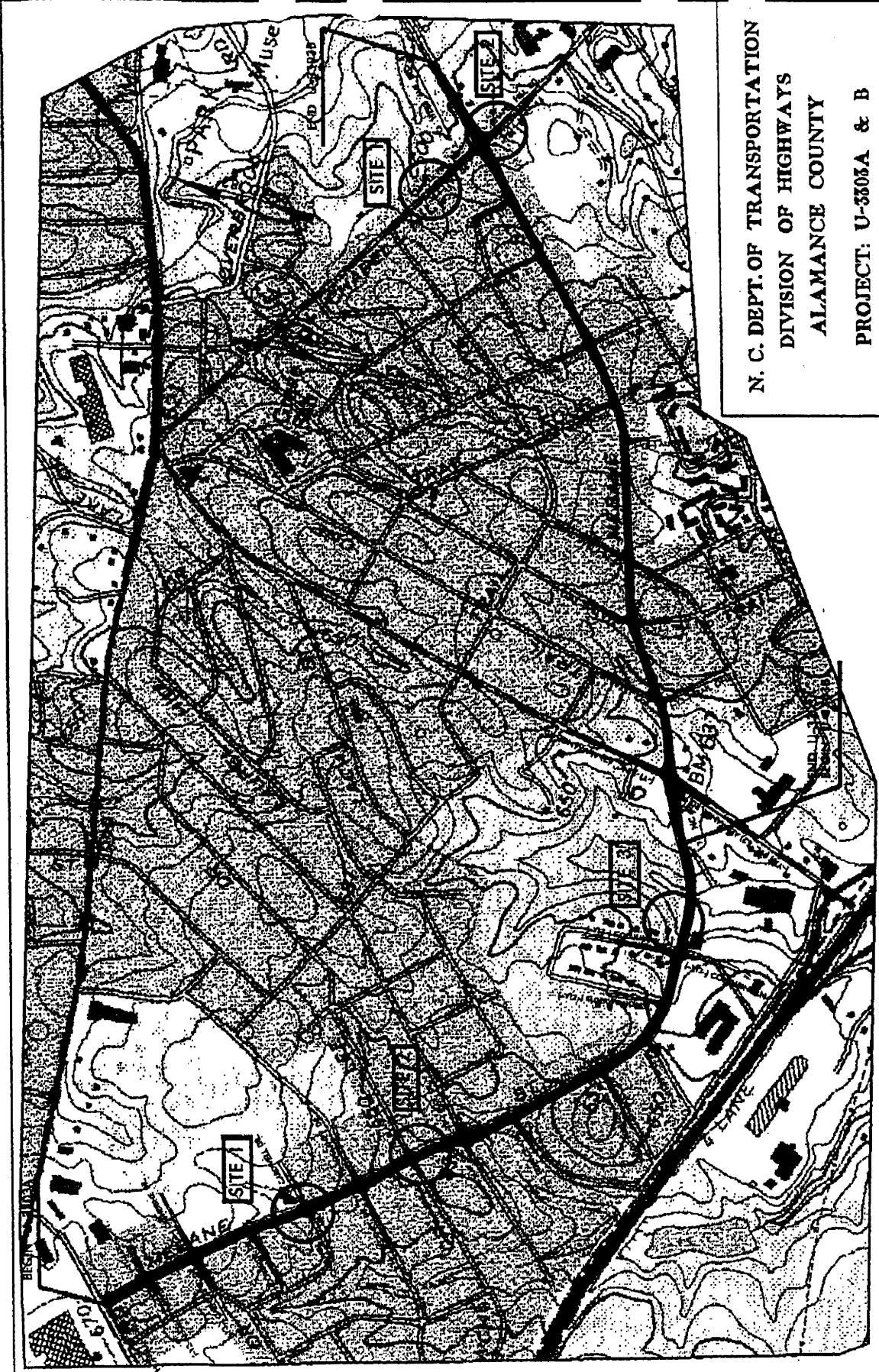

N. C. DEPT. OF TRANSPORTATION
 DIVISION OF HIGHWAYS
 ALAMANCE COUNTY
 PROJECT: U-3503A & B
 MEBANE STREET WIDENING

VICINITY MAP

Action ID:SAW-2008-01454
 Sheet 1 of 5

SHEET OF

U-3303A

125

Site 3
(see permit drawing sheet 11 of 13)

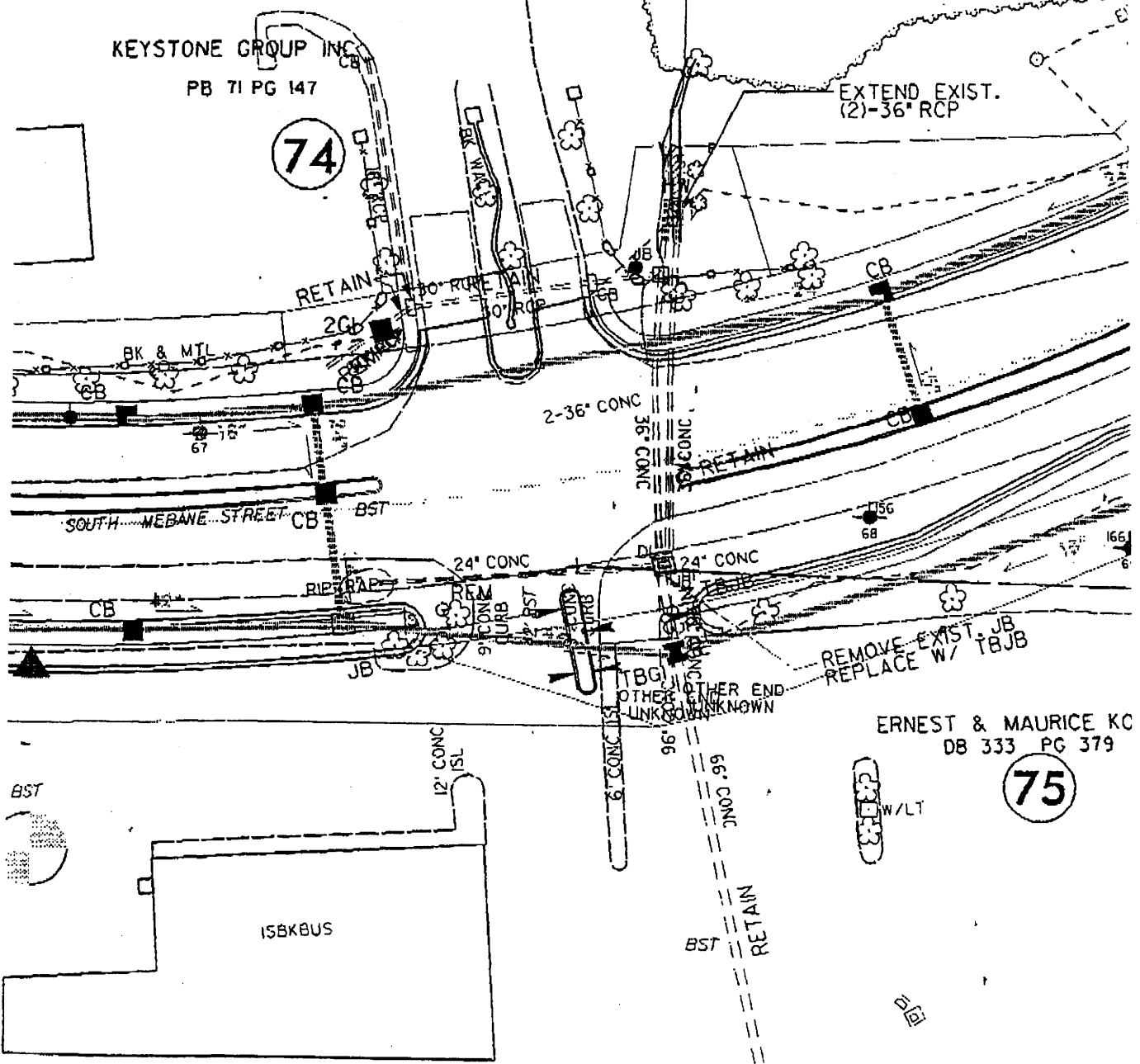
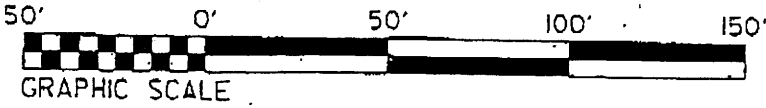

KEYSTONE GROUP INC
PB 71 PG 147

74

EXTEND EXIST.
(2)-36" RCP

SOUTH MEBANE STREET

ERNEST & MAURICE KC
DB 333 PG 379

75

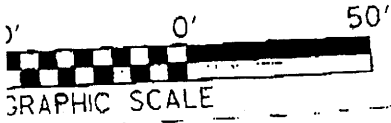

U-3-031
Site 1
(see permit drawing
Sheet 5 of 13)

18

PEC FAMILY LMTD P
DB 977 PG 510

Sta. 14+58.31
Sta. 14+60.79

19

DU VAN TRIED
DB 1595 PG 108
PB 12 PG 93

PT Sta. 29

BETTY I
DB 368
PB 12 F

20

42" CONC WALK

12" CONC

ROLYN A. PRICE
3 2092 PG 85

28

22" CONC

8A

LOUIS JONES
497 PG 737
18 16 PG 28

18" CONC

29

HAROLD FOGLEMAN
DB 1126 PG 95

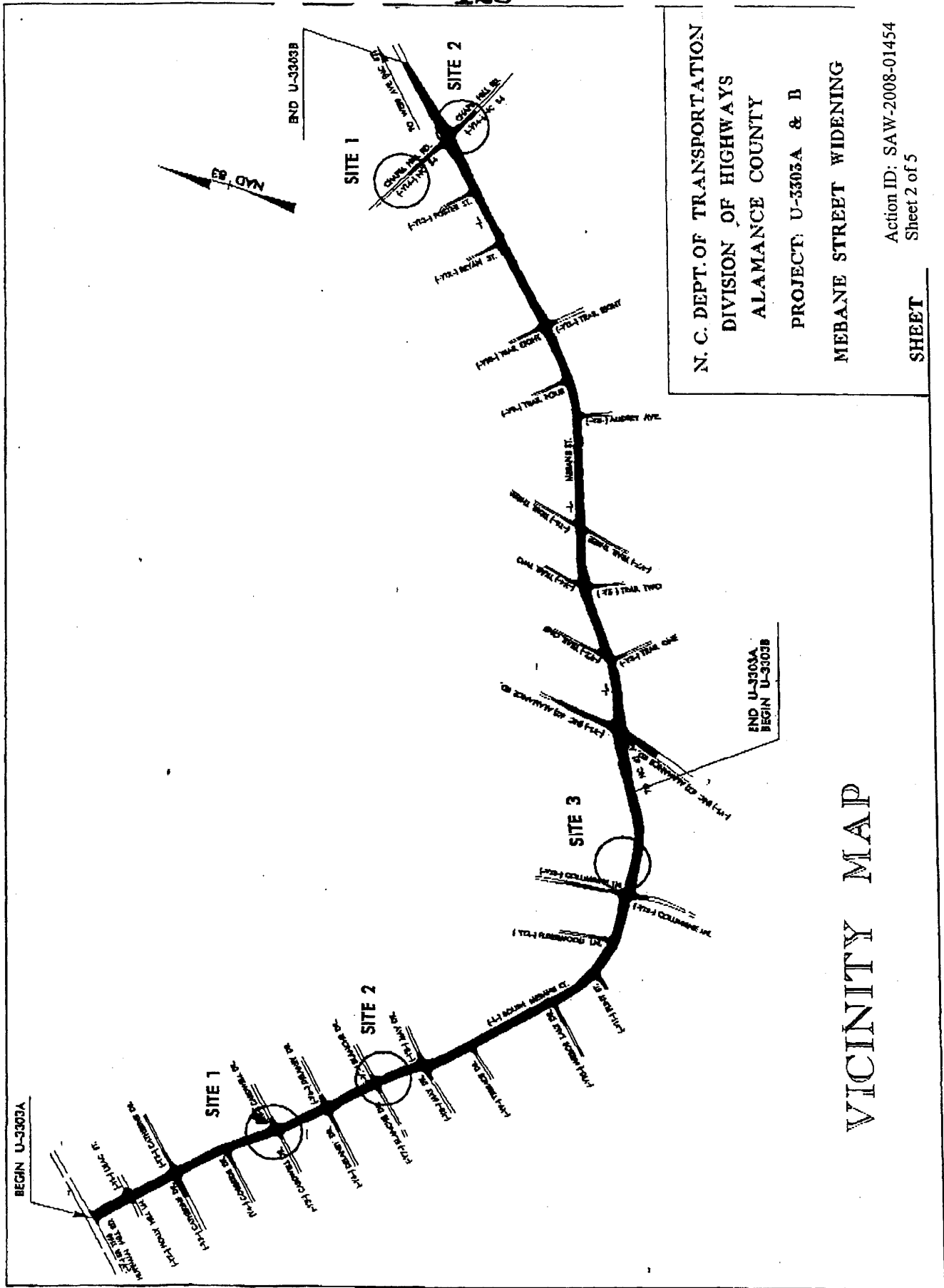

N. C. DEPT. OF TRANSPORTATION
 DIVISION OF HIGHWAYS
 ALAMANCE COUNTY
 PROJECT: U-3303A & B
 MEBANE STREET WIDENING

Action ID: SAW-2008-01454
 Sheet 2 of 5

SHEET

VICINITY MAP



129

Michael F. Easley, Governor
William G. Ross Jr., Secretary
North Carolina Department of Environment and Natural Resources

Coleen Sullins, Director
Division of Water Quality

July 25, 2008 **RECEIVED**

AUG 01 2008

RALEIGH REGULATORY FIELD OFFICE

Dr. Greg Thorpe, PhD., Branch Manager
Project Development and Environmental Analysis Branch
North Carolina Department of Transportation
1598 Mail Service Center
Raleigh, North Carolina, 27699-1548

Subject: 401 Water Quality Certification Pursuant to Section 401 of the Federal Clean Water with ADDITIONAL CONDITIONS for Proposed improvements to SR 1306 (South Mebane Street) from SR 1158 (Huffman Mill Road) to NC 54 (Chapel Hill Road) in Alamance County, Federal Aid Project No. STP-1306(8), State Project No. 8.2473101, TIP U-3303A and U-3303B.
DWQ Project No. 20080691

Dear Dr. Thorpe:

Attached hereto is a copy of Certification No. 3750 issued to The North Carolina Department of Transportation dated July 25, 2008.

If we can be of further assistance, do not hesitate to contact us.

Sincerely,

Coleen Sullins
Director

Attachments

cc: Andy Williams, US Army Corps of Engineers, Raleigh Field Office
J.M. Mills, PE, Division 7 Engineer
Jerry Parker, Division 7 Environmental Officer
Kathy Matthews, Environmental Protection Agency
Travis Wilson, NC Wildlife Resources Commission
Gary Jordan, US Fish and Wildlife Service
Amy Euliss, DWQ Winston-Salem Regional Office
File Copy



401 Water Quality Certification Pursuant to Section 401 of the Federal Clean Water Act with ADDITIONAL CONDITIONS

THIS CERTIFICATION is issued in conformity with the requirements of Section 401 Public Laws 92-500 and 95-217 of the United States and subject to the North Carolina Division of Water Quality (DWQ) Regulations in 15 NCAC 2H .0500. This certification authorizes the NCDOT to impact 0.03 acres of jurisdictional wetlands and 593 linear feet of jurisdictional streams in Alamance County. The project shall be constructed pursuant to the application dated received April 15, 2008. The authorized impacts are as described below:

Stream Impacts in the Cape Fear River Basin

Site	Permanent Fill in Intermittent Stream (linear ft.)	Temporary Fill in Intermittent Stream (linear ft.)	Permanent Fill in Perennial Stream (linear ft.)	Temporary Fill in Perennial Stream (linear ft.)	Total Temporary Impact (linear ft.)	Total Permanent Impact (linear ft.)	Total Stream Impact (linear ft.)	Stream Impacts Requiring Mitigation (linear ft.)
R-3303A								
1	36	0	0	0	0	36	36	0
2	0	0	305	46	46	305	351	305
3	0	0	12	19	19	12	31	12
TOTAL for R-3303A	36	0	317	65	65	353	418	317
R-3303B								
1	39	28	0	0	28	39	67	0
2	76	32	0	0	32	76	108	0
TOTAL for R-3303B	115	60	0	0	60	115	175	0
TOTAL FOR PROJECT	151	60	317	65	125	468	593	317

Total Stream Impact for Project: 593 linear feet

Wetland Impacts in the Cape Fear River Basin

Site	Permanent Fill (acres)	Fill (temporary) (acres)	Excavation (acres)	Mechanized Clearing (acres)	Hand Clearing (acres)	Area under Bridge (acres)	Total Wetland Impact (acres)
R-3303A							
1	<0.01	0	0	0.02	0	0	0.03
2	0	0	0	0	0	0	0
3	0	0	0	0	0	0	0
TOTAL for R-3303A	0.01	0	0	0.02	0	0	0.03
R-3303B							
1	0	0	0	0	0	0	0
2	0	0	0	0	0	0	0
TOTAL for R-3303B	0	0	0	0	0	0	0
TOTAL FOR PROJECT	0.01	0	0	0.02	0	0	0.03

Total Wetland Impact for Project: 0.03 acres.



The application provides adequate assurance that the discharge of fill material into the waters of the Cape Fear River Basin in conjunction with the proposed development will not result in a violation of applicable Water Quality Standards and discharge guidelines. Therefore, the State of North Carolina certifies that this activity will not violate the applicable portions of Sections 301, 302, 303, 306, 307 of PL 92-500 and PL 95-217 if conducted in accordance with the application and conditions hereinafter set forth.

This approval is only valid for the purpose and design that you submitted in your application dated received April 15, 2008. Should your project change, you are required to notify the DWQ and submit a new application. If the property is sold, the new owner must be given a copy of this Certification and approval letter, and is thereby responsible for complying with all the conditions. If any additional wetland impacts, or stream impacts, for this project (now or in the future) exceed one acre or 150 linear feet, respectively, additional compensatory mitigation may be required as described in 15A NCAC 2H .0506 (h) (6) and (7). For this approval to remain valid, you are required to comply with all the conditions listed below. In addition, you should obtain all other federal, state or local permits before proceeding with your project including (but not limited to) Sediment and Erosion control, Coastal Stormwater, Non-discharge and Water Supply watershed regulations. This Certification shall expire on the same day as the expiration date of the corresponding Corps of Engineers Permit.

Conditions of Certification:

1. With exception to the double pipe extension at Site 3, placement of culverts and other structures in waters, streams, and wetlands shall be placed below the elevation of the streambed by one foot for all culverts with a diameter greater than 48 inches, and 20 percent of the culvert diameter for culverts having a diameter less than 48 inches, to allow low flow passage of water and aquatic life. Design and placement of culverts and other structures including temporary erosion control measures shall not be conducted in a manner that may result in dis-equilibrium of wetlands or streambeds or banks, adjacent to or upstream and down stream of the above structures. The applicant is required to provide evidence that the equilibrium is being maintained if requested in writing by DWQ. If this condition is unable to be met at other sites due to bedrock or other limiting features encountered during construction, please contact the NC DWQ for guidance on how to proceed and to determine whether or not a modification to this certification will be required.
2. Where multiple pipes or barrels are required, they shall be designed to mimic natural stream cross section as closely as possible including pipes or barrels at flood plain elevation and/or sills where appropriate. Widening the stream channel shall be avoided. Stream channel widening at the inlet or outlet end of structures typically decreases water velocity causing sediment deposition that requires increased maintenance and disrupts aquatic life passage.
3. The use of rip-rap above the Normal High Water Mark shall be minimized. Any rip-rap placed for stream stabilization shall be placed in stream channels in such a manner that it does not impede aquatic life passage. Bioengineering boulders or structures shall be properly designed, sized and installed.
4. No rock, sand or other materials shall be dredged from the stream channel except where authorized by this certification.
5. If concrete is used during construction, a dry work area shall be maintained to prevent direct contact between curing concrete and stream water. Water that inadvertently contacts uncured concrete shall not be discharged to surface waters due to the potential for elevated pH and possible aquatic life and fish kills.
6. During the construction of the project, no staging of equipment of any kind is permitted in waters of the U.S.
7. Heavy equipment shall be operated from the banks rather than in the stream channel in order to minimize sedimentation and reduce the introduction of other pollutants into the stream.



8. All mechanized equipment operated near surface waters must be regularly inspected and maintained to prevent contamination of stream waters from fuels, lubricants, hydraulic fluids, or other toxic materials.
9. The dimension, pattern and profile of the stream above and below the crossing shall not be modified. Disturbed floodplains and streams shall be restored to natural geomorphic conditions.
10. Tall fescue should not be used in riparian areas. NCDOT should utilize onsite vegetation and materials for bank stabilization when practicable. Erosion control matting should be used on banks and steep slopes instead of straw mulch and should be well anchored with 12" staples, wooden survey stakes, or live stakes.
11. All work in or adjacent to stream waters shall be conducted in a dry work area. Approved BMP measures from the most current version of NCDOT Construction and Maintenance Activities manual such as sandbags, rock berms, cofferdams and other diversion structures shall be used to prevent excavation in flowing water.
12. Discharging hydroseed mixtures and washing out hydroseeders and other equipment in or adjacent to surface waters is prohibited.
13. The permittee and its authorized agents shall conduct its activities in a manner consistent with State water quality standards (including any requirements resulting from compliance with §303(d) of the Clean Water Act) and any other appropriate requirements of State and Federal law. If DWQ determines that such standards or laws are not being met (including the failure to sustain a designated or achieved use) or that State or federal law is being violated, or that further conditions are necessary to assure compliance, DWQ may re-evaluate and modify this certification.
14. All fill slopes located in jurisdictional wetlands shall be placed at slopes no flatter than 3:1, unless otherwise authorized by this certification.
15. The outside buffer, wetland or water boundary located within the construction corridor approved by this certification shall be clearly marked by highly visible fencing prior to any land disturbing activities. Impacts to areas within the fencing are prohibited unless otherwise authorized by this certification.
16. Native riparian vegetation must be re-established within the construction limits of the project by the end of the growing season following completion of construction.
17. There shall be no excavation from, or waste disposal into, jurisdictional wetlands or waters associated with this certification without appropriate modification. Should waste or borrow sites, or access roads to waste or borrow sites, be located in wetlands or streams, compensatory mitigation will be required since that is a direct impact from road construction activities.
18. Sediment and erosion control measures shall not be placed in wetlands or waters unless otherwise approved by this Certification.
19. Erosion and sediment control practices must be in full compliance with all specifications governing the proper design, installation and operation and maintenance of such Best Management Practices in order to protect surface waters standards:
 - a. The design, installation, operation, and maintenance of the sediment and erosion control measures must be such that they equal, or exceed, the requirements specified in the most recent version of the *North Carolina Sediment and Erosion Control Manual*. The devices shall be maintained on all construction sites, borrow sites, and waste pile (spoil) projects, including contractor-owned or leased borrow pits associated with the project.



- b. The erosion and sediment control measures for the project must be designed, installed, operated, and maintained in accordance with the most recent version of the *North Carolina Sediment and Erosion Control Planning and Design Manual*.
 - c. For borrow pit sites, the erosion and sediment control measures must be designed, installed, operated, and maintained in accordance with the most recent version of the *North Carolina Surface Mining Manual*.
 - d. The reclamation measures and implementation must comply with the reclamation in accordance with the requirements of the Sedimentation Pollution Control Act.
- * 20. The Permittee shall ensure that the final design drawings adhere to the certification and to the drawings submitted for approval.
21. The issuance of this certification does not exempt the Permittee from complying with any and all statutes, rules, regulations, or ordinances that may be imposed by other government agencies (i.e. local, state, and federal) having jurisdiction, including but not limited to applicable buffer rules, stormwater management rules, soil erosion and sedimentation control requirements, etc.
22. A copy of this Water Quality Certification shall be maintained on site at the construction site at all times. In addition, the Water Quality Certification and all subsequent modifications, if any, shall be maintained with the Division Engineer and the on-site project manager.
- * 23. Upon completion of the project (including any impacts at associated borrow or waste site), the NCDOT Division Engineer shall complete and return the enclosed "Certification of Completion Form" to notify DWQ when all work included in the 401 Certification has been completed.
24. The Permittee shall report any violations of this certification to the Division of Water Quality within 24 hours of discovery.

Violations of any condition herein set forth may result in revocation of this Certification and may result in criminal and/or civil penalties. This Certification shall become null and void unless the above conditions are made conditions of the Federal 404 and/or Coastal Area Management Act Permit. This Certification shall expire upon the expiration of the 404 or CAMA permit.

If this Certification is unacceptable to you have the right to an adjudicatory hearing upon written request within sixty (60) days following receipt of this Certification. This request must be in the form of a written petition conforming to Chapter 150B of the North Carolina General Statutes and filed with the Office of Administrative Hearings, 6714 Mail Service Center, Raleigh, N.C. 27699-6714. If modifications are made to an original Certification, you have the right to an adjudicatory hearing on the modifications upon written request within sixty (60) days following receipt of the Certification. Unless such demands are made, this Certification shall be final and binding.

This the 25th day of July 2008

DIVISION OF WATER QUALITY

Coleen Sullins
Director

WQC No. 3750

Applicant: NORTH CAROLINA DEPARTMENT OF TRANSPORTATION, MR. GREG THROPE	File Number: SAW2008-01454	Date: January 13, 2009
Attached is:		See Section below
<input type="checkbox"/> INITIAL PROFFERED PERMIT (Standard Permit or Letter of permission)		A
<input checked="" type="checkbox"/> PROFFERED PERMIT (Standard Permit or Letter of permission)		B
<input type="checkbox"/> PERMIT DENIAL		C
<input type="checkbox"/> APPROVED JURISDICTIONAL DETERMINATION		D
<input type="checkbox"/> PRELIMINARY JURISDICTIONAL DETERMINATION		E

A: INITIAL PROFFERED PERMIT: You may accept or object to the permit.

- **ACCEPT:** If you received a Standard Permit, you may sign the permit document and return it to the district engineer for final authorization. If you received a Letter of Permission (LOP), you may accept the LOP and your work is authorized. Your signature on the Standard Permit or acceptance of the LOP means that you accept the permit in its entirety, and waive all rights to appeal the permit, including its terms and conditions, and approved jurisdictional determinations associated with the permit.
- **OBJECT:** If you object to the permit (Standard or LOP) because of certain terms and conditions therein, you may request that the permit be modified accordingly. You must complete Section II of this form and return the form to the district engineer. Your objections must be received by the district engineer within 60 days of the date of this notice, or you will forfeit your right to appeal the permit in the future. Upon receipt of your letter, the district engineer will evaluate your objections and may: (a) modify the permit to address all of your concerns, (b) modify the permit to address some of your objections, or (c) not modify the permit having determined that the permit should be issued as previously written. After evaluating your objections, the district engineer will send you a proffered permit for your reconsideration, as indicated in Section B below.

B: PROFFERED PERMIT: You may accept or appeal the permit

- **ACCEPT:** If you received a Standard Permit, you may sign the permit document and return it to the district engineer for final authorization. If you received a Letter of Permission (LOP), you may accept the LOP and your work is authorized. Your signature on the Standard Permit or acceptance of the LOP means that you accept the permit in its entirety, and waive all rights to appeal the permit, including its terms and conditions, and approved jurisdictional determinations associated with the permit.
- **APPEAL:** If you choose to decline the proffered permit (Standard or LOP) because of certain terms and conditions therein, you may appeal the declined permit under the Corps of Engineers Administrative Appeal Process by completing Section II of this form and sending the form to the division engineer. This form must be received by the division engineer within 60 days of the date of this notice.

C: PERMIT DENIAL: You may appeal the denial of a permit under the Corps of Engineers Administrative Appeal Process by completing Section II of this form and sending the form to the division engineer. This form must be received by the division engineer within 60 days of the date of this notice.

D: APPROVED JURISDICTIONAL DETERMINATION: You may accept or appeal the approved JD or provide new information.

- **ACCEPT:** You do not need to notify the Corps to accept an approved JD. Failure to notify the Corps within 60 days of the date of this notice, means that you accept the approved JD in its entirety, and waive all rights to appeal the approved JD.
- **APPEAL:** If you disagree with the approved JD, you may appeal the approved JD under the Corps of Engineers Administrative Appeal Process by completing Section II of this form and sending the form to the district engineer. This form must be received by the division engineer within 60 days of the date of this notice.

E: PRELIMINARY JURISDICTIONAL DETERMINATION: You do not need to respond to the Corps regarding the preliminary JD. The Preliminary JD is not appealable. If you wish, you may request an approved JD (which may be appealed), by contacting the Corps district for further instruction. Also you may provide new information for further consideration by the Corps to reevaluate the JD.

SECTION II: REQUEST FOR APPEAL or OBJECTIONS TO AN INITIAL PROFFERED PERMIT

REASONS FOR APPEAL OR OBJECTIONS: (Describe your reasons for appealing the decision or your objections to an initial proffered permit in clear concise statements. You may attach additional information to this form to clarify where your reasons or objections are addressed in the administrative record.)

ADDITIONAL INFORMATION: The appeal is limited to a review of the administrative record, the Corps memorandum for the record of the appeal conference or meeting, and any supplemental information that the review officer has determined is needed to clarify the administrative record. Neither the appellant nor the Corps may add new information or analyses to the record. However, you may provide additional information to clarify the location of information that is already in the administrative record.

POINT OF CONTACT FOR QUESTIONS OR INFORMATION:

If you have questions regarding this decision and/or the appeal process you may contact:
 Andrew Williams, Regulatory Project Manager
 Raleigh Regulatory Field Office
 U.S. Army Corps of Engineers
 3331 Heritage Trade Drive, Suite 105
 Wake Forest, North Carolina 27587

If you only have questions regarding the appeal process you may also contact:
 Mr. Mike Bell, Administrative Appeal Review Officer
 CESAD-ET-CO-R
 U.S. Army Corps of Engineers, South Atlantic Division
 60 Forsyth Street, Room 9M15
 Atlanta, Georgia 30303-8801

RIGHT OF ENTRY: Your signature below grants the right of entry to Corps of Engineers personnel, and any government consultants, to conduct investigations of the project site during the course of the appeal process. You will be provided a 15 day notice of any site investigation, and will have the opportunity to participate in all site investigations.

_____ Signature of appellant or agent.	Date:	Telephone number:
---	-------	-------------------

For appeals on Initial Proffered Permits and approved Jurisdictional Determinations send this form to:

District Engineer, Wilmington Regulatory Division, Attn: Andrew Williams, Project Manager, Raleigh Regulatory Field Office, 3331 Heritage Trade Drive, Suite 105, Wake Forest, North Carolina 27587

For Permit denials and Proffered Permits send this form to:

Division Engineer, Commander, U.S. Army Engineer Division, South Atlantic, Attn: Mr. Mike Bell, Administrative Appeal Officer, CESAD-ET-CO-R, 60 Forsyth Street, Room 9M15, Atlanta, Georgia 30303-8801



*Certificate of Completion

DWQ Project No.: _____ County: _____

Applicant: _____

Project Name: _____

Date of Issuance of 401 Water Quality Certification: _____

Upon completion of all work approved within the 401 Water Quality Certification or applicable Buffer Rules, and any subsequent modifications, the applicant is required to return this certificate to the 401/Wetlands Unit, North Carolina Division of Water Quality, 1650 Mail Service Center, Raleigh, NC, 27699-1650. This form may be returned to DWQ by the applicant, the applicant's authorized agent, or the project engineer. It is not necessary to send certificates from all of these.

Applicant's Certification

I, _____, hereby state that, to the best of my abilities, due care and diligence was used in the observation of the construction such that the construction was observed to be built within substantial compliance and intent of the 401 Water Quality Certification and Buffer Rules, the approved plans and specifications, and other supporting materials.

Signature: _____ Date: _____

Agent's Certification

I, _____, hereby state that, to the best of my abilities, due care and diligence was used in the observation of the construction such that the construction was observed to be built within substantial compliance and intent of the 401 Water Quality Certification and Buffer Rules, the approved plans and specifications, and other supporting materials.

Signature: _____ Date: _____

If this project was designed by a Certified Professional

I, _____, as a duly registered Professional _____ (i.e., Engineer, Landscape Architect, Surveyor, etc.) in the State of North Carolina, having been authorized to observe (periodically, weekly, full time) the construction of the project, for the Permittee hereby state that, to the best of my abilities, due care and diligence was used in the observation of the construction such that the construction was observed to be built within substantial compliance and intent of the 401 Water Quality Certification and Buffer Rules, the approved plans and specifications, and other supporting materials.

Signature: _____ Registration No.: _____

Date: _____

Mclamb, Erica S

From: Williams, Andrew E SAW [Andrew.E.Williams@saw02.usace.army.mil]
Sent: Wednesday, January 21, 2009 11:37 AM
To: Mclamb, Erica S
Subject: RE: Culvert waiver

Erica,

Based on the information provided, the proposed extension of the two 36-inch RCPs at Site 3, Section U-3303A, do not have to be buried. If the project is constructed according to the approved plans for Site 3, failure to bury the pipes at this location will not result in non-compliance with the permit condition.

Please contact me if you have any questions. Thanks.

Andrew Williams
Regulatory Project Manager
U.S. Army Corps of Engineers
Wilmington District, Raleigh Field Office
3331 Heritage Trade Drive, Suite 105
Wake Forest, North Carolina 27587
919-554-4884 ext. 26

-----Original Message-----

From: Mclamb, Erica S [mailto:emclamb@ncdot.gov]
Sent: Wednesday, January 21, 2009 10:58 AM
To: Williams, Andrew E SAW
Subject: Culvert waiver

Andy,

In section U-3303 A, site 3, as stated in the permit application NCDOT will not bury the extension of two 36-inch RCPs to the north of Mebane Street. These pipes cannot be buried 20 percent due to the existing pipes and bed elevations. that pipe due to existing pipe and streambed elevations. NCDOT will need a waiver to this condition as soon as possible.

Erica McLamb
Environmental Specialist, NCDOT
919-431-1595

E-mail correspondence to and from this address may be subject to the North Carolina Public Records Law (GS 132) and may be disclosed to third parties by an authorized state official.

Email correspondence to and from this sender is subject to the N.C. Public Records Law and may be disclosed to third parties.

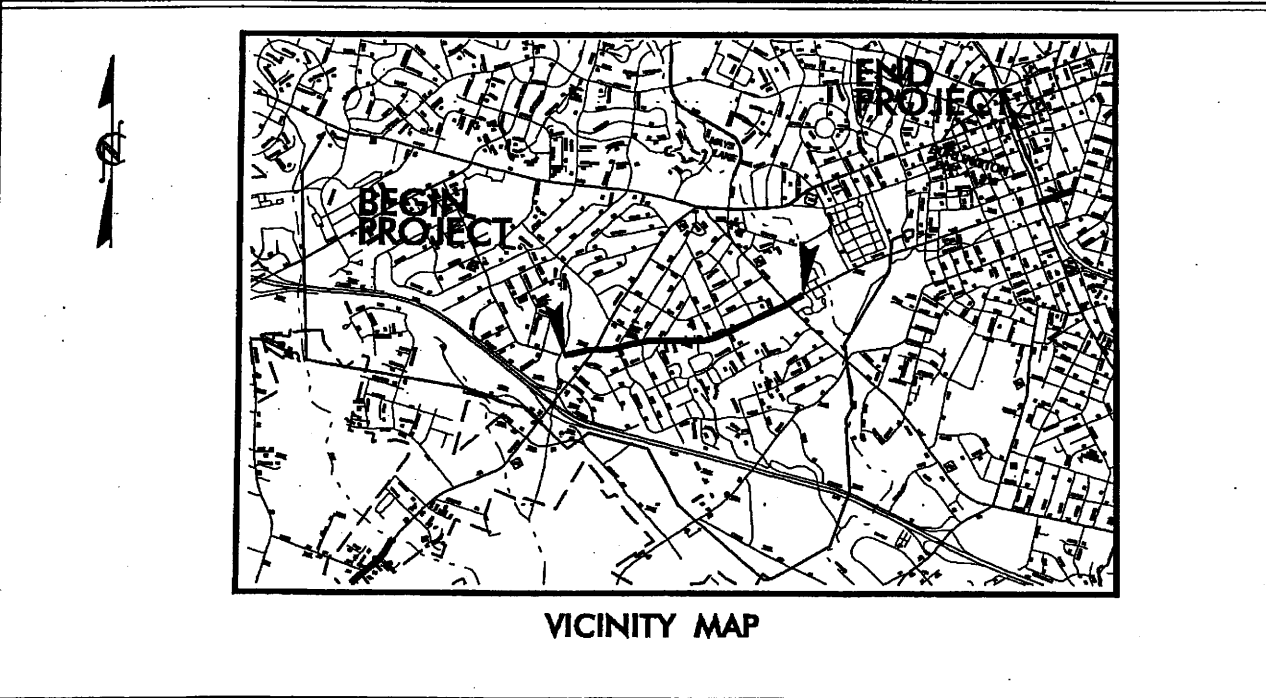
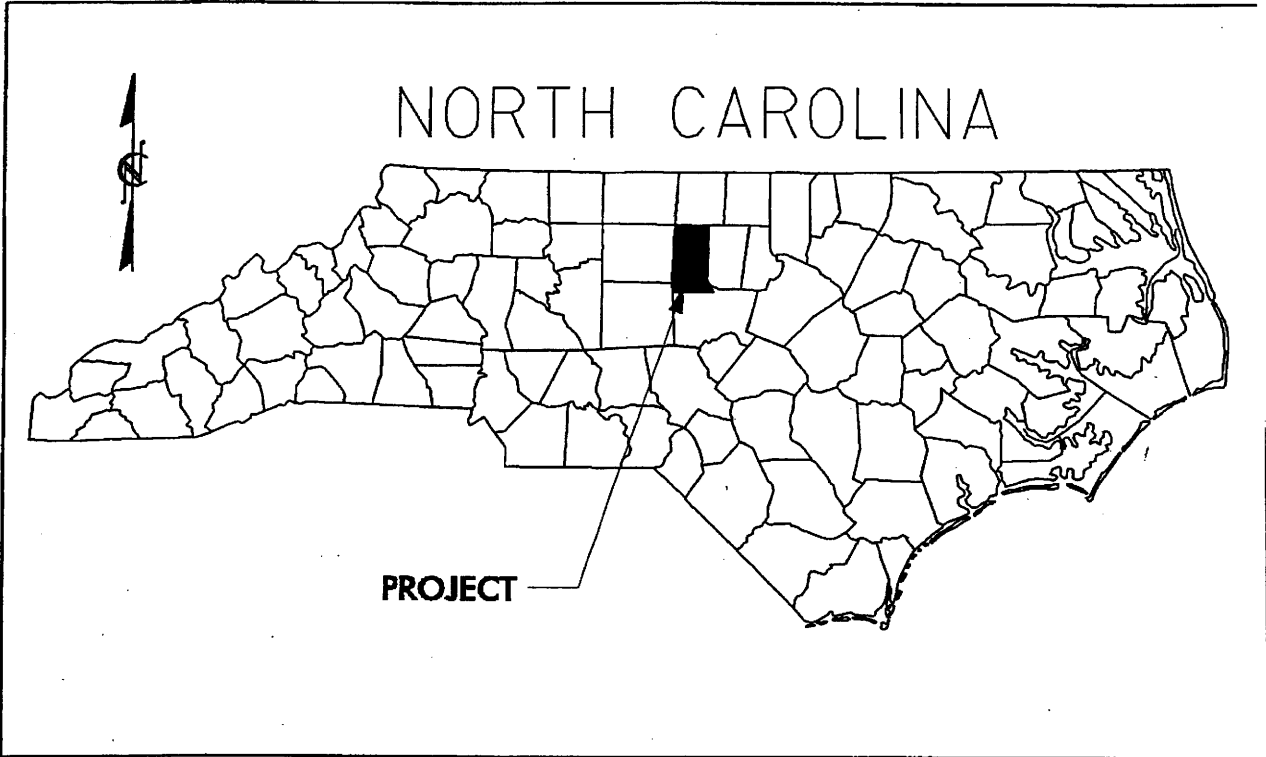

VICINITY
MAPS

NCDOT

DIVISION OF HIGHWAYS
ALAMANCE COUNTY
PROJECT: 34911.1.1 (U-3303B)
BURLINGTON-SR 1306-1363
(SOUTH MEBANE ST)
FROM NC 62 TO NC 54
(CHAPEL HILL RD)

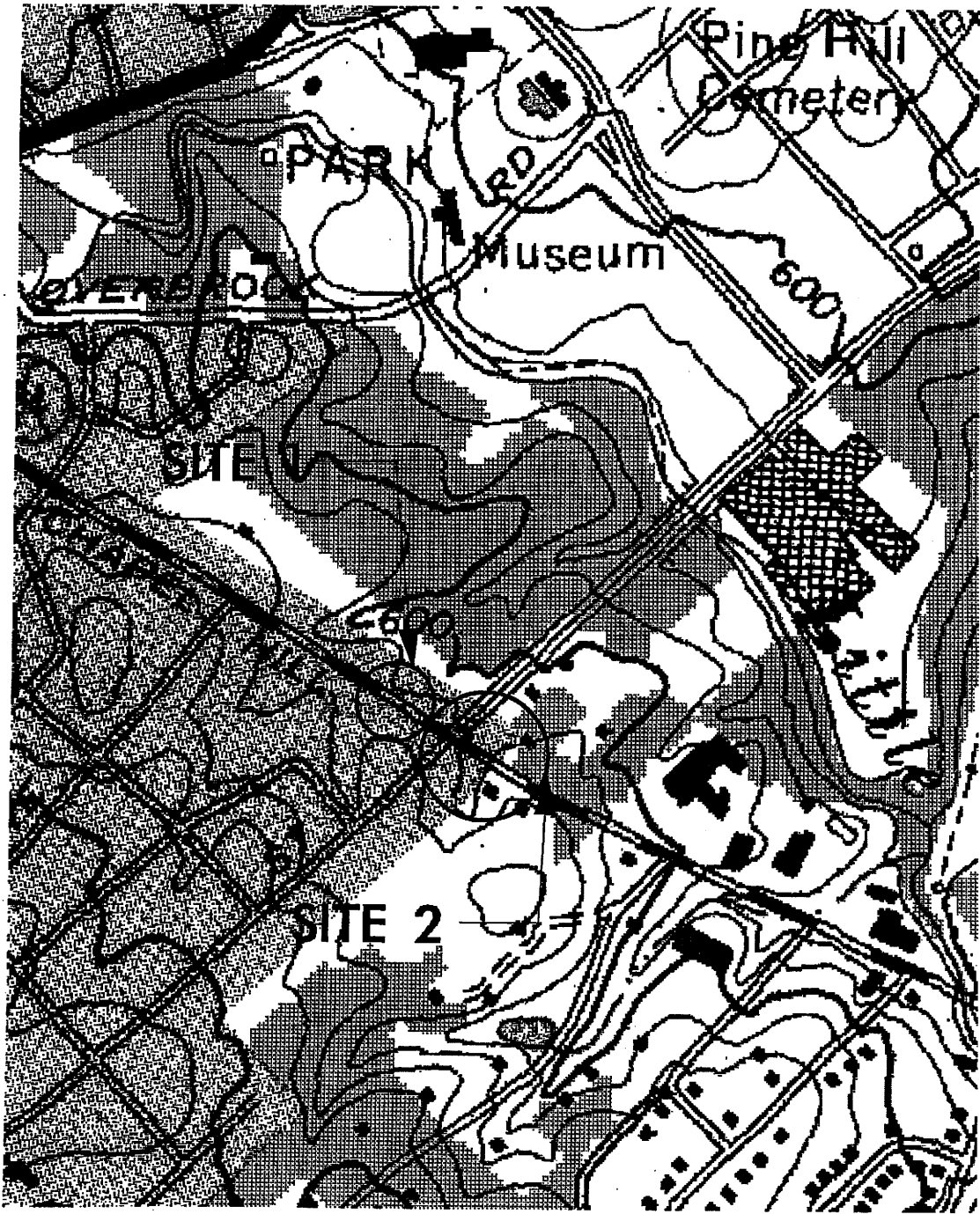

SITE
MAP

NCDOT

DIVISION OF HIGHWAYS
ALAMANCE COUNTY
PROJECT: 34911.11 (U-3303B)
BURLINGTON-SR 1306-1363
(SOUTH MEBANE ST.)
FROM NC 62 TO NC 54
(CHAPEL HILL RD)

PROPERTY OWNERS

NAMES AND ADDRESSES

PARCEL NO.	NAMES	ADDRESSES
101	THE CITY OF BURLINGTON	PO BOX 1358 BURLINGTON, NC 27216
104	WILLIAM SKELTON HEIRS	1540 S.MEBANE ST. BURLINGTON, NC 27215
99	ELOISE BRYAN	BOX 1118 BURLINGTON, NC 27216
97	AMY GILLAND	432 CHAPEL HILL RD. BURLINGTON, NC 27215

NCDOT
DIVISION OF HIGHWAYS
ALAMANCE COUNTY
PROJECT: 34911.1.1 (U-3303B)
BURLINGTON-SR 1306-1363
(SOUTH MEBANE ST.)
FROM NC 62 TO NC 54
(CHAPEL HILL RD)
SHEET 3 OF 8 06 / 07 / 06

Permit Drawing
 Sheet 8 of 8

SITE 2
 UT To Little Alamance Creek

 DENOTES FILL IN SURFACE WATER
 DENOTES TEMPORARY FILL IN SURFACE WATER

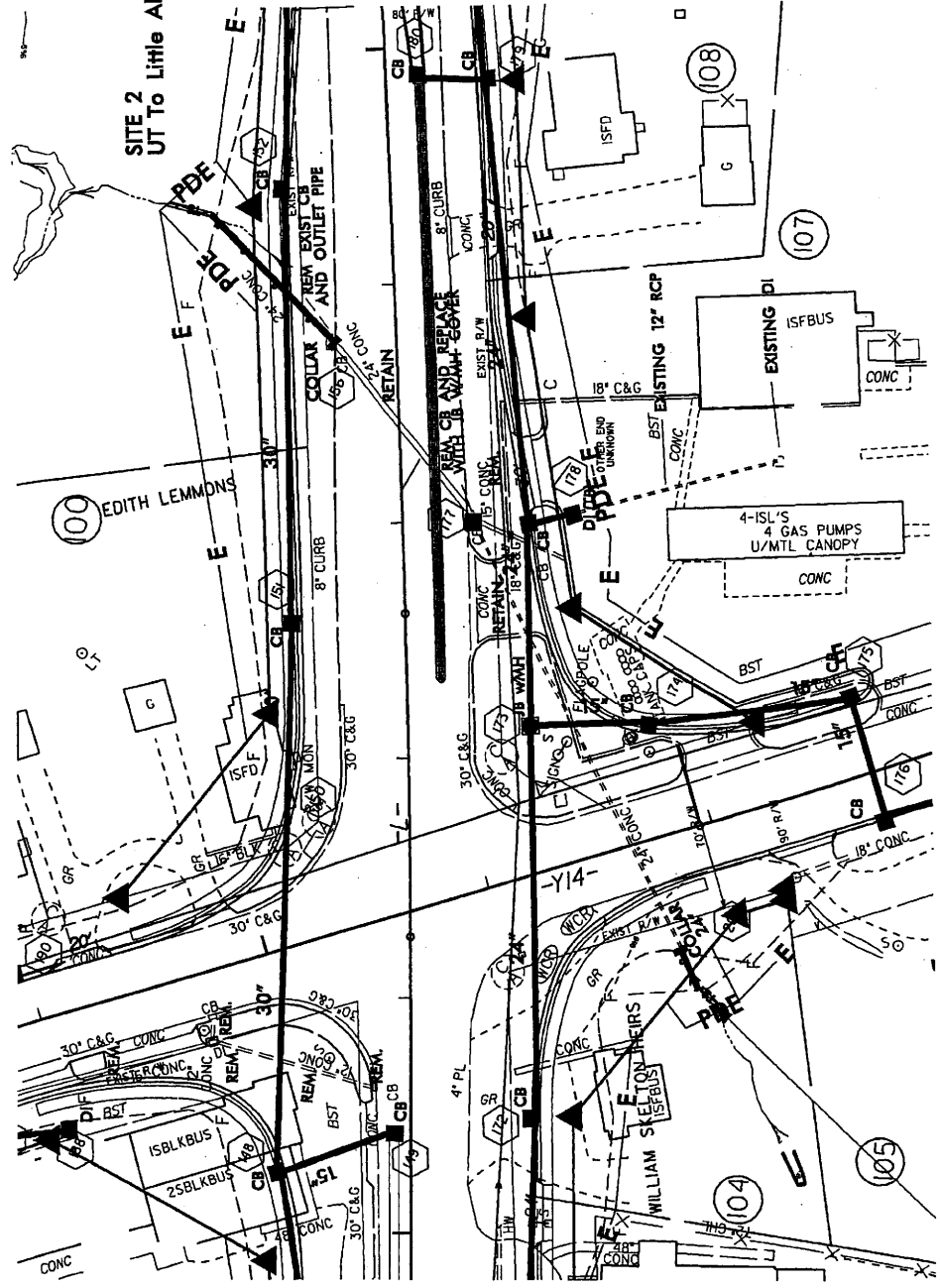
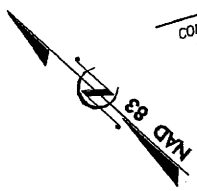

SITE 2
 UT To Little Alamance Creek



N.C. DEPT. OF TRANSPORTATION
DIVISION OF HIGHWAYS

ALAMANCE COUNTY
PROJECT: U-3306A

SHEET 1 OF 13

PROPERTY OWNERS

NAMES AND ADDRESSES

PARCEL NO.	SITE NO.	NAMES	ADDRESSES
29	1	Herald Fogleman C/O GPIN 3-21-193	1063 N. Riverview Dr. Burlington, NC 27217
18	1	PEC Family Lmt'd. Ptnrshp 201 C/O GPON 3-21-23	3530 Cardwell Drive Burlington, NC 27215
37	2	M. Amjad Bhatti C/O GPIN 12-13-69A	3210 Elk Drive Burlington, NC 27215
40	2	Wanyette Bridges C/O GPIN 12-13-70A	3340 Neptune Drive Las Cruces, NM 88012
46	2	Belkis Espaillet C/O GPIN 12-13-49	2702 May Drive Burlington, NC 27215
48	2	Marion Howe C/O GPIN 12-13-48	2701 Terrace Drive Burlington, NC 27215
74	3	Keystone Group, Inc.	3708 Alliance Dr. Greensboro, NC 27407
20	20	Andrew J. Gregory	1810 Chester Rd. Raleigh, NC 27608

N.C. DEPT. OF TRANSPORTATION
DIVISION OF HIGHWAYS

ALAMANCE COUNTY
PROJECT: U-3303A

SHEET 2 OF 13

WETLAND PERMIT IMPACT SUMMARY														
Site No.	Station (From/To)	Structure Size / Type	WETLAND IMPACTS				SURFACE WATER IMPACTS							
			Permanent Fill in Wetlands (ac)	Temp. Fill in Wetlands (ac)	Excavation in Wetlands (ac)	Mechanized Clearing in Wetlands (ac)	Hand Clearing in Wetlands (ac)	Permanent SW impacts (ac)	Temp. SW impacts (ac)	Existing Channel Impacts Permanent (ft)	Existing Channel Impacts Temp. (ft)	Natural Stream Design (ft)		
1	27+22 LT to 28+40 RT -L-	Roadway Fill	<0.01			0.02						36		
2	40+94 LT to 43+83 RT -L-	60" & 66" RCP							0.04			305	46	
3	72+38 -L-	Extend 2 @ 36" RCP										12	19	
TOTALS:			<0.01			0.02			0.04			353	65	

NC DEPARTMENT OF TRANSPORTATION
 DIVISION OF HIGHWAYS
 ALAMANCE COUNTY
 PROJECT: 34911.1.1 (U-3303A)
 WIDEN S. MEBANE ST
 3 of 13
 March-08

STATE	N.C.	PROJECT NUMBER	U-3303A	SHEET NO.	1
DATE	3/4/07	SCALE	AS SHOWN	PROJECT	TIP PROJECT U-3303A
DESIGNER	3/4/07	DATE	3/4/07	PROJECT	TIP PROJECT U-3303A
CHECKER	3/4/07	DATE	3/4/07	PROJECT	TIP PROJECT U-3303A
APPROVER	3/4/07	DATE	3/4/07	PROJECT	TIP PROJECT U-3303A

Permit Drawing
Sheet 1 of 13

STATE OF NORTH CAROLINA
DIVISION OF HIGHWAYS

ALAMANCE COUNTY

LOCATION: BURLINGTON - SR 1306 (SOUTH MEBANE ST.)
FROM SR 1158 (HUFFMAN MILL RD.)
TO NC 62 (ALAMANCE RD.)

TYPE OF WORK: GRADING, DRAINAGE, WIDENING, PAVING,
CURB & GUTTER, SIDEWALK, SIGNALS, AND
SIGNING

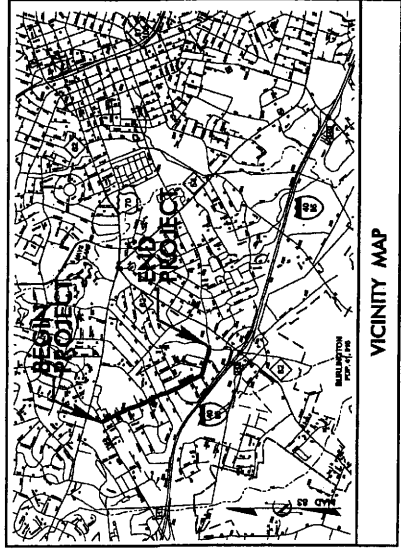

VICINITY MAP

149

STA. 76+35 -L- END TIP PROJECT U-3303A

STA. 10+00 -L- BEGIN TIP PROJECT U-3303A

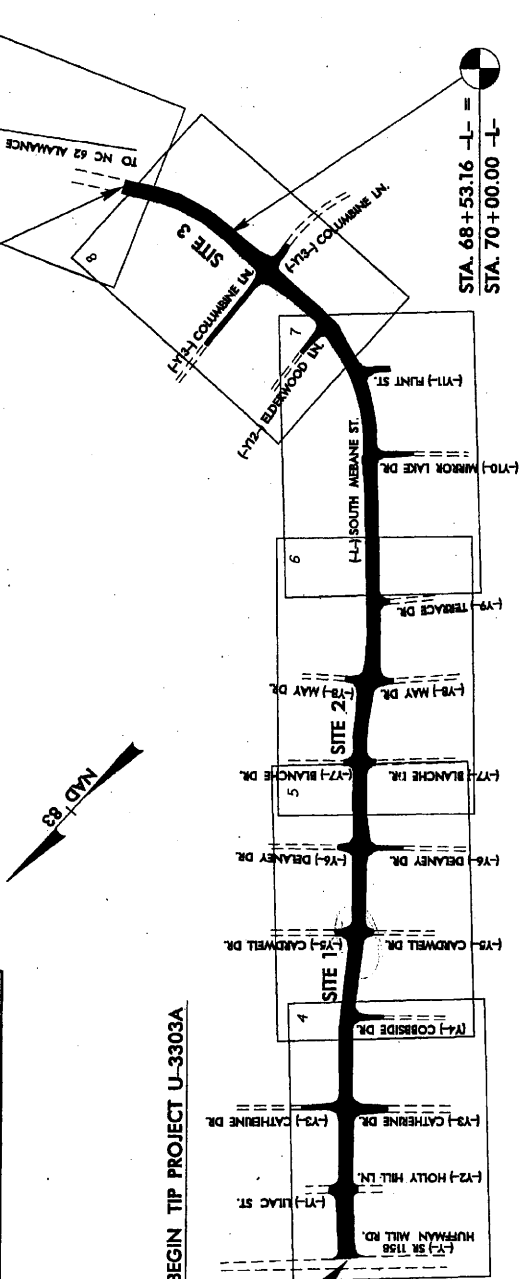

STA. 68+53.16 -L- =
STA. 70+00.00 -L-

CLEARING ON THIS PROJECT SHALL BE DONE ACCORDING TO METHOD II.
THIS PROJECT IS WITHIN THE MUNICIPAL BOUNDARIES OF BURLINGTON.

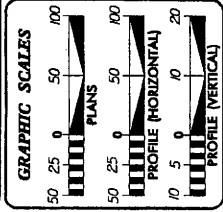

DESIGN DATA

ADT 2005	= 2175
ADT 2025	= 33,000
DIV	= 10 %
D	= 55 %
T	= 3 %
V	= 40 MPH
* TST 2% DUAL 1%	

PROJECT LENGTH
LENGTH ROADWAY F.A-PROJECT STP-30681 = 126 MI
TOTAL LENGTH STATE PROJECT 349141 = 126 MI

Prepared in the Office of
DIVISION OF HIGHWAYS
1400 Birch Side Dr., NC 27619

RIGHT OF WAY DATE:
January 19, 2007

LETTING DATE:
October 21, 2008

PROJECT MANAGER
JIMMY GOODNIGHT

PROJECT MANAGER
TIM GOINS

HYDRAULICS ENGINEER

ROADWAY DESIGN ENGINEER



CONTRACT: TIP PROJECT: U-3303A

See Sheet 1-A For Index of Sheets

PRELIMINARY PLANS
DO NOT USE FOR CONSTRUCTION

PROJECT NUMBER AND SHEET NO.	07-303A
DATE OF ISSUE	NOVEMBER 2008
PRELIMINARY PLANS	NO
FOR THE USE OF THE COMMISSIONER	NO

Permit Drawing
Sheet 6 of 13

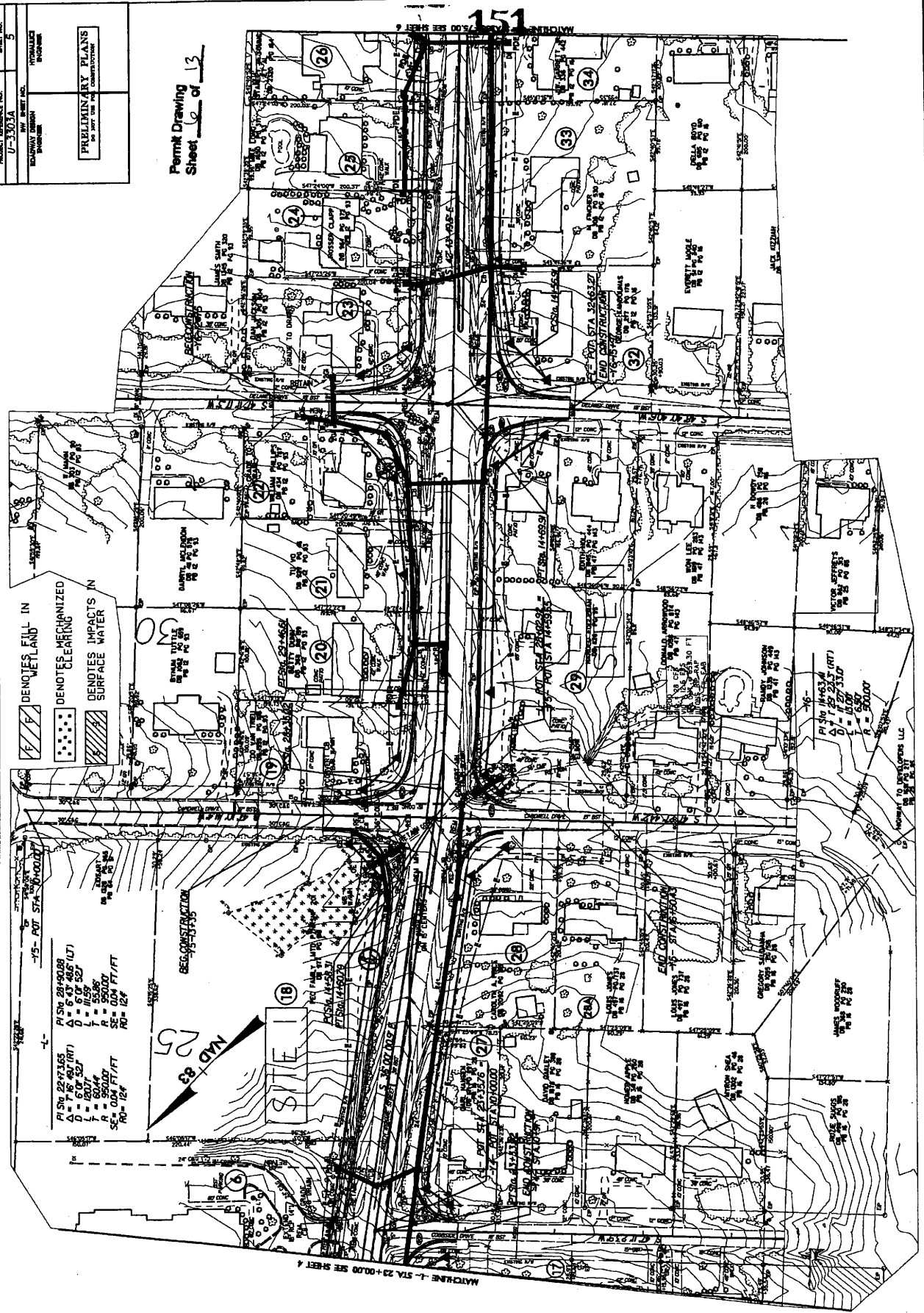

DENOTES FILL IN WETLAND
 DENOTES MECHANIZED CLEARING
 DENOTES IMPACTS IN SURFACE WATER

PI STA 22+77.65
 D = 60'
 L = 120'
 P = 50.00'
 SE = 0.04 FT/FT
 RO = 12°

PI STA 28+50.88
 D = 60'
 L = 115.9'
 P = 50.00'
 SE = 0.04 FT/FT
 RO = 12°

NAD 83
 88.25

MATCHLINE - STA. 23+00.00 SEE SHEET 4

B-MAR-2008 1552
 11-04-2008 11:22:15Z pds-5grn
 00011 81 112215Z pds-5grn

REVISIONS



B/17/79

STATION 26+00.00

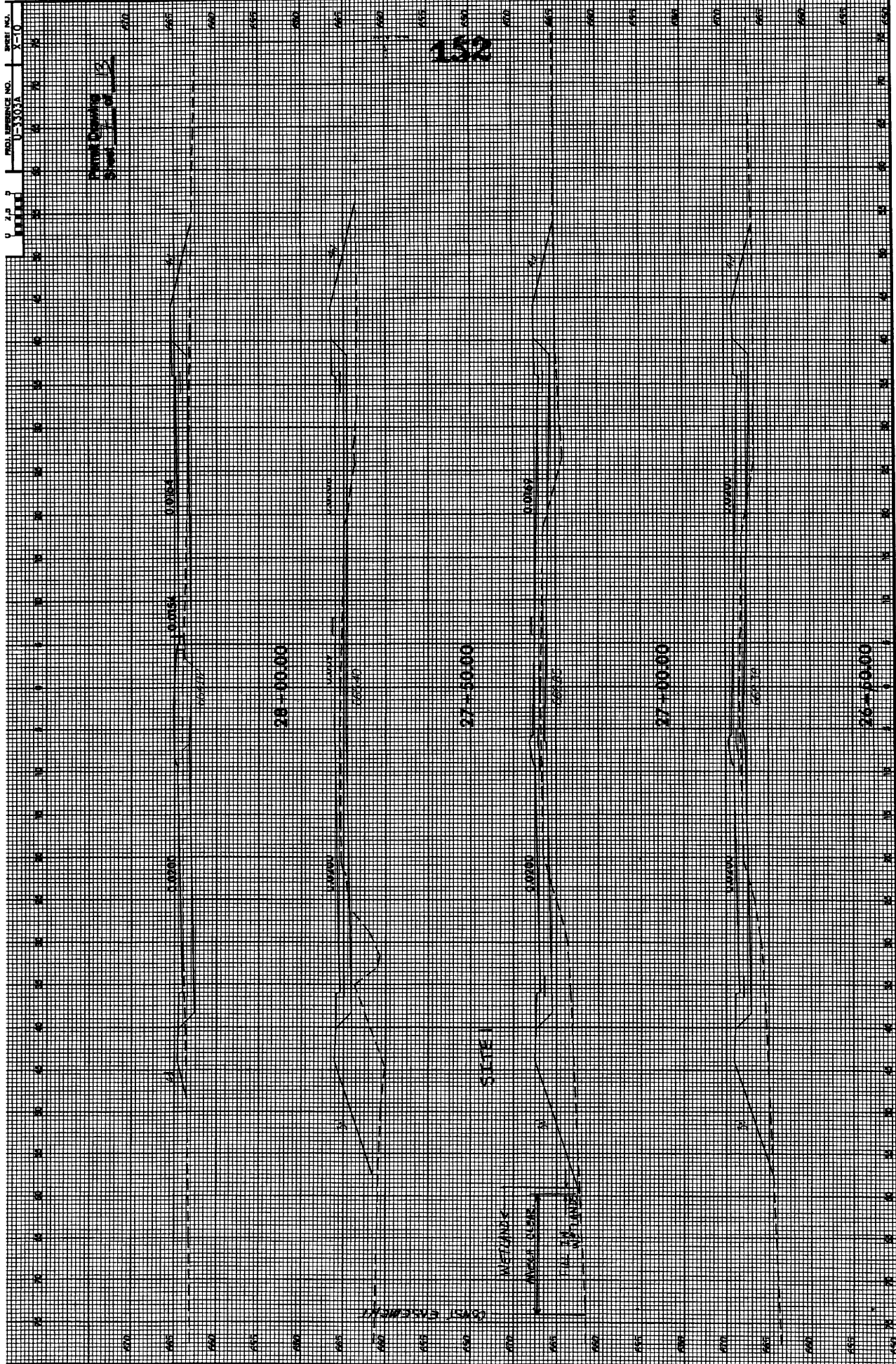
152



PROJECT REFERENCE NO. 1-100A	SHEET NO. 6
RDWAY DESIGN ENGINEER	WHEELER DEWALT
PRELIMINARY PLANS DO NOT BE USED FOR CONSTRUCTION	

 DENOTES IMPACTS IN SURFACE WATER
 DENOTES TEMPORARY IMPACTS IN SURFACE WATER

Permit Drawing
Sheet 9 of 13

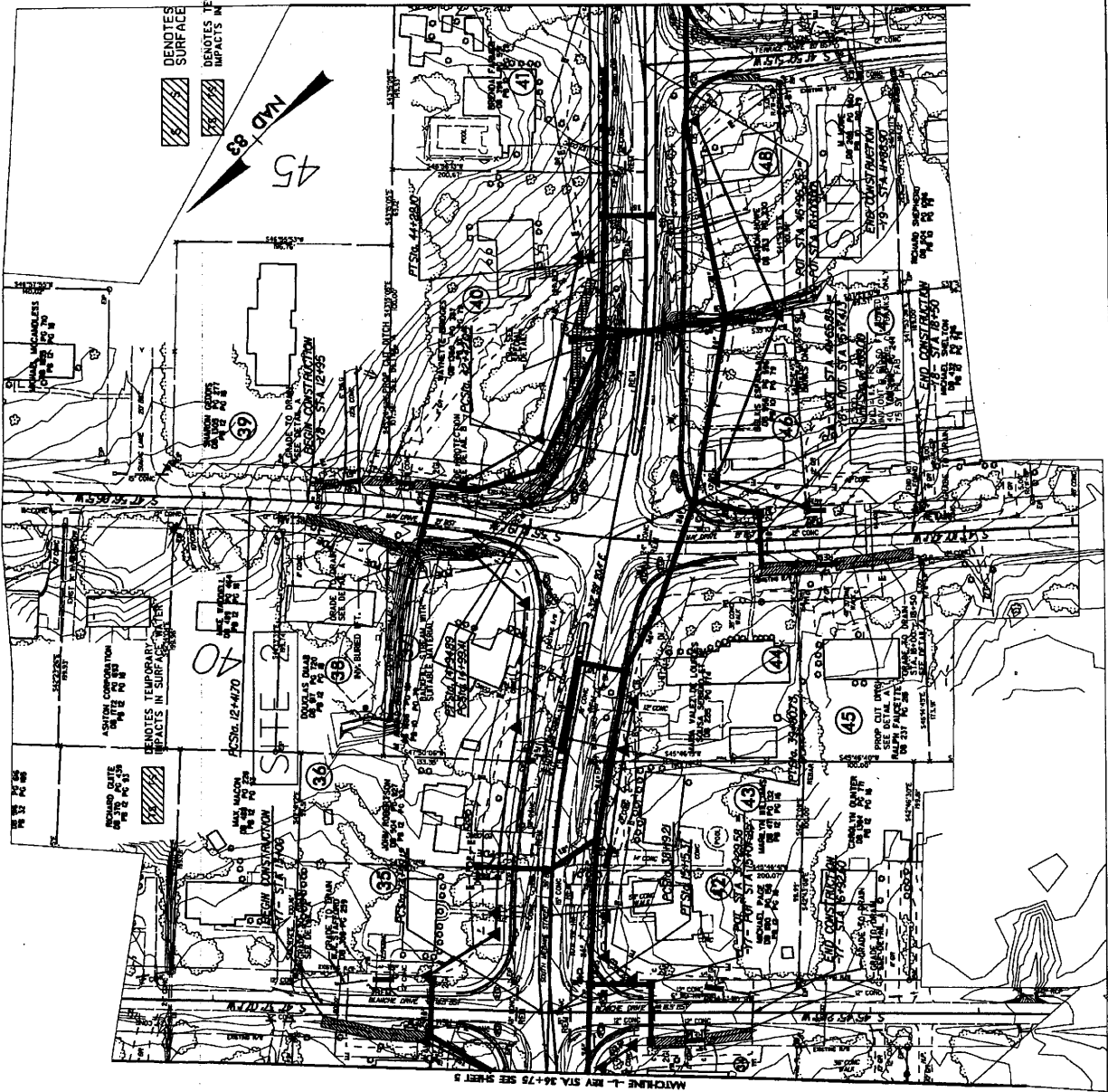

NO.	DATE	REVISIONS

18-MAR-2008 16:54
 C:\pwworking\WHEELER DEWALT\2008\154.dgn
 00111 31 11/22/07 2:38:09pm

SECTION 1

155

SECTION 2

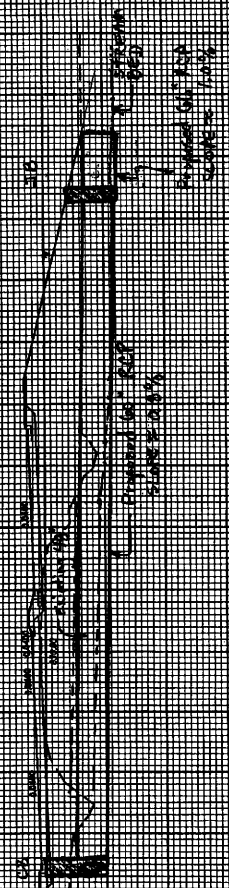

15-10-00

