

STATE OF NORTH CAROLINA
DIVISION OF HIGHWAYS

STATE PROJECT REFERENCE NO.	SHEET NO.
B-4239	TCP-1

**PLAN FOR PROPOSED
TRAFFIC CONTROL, MARKING & DELINEATION
POLK COUNTY**

B-4239

ROADWAY STANDARD DRAWINGS

THE FOLLOWING ROADWAY STANDARDS AS APPEAR IN "ROADWAY STANDARD DRAWINGS" - PROJECT SERVICES UNIT-N.C. DEPARTMENT OF TRANSPORTATION-RALEIGH, N.C., DATED JULY 2006 ARE APPLICABLE TO THIS PROJECT AND BY REFERENCE HEREBY ARE CONSIDERED A PART OF THESE PLANS:

STD. NO.	TITLE
1101.03	TEMPORARY ROAD CLOSURES
1101.05	WORK ZONE VEHICLE ACCESSES
1101.11	TRAFFIC CONTROL DESIGN TABLES
1110.01	STATIONARY WORK ZONE SIGNS
1130.01	DRUM
1145.01	BARRICADES
1205.01	PAVEMENT MARKINGS - LINE TYPES & OFFSETS
1205.02	PAVEMENT MARKINGS - 2 LANE & MULTILANE ROADWAYS
1205.12	PAVEMENT MARKINGS - BRIDGES
1261.01	GUARDRAIL & BARRIER DELINEATOR SPACING
1261.02	GUARDRAIL & BARRIER DELINEATOR TYPES
1262.01	GUARDRAIL END DELINEATION

INDEX OF SHEETS

SHEET NO.	TITLE
TCP-1	LIST OF APPLICABLE ROADWAY STANDARD DRAWINGS, LEGEND, INDEX OF SHEETS AND FINAL PAVEMENT MARKING SCHEDULE
TCP-2	GENERAL NOTES AND PHASING
TCP-3	TEMPORARY SOIL NAIL WALL LOCATIONS

LEGEND

- GENERAL**
- DIRECTION OF TRAFFIC FLOW
 - NORTH ARROW
 - PROPOSED PVMT. EXIST. PVMT.
 - WORK AREA
 - REMOVAL OF EXISTING PAVEMENT
- TRAFFIC CONTROL DEVICES**
- TYPE I BARRICADE
 - TYPE II BARRICADE
 - TYPE III BARRICADE
 - CONE
 - DRUM SKINNY DRUM
 - FLASHING ARROW PANEL (TYPE C)
 - STATIONARY SIGN
 - PORTABLE SIGN
 - STATIONARY OR PORTABLE SIGN
 - CRASH CUSHION
 - CHANGEABLE MESSAGE SIGN
 - TRUCK MOUNTED IMPACT ATTENUATOR (TMIA)
 - POLICE
 - FLAGGER
- PAVEMENT MARKINGS**
- CRYSTAL/CRYSTAL PAVEMENT MARKER
 - YELLOW/YELLOW PAVEMENT MARKER
 - CRYSTAL/RED PAVEMENT MARKER
 - PAVEMENT MARKING SYMBOLS

FINAL PAVEMENT MARKING SCHEDULE

SYMBOL	DESCRIPTION	PAY ITEM QUANTITY BREAKDOWN		TOTAL QUANTITY
		FINAL PAVEMENT MARKINGS		
PA	WHITE EDGELINE (2X)	PAINT (4")	1400 LF	
PI	YELLOW DOUBLE CENTER (2X)		1400 LF	
TOTAL			2800 LF	

NOTE: FOR EACH PAINT PAVEMENT MARKING ITEM, 1X IMPLIES A SINGLE APPLICATION, 2X IMPLIES TWO APPLICATIONS, AND 3X IMPLIES THREE APPLICATIONS.

APPROVED: _____ DATE: _____	PLAN PREPARED BY: N.C.D.O.T. WORK ZONE TRAFFIC CONTROL UNIT
	J. S. BOURNE, PE <i>TRAFFIC CONTROL ENGINEER</i>
	J. ISHAK, PE <i>TRAFFIC CONTROL PROJECT ENGINEER</i>
	J. L. PORTANOVA, PE <i>TRAFFIC CONTROL PROJECT DESIGN ENGINEER</i>
	J. FUTRELL <i>TRAFFIC CONTROL DESIGN ENGINEER</i>

TIP PROJECT:

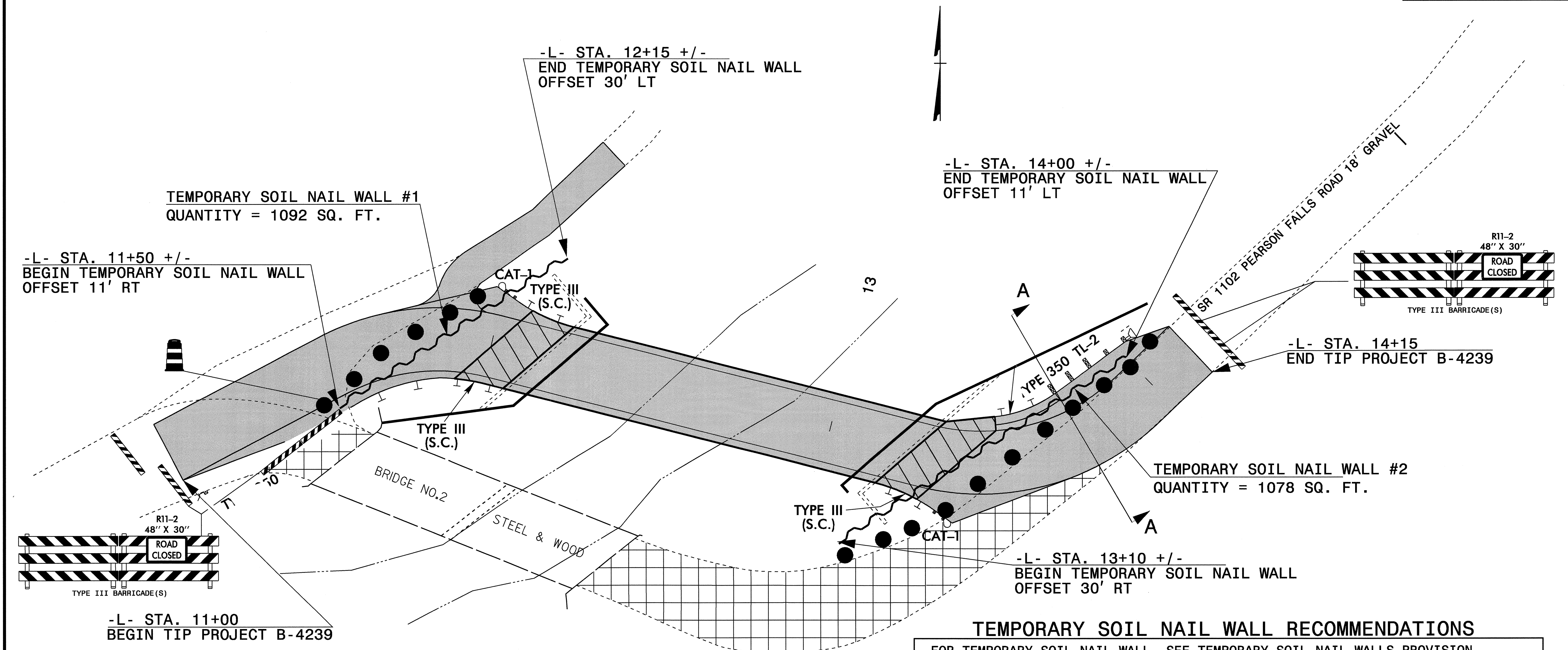

SECTION A - A

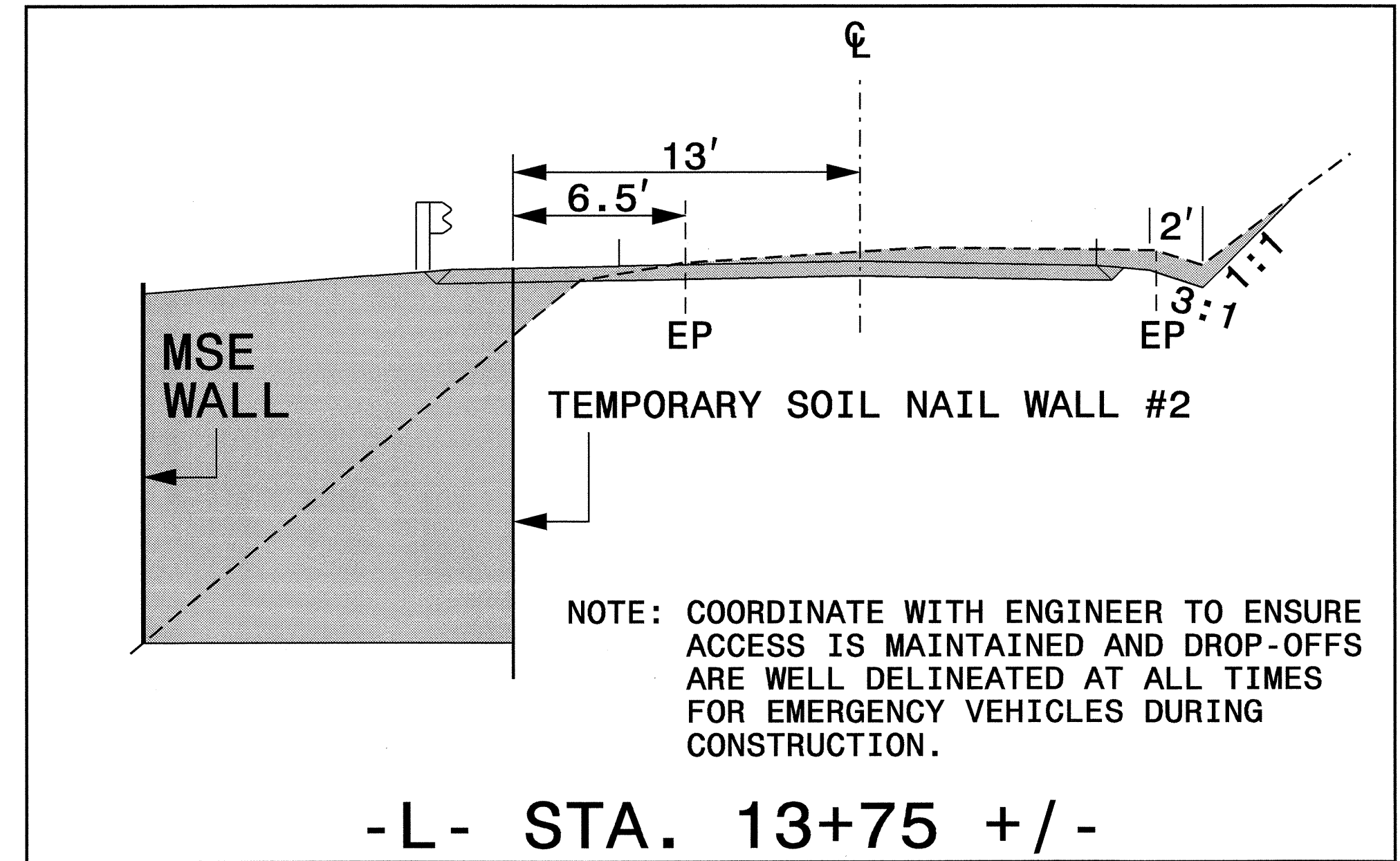

TEMPORARY SOIL NAIL WALL RECOMMENDATIONS

FOR TEMPORARY SOIL NAIL WALL, SEE TEMPORARY SOIL NAIL WALLS PROVISION.

USE THE FOLLOWING IN-SITU ASSUMED SOIL PARAMETERS FOR DESIGN OF TEMPORARY SOIL NAIL WALL:

UNIT WEIGHT OF SOIL ABOVE ELEVATION 1652, $\gamma = 115$ PCF
 UNIT WEIGHT OF SOIL BELOW ELEVATION 1652, $\gamma = 65$ PCF
 FRICTION ANGLE ABOVE ELEVATION 1652, $\phi = 28$ DEGREES
 FRICTION ANGLE BELOW ELEVATION 1652, $\phi = 35$ DEGREES
 COHESION, $c = 0$ PSF

SURVEY THE SHORING LOCATION TO DETERMINE EXISTING ELEVATIONS AND ACTUAL DESIGN HEIGHTS BEFORE BEGINNING DESIGN.

SOIL NAILS ARE REQUIRED FOR RETAINING WALL NO. 1 AND NO. 2. SOIL NAILS MUST BE A MINIMUM OF SIXTEEN FEET LONG, BE ENCAPSULATED OR EPOXY COATED, HAVE A MINIMUM DESIGN TEST LOAD OF 20 TONS, AND A MAXIMUM HORIZONTAL AND VERTICAL SPACING OF FIVE FEET. AT LEAST TWO ROWS OF NAILS MUST BE USED. SEE THE TEMPORARY SOIL NAIL WALL SPECIAL PROVISION.

NOTE: THE TEMPORARY SOIL NAIL WALL RECOMMENDATIONS SHOWN ON THIS SHEET WERE PROVIDED THROUGH A SEALED DOCUMENT FROM THE GEOTECHNICAL ENGINEERING UNIT. THE DOCUMENT WAS SUBMITTED TO THE WZTCU ON (10/16/08) AND SEALED BY A PROFESSIONAL ENGINEER, (RICHARD SCOTT WEBB), LICENSE # (028669).

APPROVED: _____ DATE: _____	TEMPORARY SOIL NAIL WALL LOCATIONS									
SCALE: NONE	DATE: OCT. 08	<table border="1"> <tr> <th colspan="2">REVISIONS</th> </tr> <tr> <td> </td> <td> </td> </tr> <tr> <td> </td> <td> </td> </tr> <tr> <td> </td> <td> </td> </tr> </table>	REVISIONS							
REVISIONS										
DWG. BY: JLF	DESIGN BY: JLF									
REVIEWED BY: JLP										

22-DEC-2008 11:57 \\dot\dfs\root\proj\ip\projects-b\4239\traffic\top\top3.dgn