

R:\Roadway\XSC\Earthwork\lb-3911_rdy_ew_lrt.log

PROJ. REFERENCE NO.	SHEET NO.
B-3911	X-0

**STATE OF NORTH CAROLINA
DIVISION OF HIGHWAYS
CROSS-SECTION SUMMARY**

Earthwork quantities are calculated by the Roadway Design Unit. These earthwork quantities are based in part on subsurface data provided by the Geotechnical Unit

Approximate quantities only. Unclassified excavation, borrow excavation, fine grading, clearing and grubbing, and removal of existing pavement will be paid for at the contract lump sum price for "Grading".

Station	Uncl. Exc. (cu. yd.)	Embt (cu. yd.)
L RT		
11+00.00	1	1
11+50.00	2	5
12+00.00	8	4
12+50.00	11	4
13+00.00	9	12
13+50.00	8	30
14+00.00	6	52
14+50.00	8	83
15+00.00	8	132
Station	Uncl. Exc. (cu. yd.)	Embt (cu. yd.)
L RT		
16+50.00	0	134
17+00.00	0	155
17+50.00	0	118
18+00.00	0	105
18+50.00	0	82
19+00.00	0	34
Station	Uncl. Exc. (cu. yd.)	Embt (cu. yd.)
L LT		
11+00.00	0	1
11+50.00		2
12+00.00		4
12+50.00		6
13+00.00		11
13+50.00		21
14+00.00		33
14+50.00		46
15+00.00		72
Station	Uncl. Exc. (cu. yd.)	Embt (cu. yd.)
L LT		
16+50.00	51	117
17+00.00	78	143
17+50.00	45	126
18+00.00	72	86
18+50.00	74	31
19+00.00	3	4

8/22/99

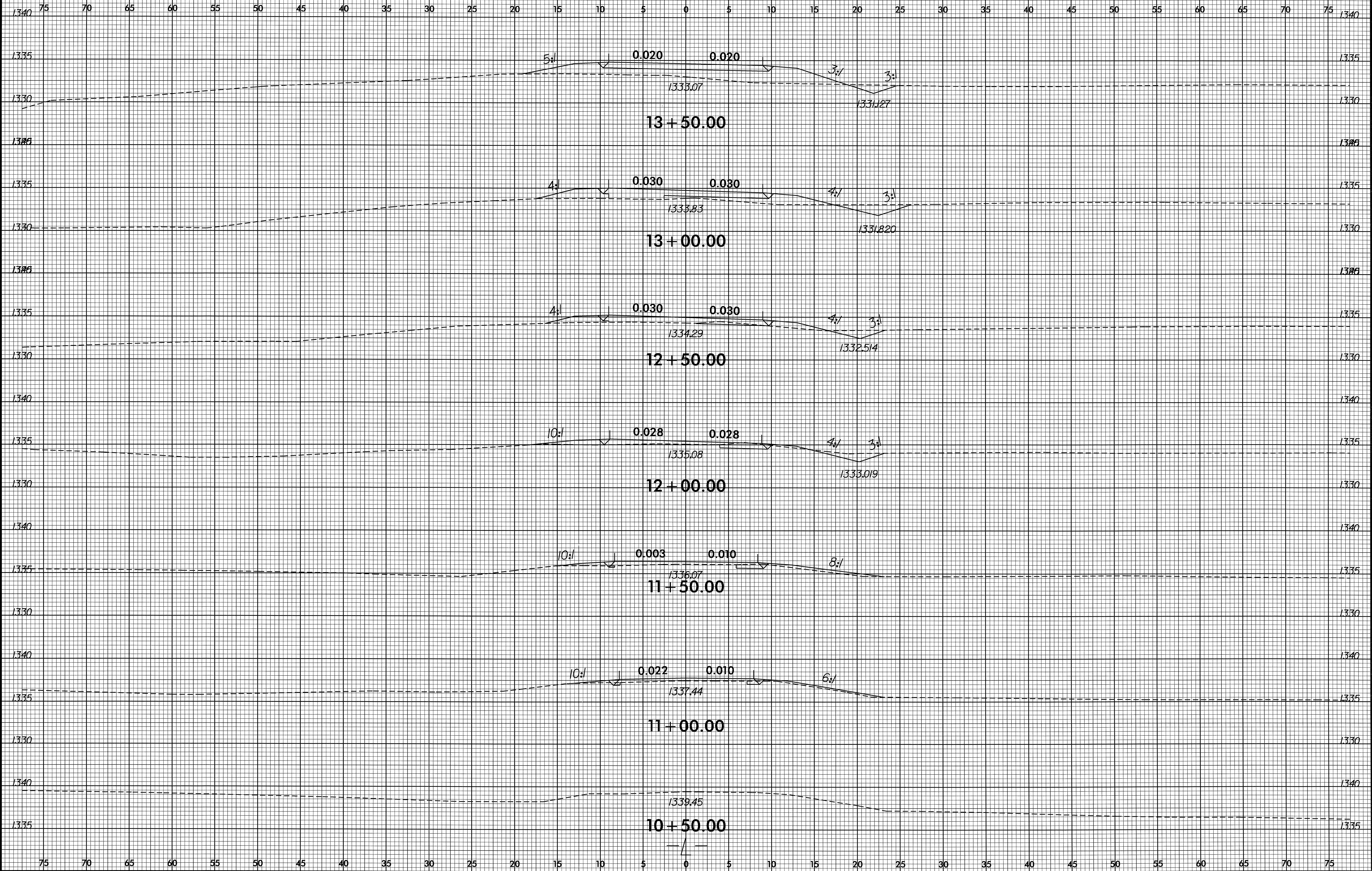

27-OCT-2008 15:37
R:\Roadway\XSC\B-3911_rdy_xpl_1.dgn
\$\$\$\$USERNAME\$\$\$\$

8/23/99

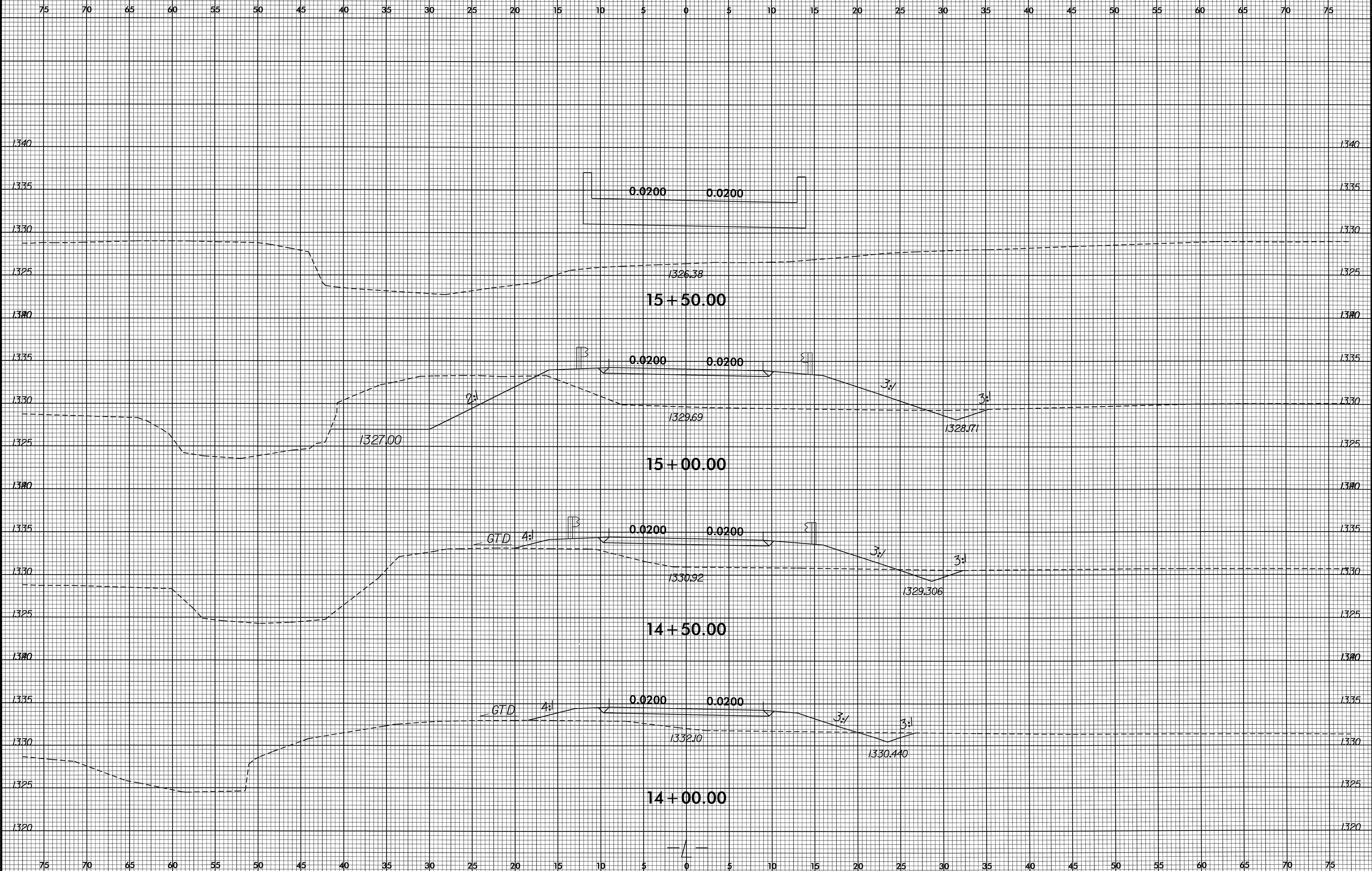

27-OCT-2008 15:37
R:\Road\8911\XSC\B-3911_rdy_xpl.dgn
\$\$\$\$USERNAME\$\$\$\$

8/23/99

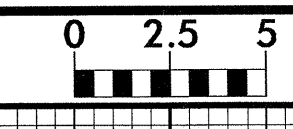

PROJ. REFERENCE NO.	SHEET NO.
B-3911	X-3

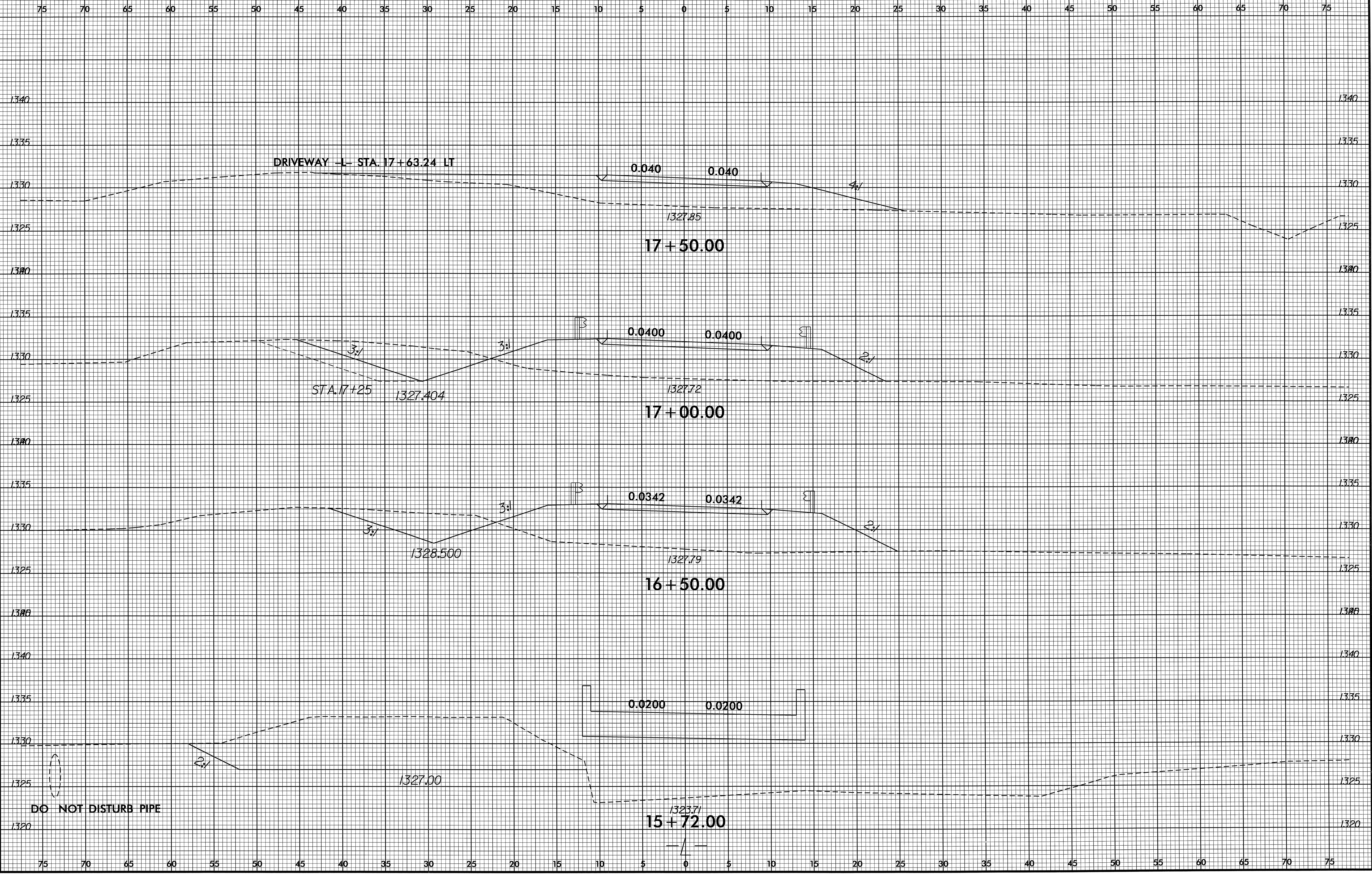

28-OCT-2008 11:18
F:\PROJECTS\B-3911_rdy_xpl_1.dgn
B-3911-X-3

8/23/99

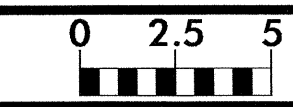

PROJ. REFERENCE NO.	SHEET NO.
B-3911	X-4

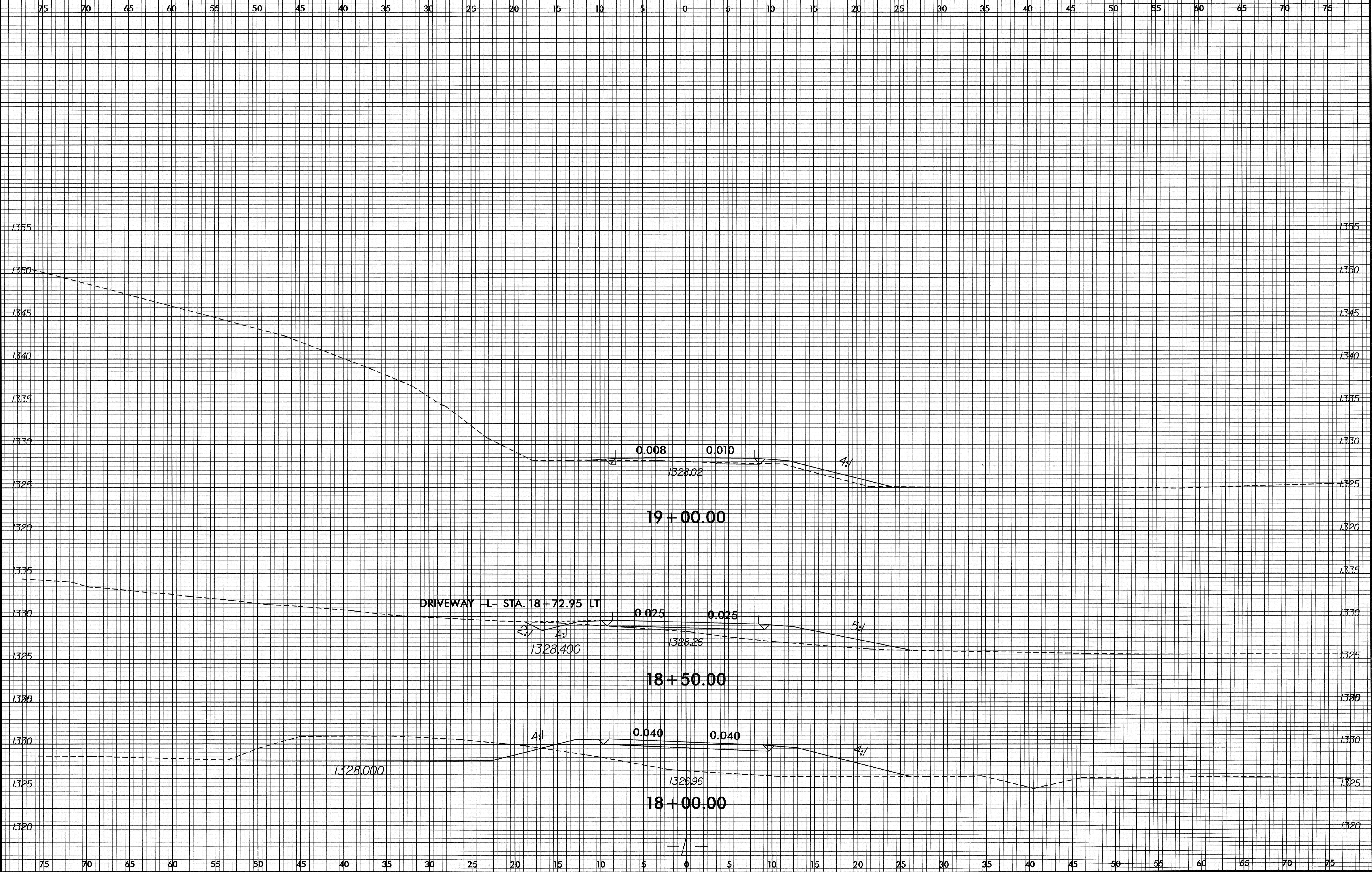

27-OCT-2008 15:37
F:\Roadway\XSC\B-3911_rdy_xpl_1.dgn
\$\$\$\$USERNAME\$\$\$\$

8/22/08

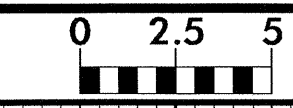

PROJ. REFERENCE NO. B-3911	SHEET NO. X-5
-------------------------------	------------------

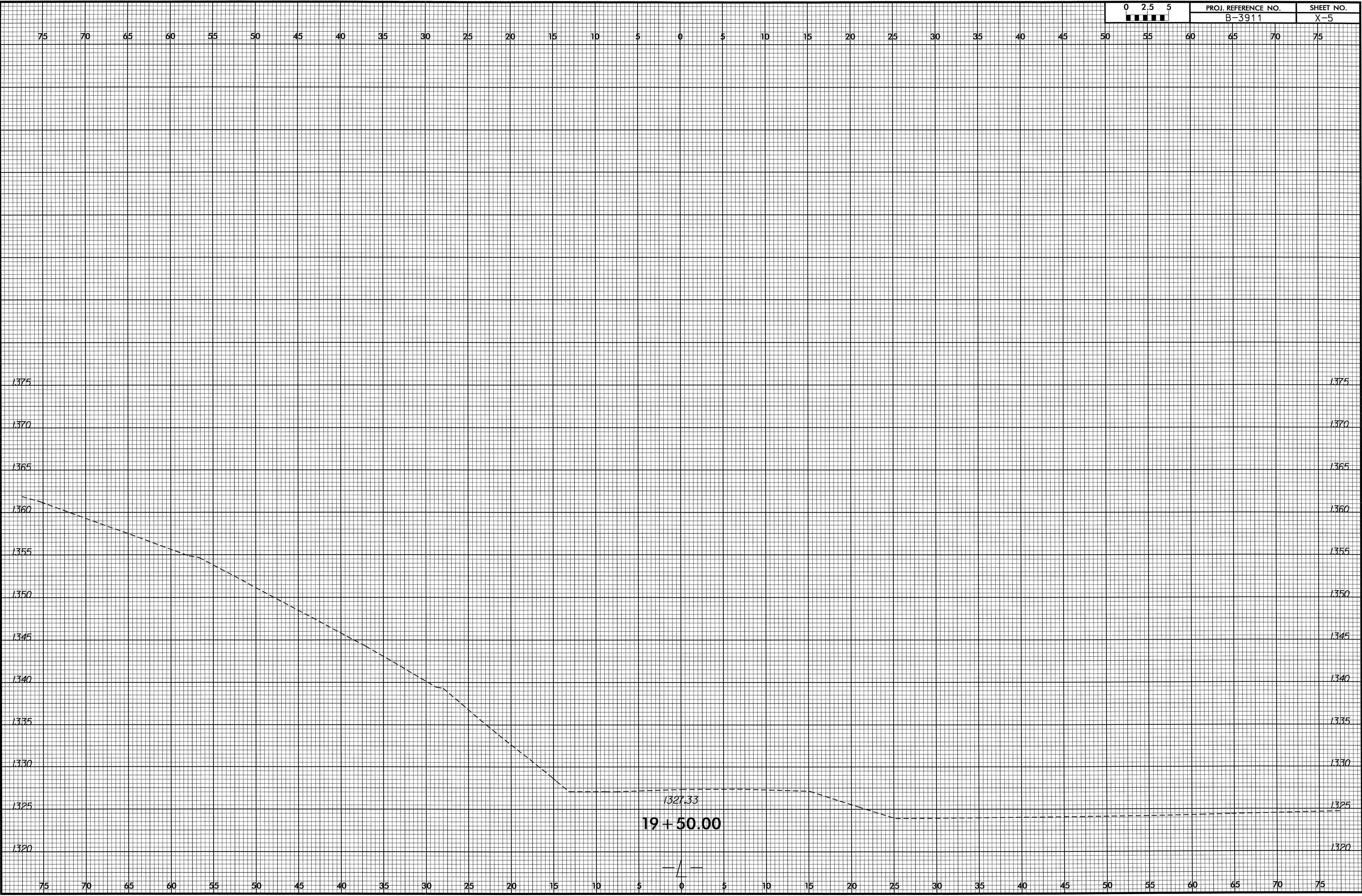

27-OCT-2008 15:36
F:\Projects\XSC\B-3911-rdy_xpl_1.dgn