

STATE OF NORTH CAROLINA
DIVISION OF HIGHWAYS

STATE PROJECT REFERENCE NO.	SHEET NO.
B-4402	TCP-1

**PLAN FOR PROPOSED
TRAFFIC CONTROL, MARKING & DELINEATION**

ALAMANCE COUNTY

B-4402

ROADWAY STANDARD DRAWINGS

THE FOLLOWING ROADWAY STANDARDS AS APPEAR IN "ROADWAY STANDARD DRAWINGS"-
PROJECT SERVICES UNIT-N.C. DEPARTMENT OF TRANSPORTATION-RALEIGH, N.C.,
DATED JULY 2006 ARE APPLICABLE TO THIS PROJECT AND BY REFERENCE HEREBY ARE
CONSIDERED A PART OF THESE PLANS:

STD. NO.	TITLE
1101.03	TEMPORARY ROAD CLOSURES
1101.11	TRAFFIC CONTROL DESIGN TABLES
1110.01	STATIONARY WORK ZONE SIGNS
1130.01	DRUM
1135.01	CONES
1145.01	BARRICADES
1150.01	FLAGGING DEVICES
1261.01	GUARDRAIL & BARRIER DELINEATOR SPACING
1261.02	GUARDRAIL & BARRIER DELINEATOR TYPES
1262.01	GUARDRAIL END DELINEATION

INDEX OF SHEETS

SHEET NO.	TITLE
TCP-1	LIST OF APPLICABLE ROADWAY STANDARD DRAWINGS, LEGEND AND INDEX OF SHEETS
TCP-2	GENERAL NOTES AND PHASING
TCP-3	DETOUR ROUTE AND SIGNING
SD-1	SPECIAL SIGN DESIGN

LEGEND

GENERAL

- DIRECTION OF TRAFFIC FLOW
- NORTH ARROW
- PROPOSED PVMT. EXIST. PVMT.
- WORK AREA
- REMOVAL OF EXISTING PAVEMENT

TRAFFIC CONTROL DEVICES

- TYPE I BARRICADE
- TYPE II BARRICADE
- TYPE III BARRICADE
- CONE
- DRUM SKINNY DRUM
- FLASHING ARROW PANEL (TYPE C)
- STATIONARY SIGN
- PORTABLE SIGN
- STATIONARY OR PORTABLE SIGN
- CRASH CUSHION
- CHANGEABLE MESSAGE SIGN
- TRUCK MOUNTED IMPACT ATTENUATOR (TMIA)
- POLICE
- FLAGGER

PAVEMENT MARKINGS

- CRYSTAL/CRYSTAL PAVEMENT MARKER
- YELLOW/YELLOW PAVEMENT MARKER
- CRYSTAL/RED PAVEMENT MARKER
- PAVEMENT MARKING SYMBOLS

TIP PROJECT:

30-SEP-2008 13:50
\\DOT\DFSROOT\PROJ\TIPPROJECTS\B\4402\TrafficControl\TCP\b-4402.tc.tcp.dgn
AT WTC244736
dhbeard

APPROVED:	PLAN PREPARED BY: N.C.D.O.T. WORK ZONE TRAFFIC CONTROL UNIT
DATE: 9/22/08	
SEAL	S. BOURNE, P.E. TRAFFIC CONTROL ENGINEER
	M. McDIARMID, P.E. TRAFFIC CONTROL PROJECT ENGINEER
	C. B. HOWARD TRAFFIC CONTROL PROJECT DESIGN ENGINEER
	D. H. BEARD TRAFFIC CONTROL DESIGN ENGINEER / TECHNICIAN

GENERAL NOTES

CHANGES MAY BE REQUIRED WHEN PHYSICAL DIMENSIONS IN THE DETAIL DRAWINGS, STANDARD DETAILS AND ROADWAY DETAILS ARE NOT ATTAINABLE TO MEET FIELD CONDITIONS, OR RESULT IN DUPLICATE, OR UNDESIRED OVERLAPPING OF DEVICES. MODIFICATION MAY INCLUDE: MOVING, SUPPLEMENTING, COVERING OR REMOVAL OF DEVICES, AS DIRECTED BY THE ENGINEER.

THE FOLLOWING GENERAL NOTES APPLY AT ALL TIMES FOR THE DURATION OF THE CONSTRUCTION PROJECT, EXCEPT WHEN OTHERWISE NOTED IN THE PLAN, OR DIRECTED BY THE ENGINEER.

TRAFFIC PATTERN ALTERATIONS

- A) NOTIFY THE ENGINEER TWENTY ONE (21) CALENDAR DAYS PRIOR TO ANY TRAFFIC PATTERN ALTERATION.

SIGNING

- B) STATE FORCES WILL BE RESPONSIBLE FOR PERMANENT SIGNING.
- C) PROVIDE DETOUR SIGNING WITHIN AND OFF THE PROJECT LIMITS.
- D) COVER OR REMOVE ALL DETOUR SIGNS WITHIN AND OFF THE PROJECT LIMITS WHEN A DETOUR IS NOT IN OPERATION.
- E) ENSURE ALL NECESSARY SIGNING IS IN PLACE PRIOR TO ALTERING ANY TRAFFIC PATTERN.

TRAFFIC CONTROL DEVICES

- F) PLACE TYPE III BARRICADES, WITH "ROAD CLOSED" SIGN R11-2 ATTACHED, OF SUFFICIENT LENGTH TO CLOSE ENTIRE ROADWAY.

PAVEMENT MARKINGS AND MARKERS

- G) STATE FORCES WILL INSTALL PAVEMENT MARKINGS AND PAVEMENT MARKERS ON THE FINAL SURFACE AS FOLLOWS:

ROAD NAME	MARKING	MARKER
SR 1504 ELON-OSSIPEE RD.	PAINT	PERMANENT RAISED MARKER

PHASING

- STEP 1) -INSTALL SCHOOL BUS TURN-AROUNDS AS DIRECTED BY THE ENGINEER USING ROADWAY STANDARD DRAWING 1101.02 SHEET 1 OF 9.

-INSTALL DETOUR SIGNING WITHIN AND OFF THE PROJECT LIMITS NO MORE THAN THREE (3) DAYS BEFORE ROAD CLOSURE. IF SIGNS ARE INSTALLED MORE THAN THREE (3) DAYS BEFORE ROAD CLOSURE, NOTIFY STATE FORCES TO COVER ALL DETOUR SIGNS ACCORDING TO STANDARD SPECIFICATION SECTION 1110-1 AND 1110-3.
- STEP 2) PLACE TRAFFIC ON OFF-SITE DETOUR AND CLOSE SR 1504 (ELON-OSSIPEE RD.) USING TYPE III BARRICADES WITH "ROAD CLOSED" SIGN R11-2, AT -L- STA. 12+00 +/- AND -L- STA. 20+50 +/- AS SHOW ON SHEET TCP-3. MAINTAIN ACCESS TO ALL DRIVEWAYS WITHIN THE PROJECT LIMITS.
- STEP 3) REMOVE EXISTING BRIDGE #7 AND APPROACHES AND CONSTRUCT THE PROPOSED BRIDGE AND APPROACHES UP TO AND INCLUDING THE FINAL LAYER OF SURFACE COURSE FROM -L- STA. 12+00 +/- TO -L- STA. 20+50 +/- . NOTIFY STATE FORCES TO PLACE FINAL PAVEMENT MARKINGS AND MARKERS.
- STEP 4) REMOVE ALL TRAFFIC CONTROL SIGNING AND DEVICES AND RE-OPEN SR 1504 (ELON-OSSIPEE RD.).

30-SEP-2008 13:51
 \DOT\DFSROOT\PROJ\TIP\Projects-B\B4402\TrafficControl\top\B-4402-tc-top-2.dgn
 dhbeard AT WZTC244736

APPROVED: <i>[Signature]</i> DATE: 7/20/08		GENERAL NOTES AND PHASING	
	SCALE: NONE		REVISIONS
	DATE: JULY 2008		
	DWG. BY: DHB		
	DESIGN BY: DHB		
REVIEWED BY: CBH			

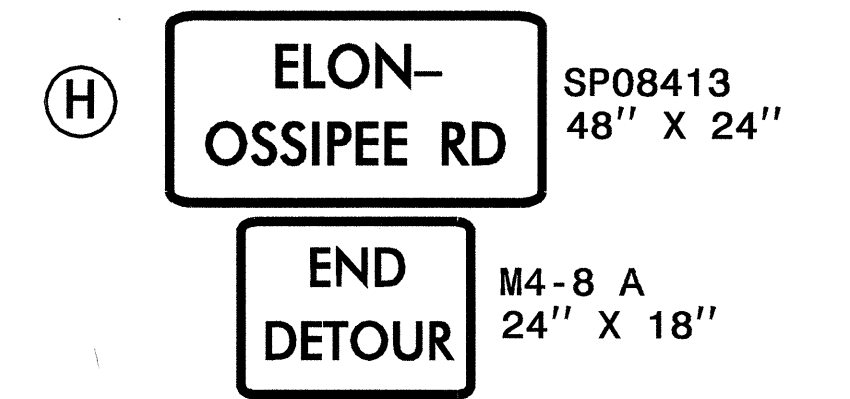
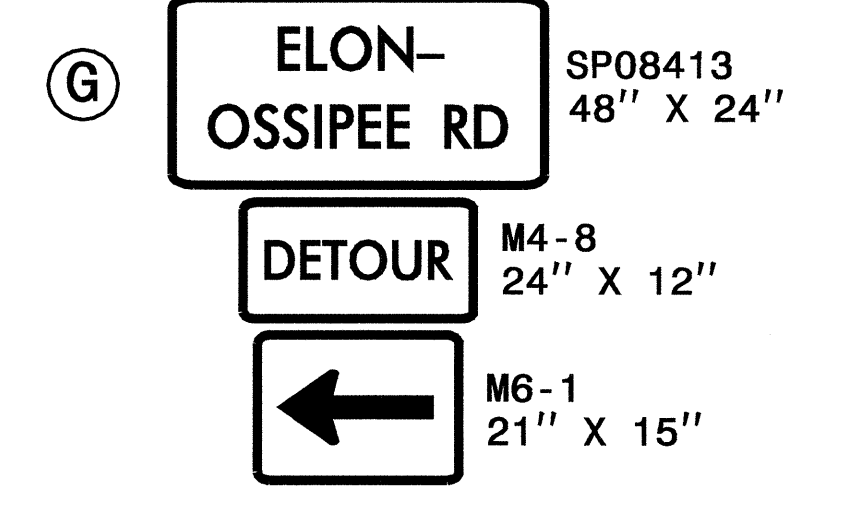
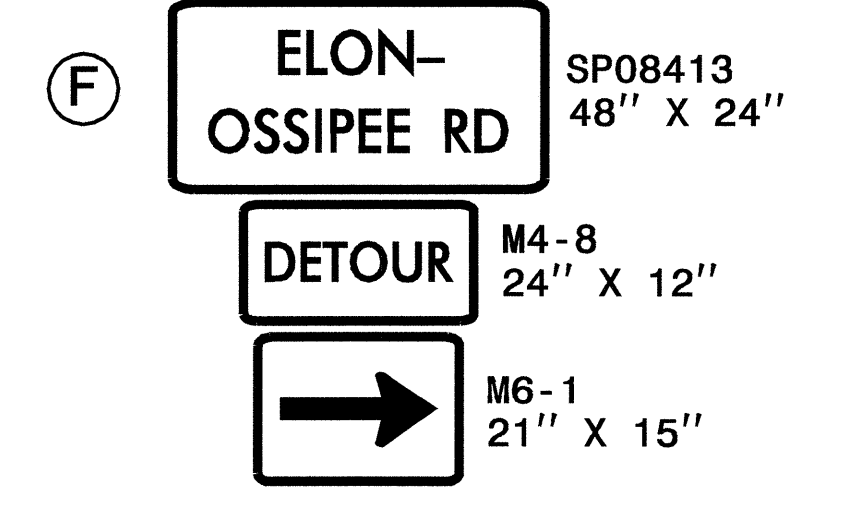
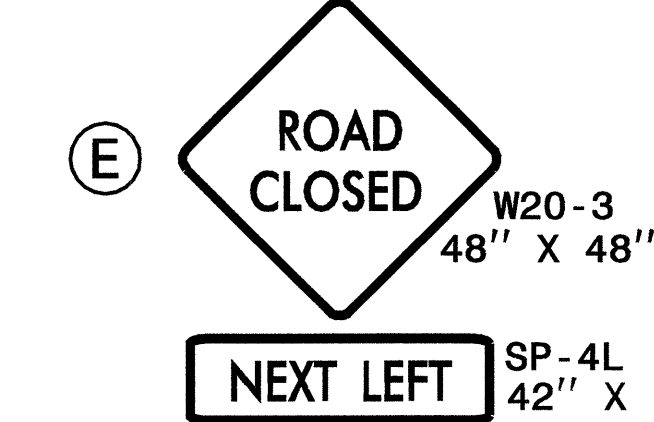
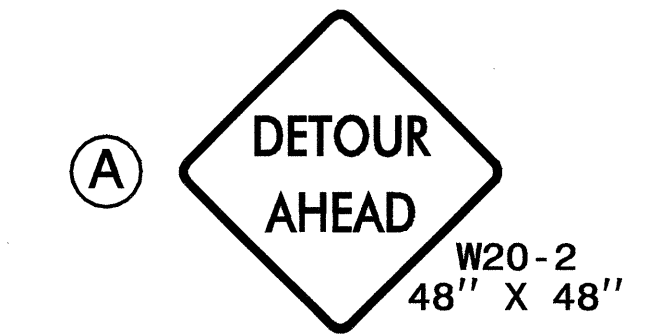
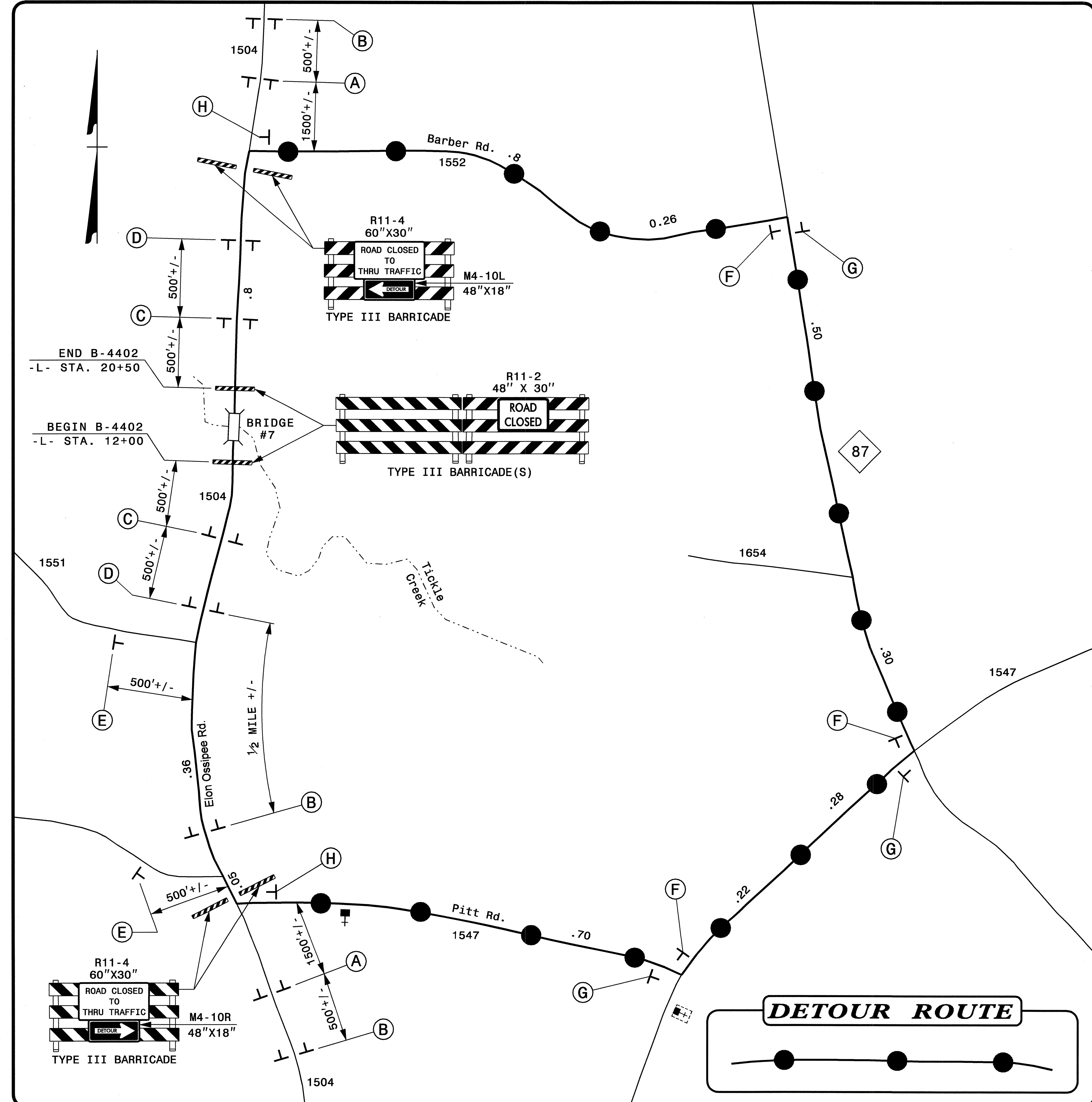

30-SEP-2008 13:51
 \root\dfs\root\proj\proj\traffic\control\top\b-4402_top-3.dgn
 dbeard AT WZTC244736

APPROVED: <i>[Signature]</i> DATE: 7/20/08	DETOUR ROUTE AND SIGNING	
SCALE: NONE		REVISIONS
DATE: JULY 2008		
DWG. BY: DHB		
DESIGN BY: DHB		
REVIEWED BY: CBH		CADD FILE