

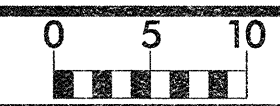



8/23/99



PROJ. REFERENCE NO.  
B-4303

SHEET NO.  
X-2

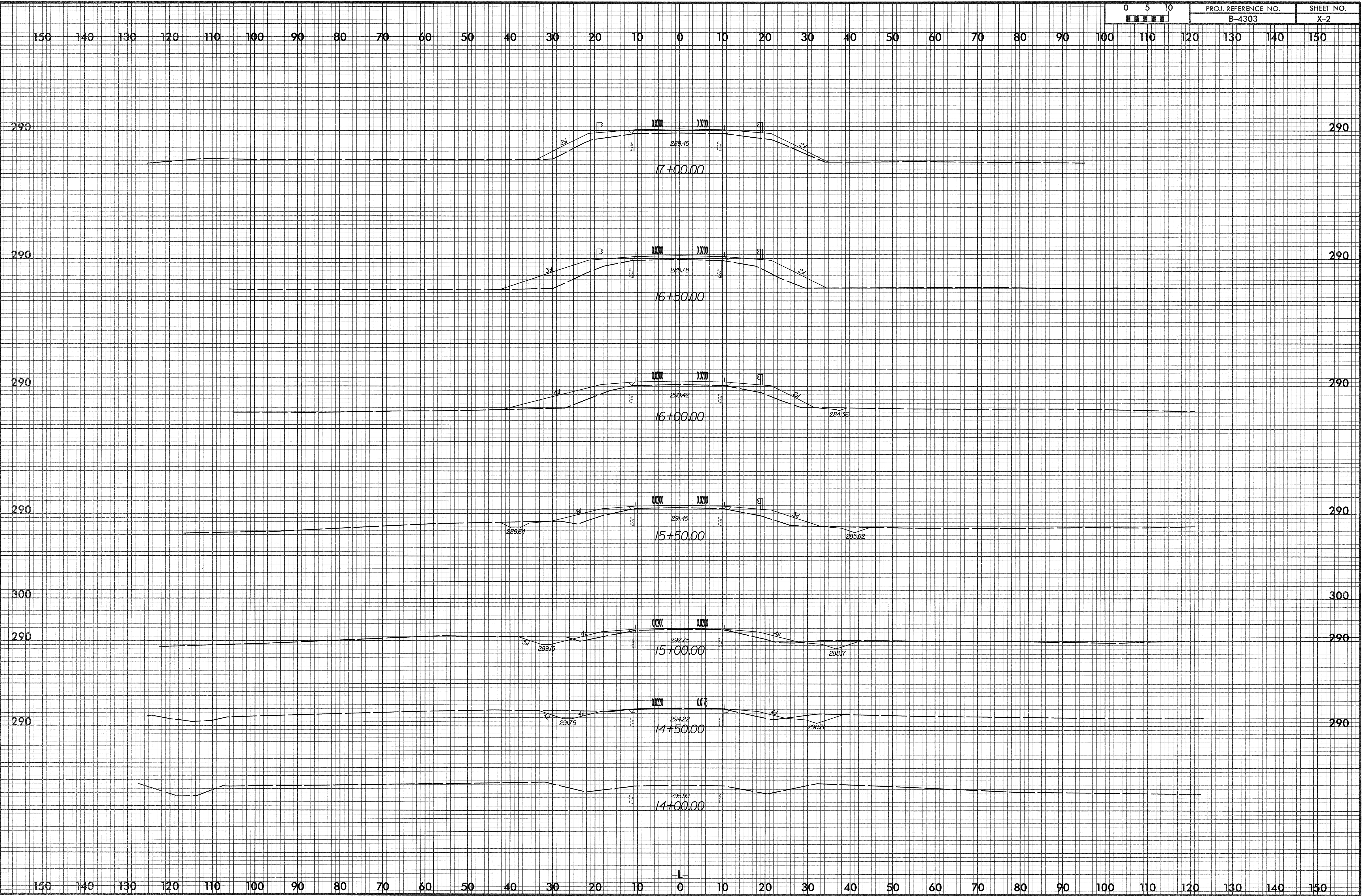

9/12/2008  
R:\Roadway\Xsc\B4303\_xd1\_xp1.dgn  
3:05:15 PM



B-23/99

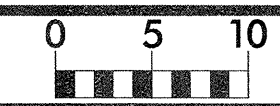

PROJ. REFERENCE NO.  
B-4303

SHEET NO.  
X-3

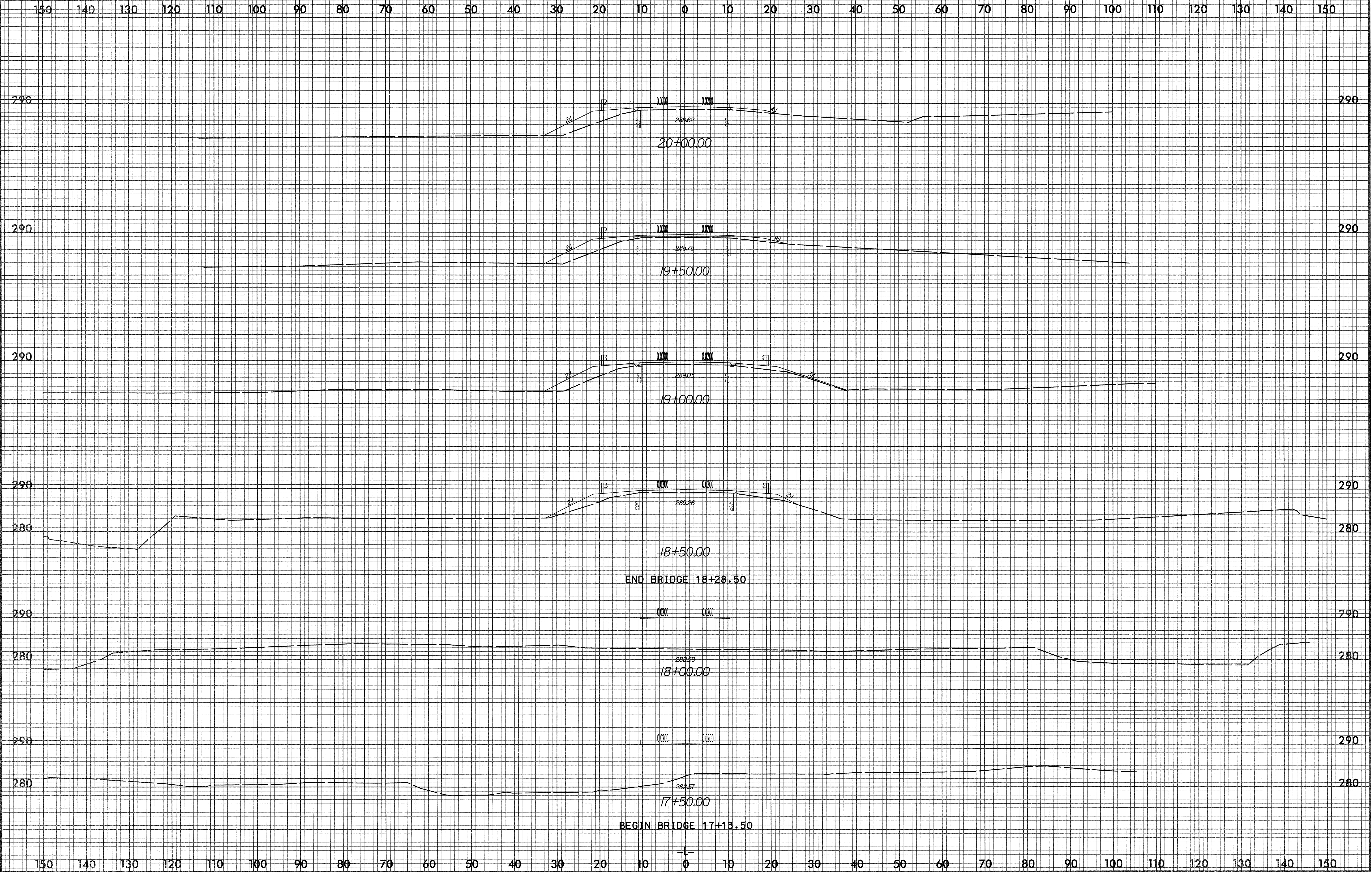

9/2/2008  
R:\Resckey\Xse-b4303\_rdy\_xpl.dgn  
3:03:31 PM



8/23/99

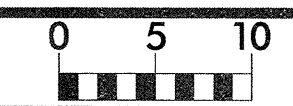

PROJ. REFERENCE NO.  
B-4303

SHEET NO.  
X-4

150 140 130 120 110 100 90 80 70 60 50 40 30 20 10 0 10 20 30 40 50 60 70 80 90 100 110 120 130 140 150

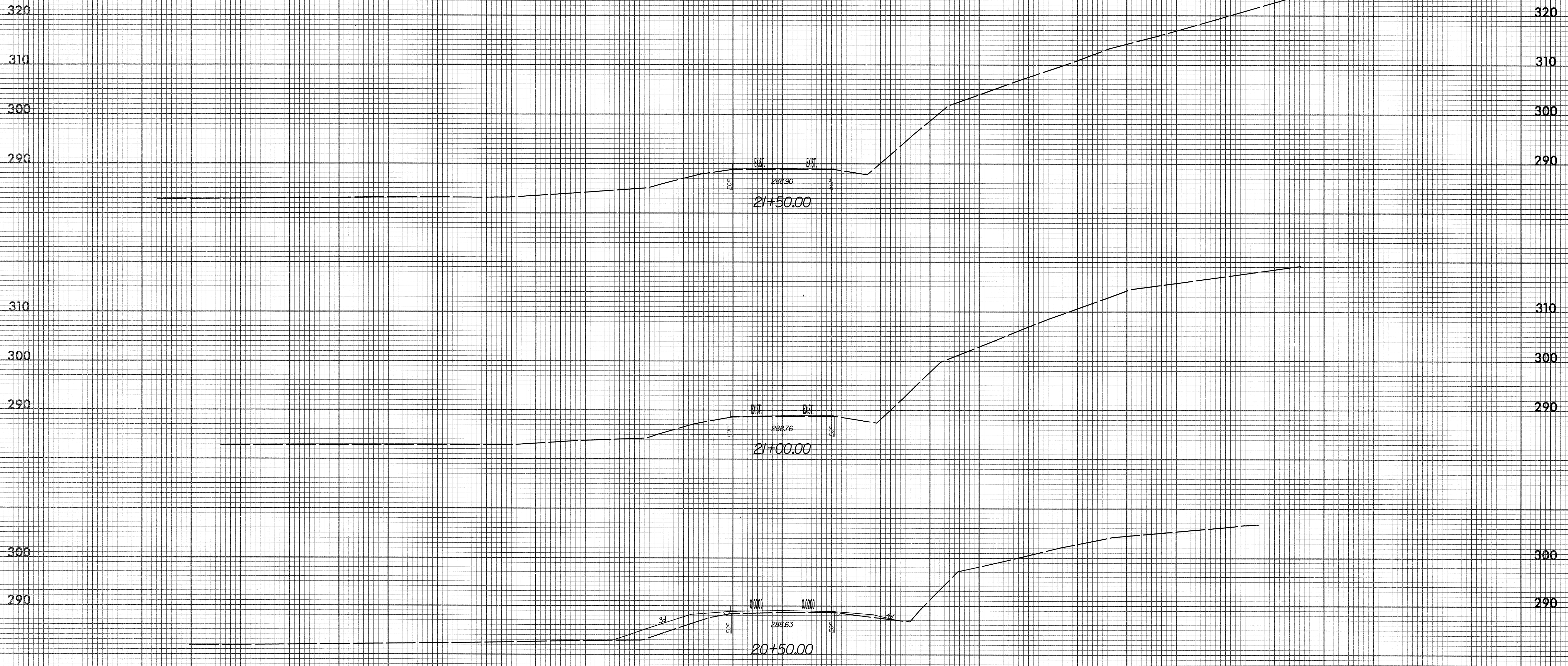

150 140 130 120 110 100 90 80 70 60 50 40 30 20 10 0 10 20 30 40 50 60 70 80 90 100 110 120 130 140 150

9/12/2008  
R:\Roggekey\Xsec\B-4303\_r.dwg\_xpl.dwg  
3:03:38 PM



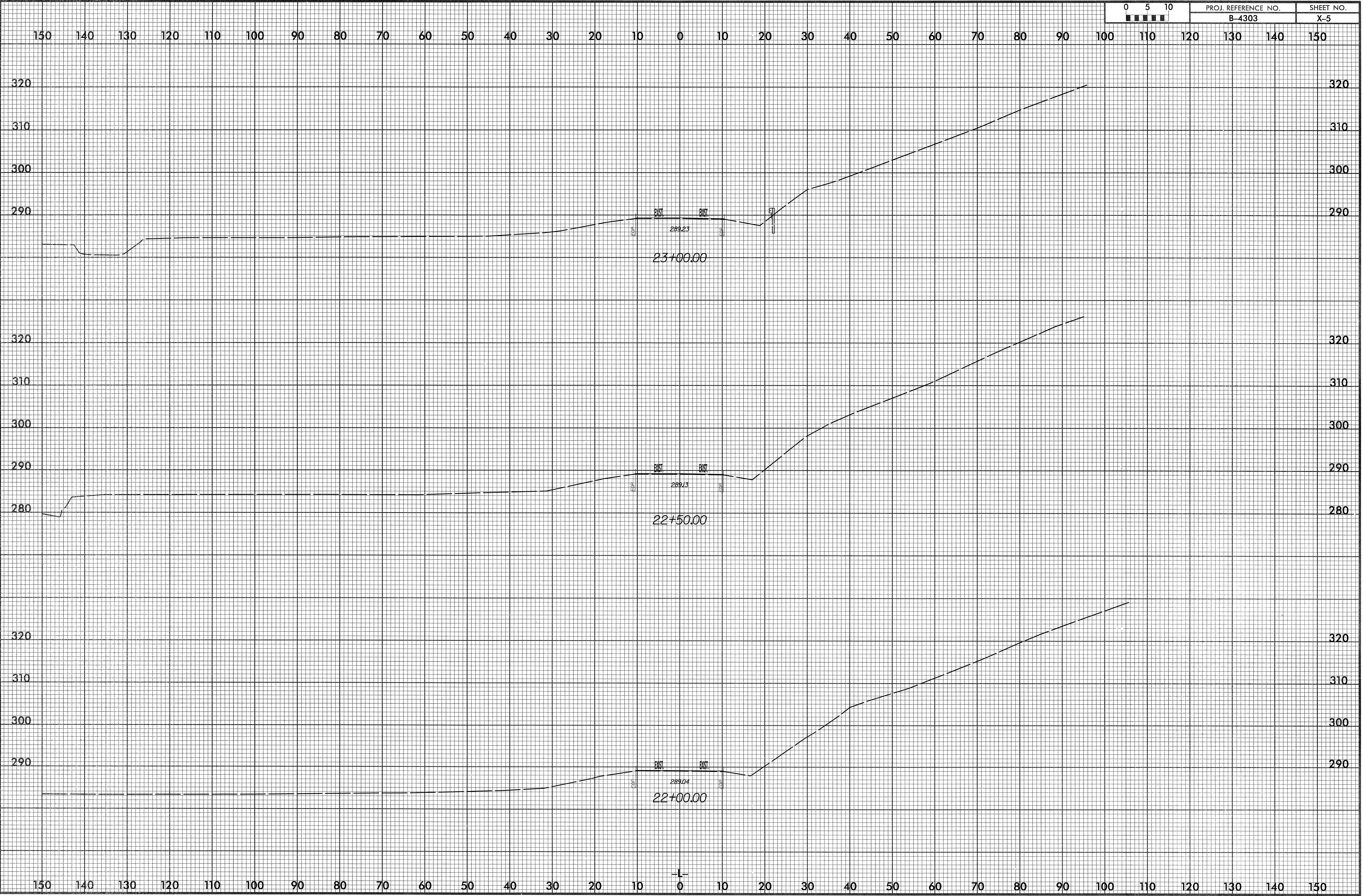



8/23/99



PROJ. REFERENCE NO.  
B-4303

SHEET NO.  
X-6

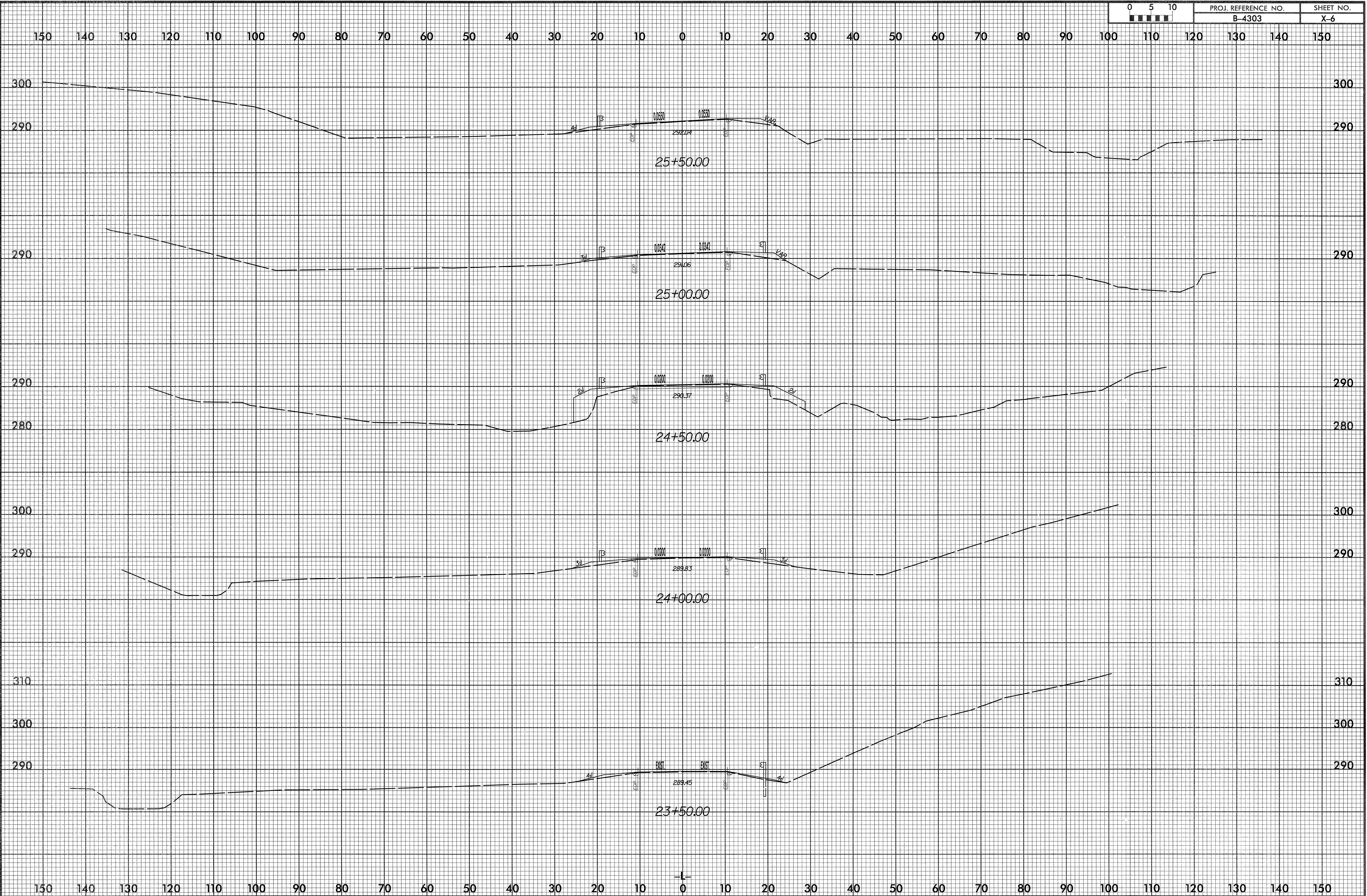

9/12/2008  
R:\Roadway\Xec\4303\_r\_du\_xpl.dgn  
3:03:50 PM



8/23/99

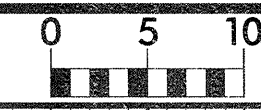

PROJ. REFERENCE NO.  
B-4303

SHEET NO.  
X-7

150 140 130 120 110 100 90 80 70 60 50 40 30 20 10 0 10 20 30 40 50 60 70 80 90 100 110 120 130 140 150

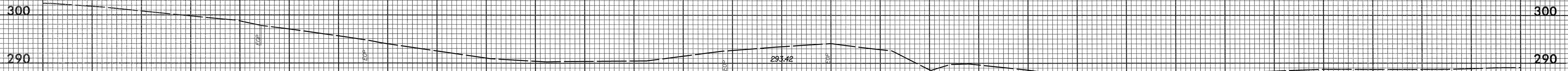

300 290 290 300

26+00.00

0

150 140 130 120 110 100 90 80 70 60 50 40 30 20 10 0 10 20 30 40 50 60 70 80 90 100 110 120 130 140 150

9/12/2008  
R:\Roadway\Xsec\4303\_rdy\_xpl.dgn  
3:03:55 PM