

09/08/99

See Sheet 1-A For Index of Sheets

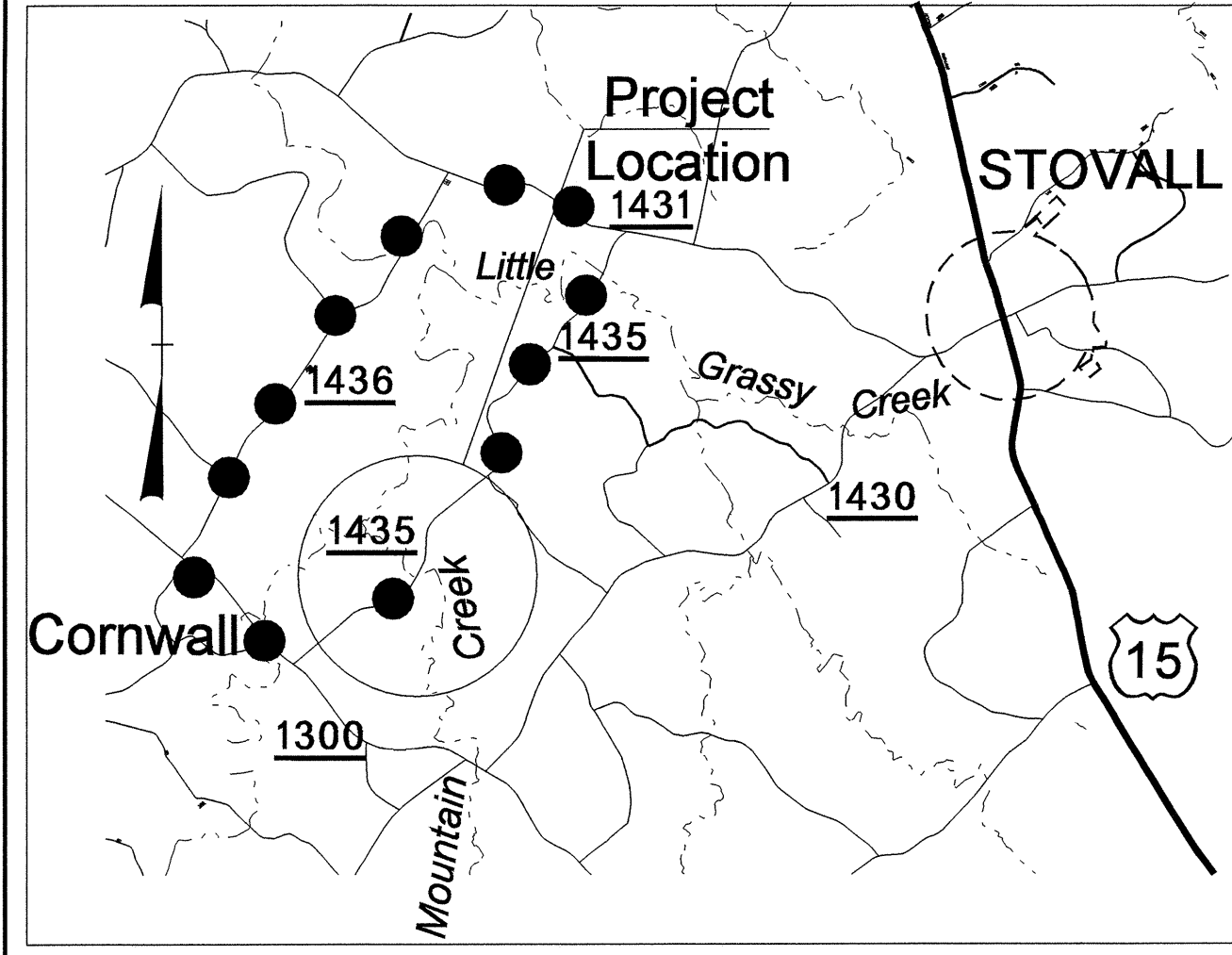

STATE OF NORTH CAROLINA
DIVISION OF HIGHWAYS

**UTILITIES BY OTHERS PLANS
GRANVILLE COUNTY**

T.I.P. NO.	SHEET NO.
B-4526	UO-1

LOCATION: Bridge #200 over Mountain Creek on SR 1435, Davis Chapel Road

TYPE OF WORK: Grading, Paving, Drainage, Structure and Utilities.

TIP PROJECT: B-4526

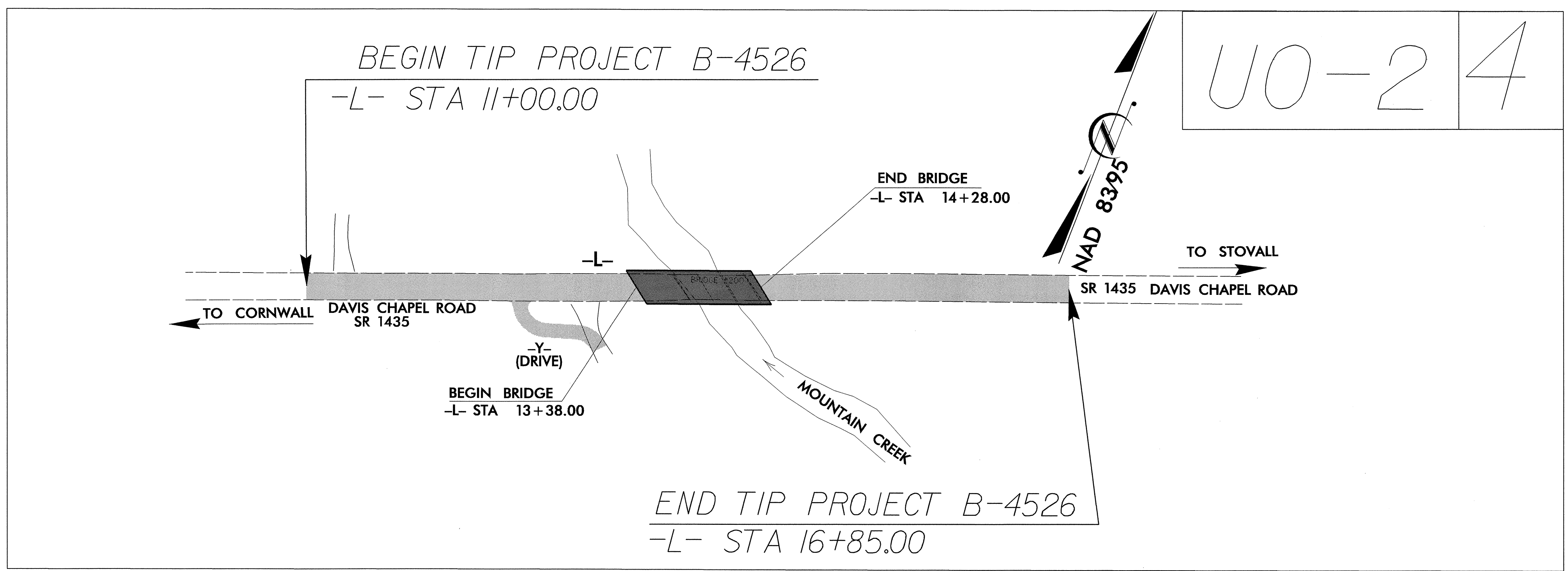

THIS PROJECT IS NOT WITHIN THE LIMITS OF ANY MUNICIPALITY
CLEARING ON THIS PROJECT SHALL BE PERFORMED BY METHOD III
DESIGN EXCEPTION REQUIRED FOR SAG VERTICAL CURVE K FACTOR AND STOPPING SIGHT DISTANCE

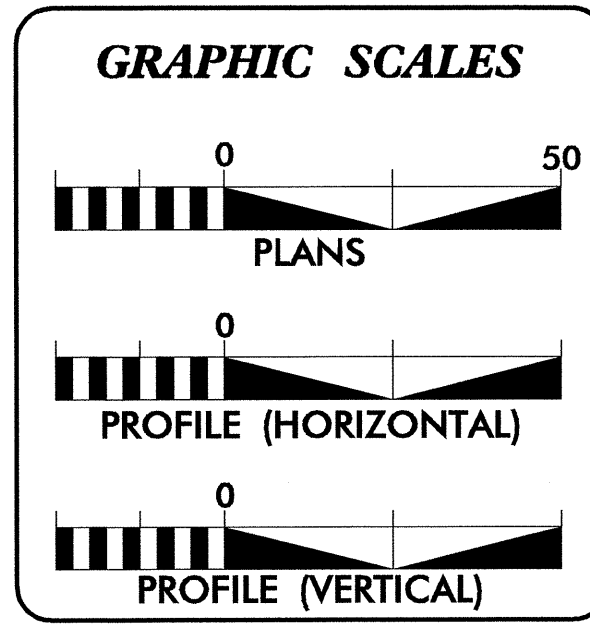

INDEX OF SHEETS

SHEET NO.	DESCRIPTION
UO-1	TITLE SHEET
UO-2	UTILITIES BY OTHERS PLAN SHEET

UTILITY OWNERS ON PROJECT

(1) EMBARQ TELEPHONE

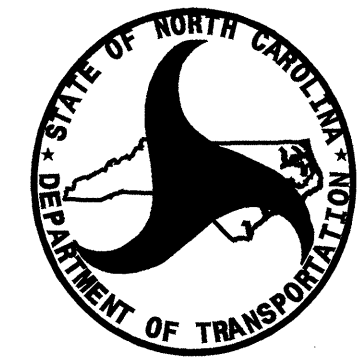

PREPARED IN THE OFFICE OF:
**DIVISION OF HIGHWAYS
DESIGN SERVICES
UTILITY SECTION**

1591 MAIL SERVICES CENTER
RALEIGH, NC 27699-1591
PHONE (919) 256-4128
FAX (919) 256-4119

Roger Worthington, P.E. UTILITIES SECTION ENGINEER
Steve McKee, P.E. UTILITIES SQUAD LEADER PROJECT ENGINEER
Jamshid Hafshejani UTILITIES PROJECT DESIGNER

01-AUG-2008 14:35 R:\Utilities\RGY_LUF\Proj\B4526-U01_rdy_tsh.dgn \$\$\$USERNAME\$\$\$

UTILITIES BY OTHERS

NOTE:
ALL PROPOSED UTILITY WORK SHOWN ON THIS SHEET WILL BE DONE BY OTHERS

Note:
Subaqueous lines (trenchless) must be replaced at a depth of seven feet (7') minimum below the lowest depth of creek and three feet (3') minimum below the wet land and in the other areas.

Note:
The Utility company's Contractor's attention is directed to Section 1550, 102 and 107 of the Standard Specifications concerning the trenchless installation. No damage is allowed to the wetlands or stream by the trenchless installation. The Contractor's Engineer shall design the installation method and provide on-site oversight.

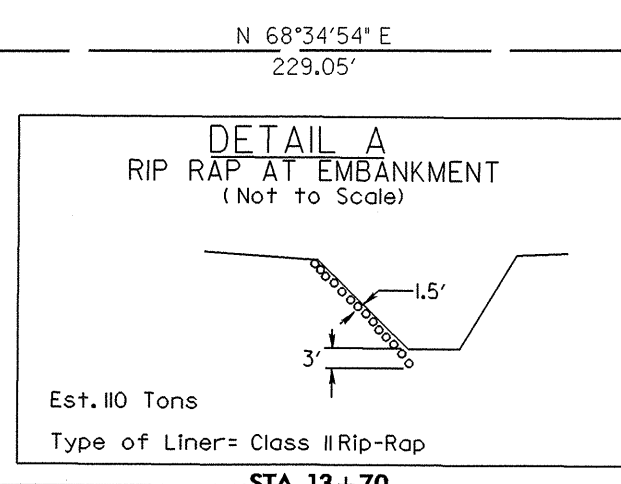

TELEPHONE BELONGS TO EMBARQ

PROP. 300' DIRECTIONAL BORE.
PROP. 4" PVC CONDUIT.

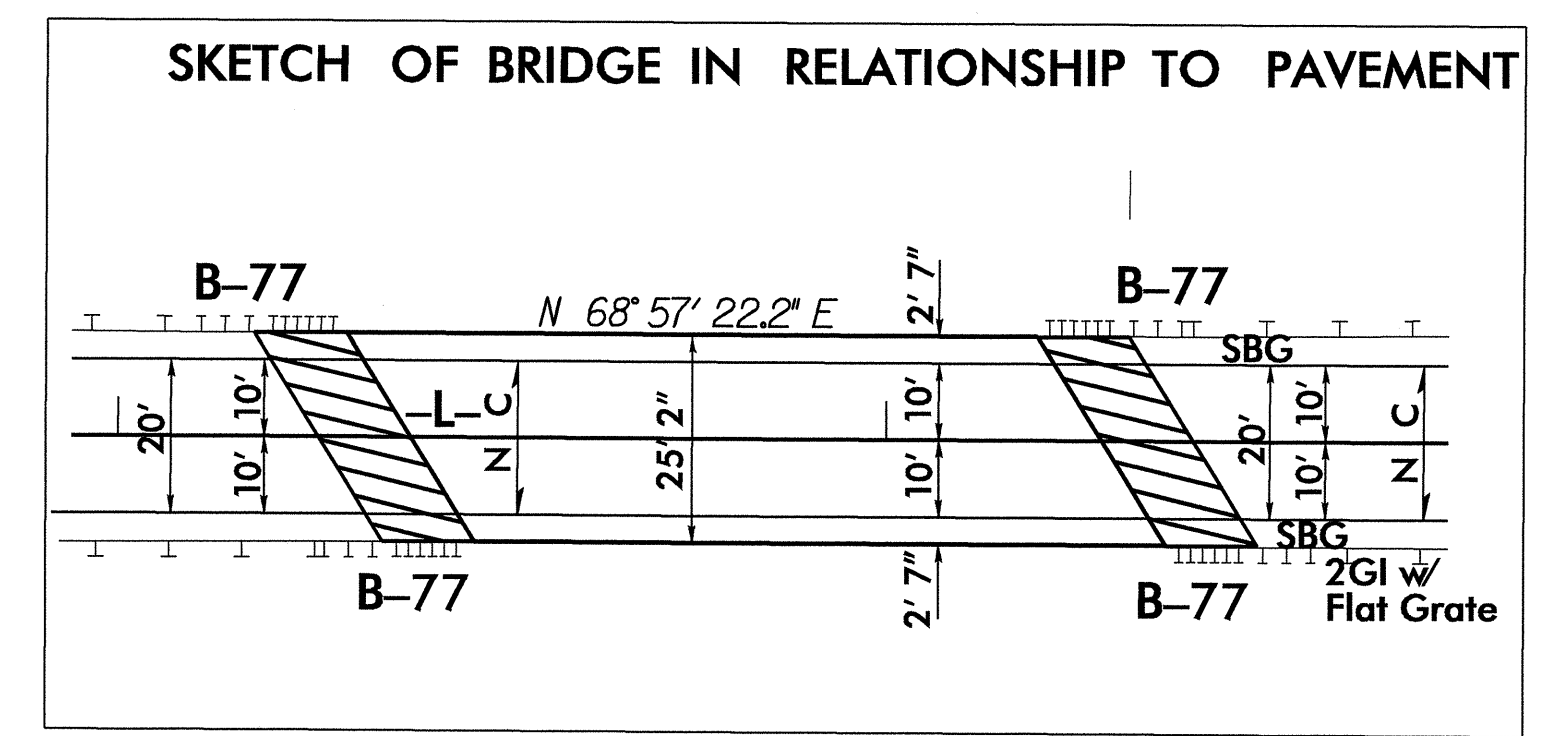

PROPOSED BRIDGE APPROACH SLAB
SBG = SHOULDER BERM GUTTER

DATUM DESCRIPTION
THE LOCALIZED COORDINATE SYSTEM DEVELOPED FOR THIS PROJECT IS BASED ON THE STATE PLANE COORDINATES ESTABLISHED BY NCDOT FOR MONUMENT "B4526-1" WITH NAD 1983/95 STATE PLANE GRID COORDINATES OF NORTHING: 989399.1334 (ft) EASTING: 2105840.1418 (ft) THE AVERAGE COMBINED GRID FACTOR USED ON THIS PROJECT (GROUND TO GRID) IS: 1.00008342 THE N.C. LAMBERT GRID BEARING AND LOCALIZED HORIZONTAL GROUND DISTANCE FROM "B4526-1" TO -L- STATION IS
ALL LINEAR DIMENSIONS ARE LOCALIZED HORIZONTAL DISTANCES VERTICAL DATUM USED IS NAVD 88

PI Sta 10+30.30	PH Sta 10+75.02
Δ = 86° 48' 41" (LT)	Δ = 62° 18' 10" (RT)
D = 286' 28" 44.0"	D = 286' 28" 44.0"
L = 30.30'	L = 21.75'
T = 18.92'	T = 12.09'
R = 20.00'	R = 20.00'

300.00' DIRECTIONAL BORE

DO NOT PLACE ROCK IN BED OF JURISDICTIONAL STREAMS

5/14/99
04-AUG-2008 15:51 \\B4526-U02_rdu_psh04.dgn