

**TIP PROJECT: B-4526**

STATE OF NORTH CAROLINA  
DIVISION OF HIGHWAYS  
  
PLAN FOR PROPOSED  
HIGHWAY EROSION CONTROL

**GRANVILLE COUNTY**

**LOCATION: Bridge #200 over Mountain Creek on SR 1435, Davis Chapel Road**

**TYPE OF WORK: Grading, Paving, Drainage and Structure**

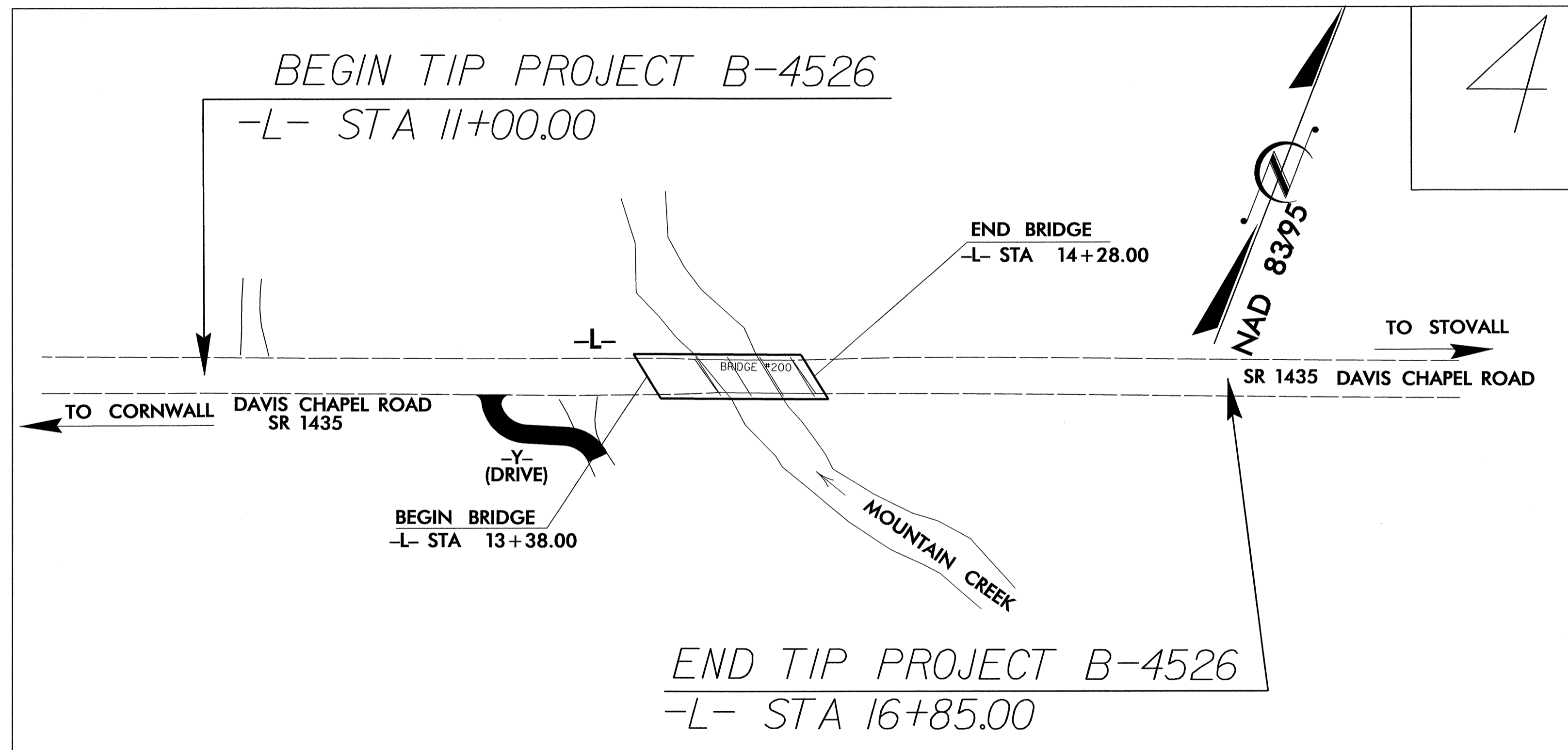

STATE	STATE PROJECT REFERENCE NO.	SHEET NO.	TOTAL SHEETS
N.C.	B-4526	EC-1	
STATE PROJ. NO.	F.A. PROJ. NO.	DESCRIPTION	

**EROSION AND SEDIMENT CONTROL MEASURES**

Std. #	Description	Symbol
1630.03	Temporary Silt Ditch	TD
1630.05	Temporary Diversion	TD
1605.01	Temporary Silt Fence	III
1606.01	Special Sediment Control Fence	III
1622.01	Temporary Berms and Slope Drains	TD
1630.01	Riser Basin	RD
	Silt Basin Type B	SB
1633.01	Temporary Rock Silt Check Type-A	TR
	Temporary Rock Silt Check Type-B	TR
	Wattle	W
1634.01	Temporary Rock Sediment Dam Type-A	RS
1634.02	Temporary Rock Sediment Dam Type-B	RS
1635.01	Rock Pipe Inlet Sediment Trap Type-A	RP
1635.02	Rock Pipe Inlet Sediment Trap Type-B	RP
1630.04	Stilling Basin	SB
1630.06	Special Stilling Basin	SSB
	Rock Inlet Sediment Trap:	
1632.01	Type A	A
1632.02	Type B	B
1632.03	Type C	C
	Skimmer Basin	SK
	Tiered Skimmer Basin	TSK
	Infiltration Basin	IB

THIS PROJECT CONTAINS  
EROSION CONTROL PLANS  
FOR CLEARING AND  
GRUBBING PHASE OF  
CONSTRUCTION.

**GRAPHIC SCALE**

0

PLANS

0

PROFILE (HORIZONTAL)

0

PROFILE (VERTICAL)

ROADSIDE ENVIRONMENTAL UNIT  
DIVISION OF HIGHWAYS  
STATE OF NORTH CAROLINA

Prepared In the Office of:  
**ROADSIDE ENVIRONMENTAL UNIT**  
1 South Wilmington St.  
Raleigh, NC 27611  
  
**2006 STANDARD SPECIFICATIONS**

**Roadway Standard Drawings**

The following roadway english standards as appear in "Roadway Standard Drawings"- Roadway Design Unit - N. C. Department of Transportation - Raleigh, N. C., dated July 18, 2006 and the latest revision thereto are applicable to this project and by reference hereby are considered a part of these plans.

1605.01 Temporary Silt Fence	1632.03 Rock Inlet Sediment Trap Type C
1607.01 Gravel Construction Entrance	1633.01 Temporary Rock Silt Check Type A
	1634.02 Temporary Rock Sediment Dam Type B

25 Jul 2008 09:04  
projects\env\roadside\details\B-4526-r.dwg, tsh.dgn  
chen AT REN23182

PROJECT REFERENCE NO. B-4526	SHEET NO. EC-2
RW SHEET NO.	
ROADWAY DESIGN ENGINEER	HYDRAULICS ENGINEER

# COIR FIBER BAFFLE DETAIL

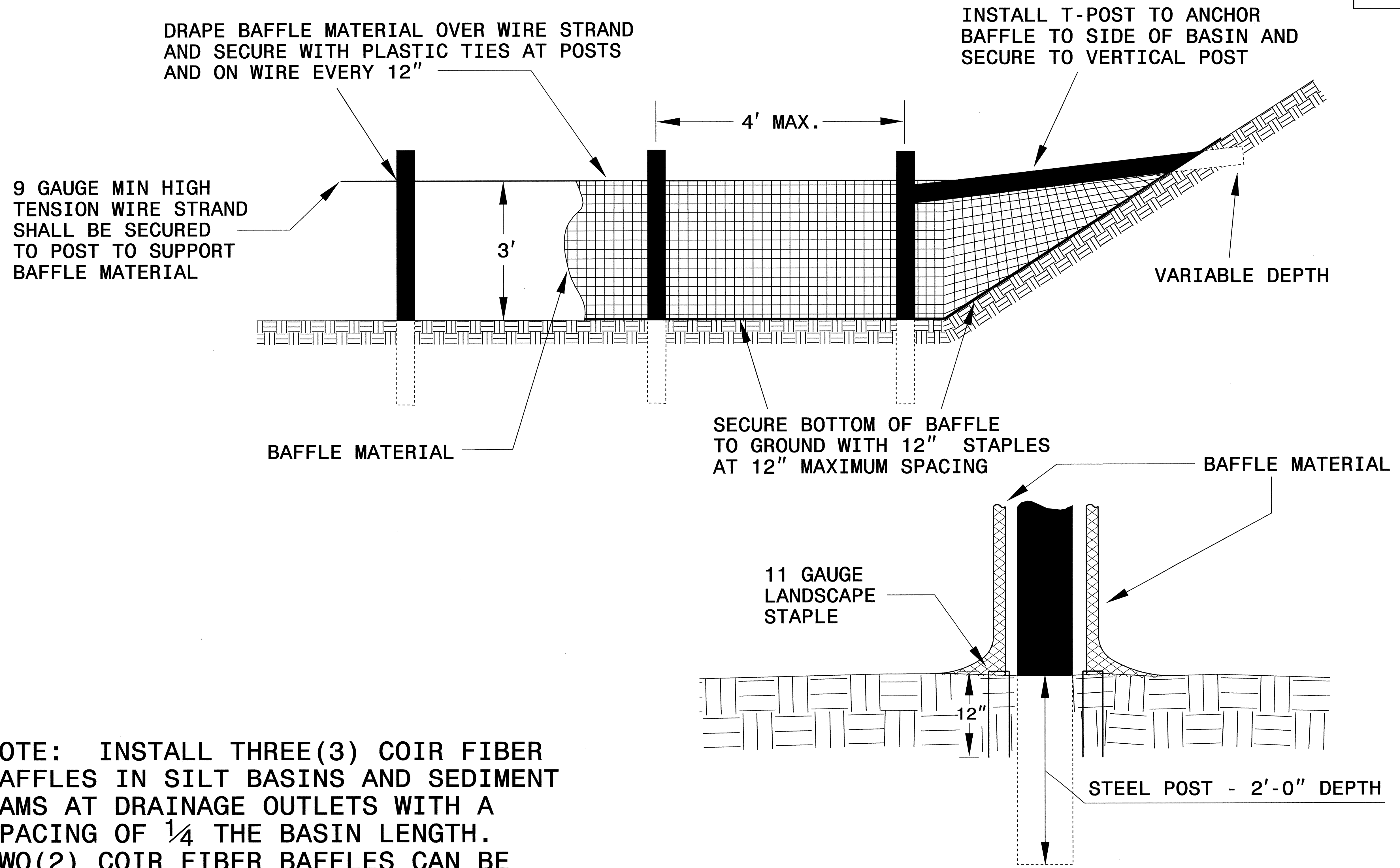

NOTE: INSTALL THREE (3) COIR FIBER BAFFLES IN SILT BASINS AND SEDIMENT DAMS AT DRAINAGE OUTLETS WITH A SPACING OF  $\frac{1}{4}$  THE BASIN LENGTH. TWO (2) COIR FIBER BAFFLES CAN BE INSTALLED IN SILT BASINS AND DAMS LESS THAN 20 FT. IN LENGTH WITH A SPACING OF  $\frac{1}{3}$  THE BASIN LENGTH.

BAFFLE MATERIAL SHALL BE SECURED TO THE BOTTOM AND SIDES OF BASIN USING 12" LANDSCAPE STAPLES

8/17/99  
 25-JUN-2008 08:05  
 g:\tipp\proj\ec-3-b-4526\environmental\design\b4526\_rdy-psn04.dgn  
 Author: AL REINZ

**CLEARING AND GRUBBING  
EROSION CONTROL FOR  
CONSTRUCTION SHEET 4**

**NOTE:**  
PLACE TEMPORARY ROCK SEDIMENT DAMS TYPE - B  
AND TEMPORARY ROCK SILT CHECKS TYPE - A AT  
DRAINAGE OUTLETS.

**NOTE:**  
UTILIZE TEMPORARY ROCK SEDIMENT DAM TYPE - B  
AND TEMPORARY ROCK SILT CHECK TYPE - A  
AS STILLING BASIN WHERE APPLICABLE.

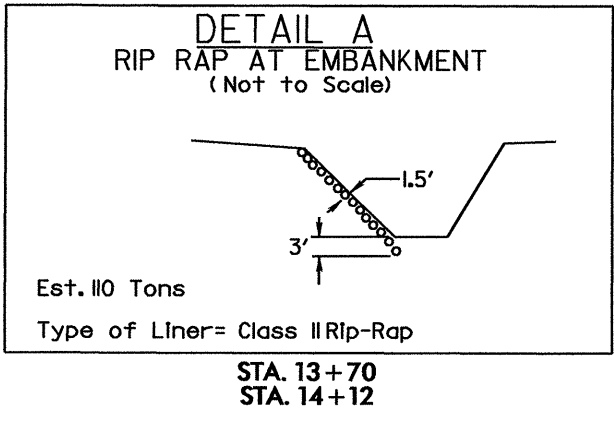

PROJECT REFERENCE NO. B-4526	SHEET NO. EC-3/CONST.4
RW SHEET NO.	
ROADWAY DESIGN ENGINEER	HYDRAULICS ENGINEER



**24 x 11 x 3  
4 ft. weir  
ID 4.1B**

**20 x 10 x 3  
4 ft. weir  
ID 4.3B**

**22 x 9 x 3  
4 ft. weir  
ID 4.2B**

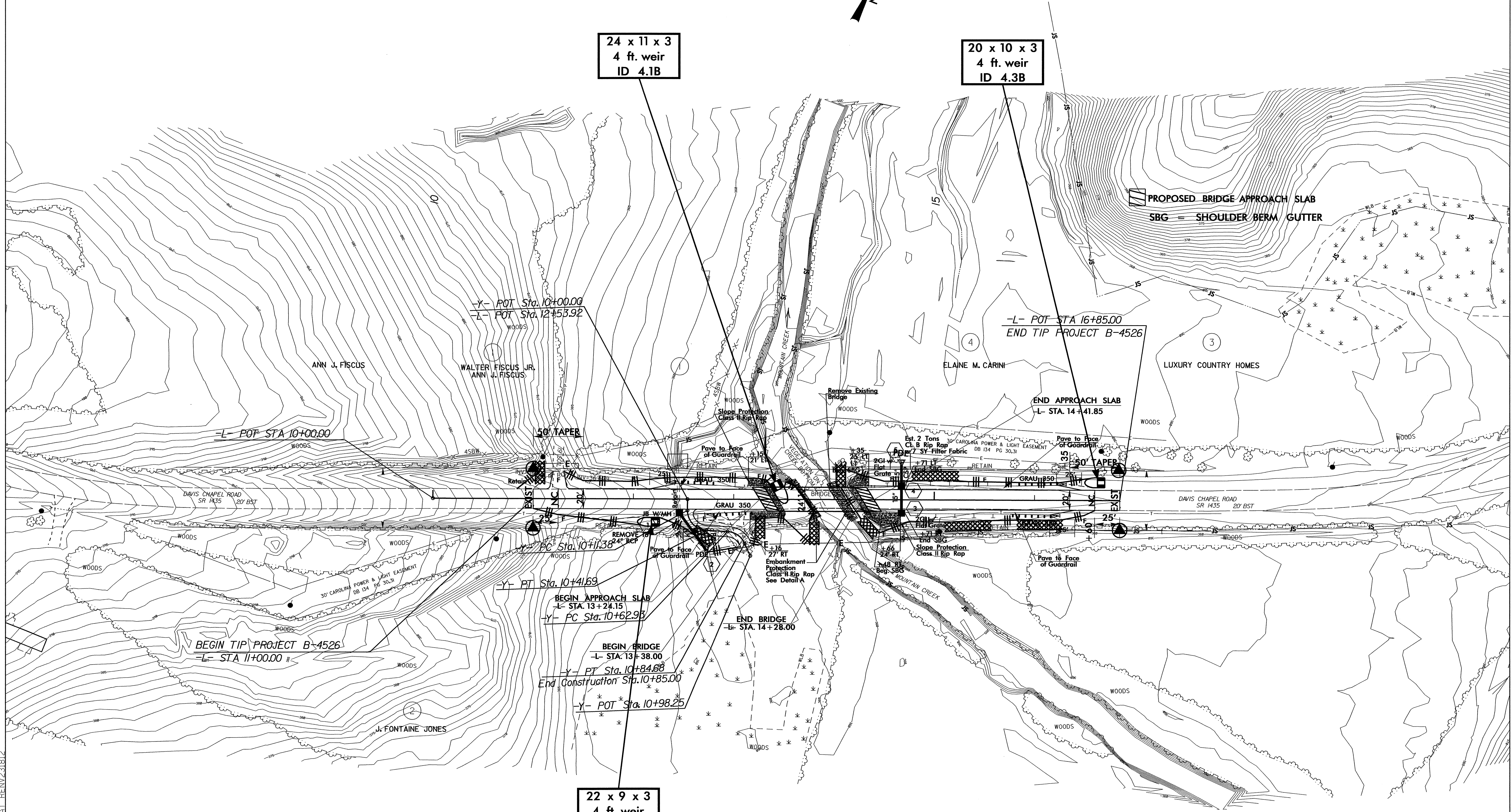

DO NOT PLACE ROCK IN BED OF JURISDICTIONAL STREAMS

8/17/99

PROJECT REFERENCE NO.	SHEET NO.
B-4526	EC-4/CONST.4
RW SHEET NO.	
ROADWAY DESIGN ENGINEER	HYDRAULICS ENGINEER

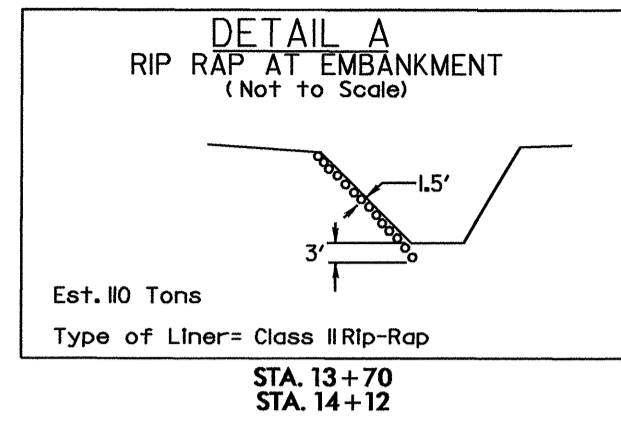

**NOTE:**  
 UTILIZE TEMPORARY ROCK SEDIMENT DAM TYPE - B  
 AND TEMPORARY ROCK SILT CHECK TYPE - A  
 AS STILLING BASIN WHERE APPLICABLE.

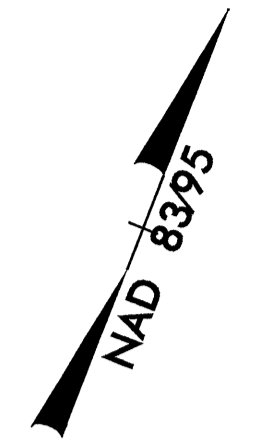

**24 x 11 x 3  
 4 ft. weir  
 ID 4.1B**

**20 x 10 x 3  
 4 ft. weir  
 ID 4.3B**

**22 x 9 x 3  
 4 ft. weir  
 ID 4.2B**

**PROPOSED BRIDGE APPROACH SLAB**  
**SBG = SHOULDER BERM GUTTER**

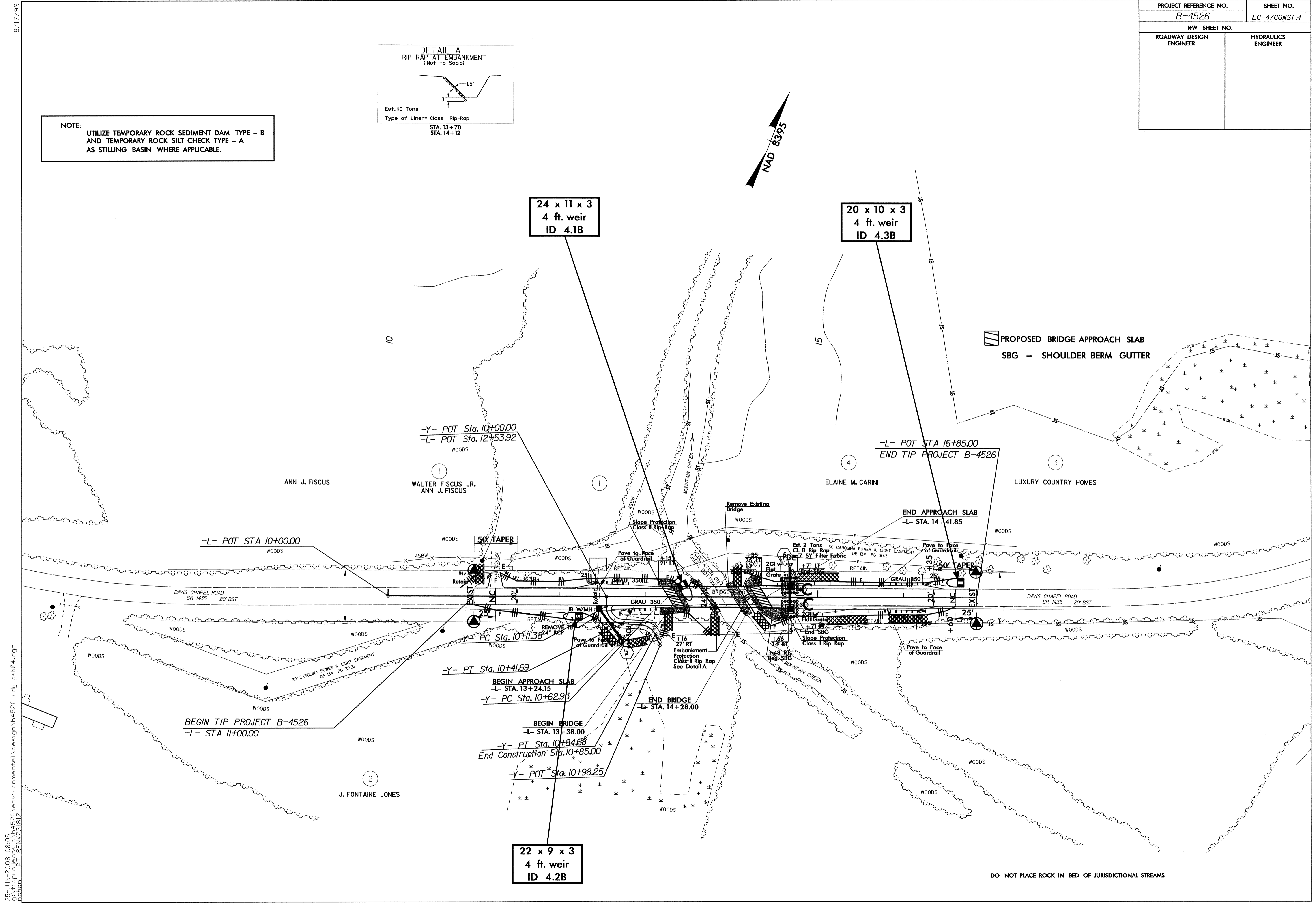

DO NOT PLACE ROCK IN BED OF JURISDICTIONAL STREAMS

25-JUN-2008 08:05  
 g:\tippro\ec-4\B-4526\environmental\design\b4526.rdy-ps1-04.dgn  
 d:\tippro\ec-4\B-4526\environmental\design\b4526.rdy-ps1-04.dgn