

I:\3-MAY-2008 11:05
 P:\TIP\Projects\R-3833A\Traffic\Signing\CADD\Quantities & OM\Signs\R-3833A\Drawings\SuppChrT E&F signs.dgn
 rdakduk AT 11:00 2/16/09

CONTRACT: C201902

T.I.P.: R-3833A

STATE OF NORTH CAROLINA
DEPARTMENT OF TRANSPORTATION

SIGNING PLANS
IREDELL COUNTY

LOCATION: SR 1100 (BRAWLEY SCHOOL ROAD) FROM SOUTH OF SR 1122 (SOUTHFORK ROAD) TO EAST OF SR 1109 (WILLIAMSON ROAD)

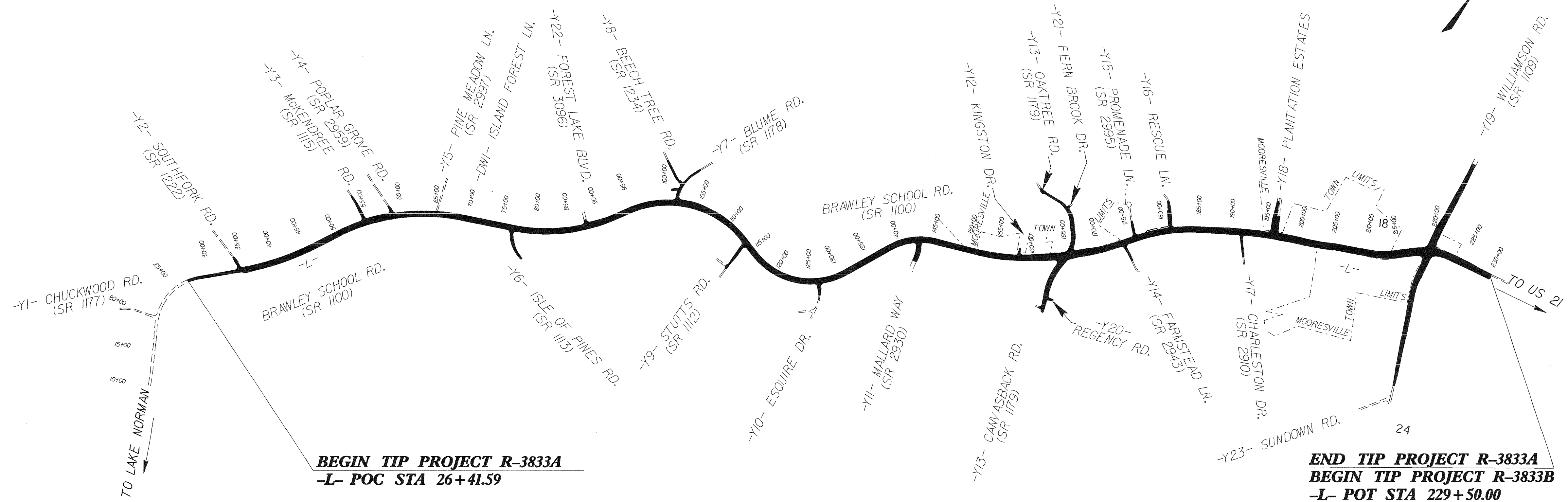

TIP NO. R-3833A	SHEET NO. SIGN-01
APPROVED: <i>[Signature]</i>	
DATE: 5/13/08	
SEAL	

PLAN PREPARED BY: N.C.D.O.T. SIGNING SECTION
R.W. King, P.E. SIGNING ENGINEER
A. Alqudwah, P.E. SIGNING PROJECT ENGINEER
J.G. Martinez SIGNING PROJECT DESIGN ENGINEER
W.R. Dakduk SIGNING DESIGN ENGINEER

ROADWAY STANDARD DRAWINGS
APPLICABLE TO THESE SIGNING PLANS
 904.10
 904.50

INDEX

SHEET NO.	DESCRIPTION
1	TITLE SHEET
2	SUMMARY OF QUANTITIES and NOTES
3	E SHEET
4 - II	SIGN ROADWAY SHEETS

TIP NO.	SHEET NO.
R-3833A	SIGN-02
APPROVED: <i>[Signature]</i>	
DATE: 5/16/08	
SEAL	



ITEM NO.		ITEM DESCRIPTION	QUANTITY	UNIT
DESCRIPTION NO.	SECT. NO.			
4072000000	903	SUPPORTS, 3 LB STEEL U-CHANNEL	4,086	L.F.
4102000000	904	SIGN ERECTION, TYPE E	271	EA.
4116100000	904	SIGN ERECTION, RELOCATE SIGN TYPE D	5	EA.
4155000000	907	DISPOSAL OF SIGN SYSTEM, U-CHANNEL	80	EA.

Pay Item Notes:	
1	RELOCATE SIGN, TYPE D
2	DISPOSAL OF SUPPORT, U-CHANNEL
3	DISPOSAL OF SIGN SYSTEM, U-CHANNEL

- General Notes:**
- . SIGNS FURNISHED BY STATE
 - . ALL TYPE 'D' SIGNS SHALL BE MOUNTED ON TWO U-CHANNEL POSTS UNLESS OTHERWISE INDICATED ON THE PLANS.
 - . IF REMOVAL OR RELOCATION OF SIGNS ON PRIVATE STREET (NON-STATE MAINTAINED) IS REQUIRED DUE TO CONSTRUCTION, THE CONTRACTOR SHALL INFORM THE ENGINEER. THE WORK WILL BE COMPLETED BY OTHERS.
 - . SIGNING PLANS DO NOT INCLUDE TEMPORARY CONSTRUCTION SIGNING OR PAVEMENT MARKINGS. SEE TRAFFIC CONTROL PLANS.
 - . WHEN NOT STATIONED OR DIMENSIONED ON PLANS, ALL 'E' AND 'F' SIGNS SHALL BE FIELD LOCATED BY THE ENGINEER
 - . ALL EXISTING SIGNS ON "U" CHANNEL POST WITHIN THE PROJECT LIMITS SHALL BE REMOVED AND DISPOSED OF UNLESS OTHERWISE NOTED ON PLANS.
 - . WHEN EXISTING SIGNS ARE REMOVED AND INSTALLED ON NEW SUPPORTS, THE RE-ERECTION SHALL IMMEDIATELY FOLLOW THE REMOVAL.
 - . THE BACKGROUND FOR TYPE E & F SIGNS SHALL BE TYPE III REFLECTIVE SHEETING.
SEE ROADWAY PLANS FOR GUARD/GUIDE RAIL DETAILS.

**SUMMARY OF QUANTITIES
AND NOTES**

P:\MAY-2008\3833A\Trsf\Fic\Signing\CADD\Quant\Titles & CM_Signs\R-3833A0\TitlesSuppChrt E&F_signs.dgn
 15 MAY 2008 13:56
 rdekduker

TIP NO. R-3833A	SHEET NO. SIGN-03
APPROVED: <i>Sydney R. [Signature]</i>	
DATE: 5/16/08	
SEAL	

401 QUANTITY REQ'D 4

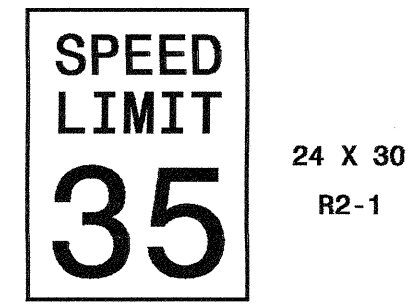

MOUNT BELOW SIGN 419
IN 2 INSTALLATIONS
ONE "U" POST PER SIGN

411 QUANTITY REQ'D 37

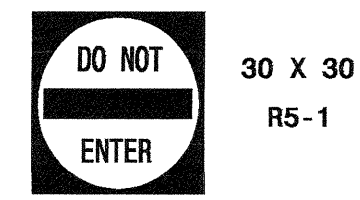

ONE "U" POST PER SIGN

416 QUANTITY REQ'D 35

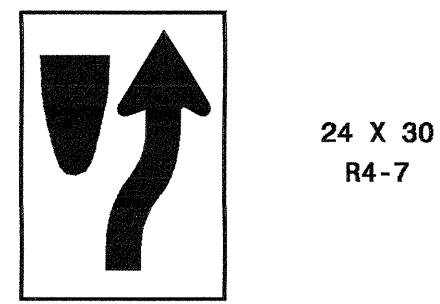

ONE "U" POST PER SIGN

422 QUANTITY REQ'D 4

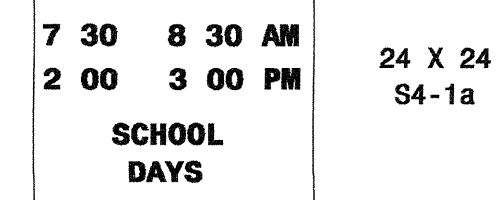

MOUNT BELOW SIGN 424
IN 2 INSTALLATIONS
MOUNT BELOW SIGN 401
IN 2 INSTALLATIONS

428 QUANTITY REQ'D 1

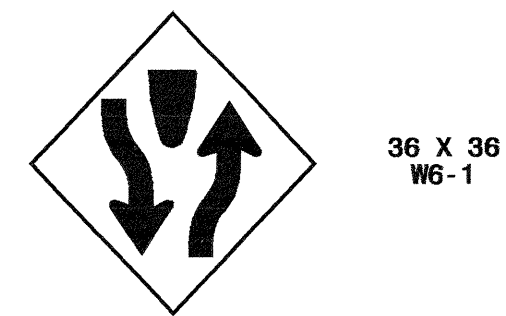

ONE "U" POST PER SIGN

402 QUANTITY REQ'D 22

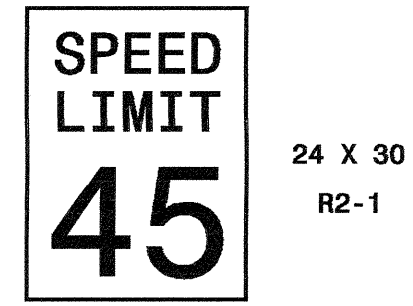

ONE "U" POST PER SIGN

412 QUANTITY REQ'D 3

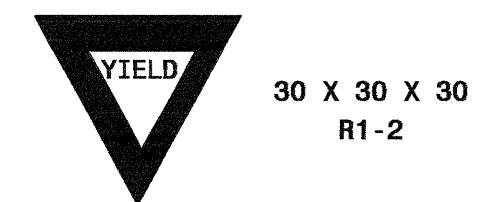

ONE "U" POST PER SIGN

417 QUANTITY REQ'D 35

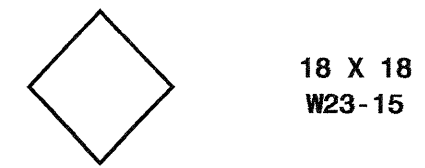

MOUNT BELOW SIGN 416
IN 35 INSTALLATIONS

424 QUANTITY REQ'D 2

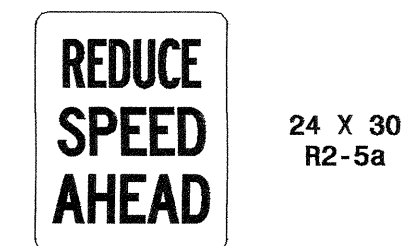

MOUNT BELOW SIGN 419
IN 2 INSTALLATIONS
ONE "U" POST PER SIGN

429 QUANTITY REQ'D 1

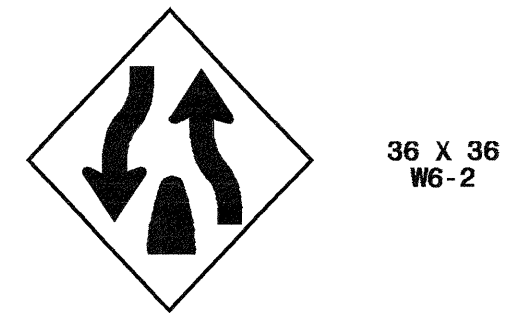

ONE "U" POST PER SIGN

408 QUANTITY REQ'D 25

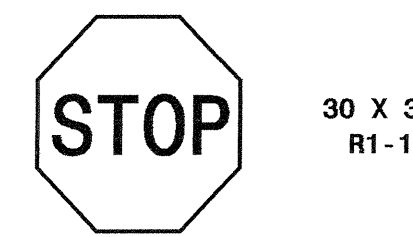

ONE "U" POST PER SIGN

413 QUANTITY REQ'D 20



MOUNT BEHIND 414
IN 1 INSTALLATION
TWO "U" POSTS PER SIGN

419 QUANTITY REQ'D 4



ONE "U" POST PER SIGN

425 QUANTITY REQ'D 13

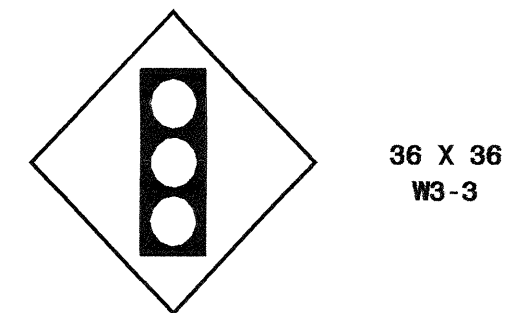

ONE "U" POST PER SIGN

430 QUANTITY REQ'D 2



ONE "U" POST PER SIGN

409 QUANTITY REQ'D 10

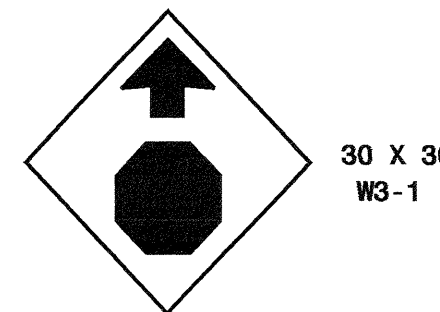

ONE "U" POST PER SIGN

414 QUANTITY REQ'D 10



TWO "U" POSTS PER SIGN

420 QUANTITY REQ'D 2



MOUNT BELOW SIGN 421
IN 2 INSTALLATIONS

426 QUANTITY REQ'D 1

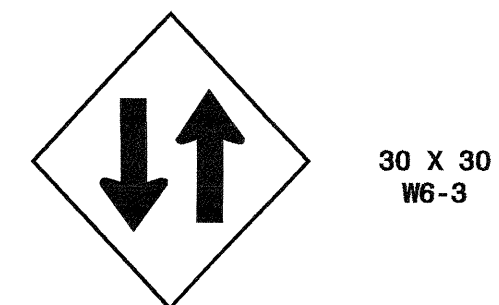

ONE "U" POST PER SIGN

431 QUANTITY REQ'D 1

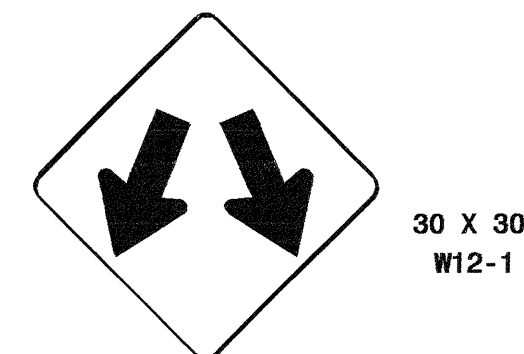

ONE "U" POST PER SIGN

410 QUANTITY REQ'D 30

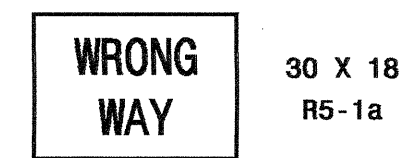

ONE "U" POST PER SIGN

415 QUANTITY REQ'D 6



ONE "U" POST PER SIGN

421 QUANTITY REQ'D 2

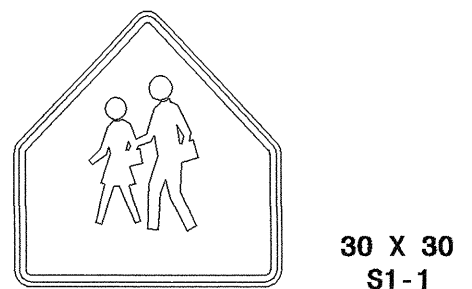

YELLOW/GREEN REFLECTIVE SHEETING

ONE "U" POSTS PER SIGN

427 QUANTITY REQ'D 1

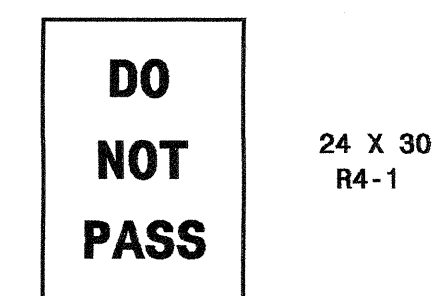

ONE "U" POST PER SIGN

TYPE "E" SIGNS

15-MAY-2008 09:48
 P:\VPPF\JULIA\3833A\Traffic\Signing\CA00\Quantities & CM_Signs\R-3833A\Drawings\SuppChrt E&F_signs.dgn
 wdkduk

13 MAY 2008 11:15
K:\Projects\Signage\Signing Layout Plans\R-3833A_Sgn_-04.dgn

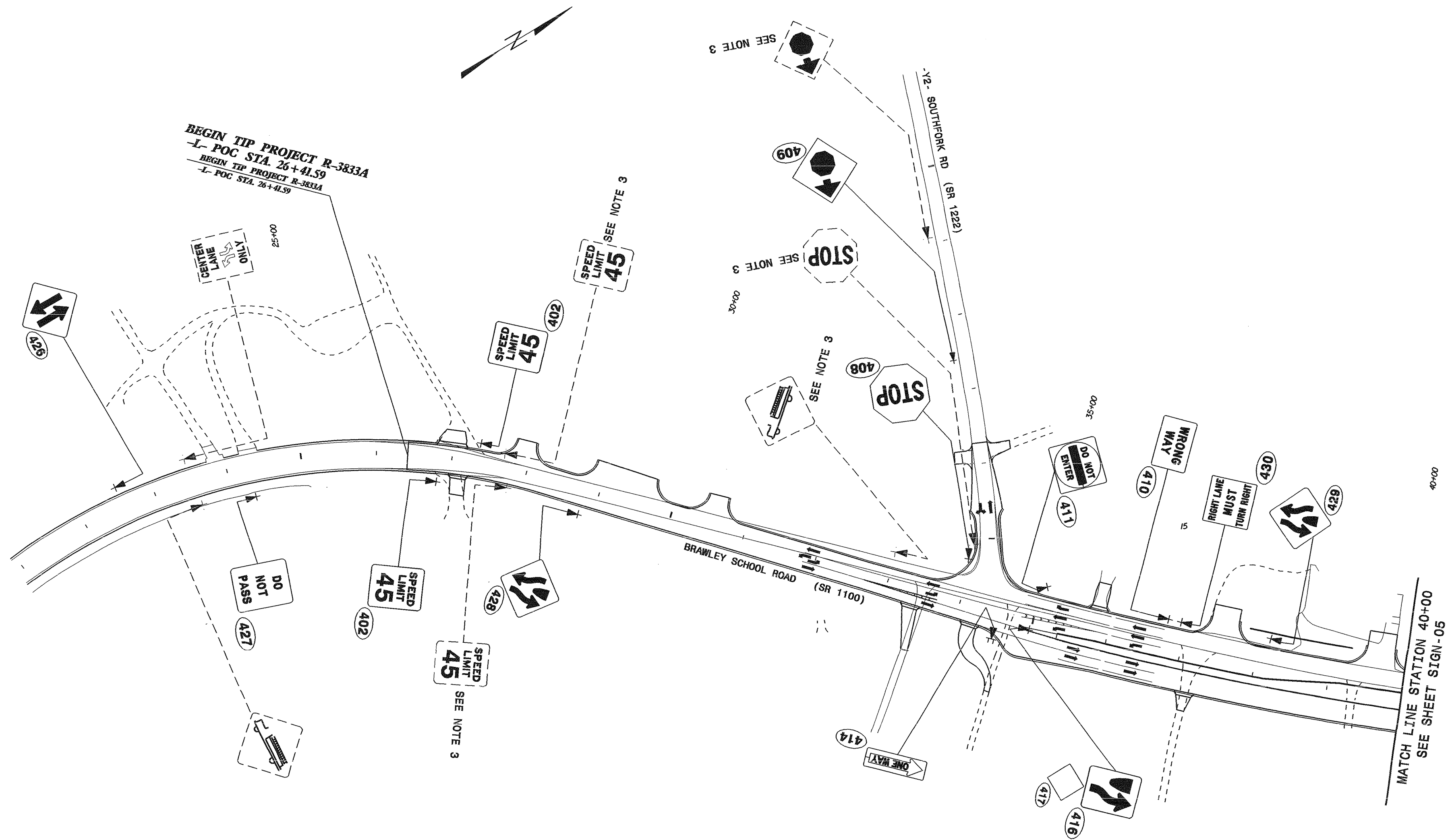

TIP NO. R-3833A	SHEET NO. SIGN-04
APPROVED: <i>[Signature]</i>	
DATE: 5/19/08	
SEAL	

SEAL
028387
ENGINEER
ATMAN I. ALQUDWAN

EXISTING AND PROPOSED SIGNS
-L- STA. 26+41.59 TO 40+00
SR 1100 (BRAWLEY SCHOOL RD)

15 MAY 2008 13:38
ppf09.ctb
wakkuk
Traffic\Signing\CADD\Signing Layout Plans\R-3833A_Sgn_-05.dgn

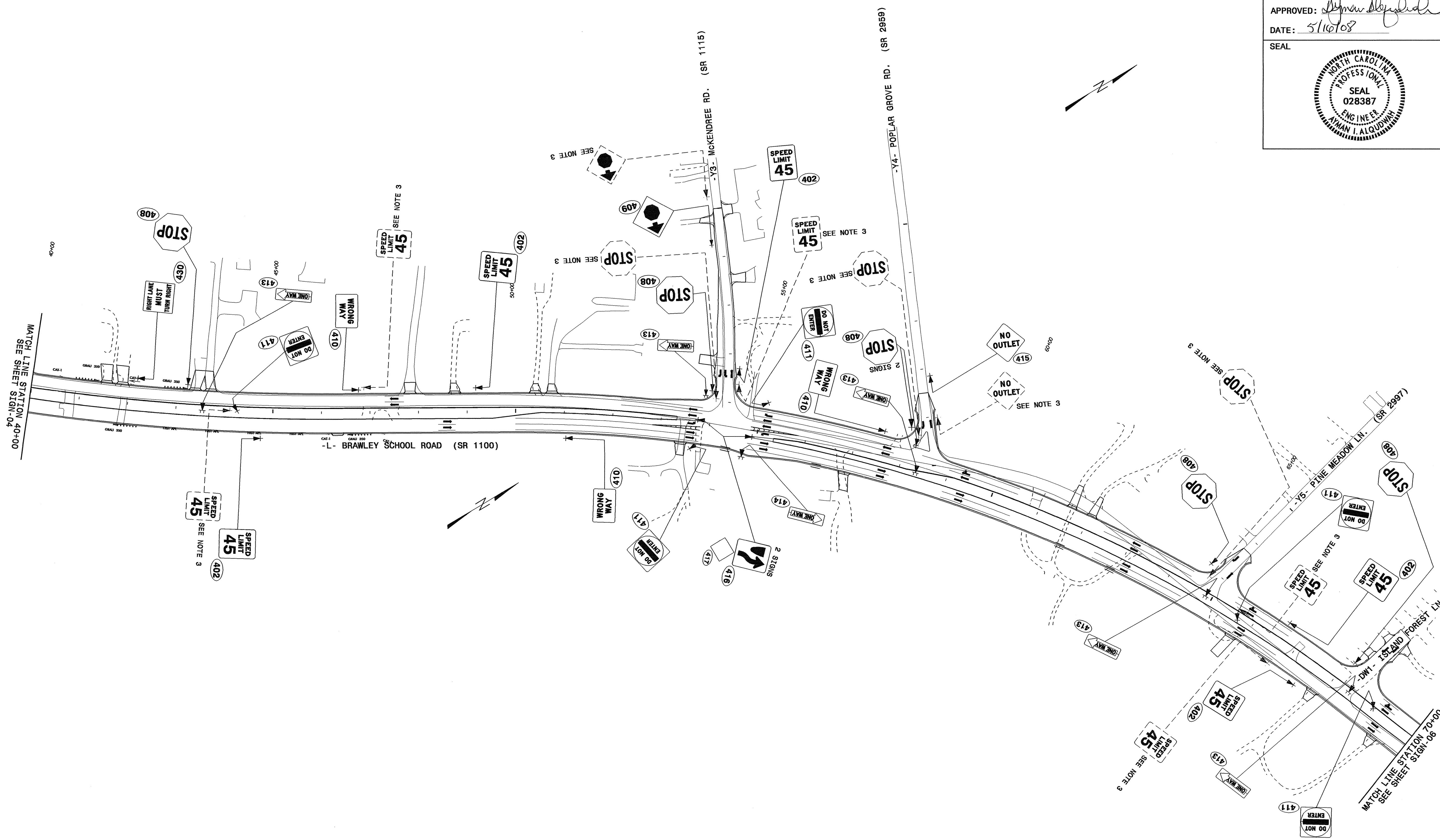

TIP NO. R-3833A	SHEET NO. SIGN-05
APPROVED: <i>[Signature]</i>	
DATE: 5/16/08	
SEAL	

Professional Engineer Seal for Alan I. Alquodiah, State of North Carolina, License No. 028387.

EXISTING AND PROPOSED SIGNS
-L- STA. 40+00 TO 70+00
SR 1100 (BRAWLEY SCHOOL RD)

15 MAY 2008 13:41 B3833A Traffic\Signing\CADD\Signing Layout Plans\R-3833A_Sgn_-06.dgn
mdakduk

TIP NO. R-3833A	SHEET NO. SIGN-06
APPROVED: <i>[Signature]</i>	
DATE: 5/16/08	
SEAL	

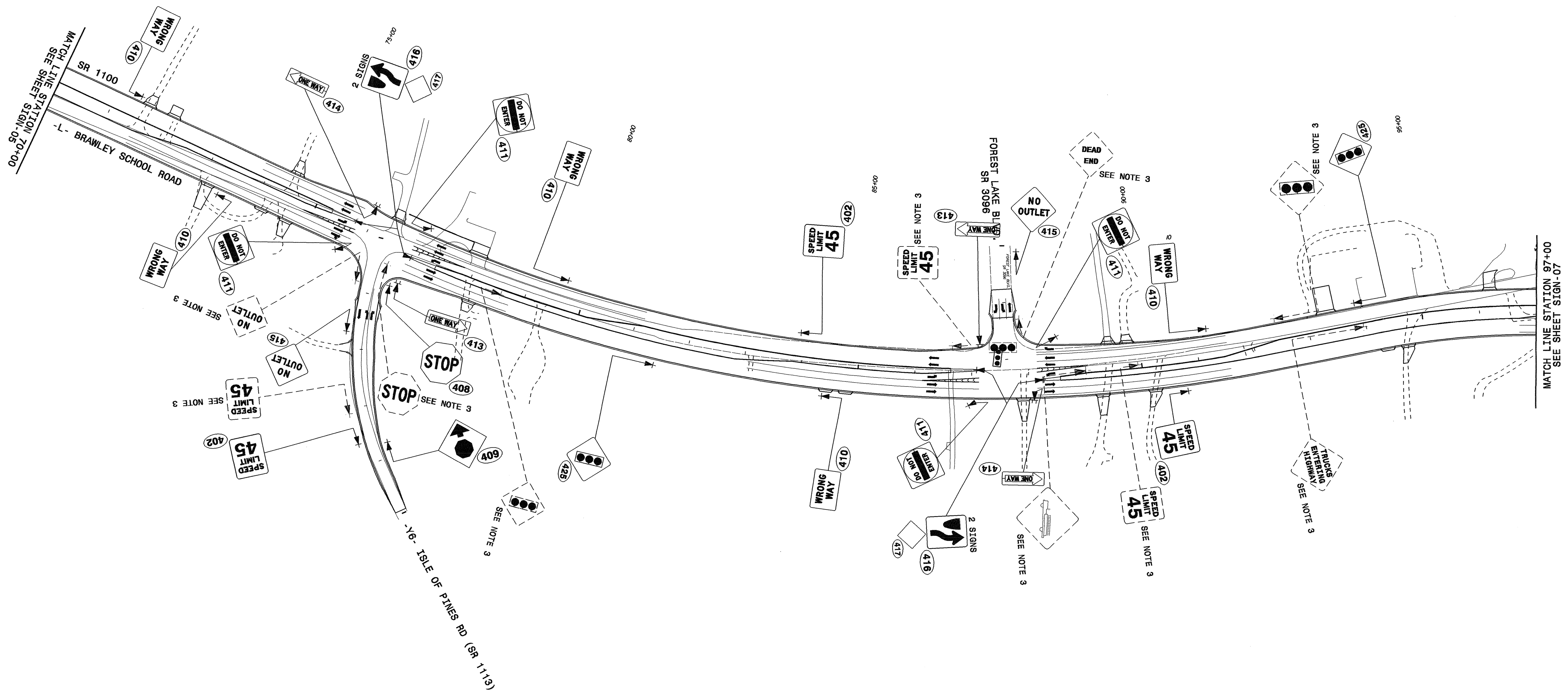

EXISTING AND PROPOSED SIGNS
-L- STA. 70+00 TO 97+00
SR 1100 (BRAWLEY SCHOOL RD)

TIP NO. R-3833A	SHEET NO. SIGN-07
APPROVED: <i>[Signature]</i>	
DATE: 5/13/08	
SEAL	

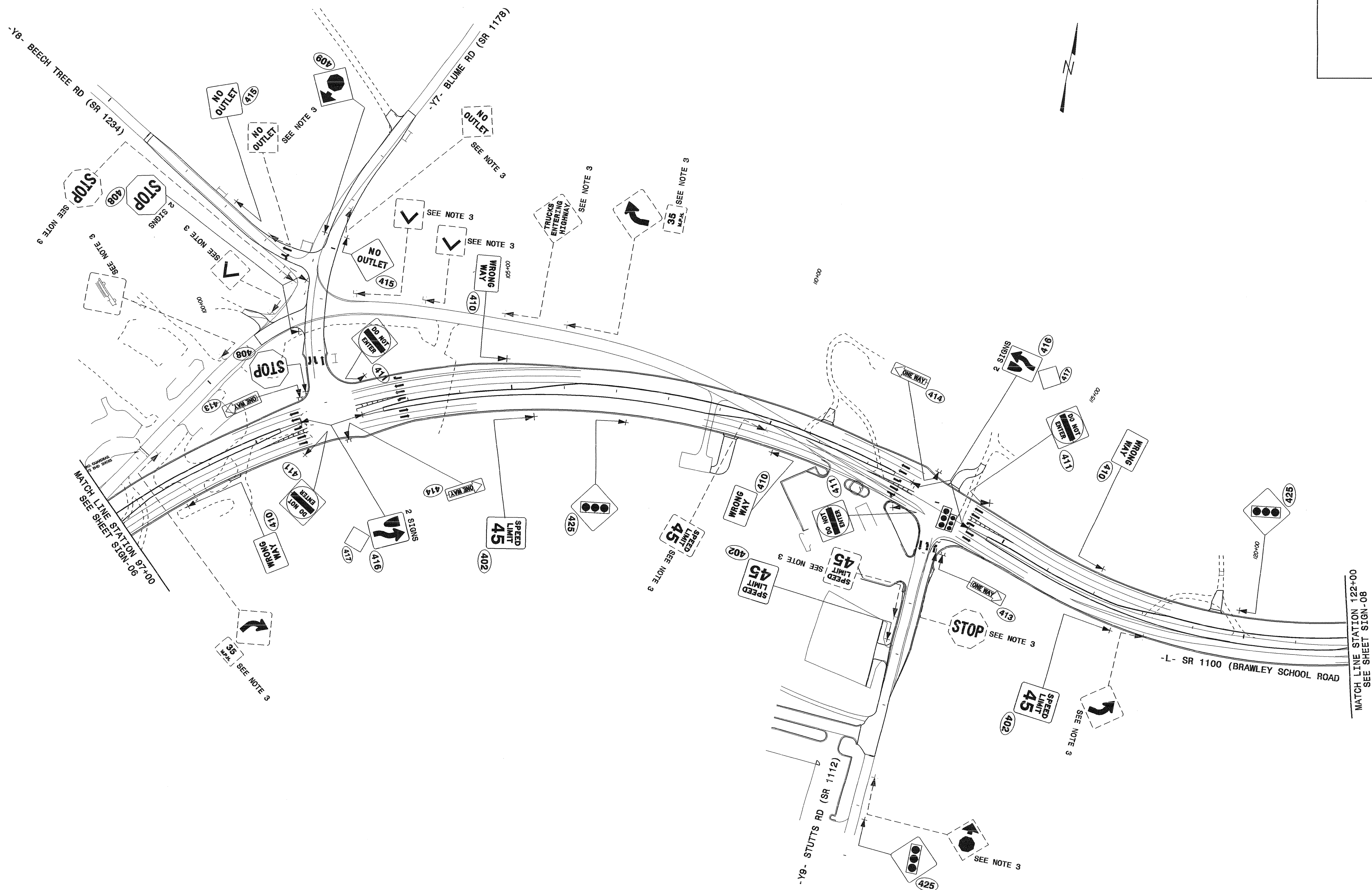

P:\MAY 2008\11:18\38333A\Traffic\Signing\CADD\Signing Layout Plans\R-3833A_Sgn_-07.dgn
 WdakuK

EXISTING AND PROPOSED SIGNS
 -L- STA. 97+00 TO 122+00
 SR 1100 (BRAWLEY SCHOOL RD)

19 MAY 2008 11:19:19 R:\B3833A\Traffic\Signing\CADD\Signing Layout Plans\R-3833A_Sgn_-08.dgn
wakkuk

TIP NO. R-3833A	SHEET NO. SIGN-08
APPROVED: <i>[Signature]</i>	
DATE: 5/13/08	
SEAL	



EXISTING AND PROPOSED SIGNS
-L- STA. 122+00 TO 148+00
SR 1100 (BRAWLEY SCHOOL RD)

15-MAY-2008 13:43 R-3833A.dgn
 \\sawdork\at\150221876\Traffic\signing\CADD\Signing Layout Plans\R-3833A_Sgn_-09.dgn

TIP NO. R-3833A	SHEET NO. SIGN-09
APPROVED: <i>[Signature]</i>	
DATE: 5/16/08	
SEAL	

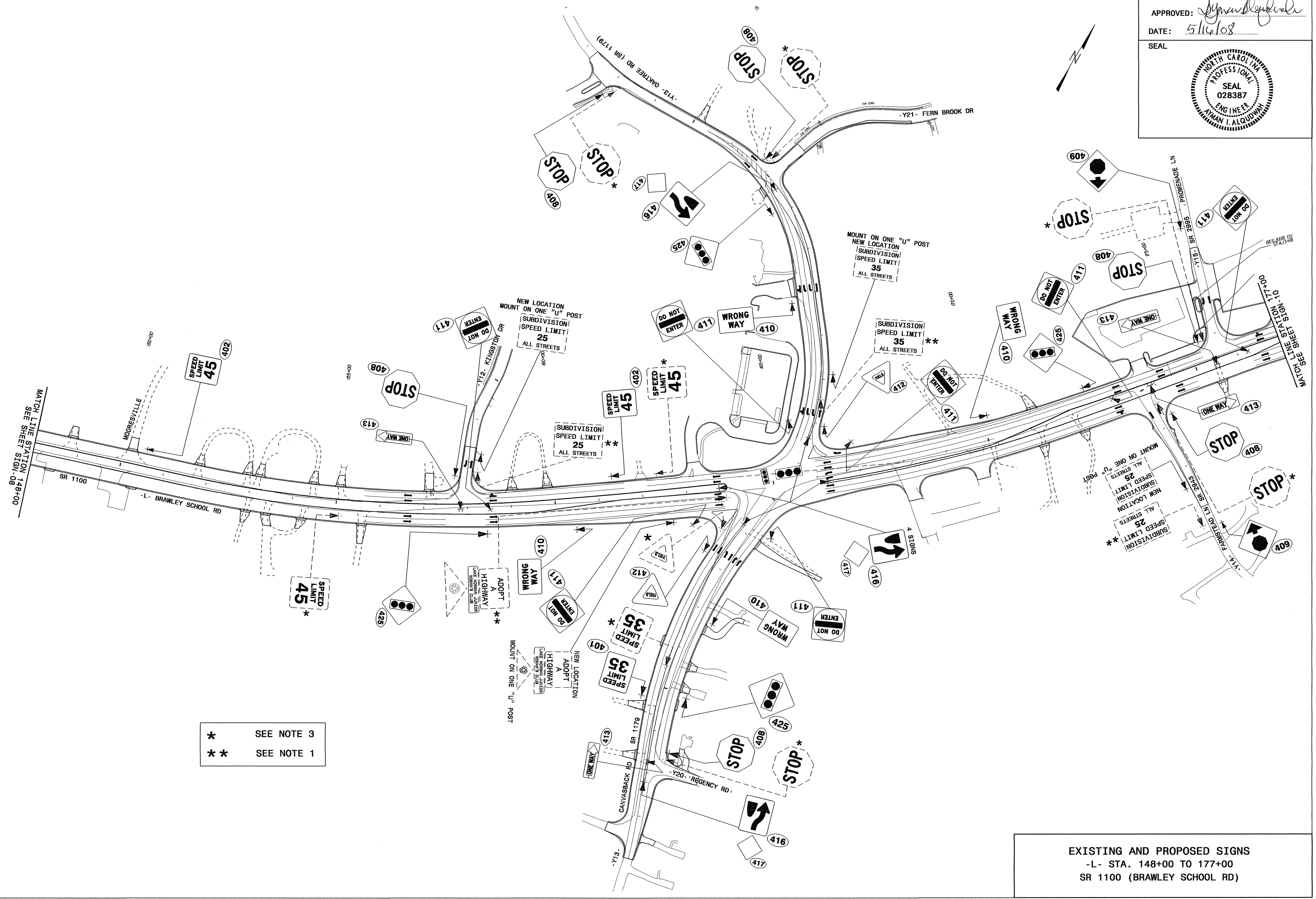

* SEE NOTE 3
 ** SEE NOTE 1

EXISTING AND PROPOSED SIGNS
 -L- STA. 148+00 TO 177+00
 SR 1100 (BRAWLEY SCHOOL RD)

15-MAY-2008 13:44 \\ppp2008-13:44\Traffic\Signing\CADD\Signing Layout Plans\R-3833A_Sgn_-10.dgn
 wdakduk

TIP NO. R-3833A	SHEET NO. SIGN-10
APPROVED: <i>[Signature]</i>	
DATE: 5/16/08	
SEAL	



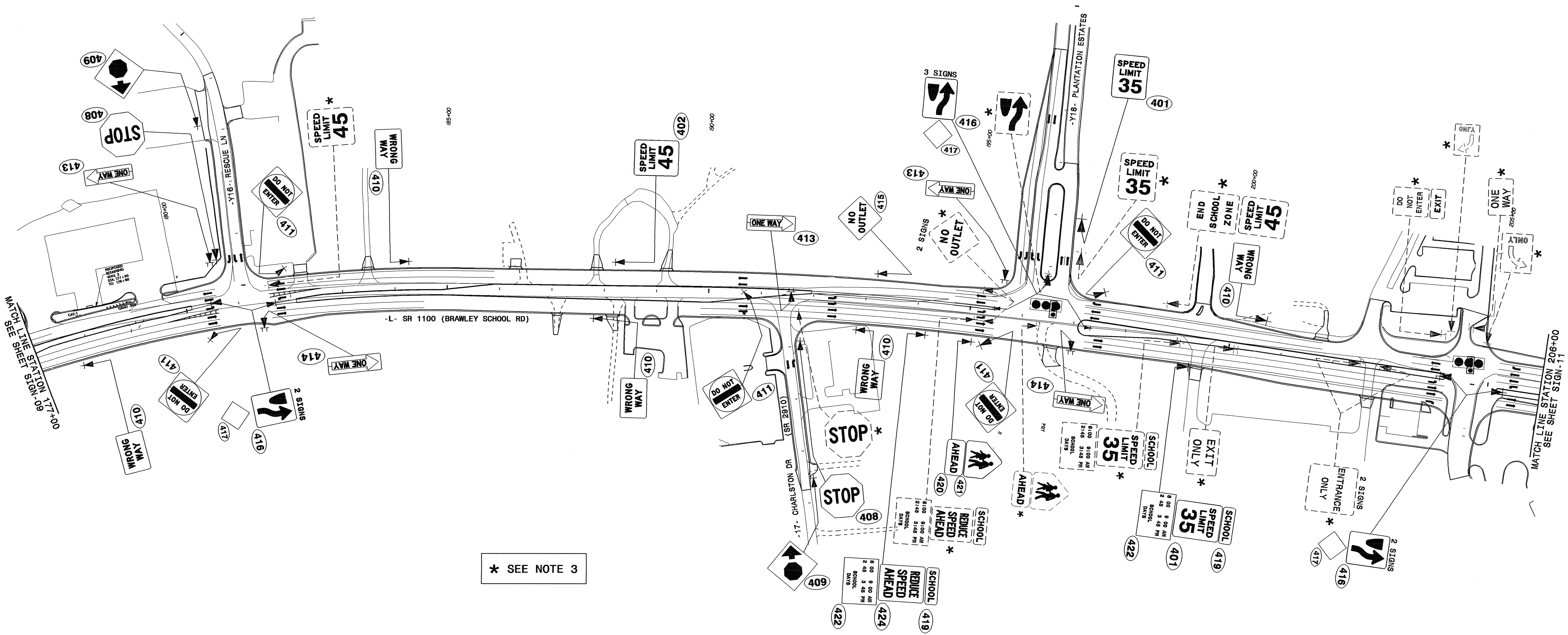

* SEE NOTE 3

EXISTING AND PROPOSED SIGNS
 -L- STA. 177+00 TO 206+00
 SR 1100 (BRAWLEY SCHOOL RD)

15-MAY-2008 13:45:45 R-3833A-Traffic\Signing\CADD\Signing Layout Plans\R-3833A_Sgn_-11.dgn
wdaokuk

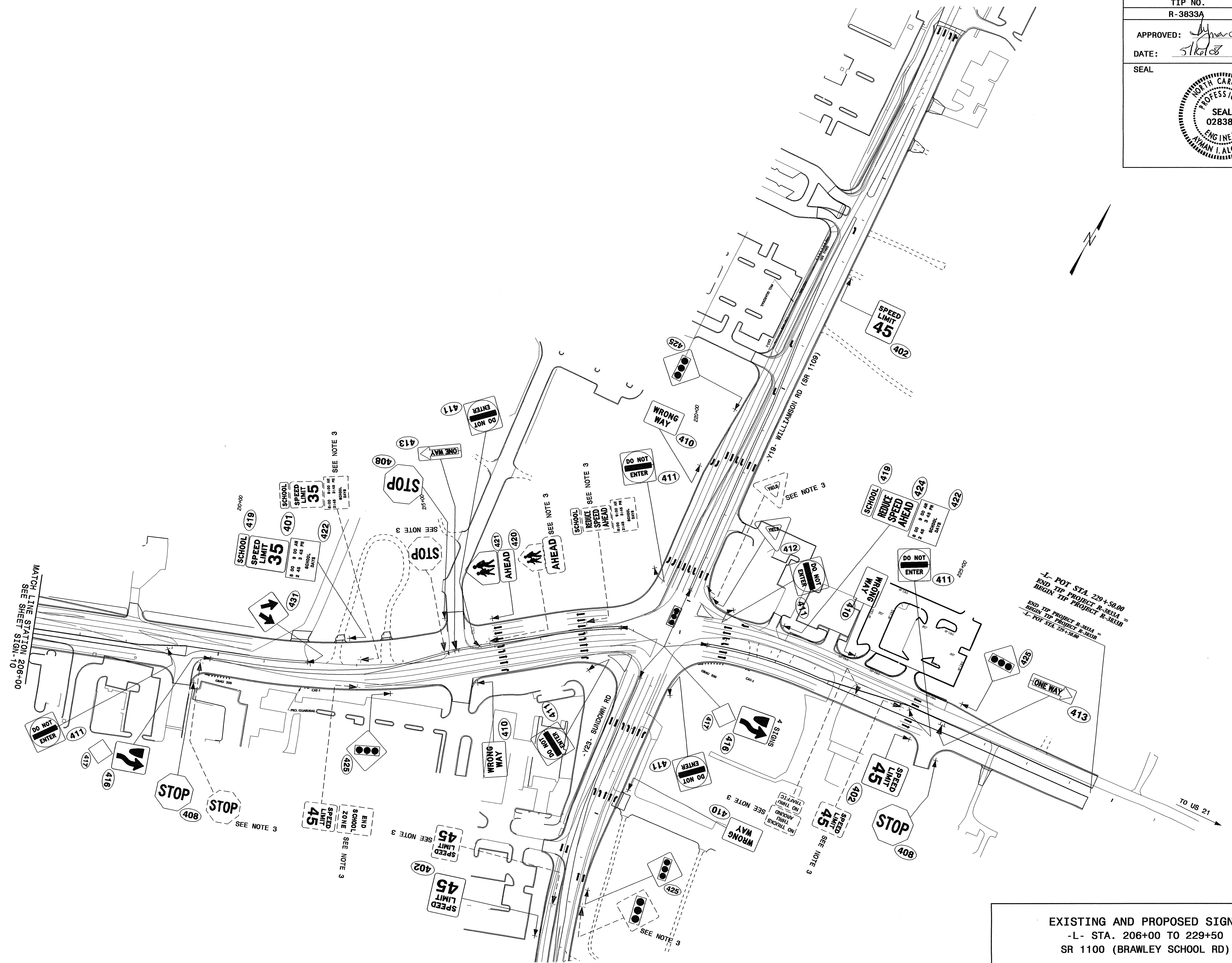

TIP NO. R-3833A	SHEET NO. SIGN-11
APPROVED: <i>[Signature]</i>	
DATE: 5/16/08	
SEAL	

EXISTING AND PROPOSED SIGNS
-L- STA. 206+00 TO 229+50
SR 1100 (BRAWLEY SCHOOL RD)