

# FINAL PAVEMENT MARKING SCHEDULE



PROJ. REFERENCE NO.	SHEET NO.
R-2554BA	PM-1

SYMBOL	DESCRIPTION	PAY ITEM/ QUANTITY BREAKDOWN	TOTAL QUANTITY
<b>PAVEMENT MARKING LINES</b>			
<b>POLYUREA (150 mm)</b>			
V6	WHITE EDGE LINE	14000 m	
V7	YELLOW EDGE LINE	13000 m	
VJ	3 m YELLOW SKIP	3125 m	
VK	0.5 m WHITE MINI-SKIP	250 m	
		TOTAL	30375 m
<b>POLYUREA (200 mm)</b>			
VP	WHITE GORE LINE	2000 m	
		TOTAL	2000 m
<b>THERMOPLASTIC (100 mm, 2.3 mm)</b>			
TA	WHITE EDGE LINE	14000 m	
TB	YELLOW EDGE LINE	7000 m	
		TOTAL	21000 m
<b>THERMOPLASTIC (100 mm, 3.1 mm)</b>			
TD	0.5 m WHITE MINI-SKIP	180 m	
TE	WHITE SOLID LANE LINE	1000 m	
TF	3 m YELLOW SKIP	175 m	
TH	YELLOW SINGLE CENTER	700 m	
TI	YELLOW DOUBLE CENTER LINE	6400 m	
		TOTAL	8455 m
<b>THERMOPLASTIC (150mm, 3.1mm)</b>			
TJ	3 m WHITE SKIP	700 m	
		TOTAL	700 m
<b>THERMOPLASTIC (200 mm, 2.3 mm)</b>			
TP	WHITE GORE LINE	200 m	
TQ	WHITE DIAGONAL	130 m	
TT	YELLOW DIAGONAL	120 m	
		TOTAL	450 m
<b>THERMOPLASTIC (600 mm, 3.1 mm)</b>			
T2	WHITE STOP BAR	120 m	
		TOTAL	120 m
<b>PAINT (100 mm)</b>			
PA	WHITE EDGE LINE (2X)	4400 m	
PB	YELLOW EDGE LINE (2X)	1100 m	
PD	0.5 m WHITE MINI-SKIP (2X)	40 m	
PE	WHITE SOLID LANE LINE (2X)	270 m	
PI	YELLOW DOUBLE CENTER LINE (2X)	5600 m	
		TOTAL	11410 m
<b>PAINT (200 mm)</b>			
PV	YELLOW DIAGONAL (2X)	1300 m	
		TOTAL	1300 m
<b>PAINT (600 mm)</b>			
P4	WHITE STOP BAR (2X)	40 m	
		TOTAL	40 m
<b>PAVEMENT MARKING SYMBOLS</b>			
<b>POLYUREA SYMBOLS</b>			
WC	STRAIGHT ARROW	24 EA	
		TOTAL	24 EA
<b>THERMOPLASTIC SYMBOLS (2.3 mm)</b>			
UA	LEFT TURN ARROW	33 EA	
UB	RIGHT TURN ARROW	11 EA	
UC	STRAIGHT ARROW	22 EA	
UE	COMBO STRAIGHT & RIGHT TURN ARROW	7 EA	
		TOTAL	73 EA
<b>THERMOPLASTIC PAVEMENT CHARACTERS (3.1 mm)</b>			
UI	ALPHANUMERIC CHAR.	4 EA	
		TOTAL	4 EA
<b>PAINT SYMBOLS</b>			
QA	LEFT TURN ARROW (2X)	6 EA	
QB	RIGHT TURN ARROW (2X)	10 EA	
QC	STRAIGHT ARROW (2X)	18 EA	
QD	COMBO. STRAIGHT/LEFT (2X)	4 EA	
		TOTAL	38 EA
<b>PAVEMENT MARKERS</b>			
<b>PERMANENT RAISED</b>			
MA	YELLOW & YELLOW	760 EA	
MB	CRYSTAL & RED	1410 EA	
		TOTAL	2170 EA

NOTE: FOR EACH PAINT PAVEMENT MARKING ITEM, 1X IMPLIES A SINGLE APPLICATION, 2X IMPLIES TWO APPLICATIONS, AND 3X IMPLIES THREE APPLICATIONS.

APPROVED: _____	DATE: _____	<b>FINAL PAVEMENT MARKING SCHEDULE</b>					
		SCALE: NONE					
		DATE: NOV-07					
		DWG. BY: AYL					
		DESIGN BY: AYL					
REVIEWED BY: JLP		CADD FILE	<table border="1" style="width: 100%; border-collapse: collapse;"> <tr> <th colspan="2" style="font-size: x-small;">REVISIONS</th> </tr> <tr> <td style="width: 50%; height: 20px;"></td> <td style="width: 50%;"></td> </tr> </table>	REVISIONS			
REVISIONS							

03-DEC-2007 13:26 \\dot\dfs\00101\projects\store\proj\hiprojects-r\2554ba\traffic\trafficcontrol\top\002\FinalPMP\R-2554BA-TC-PMP-OL-FINAL PMP Schedule.dgn







PROJ. REFERENCE NO.	SHEET NO.
R-2554BA	PM-4

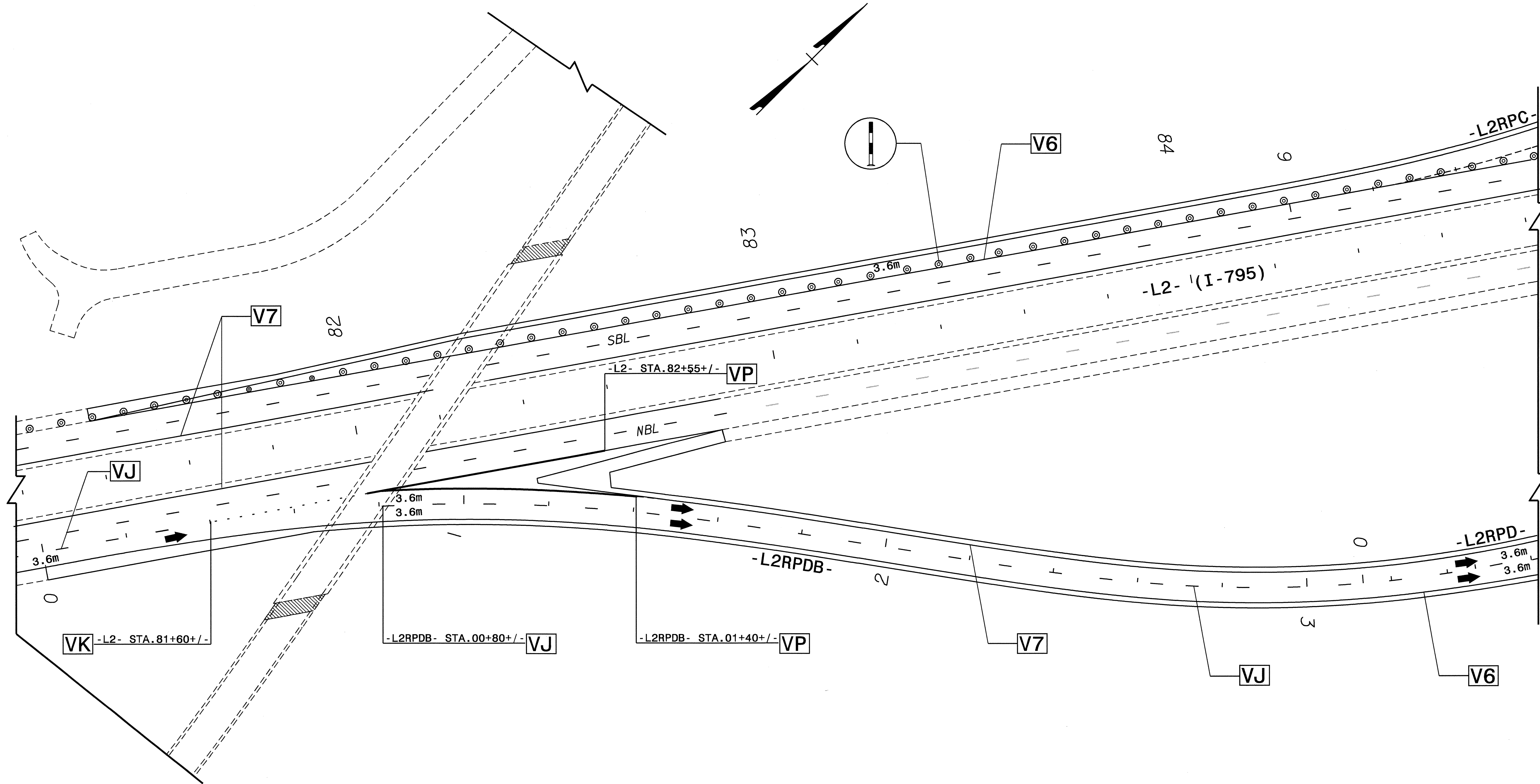

NOTE:  
REFER TO SHEET PM-1 FOR FINAL PAVEMENT MARKING SCHEDULE.

APPROVED: _____ DATE: _____	<b>FINAL PAVEMENT MARKING PLAN</b>		REVISIONS	
			SCALE: NONE	
	DATE: OCT-07	_____		
	DWG. BY: AYL	DESIGNED BY: AYL	REVIEWED BY: JLP	

03-DEC-2007 15:29  
 \\dot\dfsroot\projstore\proj\ipproj\projects\r\2554ba\traffic\trafficcontrol\top\100% Final\PM-4-T.C.PMP-04.dgn  
 dlyudini AT WZ1C23740

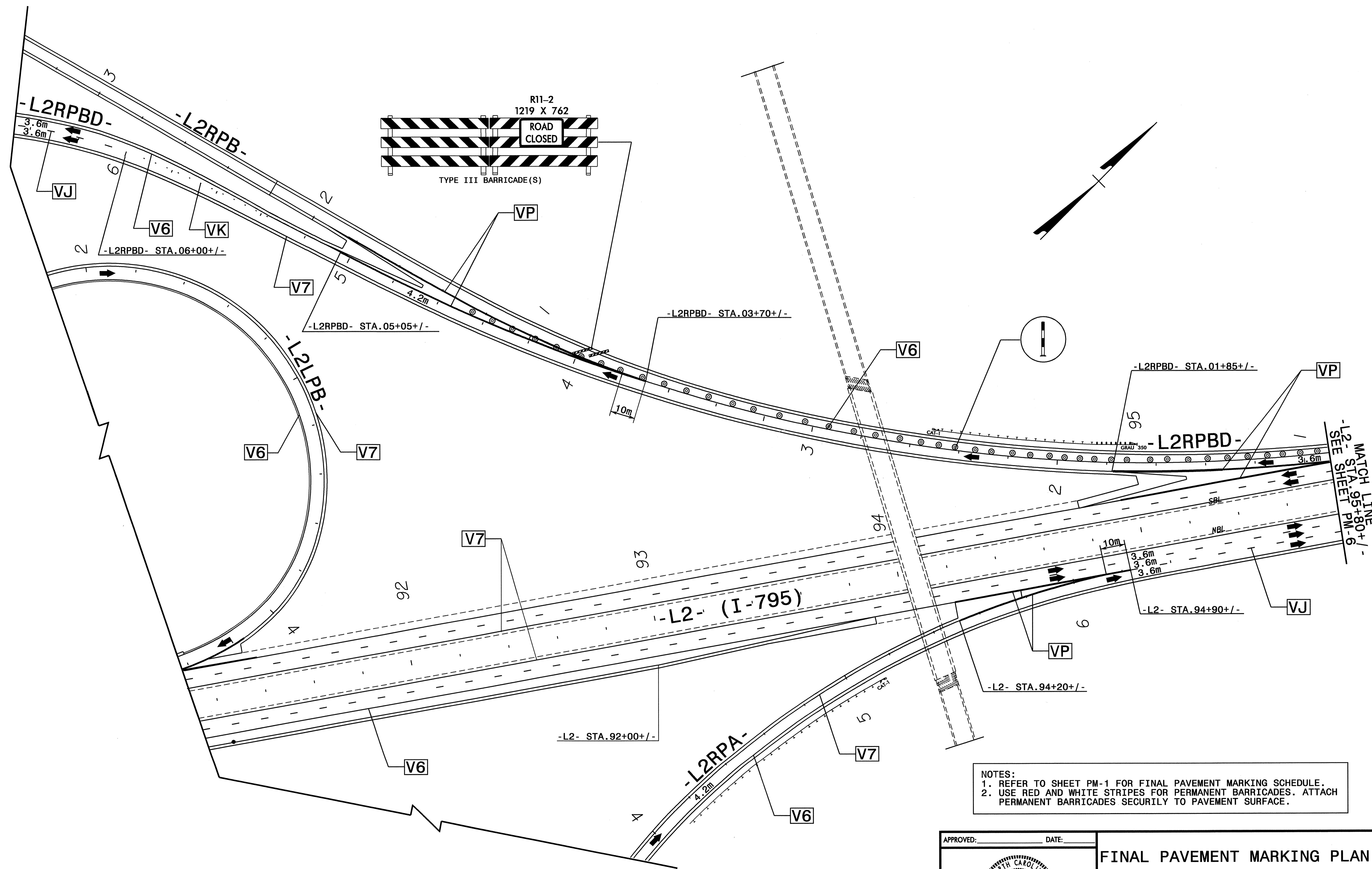

NOTES:  
 1. REFER TO SHEET PM-1 FOR FINAL PAVEMENT MARKING SCHEDULE.  
 2. USE RED AND WHITE STRIPES FOR PERMANENT BARRICADES. ATTACH PERMANENT BARRICADES SECURELY TO PAVEMENT SURFACE.

APPROVED: \_\_\_\_\_ DATE: \_\_\_\_\_

*John P. [Signature]*  
 PROFESSIONAL ENGINEER  
 027836  
 ENGINEER  
 PORTLAND, OREGON  
 12/3/07

**FINAL PAVEMENT MARKING PLAN**

SCALE: NONE  
 DATE: OCT-07  
 DWG. BY: AYL  
 DESIGN BY: AYL  
 REVIEWED BY: JLP

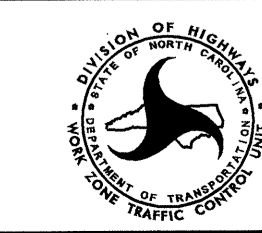

REVISIONS	

03-DEC-2007 15:30  
 \\dot\dfs\0310\projects\store\projstore\2554ba\traffic\trafficcontrol\top\002\FinalPMP\AR-2554BA\_TC\_PMP\_05.dgn  
 gilyucmi AT MZTC237440





PROJ. REFERENCE NO.	SHEET NO.
R-2554BA	PM-7

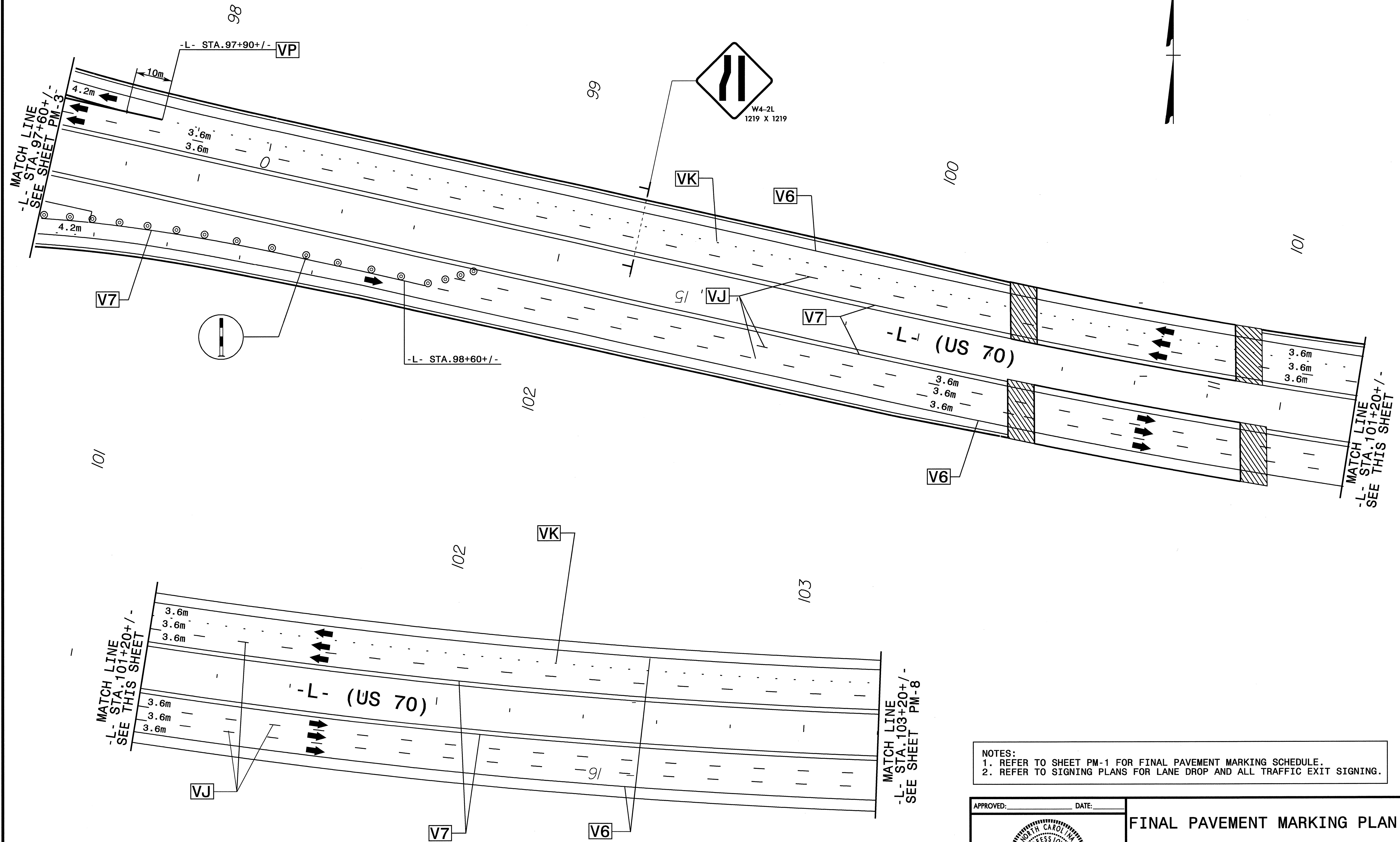
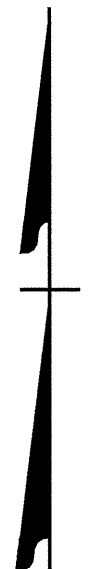

NOTES:  
 1. REFER TO SHEET PM-1 FOR FINAL PAVEMENT MARKING SCHEDULE.  
 2. REFER TO SIGNING PLANS FOR LANE DROP AND ALL TRAFFIC EXIT SIGNING.

APPROVED: \_\_\_\_\_ DATE: \_\_\_\_\_  
  
 James L. Portantoni  
 12/21/07

<b>FINAL PAVEMENT MARKING PLAN</b>		REVISIONS									
SCALE:	NONE		<table border="1"> <tr><td> </td><td> </td></tr> <tr><td> </td><td> </td></tr> <tr><td> </td><td> </td></tr> <tr><td> </td><td> </td></tr> </table>								
DATE:	OCT-07										
DWG. BY:	AYL										
DESIGN BY:	AYL										
REVIEWED BY:	JLP	CARD									
		FILE									

03-DEC-2007 15:23  
 \\dot\dfs\05101\projstore\projstore\2554ba\traffic\trafficcontrol\top\002\FinalPMP\R-2554BA\_TC\_PMP\_07.dgn  
 gilyuemi AT MZTC237440



PROJ. REFERENCE NO.	SHEET NO.
R-2554BA	PM-8

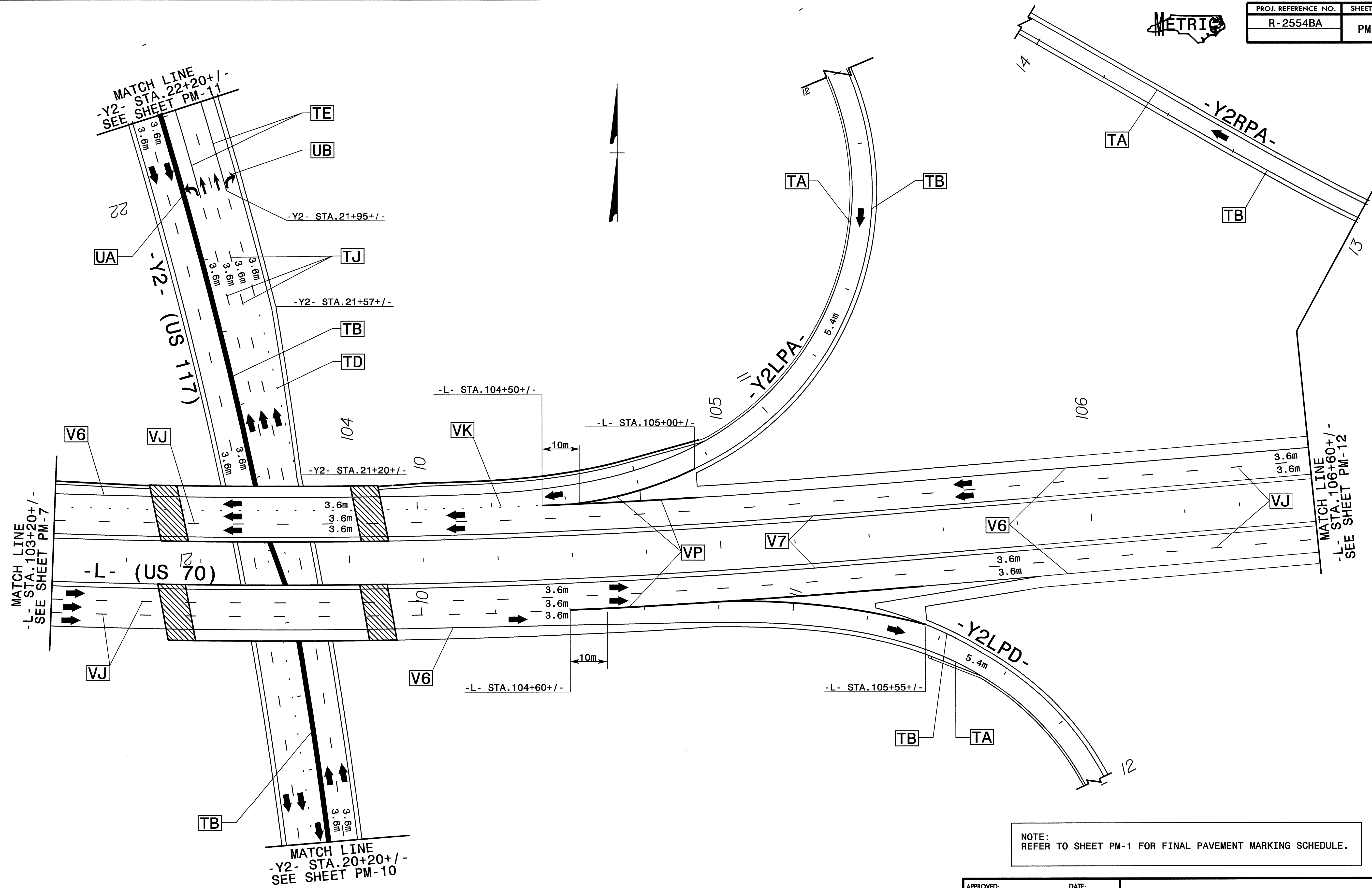

NOTE:  
REFER TO SHEET PM-1 FOR FINAL PAVEMENT MARKING SCHEDULE.

APPROVED: _____ DATE: _____	<b>FINAL PAVEMENT MARKING PLAN</b>																			
<table border="1"> <tr> <td>SCALE:</td> <td>NONE</td> </tr> <tr> <td>DATE:</td> <td>OCT-07</td> </tr> <tr> <td>DWG. BY:</td> <td>AYL</td> </tr> <tr> <td>DESIGN BY:</td> <td>AYL</td> </tr> <tr> <td>REVIEWED BY:</td> <td>JLP</td> </tr> </table>	SCALE:	NONE	DATE:	OCT-07	DWG. BY:	AYL	DESIGN BY:	AYL	REVIEWED BY:	JLP	<table border="1"> <tr> <th colspan="2">REVISIONS</th> </tr> <tr> <td> </td> <td> </td> </tr> <tr> <td> </td> <td> </td> </tr> <tr> <td> </td> <td> </td> </tr> </table>		REVISIONS							
SCALE:	NONE																			
DATE:	OCT-07																			
DWG. BY:	AYL																			
DESIGN BY:	AYL																			
REVIEWED BY:	JLP																			
REVISIONS																				

03-DEC-2007 13:23  
 \\dot\dfs\02101\proj\store\proj\2\store\r\2554ba\traffico\traffico\top\00\Final\PMR-2554BA\_TC\_PMP\_08.dgn  
 jlyu\dmi AT WZTC37440

20



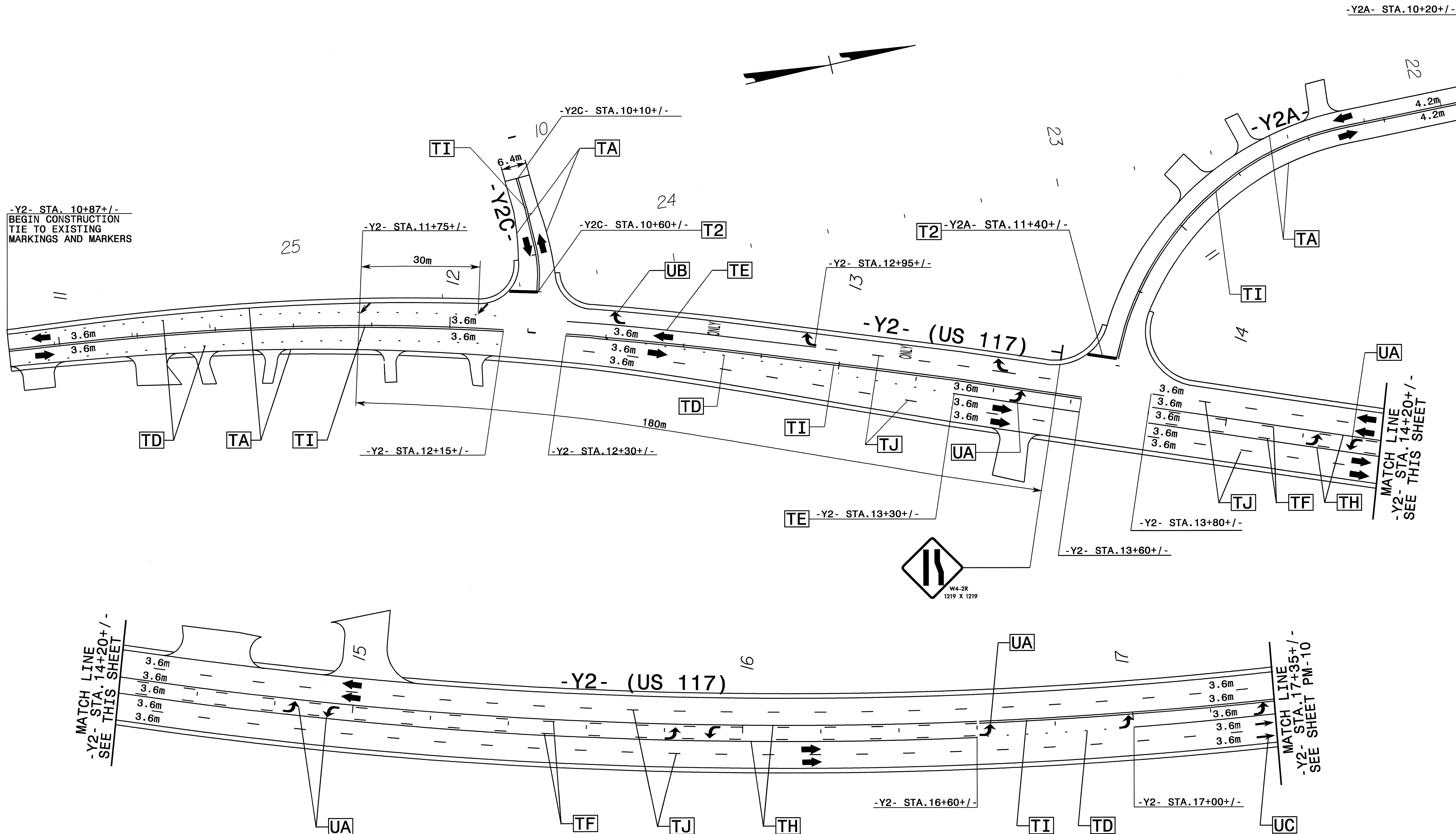

MATCH LINE  
-Y2- STA. 14+20+/-  
SEE THIS SHEET

MATCH LINE  
-Y2- STA. 14+20+/-  
SEE THIS SHEET

MATCH LINE  
-Y2- STA. 17+35+/-  
SEE SHEET PM-10

NOTE:  
REFER TO SHEET PM-1 FOR FINAL PAVEMENT MARKING SCHEDULE.

APPROVED: _____ DATE: _____	<b>FINAL PAVEMENT MARKING PLAN</b>	
SCALE: NONE	REVISIONS	
DATE: OCT-07		
DWG. BY: AYL		
DESIGN BY: AYL		
REVIEWED BY: JLP	CARD FILE	

03-DEC-2007 13:22 \\dot\dfsroot\projects\proj\h\projects\proj\h\2554ba\traffic\trafficcontrol\top\000\FinalPMP\AR-2554BA\_TC\_PMP\_09.dgn

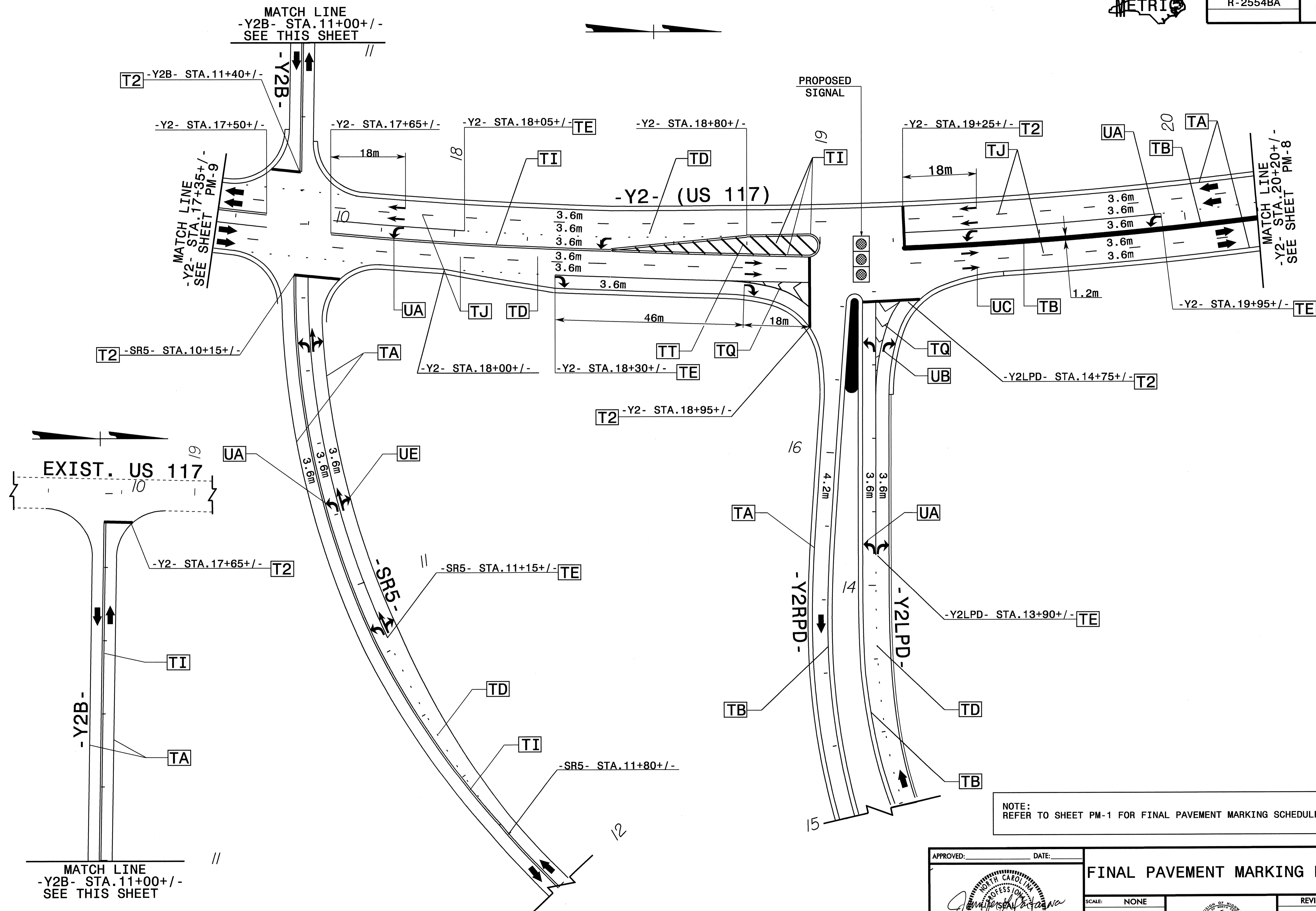

NOTE:  
REFER TO SHEET PM-1 FOR FINAL PAVEMENT MARKING SCHEDULE.

APPROVED: \_\_\_\_\_ DATE: \_\_\_\_\_

12/3/07

**FINAL PAVEMENT MARKING PLAN**

SCALE: NONE  
DATE: OCT-07  
DWG. BY: AYL  
DESIGN BY: AYL  
REVIEWED BY: JLP

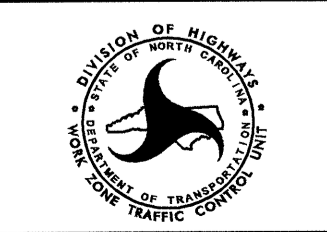

REVISIONS	

03-DEC-2007 13:22  
 \\dot\dfs\oof\projstore\proj\pmp\projects-r\2554ba\traffic\trafficcontrol\top\100\FinalPMP\R-2554BA-TC-PMP\_10.dgn  
 alyudml AT WZTC231440







PROJ. REFERENCE NO.	SHEET NO.
R-2554BA	PM-13

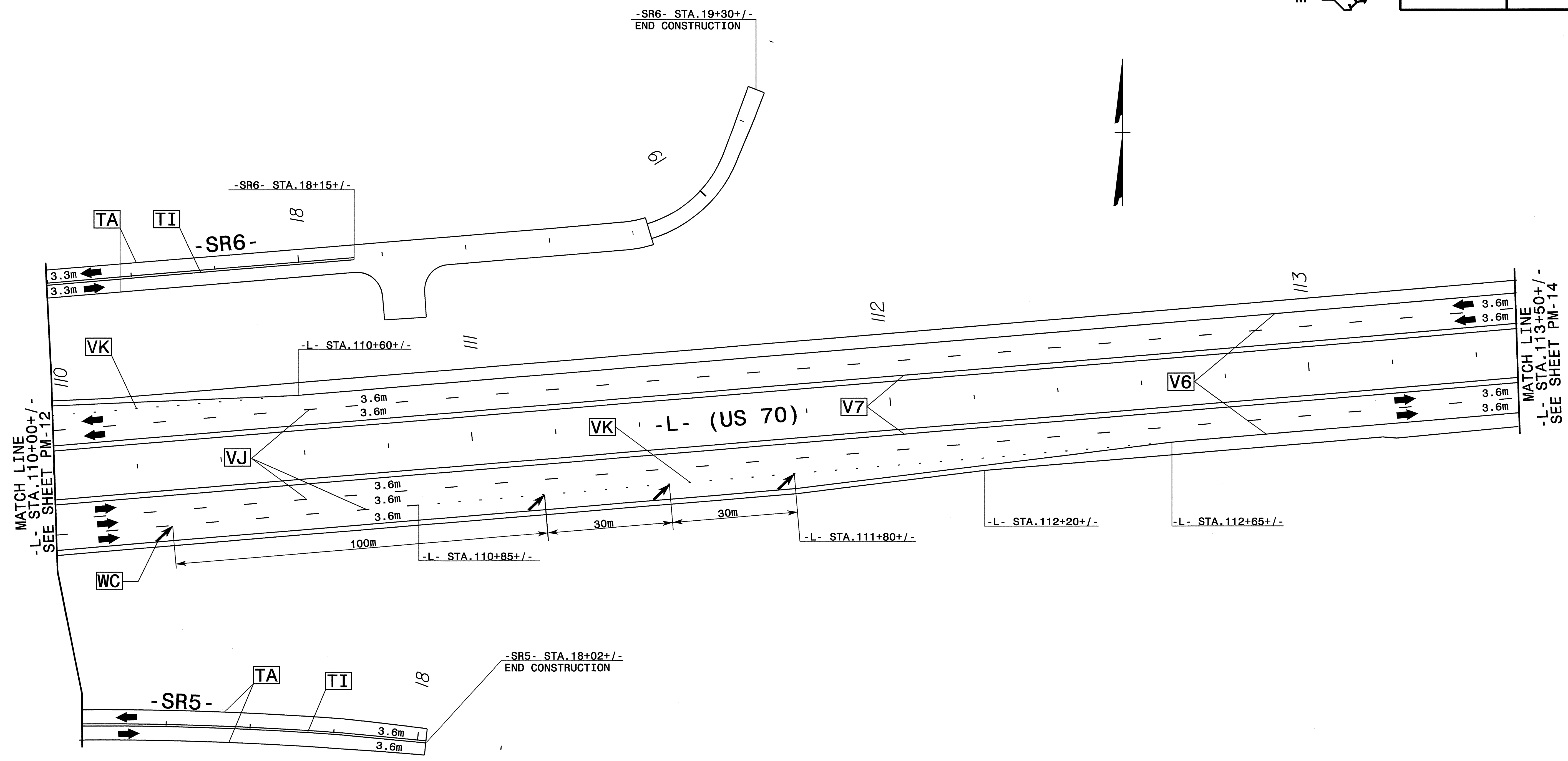

MATCH LINE  
-L- STA. 110+00+/-  
SEE SHEET PM-12

MATCH LINE  
-L- STA. 113+50+/-  
SEE SHEET PM-14

NOTE:  
REFER TO SHEET PM-1 FOR FINAL PAVEMENT MARKING SCHEDULE.

APPROVED: _____	DATE: _____	<b>FINAL PAVEMENT MARKING PLAN</b>	
		DATE: OCT-07	REVISIONS
DWG. BY: AYL			
DESIGN BY: AYL			
REVIEWED BY: JLP			

03-DEC-2007 13:20  
 \\dot\dfs\00101\projstore\proj\pmp\projects-r\2554ba\traffic\control\top\1002\FinalPMP\R-2554BA\_TC\_PMP\_13.dgn  
 glydmi AT WZTC237440



PROJ. REFERENCE NO.	SHEET NO.
R-2554BA	PM-14

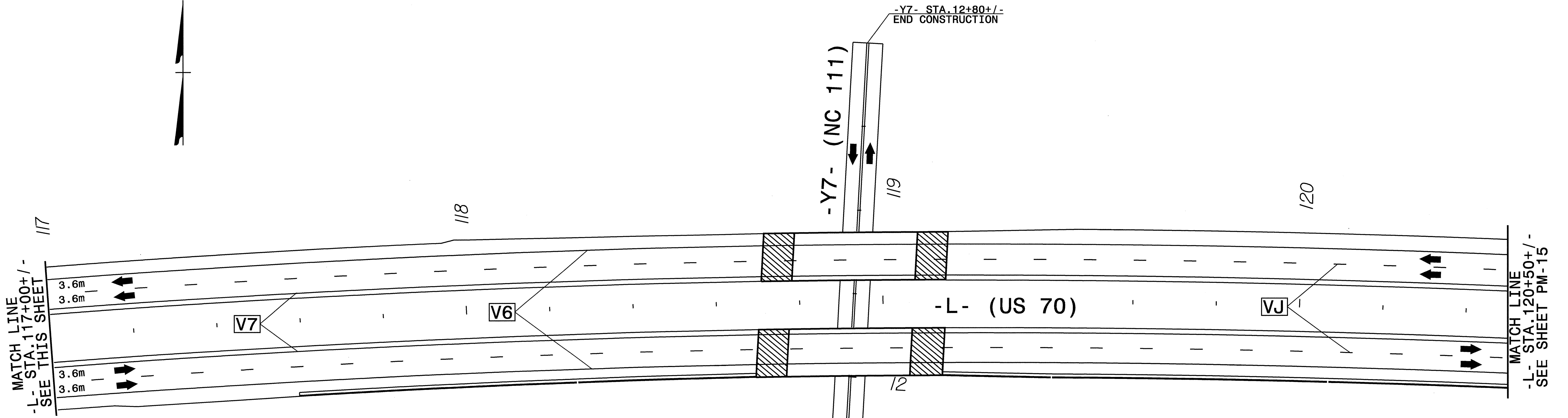
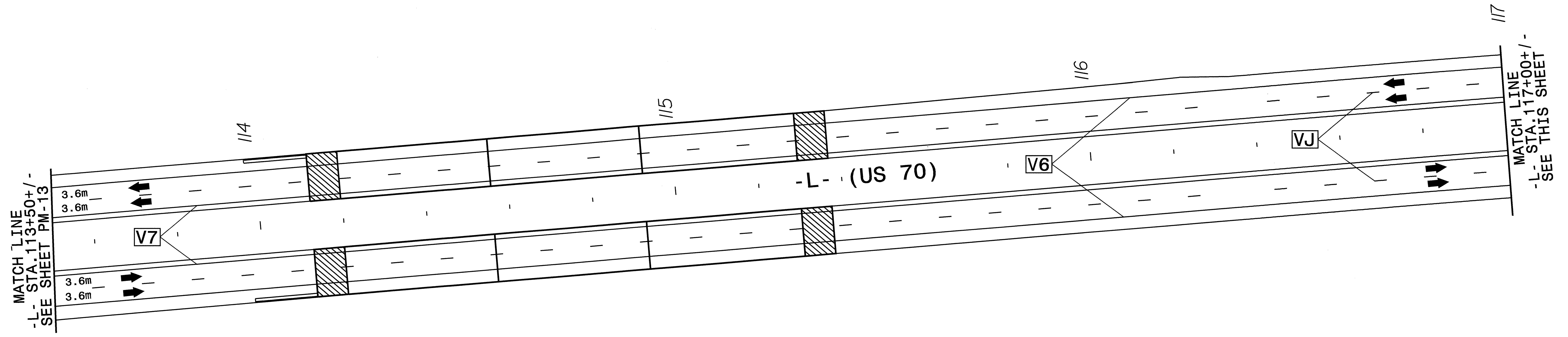

-Y7- STA. 12+80+/-  
END CONSTRUCTION

-Y7- (NC 111)

12

-Y7- STA. 11+60+/-  
BEGIN CONSTRUCTION

TI  
TA

NOTE:  
REFER TO SHEET PM-1 FOR FINAL PAVEMENT MARKING SCHEDULE.

APPROVED: \_\_\_\_\_ DATE: \_\_\_\_\_

12/3/07

**FINAL PAVEMENT MARKING PLAN**

SCALE: NONE  
DATE: OCT-07  
DWG. BY: AYL  
DESIGN BY: AYL  
REVIEWED BY: JLP

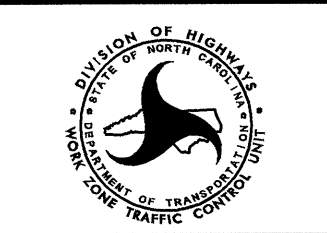

REVISIONS	

03-DEC-2007 15:20  
 \\dot\dfsroot\0\projstore\projstore\proj\2554ba\traffic\trafficcontrol\top\000\FinalPMP\R-2554BA\_TC\_PMP\_14.dgn  
 ghyuemi AT MZIC2374d0



PROJ. REFERENCE NO.	SHEET NO.
R-2554BA	PM-15

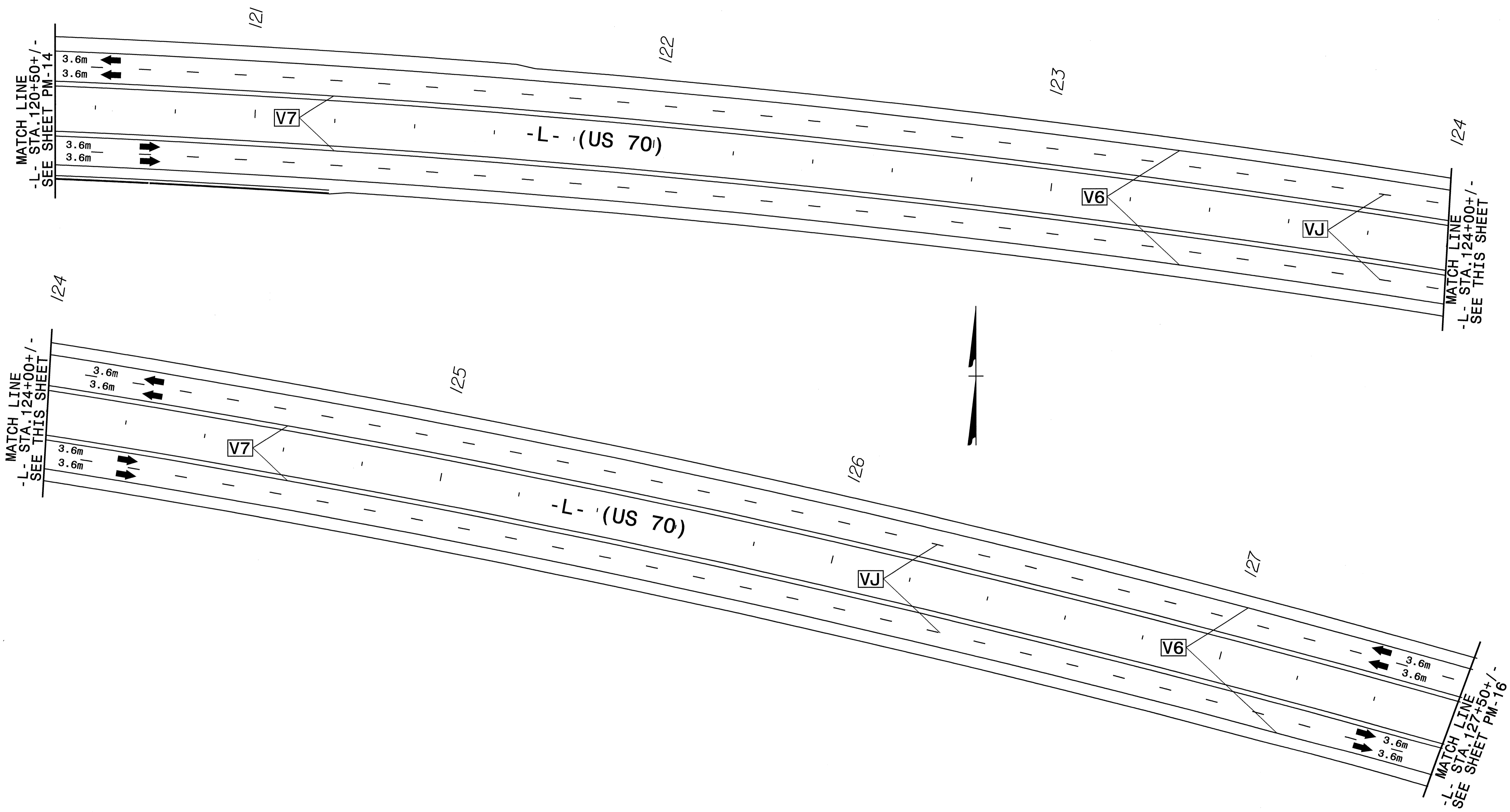

03-DEC-2007 13:19  
 \\dot\dfs\09101\p\store\proj\h\ip\projects-r\2554ba\traffic\trafficcontrol\top\100\FinalPMP\R-2554BA\_TC\_PMP\_15.dgn  
 gjyucmi AT WZTC237440

**NOTES:**  
 1. REFER TO SHEET PM-1 FOR FINAL PAVEMENT MARKING SCHEDULE.  
 2. REFER TO SIGNING PLANS FOR OVERHEAD SIGNS LOCATION, LANE DROP AND ALL TRAFFIC EXIT SIGNING.

APPROVED: \_\_\_\_\_ DATE: \_\_\_\_\_  
  
 Jennifer L. Portantoni  
 10/3/07

<b>FINAL PAVEMENT MARKING PLAN</b>							
SCALE: NONE							
DATE: OCT-07							
DWG. BY: AYL							
DESIGN BY: AYL							
REVIEWED BY: JLP	<table border="1"> <tr> <th colspan="2">REVISIONS</th> </tr> <tr> <td> </td> <td> </td> </tr> <tr> <td> </td> <td> </td> </tr> </table>	REVISIONS					
REVISIONS							

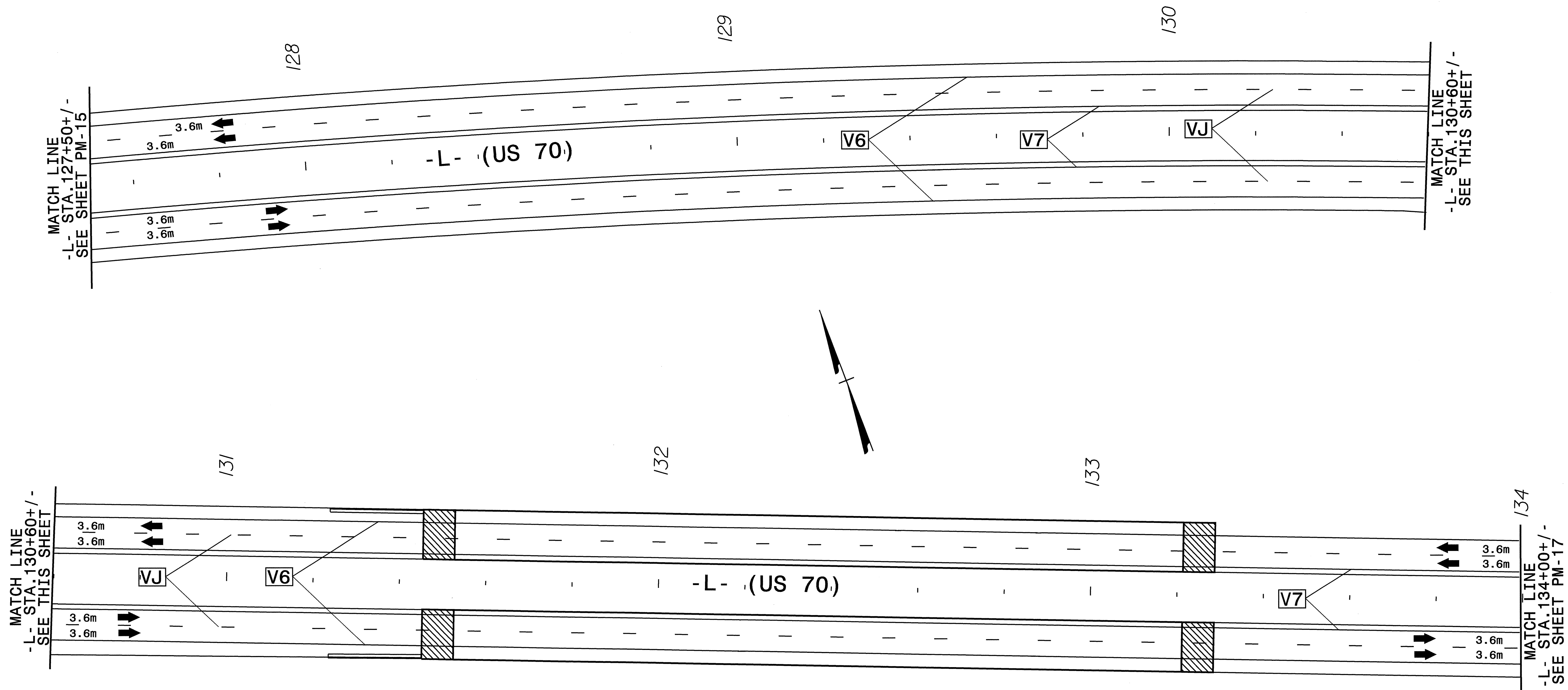

NOTES:  
 1. REFER TO SHEET PM-1 FOR FINAL PAVEMENT MARKING SCHEDULE.  
 2. REFER TO SIGNING PLANS FOR LANE DROP AND ALL TRAFFIC EXIT SIGNING.

APPROVED: _____ DATE: _____	<b>FINAL PAVEMENT MARKING PLAN</b>	
SCALE: NONE		REVISIONS
DATE: OCT-07		
DWG. BY: AYL		
DESIGN BY: AYL		
REVIEWED BY: JLP		CADD FILE

03-DEC-2007 13:19  
 \\dot\dfs\oct10\projstore\projstore\proj\traffic\traffic\traffic\traffic\top\002\Final\PM\PM-R-2554BA\_TC\_PMP\_16.dgn  
 dlyudmi AT WZTC237440





PROJ. REFERENCE NO.	SHEET NO.
R-2554BA	PM-17

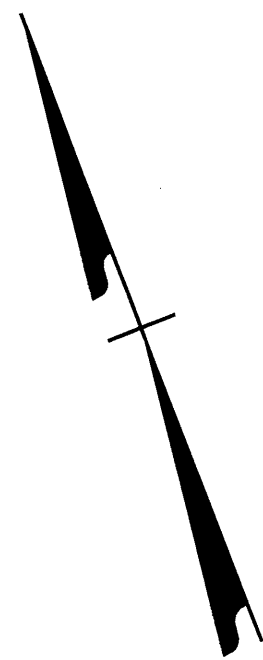
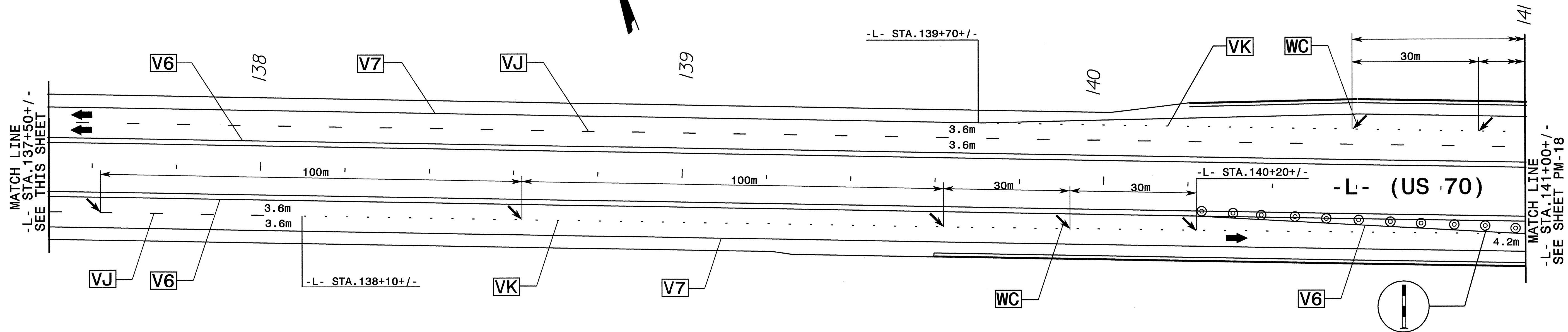
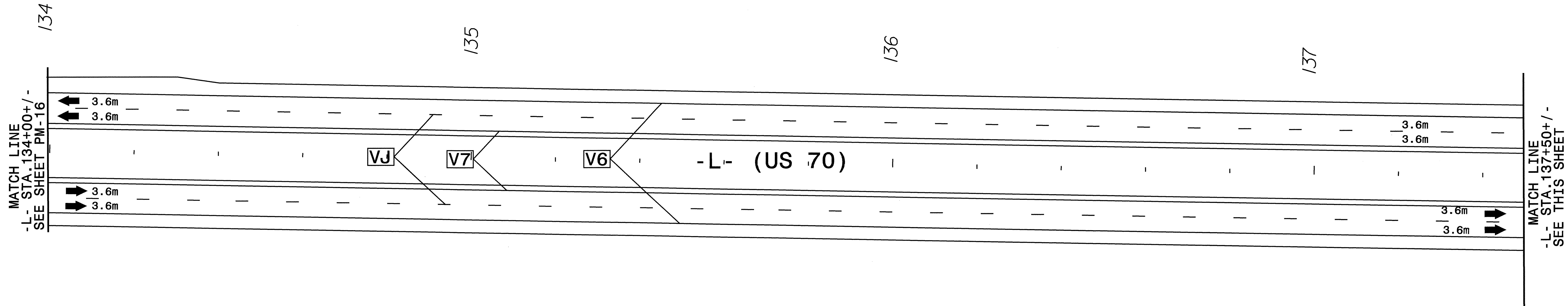

NOTES:  
 1. REFER TO SHEET PM-1 FOR FINAL PAVEMENT MARKING SCHEDULE.  
 2. REFER TO SIGNING PLANS FOR LANE DROP AND ALL TRAFFIC EXIT SIGNING.

APPROVED: \_\_\_\_\_ DATE: \_\_\_\_\_  
  
 Jennifer L. Poiranony  
 ENGINEER  
 12/3/07

<b>FINAL PAVEMENT MARKING PLAN</b>	
SCALE: NONE	REVISIONS
DATE: OCT-07	
DWG. BY: AYL	
DESIGN BY: AYL	
REVIEWED BY: JLP	

03-DEC-2007 13:18  
 \\dot\dfs\o\top\projects\proj\ip\projects\proj\ip\traffic\traffic\control\top\100% Final\PM-17-2554BA-TC-PM-17.dgn  
 ayudmi AT WZ1C237440



PROJ. REFERENCE NO. R-2554BA	SHEET NO. PM-18
---------------------------------	--------------------

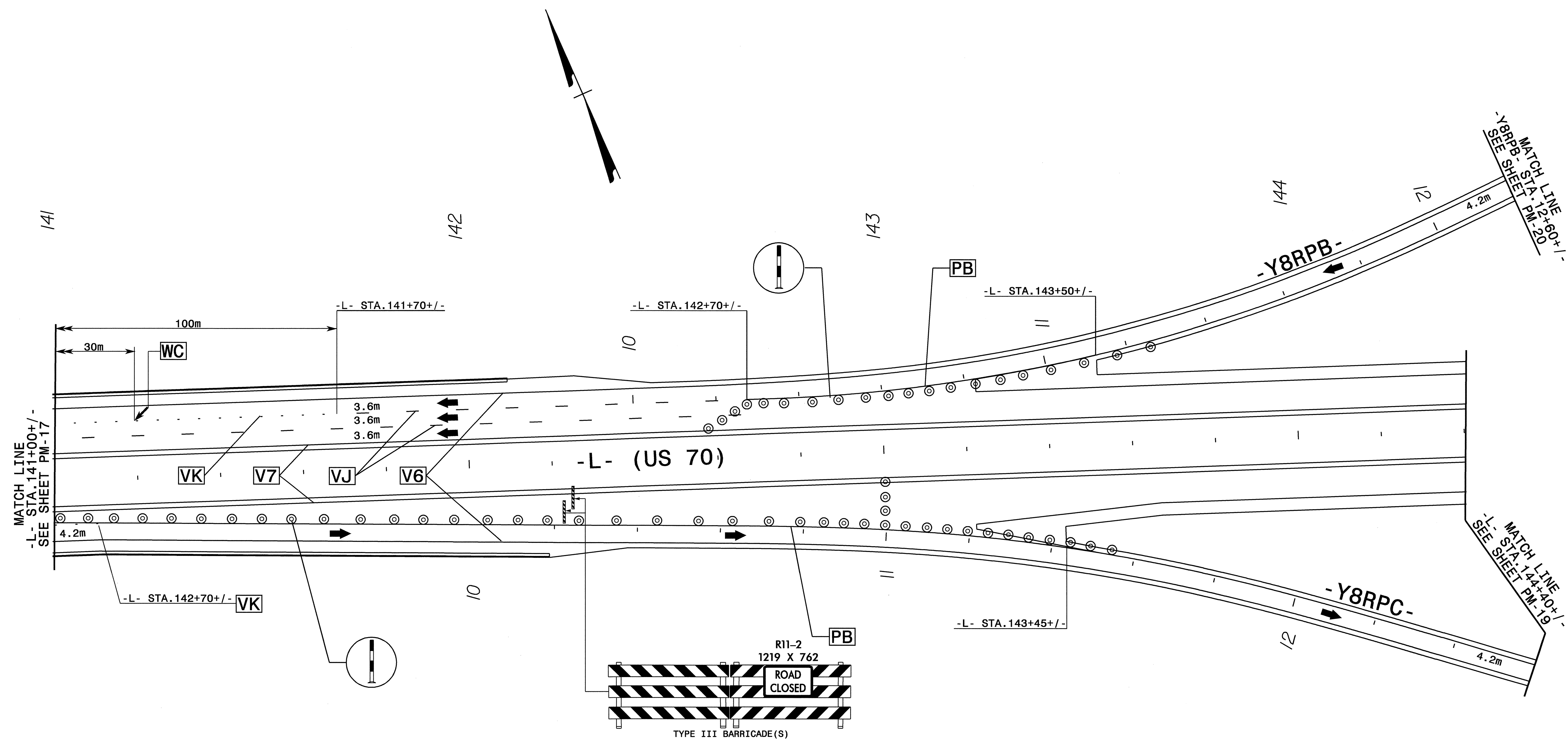

**NOTES:**  
 1. REFER TO SHEET PM-1 FOR FINAL PAVEMENT MARKING SCHEDULE.  
 2. USE RED AND WHITE STRIPES FOR PERMANENT BARRICADES. ATTACH PERMANENT BARRICADES SECURELY TO PAVEMENT SURFACE.  
 3. REFER TO SIGNING PLANS FOR LANE DROP AND ALL TRAFFIC EXIT SIGNING.

APPROVED: _____ DATE: _____	<b>FINAL PAVEMENT MARKING PLAN</b>									
SCALE: NONE	DATE: OCT-07	<table border="1"> <thead> <tr> <th colspan="2">REVISIONS</th> </tr> <tr> <th>NO.</th> <th>DESCRIPTION</th> </tr> </thead> <tbody> <tr> <td> </td> <td> </td> </tr> <tr> <td> </td> <td> </td> </tr> </tbody> </table>	REVISIONS		NO.	DESCRIPTION				
REVISIONS										
NO.	DESCRIPTION									
DWG. BY: AYL	DESIGN BY: AYL									
REVIEWED BY: JLP	DATE: 12/3/07									

03-DEC-2007 13:18  
 \\dot\dfsroot\projstore\projstore\proj\projects-r\2554ba\traffic\trafficcontrol\top\100% Final PMP R-2554BA\_TC.PMP\_18.dgn  
 ayudimi AT WZ1C237440



PROJ. REFERENCE NO.	SHEET NO.
R-2554BA	PM-19

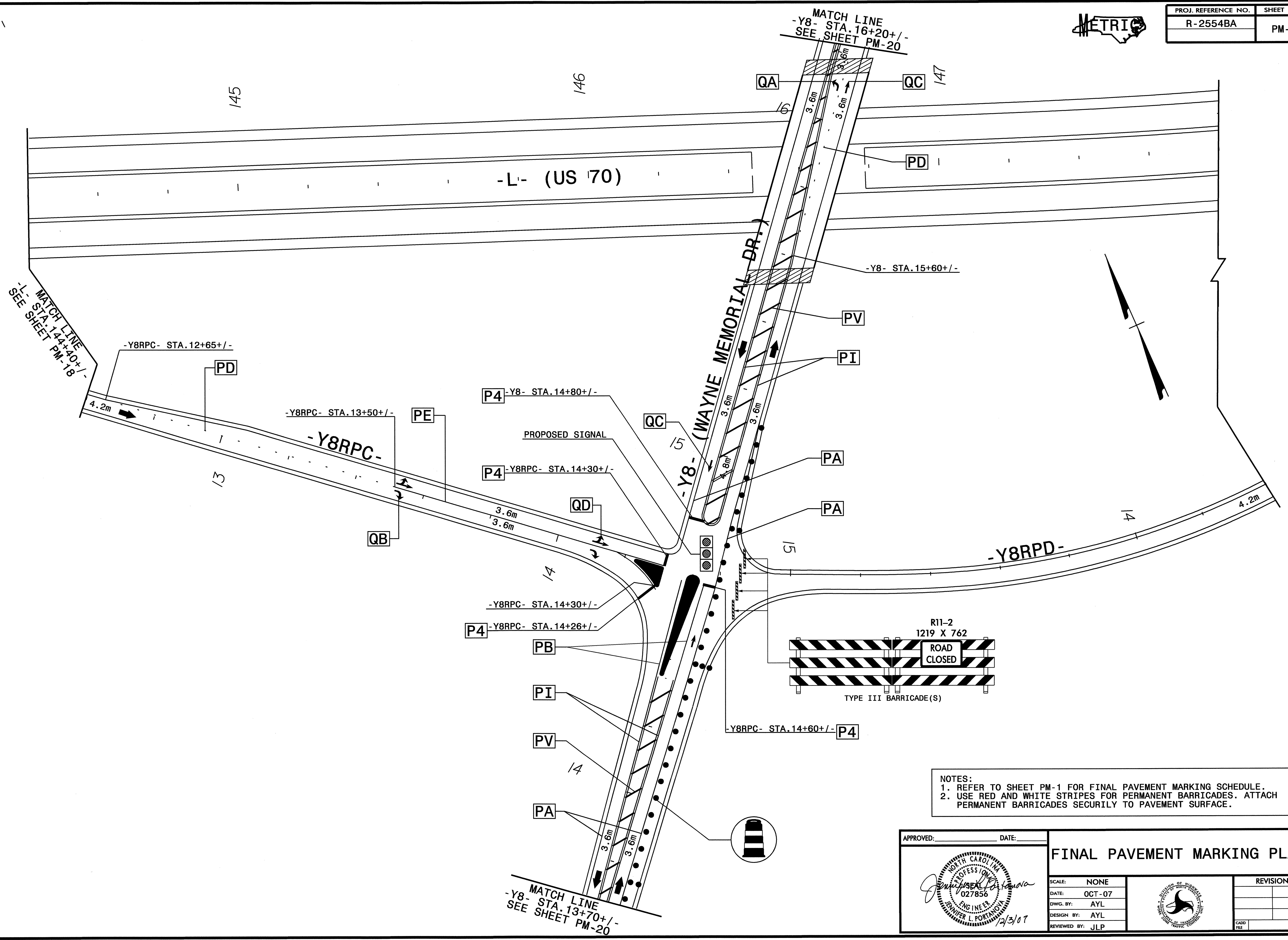

NOTES:  
 1. REFER TO SHEET PM-1 FOR FINAL PAVEMENT MARKING SCHEDULE.  
 2. USE RED AND WHITE STRIPES FOR PERMANENT BARRICADES. ATTACH PERMANENT BARRICADES SECURELY TO PAVEMENT SURFACE.

APPROVED: \_\_\_\_\_ DATE: \_\_\_\_\_  
  
 Jennifer L. Portanova  
 ENGINEER  
 12/3/07

**FINAL PAVEMENT MARKING PLAN**

SCALE: NONE		REVISIONS
DATE: OCT-07		
DWG. BY: AYL		
DESIGN BY: AYL		
REVIEWED BY: JLP		

03-DEC-2007 13:17  
 \\p01\proj\store\proj\pmp\projects-r\2554ba\traffic\trafficcontrol\top\100%\Final\pmp\R-2554BA\_TC\_PMP\_19.dgn  
 01/23/07 11:48  
 JLP

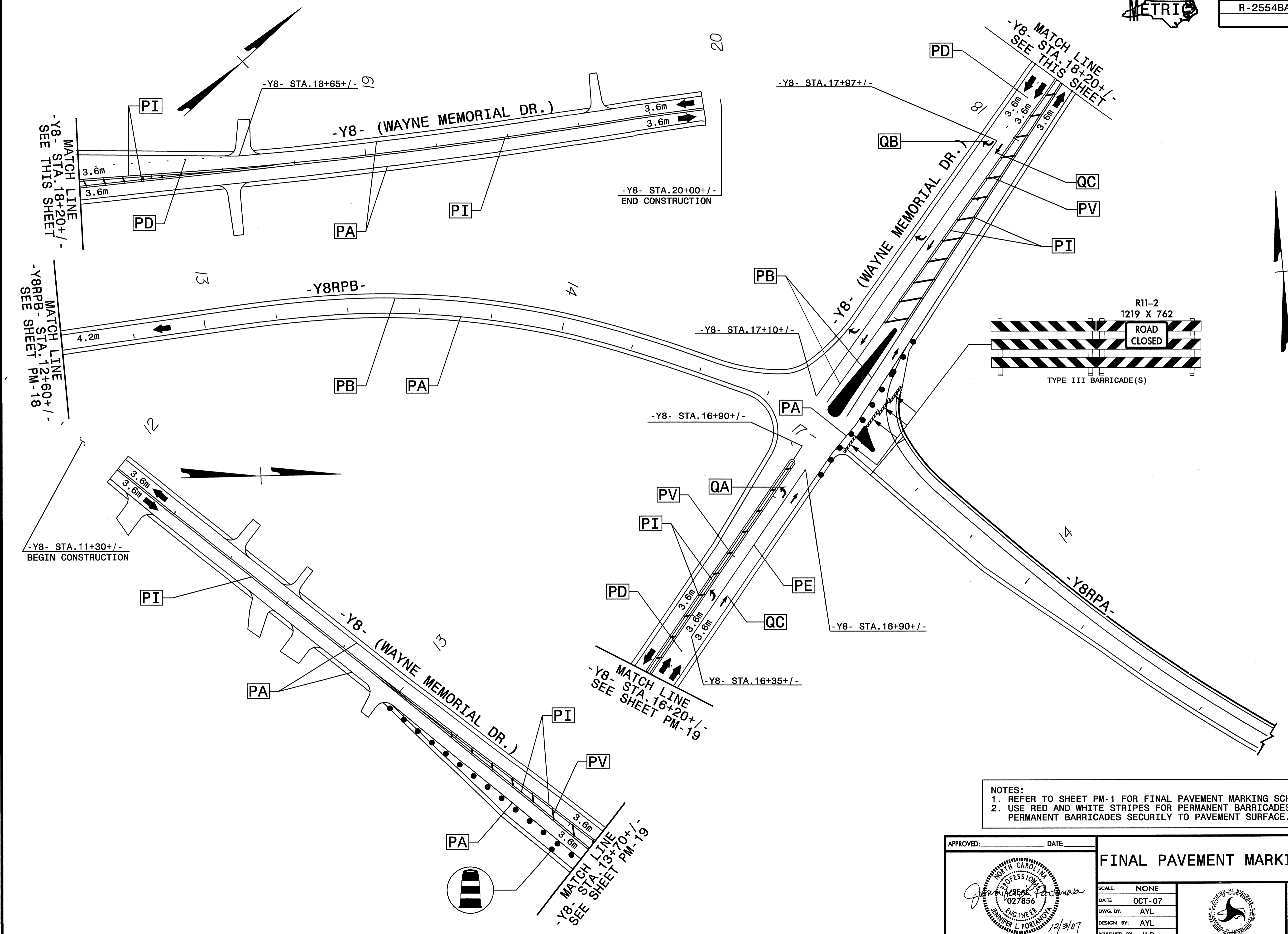
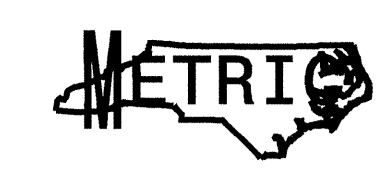

NOTES:  
 1. REFER TO SHEET PM-1 FOR FINAL PAVEMENT MARKING SCHEDULE.  
 2. USE RED AND WHITE STRIPES FOR PERMANENT BARRICADES. ATTACH PERMANENT BARRICADES SECURELY TO PAVEMENT SURFACE.

APPROVED: \_\_\_\_\_ DATE: \_\_\_\_\_

10/2/07

**FINAL PAVEMENT MARKING PLAN**

SCALE: NONE  
 DATE: OCT-07  
 DWG. BY: AYL  
 DESIGN BY: AYL  
 REVIEWED BY: JLP

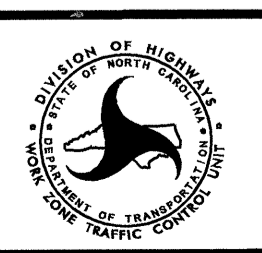

REVISIONS	

03-DEC-2007 13:16  
 c:\p\proj\store\proj\2554ba\traffic\trafficcontrol\top\002\FinalPMP\R-2554BA\_TC\_PMP\_20.dgn  
 alysmi AT 02/03/07