

STATE OF NORTH CAROLINA
DIVISION OF HIGHWAYS

STATE PROJECT REFERENCE NO.	SHEET NO.
B-4116	TCP-1

**PLAN FOR PROPOSED
TRAFFIC CONTROL, MARKING & DELINEATION
GASTON COUNTY**

B-4116

ROADWAY STANDARD DRAWINGS

THE FOLLOWING ROADWAY STANDARDS AS APPEAR IN "ROADWAY STANDARD DRAWINGS" - PROJECT SERVICES UNIT-N.C. DEPARTMENT OF TRANSPORTATION-RALEIGH, N.C., DATED JULY 2006 ARE APPLICABLE TO THIS PROJECT AND BY REFERENCE HEREBY ARE CONSIDERED A PART OF THESE PLANS:

STD. NO.	TITLE
1101.02	TEMPORARY LANE CLOSURES
1101.03	TEMPORARY ROAD CLOSURES
1101.05	WORK ZONE VEHICLE ACCESSES
1101.11	TRAFFIC CONTROL DESIGN TABLES
1110.01	STATIONARY WORK ZONE SIGNS
1110.02	PORTABLE WORK ZONE SIGNS
1135.01	CONES
1145.01	BARRICADES
1205.01	PAVEMENT MARKINGS - LINE TYPES & OFFSETS
1205.02	PAVEMENT MARKINGS - 2 LANE & MULTILANE ROADWAYS
1205.12	PAVEMENT MARKINGS - BRIDGES
1250.01	PAVEMENT MARKER SPACING
1261.01	GUARDRAIL & BARRIER DELINEATOR SPACING
1261.02	GUARDRAIL & BARRIER DELINEATOR TYPES
1262.01	GUARDRAIL END DELINEATION

INDEX OF SHEETS

SHEET NO.	TITLE
TCP-1	LIST OF APPLICABLE ROADWAY STANDARD DRAWINGS, LEGEND, AND INDEX OF SHEETS
TCP-2	GENERAL NOTES, PHASING, AND FINAL PAVEMENT MARKING SCHEDULE
TCP-3	DETOUR MAP AND SIGNING
SD-1	SIGN DESIGN

LEGEND

GENERAL

- DIRECTION OF TRAFFIC FLOW
- NORTH ARROW
- PROPOSED PVMT. EXIST. PVMT.
- WORK AREA
- REMOVAL OF EXISTING PAVEMENT

TRAFFIC CONTROL DEVICES

- TYPE I BARRICADE
- TYPE II BARRICADE
- TYPE III BARRICADE
- CONE
- DRUM SKINNY DRUM
- FLASHING ARROW PANEL (TYPE C)
- STATIONARY SIGN
- PORTABLE SIGN
- STATIONARY OR PORTABLE SIGN
- WARNING FLAGS
- CRASH CUSHION
- CHANGEABLE MESSAGE SIGN
- TRUCK MOUNTED IMPACT ATTENUATOR (TMIA)
- POLICE
- FLAGGER

PAVEMENT MARKINGS

- CRYSTAL/CRYSTAL PAVEMENT MARKER
- YELLOW/YELLOW PAVEMENT MARKER
- CRYSTAL/RED PAVEMENT MARKER
- PAVEMENT MARKING SYMBOLS

TIP PROJECT:

03-APR-2008 09:26
\\dot\dfsroot\proj\1122\projects-b\4116\traffic\trafficcontrol\top\b-4116-tc-top.lgdg
hadwands - AT WZ1C24250

APPROVED: _____ DATE: _____	PLAN PREPARED BY: N.C.D.O.T. WORK ZONE TRAFFIC CONTROL UNIT
	J.S. BOURNE, PE _____ TRAFFIC CONTROL ENGINEER
	JOSEPH ISHAK, PE _____ TRAFFIC CONTROL PROJECT ENGINEER
	HABIB A. LAWANDOS _____ TRAFFIC CONTROL PROJECT DESIGN ENGINEER
	_____ TRAFFIC CONTROL DESIGN ENGINEER

GENERAL NOTES

PHASING

ADAPT THE TRAFFIC CONTROL PLANS, WHEN DIRECTED BY THE ENGINEER, TO MEET FIELD CONDITIONS TO PROVIDE SAFE AND EFFICIENT TRAFFIC MOVEMENT. CHANGES MAY BE REQUIRED WHEN PHYSICAL DIMENSIONS IN THE DETAIL DRAWINGS, STANDARD DETAILS AND ROADWAY DETAILS ARE NOT ATTAINABLE, OR RESULT IN DUPLICATE, OR UNDESIRE OVERLAPPING OF DEVICES. MODIFICATION MAY INCLUDE: MOVING, SUPPLEMENTING, COVERING OR REMOVAL OF DEVICES.

THE FOLLOWING GENERAL NOTES APPLY AT ALL TIMES FOR THE DURATION OF THE CONSTRUCTION PROJECT, EXCEPT WHEN OTHERWISE NOTED IN THE PLAN, OR DIRECTED BY THE ENGINEER.

LANE AND SHOULDER CLOSURE REQUIREMENTS

- A) REMOVE LANE CLOSURE DEVICES FROM THE LANE WHEN WORK IS NOT BEING PERFORMED BEHIND THE LANE CLOSURE OR WHEN A LANE CLOSURE IS NO LONGER NEEDED, OR AS DIRECTED BY THE ENGINEER.
- B) WHEN PERSONNEL AND/OR EQUIPMENT ARE WORKING WITHIN 15 FT OF AN OPEN TRAVEL LANE, CLOSE THE NEAREST OPEN SHOULDER USING ROADWAY STANDARD DRAWING NO. 1101.04 UNLESS THE WORK AREA IS PROTECTED BY BARRIER OR GUARDRAIL OR A LANE CLOSURE IS INSTALLED.
- C) WHEN PERSONNEL AND/OR EQUIPMENT ARE WORKING ON THE SHOULDER ADJACENT TO AN UNDIVIDED FACILITY AND WITHIN 5 FT OF AN OPEN TRAVEL LANE, CLOSE THE NEAREST OPEN TRAVEL LANE USING ROADWAY STANDARD DRAWING NO. 1101.02 UNLESS THE WORK AREA IS PROTECTED BY BARRIER OR GUARDRAIL.
- D) WHEN PERSONNEL AND/OR EQUIPMENT ARE WORKING WITHIN A LANE OF TRAVEL OF AN UNDIVIDED OR DIVIDED FACILITY, CLOSE THE LANE ACCORDING TO THE TRAFFIC CONTROL PLANS, ROADWAY STANDARD DRAWINGS OR AS DIRECTED BY THE ENGINEER. CONDUCT THE WORK SO THAT ALL PERSONNEL AND/OR EQUIPMENT REMAIN WITHIN THE CLOSED TRAVEL LANE.

PAVEMENT EDGE DROP OFF REQUIREMENTS

- E) BACKFILL AT A 6:1 SLOPE UP TO THE EDGE AND ELEVATION OF EXISTING PAVEMENT IN AREAS ADJACENT TO AN OPENED TRAVEL LANE THAT HAS AN EDGE OF PAVEMENT DROP-OFF AS FOLLOWS:
 - BACKFILL DROP-OFFS THAT EXCEED 2 INCHES ON ROADWAYS WITH POSTED SPEED LIMITS OF 45 MPH OR GREATER.
 - BACKFILL DROP-OFFS THAT EXCEED 3 INCHES ON ROADWAYS WITH POSTED SPEED LIMITS LESS THAN 45 MPH.
 - BACKFILL WITH SUITABLE COMPACTED MATERIAL, AS APPROVED BY THE ENGINEER, AT NO EXPENSE TO THE DEPARTMENT.
- F) DO NOT EXCEED A DIFFERENCE OF 2 INCHES IN ELEVATION BETWEEN OPEN LANES OF TRAFFIC FOR NOMINAL LIFTS OF 1.5 INCHES. INSTALL ADVANCE WARNING "UNEVEN LANES" SIGNS (W8-11) 500 FT IN ADVANCE AND A MINIMUM OF EVERY HALF MILE THROUGHOUT THE UNEVEN AREA.

TRAFFIC PATTERN ALTERATIONS

- G) NOTIFY THE ENGINEER TWENTY ONE (21) CALENDAR DAYS PRIOR TO ANY TRAFFIC PATTERN ALTERATION.

SIGNING

- H) STATE FORCES WILL INSTALL PERMANENT SIGNING.
- I) PROVIDE DETOUR SIGNING WITHIN AND OFF THE PROJECT LIMITS.
- J) COVER OR REMOVE ALL DETOUR SIGNS WITHIN AND OFF THE PROJECT LIMITS WHEN A DETOUR IS NOT IN OPERATION.
- K) ENSURE ALL NECESSARY SIGNING IS IN PLACE PRIOR TO ALTERING ANY TRAFFIC PATTERN.

PAVEMENT MARKINGS AND MARKERS

- L) INSTALL PAVEMENT MARKINGS AND PAVEMENT MARKERS ON THE FINAL SURFACE AS FOLLOWS:

ROAD NAME	MARKING	MARKER
SR 1618 (LANDERS CHAPEL RD)	PAINT	N/A
- M) TIE PROPOSED PAVEMENT MARKING LINES TO EXISTING PAVEMENT MARKING LINES.
- N) REPLACE ANY PAVEMENT MARKINGS THAT HAVE BEEN DAMAGED BY THE END OF EACH DAY'S OPERATION.

NOTE: MAINTAIN VEHICULAR ACCESS TO DRIVEWAYS WITHIN THE PROJECT LIMITS THROUGHOUT THE DURATION OF THE PROJECT.

WORKING IN A CONTINUOUS MANNER, COMPLETE THE FOLLOWING:

- STEP 1: USING RSD 1101.03 SHEET 1 OF 9, AS DIRECTED BY THE ENGINEER, INSTALL DETOUR SIGNING AND BARRICADES TO CLOSE SR 1618 TO THRU TRAFFIC AND SHIFT TRAFFIC ONTO OFFSITE DETOUR. (SEE SHEETS TCP-3 AND SD-1)
- STEP 2: - AWAY FROM TRAFFIC, BEGIN CONSTRUCTION ON -L- FROM -L- STA. 10+00 +/- TO -L- STA. 20+50 +/-
 - USING RSD 1101.02 SHEET 1 OF 9 AS NECESSARY, CONSTRUCT -DRIVE1- AND OPEN IT TO TRAFFIC.
- STEP 3: AWAY FROM TRAFFIC, COMPLETE PROPOSED CONSTRUCTION ON -L- UP TO AND INCLUDING FINAL LAYER OF SURFACE COURSE AND PLACE FINAL PAVEMENT MARKINGS (PAINT) FROM -L- STA. 10+00 +/- TO -L- STA. 20+50 +/-, INCLUDING PROPOSED -DRIVE1- AND PROPOSED STRUCTURE.
- STEP 4: REMOVE DETOUR SIGNS AND ALL TRAFFIC CONTROL DEVICES AND OPEN SR 1618 (LANDERS CHAPEL RD.) TO PROPOSED TRAFFIC PATTERN.

FINAL PAVEMENT MARKING SCHEDULE

SYMBOL	DESCRIPTION	PAY ITEM QUANTITY	
		BREAKDOWN	TOTAL QUANTITY
	FINAL PAVEMENT MARKINGS		
	PAINT (4")		
PA	WHITE EDGE LINE (2X)	4400 LF	
PI	YELLOW DOUBLE CENTER (2X)	4400 LF	
	TOTAL		8800 LF

NOTE: FOR EACH PAINT PAVEMENT MARKING ITEM, 1X IMPLIES A SINGLE APPLICATION, 2X IMPLIES TWO APPLICATIONS, AND 3X IMPLIES THREE APPLICATIONS.

APPROVED:	DATE:	GENERAL NOTES, PHASING, AND FINAL PAVEMENT MARKING SCHEDULE	
	SCALE: NONE		REVISIONS
	DATE: April 08		
	DWG. BY: HAL		
	DESIGN BY: HAL		
REVIEWED BY: JI			

03-APR-2008 12:57
 \\goft\dfs\root\1\proj\1101\traffic\trafficcontrol\tcp\B-4116-TCP-2.dgn
 \\goft\dfs\root\1\proj\1101\traffic\trafficcontrol\tcp\B-4116-TCP-2.dgn
 \\goft\dfs\root\1\proj\1101\traffic\trafficcontrol\tcp\B-4116-TCP-2.dgn

VICINITY MAP

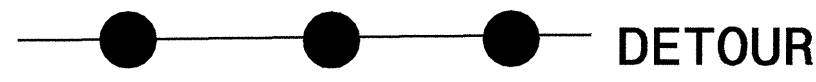

PROJ. REFERENCE NO.	SHEET NO.
B-4116	TCP-3

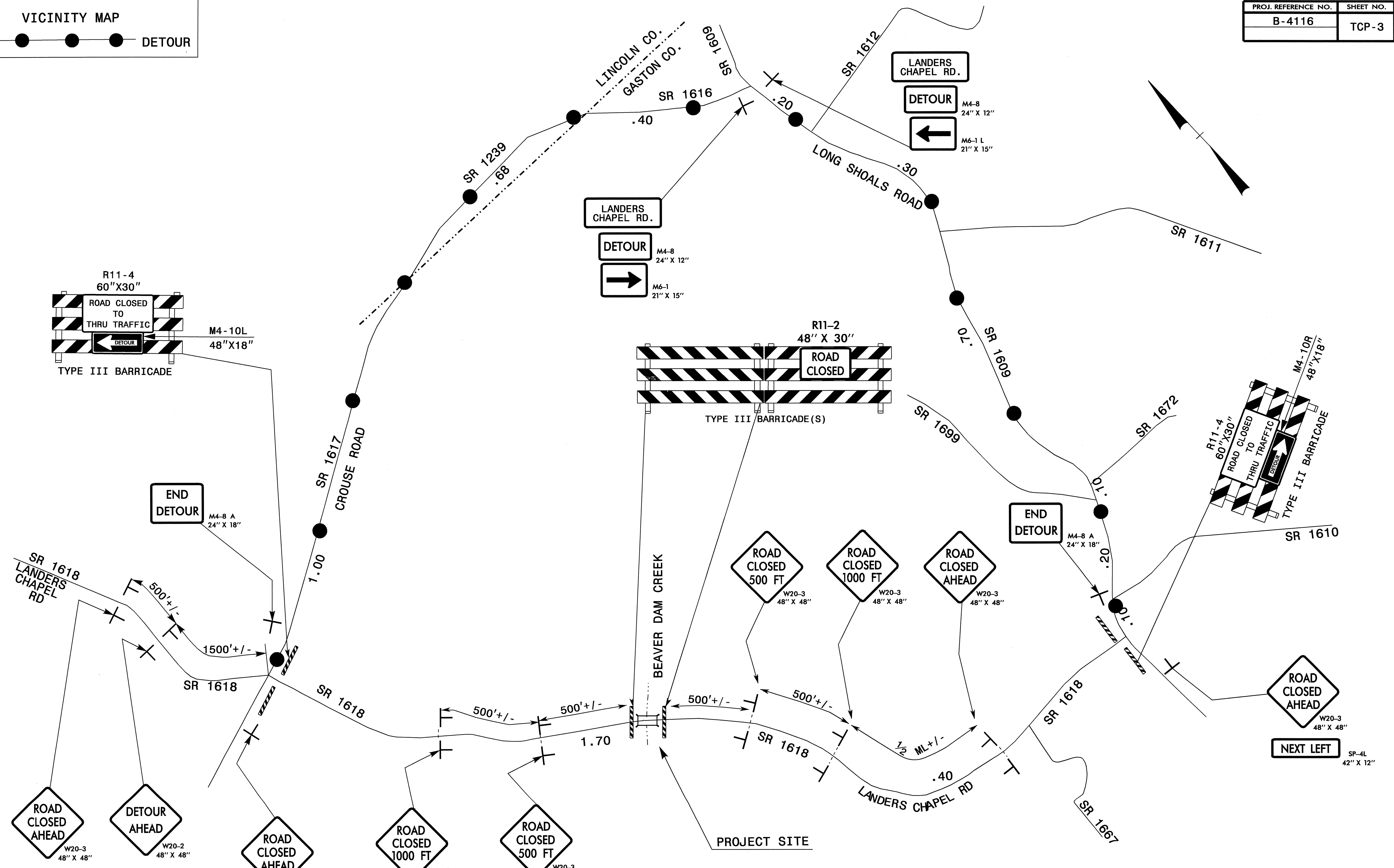

02-APR-2008 11:53
 h:\dot\dfsroot\p\p\projects-b\4116\trafficcontrol\top\B-4116_TC-TCP-3.dgn
 halawanda AT WZTC224250

APPROVED:	DATE:	DETOUR MAP AND SIGNING	
SCALE:	NONE		REVISIONS
DATE:	April 08		
DESIGN BY:	HAL		
REVIEWED BY:	JI		