

STATE OF NORTH CAROLINA
DIVISION OF HIGHWAYS

**UTILITY CONSTRUCTION PLANS
CATAWBA COUNTY**

**LOCATION: BRIDGE 79 OVER HILDEBRAN CREEK
ON SR 1156 IN NEWTON**

TYPE OF WORK: UTILITY CONSTRUCTION

STA. 21+00.00 -EL- END TIP PROJECT B-4059

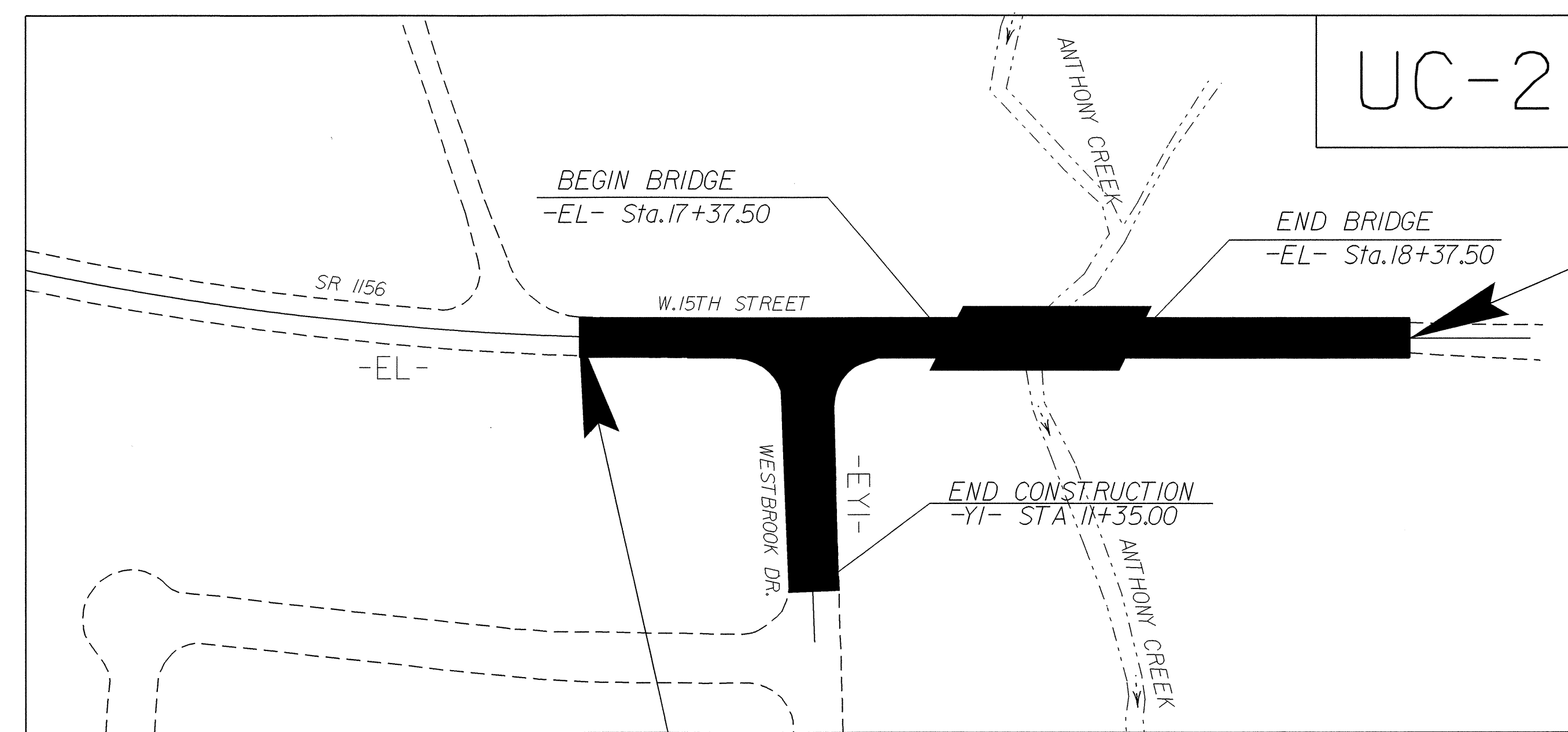
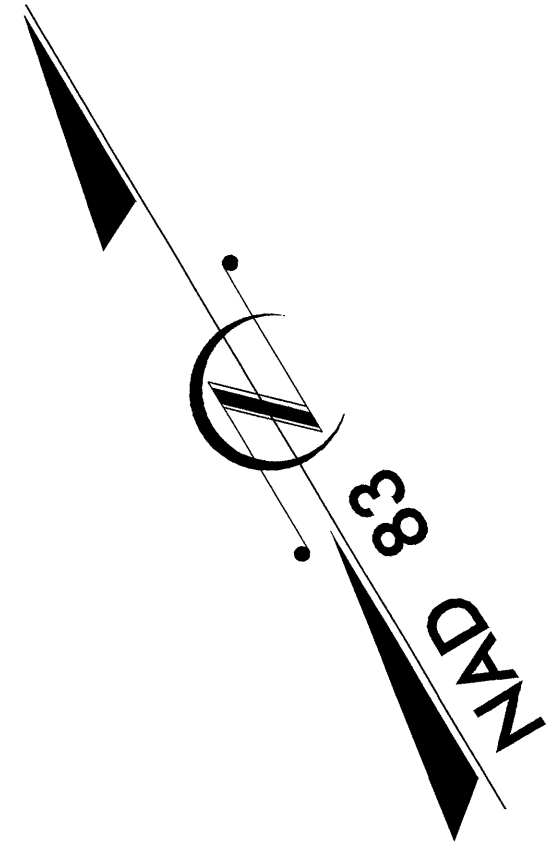
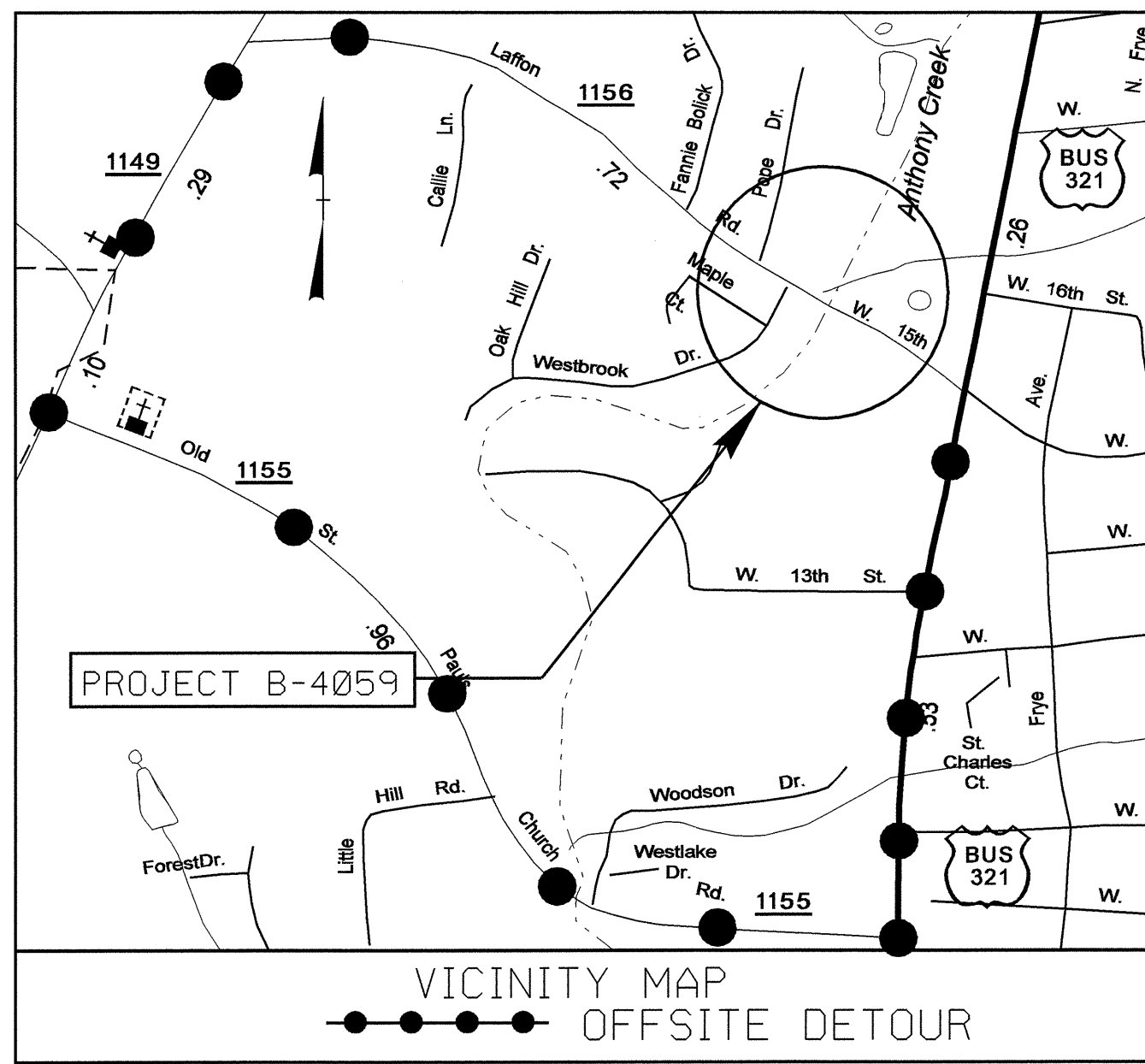

STA. 14+70.00 -EL- BEGIN TIP PROJECT B-4059

CONTRACT: C201836 **TIP PROJECT: B-4059**

01-FEB-2008 09:36
 F:\Utilities\rdy\ut\proj\b4059_ut_title_ucLpsh.dgn
 \$\$\$USERNAME\$\$\$

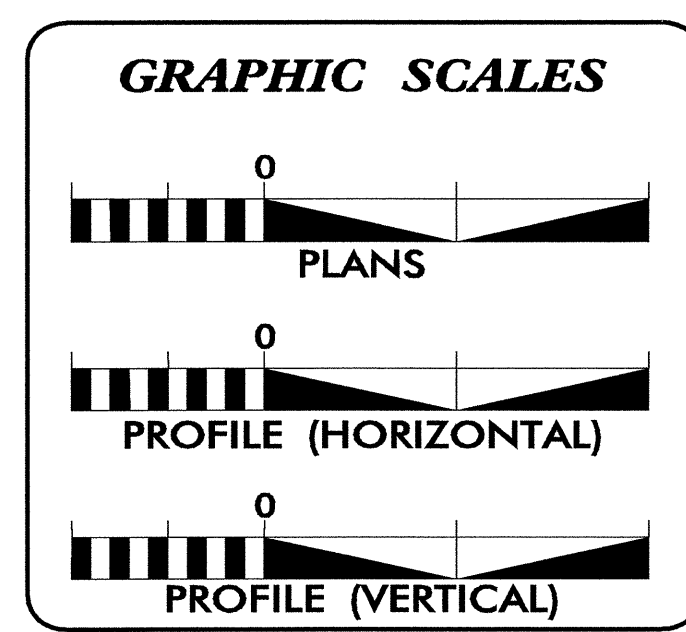

SHEET NO.	DESCRIPTION
UC-1	TITLE SHEET
UC-2	UTILITY CONSTRUCTION PLAN SHEET

WATER AND SEWER OWNERS ON PROJECT

(1) WATER - CITY OF NEWTON
(2) SANITARY SEWER - CITY OF NEWTON

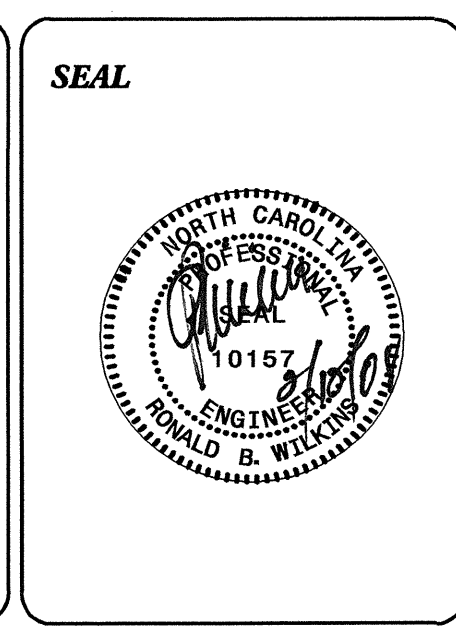

PREPARED IN THE OFFICE OF:
**DIVISION OF HIGHWAYS
PROJECT SERVICES
UTILITY SECTION**

1591 MAIL SERVICES CENTER
RALEIGH NC 27699-1591
PHONE (919) 250-4128
FAX (919) 250-4119

Roger Worthington, P.E. UTILITIES SECTION ENGINEER
R. B. WILKINS, P.E. UTILITIES SQUAD LEADER PROJECT ENGINEER
MICHAEL R. BRIGHT UTILITIES PROJECT DESIGNER

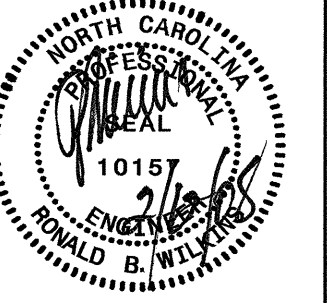

UTILITY CONSTRUCTION

5/14/99
 05-FEB-2008 14:47
 r:\utilities\cdm\proj\B4059\ut_4_uc2_psh.dgn

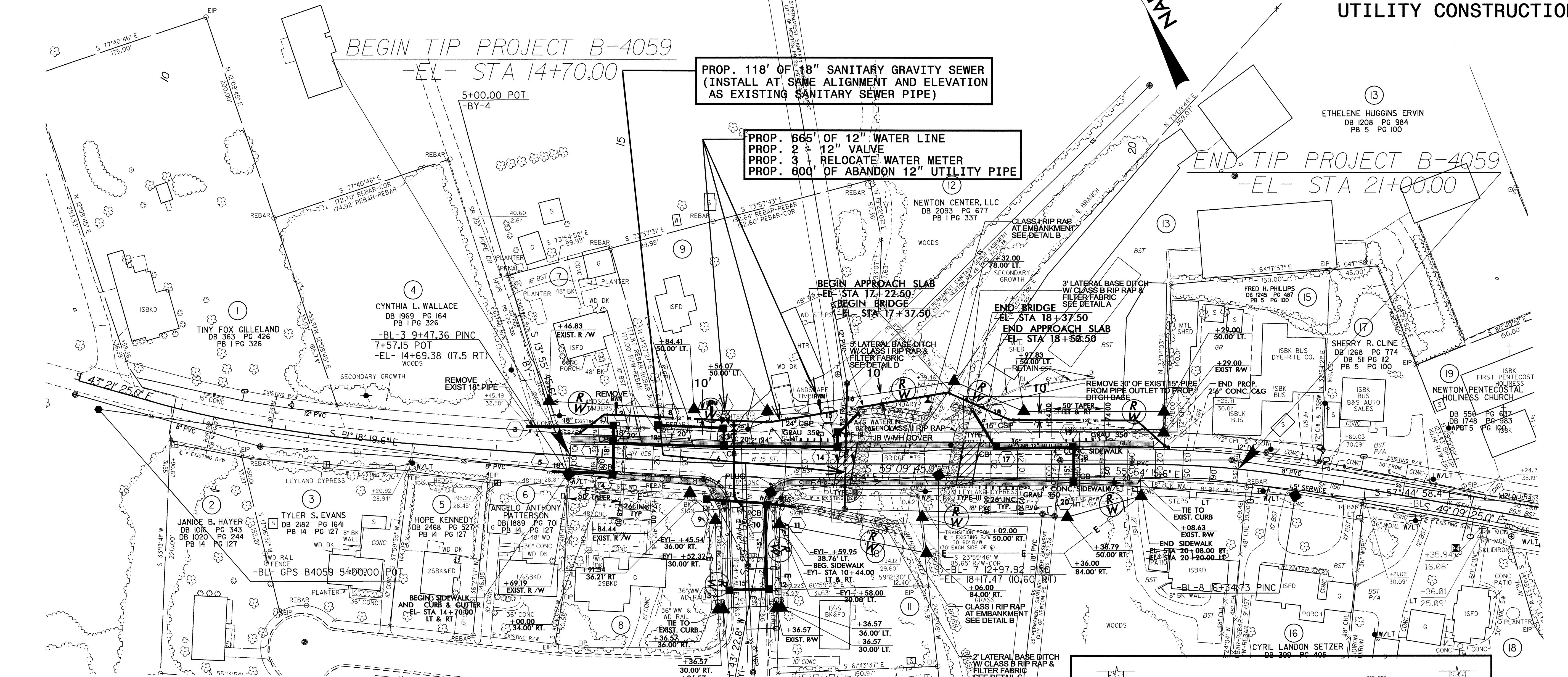

PROP. 118' OF 18" SANITARY GRAVITY SEWER (INSTALL AT SAME ALIGNMENT AND ELEVATION AS EXISTING SANITARY SEWER PIPE)

**PROP. 665' OF 12" WATER LINE
 PROP. 2 x 12" VALVE
 PROP. 3' RELOCATE WATER METER
 PROP. 600' OF ABANDON 12" UTILITY PIPE**

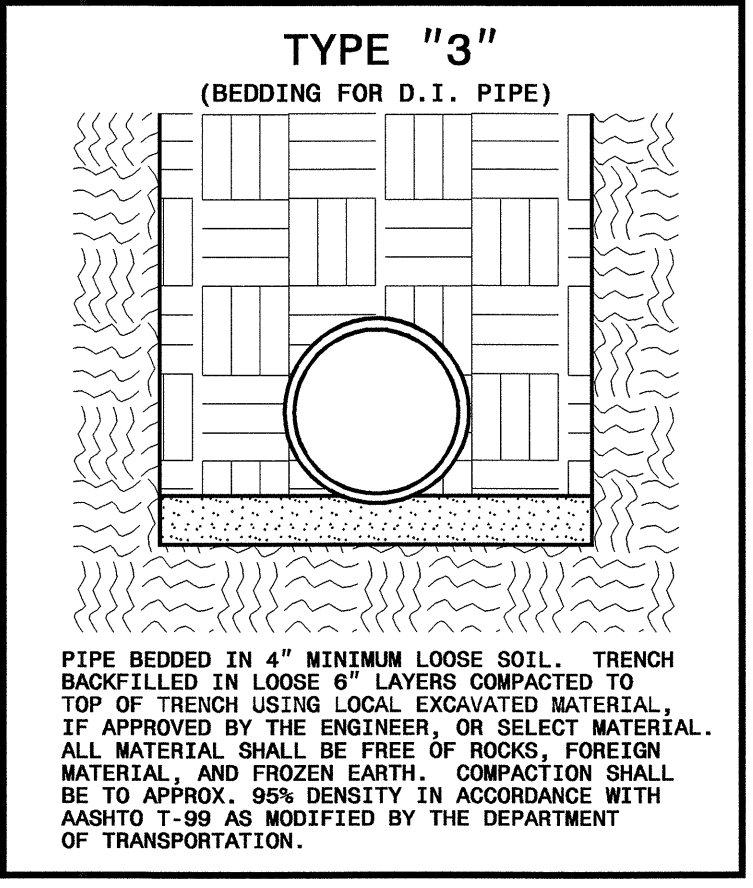
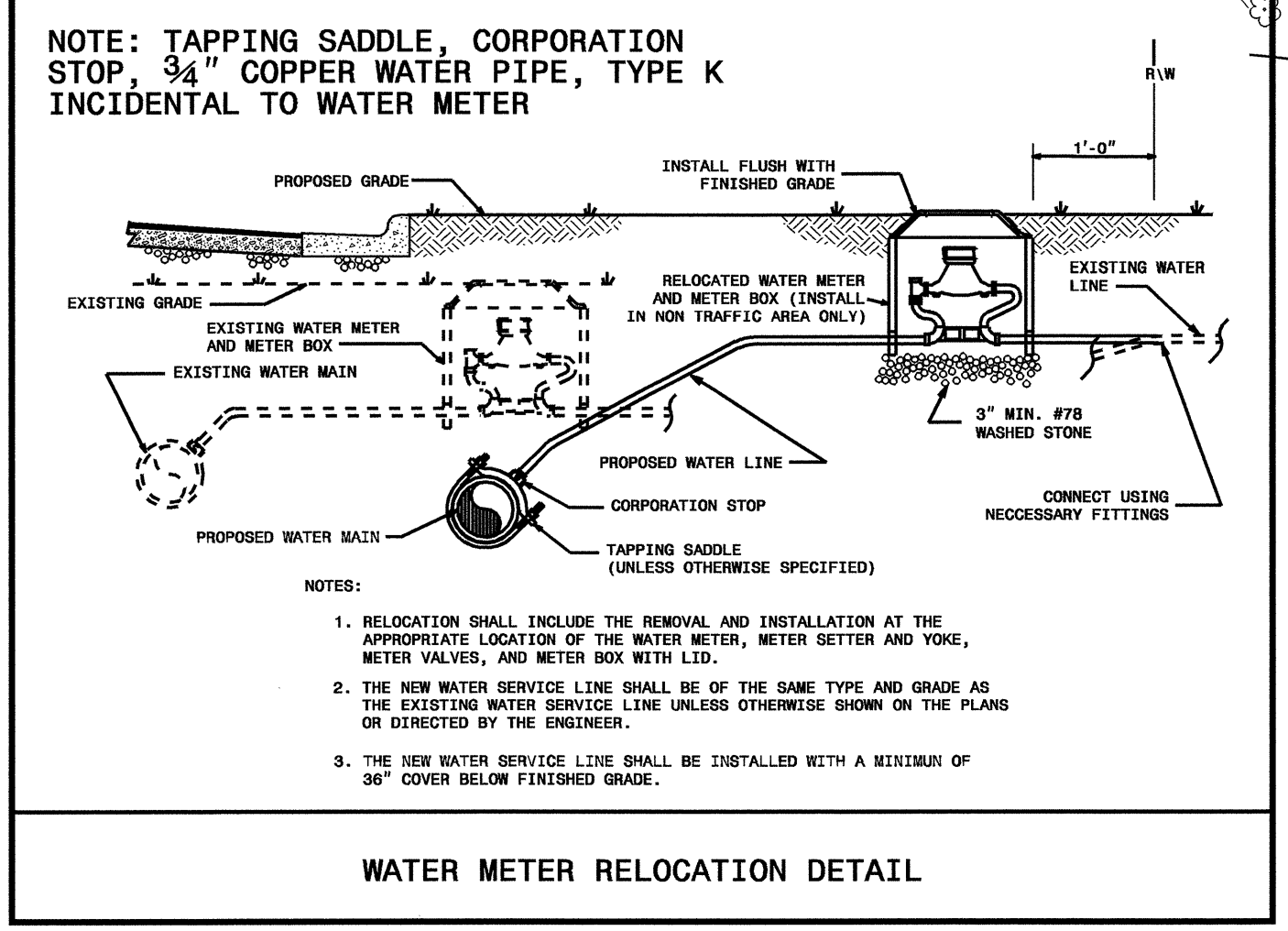

MAXIMUM TRENCH WIDTH AT TOP OF PIPE

NOMINAL PIPE SIZE (INCHES)	TRENCH WIDTH (INCHES)	NOMINAL PIPE SIZE (INCHES)	TRENCH WIDTH (INCHES)
4	28	20	44
6	30	24	48
8	32	30	54
10	34	36	60
12	36	42	66
14	38	48	72
16	40	54	78
18	42		

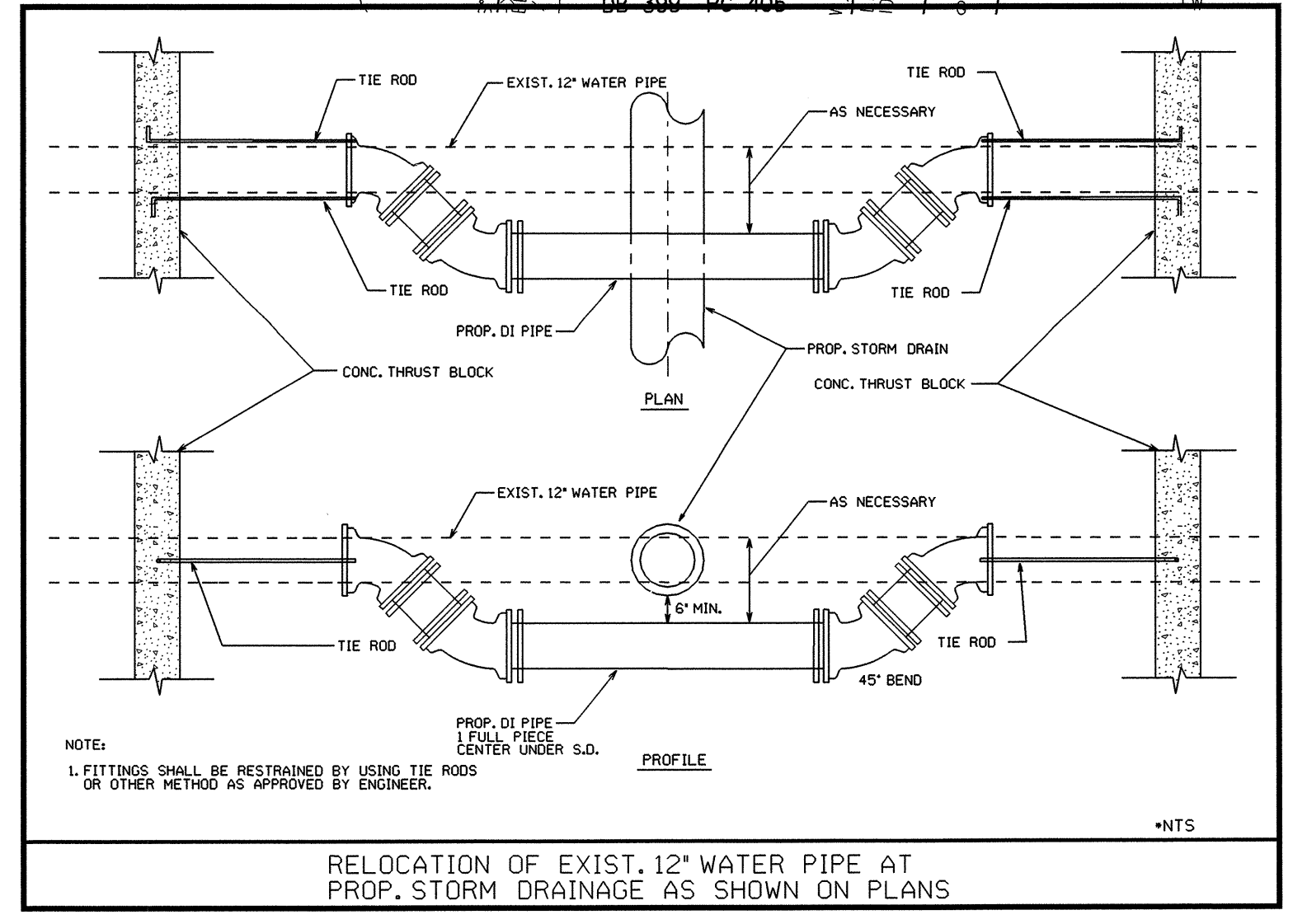

09/08/99

T.I.P. NO.	SHEET NO.
B-4059	UO-1

STATE OF NORTH CAROLINA
DIVISION OF HIGHWAYS

**UTILITY CONSTRUCTION PLANS
CATAWBA COUNTY**

**LOCATION: BRIDGE 79 OVER HILDEBRAN CREEK
ON SR 1156 IN NEWTON**

TYPE OF WORK: UTILITIES BY OTHERS

STA. 21+00.00 -EL- END TIP PROJECT B-4059

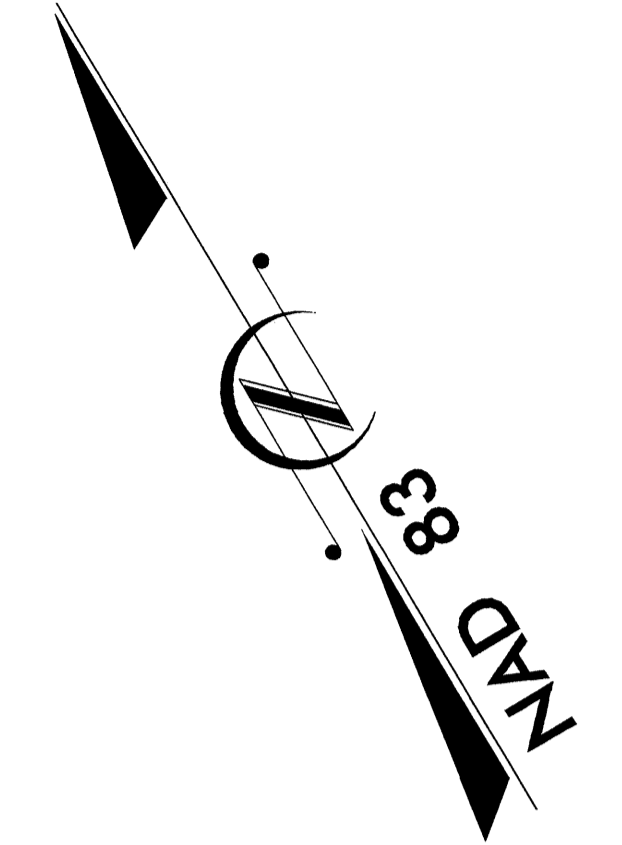
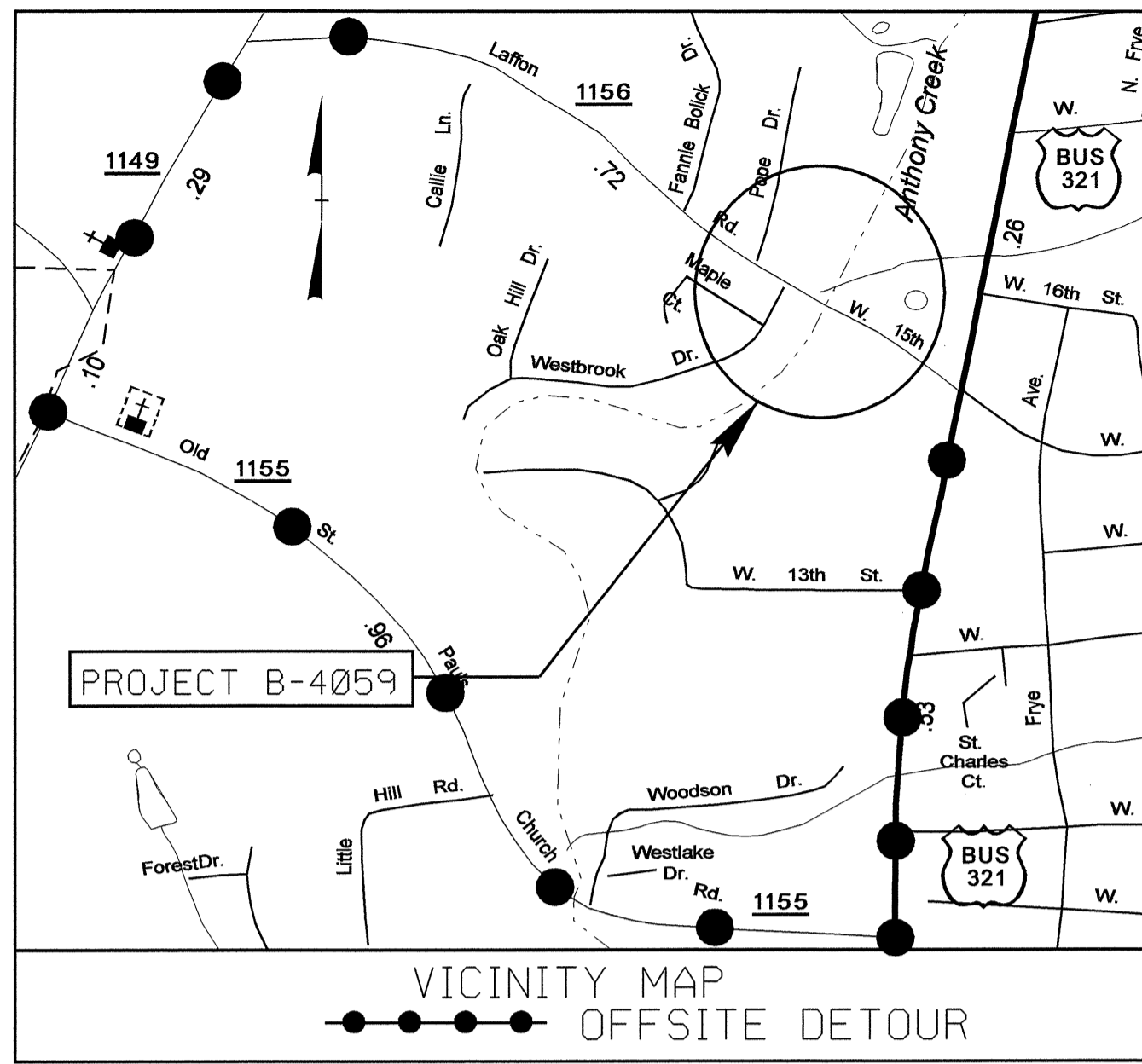

TIP PROJECT: B-4059

CONTRACT: C201836

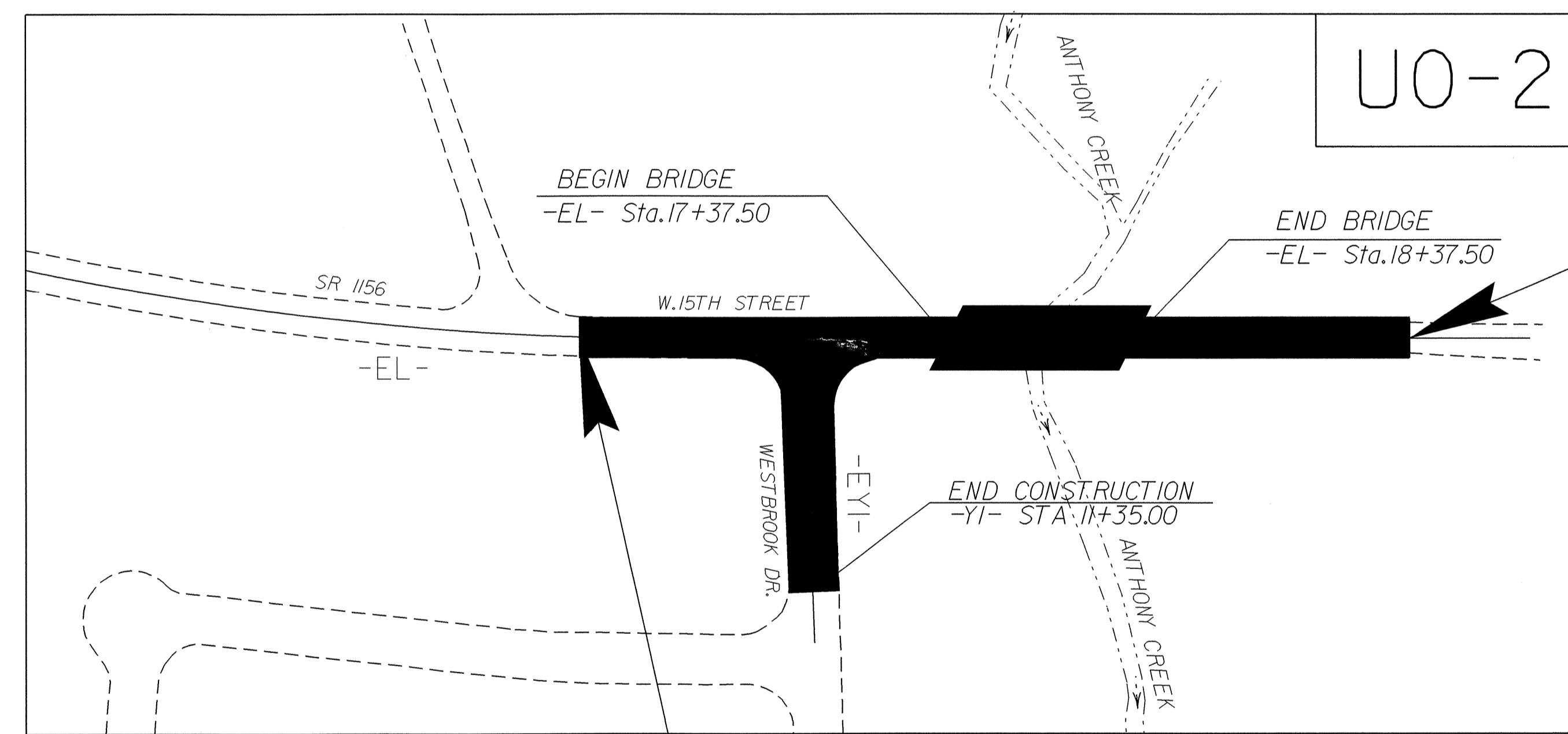

STA. 14+70.00 -EL- BEGIN TIP PROJECT B-4059

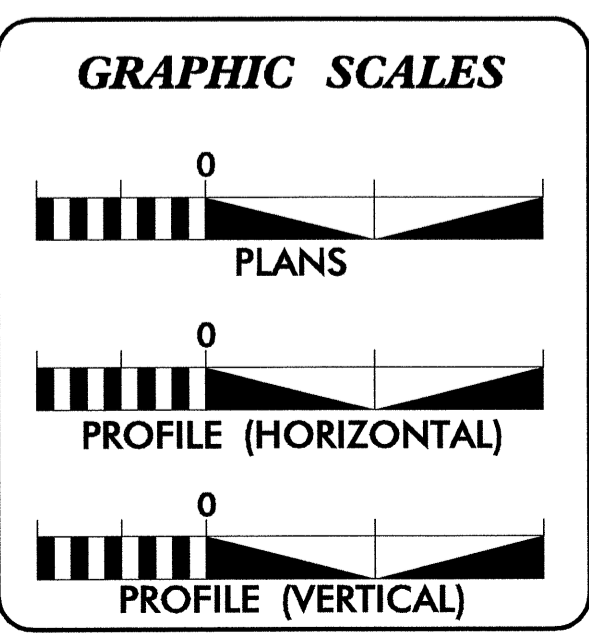

INDEX OF SHEETS

SHEET NO.	DESCRIPTION
UO-1	TITLE SHEET
UO-2	UTILITY BY OTHERS PLAN SHEETS

- UTILITY OWNERS ON PROJECT**
- (1) CITY OF NEWTON - POWER (DISTRIBUTION)
 - (2) DUKE ENERGY - POWER (DISTRIBUTION)
 - (3) AT&T SOUTHEAST - TELEPHONE
 - (4) CHARTER CABLE - CATV
 - (5) PIEDMONT NATURAL GAS

PREPARED IN THE OFFICE OF:
**DIVISION OF HIGHWAYS
DESIGN SERVICES
UTILITY SECTION**

1591 MAIL SERVICES CENTER
RALEIGH NC 27699-1591
PHONE (919) 250-4128
FAX (919) 250-4119

Roger Worthington, P.E. UTILITIES SECTION ENGINEER
R. B. WILKINS, P.E. UTILITIES SQUAD LEADER PROJECT ENGINEER
MICHAEL R. BRIGHT UTILITIES PROJECT DESIGNER

20-MAR-2008 11:18
F:\utilities\rdy\proj\b4059_ut_title_uoL.psh.dgn
\$\$\$\$\$USERNAME\$\$\$\$\$

