

STATE OF NORTH CAROLINA
DIVISION OF HIGHWAYS

STATE PROJECT REFERENCE NO.	SHEET NO.
B-3707	TCP-1

**PLAN FOR PROPOSED
TRAFFIC CONTROL, MARKING & DELINEATION
WARREN COUNTY**

B-3707

ROADWAY STANDARD DRAWINGS

THE FOLLOWING ROADWAY STANDARDS AS APPEAR IN "ROADWAY STANDARD DRAWINGS" - PROJECT SERVICES UNIT-N.C. DEPARTMENT OF TRANSPORTATION-RALEIGH, N.C., DATED JULY 2006 ARE APPLICABLE TO THIS PROJECT AND BY REFERENCE HEREBY ARE CONSIDERED A PART OF THESE PLANS:

STD. NO.	TITLE
1101.03	TEMPORARY ROAD CLOSURES
1101.11	TRAFFIC CONTROL DESIGN TABLES
1110.01	STATIONARY WORK ZONE SIGNS
1130.01	DRUM
1145.01	BARRICADES
1205.01	PAVEMENT MARKINGS - LINE TYPES & OFFSETS
1205.02	PAVEMENT MARKINGS - 2 LANE & MULTILANE ROADWAYS
1205.12	PAVEMENT MARKINGS - BRIDGES
1250.01	PAVEMENT MARKER SPACING
1251.01	RAISED PAVEMENT MARKERS (TEMPORARY & PERMANENT)

INDEX OF SHEETS

SHEET NO.	TITLE
TCP-1	LIST OF APPLICABLE ROADWAY STANDARD DRAWINGS, LEGEND, INDEX OF SHEETS AND FINAL PAVEMENT MARKING SCHEDULE
TCP-2	GENERAL NOTES AND PHASING
TCP-3	DETOUR ROUTE AND BARRICADE PLACEMENT
SD-1	SPECIAL SIGN DESIGN

LEGEND

- GENERAL**
- DIRECTION OF TRAFFIC FLOW
 - NORTH ARROW
 - PROPOSED PVMT. EXIST. PVMT.
 - WORK AREA
 - REMOVAL OF EXISTING PAVEMENT
- TRAFFIC CONTROL DEVICES**
- TYPE I BARRICADE
 - TYPE II BARRICADE
 - TYPE III BARRICADE
 - CONE
 - DRUM SKINNY DRUM
 - FLASHING ARROW PANEL (TYPE C)
 - STATIONARY SIGN
 - PORTABLE SIGN
 - STATIONARY OR PORTABLE SIGN
 - WARNING FLAGS
 - CRASH CUSHION
 - CHANGEABLE MESSAGE SIGN
 - TRUCK MOUNTED IMPACT ATTENUATOR (TMIA)
 - POLICE
 - FLAGGER
- PAVEMENT MARKINGS**
- CRYSTAL/CRYSTAL PAVEMENT MARKER
 - YELLOW/YELLOW PAVEMENT MARKER
 - CRYSTAL/RED PAVEMENT MARKER
 - PAVEMENT MARKING SYMBOLS

FINAL PAVEMENT MARKING SCHEDULE

SYMBOL	DESCRIPTION	PAY ITEM	QUANTITY BREAKDOWN	TOTAL QUANTITY
FINAL PAVEMENT MARKINGS				
TI	YELLOW DOUBLE CENTER	THERMOPLASTIC(4", 120 MILS)	1900 LF	TOTAL 1900 LF
TA	WHITE EDGELINE	THERMOPLASTIC(4", 90 MILS)	1900 LF	TOTAL 1900 LF
MARKERS				
MA	YELLOW & YELLOW	PERMANENT RAISED PAVEMENT MARKERS	16 EA	TOTAL 16 EA

APPROVED: _____ DATE: _____	PLAN PREPARED BY: N.C.D.O.T. WORK ZONE TRAFFIC CONTROL UNIT
	J. S. BOURNE, PE TRAFFIC CONTROL ENGINEER
	J. ISHAK, PE TRAFFIC CONTROL PROJECT ENGINEER
	J. L. PORTANOVA, PE TRAFFIC CONTROL PROJECT DESIGN ENGINEER
	E. K. GROUNDWATER TRAFFIC CONTROL DESIGN ENGINEER

07-FEB-2008 09:20 \\dot\dfsroot\01\Proj\TIP\Projects-B\B3707\TrafficControl\Top\B3707_TCP1.dgn
ekgroundwater AT WZTC22464

TIP PROJECT:

GENERAL NOTES

CHANGES MAY BE REQUIRED WHEN PHYSICAL DIMENSIONS IN THE DETAIL DRAWINGS, STANDARD DETAILS AND ROADWAY DETAILS ARE NOT ATTAINABLE TO MEET FIELD CONDITIONS, OR RESULT IN DUPLICATE, OR UNDESIRE OVERLAPPING OF DEVICES. MODIFICATION MAY INCLUDE: MOVING, SUPPLEMENTING, COVERING OR REMOVAL OF DEVICES, AS DIRECTED BY THE ENGINEER.

THE FOLLOWING GENERAL NOTES APPLY AT ALL TIMES FOR THE DURATION OF THE CONSTRUCTION PROJECT, EXCEPT WHEN OTHERWISE NOTED IN THE PLAN, OR DIRECTED BY THE ENGINEER.

TRAFFIC PATTERN ALTERATIONS

- A) NOTIFY THE ENGINEER TWENTY ONE (21) CALENDAR DAYS PRIOR TO ANY TRAFFIC PATTERN ALTERATION.

SIGNING

- B) PROVIDE PERMANENT SIGNING.
 C) PROVIDE DETOUR SIGNING WITHIN AND OFF THE PROJECT LIMITS.
 D) COVER OR REMOVE ALL DETOUR SIGNS WITHIN AND OFF THE PROJECT LIMITS WHEN A DETOUR IS NOT IN OPERATION.
 E) ENSURE ALL NECESSARY SIGNING IS IN PLACE PRIOR TO ALTERING ANY TRAFFIC PATTERN.

TRAFFIC CONTROL DEVICES

- F) PLACE TYPE III BARRICADES, WITH "ROAD CLOSED" SIGN R11-2 ATTACHED, OF SUFFICIENT LENGTH TO CLOSE ENTIRE ROADWAY.

PAVEMENT MARKINGS AND MARKERS

- G) INSTALL PAVEMENT MARKINGS AND PAVEMENT MARKERS ON THE FINAL SURFACE AS FOLLOWS:

ROAD NAME	MARKING	MARKER
DAVIS RD. (SR 1507)	THERMOPLASTIC	PERMANENT RAISED

- H) TIE PROPOSED PAVEMENT MARKING LINES TO EXISTING PAVEMENT MARKING LINES.

PHASING

STEP 1: USING RSD 1101.03, SHEET 1 OF 9, AND SHEET TCP-3, INSTALL DETOUR SIGNS, PLACE TYPE III BARRICADES TO CLOSE DAVIS RD. (SR 1507) TO THRU TRAFFIC AND SHIFT TRAFFIC ONTO PROPOSED DETOUR.

STEP 2: AWAY FROM TRAFFIC PERFORM THE FOLLOWING: (SEE ROADWAY PLANS)

- 1) REMOVE EXISTING STRUCTURE NO. 67 AND CONSTRUCT PROPOSED STRUCTURE.
 -CONSTRUCT PROPOSED -L- UP TO AND INCLUDING THE FINAL LAYER OF SURFACE COURSE FROM -L- STA. 15+00 +/- TO -L- STA. 23+55 +/-.
- 2) PLACE FINAL PAVEMENT MARKINGS (THERMOPLASTIC) AND MARKERS (PERMANENT RAISED) AND TIE TO EXISTING MARKINGS.

STEP 3: REMOVE ALL TRAFFIC CONTROL DEVICES AND DETOUR SIGNING. OPEN DAVIS RD. (SR 1507) TO TWO-LANE, TWO-WAY TRAFFIC PATTERN.

07-FEB-2008 09:17
 \\dot\dfsroot\01\Projects\TIP\Projects-B\B3707\TrafficControl\top\B3707_TCP2.dgn
 AT WZTC22464
 ekggroundwater

APPROVED: _____ DATE: _____	GENERAL NOTES AND PHASING									
	SCALE: NONE									
	DATE: 02/08									
	DWG. BY: EKG									
	DESIGN BY: EKG									
REVIEWED BY: JLP	<table border="1" style="width: 100%;"> <thead> <tr> <th colspan="2">REVISIONS</th> </tr> </thead> <tbody> <tr> <td> </td> <td> </td> </tr> <tr> <td> </td> <td> </td> </tr> <tr> <td> </td> <td> </td> </tr> </tbody> </table>		REVISIONS							
REVISIONS										
CADD FILE										

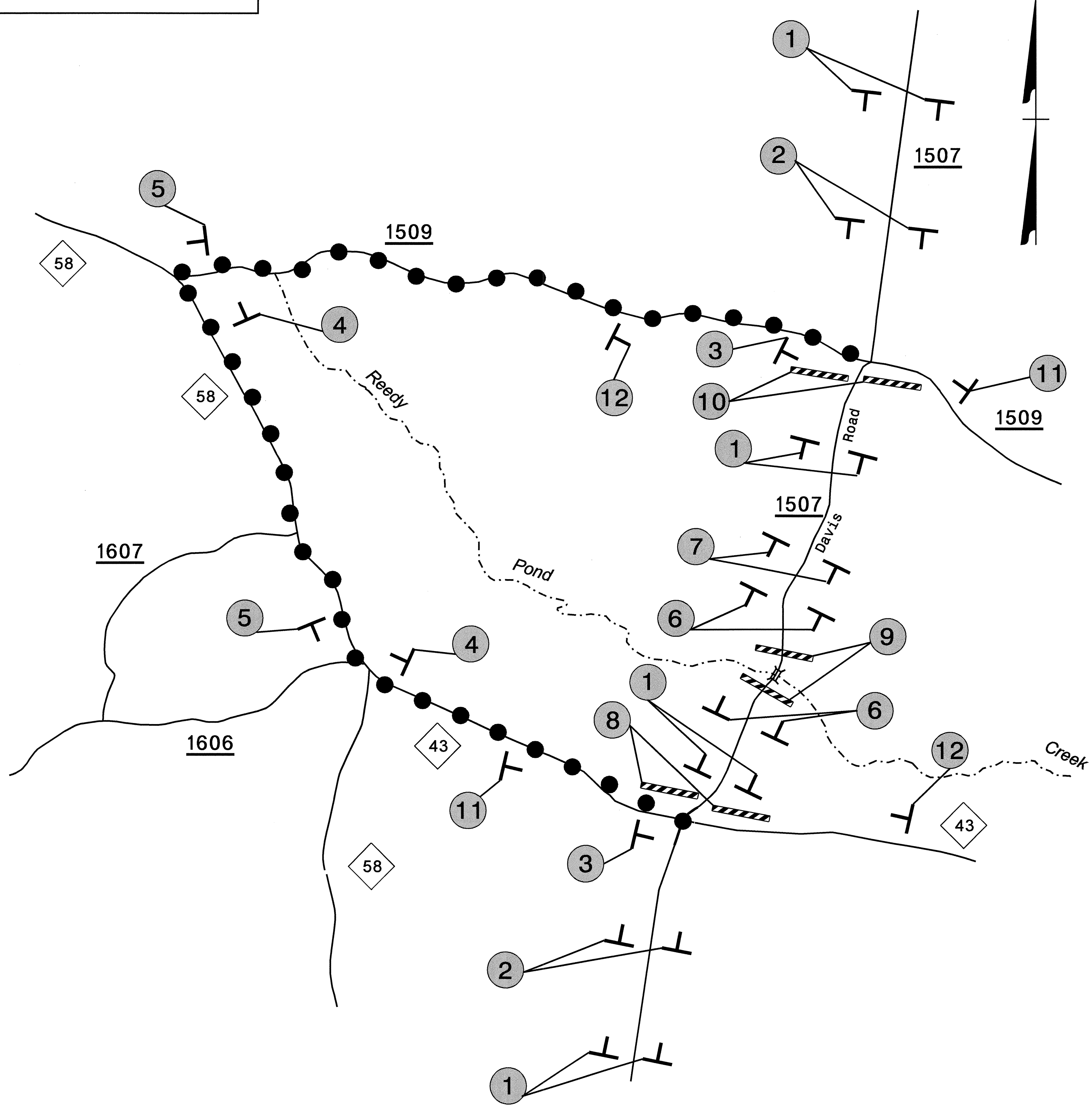

NOTES:

1. REFER TO RSD 1101.03, SHEET 1 OF 9 FOR SIGN SPACING DISTANCES.
2. SEE SHEET SD-1 FOR DETOUR SIGN DESIGN.

OFF-SITE DETOUR ROUTE ●—●—●

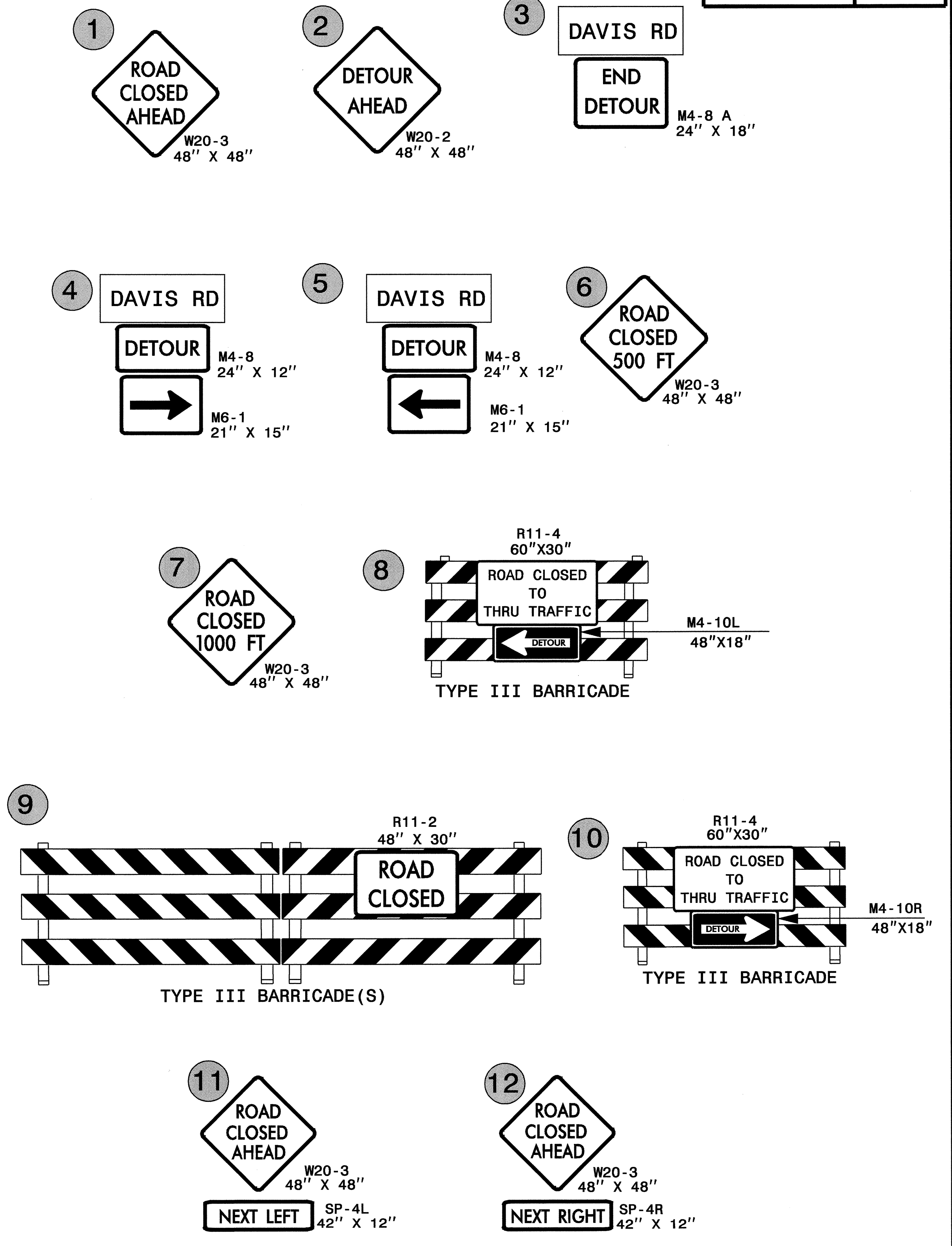

APPROVED:	DATE:	DETOUR ROUTE & BARRICADE PLACEMENT									
				SCALE: NONE	<table border="1"> <tr> <th colspan="2">REVISIONS</th> </tr> <tr> <td> </td> <td> </td> </tr> <tr> <td> </td> <td> </td> </tr> <tr> <td> </td> <td> </td> </tr> </table>	REVISIONS					
		REVISIONS									
DATE: 02/08	DWG. BY: EKG										
DESIGN BY: EKG	REVIEWED BY: JLP										
		CADD FILE									

06-FEB-2008 12:57
 \\dot\dfsroot\N\Pro\TIP\Projects-B\B3707\TrafficControl\top\B3707_TCP3.dgn
 AT WZTC224164
 ekggroundwater