

STATE OF NORTH CAROLINA
DIVISION OF HIGHWAYS

| | |
|-----------------------------|-----------|
| STATE PROJECT REFERENCE NO. | SHEET NO. |
| B-4193 | TCP-1 |

**PLAN FOR PROPOSED
TRAFFIC CONTROL, MARKING & DELINEATION
MCDOWELL COUNTY**

B-4193

ROADWAY STANDARD DRAWINGS

THE FOLLOWING ROADWAY STANDARDS AS APPEAR IN "ROADWAY STANDARD DRAWINGS"-
ROADWAY DESIGN UNIT-N.C. DEPARTMENT OF TRANSPORTATION-RALEIGH, N.C.,
DATED JULY 2006 ARE APPLICABLE TO THIS PROJECT AND BY REFERENCE HEREBY ARE
CONSIDERED A PART OF THESE PLANS:

| STD. NO. | TITLE |
|----------|-------------------------------------------------|
| 1101.02 | TEMPORARY LANE CLOSURES |
| 1101.03 | TEMPORARY ROAD CLOSURES |
| 1101.04 | TEMPORARY SHOULDER CLOSURES |
| 1101.11 | TRAFFIC CONTROL DESIGN TABLES |
| 1110.01 | STATIONARY WORK ZONE SIGNS |
| 1110.02 | PORTABLE WORK ZONE SIGNS |
| 1130.01 | DRUM |
| 1145.01 | BARRICADES |
| 1205.01 | PAVEMENT MARKINGS - LINE TYPES & OFFSETS |
| 1205.02 | PAVEMENT MARKINGS - 2 LANE & MULTILANE ROADWAYS |
| 1205.12 | PAVEMENT MARKINGS - BRIDGES |
| 1261.01 | GUARDRAIL & BARRIER DELINEATOR SPACING |
| 1261.02 | GUARDRAIL & BARRIER DELINEATOR TYPES |
| 1262.01 | GUARDRAIL END DELINEATION |

INDEX OF SHEETS

| SHEET NO. | TITLE |
|-----------|-----------------------------------------------------------------------------------------------------------------|
| TCP-1 | LIST OF APPLICABLE ROADWAY STANDARD DRAWINGS, LEGEND, INDEX OF SHEETS AND FINAL PAVEMENT MARKING SCHEDULE |
| TCP-2 | PROJECT NOTES AND PHASING |
| TCP-3 | DETAILS 1 & 2 |
| TCP-4 | DETOUR ROUTE AND BARRICADE PLACEMENT |
| SD-1 | SPECIAL SIGN DESIGN |

LEGEND

- GENERAL**
- DIRECTION OF TRAFFIC FLOW
 - NORTH ARROW
 - PROPOSED PVMT. EXIST. PVMT.
 - WORK AREA
 - REMOVAL OF EXISTING PAVEMENT

TRAFFIC CONTROL DEVICES

- TYPE I BARRICADE
- TYPE II BARRICADE
- TYPE III BARRICADE
- CONE
- DRUM SKINNY DRUM
- FLASHING ARROW PANEL (TYPE C)
- STATIONARY SIGN
- PORTABLE SIGN
- STATIONARY OR PORTABLE SIGN
- WARNING FLAGS
- CRASH CUSHION
- CHANGEABLE MESSAGE SIGN
- TRUCK MOUNTED IMPACT ATTENUATOR (TMIA)
- POLICE
- FLAGGER

PAVEMENT MARKINGS

- CRYSTAL/CRYSTAL PAVEMENT MARKER
- YELLOW/YELLOW PAVEMENT MARKER
- CRYSTAL/RED PAVEMENT MARKER
- PAVEMENT MARKING SYMBOLS

FINAL PAVEMENT MARKING SCHEDULE

| SYMBOL | DESCRIPTION | PAY ITEM | QUANTITY BREAKDOWN | TOTAL QUANTITY |
|-------------------|--------------------------------|------------|--------------------|----------------|
| PAVEMENT MARKINGS | | | | |
| PA | WHITE EDGE LINE (2X) | PAINT (4") | 750 LF | 1,500 LF |
| PI | YELLOW DOUBLE CENTER LINE (2X) | PAINT (4") | 375 LF | 1,500 LF |
| | | | TOTAL | 3,000 LF |

NOTE: FOR EACH PAINT PAVEMENT MARKING ITEM, 1X IMPLIES A SINGLE APPLICATION, 2X IMPLIES TWO APPLICATION, AND 3X IMPLIES THREE APPLICATION

TIP PROJECT:

07-FEB-2008 08:52 \\dot\des\control\Projects\b\4193\TrafficControl\top\final\top\b-4193-tc-top-1.dgn
ekgroundwater AT WZTC224164

| | |
|--------------------------------|--------------------------------------------------------------|
| APPROVED: _____ DATE: _____ | PLAN PREPARED BY: N.C.D.O.T. WORK ZONE TRAFFIC CONTROL UNIT |
| | J.S. BOURNE, P.E. TRAFFIC CONTROL ENGINEER |
| | J. ISHAK, P.E. TRAFFIC CONTROL PROJECT ENGINEER |
| | J.L. PORTANOVA, P.E. TRAFFIC CONTROL PROJECT DESIGN ENGINEER |
| | ALLA LYUDMIRSKAYA TRAFFIC CONTROL DESIGN ENGINEER |

DETAIL 1

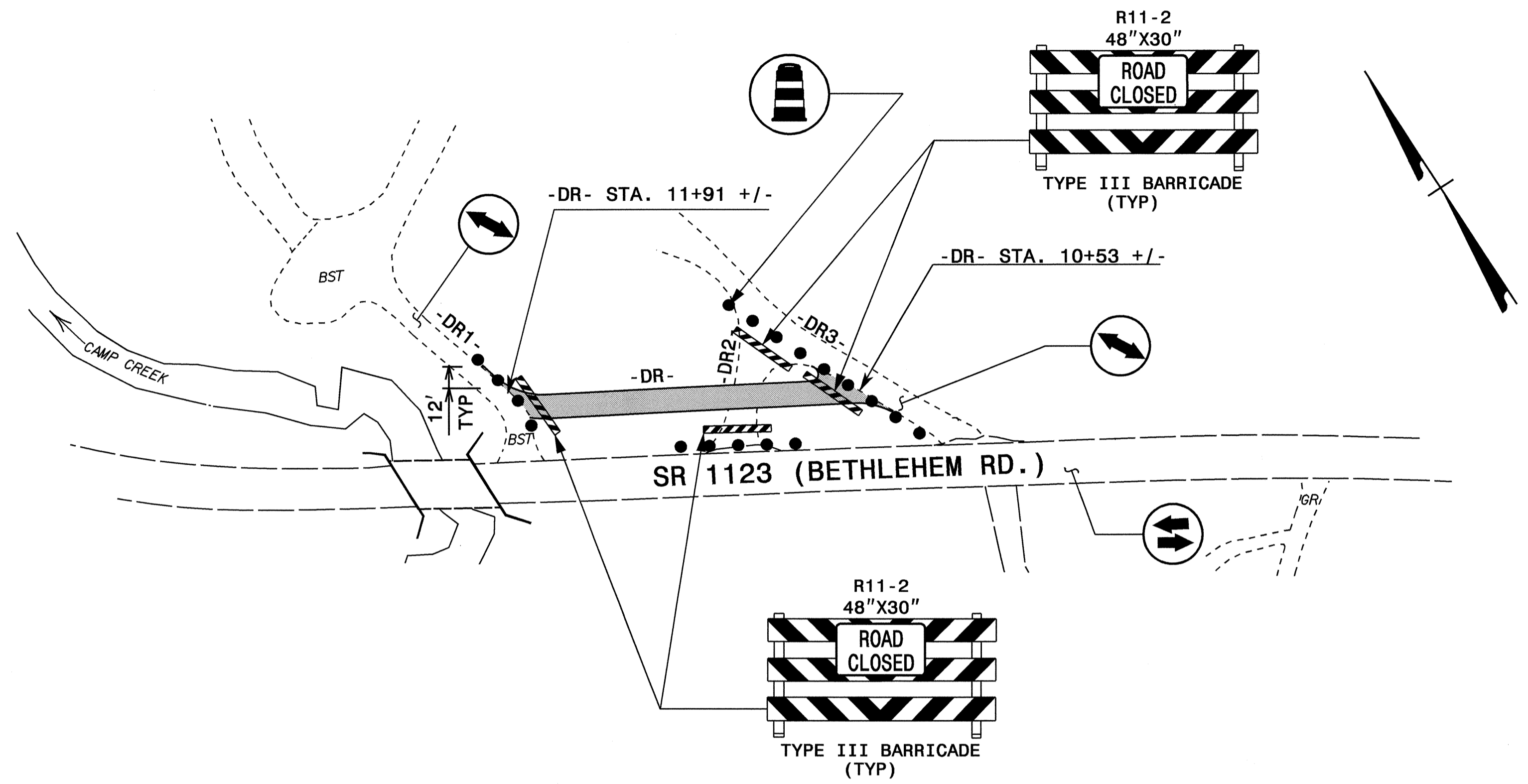

DETAIL 2

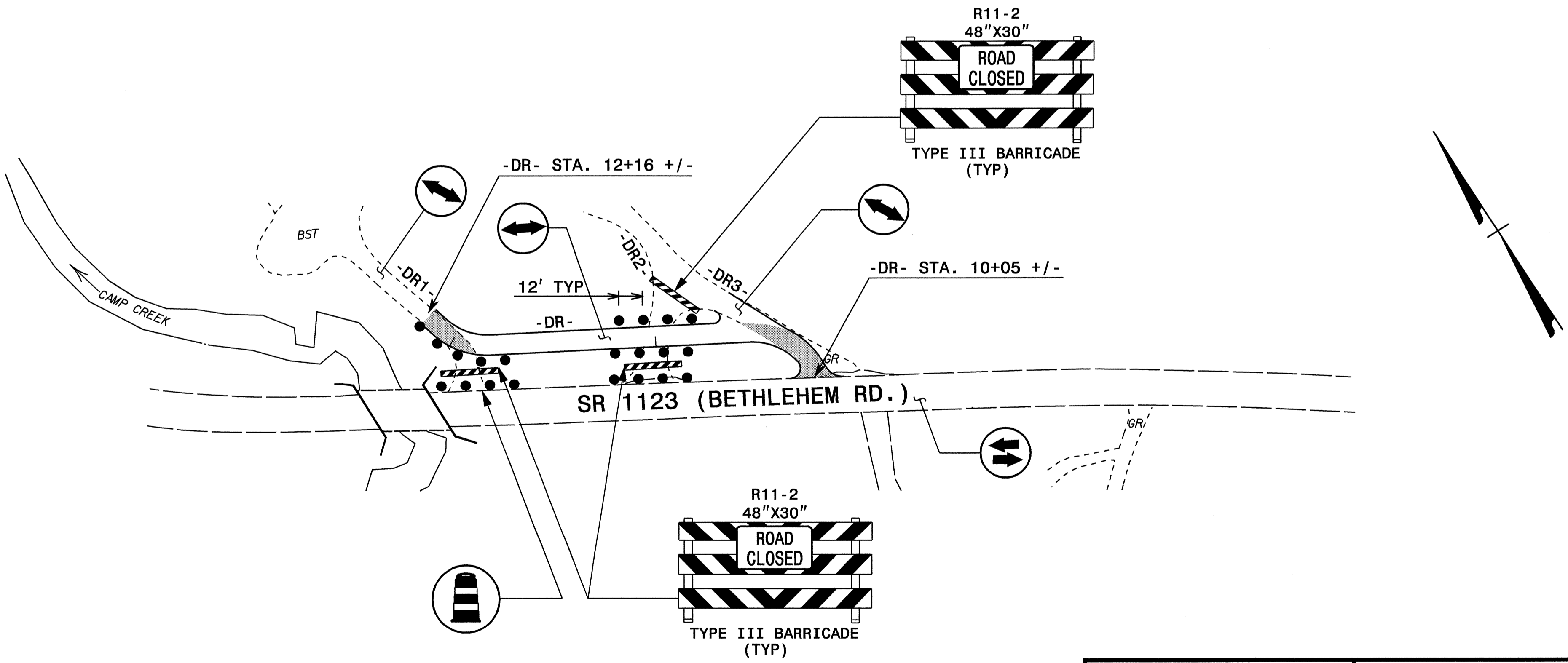

Z:\JAN-2008 10-73
 \JO\Pro\Tipp\projects-b\4193\traffic\trafficcontrol\top\final\top\B-4193_TCP-3.dgn
 city\adm\ AT WZTC237240

| | | |
|-----------------------------|--------------------------|--|
| APPROVED: _____ DATE: _____ | DETAILS 1 & 2 | |
| | SCALE: NONE | |
| | DATE: JAN/08 | |
| | DWG. BY: EKG | |
| | DESIGN BY: EKG | |
| REVIEWED BY: JLP | REVISIONS | |
| | | |
| | | |
| | | |

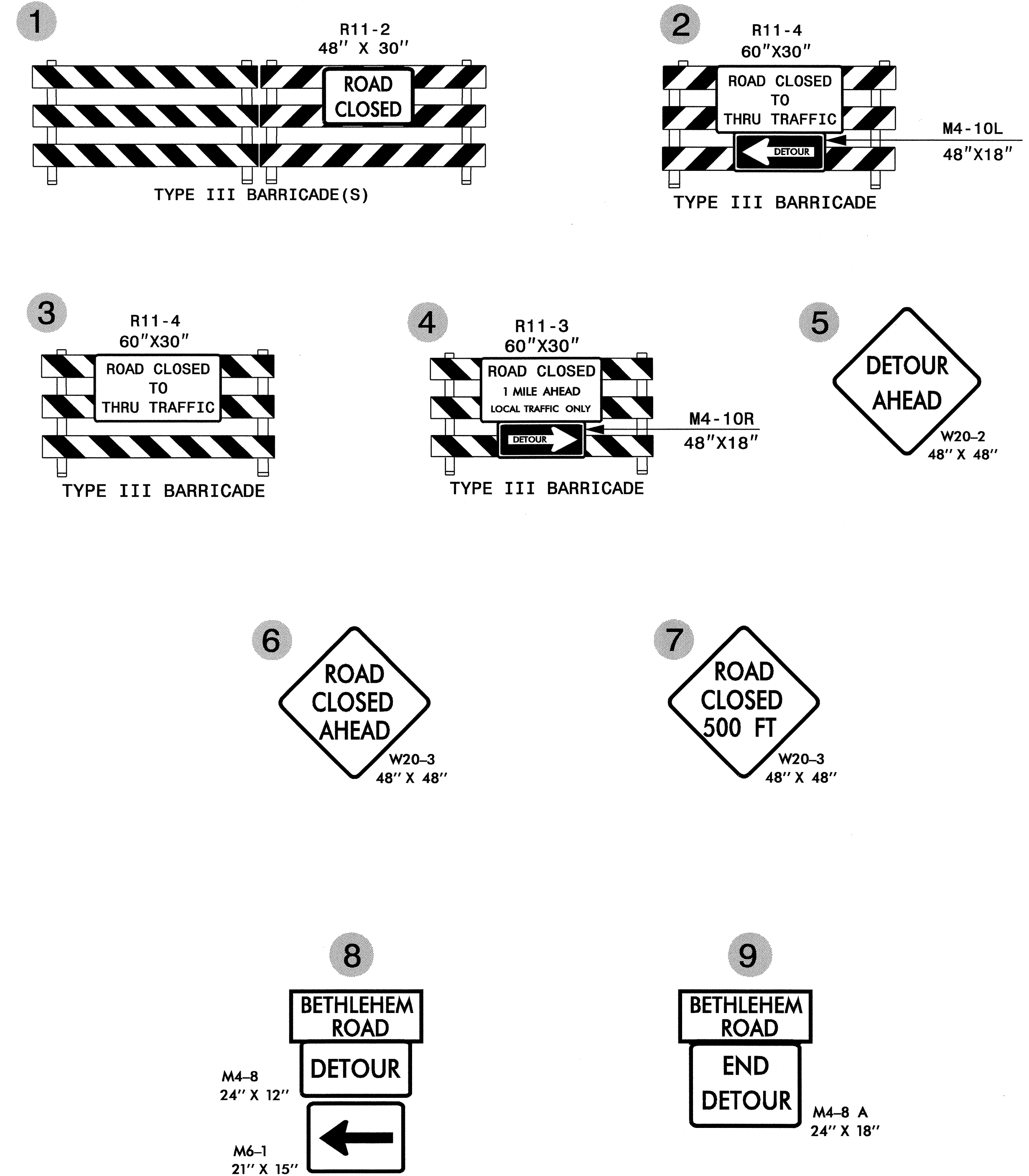
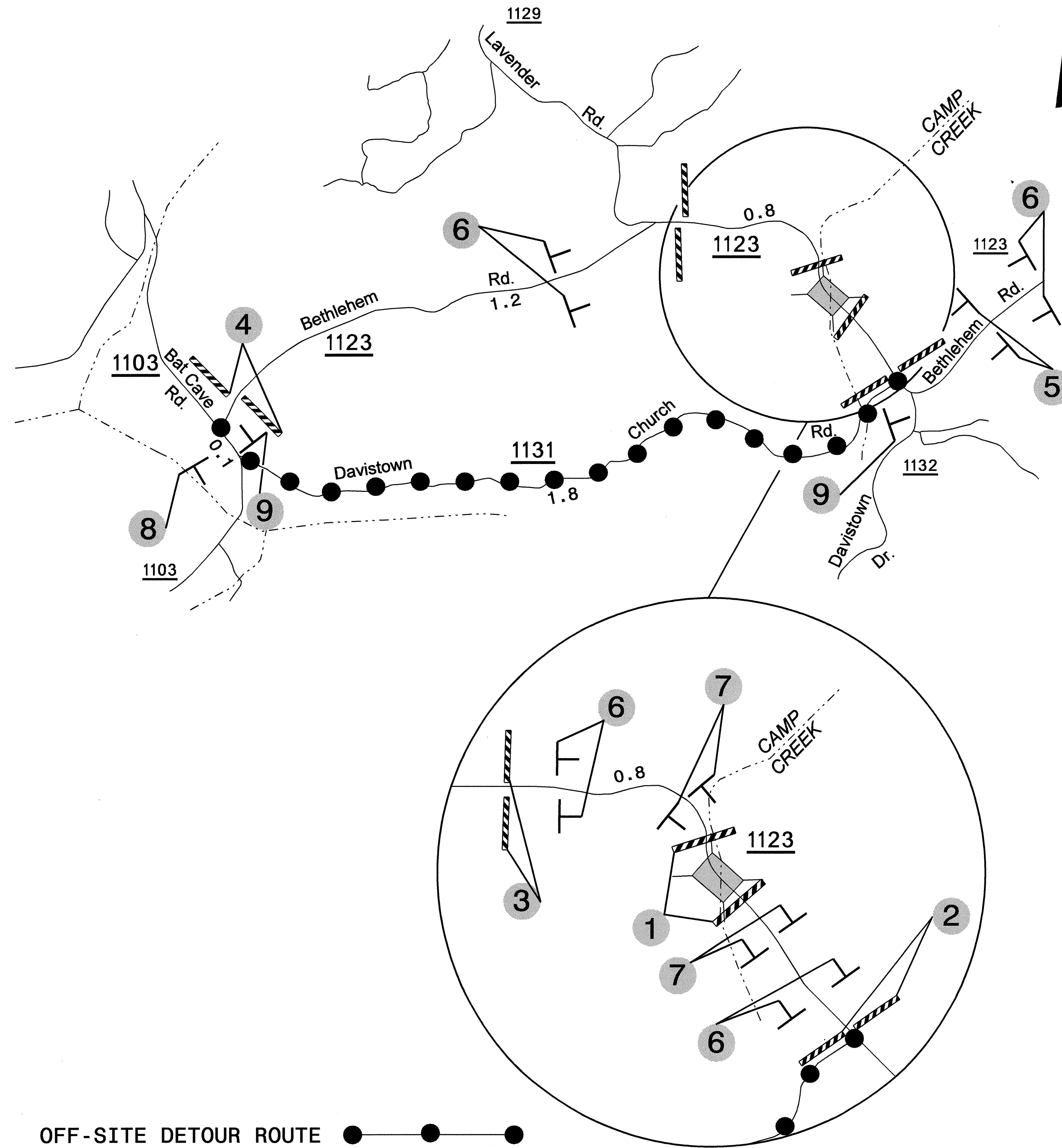

NOTES:

1. SEE SHEET SD-1 FOR DETOUR SIGN DESIGN.
2. REFER TO RSD 1101.03, SHEET 1 OF 9 FOR SIGN DISTANCES.

24-APR-2008 16:30
 \\dot\dfs\p0101\p01\proj\proj\traffic\traffic\control\top\final\top\b-4193_t-c_top-4.dgn
 glyudml AT WZ12317440

| | | | | | | | | |
|-----------------------------------------------------------------------------------|---------------------------------------------|------------------------------------------------------------------------------------------------------------------------------------|--|--|--|--|--|--|
| APPROVED: _____ DATE: _____ | DETOUR ROUTE AND BARRICADE PLACEMENT | | | | | | | |
| | | | | | | | | |
| SCALE: NONE DATE: APR/08 DWG. BY: EKG DESIGN BY: EKG REVIEWED BY: JLP | | REVISIONS <table border="1"> <tr><td> </td><td> </td></tr> <tr><td> </td><td> </td></tr> <tr><td> </td><td> </td></tr> </table> | | | | | | |
| | | | | | | | | |
| | | | | | | | | |
| | | | | | | | | |