

T.I.P.: B-4052

CONTRACT: C201837

**STATE OF NORTH CAROLINA
DEPARTMENT OF TRANSPORTATION**

**SIGNING PLANS
CALDWELL COUNTY**

LOCATION: BRIDGE NO. 7 OVER YADKIN RIVER ON NC 268

TIP NO. B-4052	SHEET NO. SIGN-1
APPROVED: <i>[Signature]</i>	
DATE: 1/29/08	
SEAL	
	

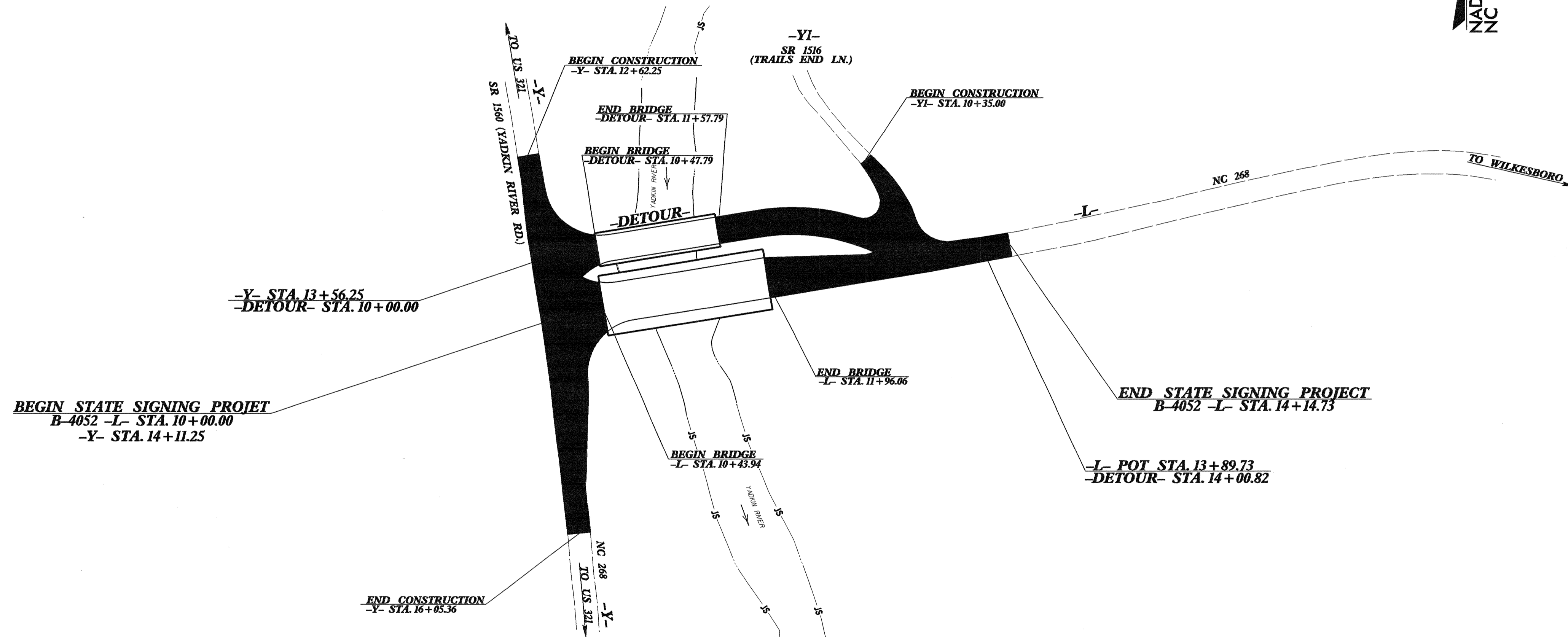

SUMMARY OF QUANTITIES

ITEM NO.		ITEM DESCRIPTION	QUANTITY	UNIT
DESC. NO.	SECT. NO.			
4025000000	901	CONTRACTOR FURNISHED, TYPE E SIGN	17.5	S.F.
4025000000	901	CONTRACTOR FURNISHED, TYPE F SIGN	46.94	S.F.
4072000000	903	SUPPORTS, 3 LB STEEL U-CHANNEL	130	L.F.
4102000000	904	SIGN ERECTION, TYPE E	3	EA.
4108000000	904	SIGN ERECTION, TYPE F	5	EA.
4155000000	907	DISPOSAL OF SIGN SYSTEM, U-CHANNEL	11	EA.

INDEX

SHEET NO.	DESCRIPTION
1	TITLE SHEET
2	TYPE "E" & "F" SIGNS
3	EXISTING/PROPOSED ROADWAY

PLAN PREPARED BY: N.C.D.O.T. SIGNING SECTION

R. W. KING, PE SIGNING ENGINEER

A. I. ALQUDWAH, PE SIGNING PROJECT ENGINEER

D. M. EATON SIGNING PROJECT DESIGN ENGINEER

R. R. HENNEIN SIGNING DESIGNER

ROADWAY STANDARD DRAWINGS
APPLICABLE TO THESE SIGNING PLANS
904.10 904.50

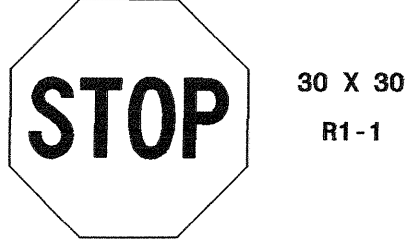
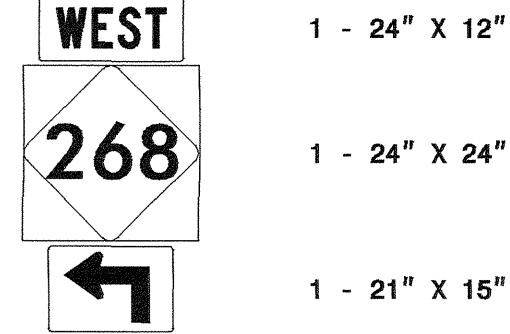
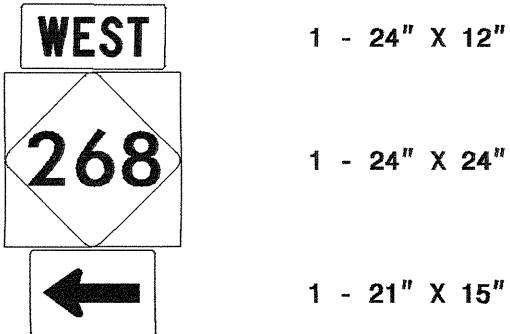
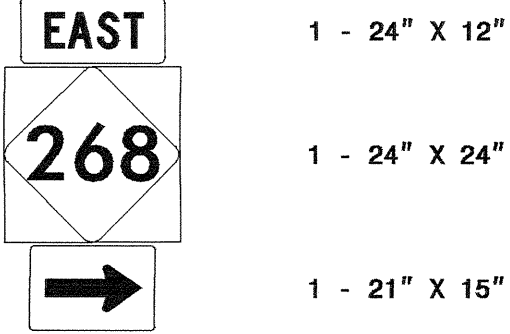
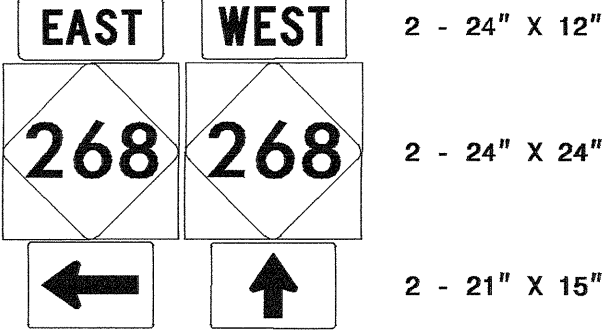
		TIP NO. B-4052	SHEET NO. SIGN-2
<p>403 QUANTITY REQ'D _1_</p>  <p>ONE "U" POST PER SIGN</p>			<p>APPROVED: <i>[Signature]</i></p> <p>DATE: 1/29/08</p> <p>SEAL</p> 
<p>408 QUANTITY REQ'D _2_</p>  <p>ONE "U" POST PER SIGN</p>		<p>501</p>  <p>ONE "U" POST PER SIGN</p>	
		<p>502</p>  <p>ONE "U" POST PER SIGN</p>	
		<p>503</p>  <p>ONE "U" POST PER SIGN</p>	
		<p>504</p>  <p>ONE "U" POST PER SIGN</p>	
		<p>505</p>  <p>TWO "U" POSTS PER SIGN</p>	
			<p>TYPE "E" & "F" SIGNS</p>

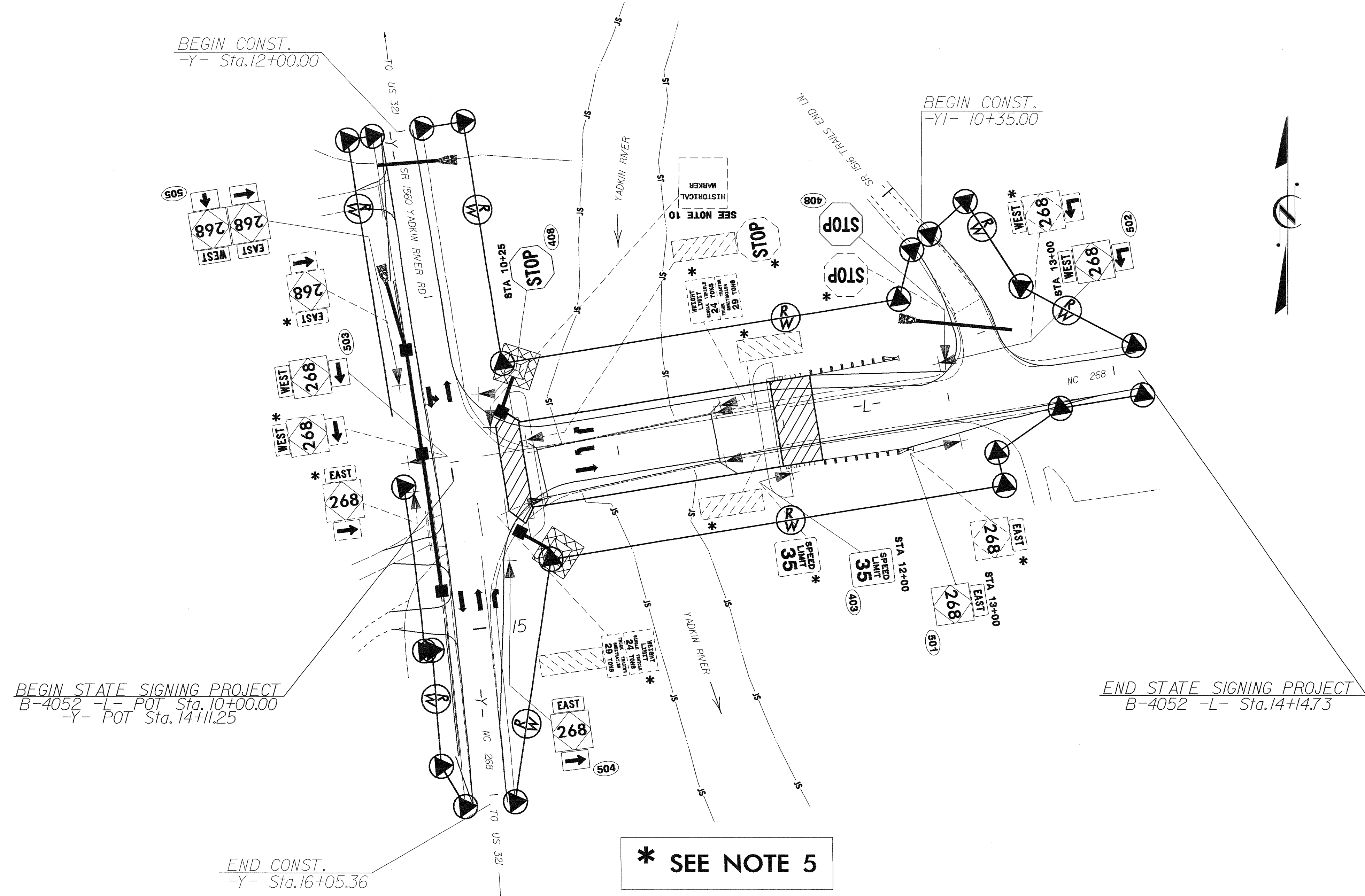

WARNING SIGNS PLACEMENT CHART

POSTED OR 85TH PERCENTILE SPEED MPH (KMH)	MUTCD DISTANCE FT (M)	SUGGESTED LOCATION FT (M)	SUGGESTED MAXIMUM FT (M)
30 (50)	450 (140)	475 (145)	575 (175)
35 (55)	550 (170)	575 (175)	675 (205)
40 (65)	650 (200)	675 (205)	775 (235)
45 (70)	750 (230)	775 (235)	875 (270)
50 (80)	850 (260)	875 (270)	975 (300)
55 (90)	950 (290)	975 (300)	1075 (330)
60 (95)	1100 (335)	1125 (345)	1225 (375)
65 (105)	1200 (365)	1225 (375)	1325 (405)
70 (115)	1250 (380)	1275 (390)	1375 (420)

1. SEE ROADWAY STANDARD NO. 904.50 FOR MOUNTING OF TYPE 'D', 'E', AND 'F' SIGNS ON 'U' CHANNEL POSTS.
2. SEE CHART FOR PLACEMENT OF WARNING SIGNS. DISTANCES SHOWN IN MINIMUM ROAD COLUMNS ARE FOR LEVEL ROADWAYS. MAKE CORRECTIONS FOR GRADES. IF 48-INCH (1219 MM) SIGNS ARE USED, THE LEGIBILITY DISTANCE MAY BE INCREASED TO 200 FEET (61 M). THIS WOULD ALLOW REDUCING THE CHART SPECIFIED DISTANCE BY 75 FEET (23 M).
3. IF THE BRIDGE IS OVER A MAJOR STREAM OR RIVER, A SIGN FOR THE NAME OF THE STREAM OR RIVER SHOULD BE INSTALLED AT EACH APPROACH. THESE DESIGNS WILL BE COMPLETED BY THE SIGNING SECTION UPON REQUEST.
4. SIGNS FURNISHED BY CONTRACTOR. BACKGROUND SHEETING SHALL BE TYPE III REFLECTIVE SHEETING.
5. DISPOSAL OF SIGN SYSTEM, U-CHANNEL.
6. SIGN ERECTION, RELOCATE SIGN TYPE D, E, OR F.
7. DISPOSAL OF SIGN SYSTEM, WOOD.
8. DISPOSAL OF SIGN, D, E, OR F.
9. DISPOSAL OF SUPPORT, U-CHANNEL.
10. THE CONTRACTOR SHALL COORDINATE WITH N.C.D.O.T. DIVISION FORCES FOR THE REMOVAL AND STOCKPILING OF THE HISTORICAL MARKER.

STA 10+00 TO 14+14.73
NC 268
EXISTING/PROPOSED ROADWAY