

## STATE OF NORTH CAROLINA DIVISION OF HIGHWAYS

### CROSS-SECTION SUMMARY

Station	Uncl. Exc.	Embt	UnderCut												
L	(cu. yd.)	(cu. yd.)	(cu. yd.)												
16+50.00	0	0	0												
17+00.00	1	47	0												
17+50.00	6	76	0												
18+00.00	2	64	0												
18+50.00	2	82	0												
19+00.00	1	119	0												
19+50.00	43	129	0												
20+00.00	77	129	0												
20+20.00	28	58	0												
				Approximate quantities only. Unclassified excavation, borrow excavation, fine grading, clearing and grubbing, and removal of existing pavement will be paid for at the lump sum price for "Grading".											
Station	Uncl. Exc.	Embt	UnderCut												
L	(cu. yd.)	(cu. yd.)	(cu. yd.)												
21+70.00	0	0	0												
22+00.00	0	147	0												
22+50.00	0	251	0												
23+00.00	0	241	0												
23+50.00	0	183	0												
24+00.00	1	123	0												
24+50.00	7	88	0												
25+00.00	11	65	0												
25+50.00	10	52	0												
26+00.00	8	41	0												
26+50.00	6	35	0												
27+00.00	5	39	0												
27+50.00	37	24	25												
28+00.00	48	3	38												
28+50.00	15	1	13												
28+71.85	1	1	0												
<p><b>Earthwork quantities are calculated by the Roadway Design Unit. These earthwork quantities are based in part on subsurface data provided by the Geotechnical Engineering Unit.</b></p>															

8/23/99

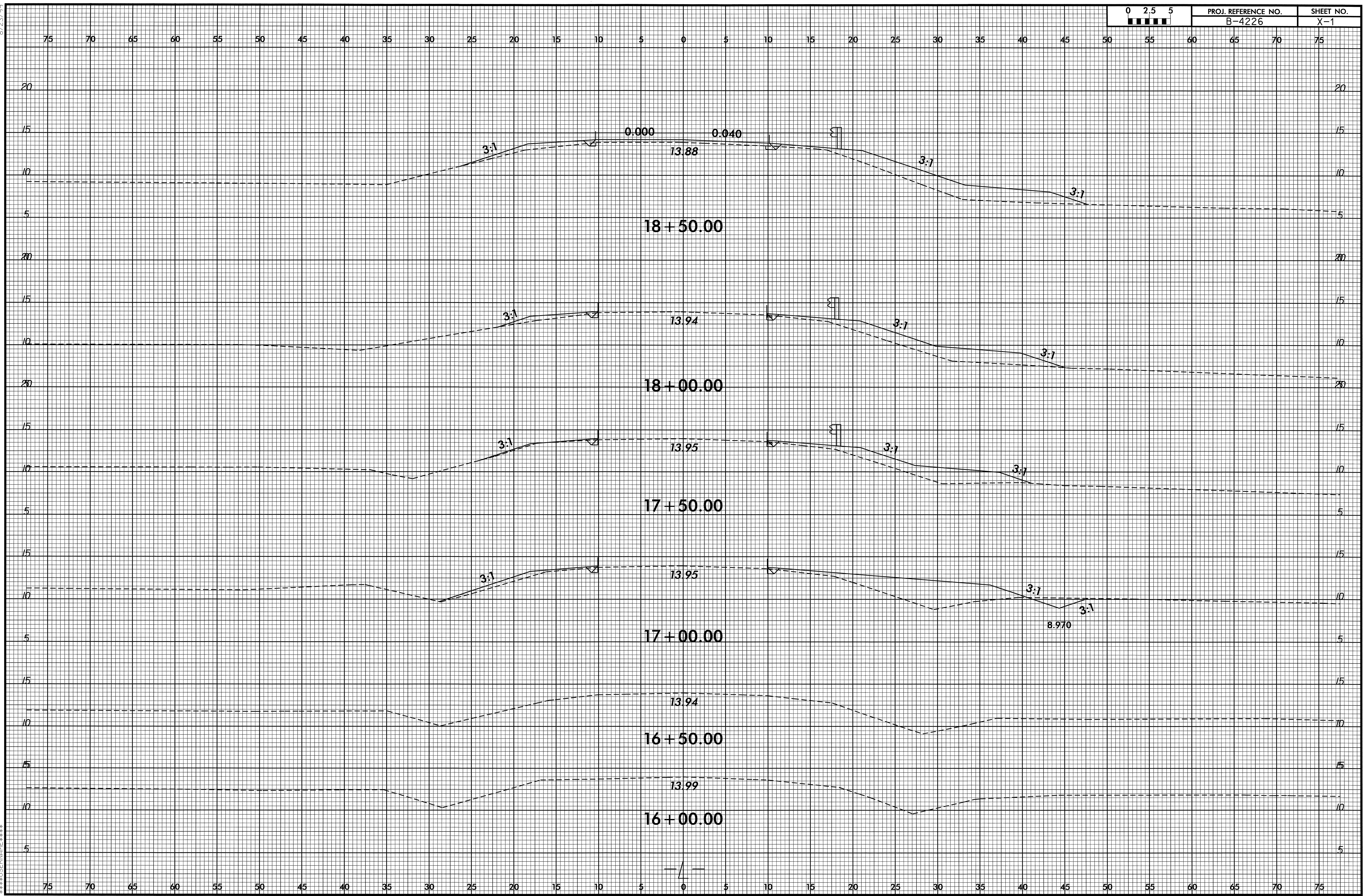

7-DEC-2007 14:50  
6338105704226.dwg -xp1.l.dgn

8/23/99

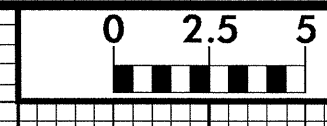

PROJ. REFERENCE NO.	SHEET NO.
B-4226	X-2

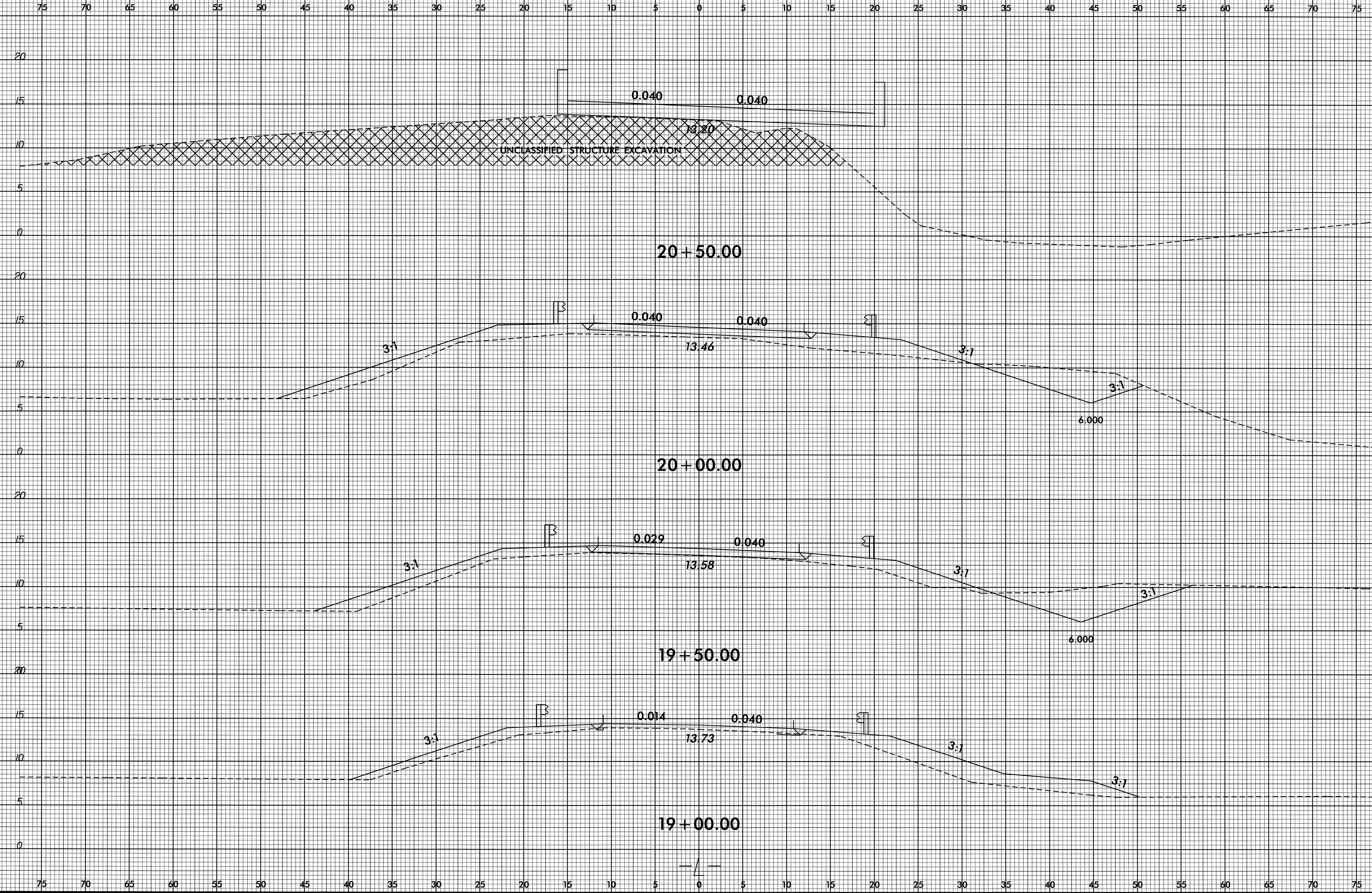

7-DEC-2007 14:50  
8339105226.rdw-  
xp1.1.dgn

8/23/98

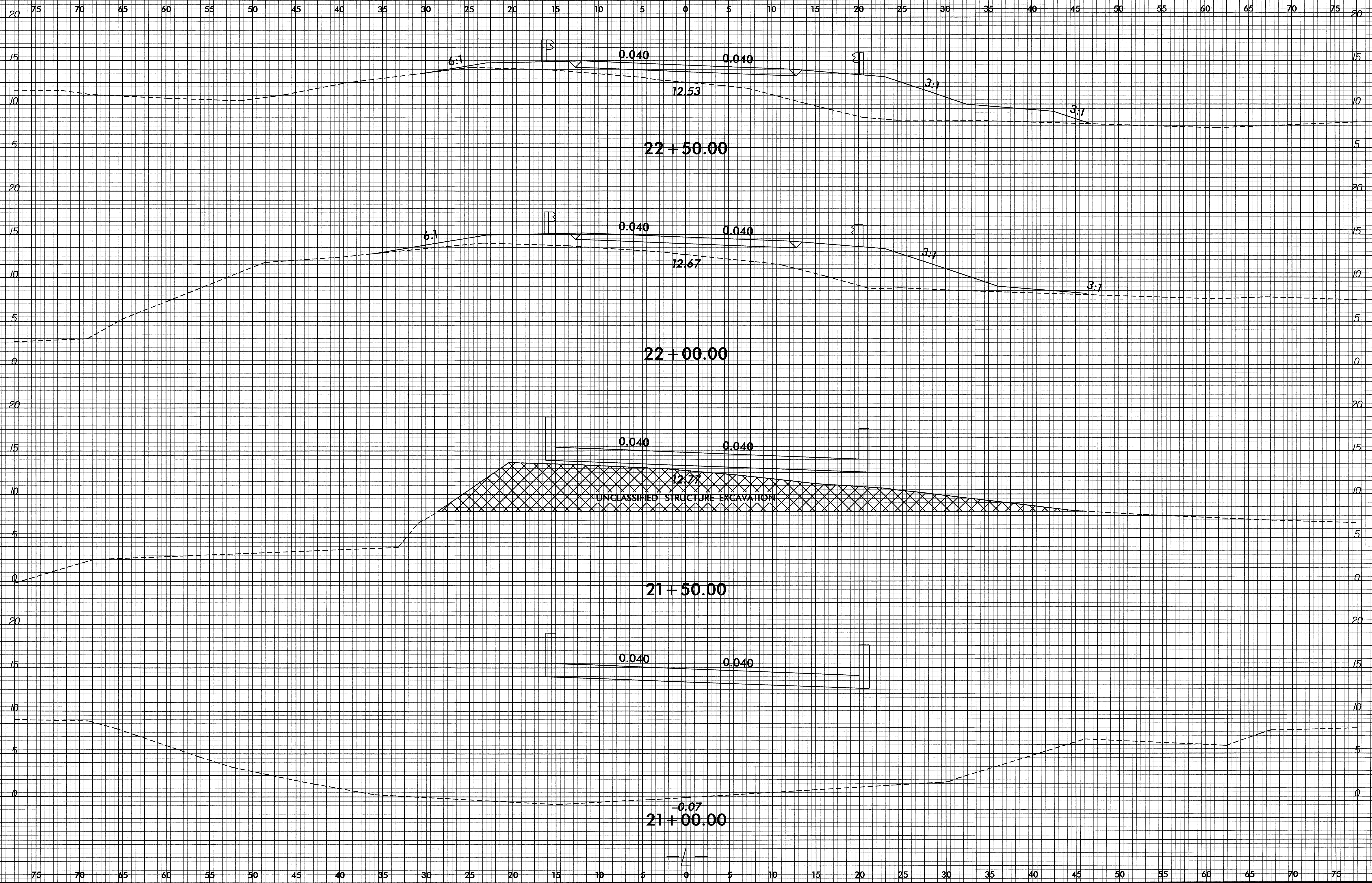

10-DEC-2007 12:06  
R:\Roadwork\XSCAB-4226-rdu\_xpl1.dgn  
\$\$\$\$\$\$\$\$\$\$\$\$\$\$\$\$

8/23/99

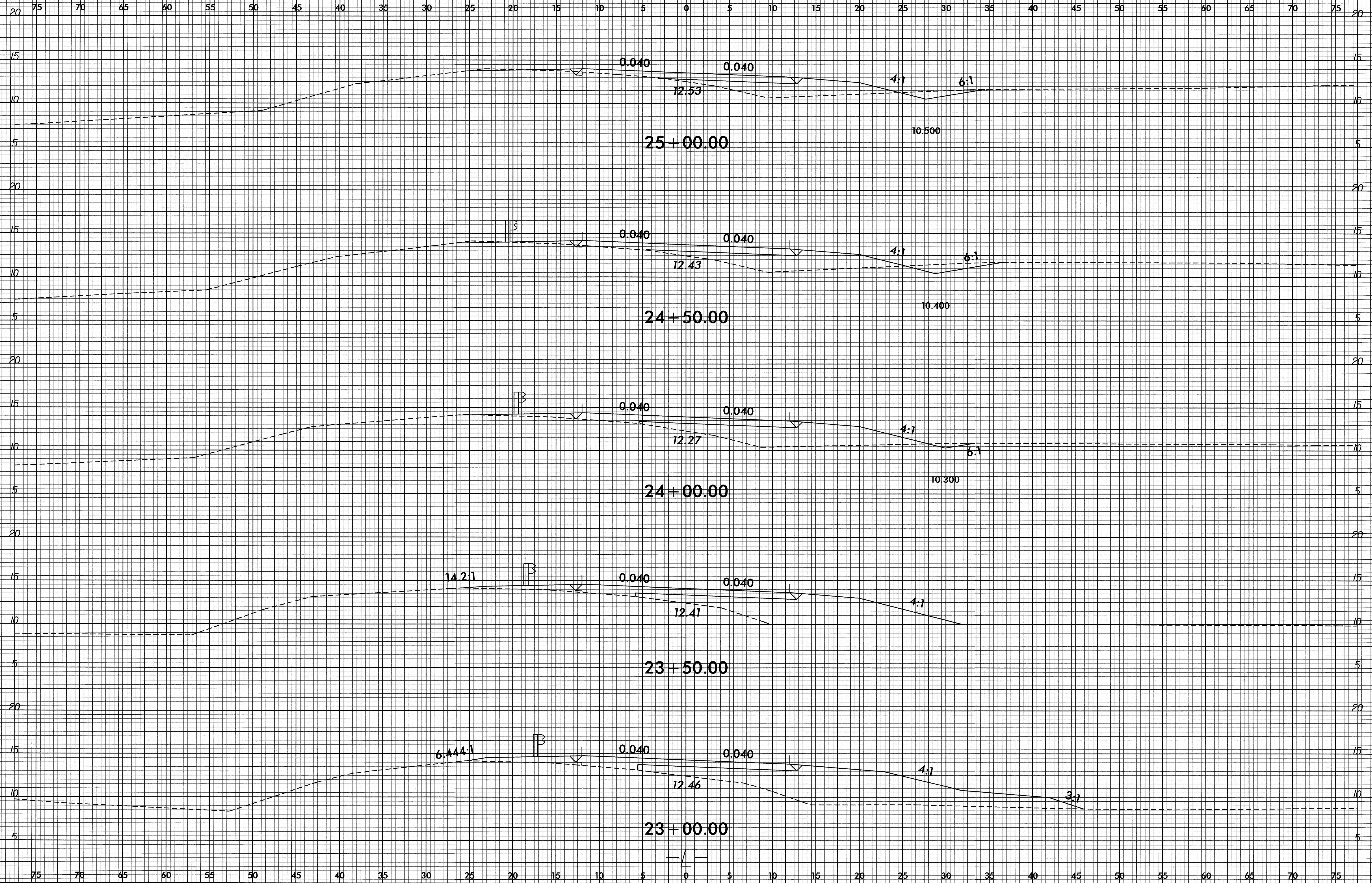

10-DEC-2007 12:06  
P:\00000000\X26\B-4226-r.dwg\_xp1.1.dgn  
\$\$\$\$\$

8/23/99

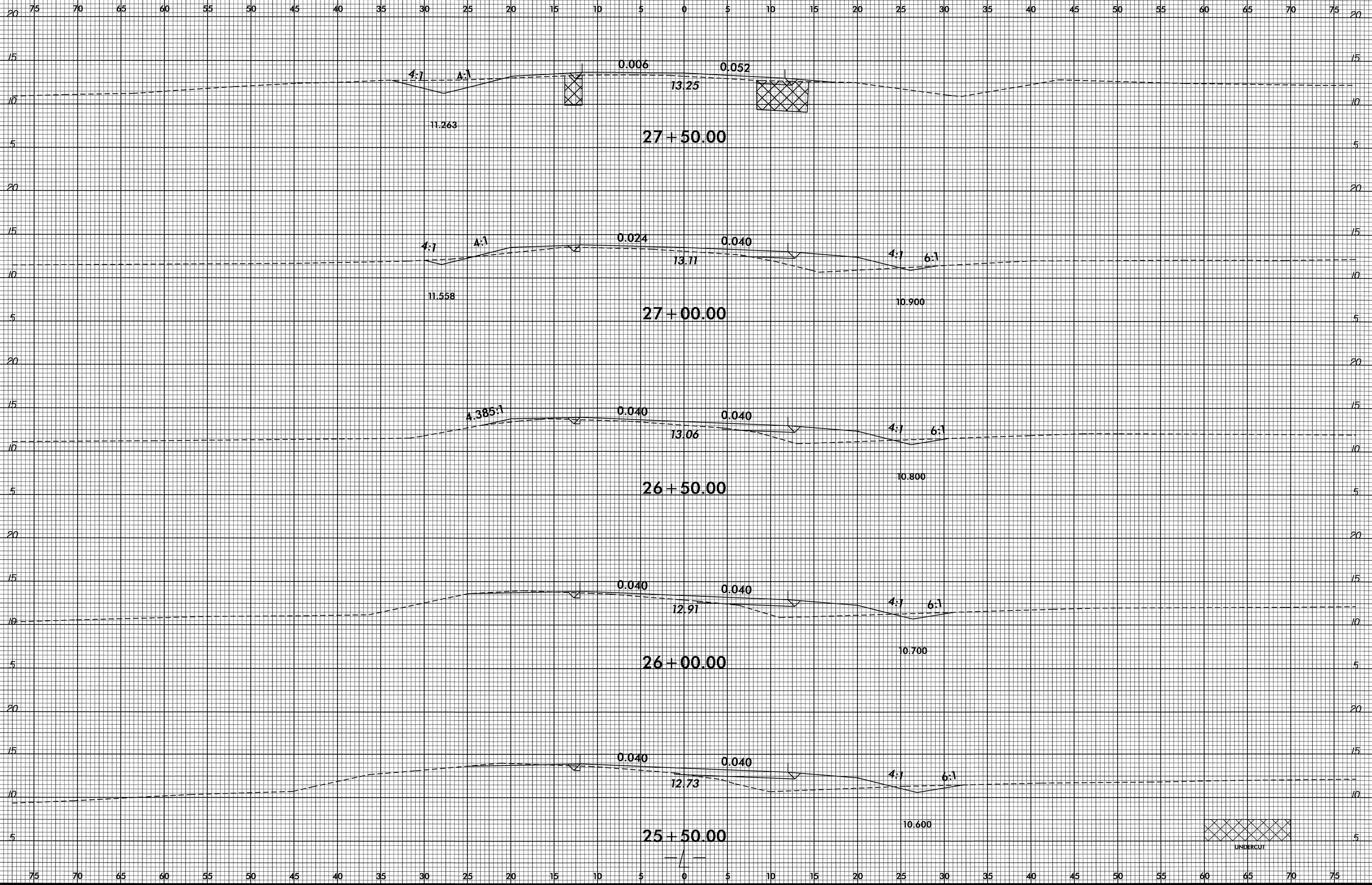

F:\DEC-2007\1450\_4226\_r-dj-vp\1.dgn

8/23/99

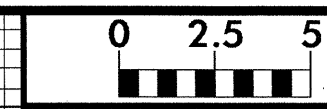

PROJ. REFERENCE NO.  
B-4226

SHEET NO.  
X-6

75 70 65 60 55 50 45 40 35 30 25 20 15 10 5 0 5 10 15 20 25 30 35 40 45 50 55 60 65 70 75

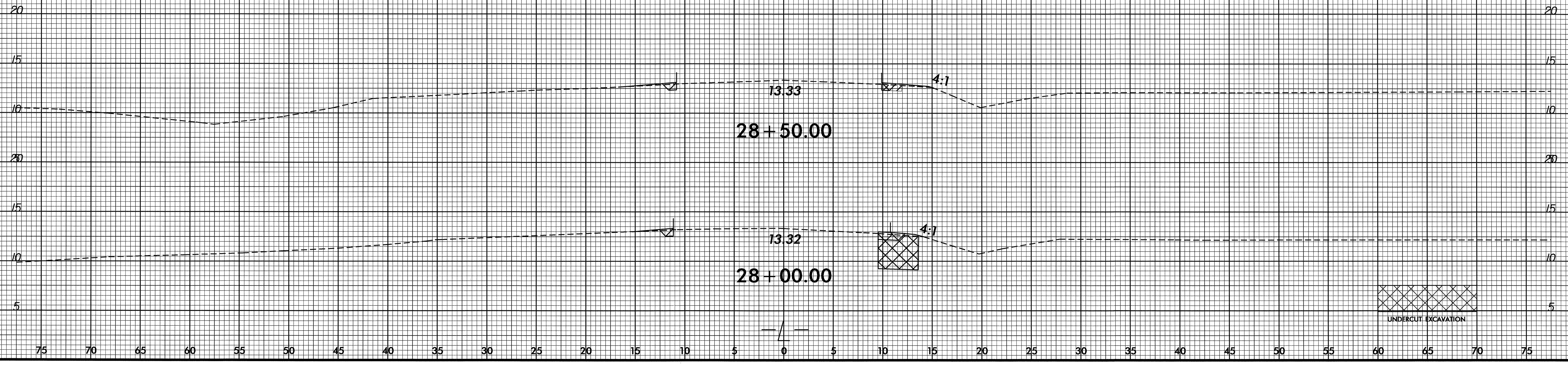

10-DEC-2007 12:06  
 F:\Roadway\XSC\B-4226\_rdy\_xp1.dgn  
 \$\$\$USER\$\$\$