

**TIP PROJECT: B-4130**

STATE OF NORTH CAROLINA  
DIVISION OF HIGHWAYS

---

PLAN FOR PROPOSED  
HIGHWAY EROSION CONTROL

---

**GUILFORD COUNTY**

**LOCATION: BRIDGE NO. 228 OVER BIG ALAMANCE CREEK ON  
SR 3045 (MOUNT HOPE CHURCH ROAD)**

**TYPE OF WORK: GRADING, DRAINAGE, PAVING & STRUCTURE**

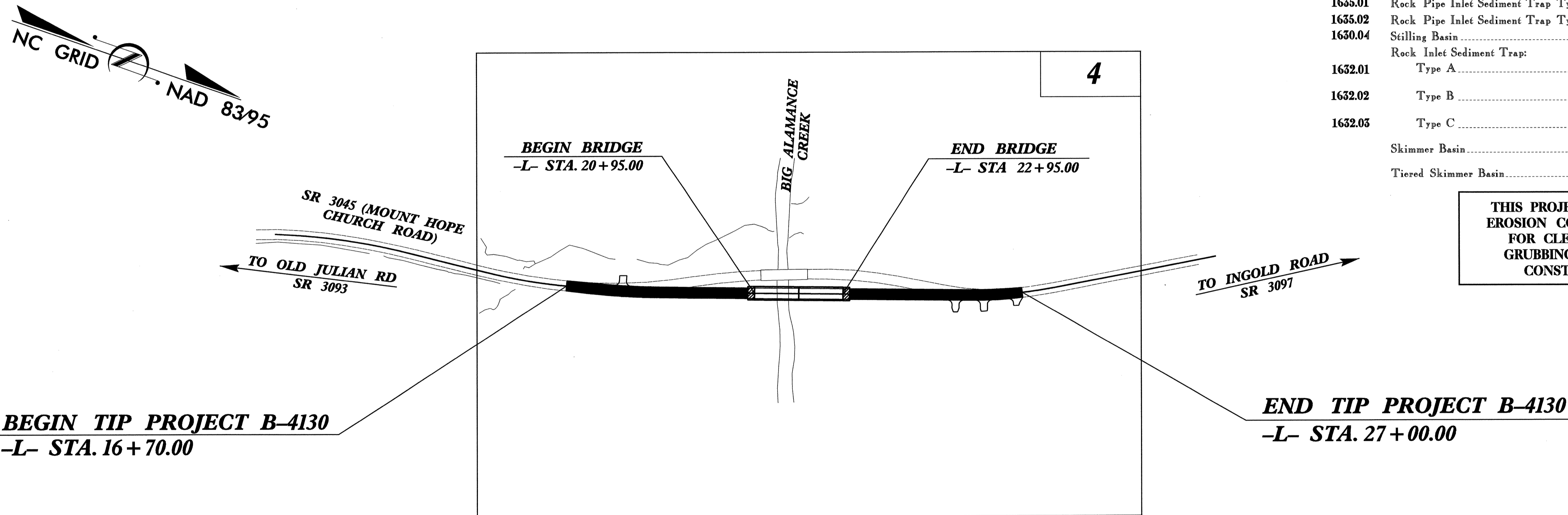

STATE	STATE PROJECT REFERENCE NO.	SHEET NO.	TOTAL SHEETS
N.C.	B-4130	EC-1	
STATE PROJ. NO.	F.A. PROJ. NO.	DESCRIPTION	

**EROSION AND SEDIMENT CONTROL MEASURES**

Std. #	Description	Symbol
	Streambank Reforestation.....	
1630.05	Temporary Silt Ditch.....	
1630.05	Temporary Diversion.....	
1605.01	Temporary Silt Fence.....	
1606.01	Special Sediment Control Fence.....	
1622.01	Temporary Berms and Slope Drains.....	
1630.01	Riser Basin.....	
1630.02	Silt Basin Type B.....	
1633.01	Temporary Rock Silt Check Type-A.....	
	Temporary Rock Silt Check Type-B.....	
1634.01	Temporary Rock Sediment Dam Type-A.....	
1634.02	Temporary Rock Sediment Dam Type-B.....	
1635.01	Rock Pipe Inlet Sediment Trap Type-A.....	
1635.02	Rock Pipe Inlet Sediment Trap Type-B.....	
1630.04	Stilling Basin.....	
	Rock Inlet Sediment Trap:	
1632.01	Type A.....	
1632.02	Type B.....	
1632.03	Type C.....	
	Skimmer Basin.....	
	Tiered Skimmer Basin.....	

**THIS PROJECT CONTAINS  
EROSION CONTROL PLANS  
FOR CLEARING AND  
GRUBBING PHASE OF  
CONSTRUCTION.**

**GRAPHIC SCALE**

0

PLANS

0

PROFILE (HORIZONTAL)

0

PROFILE (VERTICAL)

ROADSIDE ENVIRONMENTAL UNIT  
DIVISION OF HIGHWAYS  
STATE OF NORTH CAROLINA

Prepared in the Office of:  
**ROADSIDE ENVIRONMENTAL UNIT**  
1 South Wilmington St.  
Raleigh, NC 27611  
**2006 STANDARD SPECIFICATIONS**

Roadway Standard Drawings

The following roadway english standards as appear in "Roadway Standard Drawings"- Roadway Design Unit - N. C. Department of Transportation - Raleigh, N. C., dated July 18, 2006 and the latest revision thereto are applicable to this project and by reference hereby are considered a part of these plans.

1605.01 Temporary Silt Fence	1630.06 Special Stilling Basin
1607.01 Gravel Construction Entrance	1632.03 Rock Inlet Sediment Trap Type C
1622.01 Temporary Berms and Slope Drains	1633.01 Temporary Rock Silt Check Type A
1630.02 Silt Basin Type B	1634.02 Temporary Rock Sediment Dam Type B
1630.03 Temporary Silt Ditch	

26-0013007-021  
 project:\environmental\detail\4130-er-dj-esh.dgn  
 11/23/07 11:23:11 AM  
 P:\projects\26-0013007-021\environmental\detail\4130-er-dj-esh.dgn

PROJECT REFERENCE NO. B-4130	SHEET NO. EC-2
RW SHEET NO.	
ROADWAY DESIGN ENGINEER	HYDRAULICS ENGINEER

# TEMPORARY ROCK SILT CHECK TYPE 'B' DETAIL

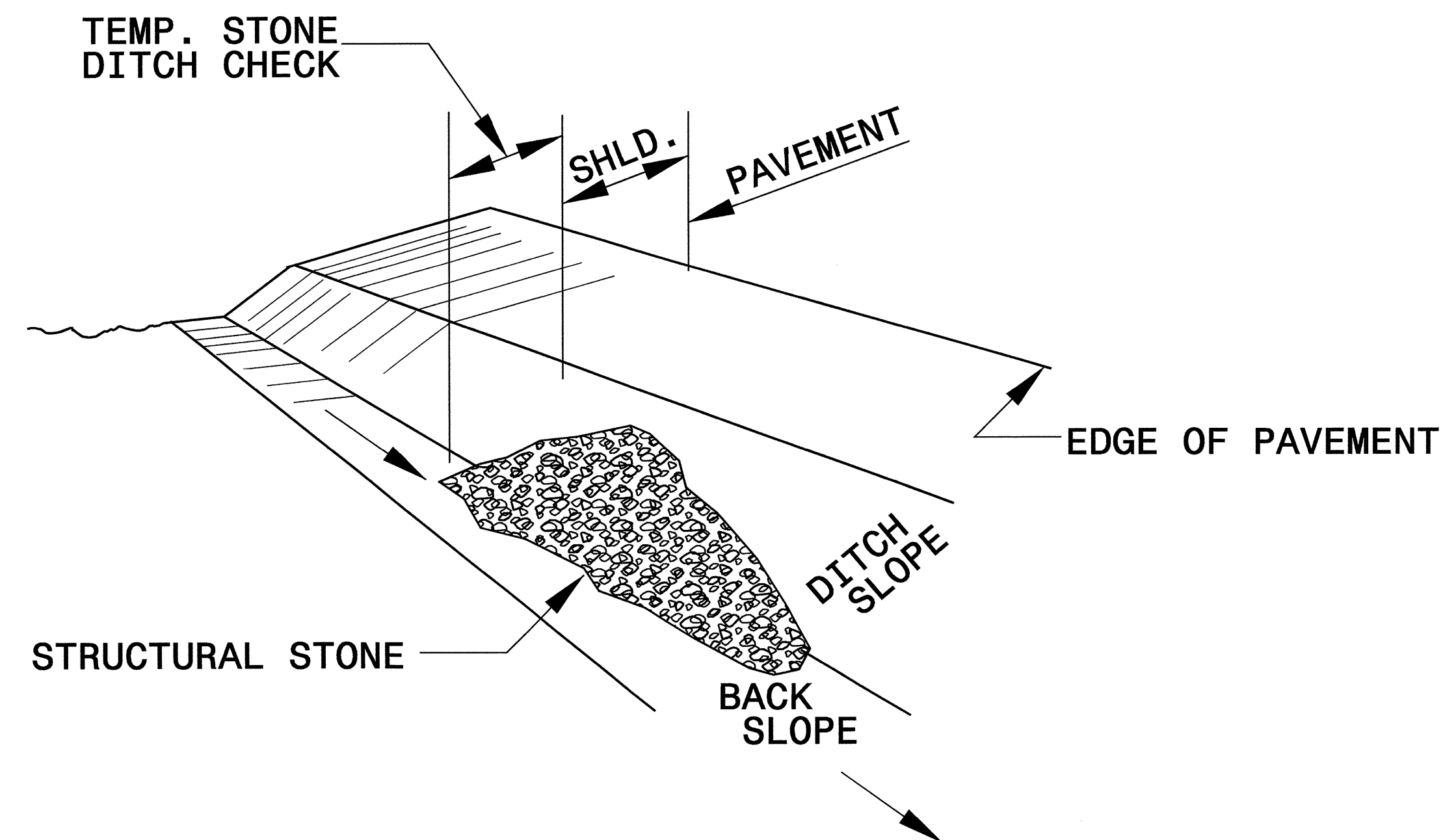

**ISOMETRIC VIEW**

**NOTES:**

USE CLASS 'B' EROSION CONTROL STONE FOR STRUCTURAL STONE.

THE ENGINEER MAY DIRECT THE OPTION OF CLASS "A" STONE FOR SITES HAVING LESS THAN ONE (1) ACRE DRAINAGE AREA AND A DITCH GRADE LESS THAN 3%.

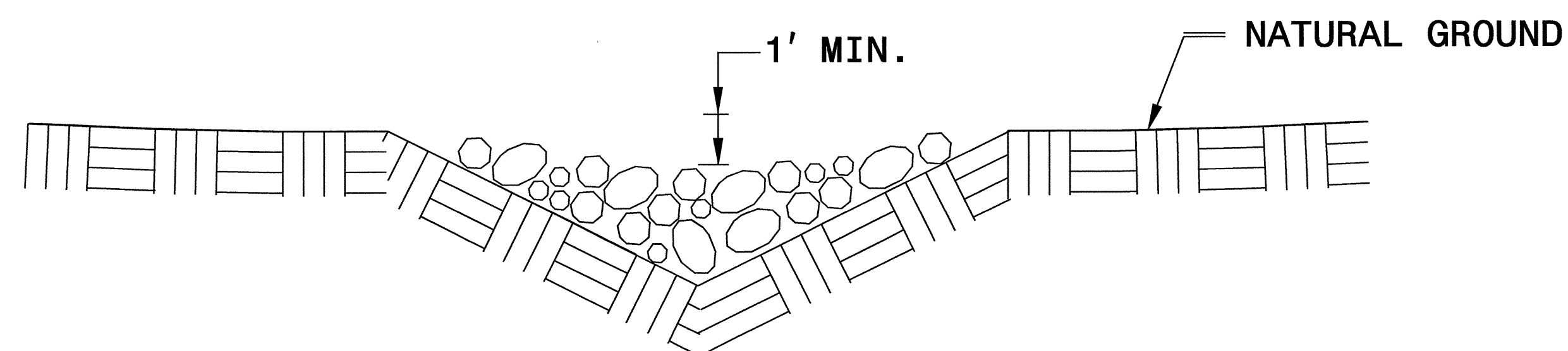

**CROSS SECTION VEE DITCH**

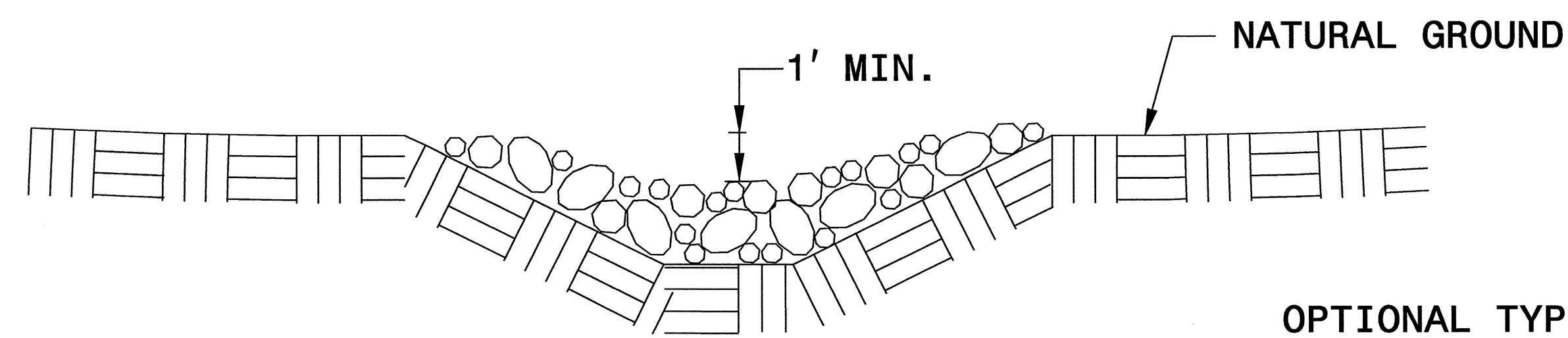

**CROSS SECTION TRAPEZOIDAL DITCH**

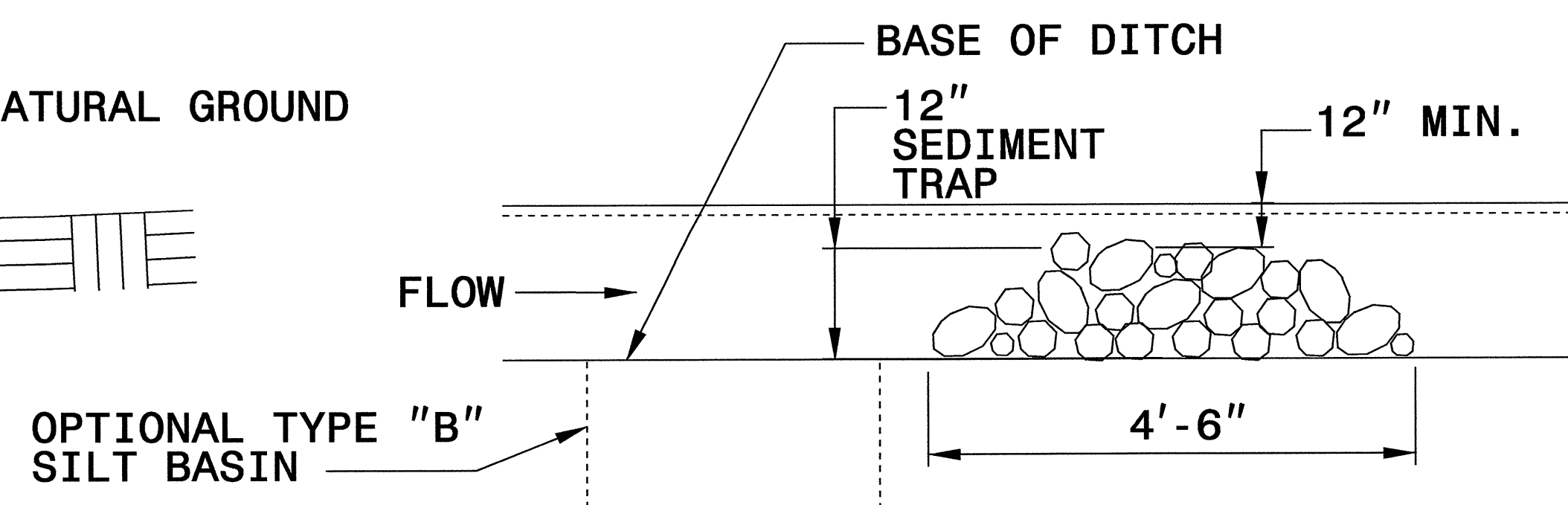

**ELEVATION VIEW**

PROJECT REFERENCE NO. B-4130	SHEET NO. EC-2A
RW SHEET NO.	
ROADWAY DESIGN ENGINEER	HYDRAULICS ENGINEER

# COIR FIBER BAFFLE DETAIL

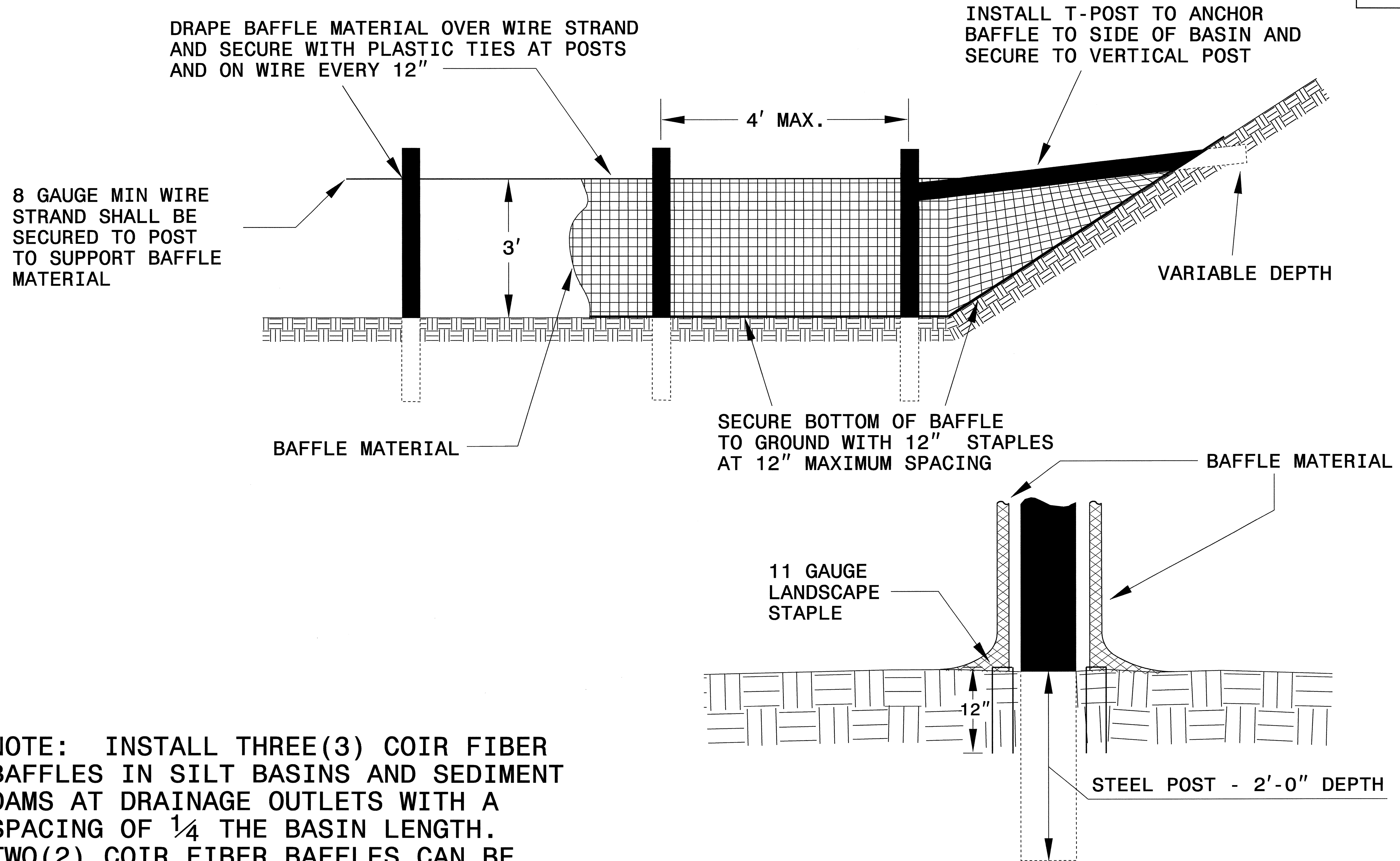

NOTE: INSTALL THREE(3) COIR FIBER BAFFLES IN SILT BASINS AND SEDIMENT DAMS AT DRAINAGE OUTLETS WITH A SPACING OF  $\frac{1}{4}$  THE BASIN LENGTH. TWO(2) COIR FIBER BAFFLES CAN BE INSTALLED IN SILT BASINS AND DAMS LESS THAN 20 FT. IN LENGTH WITH A SPACING OF  $\frac{1}{3}$  THE BASIN LENGTH.

BAFFLE MATERIAL SHALL BE SECURED TO THE BOTTOM AND SIDES OF BASIN USING 12" LANDSCAPE STAPLES





PROJECT REFERENCE NO.	SHEET NO.
B-4130	EC-4/CONST.4
RW SHEET NO.	
ROADWAY DESIGN ENGINEER	HYDRAULICS ENGINEER

CLEARING AND GRUBBING  
EROSION CONTROL FOR  
CONSTRUCTION SHEET 4

NOTE:  
PLACE TEMPORARY ROCK SEDIMENT DAMS - B  
AND TEMPORARY ROCK SILT CHECKS TYPE - A AT  
DRAINAGE OUTLETS.

NOTE:  
UTILIZE SPECIAL STILLING BASIN  
WHERE APPLICABLE.

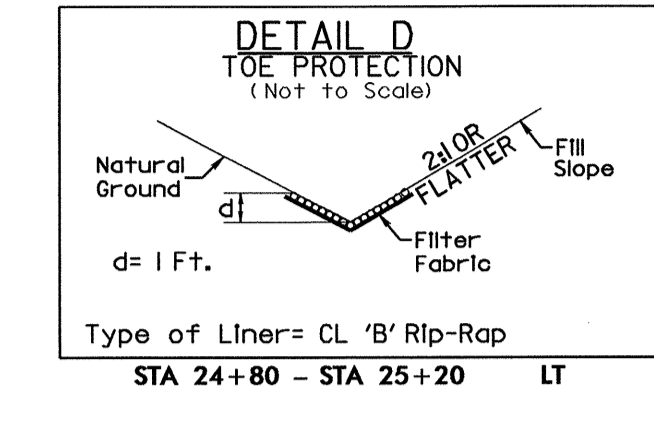
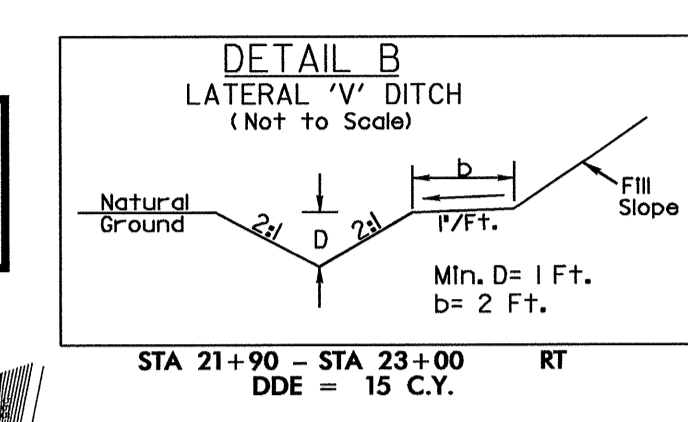
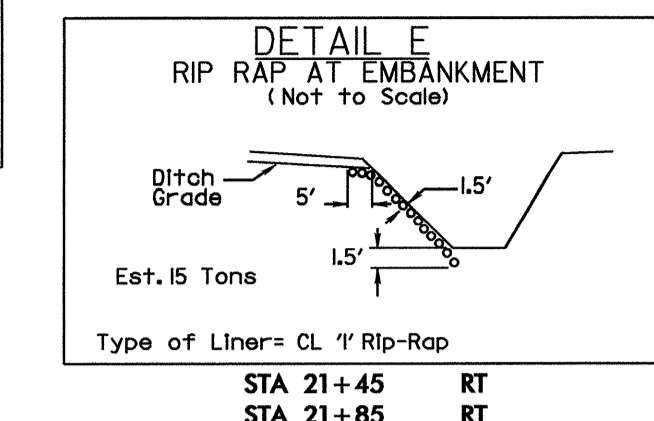
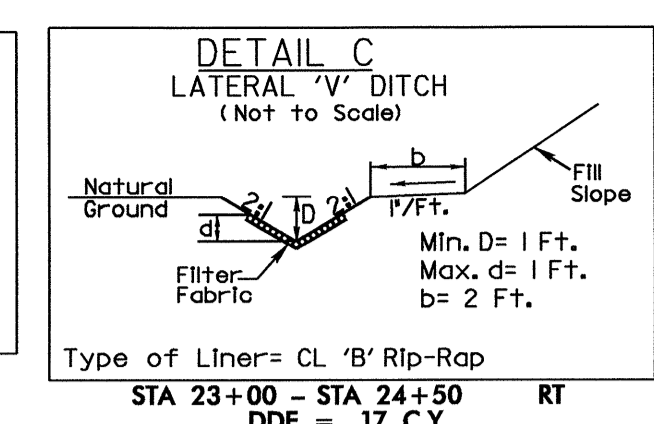
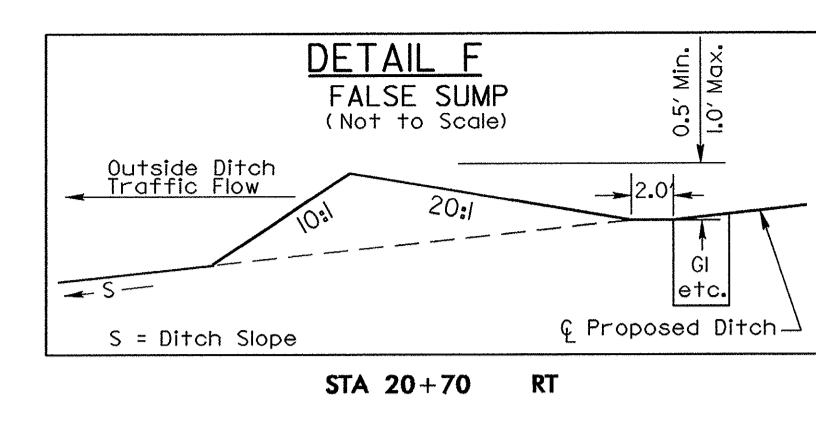

BEGIN PROJECT B-4130  
-L- POT STA. 16+70.00

33 x 15 x 3  
5' weir  
ID 4.2B

30 x 14 x 3  
5' weir  
ID 4.5B

34 x 17 x 3  
6' weir  
ID 4.6B

END PROJECT B-4130  
-L- POC STA. 27+00.00

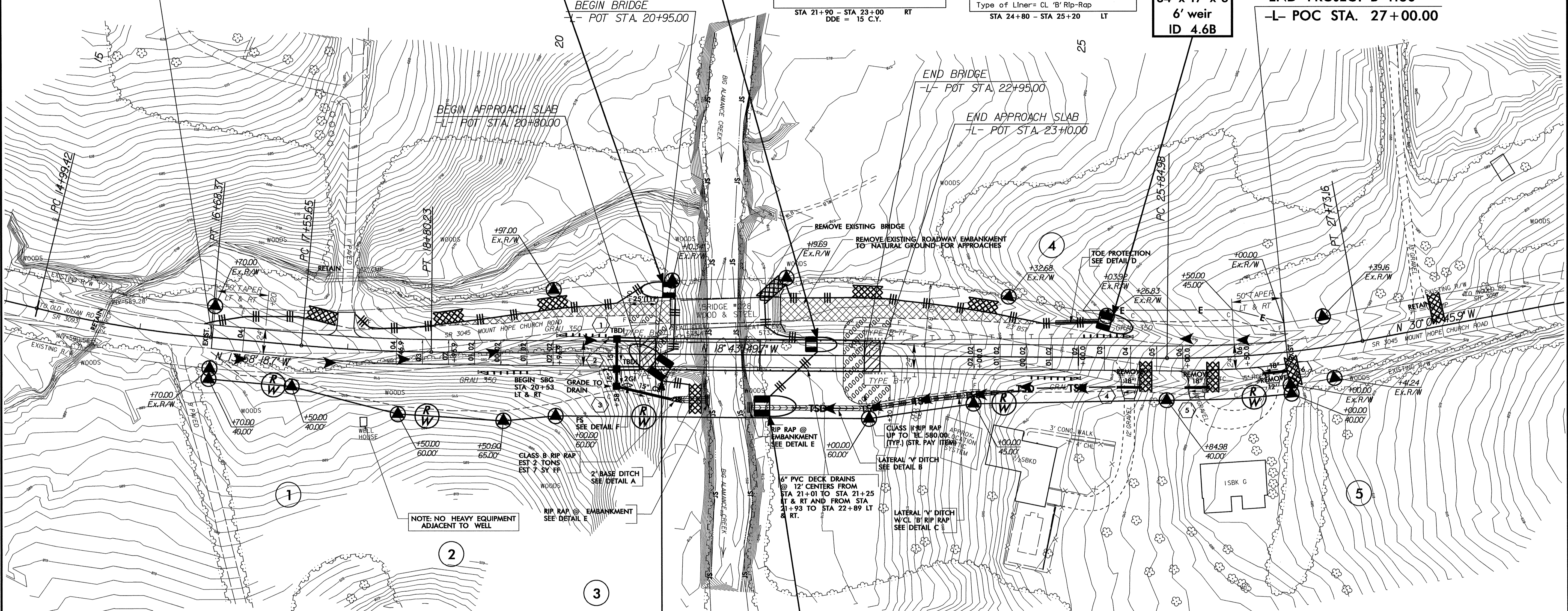

PI Sta 15+84.05  
Δ = 8' 27' 16.2" (LT)  
D = 5' 00' 14.4"  
L = 168.95'  
T = 84.63'  
R = 1,445.00'  
SE = 0.04  
DS = 50 mph

PI Sta 18+77.97  
Δ = 4' 45' 31.0" (LT)  
D = 3' 49' 11.0"  
L = 124.58'  
T = 62.33'  
R = 1,500.00'  
SE = 0.04  
DS = 50 mph

44 x 21 x 3  
7' weir  
ID 4.1C

40 x 20 x 3  
7' weir  
ID 4.4B

NOTE: USE 10' RADII AND 16' WIDTH  
ON DRIVES UNLESS SHOWN OTHERWISE.

LEGEND	
	PAVEMENT REMOVAL
	APPROACH SLAB

FOR -L- PROFILE, SEE SHEET NO. 5

26-OCT-2007 10:20 gr:\tippr-o\ec\ss-b\4130\environmental\design\b4130\_rdy\_psh\_04.dgn



PROJECT REFERENCE NO.	SHEET NO.
B-4130	EC-5/CONST.4
RW SHEET NO.	
ROADWAY DESIGN ENGINEER	HYDRAULICS ENGINEER

NOTE: UTILIZE SPECIAL STILLING BASIN WHERE APPLICABLE.

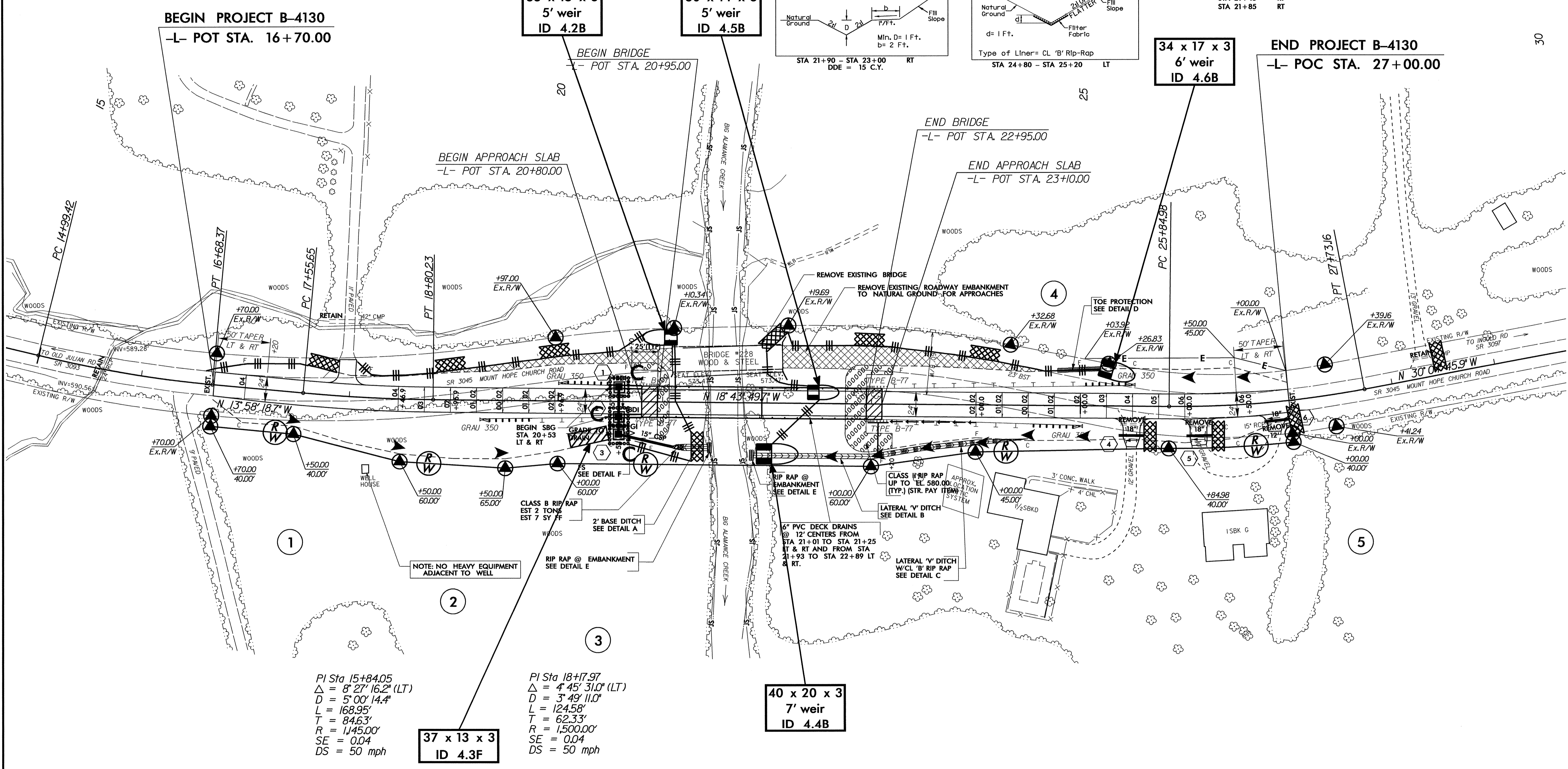
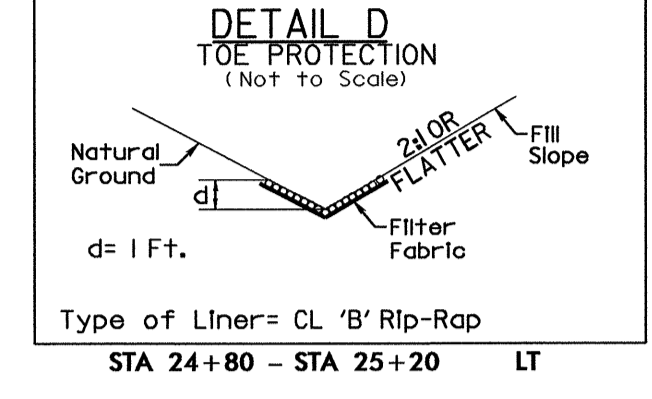
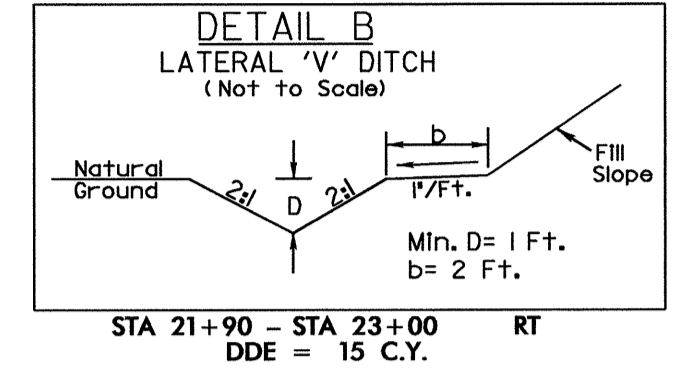
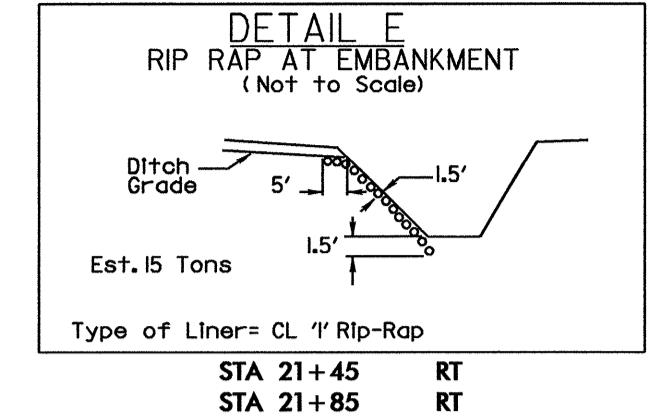
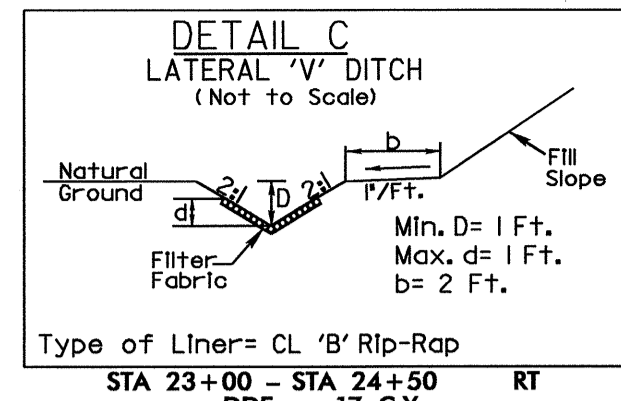
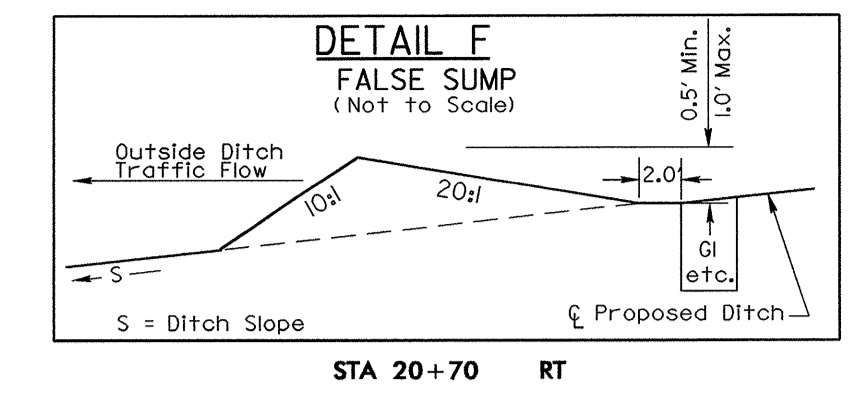

PI Sta 15+84.05  
 $\Delta = 8' 27'' 16.2''$  (LT)  
 $D = 5' 00'' 14.4''$   
 $L = 168.95'$   
 $T = 84.63'$   
 $R = 1,145.00'$   
 $SE = 0.04$   
 $DS = 50$  mph

PI Sta 18+17.97  
 $\Delta = 4' 45'' 31.0''$  (LT)  
 $D = 3' 49'' 11.0''$   
 $L = 124.58'$   
 $T = 62.33'$   
 $R = 1,500.00'$   
 $SE = 0.04$   
 $DS = 50$  mph

NOTE: USE 10' RADII AND 16' WIDTH ON DRIVES UNLESS SHOWN OTHERWISE.

**LEGEND**

	PAVEMENT REMOVAL
	APPROACH SLAB

FOR -L- PROFILE, SEE SHEET NO. 5

8/17/99  
 26-OCT-2007 10:19  
 g:\tippro\ec\B-4130\environmental\design\B4130\_rdy\_psh\_04.dgn  
 B4130 AT REN\231812