



STATE OF NORTH CAROLINA
DEPARTMENT OF TRANSPORTATION

SIGNING PLANS
FORSYTH COUNTY



LOCATION: WINSTON-SALEM SR 1103 (LEWISVILLE-CLEMMONS RD.) FROM SR 1891 (PEACE HAVEN RD.) TO SR 3580 (FOREST OAKS DR.)

T.I.P.: U-3119A

CONTRACT: C201684

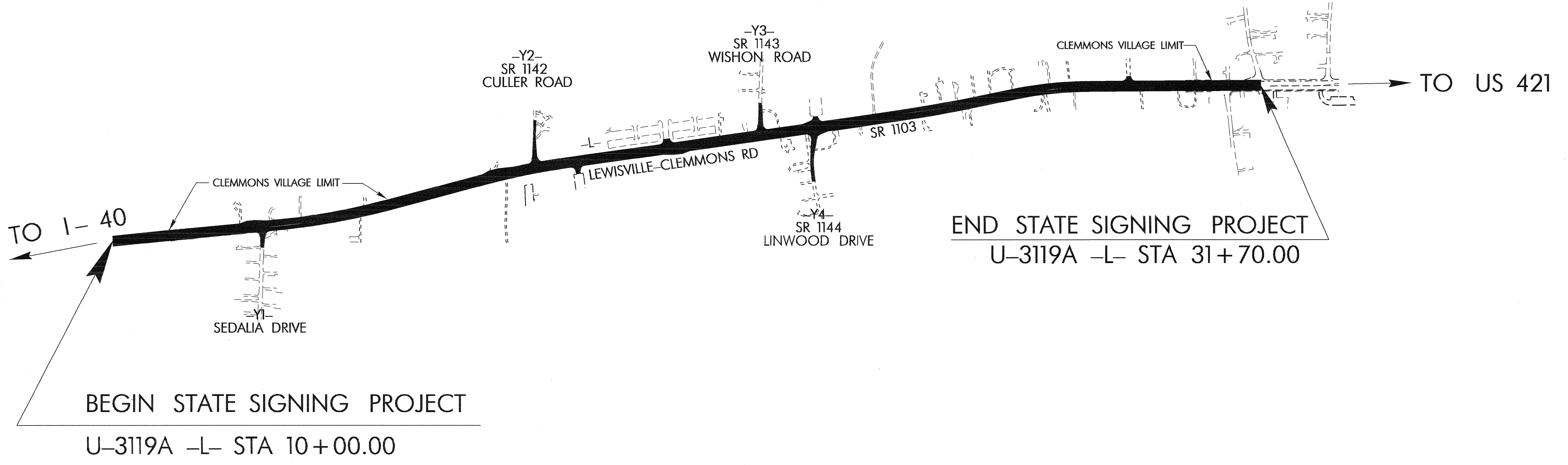

INDEX

SHEET NO.	DESCRIPTION
1	TITLE SHEET
2	SUMMARY OF QUANTITIES and NOTES
3	E SHEETS
4-10	SIGN ROADWAY SHEETS

PLAN PREPARED BY: N.C.D.O.T. SIGNING SECTION	SEAL
RON KING, P.E. SIGNING ENGINEER	
AYMAN ALQUDWAH, P.E. SIGNING PROJECT ENGINEER	
KELVIN JORDAN SIGNING PROJECT DESIGN ENGINEER	
STACEY JOHNS SIGNING DESIGNER	



TIP NO. U-3119A	SHEET NO. SIGN-2
APPROVED: <i>Sydney R. Lyndahl</i>	
DATE: 9/27/07	
SEAL	

ITEM NO.		ITEM DESCRIPTION	QUANTITY	UNIT
DESC. NO.	SECT. NO.			
4025000000	901	CONTRACTOR FURNISHED, TYPE E SIGN	22	S.M.
4072000000	903	SUPPORTS, 4.5-KG STEEL U-CHANNEL	208	L.M.
4102000000	904	SIGN ERECTION, TYPE E	44	EA.
4116100000	906	SIGN ERECTION, RELOCATE, TYPE E	1	EA.
4155000000	907	DISPOSAL OF SIGN SYSTEM, U-CHANNEL	20	EA.
4158000000	907	DISPOSAL OF SIGN SYSTEM, WOOD	1	EA.

General Notes:

- . SIGNS FURNISHED BY CONTRACTOR
- . IF REMOVAL OR RELOCATION OF SIGNS ON PRIVATE STREET (NON-STATE MAINTAINED) IS REQUIRED DUE TO CONSTRUCTION, THE CONTRACTOR SHALL INFORM THE ENGINEER. THE WORK WILL BE COMPLETED BY OTHERS.
- . SIGNING PLANS DO NOT INCLUDE TEMPORARY CONSTRUCTION SIGNING OR PAVEMENT MARKINGS. SEE TRAFFIC CONTROL PLANS.
- . WHEN NOT STATIONED OR DIMENSIONED ON PLANS, ALL 'E' AND 'F' SIGNS SHALL BE FIELD LOCATED BY THE ENGINEER
- . ALL EXISTING SIGNS ON "U" CHANNEL POST WITHIN THE PROJECT LIMITS SHALL BE REMOVED AND DISPOSED OF UNLESS OTHERWISE NOTED ON PLANS.
- . WHEN EXISTING SIGNS ARE REMOVED AND INSTALLED ON NEW SUPPORTS, THE RE-ERECTION SHALL IMMEDIATELY FOLLOW THE REMOVAL.
- . THE BACKGROUND FOR TYPE E & F SIGNS SHALL BE TYPE III REFLECTIVE SHEETING.

Pay Item Notes:

- | | |
|---|------------------------------------|
| 1 | DISPOSAL OF SIGN SYSTEM, U-CHANNEL |
| 2 | DISPOSAL OF SIGN SYSTEM, WOOD |
| 3 | RELOCATE, SIGN E |

Project Notes:

- | | |
|---|--|
| A | SCHOOL FLASHER & SIGNS TO BE RELOCATED BY DIVISION FORCES. |
|---|--|

ROADWAY STANDARD DRAWINGS
APPLICABLE TO THESE SIGNING PLANS

904 . 50

**SUMMARY OF QUANTITIES
AND NOTES**

27-SEP-2007 14:45
M:\TIPProje\11-11-07\11-11-07\Traffic\Signing\CADD\Signing Layout Plans\Signing\Title.dgn



TIP NO. U-3119A	SHEET NO. SIGN-5
APPROVED: <i>[Signature]</i>	
DATE: 9/26/07	
SEAL	

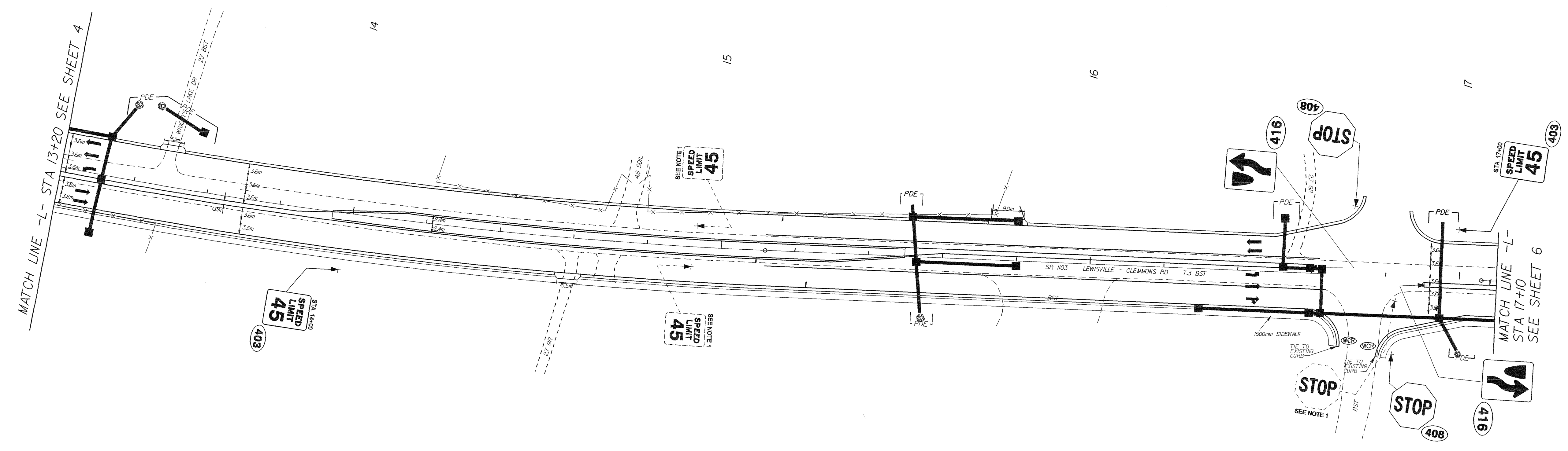
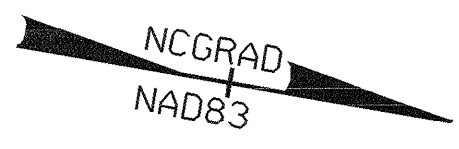

PROPOSED & EXISTING SIGNS
 STA. 13+20 TO STA. 16+80
 SR 1103 (LEWISVILLE-CLEMMONS RD.)

 SYSTEMS
 CONSULTANTS
 INC.
 1100 W. HARRIS ST.
 RALEIGH, NC 27601
 919.876.1100



TIP NO. U-3119A	SHEET NO. SIGN-6
APPROVED: <i>[Signature]</i>	
DATE: 9/26/07	
SEAL	



NCGRID
NAD83

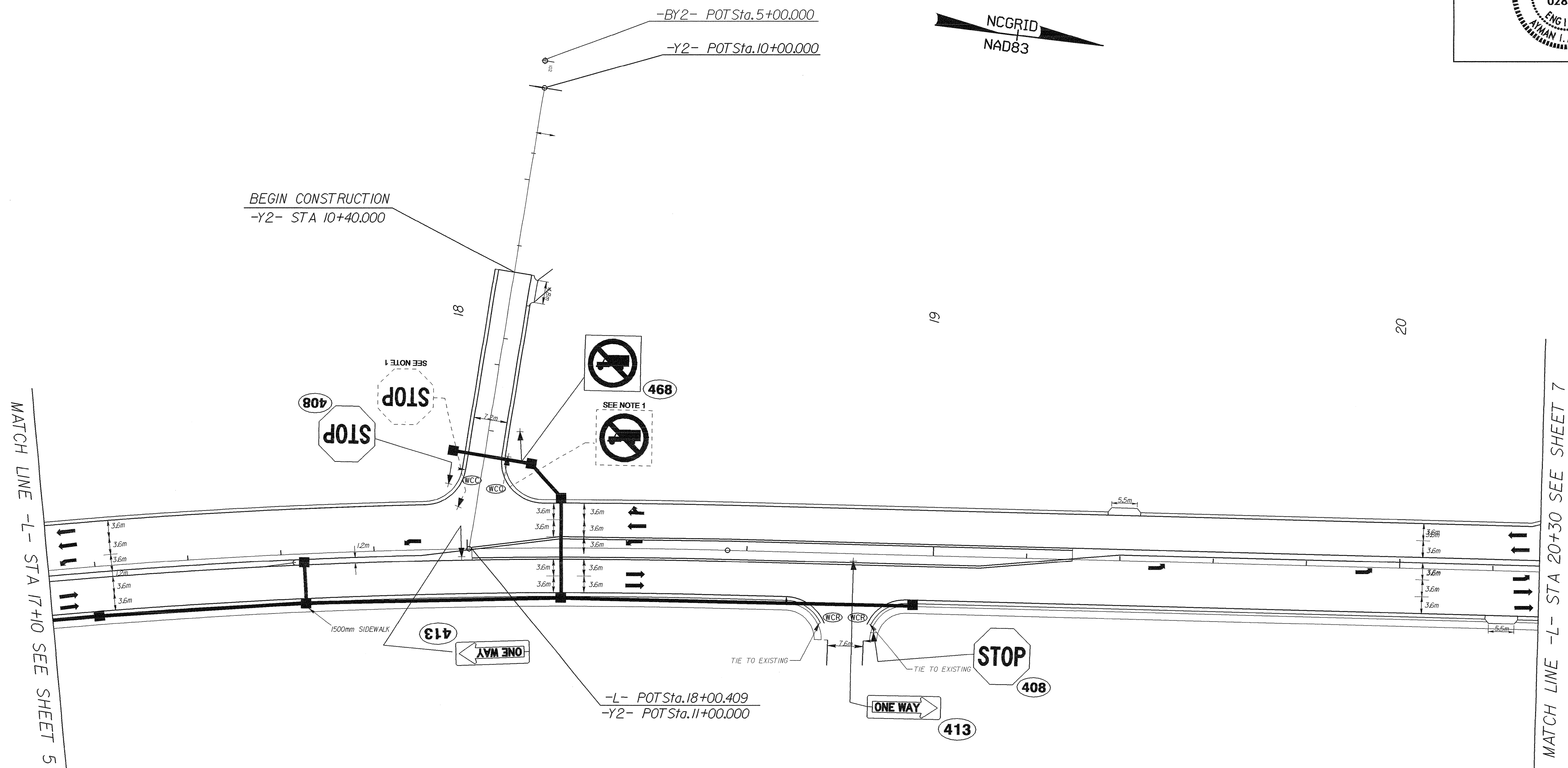

PROPOSED & EXISTING SIGNS
STA. 16+80 TO STA. 20+40
SR 1103 (LEWISVILLE-CLEMMONS RD.)

*****SYSTEMTIME*****
*****20070926140000*****
*****C:\P1\PROJECTS\U-3119A\SIGN-6.DWG*****
*****PLT:SIGN-6.DWG*****
*****PLOTTER:HPGL*****



TIP NO. U-3119A	SHEET NO. SIGN-7
APPROVED: <i>[Signature]</i>	
DATE: 9/26/07	
SEAL	

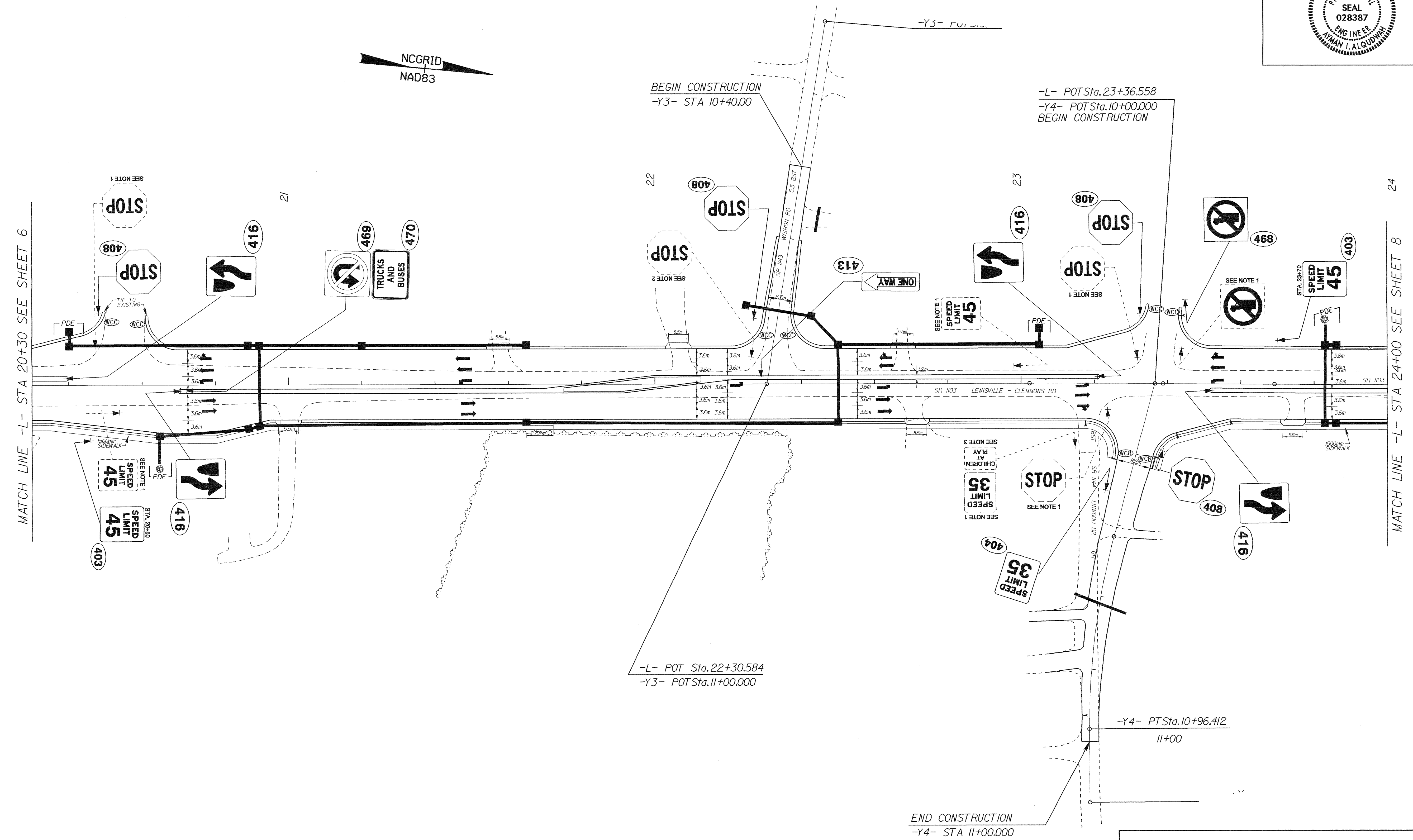
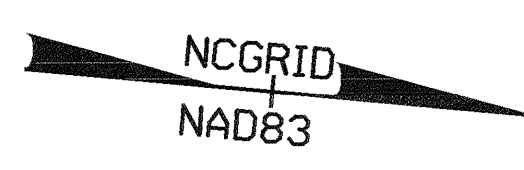

MATCH LINE -L- STA 20+30 SEE SHEET 6

MATCH LINE -L- STA 24+00 SEE SHEET 8

BEGIN CONSTRUCTION
-Y3- STA 10+40.00

-L- POT Sta. 23+36.558
-Y4- POT Sta. 10+00.000
BEGIN CONSTRUCTION

-L- POT Sta. 22+30.584
-Y3- POT Sta. 11+00.000

END CONSTRUCTION
-Y4- STA 11+00.000

**PROPOSED & EXISTING SIGNS
STA. 20+40 TO STA. 24+00
SR 1103 (LEWISVILLE-CLEMMONS RD.)**

SYSTEMS



TIP NO. U-3119A SHEET NO. SIGN-9
 APPROVED: *[Signature]*
 DATE: 9/26/07

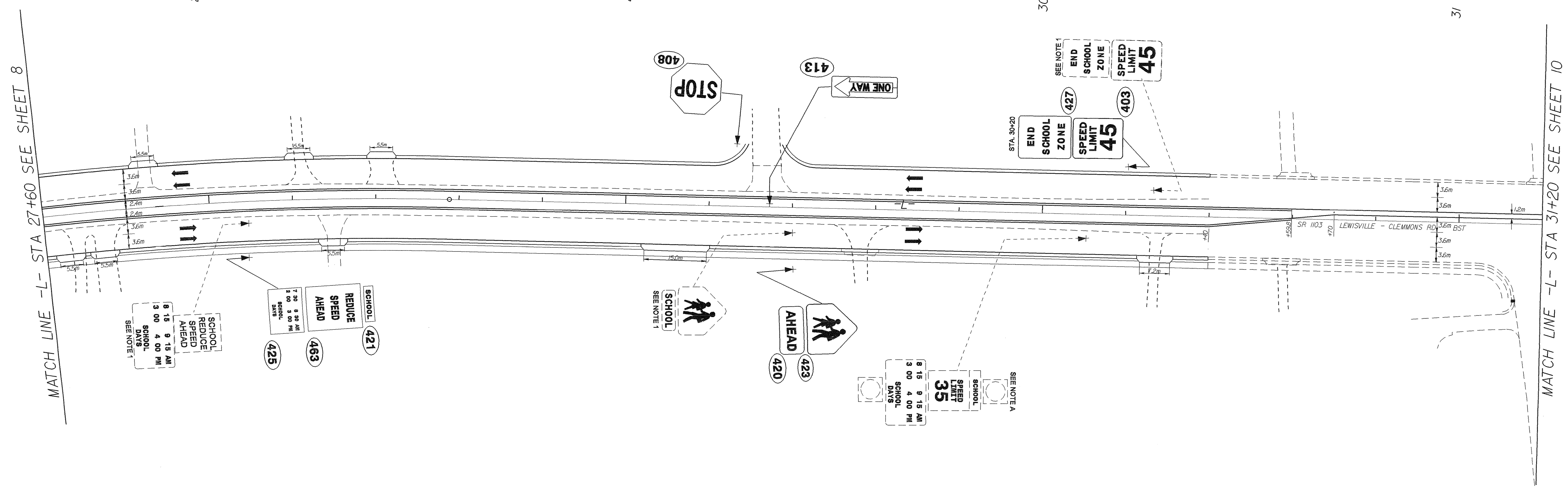
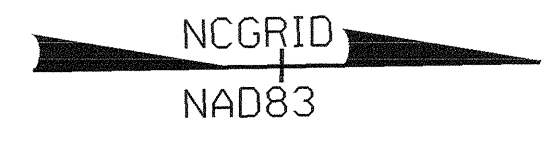

 SYSTEMS

PROPOSED & EXISTING SIGNS
 STA. 27+60 TO STA. 31+20
 SR 1103 (LEWISVILLE-CLEMMONS RD.)



TIP NO. U-3119A	SHEET NO. SIGN-10
APPROVED: <i>[Signature]</i>	
DATE: 9/26/07	

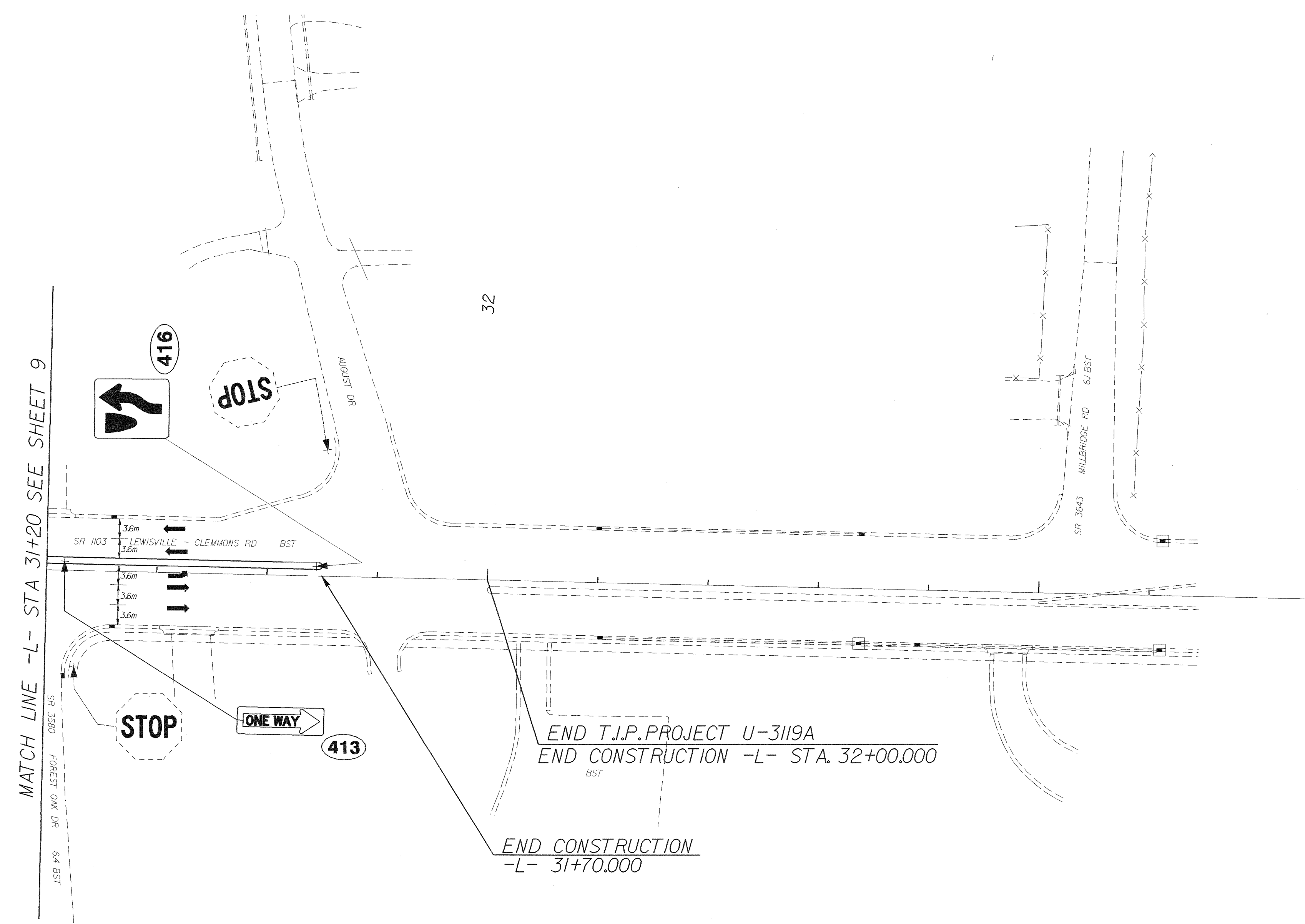
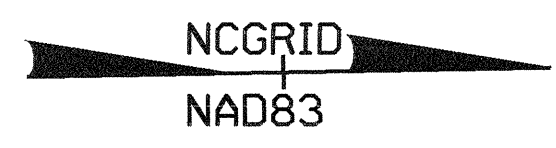
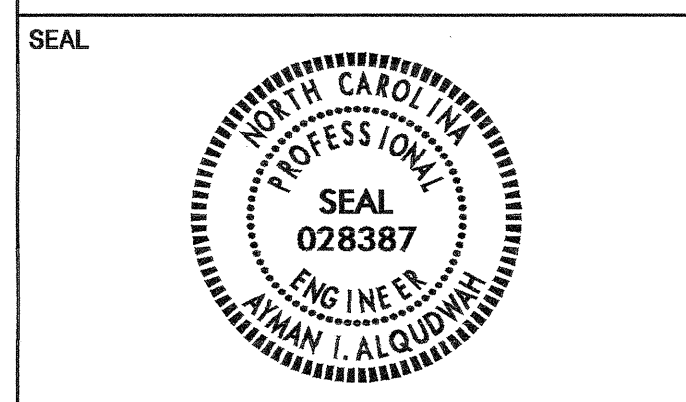

26-SEP-2007 10:19:10 AM C:\Users\j11111111\My Documents\Projects\Traffic\Signing\CADD\Signing Layout Plans\Signing\3119\10.pat
 26-SEP-2007 10:19:10 AM C:\Users\j11111111\My Documents\Projects\Traffic\Signing\CADD\Signing Layout Plans\Signing\3119\10.pat

PROPOSED & EXISTING SIGNS
STA. 31+20 TO STA. 31+70
SR 1103 (LEWISVILLE-CLEMMONS RD.)