

STATE OF NORTH CAROLINA
DIVISION OF HIGHWAYS

| | |
|-----------------------------|-----------|
| STATE PROJECT REFERENCE NO. | SHEET NO. |
| B-4112 | TCP-1 |

**PLAN FOR PROPOSED
TRAFFIC CONTROL, MARKING & DELINEATION**

FORSYTH COUNTY

B-4112

ROADWAY STANDARD DRAWINGS

THE FOLLOWING ROADWAY STANDARDS AS APPEAR IN "ROADWAY STANDARD DRAWINGS"-
ROADWAY DESIGN UNIT-N.C. DEPARTMENT OF TRANSPORTATION-RALEIGH, N.C.,
DATED JANUARY 2002 ARE APPLICABLE TO THIS PROJECT AND BY REFERENCE HEREBY ARE
CONSIDERED A PART OF THESE PLANS:

| STD. NO. | TITLE |
|----------|---|
| 1101.03 | TEMPORARY ROAD CLOSURES |
| 1101.05 | WORK ZONE VEHICLE ACCESSES |
| 1101.11 | TRAFFIC CONTROL DESIGN TABLES |
| 1110.01 | STATIONARY WORK ZONE SIGNS |
| 1145.01 | BARRICADES |
| 1205.01 | PAVEMENT MARKINGS - LINE TYPES & OFFSETS |
| 1205.02 | PAVEMENT MARKINGS - 2 LANE & MULTILANE ROADWAYS |
| 1205.12 | PAVEMENT MARKINGS - BRIDGES |
| 1250.01 | PAVEMENT MARKER SPACING |
| 1253.01 | SNOWPLOWABLE RAISED PAVEMENT MARKERS |
| 1261.01 | GUARDRAIL & BARRIER DELINEATOR SPACING |
| 1261.02 | GUARDRAIL & BARRIER DELINEATOR TYPES |
| 1262.01 | GUARDRAIL END DELINEATION |
| 1264.01 | OBJECT MARKERS |
| 1264.02 | PLACEMENT OF OBJECT MARKERS |

INDEX OF SHEETS

| SHEET NO. | TITLE |
|-----------|--|
| TCP-1 | LIST OF APPLICABLE ROADWAY STANDARD DRAWINGS, LEGEND, PROJECT NOTES, PHASINGS, AND INDEX OF SHEETS |
| TCP-2 | OFFSITE DETOUR AND SPECIAL SIGN DESIGN |

LEGEND

GENERAL

← NORTH ARROW

TRAFFIC CONTROL DEVICES

▬ TYPE III BARRICADE

⊥ STATIONARY SIGN

PHASING

STEP 1)
INSTALL ALL OFFSITE DETOUR SIGNING. IF ROAD IS NOT CLOSED WITHIN ONE
(1) WEEK OF SIGN INSTALLATION, COVER OR REMOVE ALL SIGNS AT NO COST TO
THE DEPARTMENT (SEE TCP-2 FOR SIGN LOCATIONS).

STEP 2)
USING ROADWAY STANDARD DRAWING 1101.03, SHEET 1 OF 9 AND TCP-2, DETOUR
TRAFFIC OFFSITE (SEE TCP-2 FOR OFFSITE DETOUR), CLOSE SR 1631 (MIZPAH
CHURCH RD), AND CONSTRUCT -L- UP TO AND INCLUDING THE FINAL LIFT OF
SURFACE COURSE, FINAL PAVEMENT MARKINGS, AND FINAL PAVEMENT MARKERS
(MAINTAIN DRIVEWAYS AS NEEDED WITH INCIDENTAL STONE).

STEP 3)
OPEN SR 1631 TO THE FINAL TRAFFIC PATTERN AND REMOVE ALL DETOUR
SIGNING.

PROJECT NOTES

CHANGES MAY BE REQUIRED WHEN PHYSICAL DIMENSIONS IN THE DETAIL
DRAWINGS, STANDARD DETAILS AND ROADWAY DETAILS ARE NOT ATTAINABLE
TO MEET FIELD CONDITIONS, OR RESULT IN DUPLICATE, OR UNDESIRE
OVERLAPPING OF DEVICES. MODIFICATION MAY INCLUDE: MOVING,
SUPPLEMENTING, COVERING OR REMOVAL OF DEVICES, AS DIRECTED BY THE
ENGINEER.

THE FOLLOWING GENERAL NOTES APPLY AT ALL TIMES FOR THE DURATION OF
THE CONSTRUCTION PROJECT, EXCEPT WHEN OTHERWISE NOTED IN THE PLAN,
OR DIRECTED BY THE ENGINEER.

TRAFFIC PATTERN ALTERATIONS

A) NOTIFY THE ENGINEER TWENTY ONE (21) CALENDAR DAYS PRIOR TO ANY
TRAFFIC PATTERN ALTERATION.

SIGNING

- B) PROVIDE PERMANENT SIGNING.
- C) PROVIDE DETOUR SIGNING OFF THE PROJECT LIMITS.
- D) COVER OR REMOVE ALL DETOUR SIGNS OFF THE PROJECT LIMITS WHEN A
DETOUR IS NOT IN OPERATION.
- E) ENSURE ALL NECESSARY SIGNING IS IN PLACE PRIOR TO ALTERING ANY
TRAFFIC PATTERN.

TRAFFIC CONTROL DEVICES

F) PLACE TYPE III BARRICADES, WITH "ROAD CLOSED" SIGN R11-2 ATTACHED,
OF SUFFICIENT LENGTH TO CLOSE ENTIRE ROADWAY. STAGGER OR OVERLAP
BARRICADES TO ALLOW FOR INGRESS OR EGRESS.

PAVEMENT MARKINGS AND MARKERS

G) INSTALL PAVEMENT MARKINGS AND PAVEMENT MARKERS ON THE FINAL
SURFACE AS FOLLOWS:

| ROAD NAME | MARKING | MARKER |
|-------------------------------|----------|--------------|
| 1. SR 1631 (MIZPAH CHURCH RD) | POLYUREA | SNOWPLOWABLE |

H) TIE PROPOSED PAVEMENT MARKING LINES TO EXISTING PAVEMENT MARKING
LINES.

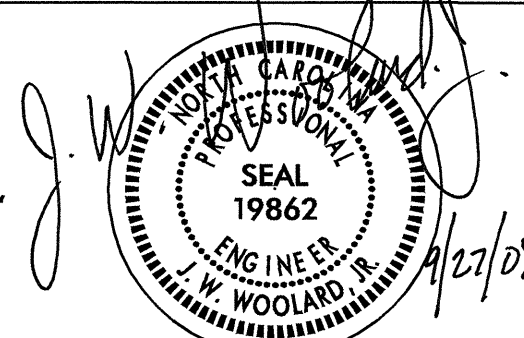
| | |
|--|---|
| APPROVED: _____ DATE: _____ | PLAN PREPARED BY: N.C.D.O.T. WORK ZONE TRAFFIC CONTROL UNIT |
| SEAL  | J. S. BOURNE, P. E. TRAFFIC CONTROL ENGINEER |
| | G. L. GETTIER, P. E. TRAFFIC CONTROL PROJECT ENGINEER |
| | J. W. WOOLARD, P. E. TRAFFIC CONTROL PROJECT DESIGN ENGINEER |
| | D. A. HAYES, E. I. TRAFFIC CONTROL DESIGN ENGINEER / TECHNICIAN |

TIP PROJECT:

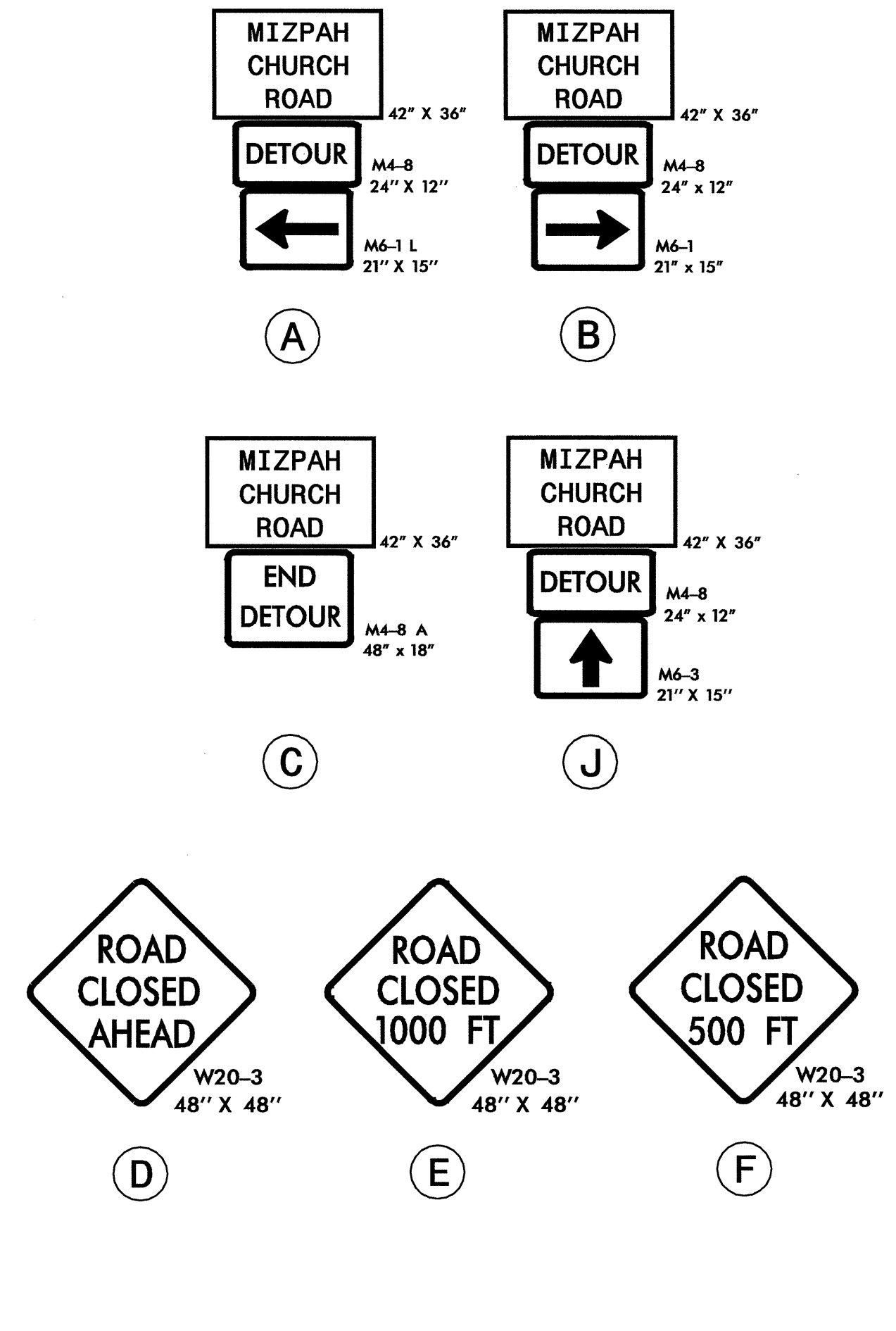
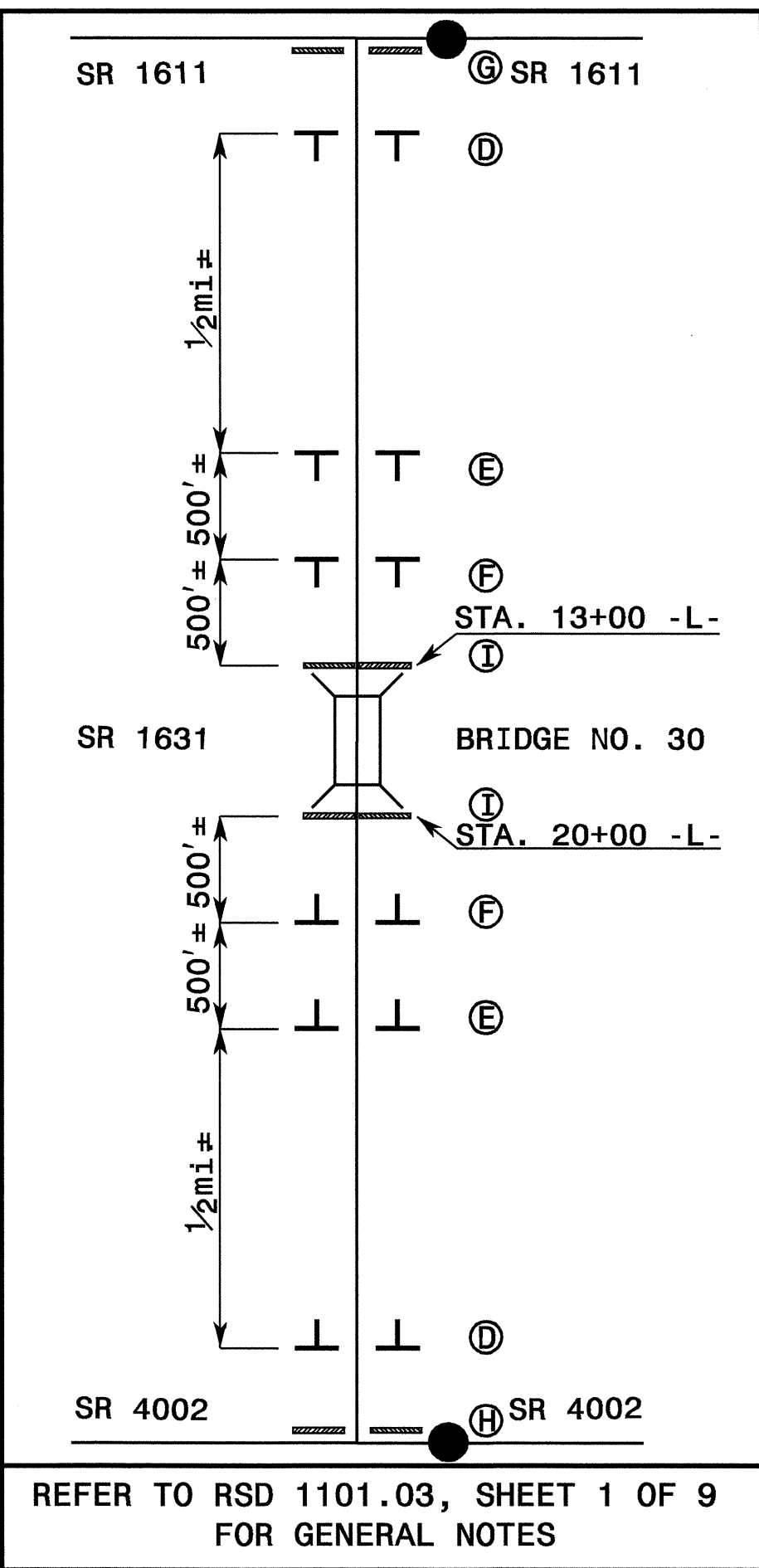
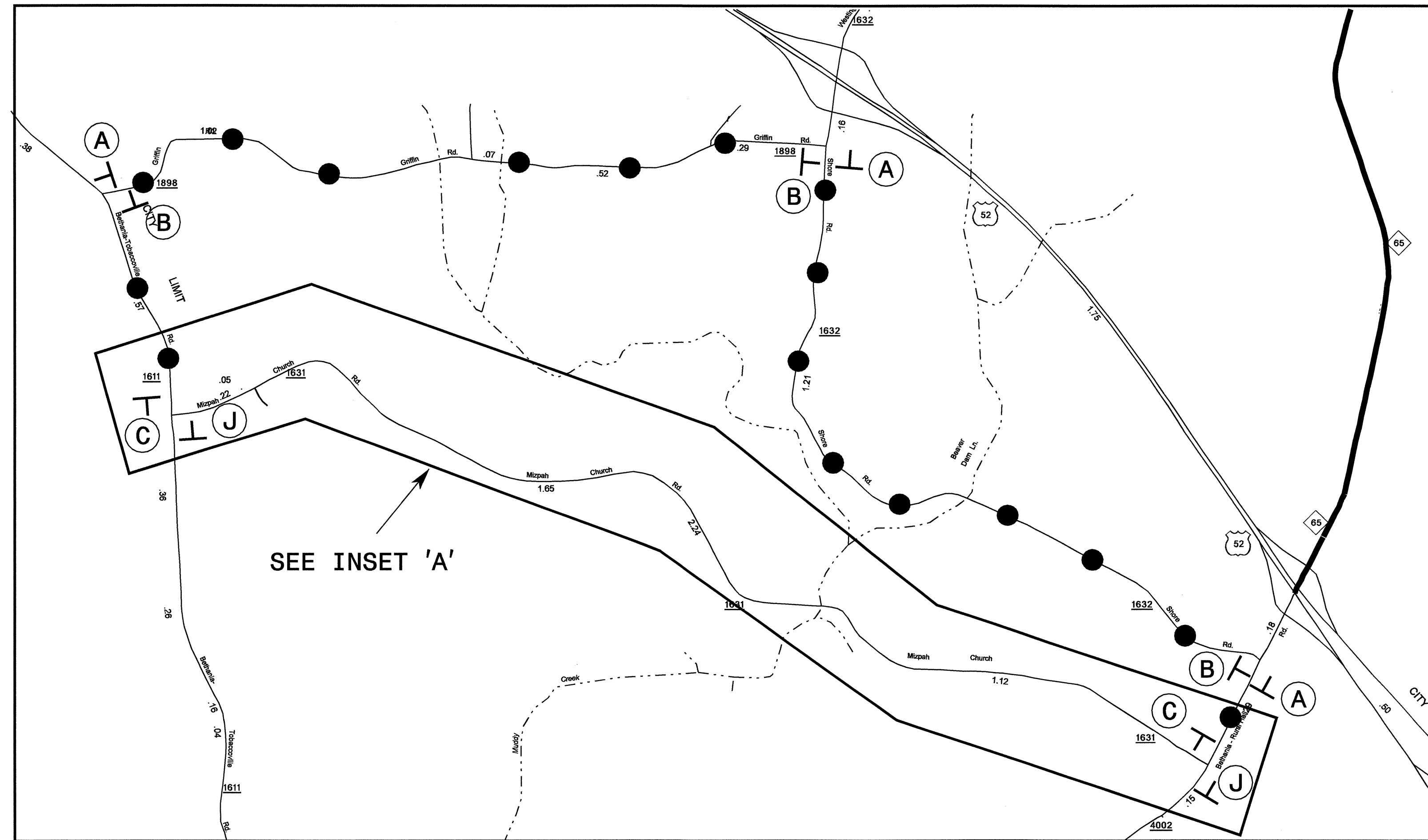

INSET 'A'

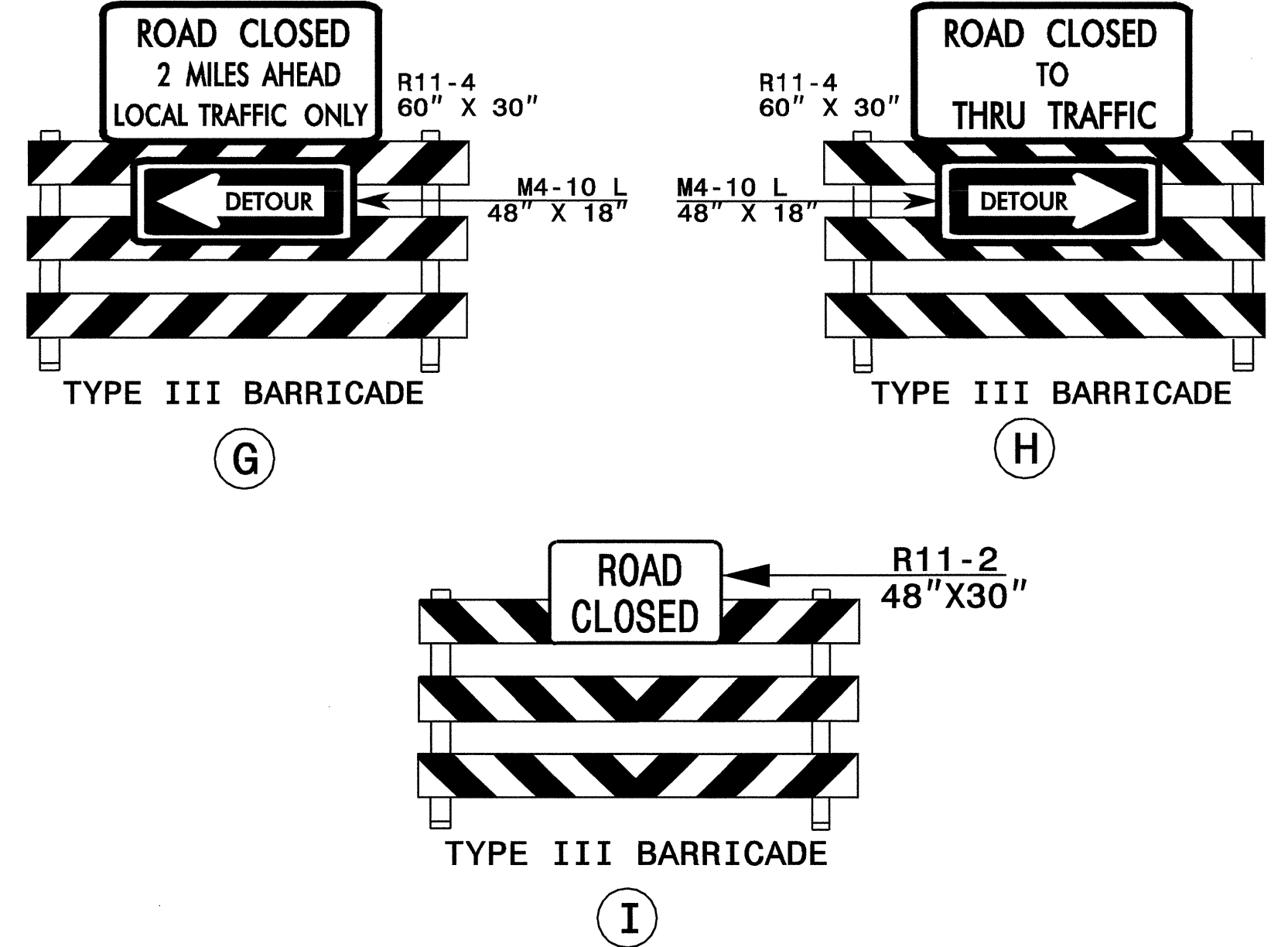

| Sign Number: Type: D Ground Quantity: 1 | Design By: KLJ Project ID: B-4112 | Check By: DIV: 9 | STD #: N/A Date: Dec 12, 2005 | | | | | | | | | | | | | | | | | | | | | | | | | | | | | | | | | | | | |
|--|--|---|----------------------------------|-----|-----|------|---|-------------|---|---|--|-------------|--|-----|-----|-----|-----|-----|-----|---|-----|--|-----|-----|-----|-----|-----|-----|---|-----|--|------|-----|-----|-----|---|------|--|------|
| Sign Width: 3'-6" Height: 3'-0" Total Area: 10.5 Sq.Ft. | Background Color: Fluorescent Orange Legend & Border Color: Black | <div style="text-align: center;"> </div> | | | | | | | | | | | | | | | | | | | | | | | | | | | | | | | | | | | | | |
| Border Type: Recessed Recess: 0.47" Width: 0.63" Radii: 1.5" | Backing Material: 0.125 in. Aluminum 0.079 in. Composite | NOTES: 1. Legend and border shall be direct applied non-reflective sheeting. 2. Background shall be Type VII, VIII, or IX (prismatic) retroreflective sheeting. | | | | | | | | | | | | | | | | | | | | | | | | | | | | | | | | | | | | | |
| Letter spacings are to start of next letter | | | | | | | | | | | | | | | | | | | | | | | | | | | | | | | | | | | | | | | |
| <table border="1" style="width: 100%; border-collapse: collapse; text-align: center;"> <thead> <tr> <th></th> <th>M</th> <th>I</th> <th>Z</th> <th>P</th> <th>A</th> <th>H</th> <th></th> <th>Series/Size</th> </tr> </thead> <tbody> <tr> <td></td> <td>6.5</td> <td>6.1</td> <td>2.4</td> <td>5.2</td> <td>5.2</td> <td>6.1</td> <td>4</td> <td>6.5</td> </tr> <tr> <td></td> <td>5.8</td> <td>5.2</td> <td>5.5</td> <td>5.5</td> <td>5.2</td> <td>5.2</td> <td>4</td> <td>5.8</td> </tr> <tr> <td></td> <td>10.7</td> <td>5.2</td> <td>5.4</td> <td>6.1</td> <td>4</td> <td>10.7</td> <td></td> <td>20.7</td> </tr> </tbody> </table> | | | | | M | I | Z | P | A | H | | Series/Size | | 6.5 | 6.1 | 2.4 | 5.2 | 5.2 | 6.1 | 4 | 6.5 | | 5.8 | 5.2 | 5.5 | 5.5 | 5.2 | 5.2 | 4 | 5.8 | | 10.7 | 5.2 | 5.4 | 6.1 | 4 | 10.7 | | 20.7 |
| | M | I | Z | P | A | H | | Series/Size | | | | | | | | | | | | | | | | | | | | | | | | | | | | | | | |
| | 6.5 | 6.1 | 2.4 | 5.2 | 5.2 | 6.1 | 4 | 6.5 | | | | | | | | | | | | | | | | | | | | | | | | | | | | | | | |
| | 5.8 | 5.2 | 5.5 | 5.5 | 5.2 | 5.2 | 4 | 5.8 | | | | | | | | | | | | | | | | | | | | | | | | | | | | | | | |
| | 10.7 | 5.2 | 5.4 | 6.1 | 4 | 10.7 | | 20.7 | | | | | | | | | | | | | | | | | | | | | | | | | | | | | | | |
| Spacing Factor is 1 unless specified otherwise FILENAME: G840_ENGL | | | | | | | | | | | | | | | | | | | | | | | | | | | | | | | | | | | | | | | |

| | | | | | | | | | | | | | | |
|--|---|--|--|--|--|--|--|--|--|--|--|--|--|--|
| APPROVED: _____ DATE: _____ | OFFSITE DETOUR AND SPECIAL SIGN DESIGN | REVISIONS <table border="1" style="width: 100%; border-collapse: collapse;"> <tr> <td style="width: 5%;"> </td> <td style="width: 15%;"> </td> <td style="width: 15%;"> </td> <td style="width: 15%;"> </td> <td style="width: 15%;"> </td> <td style="width: 15%;"> </td> </tr> <tr> <td> </td> <td> </td> <td> </td> <td> </td> <td> </td> <td> </td> </tr> </table> | | | | | | | | | | | | |
| | | | | | | | | | | | | | | |
| | | | | | | | | | | | | | | |
| SCALE: NONE DATE: 12/05 DWG. BY: DAH DESIGN BY: DAH REVIEWED BY: JWW | | CADD FILE: _____ | | | | | | | | | | | | |

26-SEP-2007 15:41 \\dot\dfsroot\proj\TIP\Projects-B\B4112\Traffic\TrafficControl\top\B-4112-TC-TCP-02.dgn AT: WZTC224241