

STATE OF NORTH CAROLINA
DIVISION OF HIGHWAYS

UTILITY CONSTRUCTION PLANS
DAVIDSON COUNTY

**LOCATION: BRIDGE 141 OVER SPURGEON CREEK ON
SR 1741 (WALBURG-HIGH POINT RD.) IN
THOMASVILLE**
TYPE OF WORK: UTILITY CONSTRUCTION

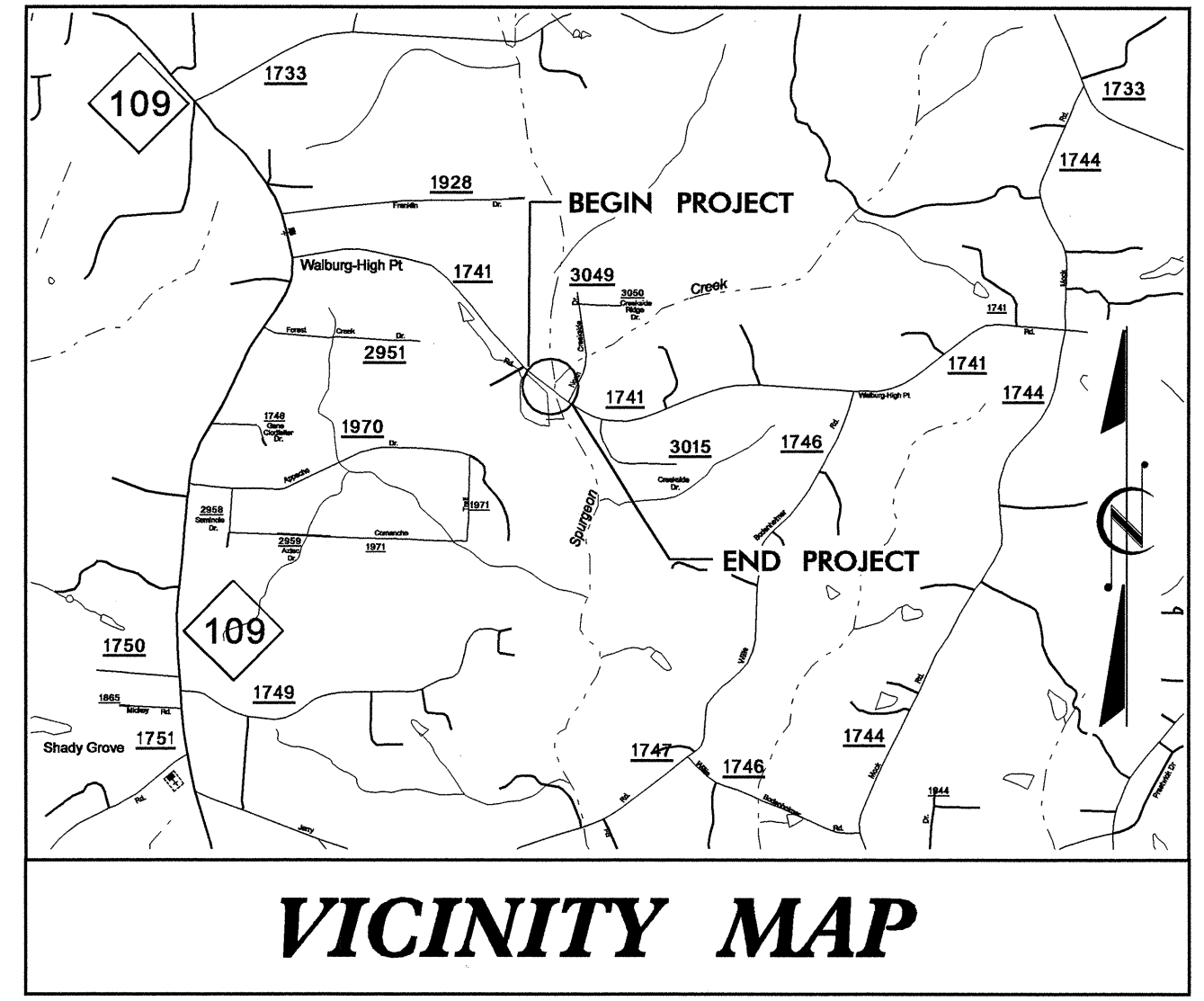

TIP PROJECT: B-4101
CONTRACT: C201757

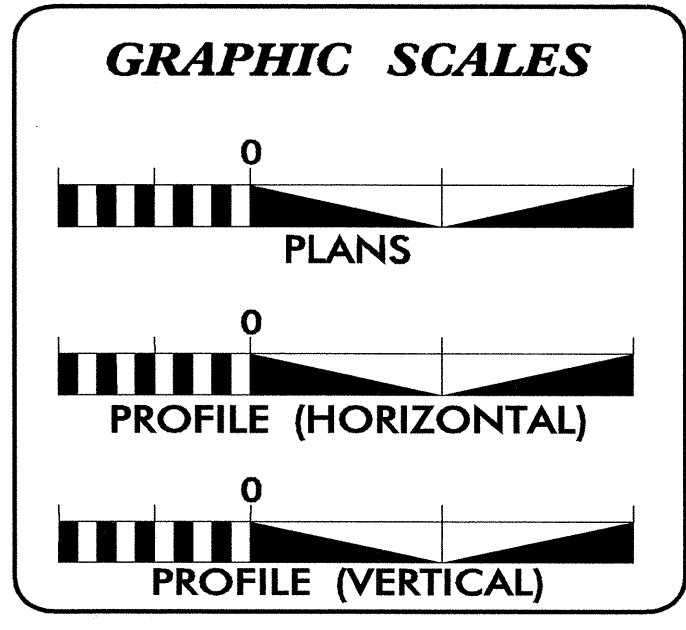
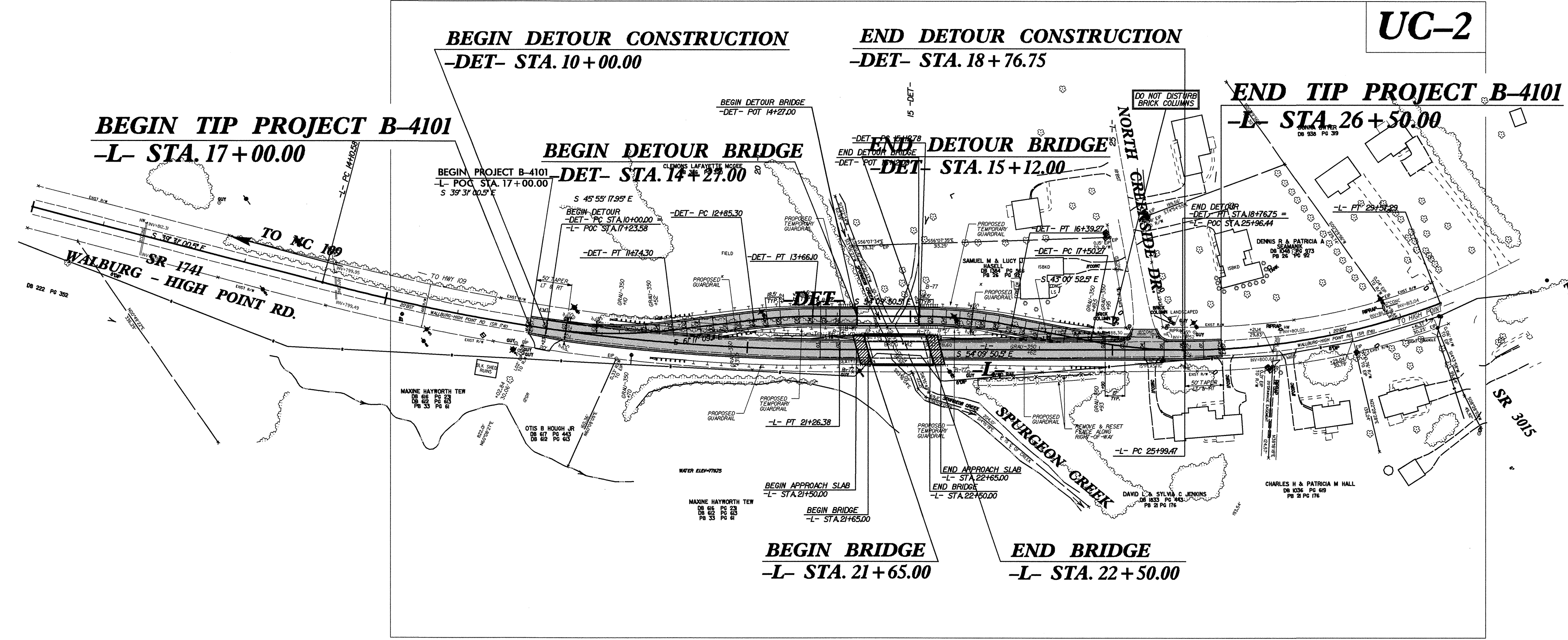

INDEX OF SHEETS

SHEET NO.	DESCRIPTION
UC-1	TITLE SHEET
UC-2	UTILITY CONSTRUCTION PLAN SHEET

WATER AND SEWER OWNERS ON PROJECT

(1) WATER - DAVIDSON WATER, INC.

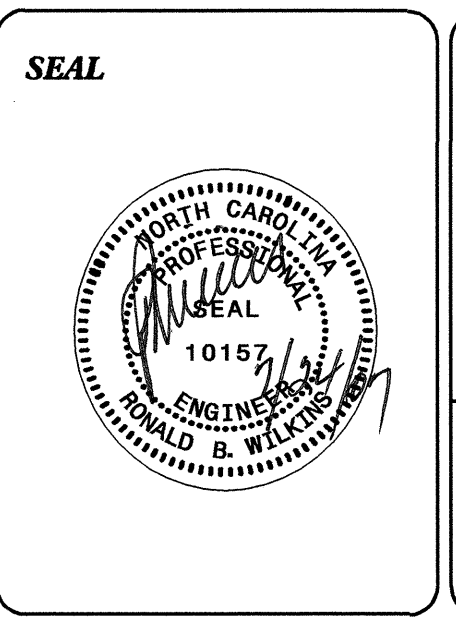

PREPARED IN THE OFFICE OF:
DIVISION OF HIGHWAYS
PROJECT SERVICES
UTILITY SECTION

1591 MAIL SERVICES CENTER
RALEIGH NC 27699-1591
PHONE (919) 250-4128
FAX (919) 250-4119

Roger Worthington, P.E. UTILITIES SECTION ENGINEER
R. B. WILKINS, P.E. UTILITIES SQUAD LEADER PROJECT ENGINEER
MICHAEL R. BRIGHT UTILITIES PROJECT DESIGNER

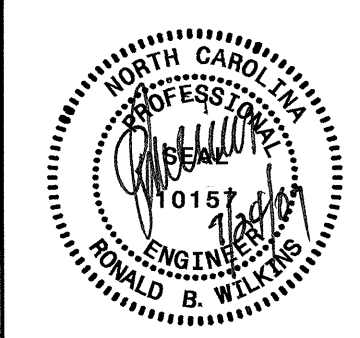

UTILITY CONSTRUCTION

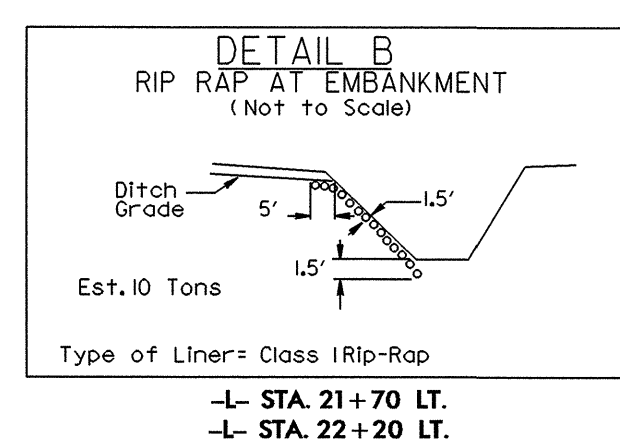
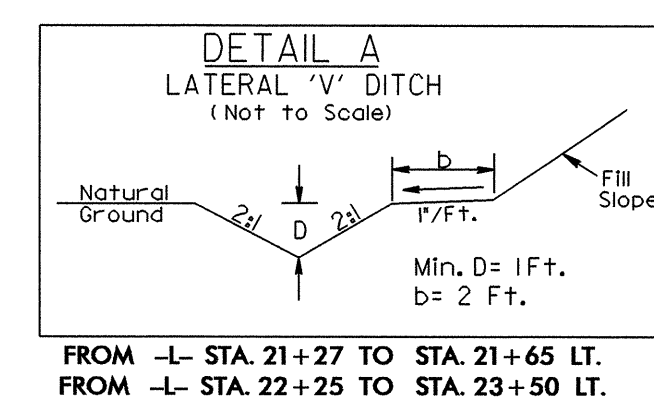

DETOUR

PI Sta 10+87.68 Δ = 15' 21" 51.1" (LT) D = 8' 48" 53.0" L = 174.30' T = 87.68' R = 650.00'	PI Sta 13+25.75 Δ = 7' 07" 18.5" (RT) D = 8' 48" 53.0" L = 80.79' T = 40.45' R = 650.00'	PI Sta 15+76.22 Δ = 11' 08" 58.0" (RT) D = 8' 48" 53.0" L = 126.49' T = 63.44' R = 650.00'	PI Sta 18+13.71 Δ = 11' 08" 58.0" (LT) D = 8' 48" 53.0" L = 126.49' T = 63.44' R = 650.00'
---	---	---	---

* LEAVE GAPS IN PROPOSED GUARDRAIL AS REQUIRED BY TRAFFIC CONTROL PLANS IN ORDER TO REMOVE DETOUR EMBANKMENT. SEE TRAFFIC CONTROL PLANS.

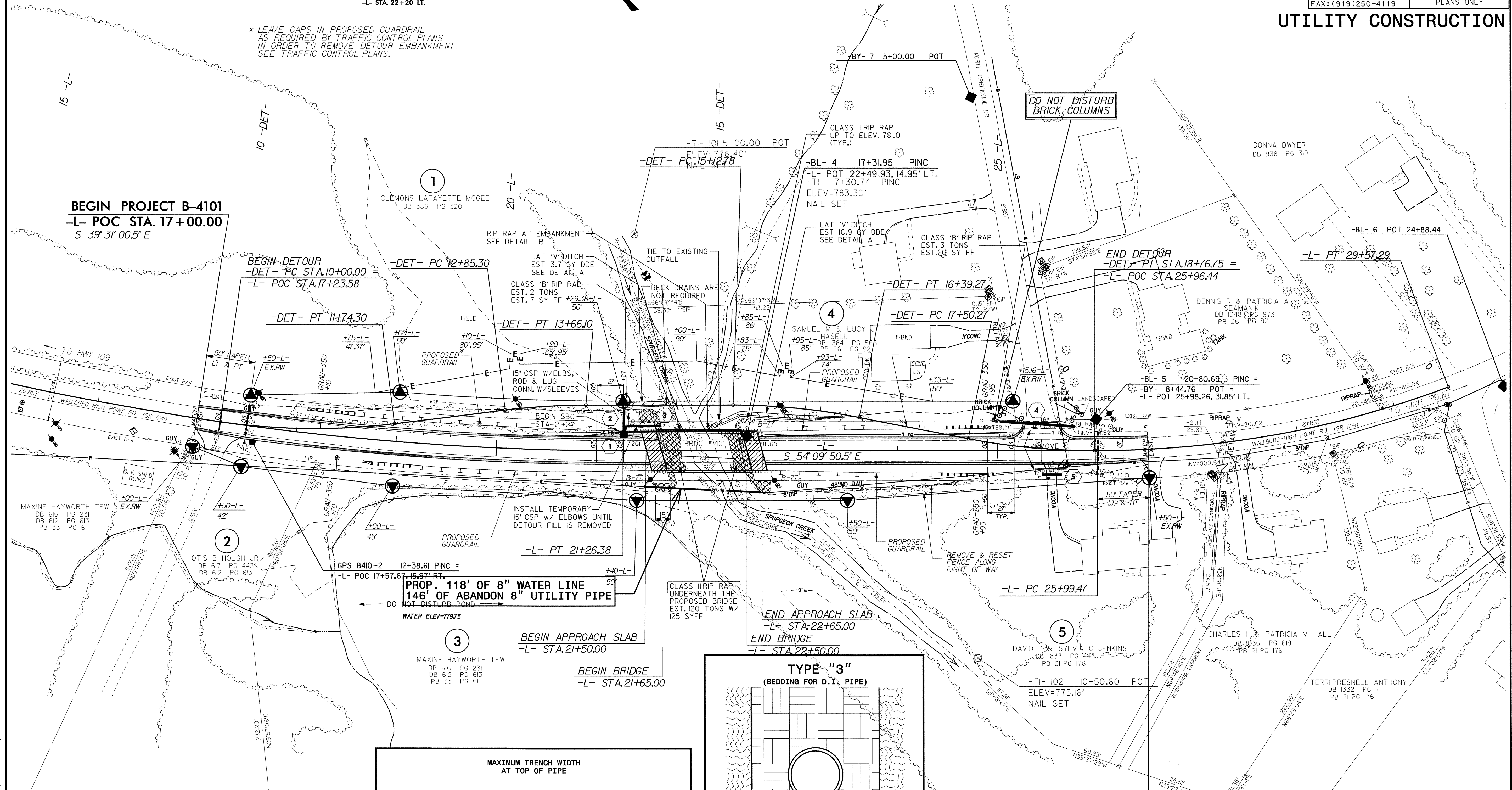

BEGIN PROJECT B-4101
 -L- POC STA. 17+00.00
 S 39° 31' 00.5" E

BEGIN DETOUR
 -DET- PC STA. 10+00.00
 -L- POC STA. 17+23.58

END DETOUR
 -DET- PT STA. 18+76.75 =
 -L- POC STA. 25+96.44

PROP. 118' OF 8" WATER LINE
146' OF ABANDON 8" UTILITY PIPE
 WATER ELEV=779.75

BEGIN APPROACH SLAB
 -L- STA. 21+50.00

BEGIN BRIDGE
 -L- STA. 21+65.00

END APPROACH SLAB
 -L- STA. 22+65.00

END BRIDGE
 -L- STA. 22+50.00

END PROJECT B-4101
 -L- POC STA. 26+50.00

PI Sta 17+70.44 Δ = 14' 38" 50.1" (LT) D = 2' 02" 46.6" L = 715.80' T = 359.86' R = 2,800.00' SE = 0.030 RO = 8'	PI Sta 27+80.37 Δ = 20' 48" 50.3" (LT) D = 5' 49" 00.6" L = 357.82' T = 180.91' R = 985.00' SE = EXIST
---	--

MAXIMUM TRENCH WIDTH AT TOP OF PIPE

NOMINAL PIPE SIZE (INCHES)	TRENCH WIDTH (INCHES)	NOMINAL PIPE SIZE (INCHES)	TRENCH WIDTH (INCHES)
4	28	20	44
6	30	24	48
8	32	30	54
10	34	36	60
12	36	42	66
14	38	48	72
16	40	54	78
18	42		

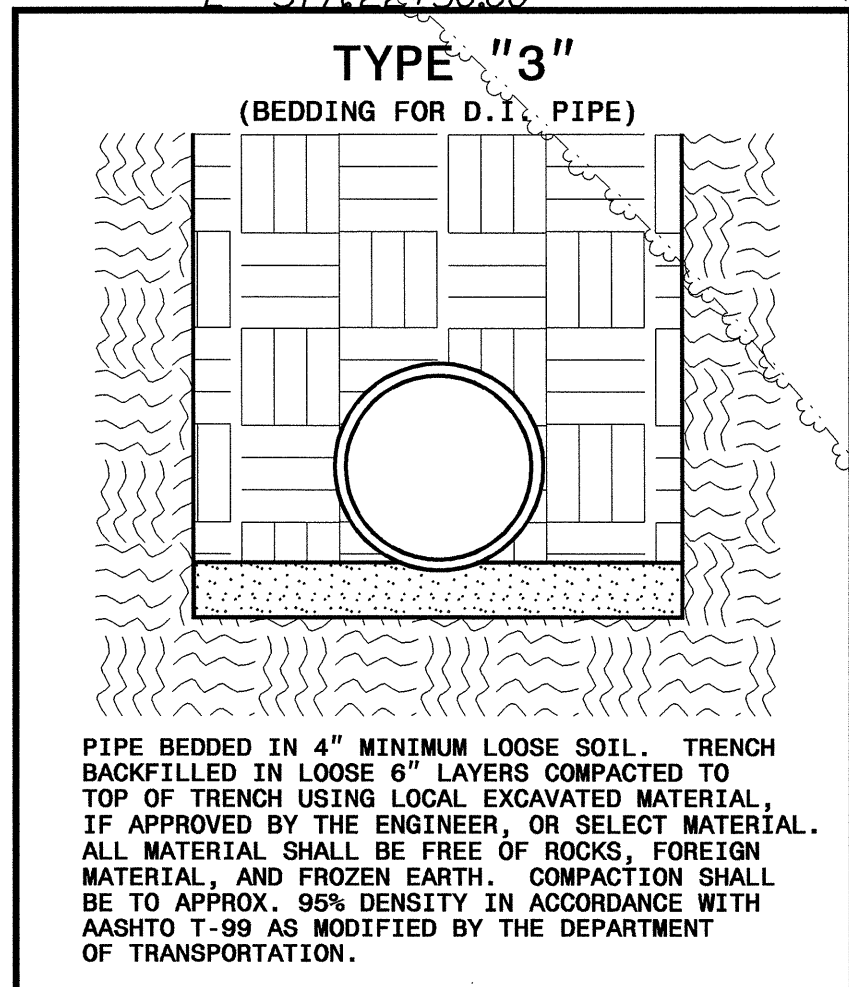

5/14/99
 24-JUL-2007 11:32 B:\24101\11-24101-UC2-pshd.dgn

STATE OF NORTH CAROLINA
DIVISION OF HIGHWAYS

**UTILITY CONSTRUCTION PLANS
DAVIDSON COUNTY**

**LOCATION: BRIDGE 141 OVER SPURGEON CREEK ON
SR 1741 (WALBURG-HIGH POINT RD.) IN
THOMASVILLE**

TYPE OF WORK: UTILITIES BY OTHERS

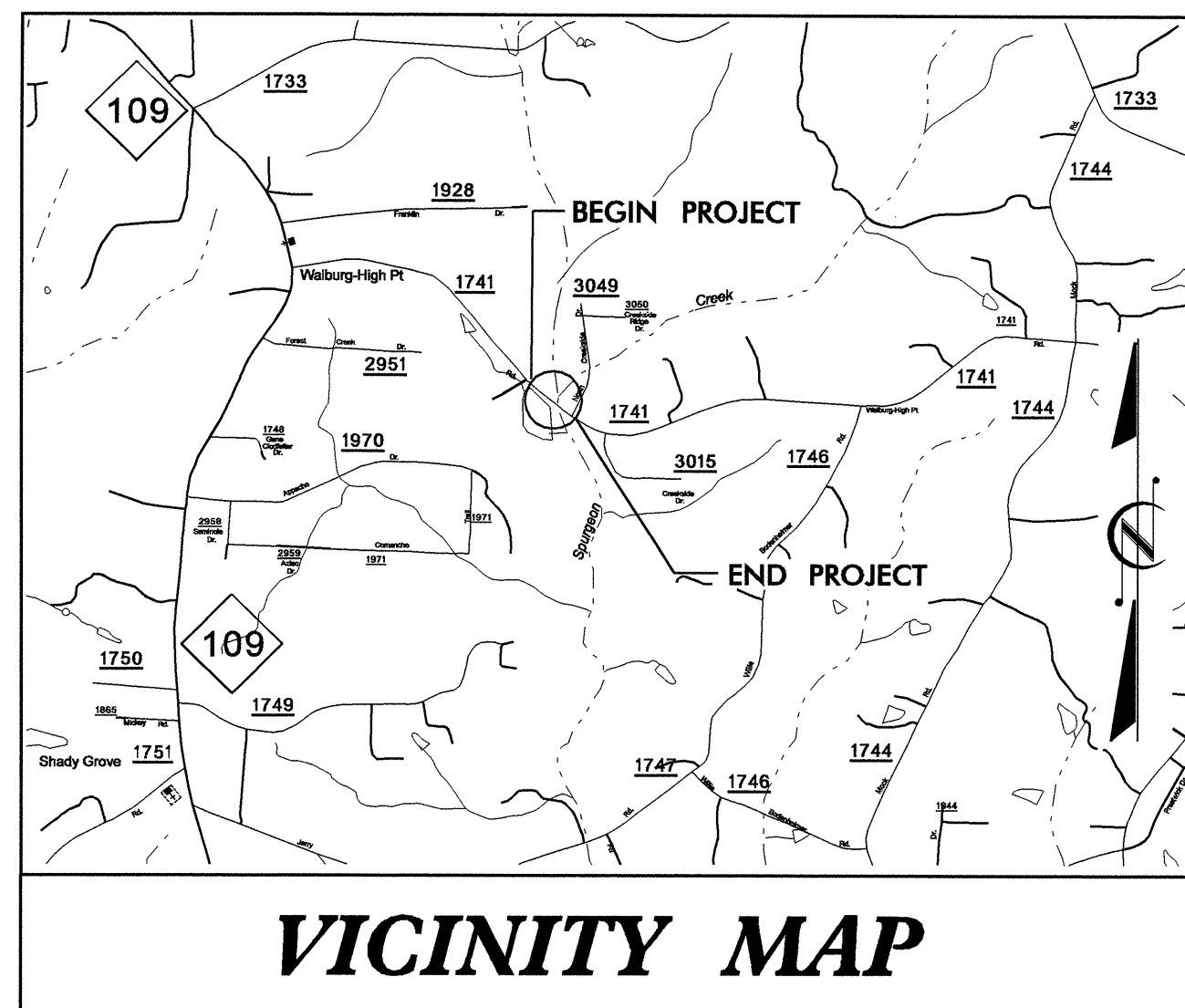

VICINITY MAP

TIP PROJECT: B-4101

CONTRACT: C201757

UO-2

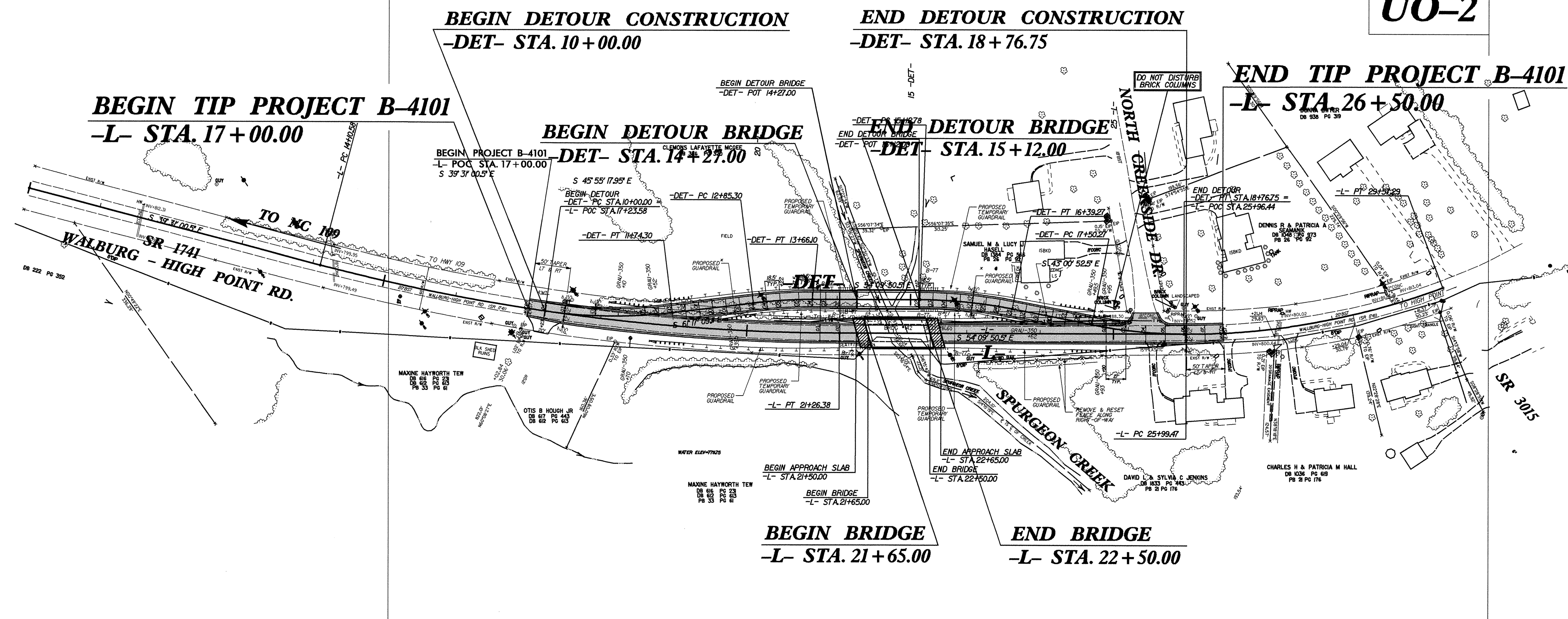

**NC GRID
NAD 83 95**

GRAPHIC SCALES

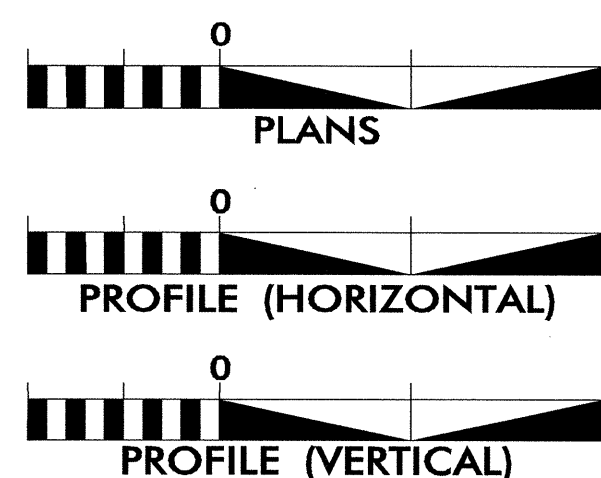

INDEX OF SHEETS

<u>SHEET NO.</u>	<u>DESCRIPTION</u>
UO-1	TITLE SHEET
UO-2	UTILITIES BY OTHERS PLAN SHEET

UTILITY OWNERS ON PROJECT

- (1) CITY OF LEXINGTON ELECTRIC - POWER (DIST.)
- (2) AT&T - TELEPHONE
- (3) LEXCOM - COMMUNICATION
- (4) ENERGY UNITED - POWER (DIST.)

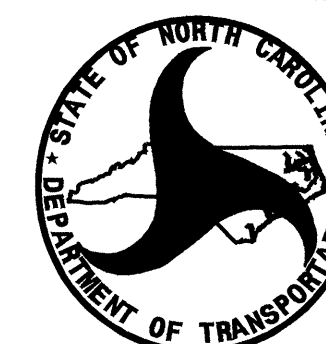

PREPARED IN THE OFFICE OF:
**DIVISION OF HIGHWAYS
PROJECT SERVICES
UTILITY SECTION**
1591 MAIL SERVICES CENTER
RALEIGH NC 27699-1591
PHONE (919) 250-4128
FAX (919) 250-4119

Roger Worthington, P.E. UTILITIES SECTION ENGINEER
R. B. WILKINS, P.E. UTILITIES SQUAD LEADER PROJECT ENGINEER
MICHAEL R. BRIGHT UTILITIES PROJECT DESIGNER

UTILITIES BY OTHERS

NOTE:
ALL PROPOSED UTILITY WORK
SHOWN ON THIS SHEET WILL
BE DONE BY OTHERS

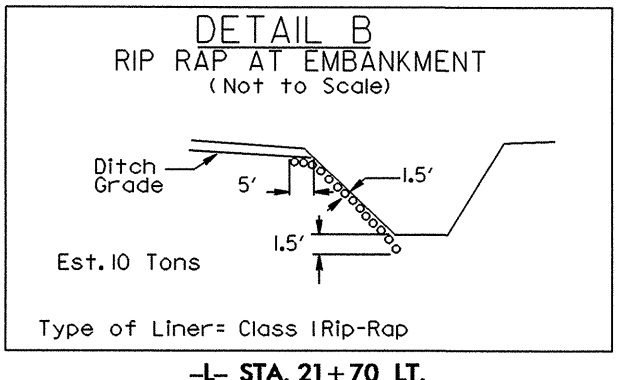
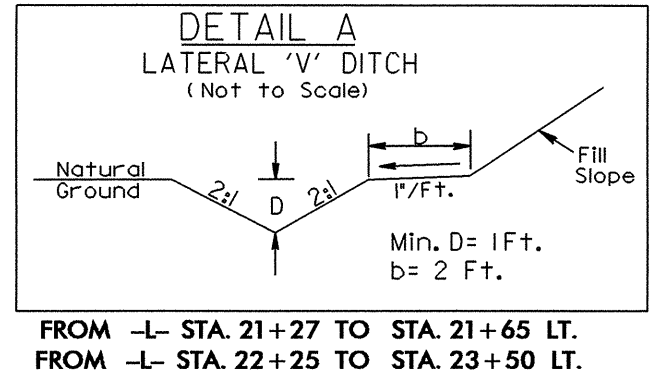

DETOUR

PI Sta 10+87.68	PI Sta 13+25.75	PI Sta 15+76.22	PI Sta 18+13.71
$\Delta = 15' 21" 51J (LT)$	$\Delta = 7' 07" 18.5 (RT)$	$\Delta = 11' 08" 58.0 (RT)$	$\Delta = 11' 08" 58.0 (LT)$
$D = 8' 48" 53.0'$	$D = 8' 48" 53.0'$	$D = 8' 48" 53.0'$	$D = 8' 48" 53.0'$
$L = 174.30'$	$L = 80.79'$	$L = 126.49'$	$L = 126.49'$
$T = 87.68'$	$T = 40.45'$	$T = 63.44'$	$T = 63.44'$
$R = 650.00'$	$R = 650.00'$	$R = 650.00'$	$R = 650.00'$

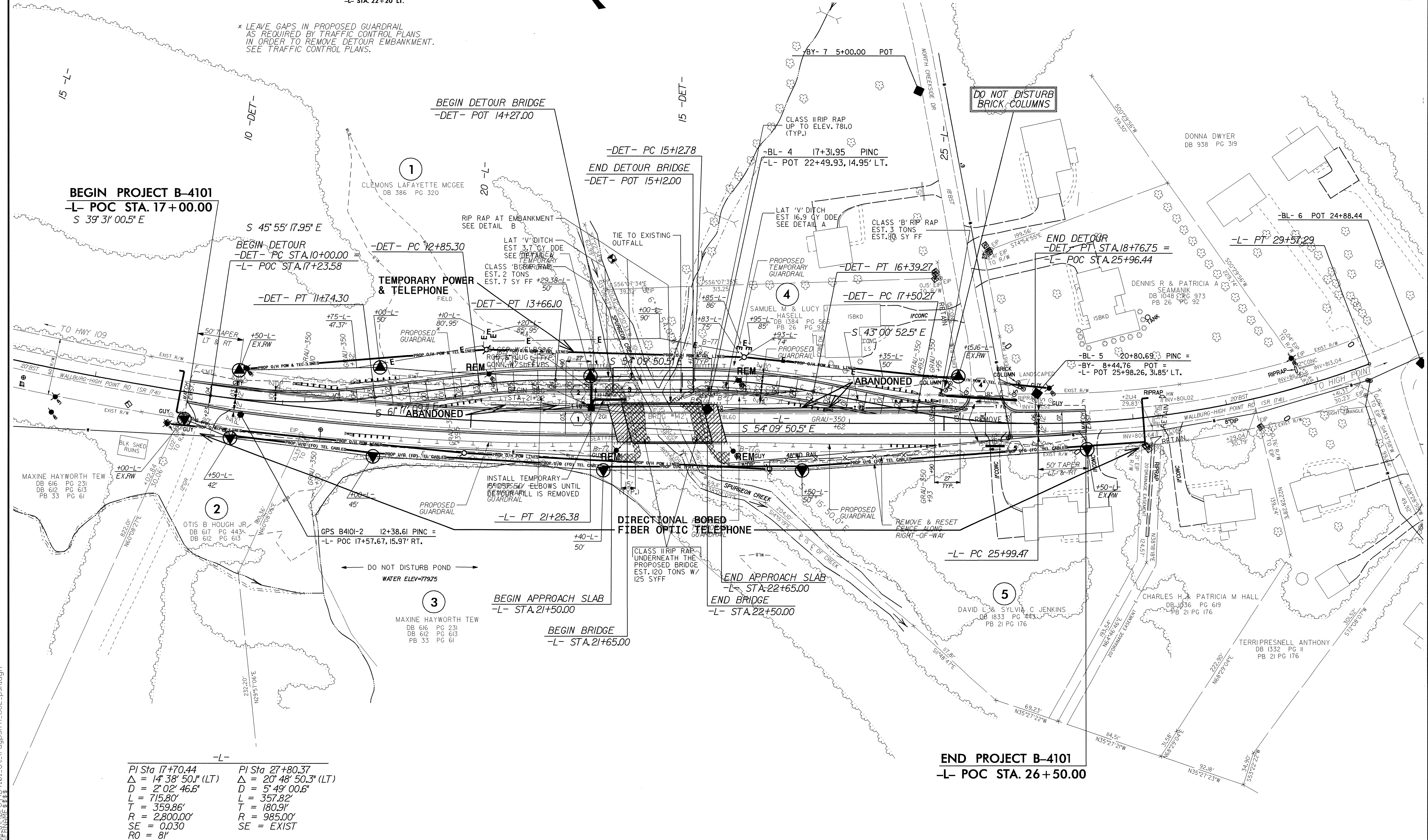

-L-

PI Sta 17+70.44	PI Sta 27+80.37
$\Delta = 14' 38" 50.1 (LT)$	$\Delta = 20' 48" 50.3 (RT)$
$D = 2' 02" 46.6"$	$D = 5' 49" 00.6"$
$L = 715.80'$	$L = 357.82'$
$T = 359.86'$	$T = 180.91'$
$R = 2,800.00'$	$R = 985.00'$
$SE = 0.030$	$SE = EXIST$
$RO = 81'$	

14-AUG-2007 09:58 B-4101_U0-2-psht.dgn