

T.I.P.: B-3818

CONTRACT: C201602

**STATE OF NORTH CAROLINA
DEPARTMENT OF TRANSPORTATION**

**SIGNING PLANS
CALDWELL COUNTY**

LOCATION: BRIDGE NO. 3 OVER LOST COVE CREEK ON NC 90

TIP NO. B-3818	SHEET NO. SIGN-1
APPROVED: <i>[Signature]</i>	
DATE: 10/9/07	
SEAL	

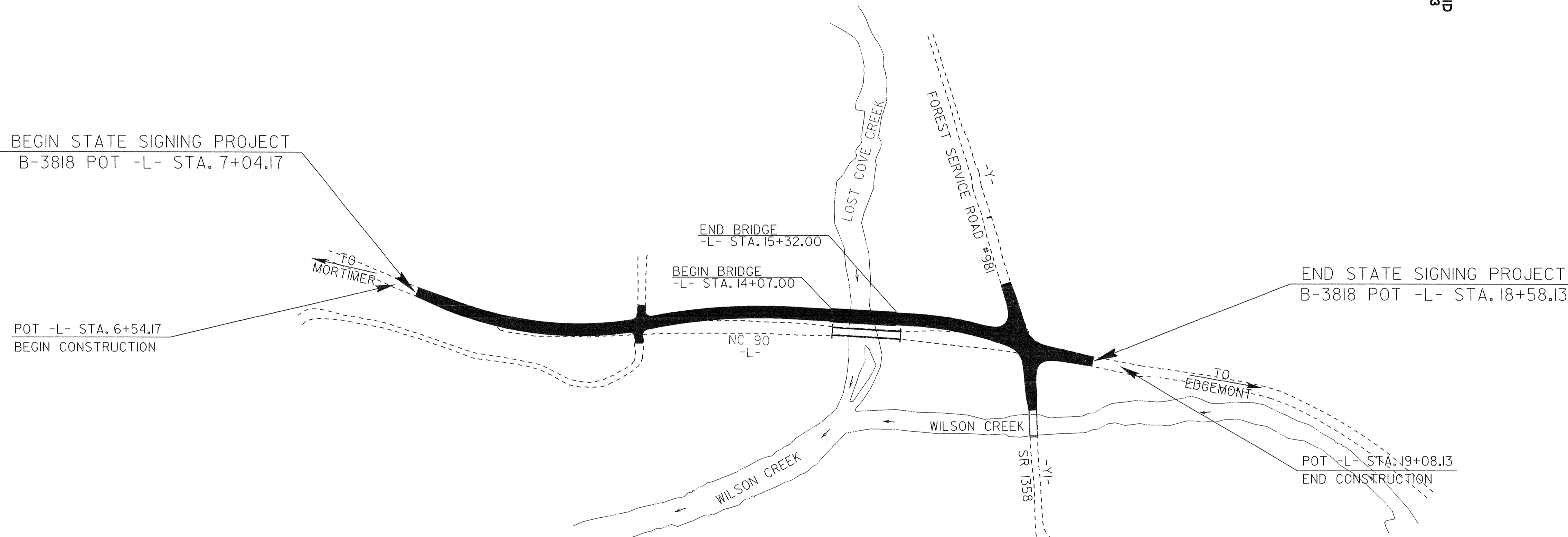
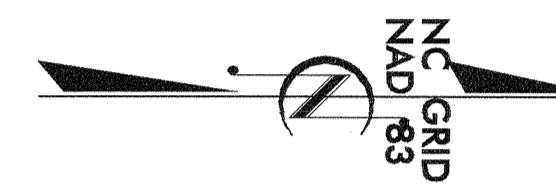

SUMMARY OF QUANTITIES

ITEM NO.		ITEM DESCRIPTION	QUANTITY	UNIT
DESC. NO.	SECT. NO.			
4025000000	901	CONTRACTOR FURNISHED, TYPE E SIGN	37.50	S.F.
4025000000	901	CONTRACTOR FURNISHED, TYPE F SIGN	6	S.F.
4072000000	903	SUPPORTS, 3 LB STEEL U-CHANNEL	110	L.F.
4102000000	904	SIGN ERECTION, TYPE E	6	EA.
4108000000	904	SIGN ERECTION, TYPE F	1	EA.
4116100000	904	SIGN ERECTION, RELOCATE SIGN TYPE E	2	EA.
4155000000	907	DISPOSAL OF SIGN SYSTEM, U-CHANNEL	11	EA.
4192000000	907	DISPOSAL OF SUPPORT, U-CHANNEL	1	EA.

INDEX

SHEET NO.	DESCRIPTION
1	TITLE SHEET
2	TYPE "E" SIGNS
3	TYPE "F" SIGNS
4	EXISTING/PROPOSED ROADWAY

PLAN PREPARED BY: N.C.D.O.T. SIGNING SECTION

R. W. KING, PE SIGNING ENGINEER
A. I. ALQUDWAH, PE SIGNING PROJECT ENGINEER
D. M. EATON SIGNING PROJECT DESIGN ENGINEER
R. R. HENNEIN SIGNING DESIGNER

ROADWAY STANDARD DRAWINGS
APPLICABLE TO THESE SIGNING PLANS
904.10 904.50

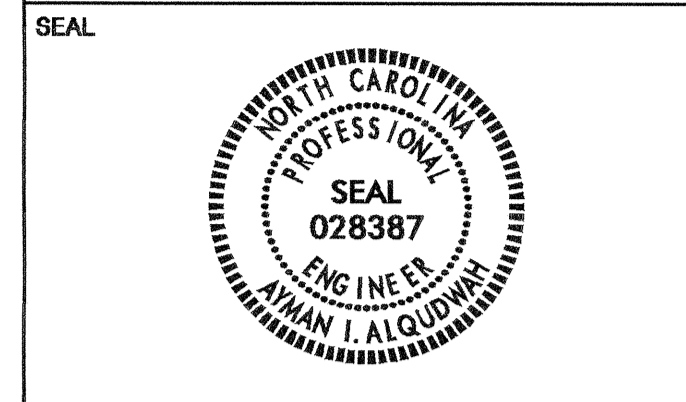

408 QUANTITY REQ'D 2

30 X 30
R1-1

ONE "U" POST PER SIGN

464 QUANTITY REQ'D 1

30 X 30
W8-7

ONE "U" POST PER SIGN

465 QUANTITY REQ'D 1

30 X 30
W6-3

ONE "U" POST PER SIGN

466 QUANTITY REQ'D 1

30 X 30
SEE SIGN DESIGN

ONE "U" POST PER SIGN

467 QUANTITY REQ'D 1

30 X 30
W6-3

ONE "U" POST PER SIGN

SIGN NUMBER: 466 BACKG COLOR: Yellow
 TYPE: E COPY COLOR: Black
 QUANTITY: 1

SYMBOL	X	Y	WID	HT

SIGN WIDTH: 30"
 HEIGHT: 30"
 TOTAL AREA: 6.25 Sq.Ft.

BORDER TYPE: RECESSED
 RECESS: 0.5"
 WIDTH: 0.75"
 RADII: 1.88"

NO. Z BARS: MAT'L: 0.063" (1.6 mm) ALUMINUM
 LENGTH:

DESIGN BY: R. HENNEIN CHECKED BY:
 PROJECT ID: B-3818 DIV: 11 DATE: Oct 01, 2007

USE NOTES:
 1. Legend and border shall be direct applied non-reflective sheeting.
 2. Background shall be Type III reflective sheeting.

LETTER POSITIONS

Letter spacings are to start of next letter											Series/Size
	O	N	E	L	A	N	E				Text Length
	10.2	2.8	2.8	1.9	3	2	3	2.8	1.9	10.2	D 2000 20.1
	13.5	2.6	2.5	1.2	2.6	2.7	1.9	13.5			D 2000 13.5
	16	3.1	0.9	2.3	2	16					D 2000 8.4
	10.4	2.3	2.8	2.6	2.7	2.8	2.5	2.1	2	10.4	D 2000 19.7

FILENAME: signdesigns NORTH CAROLINA D.O.T. SIGN DETAIL

TYPE "E" SIGNS

501

END

1 - 24 X 12

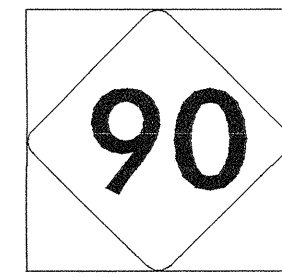

1 - 24 X 24

TIP NO. SHEET NO.

B-3818 SIGN-3

APPROVED: *[Signature]*

DATE: 10/9/07

SEAL



TYPE "F" SIGNS

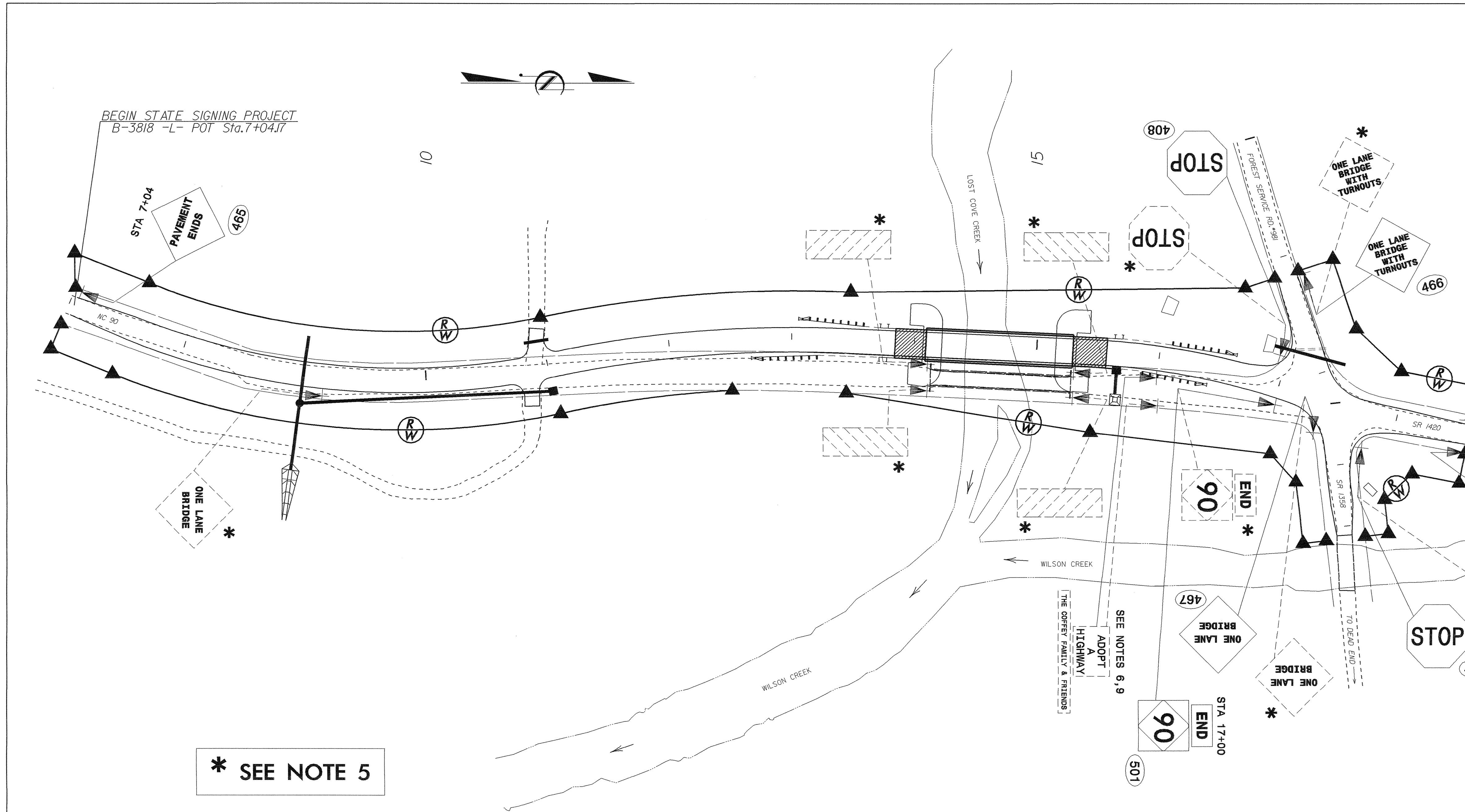

* SEE NOTE 5

WARNING SIGNS PLACEMENT CHART

POSTED OR 85TH PERCENTILE SPEED MPH (KMH)	MUTCD DISTANCE FT (M)	SUGGESTED LOCATION FT (M)	SUGGESTED MAXIMUM FT (M)
30 (50)	450 (140)	475 (145)	575 (175)
35 (55)	550 (170)	575 (175)	675 (205)
40 (65)	650 (200)	675 (205)	775 (235)
45 (70)	750 (230)	775 (235)	875 (270)
50 (80)	850 (260)	875 (270)	975 (300)
55 (90)	950 (290)	975 (300)	1075 (330)
60 (95)	1100 (335)	1125 (345)	1225 (375)
65 (105)	1200 (365)	1225 (375)	1325 (405)
70 (115)	1250 (380)	1275 (390)	1375 (420)

1. SEE ROADWAY STANDARD NO. 904.50 FOR MOUNTING OF TYPE 'D', 'E', AND 'F' SIGNS ON 'U' CHANNEL POSTS.
2. SEE CHART FOR PLACEMENT OF WARNING SIGNS. DISTANCES SHOWN IN MINIMUM ROAD COLUMNS ARE FOR LEVEL ROADWAYS. MAKE CORRECTIONS FOR GRADES. IF 48-INCH (1219 MM) SIGNS ARE USED, THE LEGIBILITY DISTANCE MAY BE INCREASED TO 200 FEET (61 M). THIS WOULD ALLOW REDUCING THE CHART SPECIFIED DISTANCE BY 75 FEET (23 M).
3. IF THE BRIDGE IS OVER A MAJOR STREAM OR RIVER, A SIGN FOR THE NAME OF THE STREAM OR RIVER SHOULD BE INSTALLED AT EACH APPROACH. THESE DESIGNS WILL BE COMPLETED BY THE SIGNING SECTION UPON REQUEST.
4. SIGNS FURNISHED BY CONTRACTOR. BACKGROUND SHEETING SHALL BE TYPE III REFLECTIVE SHEETING.
5. DISPOSAL OF SIGN SYSTEM, U-CHANNEL.
6. SIGN ERECTION, RELOCATE SIGN TYPE D, E, OR F.
7. DISPOSAL OF SIGN SYSTEM, WOOD.
8. DISPOSAL OF SIGN, D, E, OR F.
9. DISPOSAL OF SUPPORT, U-CHANNEL.

STA 7+00 TO 19+00
NC 90
EXISTING/PROPOSED ROADWAY