

8/17/99

PROJECT REFERENCE NO. R-4758		SHEET NO. EC-1	
RW SHEET NO.			
ROADWAY DESIGN ENGINEER 		HYDRAULICS ENGINEER 	

Std. #	Description	Symbol
1605.01	Temporary Silt Fence	
1606.01	Special Sediment Control Fence	
1622.01	Temporary Berms and Slope Drains	
1630.02	Silt Basin Type B	
1630.05	Temporary Silt Ditch	
1630.05	Temporary Diversion	
1632.03	Rock Inlet Sediment Trap Type C	
1633.01	Temporary Rock Silt Check Type-A	
	Temporary Rock Silt Check Type-B	
1634.02	Temporary Rock Sediment Dam Type-B	
1635.01	Rock Pipe Inlet Sediment Trap Type-A	

Underground water and sewer lines exist in the area. Contractor shall contact Cherokee Utilities at 497-1820 prior to digging.

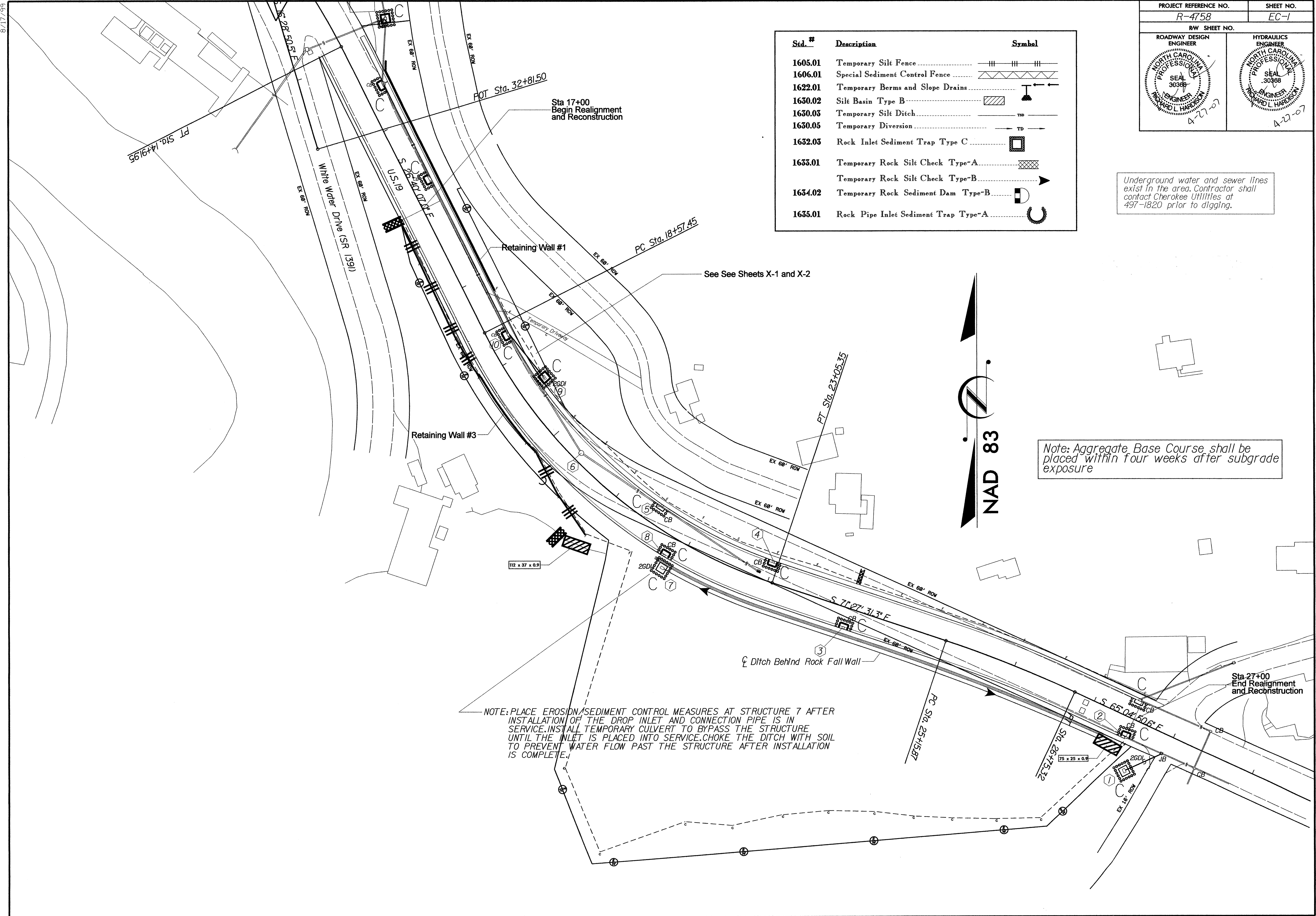

Note: Aggregate Base Course shall be placed within four weeks after subgrade exposure

NOTE: PLACE EROSION/SEDIMENT CONTROL MEASURES AT STRUCTURE 7 AFTER INSTALLATION OF THE DROP INLET AND CONNECTION PIPE IS IN SERVICE. INSTALL TEMPORARY CULVERT TO BYPASS THE STRUCTURE UNTIL THE INLET IS PLACED INTO SERVICE. CHOKE THE DITCH WITH SOIL TO PREVENT WATER FLOW PAST THE STRUCTURE AFTER INSTALLATION IS COMPLETE.