



FINAL PAVEMENT MARKING SCHEDULE

SYMBOL	DESCRIPTION	PAT ITEM QUANTITY BREAKDOWN	TOTAL QUANTITY
PAVEMENT MARKINGS			
THERMOPLASTIC (100MM, 3.1MM)			
TC	3 M. WHITE SKIP	497 M	
TD	0.5 M. WHITE MINISKIP	50 M	
TE	WHITE SOLID LANE LINE	450 M	
TF	3 M. YELLOW SKIP	140 M	
TH	YELLOW SINGLE CENTER	560 M	
TI	YELLOW DOUBLE CENTER	1886 M	
			TOTAL 3583 M
T7	THERMOPLASTIC (150MM, 2.3MM) YELLOW EDGELINE	250 M	
			TOTAL 250 M
THERMOPLASTIC (200MM, 2.3MM)			
TT	YELLOW DIAGONAL	68 M	
			TOTAL 68 M
THERMOPLASTIC (200MM, 3.1MM)			
TV	WHITE CROSSWALK LINE	264 M	
			TOTAL 264 M
THERMOPLASTIC (600MM, 3.1MM)			
T2	WHITE STOPBAR	150 M	
			TOTAL 150 M
THERMOPLASTIC PAVEMENT MARKING SYMBOLS (2.3MM)			
UA	LEFT TURN ARROW	40 EA	
UB	RIGHT TURN ARROW	15 EA	
UC	STRAIGHT ARROW	25 EA	
UE	COMBO. STRAIGHT/RIGHT	10 EA	
UG	LEFT/RIGHT/STRAIGHT	1 EA	
			TOTAL 91 EA

I7-OCT-2006 11:25
 \DOT\DOTSR001\NSPROJ\TIP\Projects-U\U2306a\traffic\trafficcontrol\top\pavement marking\U2306a.tc.pml.schedule.dgn
 jwoolard AT WTC22404

APPROVED:	DATE: 10/17/06	FINAL PAVEMENT MARKING SCHEDULE					
SEAL 	SCALE: NONE	 REVISIONS <table border="1" style="width: 100%; height: 40px;"> <tr><td> </td><td> </td></tr> <tr><td> </td><td> </td></tr> </table>					
	DATE: 2006 OCT 17						
DWG. BY: MRM							
DESIGN BY: MRM							
REVIEWED BY: JWJ	 CADD FILE						

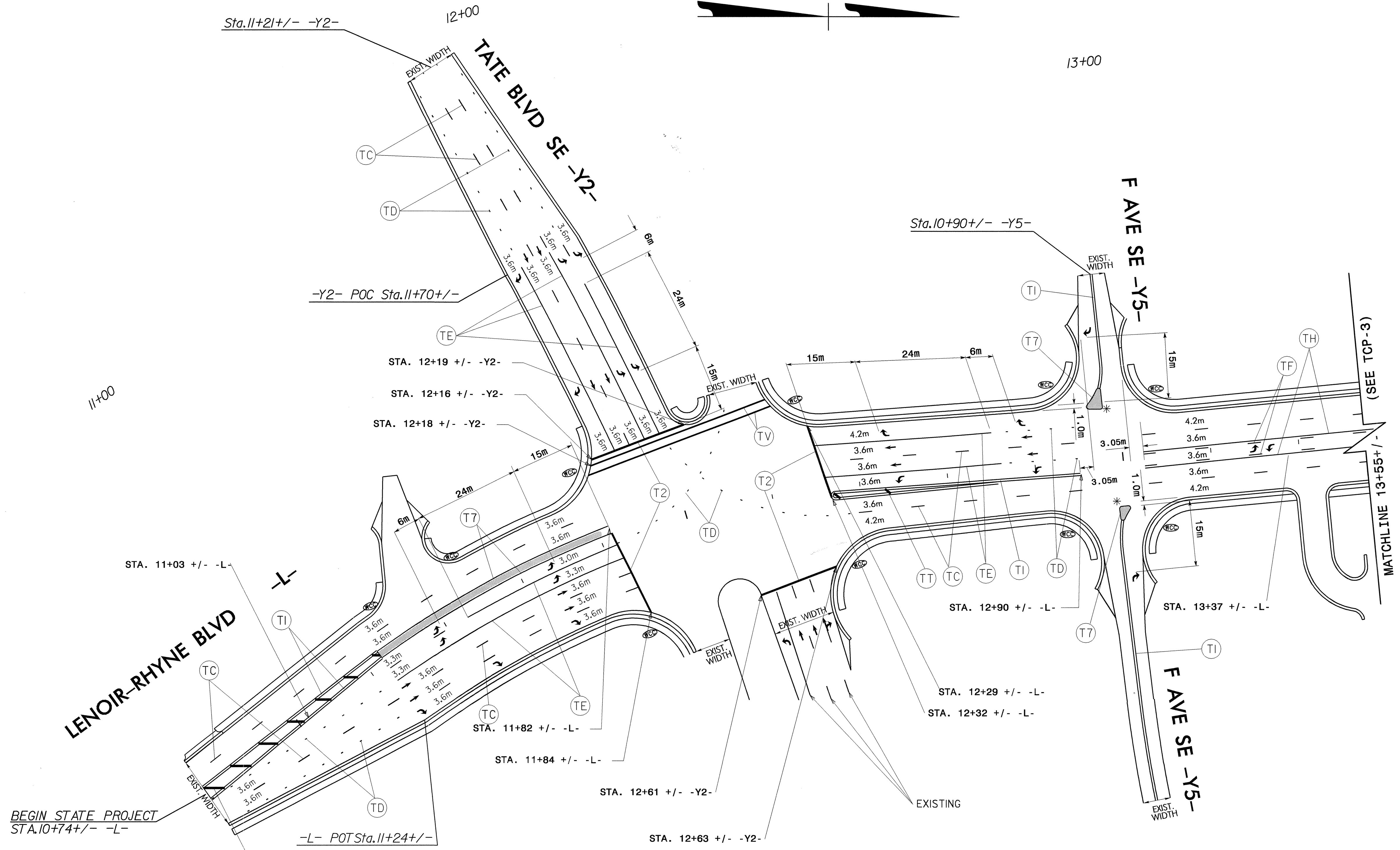

BEGIN STATE PROJECT
STA. 10+74 +/- -L-

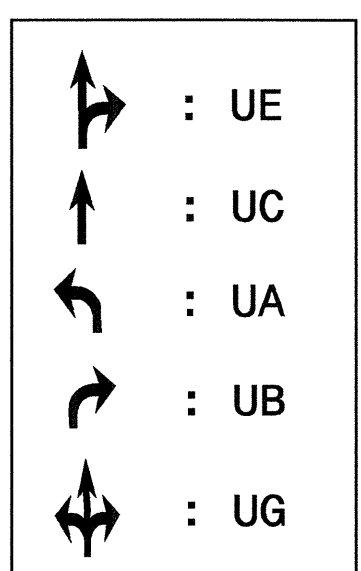

- 1) PAVEMENT MARKERS SHALL BE PLACED ACCORDING TO RSD 1250.01, 1251.01 AND 1253.01.
 - 2) FOR FINAL PAVEMENT MARKING SCHEDULE SEE SHEET PM-1.
 - 3) PEDESTRIAN SIDEWALK SHALL BE PLACED ACCORDING TO RSD 1205.07
- * PROPOSED MONOLITHIC ISLAND

APPROVED: *[Signature]* DATE: 8/20/04

SEAL

FINAL PAVEMENT MARKINGS

SCALE:	NONE		REVISIONS <table border="1"> <tr><td> </td><td> </td></tr> <tr><td> </td><td> </td></tr> <tr><td> </td><td> </td></tr> <tr><td> </td><td> </td></tr> </table>								
DATE:	2004 AUG 19										
DWG. BY:	MRM										
DESIGN BY:	MRM										
REVIEWED BY:	JWW	CADD FILE									

19-AUG-2004 15:31
 I:\TCP\pavement\Marking\U2306A_Tc.pm2_final.dgn
 AT TETC85145
 csmozingo

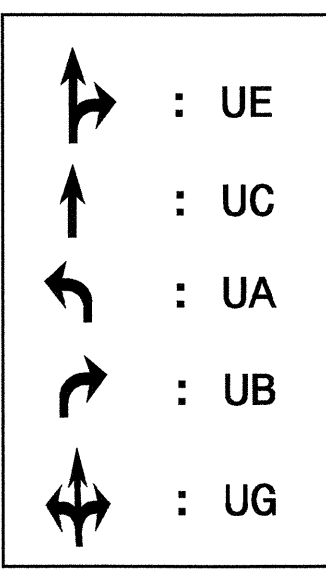
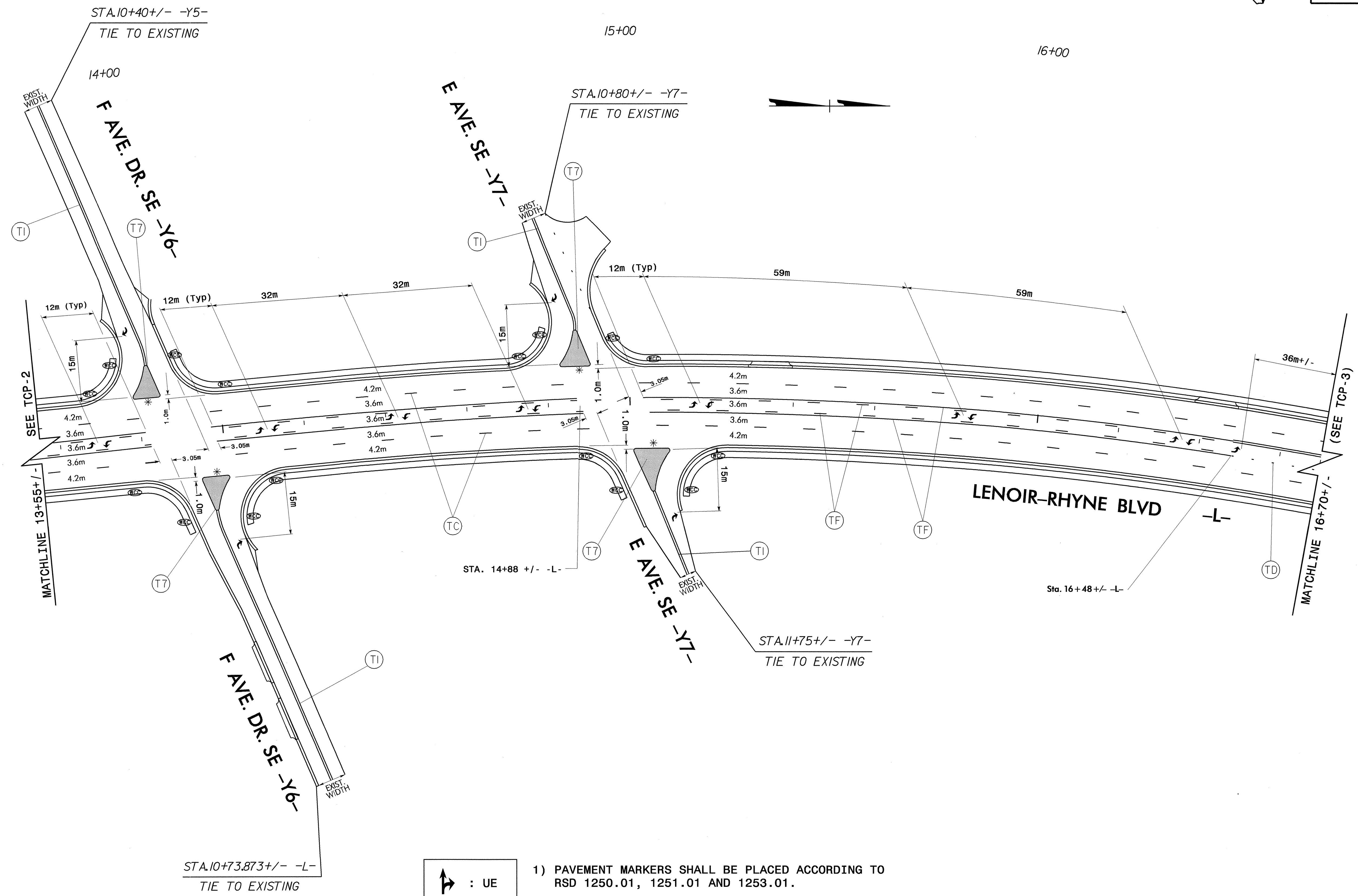

- 1) PAVEMENT MARKERS SHALL BE PLACED ACCORDING TO RSD 1250.01, 1251.01 AND 1253.01.
 - 2) FOR FINAL PAVEMENT MARKING SCHEDULE SEE SHEET PM-1.
 - 3) PEDESTRIAN SIDEWALK SHALL BE PLACED ACCORDING TO RSD 1205.07
- * OR MONOLITHIC ISLAND PROPOSAL

APPROVED:	DATE: 8/4/04	FINAL PAVEMENT MARKINGS			
SCALE: NONE	REVISIONS				
DATE: 2004 AUG 3					
DWG. BY: MRM					
DESIGN BY: MRM					
REVIEWED BY: JWW		<table border="1"> <tr> <td>CADD FILE</td> <td></td> </tr> </table>		CADD FILE	
CADD FILE					

04-AUG-2004 07:39
 T:\TCP\Pavement\Marking\U2306A_TC.pm3_final.dgn
 CSMozingo AT TETC195145



PROJ. REFERENCE NO.	SHEET NO.
U-2306 A	PM-4

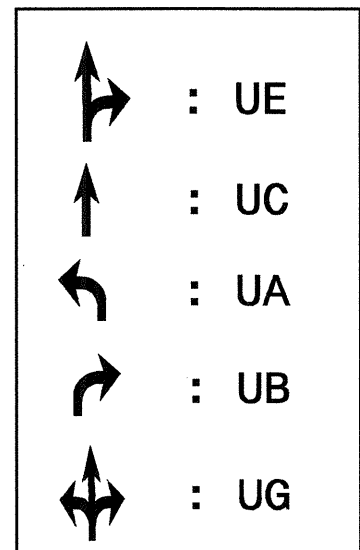
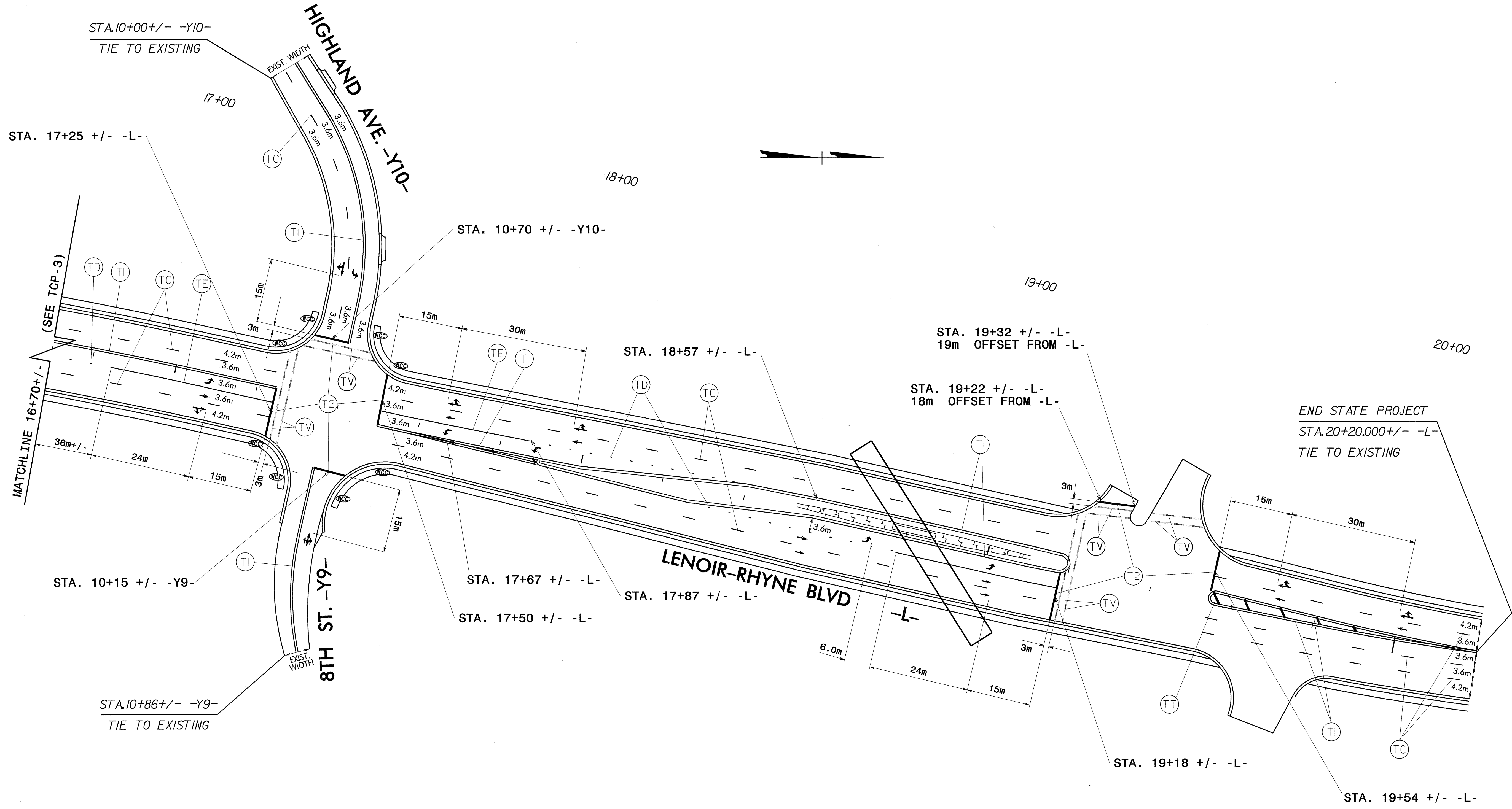

- 1) PAVEMENT MARKERS SHALL BE PLACED ACCORDING TO RSD 1250.01, 1251.01 AND 1253.01.
- 2) FOR FINAL PAVEMENT MARKING SCHEDULE SEE SHEET PM-1.
- 3) PEDESTRIAN SIDEWALK SHALL BE PLACED ACCORDING TO RSD 1205.07

APPROVED: *J.W. Woolard* DATE: 8/1/04

SEAL

FINAL PAVEMENT MARKINGS

SCALE: NONE		REVISIONS
DATE: 2004 AUG 3		
DWG. BY: MRM		
DESIGN BY: MRM		
REVIEWED BY: JWW		

04-AUG-2004 07:41
 T:\TCP\pavement\U2306A.TC.pm4_final.dgn
 CSMozingo AT TETC95145