

TIP PROJECT: B-3900

STATE OF NORTH CAROLINA
 DIVISION OF HIGHWAYS
 PLAN FOR PROPOSED
 HIGHWAY EROSION CONTROL
ROCKINGHAM COUNTY

**LOCATION: BRIDGE NO. 165 OVER A CREEK ON
 SR 1376 (PAW PAW ROAD)
 TYPE OF WORK: GRADING, DRAINAGE, AND CULVERT**

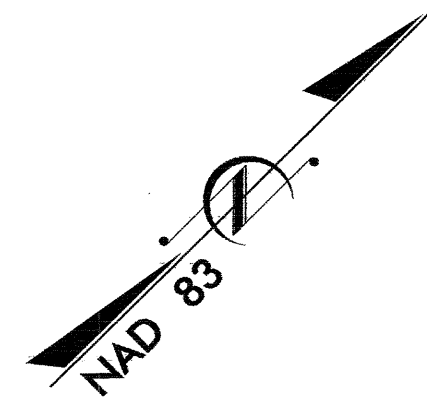

STA. 13+50.00 -L- BEGIN TIP PROJECT B-3900

STA. 20+50.00 -L- END TIP PROJECT B-3900

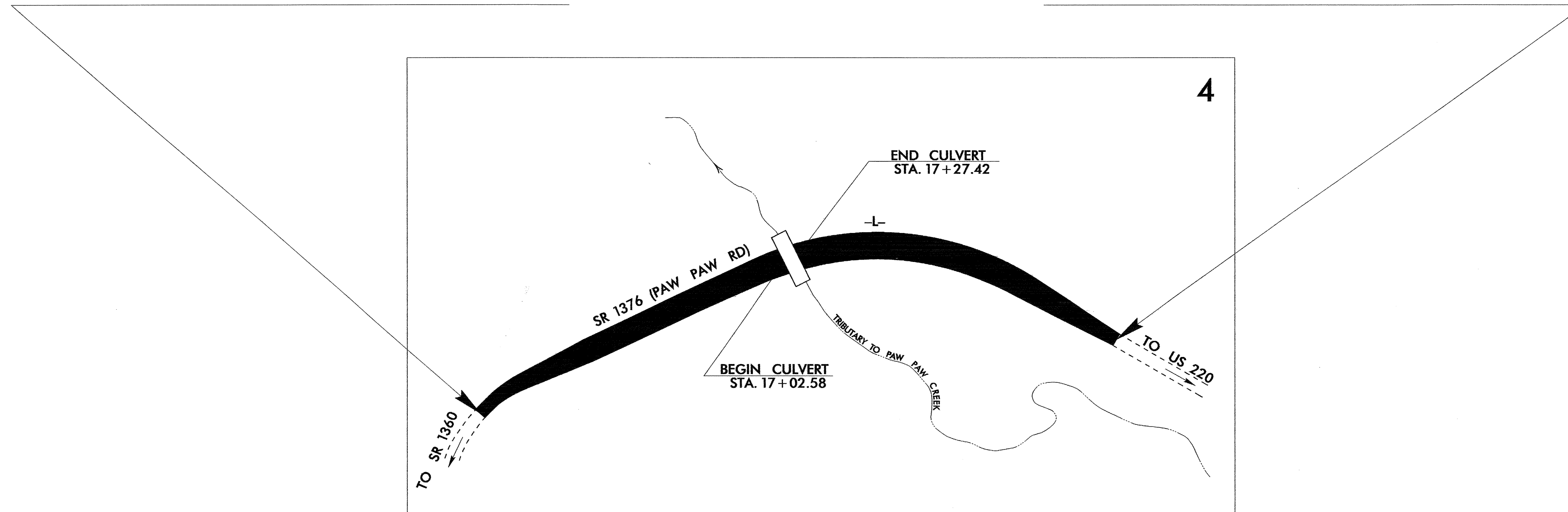

STATE	STATE PROJECT REFERENCE NO.	SHEET NO.	TOTAL SHEETS
N.C.	B-3900	EC-1	
STATE PROJ. NO.	F.A. PROJ. NO.	DESCRIPTION	

EROSION AND SEDIMENT CONTROL MEASURES

Std. #	Description	Symbol
	Streambank Reforestation	
1630.03	Temporary Silt Ditch	
1630.05	Temporary Diversion	
1605.01	Temporary Silt Fence	
1606.01	Special Sediment Control Fence	
1622.01	Temporary Berms and Slope Drains	
1630.01	Riser Basin	
1630.02	Silt Basin Type B	
1633.01	Temporary Rock Silt Check Type-A	
	Temporary Rock Silt Check Type-B	
1634.01	Temporary Rock Sediment Dam Type-A	
1634.02	Temporary Rock Sediment Dam Type-B	
1635.01	Rock Pipe Inlet Sediment Trap Type-A	
1635.02	Rock Pipe Inlet Sediment Trap Type-B	
1630.04	Stilling Basin	
	Rock Inlet Sediment Trap:	
1632.01	Type A	
1632.02	Type B	
1632.03	Type C	
	Skimmer Basin	
	Tiered Skimmer Basin	

**THIS PROJECT CONTAINS
 EROSION CONTROL PLANS
 FOR CLEARING AND
 GRUBBING PHASE OF
 CONSTRUCTION.**

GRAPHIC SCALE

0

PLANS

0

PROFILE (HORIZONTAL)

0

PROFILE (VERTICAL)

ROADSIDE ENVIRONMENTAL UNIT
 DIVISION OF HIGHWAYS
 STATE OF NORTH CAROLINA

Prepared In the Office of:
ROADSIDE ENVIRONMENTAL UNIT
 1 South Wilmington St.
 Raleigh, NC 27611
2006 STANDARD SPECIFICATIONS

Roadway Standard Drawings

The following roadway english standards as appear in "Roadway Standard Drawings"- Roadway Design Unit - N. C. Department of Transportation - Raleigh, N. C., dated July 18, 2006 and the latest revision thereto are applicable to this project and by reference hereby are considered a part of these plans.

1605.01 Temporary Silt Fence	1633.01 Temporary Rock Silt Check Type A
1607.01 Gravel Construction Entrance	1634.02 Temporary Rock Sediment Dam Type B
1622.01 Temporary Berms and Slope Drains	1635.02 Rock Pipe Inlet Sediment Trap Type B
1630.02 Silt Basin Type B	
1630.04 Stilling Basin	
1630.05 Temporary Diversion	

16-FEB-2007 14:41
 john.ferrari@ncdot.gov

PROJECT REFERENCE NO. B-3900	SHEET NO. EC-2
RW SHEET NO.	
ROADWAY DESIGN ENGINEER	HYDRAULICS ENGINEER

TEMPORARY ROCK SILT CHECK TYPE 'B' DETAIL

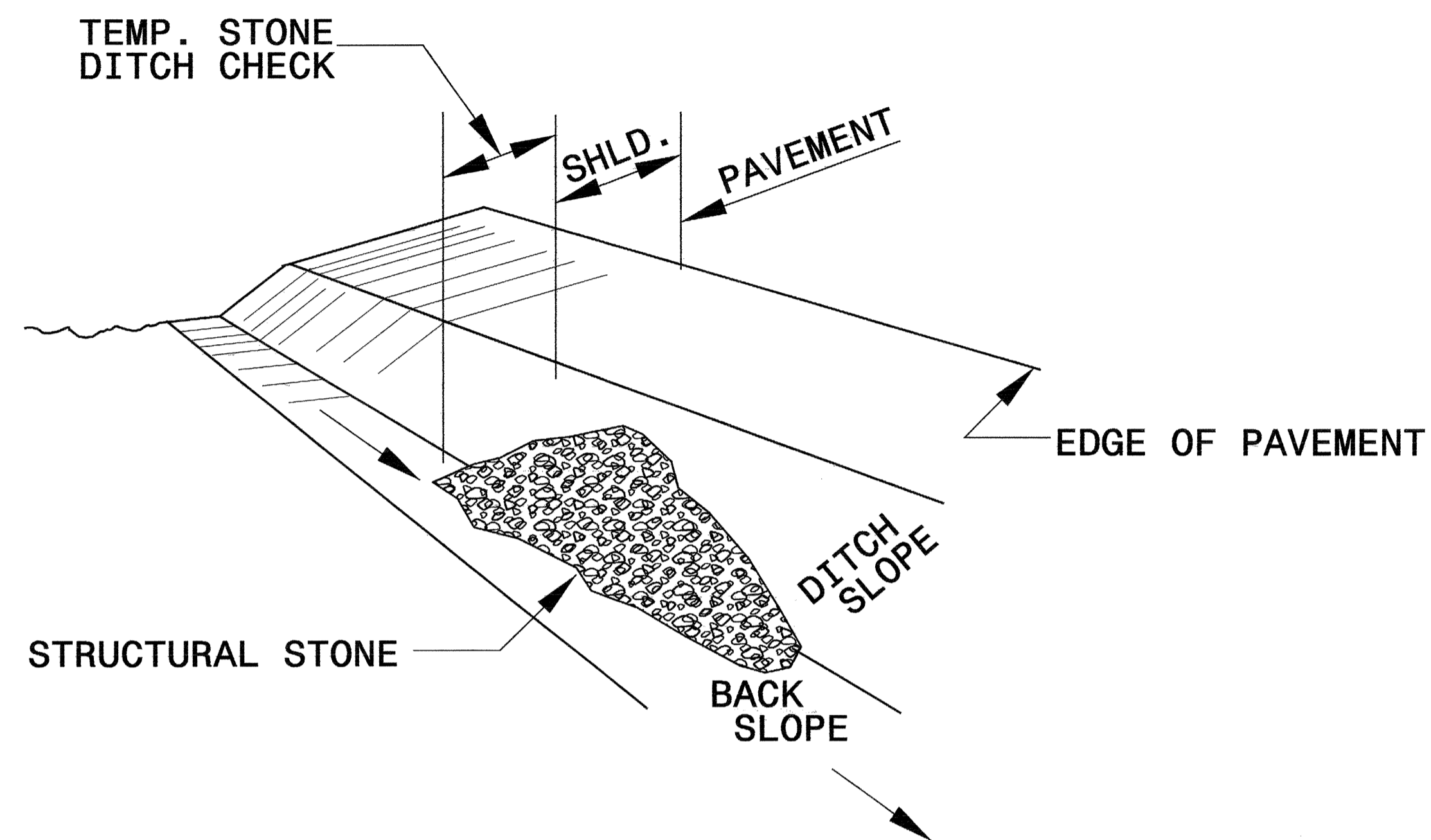

ISOMETRIC VIEW

NOTES:

USE CLASS 'B' EROSION CONTROL STONE FOR STRUCTURAL STONE.

THE ENGINEER MAY DIRECT THE OPTION OF CLASS "A" STONE FOR SITES HAVING LESS THAN ONE (1) ACRE DRAINAGE AREA AND A DITCH GRADE LESS THAN 3%.

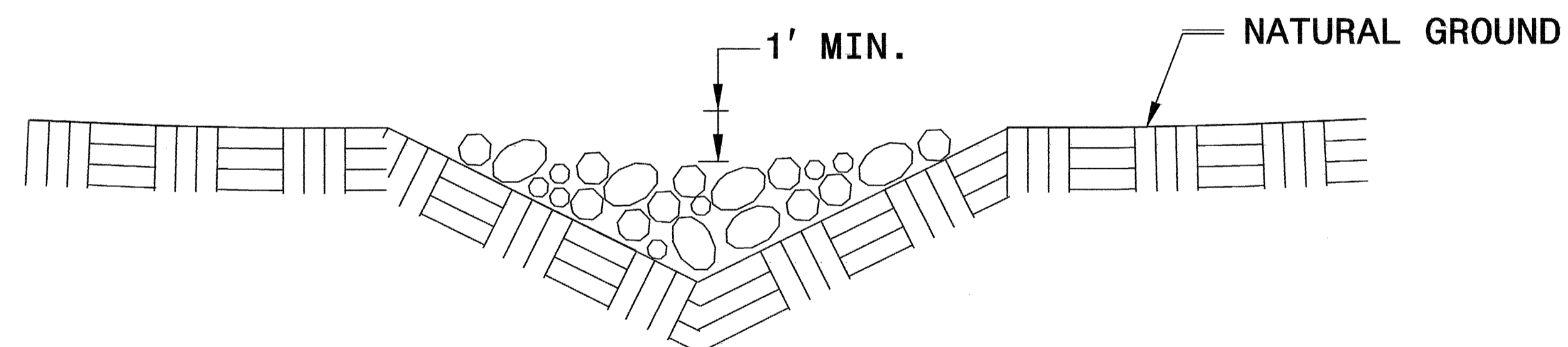

**CROSS SECTION
VEE DITCH**

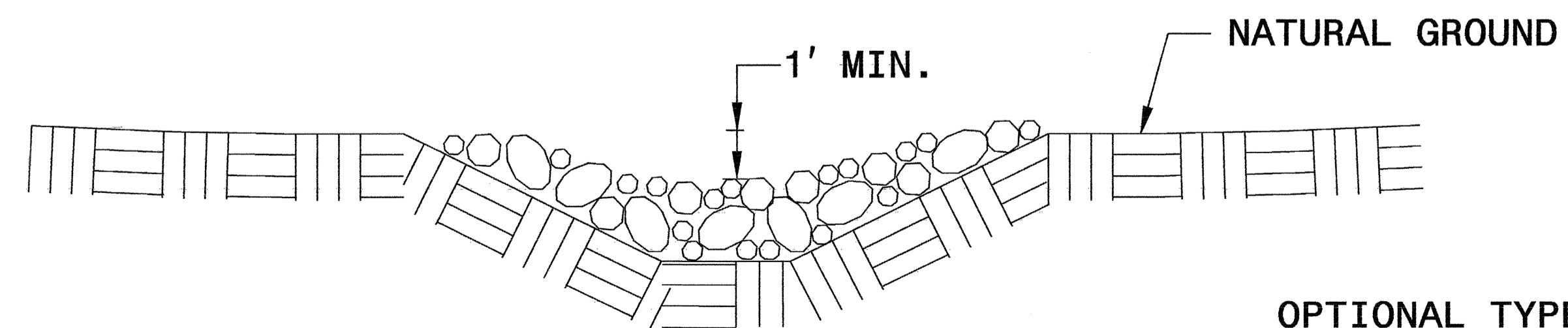

**CROSS SECTION
TRAPEZOIDAL DITCH**

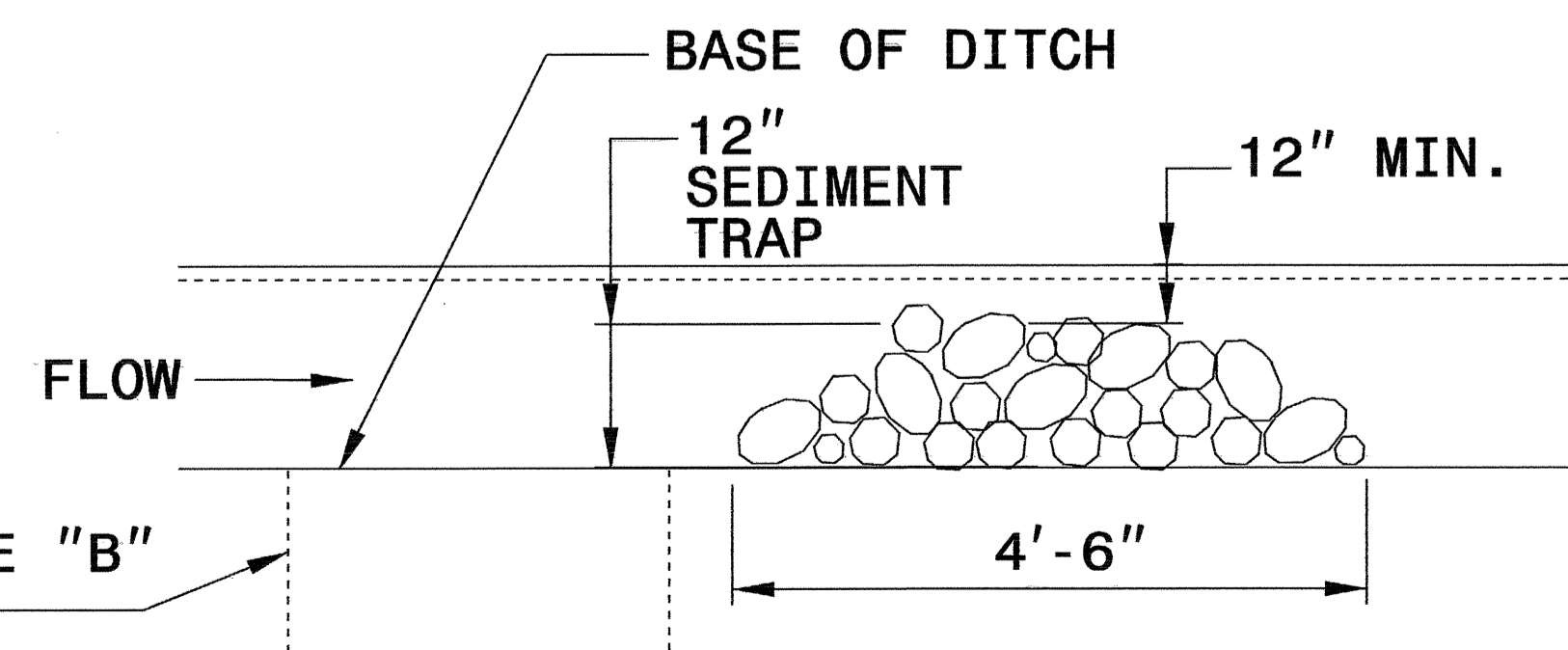

ELEVATION VIEW

PROJECT REFERENCE NO. B-3900	SHEET NO. EC-2A
RW SHEET NO.	
ROADWAY DESIGN ENGINEER	HYDRAULICS ENGINEER

COIR FIBER BAFFLE DETAIL

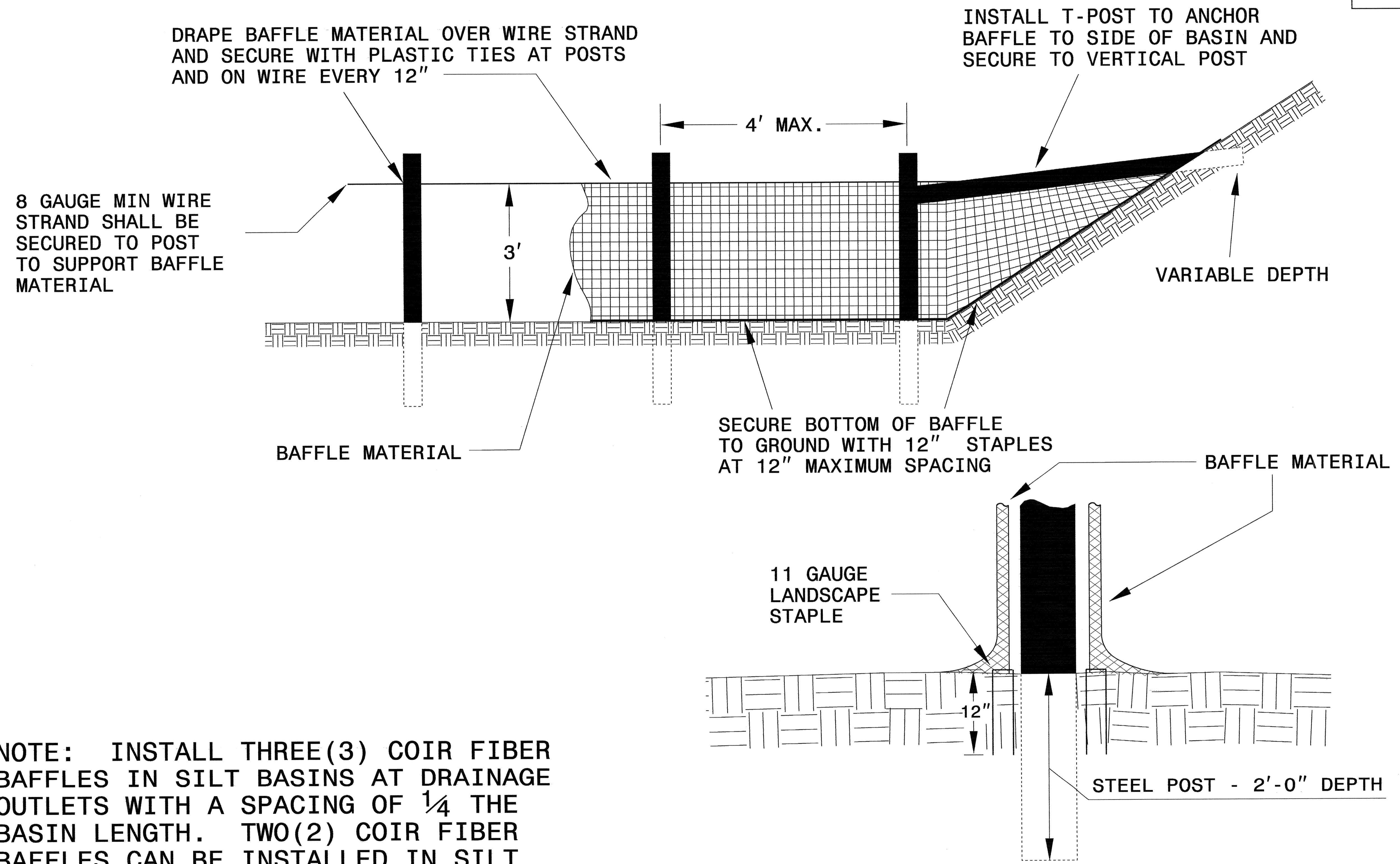

NOTE: INSTALL THREE (3) COIR FIBER BAFFLES IN SILT BASINS AT DRAINAGE OUTLETS WITH A SPACING OF $\frac{1}{4}$ THE BASIN LENGTH. TWO (2) COIR FIBER BAFFLES CAN BE INSTALLED IN SILT BASINS LESS THAN 20 FT. IN LENGTH WITH A SPACING OF $\frac{1}{3}$ THE BASIN LENGTH.

BAFFLE MATERIAL SHALL BE SECURED TO THE BOTTOM AND SIDES OF BASIN USING 12" LANDSCAPE STAPLES

SKIMMER BASIN WITH BAFFLES DETAIL

PROJECT REFERENCE NO. B-3900	SHEET NO. EC-2B
RW SHEET NO.	
ROADWAY DESIGN ENGINEER	HYDRAULICS ENGINEER

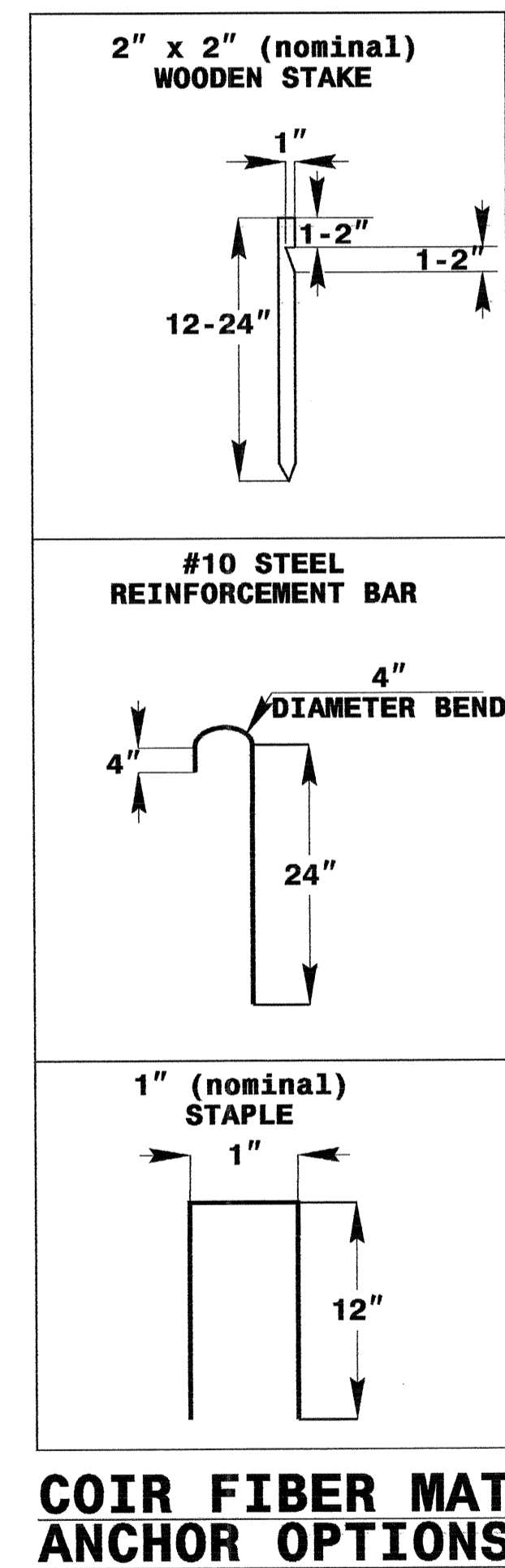
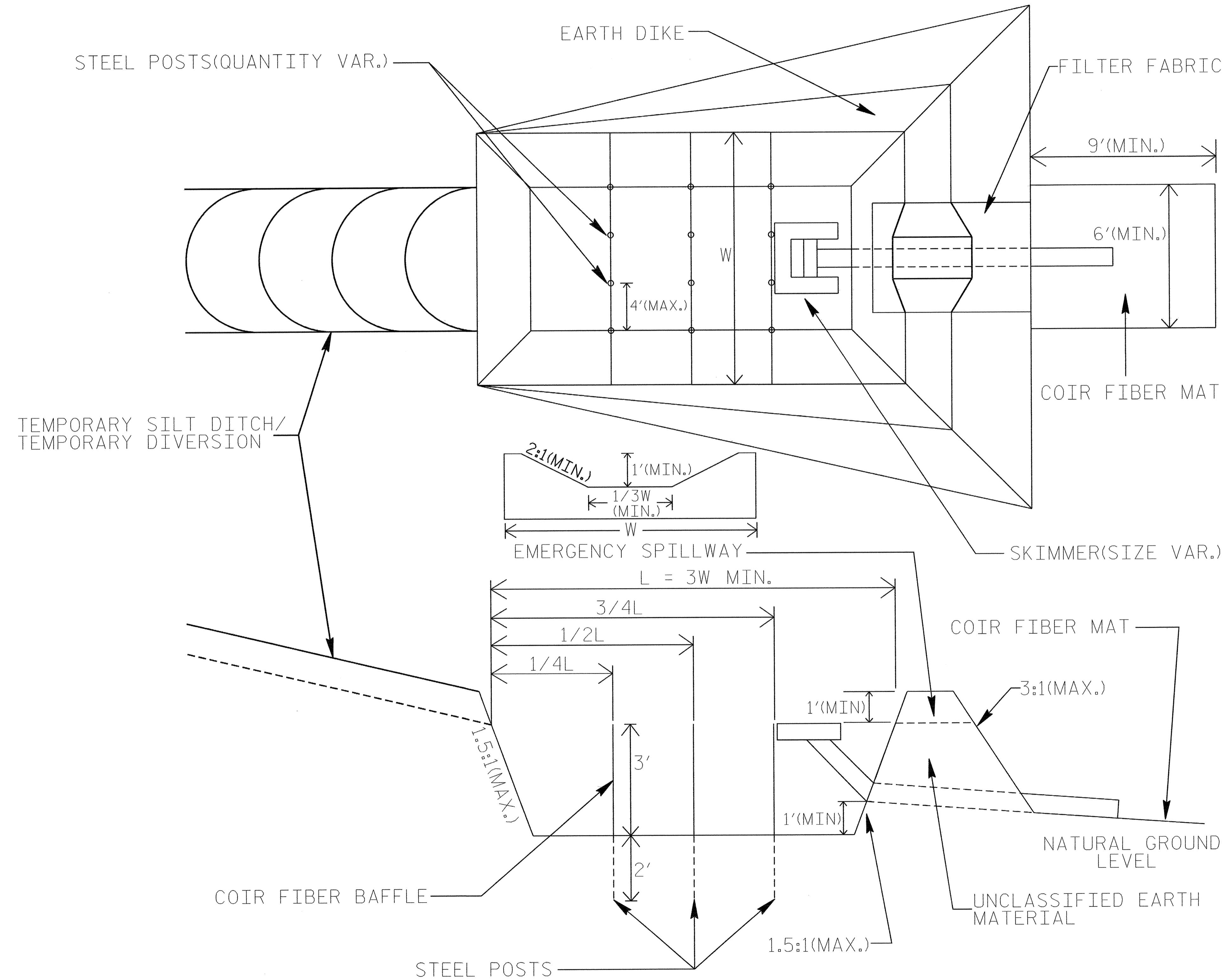

CLEARING AND GRUBBING
EROSION CONTROL FOR
CONSTRUCTION SHEET 4

NOTE:
PLACE TEMPORARY ROCK SEDIMENT DAMS TYPE - B
AND TEMPORARY ROCK SILT CHECKS TYPE - A AT
DRAINAGE OUTLETS.

** NOTE: DESIGN EXCEPTION REQUIRED
FOR DESIGN SPEED (30MPH)

PROJECT REFERENCE NO.	SHEET NO.
B-3900	EC-3/CONST.4
RW SHEET NO.	
ROADWAY DESIGN ENGINEER	HYDRAULICS ENGINEER

STA. 13+50.00 -L- BEGIN STATE PROJECT B-3900

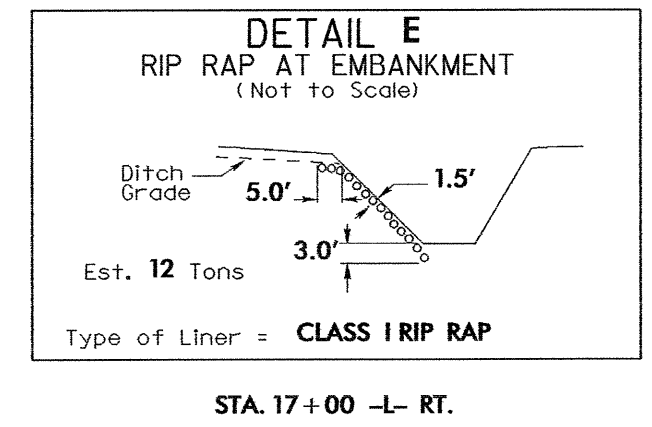
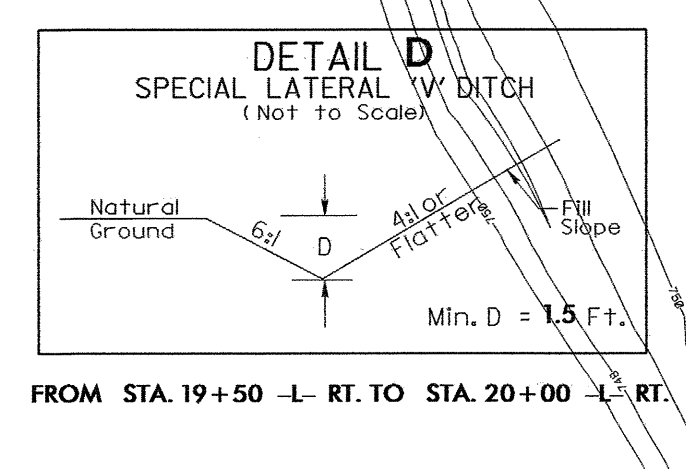
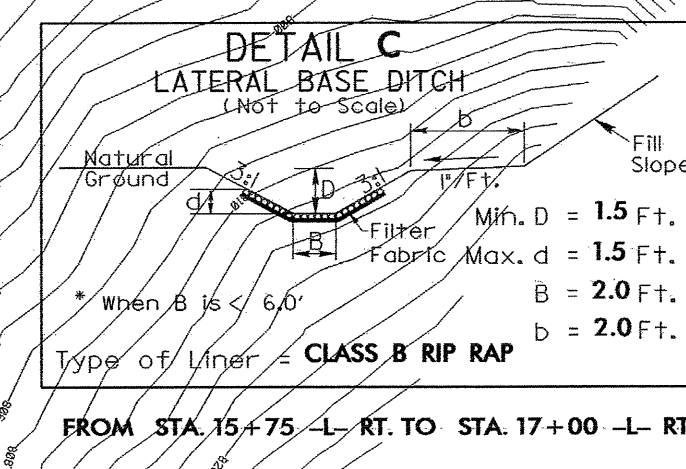
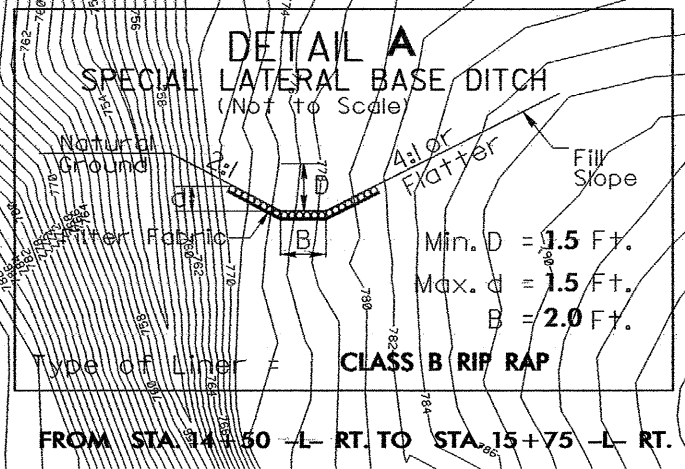
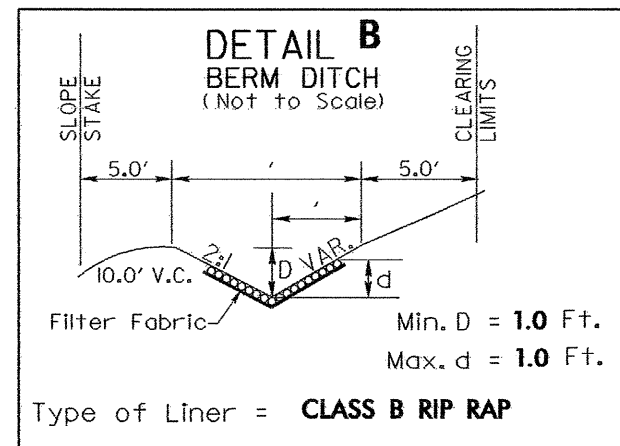
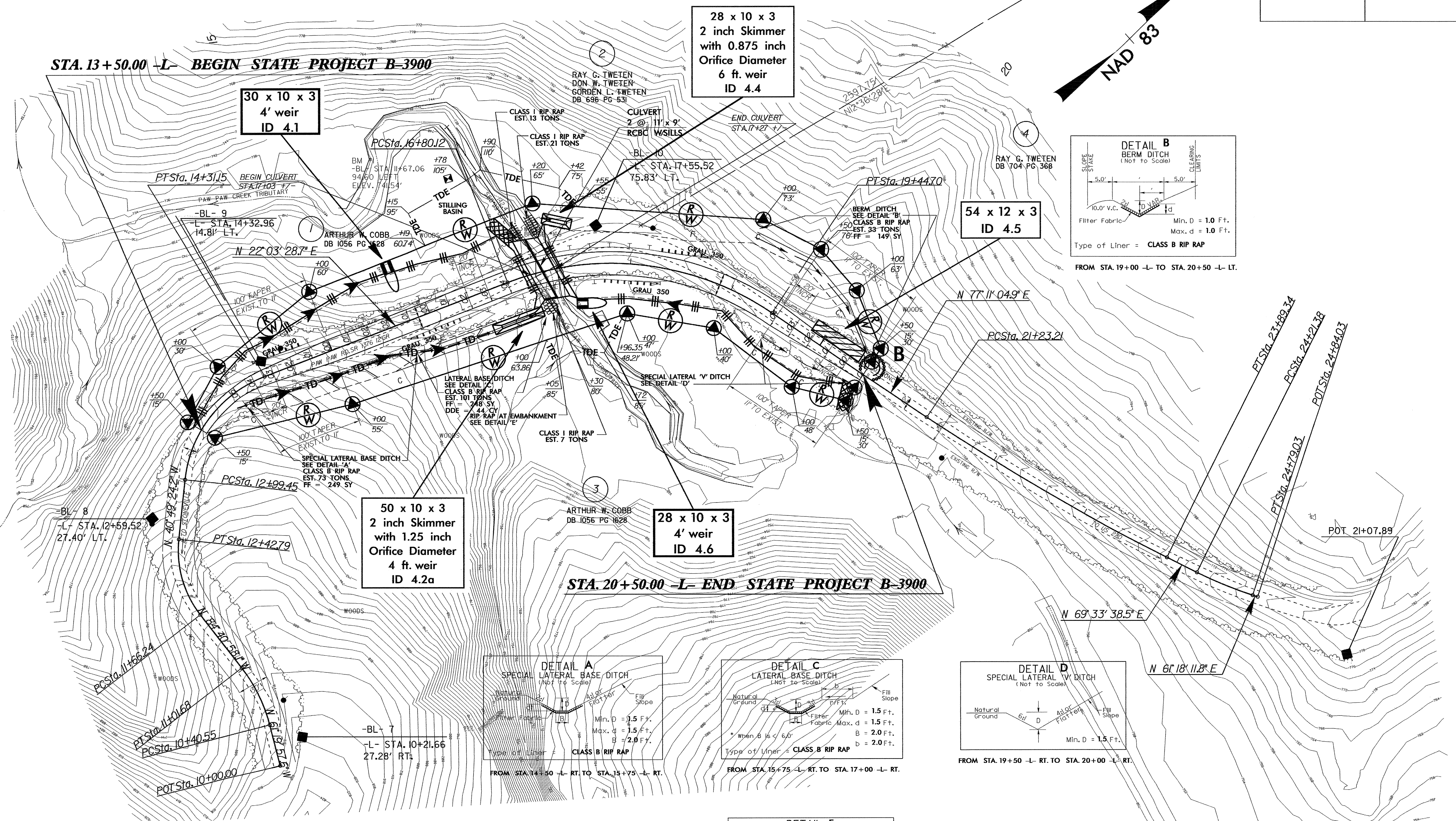

FOR -L- PROFILE SEE SHEET 5
SEE SHEETS C-1 THRU C- FOR CULVERT PLANS

CULVERT CONSTRUCTION SEQUENCE STA. 17+15 -L-

PROJECT REFERENCE NO. B-3900	SHEET NO. EC-4/CONST.4
RW SHEET NO.	
ROADWAY DESIGN ENGINEER	HYDRAULICS ENGINEER

1. CONSTRUCT STILLING BASIN (60 CY).
2. CONSTRUCT TEMPORARY CHANNEL CHANGE WITH LINER (8 FT. BASE, 2 FT. DEEP, 2:1 SIDE SLOPES).
3. CONSTRUCT IMPERVIOUS DIKES, DIVERTING FLOW THROUGH TEMPORARY CHANNEL CHANGE.
4. CONSTRUCT CULVERT, INCLUDING ANY NECESSARY UPSTREAM/DOWNSTREAM CHANNEL IMPROVEMENTS.
5. COMPLETE ROADWAY.

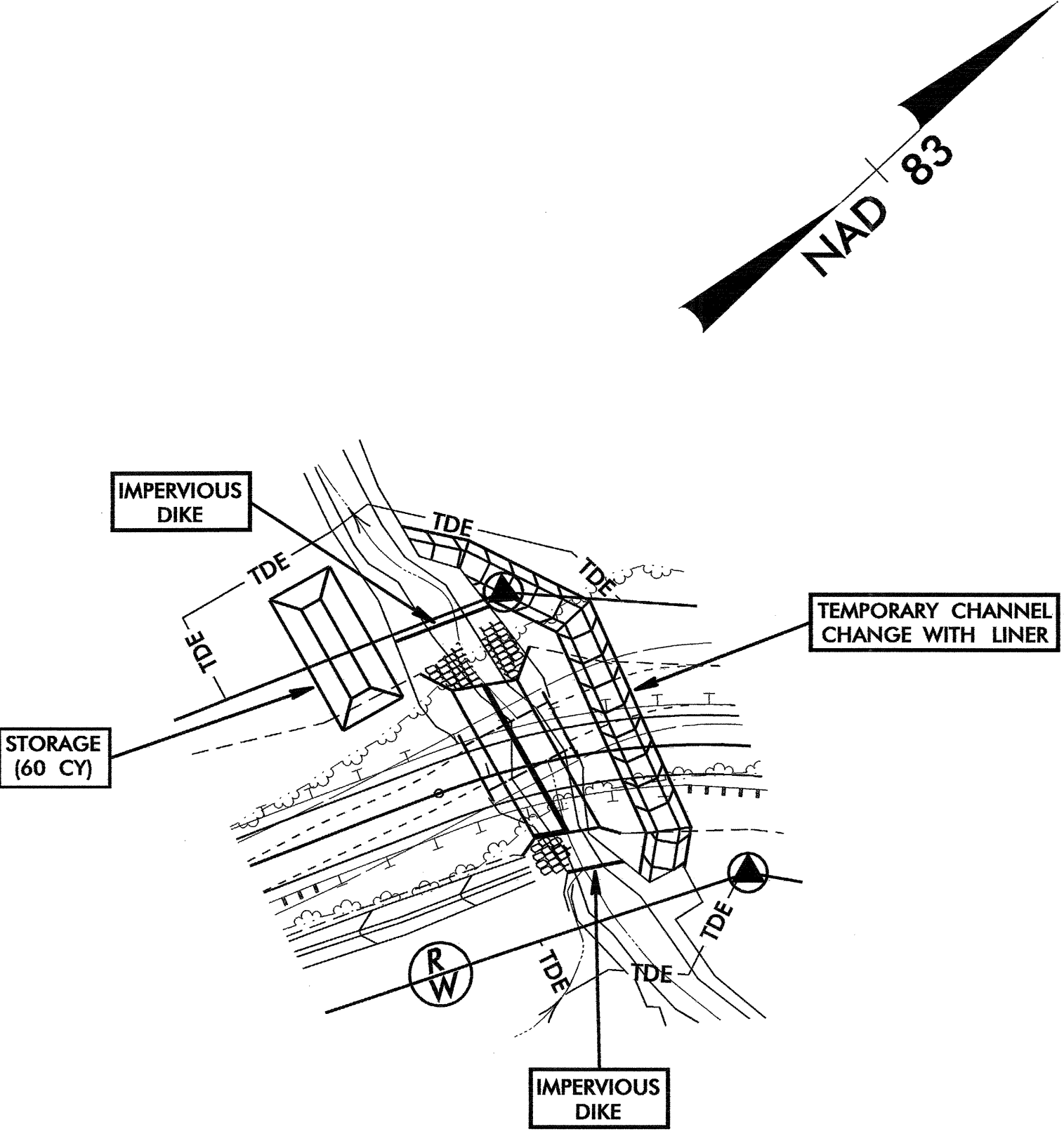

** NOTE: DESIGN EXCEPTION REQUIRED FOR DESIGN SPEED (30MPH)

PROJECT REFERENCE NO.	SHEET NO.
B-3900	EC-5/CONST.4
RW SHEET NO.	
ROADWAY DESIGN ENGINEER	HYDRAULICS ENGINEER

STA. 13+50.00 -L- BEGIN STATE PROJECT B-3900

STA. 20+50.00 -L- END STATE PROJECT B-3900

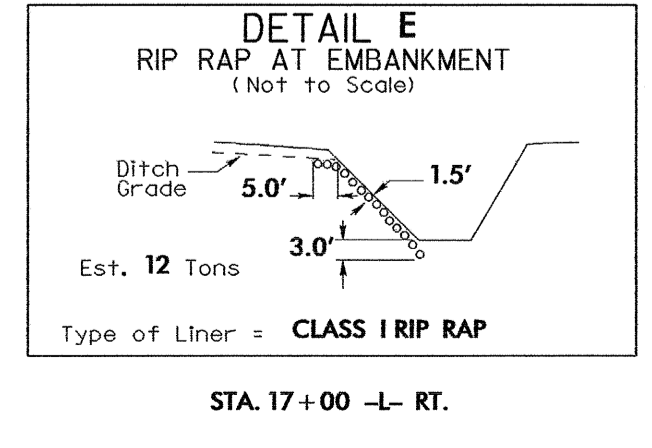
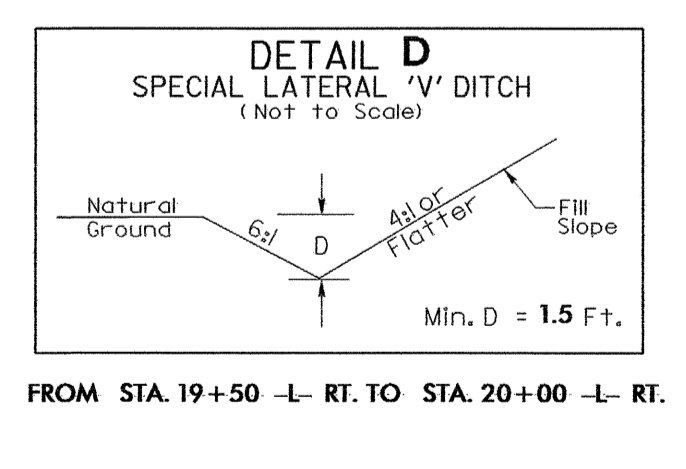
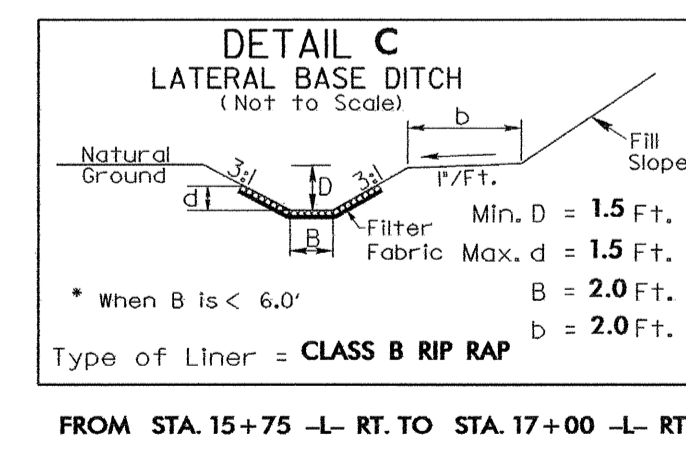
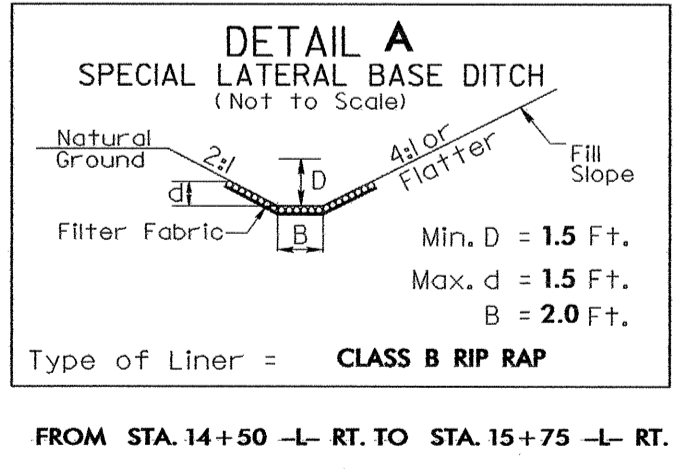
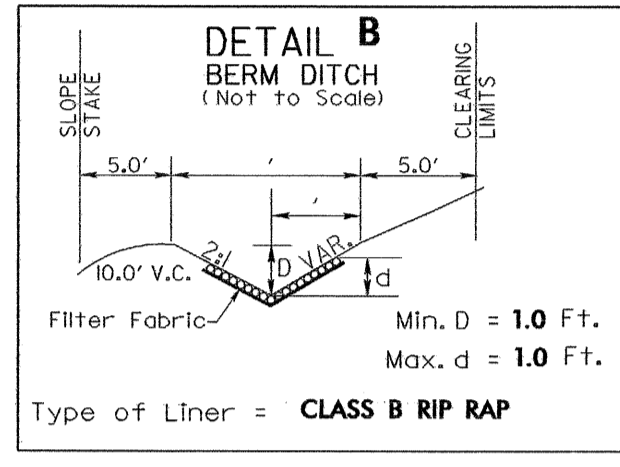
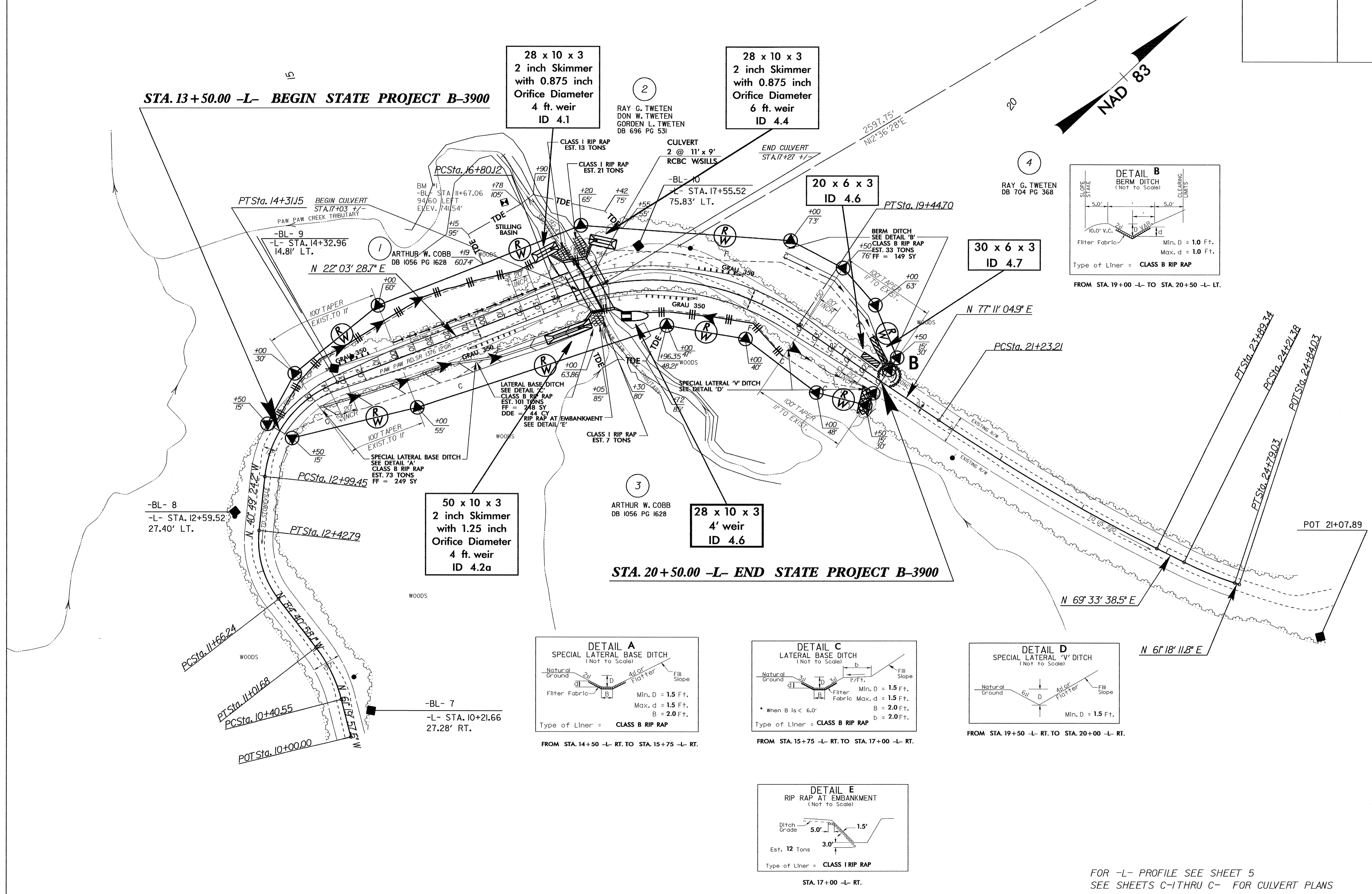

FOR -L- PROFILE SEE SHEET 5
SEE SHEETS C-1 THRU C- FOR CULVERT PLANS