

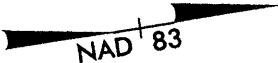







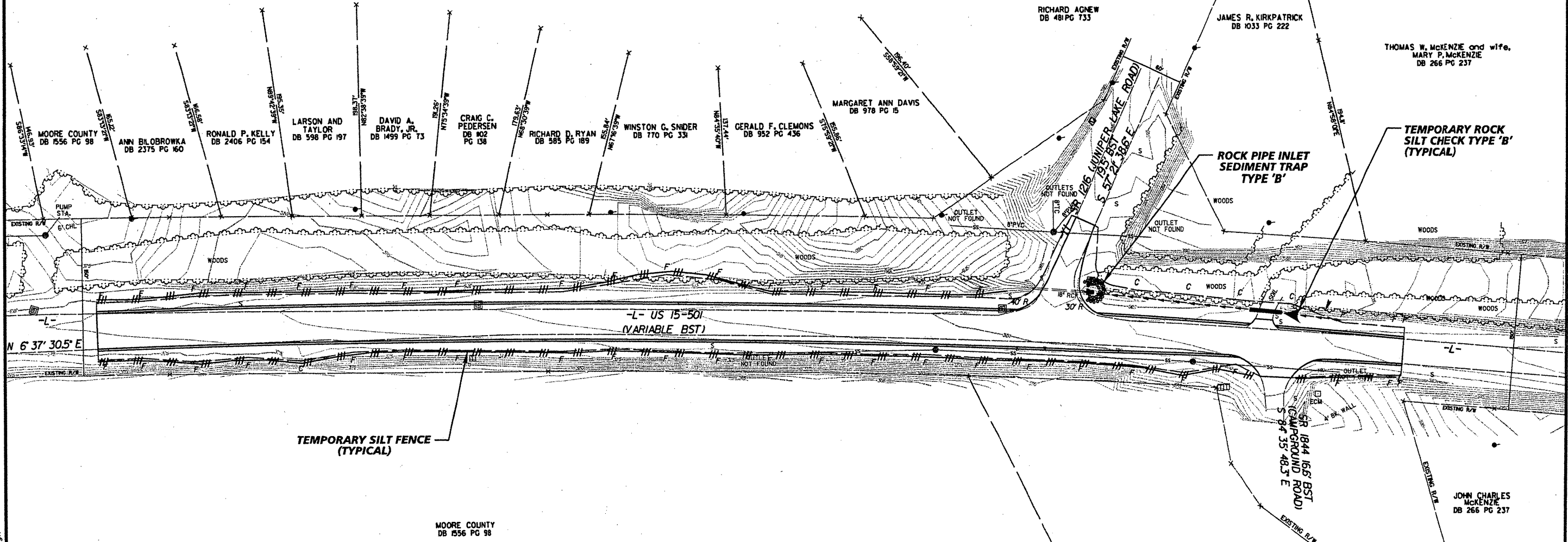

REVISIONS

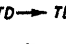
	PROJECT REFERENCE NO. WBS 37620	SHEET NO. ERO-1
	RW SHEET NO.	
	ROADWAY DESIGN ENGINEER	
		
P.O. BOX 33068 RALEIGH, N.C. 27636-3068		
RIGHT-OF-WAY REV.		
CONST. REV.		

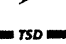
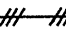
EROSION CONTROL PLAN











LEGEND	
	TEMPORARY ROCK SEDIMENT DAM TYPE 'B' STANDARD DRAWING 1634.02
	TEMPORARY DIVERSION STANDARD DRAWING 1630.05
	ROCK PIPE INLET SEDIMENT TRAP TYPE 'B' STANDARD DRAWING 1635.01
	TEMPORARY ROCK SILT CHECK TYPE 'B' STANDARD DRAWING 1633.02
	TEMPORARY SLOPE DRAIN STANDARD DRAWING 1622.01
	TEMPORARY SILT FENCE STANDARD DRAWING 1605.01
	TEMPORARY SILT BASIN TYPE-B STANDARD DRAWING 1630.02
	TEMPORARY ROCK SILT SCREEN STANDARD DRAWING 1636.01
	ROCK INLET SEDIMENT TRAP TYPE 'B' OR TYPE 'C' STANDARD DRAWING 1632.02 AND 1632.03

**INTERSECTION #1
SR 1216 (JUPITER LAKE ROAD)**

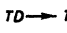
r:\01056067\roadway\mcd08032r_roy_ero-1.dgn 11/16/2006

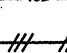
REVISIONS

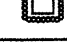
PROJECT REFERENCE NO. WBS 37820	SHEET NO. ERO-3
RW SHEET NO.	
ROADWAY DESIGN ENGINEER	
	
Kimley-Horn and Associates, Inc. P.O. BOX 33068 RALEIGH, N.C. 27636-3068	
<small>ROADWAY REV.</small> <small>CONST. REV.</small>	

LEGEND	
	TEMPORARY ROCK SEDIMENT DAM TYPE 'B' STANDARD DRAWING 1634.02
	TEMPORARY DIVERSION STANDARD DRAWING 1630.05
	ROCK PIPE INLET SEDIMENT TRAP TYPE 'B' STANDARD DRAWING 1635.01
	TEMPORARY ROCK SILT CHECK TYPE 'B' STANDARD DRAWING 1622.02
	TEMPORARY SLOPE DRAIN STANDARD DRAWING 1622.01
	TEMPORARY SILT FENCE STANDARD DRAWING 1605.01
	TEMPORARY SILT BASIN TYPE 'B' STANDARD DRAWING 1630.02
	TEMPORARY ROCK SILT SCREEN STANDARD DRAWING 1636.01
	ROCK INLET SEDIMENT TRAP TYPE 'B' OR TYPE 'C' STANDARD DRAWING 1632.02 AND 1632.03

EROSION CONTROL PLAN

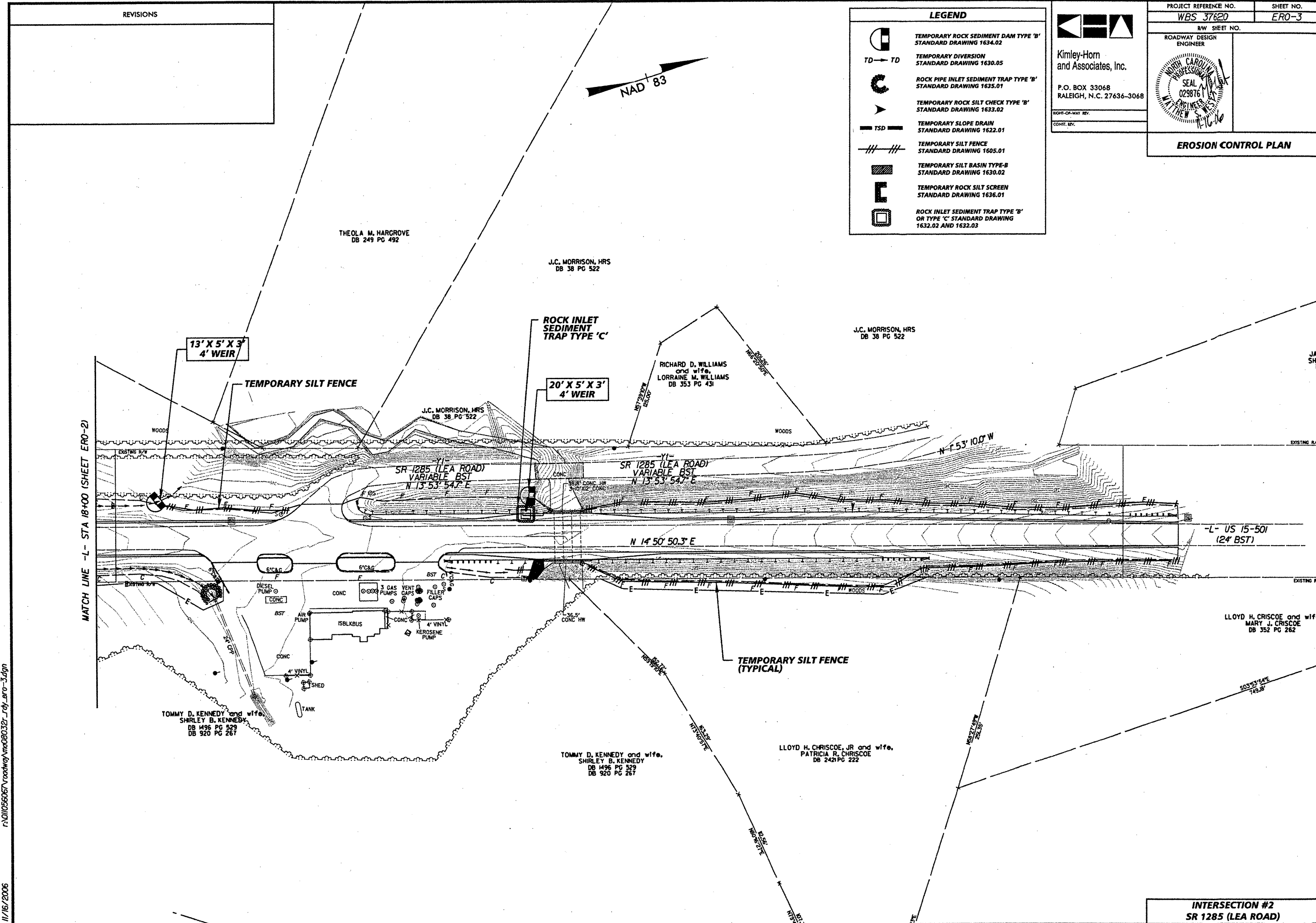

**INTERSECTION #2
SR 1285 (LEA ROAD)**

11/16/2006

REVISIONS



LEGEND	
	TEMPORARY ROCK SEDIMENT DAM TYPE 'B' STANDARD DRAWING 1634.02
	TEMPORARY DIVERSION STANDARD DRAWING 1630.05
	ROCK PIPE INLET SEDIMENT TRAP TYPE 'B' STANDARD DRAWING 1635.01
	TEMPORARY ROCK SILT CHECK TYPE 'B' STANDARD DRAWING 1633.02
	TEMPORARY SLOPE DRAIN STANDARD DRAWING 1622.01
	TEMPORARY SILT FENCE STANDARD DRAWING 1605.01
	TEMPORARY SILT BASIN TYPE-B STANDARD DRAWING 1630.02
	TEMPORARY ROCK SILT SCREEN STANDARD DRAWING 1636.01
	ROCK INLET SEDIMENT TRAP TYPE 'B' OR TYPE 'C' STANDARD DRAWING 1632.02 AND 1632.03

PROJECT REFERENCE NO. WBS 37620	SHEET NO. ERO-4
RW SHEET NO.	
ROADWAY DESIGN ENGINEER	
EROSION CONTROL PLAN	

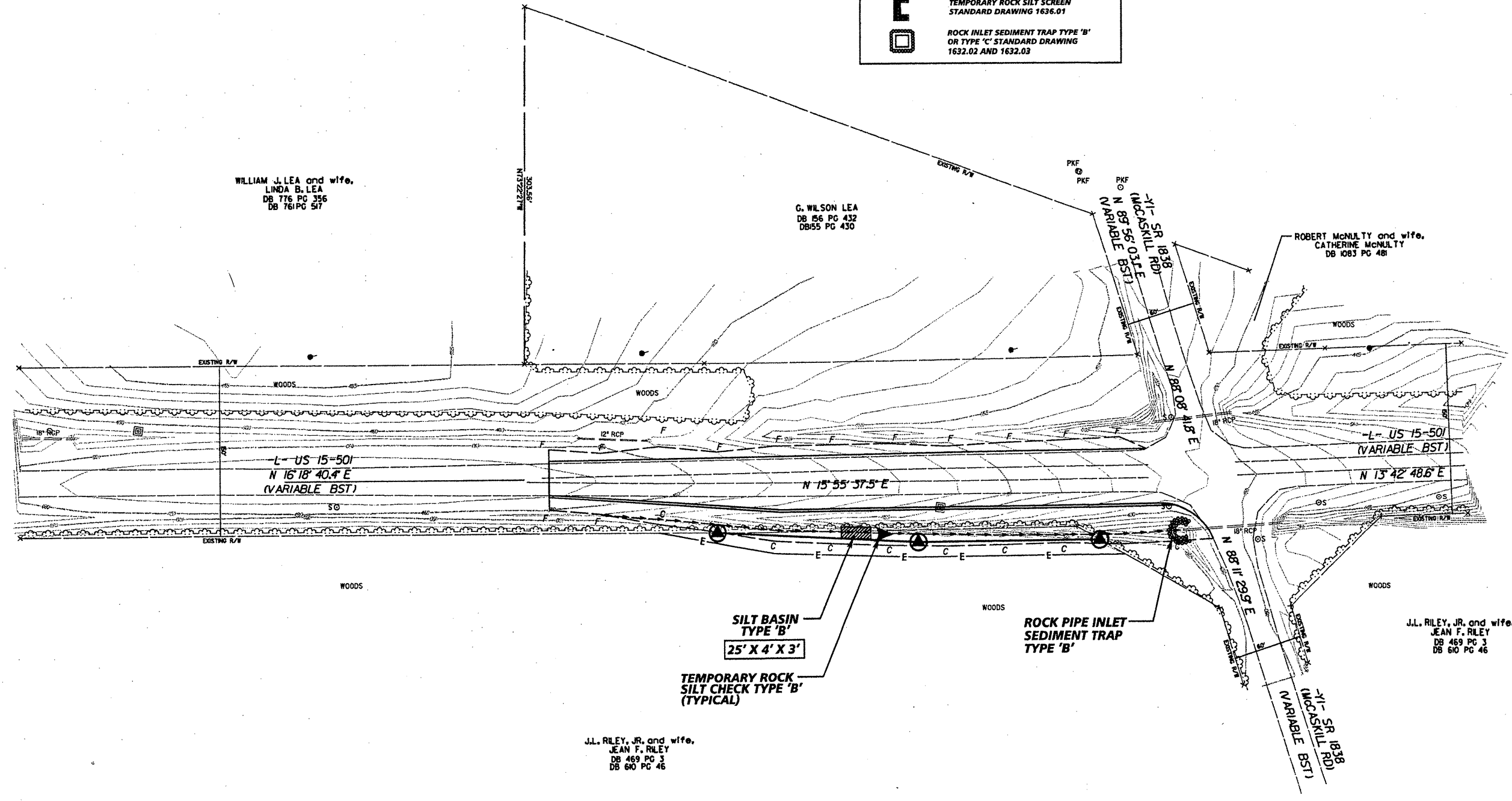

11/16/2006
 F:\01056067\roadway\mc080321_roy_ero-4.dgn

INTERSECTION #3
SR 1838 (McCASKILL ROAD)

REVISIONS

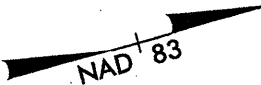

LAIVORA SALLY EHRHARDT and husband,
HERBERT W. EHRHARDT, JR.
DB 344 PG 84

JOHNNY MICHAEL BLACK
DB 1490 PG 331

LEGEND	
	TEMPORARY ROCK SEDIMENT DAM TYPE 'B' STANDARD DRAWING 1634.02
	TEMPORARY DIVERSION STANDARD DRAWING 1630.05
	ROCK PIPE INLET SEDIMENT TRAP TYPE 'B' STANDARD DRAWING 1635.01
	TEMPORARY ROCK SILT CHECK TYPE 'B' STANDARD DRAWING 1633.02
	TEMPORARY SLOPE DRAIN STANDARD DRAWING 1622.01
	TEMPORARY SILT FENCE STANDARD DRAWING 1605.01
	TEMPORARY SILT BASIN TYPE 'B' STANDARD DRAWING 1630.02
	TEMPORARY ROCK SILT SCREEN STANDARD DRAWING 1636.01
	ROCK INLET SEDIMENT TRAP TYPE 'B' OR TYPE 'C' STANDARD DRAWING 1632.02 AND 1632.03

Kimley-Horn
and Associates, Inc.
P.O. BOX 33068
RALEIGH, N.C. 27636-3068

ROADWAY DESIGN
ENGINEER

SEAL
029876
MATTHEW S. WELLS
ENGINEER

PROJECT REFERENCE NO. WBS 37620	SHEET NO. ERO-5
RW SHEET NO.	
ROADWAY DESIGN ENGINEER	
EROSION CONTROL PLAN	

RONNIE S. WILLIAMS
DB 517 PG 839

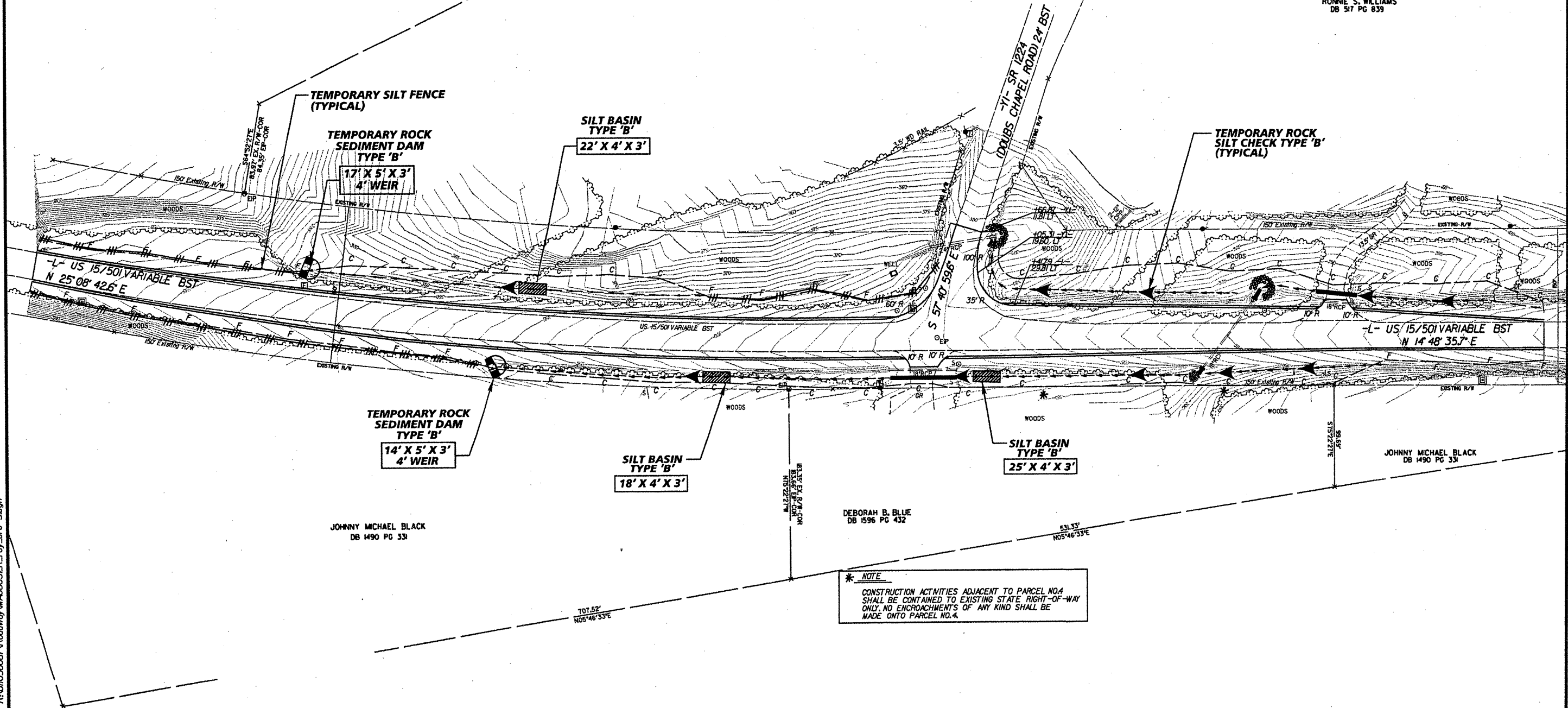

JOHNNY MICHAEL BLACK
DB 1490 PG 331

DEBORAH B. BLUE
DB 1596 PG 432







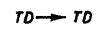

JOHNNY MICHAEL BLACK
DB 1490 PG 331

* NOTE
CONSTRUCTION ACTIVITIES ADJACENT TO PARCEL NO.4
SHALL BE CONTAINED TO EXISTING STATE RIGHT-OF-WAY
ONLY. NO ENCROACHMENTS OF ANY KIND SHALL BE
MADE ONTO PARCEL NO.4.

R:\01056067\Roadway\MA08032R_rdy_ero-5.dgn
1/11/2007

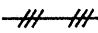
REVISIONS

PROJECT REFERENCE NO. WBS 37620	SHEET NO. ERO-6
RW SHEET NO.	
ROADWAY DESIGN ENGINEER	
	
Kimley-Horn and Associates, Inc. P.O. BOX 33068 RALEIGH, N.C. 27636-3068	
RIGHT-OF-WAY REV.	
CONST. REV.	

LEGEND	
	TEMPORARY ROCK SEDIMENT DAM TYPE 'B' STANDARD DRAWING 1634.02
	TEMPORARY DIVERSION STANDARD DRAWING 1630.05
	ROCK PIPE INLET SEDIMENT TRAP TYPE 'B' STANDARD DRAWING 1635.01
	TEMPORARY ROCK SILT CHECK TYPE 'B' STANDARD DRAWING 1633.02
	TEMPORARY SLOPE DRAIN STANDARD DRAWING 1622.01
	TEMPORARY SILT FENCE STANDARD DRAWING 1605.01
	TEMPORARY SILT BASIN TYPE-B STANDARD DRAWING 1630.02
	TEMPORARY ROCK SILT SCREEN STANDARD DRAWING 1636.01
	ROCK INLET SEDIMENT TRAP TYPE 'B' OR TYPE 'C' STANDARD DRAWING 1632.02 AND 1632.03

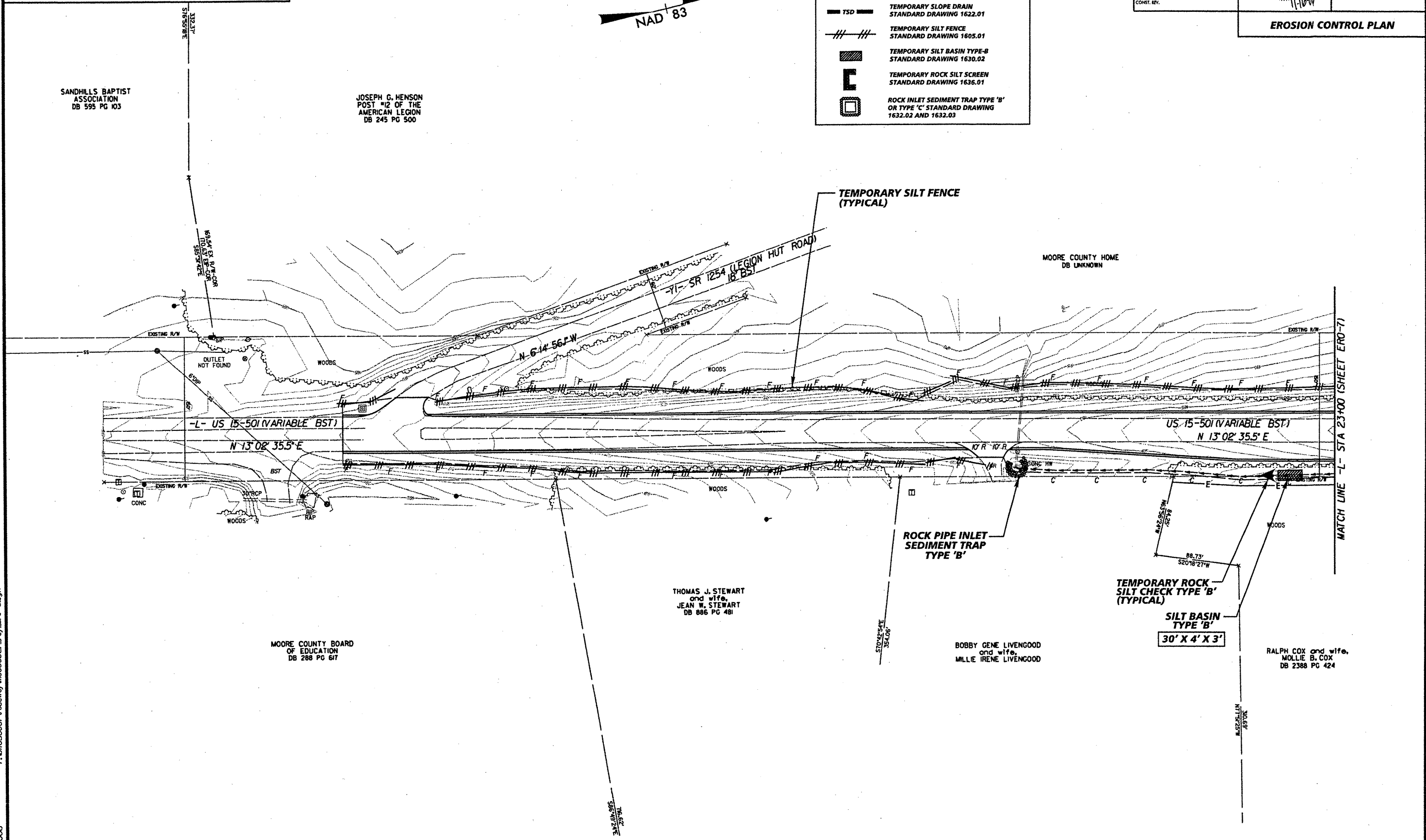
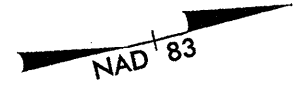

SANDHILLS BAPTIST ASSOCIATION
DB 595 PG 103

JOSEPH G. HENSON
POST #12 OF THE AMERICAN LEGION
DB 245 PG 500

MOORE COUNTY HOME
DB UNKNOWN

THOMAS J. STEWART and wife,
JEAN W. STEWART
DB 886 PG 481

BOBBY GENE LIVENGOOD and wife,
MILLIE IRENE LIVENGOOD

RALPH COX and wife,
MOLLIE B. COX
DB 2388 PG 424







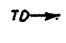

MOORE COUNTY BOARD OF EDUCATION
DB 288 PG 617

INTERSECTION #5
SR 1883 (JOEL ROAD)

11/16/2006 F:\01056067\roadway\m080321_rdy_ero-6.dgn

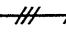
REVISIONS

LEGEND

-  TEMPORARY ROCK SEDIMENT DAM TYPE 'B'
STANDARD DRAWING 1634.02
-  TD → TD
TEMPORARY DIVERSION
STANDARD DRAWING 1630.03
-  ROCK PIPE INLET SEDIMENT TRAP TYPE 'B'
STANDARD DRAWING 1635.01
-  TEMPORARY ROCK SILT CHECK TYPE 'B'
STANDARD DRAWING 1633.02
-  TD TD
TEMPORARY SLOPE DRAIN
STANDARD DRAWING 1632.01
-  // //
TEMPORARY SILT FENCE
STANDARD DRAWING 1605.01
-  TEMPORARY SILT BASIN TYPE 'B'
STANDARD DRAWING 1630.02
-  TEMPORARY ROCK SILT SCREEN
STANDARD DRAWING 1636.01
-  ROCK INLET SEDIMENT TRAP TYPE 'B'
OR TYPE 'C' STANDARD DRAWING
1632.02 AND 1632.03



Kimley-Horn
and Associates, Inc.
P.O. BOX 33068
RALEIGH, N.C. 27636-3068

PROJECT REFERENCE NO. WBS 37620	SHEET NO. ERO-7
RW SHEET NO.	
	
EROSION CONTROL PLAN	

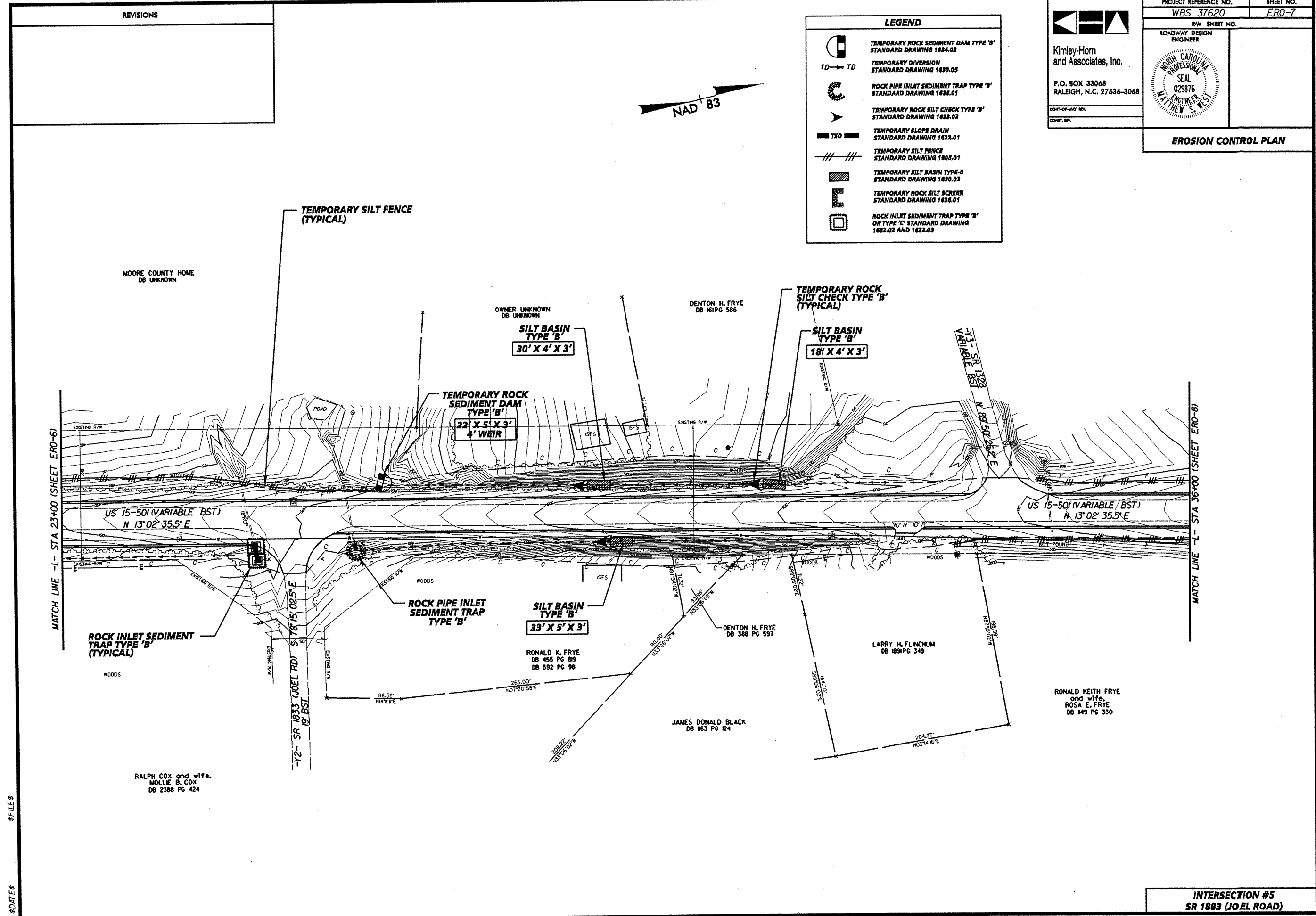
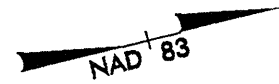

\$FILES \$DATES

**INTERSECTION #5
SR 1883 (JOEL ROAD)**

REVISIONS

LEGEND	
	TEMPORARY ROCK SEDIMENT DAM TYPE 'B' STANDARD DRAWING 1634.02
	TEMPORARY DIVERSION STANDARD DRAWING 1630.05
	ROCK PIPE INLET SEDIMENT TRAP TYPE 'B' STANDARD DRAWING 1635.01
	TEMPORARY ROCK SILT CHECK TYPE 'B' STANDARD DRAWING 1633.02
	TEMPORARY SLOPE DRAIN STANDARD DRAWING 1622.01
	TEMPORARY SILT FENCE STANDARD DRAWING 1605.01
	TEMPORARY SILT BASIN TYPE-B STANDARD DRAWING 1630.02
	TEMPORARY ROCK SILT SCREEN STANDARD DRAWING 1636.01
	ROCK INLET SEDIMENT TRAP TYPE 'B' OR TYPE 'C' STANDARD DRAWING 1632.02 AND 1632.03

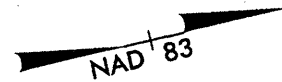

FREDERICK EUGENE SNEATH
DB 538 PG 663

Kimley-Horn
and Associates, Inc.

P.O. BOX 33068
RALEIGH, N.C. 27636-3068

RIGHT-OF-WAY REV.
CONST. REV.

PROJECT REFERENCE NO. WBS 37620	SHEET NO. ERO-8
RW SHEET NO.	
ROADWAY DESIGN ENGINEER	

EROSION CONTROL PLAN

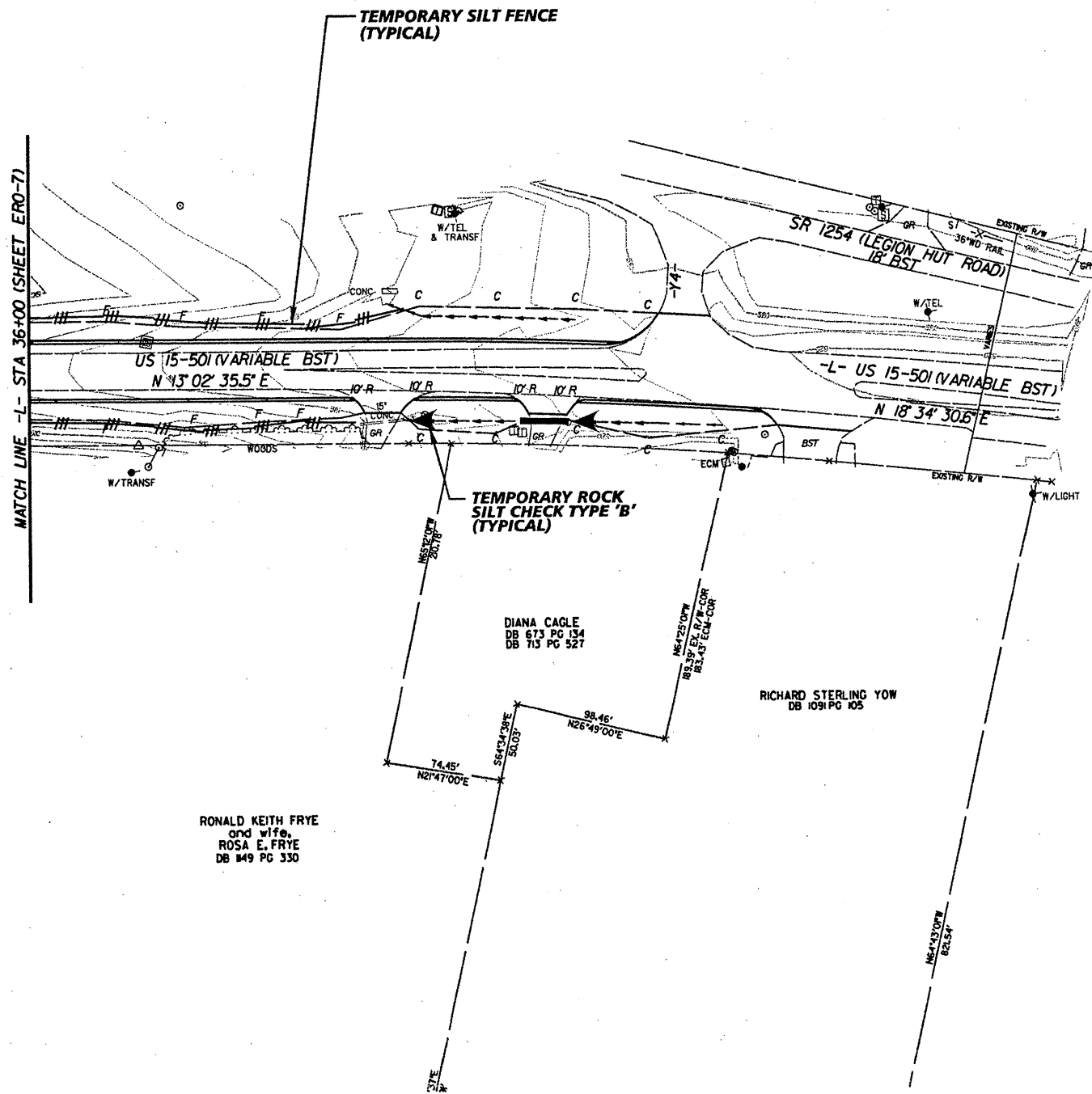

r:\311056067\roadway\mcd0321_rdy_ero-8.dgn

11/16/2006

**INTERSECTION #5
SR 1883 (JOEL ROAD)**

REVISIONS

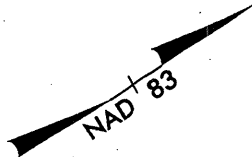

LEGEND	
	TEMPORARY ROCK SEDIMENT DAM TYPE 'B' STANDARD DRAWING 1634.02
	TEMPORARY DIVERSION STANDARD DRAWING 1630.05
	ROCK PIPE INLET SEDIMENT TRAP TYPE 'B' STANDARD DRAWING 1633.01
	TEMPORARY ROCK SILT CHECK TYPE 'B' STANDARD DRAWING 1633.02
	TEMPORARY SLOPE DRAIN STANDARD DRAWING 1622.01
	TEMPORARY SILT FENCE STANDARD DRAWING 1605.01
	TEMPORARY SILT BASIN TYPE-B STANDARD DRAWING 1630.02
	TEMPORARY ROCK SILT SCREEN STANDARD DRAWING 1636.01
	ROCK INLET SEDIMENT TRAP TYPE 'B' OR TYPE 'C' STANDARD DRAWING 1632.02 AND 1632.03



Kimley-Horn
and Associates, Inc.
P.O. BOX 33068
RALEIGH, N.C. 27636-3068

PROJECT REFERENCE NO. WBS 37620	SHEET NO. ERO-8A
ROADWAY DESIGN ENGINEER	HYDRAULICS ENGINEER

EROSION CONTROL PLAN

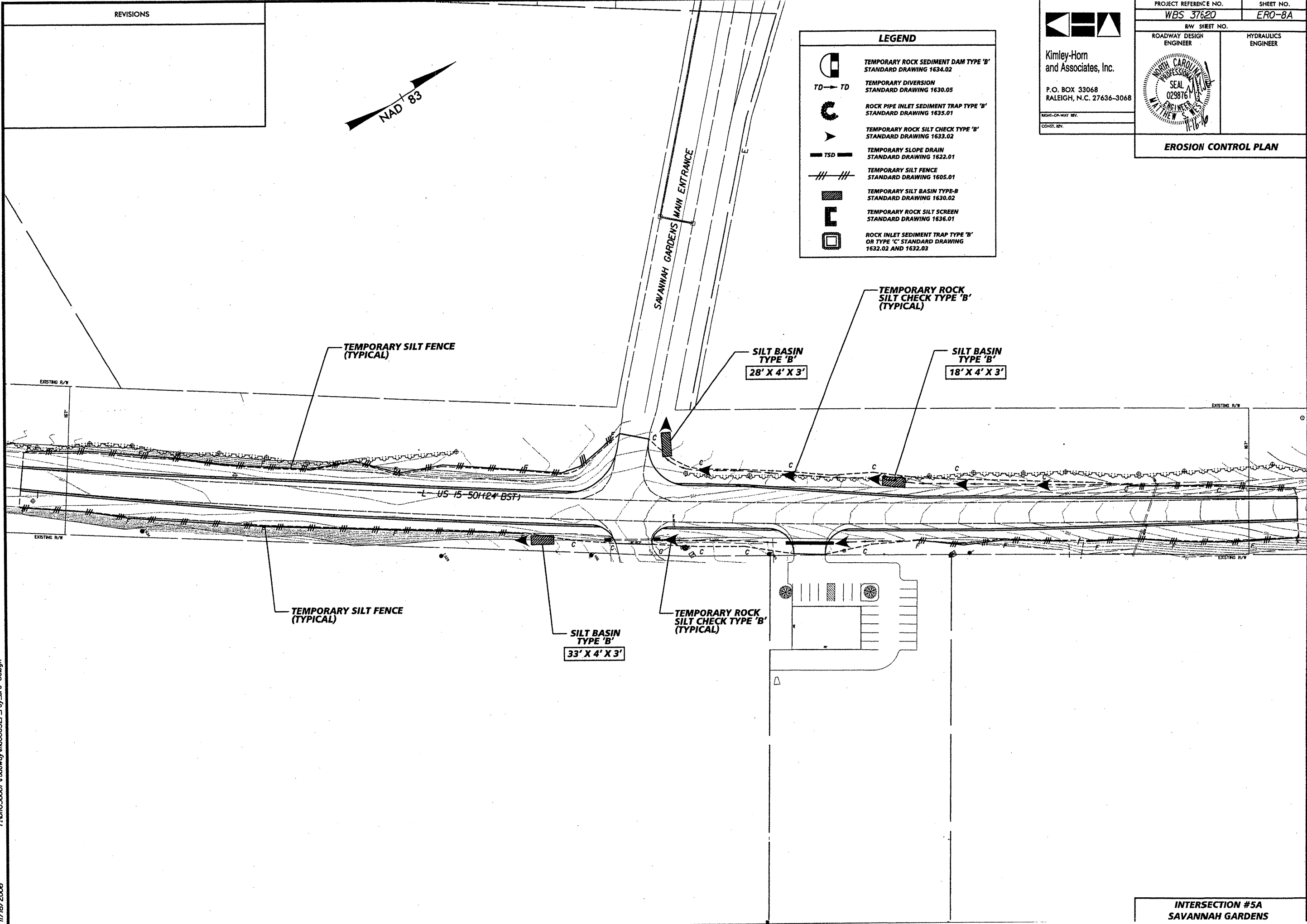

r:\01056067\roadway\mc080321_rdy_ero-Budgn

11/16/2006

**INTERSECTION #5A
SAVANNAH GARDENS**

REVISIONS

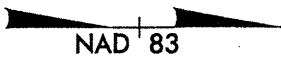

LEGEND	
	TEMPORARY ROCK SEDIMENT DAM TYPE 'B' STANDARD DRAWING 1634.02
	TEMPORARY DIVERSION STANDARD DRAWING 1630.05
	ROCK PIPE INLET SEDIMENT TRAP TYPE 'B' STANDARD DRAWING 1635.01
	TEMPORARY ROCK SILT CHECK TYPE 'B' STANDARD DRAWING 1633.02
	TEMPORARY SLOPE DRAIN STANDARD DRAWING 1622.01
	TEMPORARY SILT FENCE STANDARD DRAWING 1605.01
	TEMPORARY SILT BASIN TYPE-B STANDARD DRAWING 1630.02
	TEMPORARY ROCK SILT SCREEN STANDARD DRAWING 1636.01
	ROCK INLET SEDIMENT TRAP TYPE 'B' OR TYPE 'C' STANDARD DRAWING 1632.02 AND 1632.03

PROJECT REFERENCE NO. WBS 37620	SHEET NO. ERO-9
RW SHEET NO.	
ROADWAY DESIGN ENGINEER	
Kimley-Horn and Associates, Inc. P.O. BOX 33068 RALEIGH, N.C. 27636-3068	
<small>RIGHT-OF-WAY REV. CONST. REV.</small>	

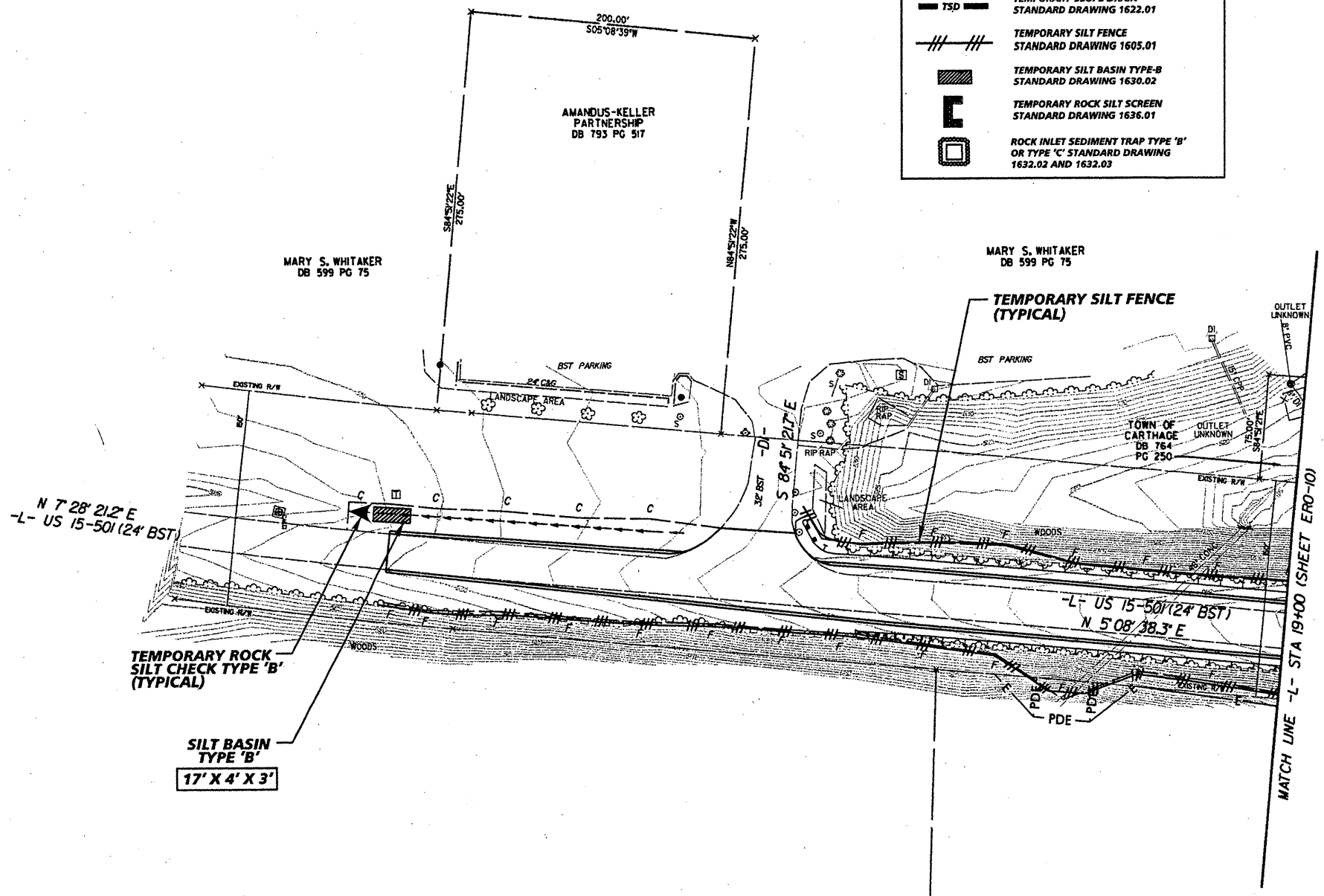

r:\011056067\roadway\mxd\0302\roy_ero-9.dgn
 11/16/2006

**INTERSECTION #6
(SOCIAL SERVICES DRIVE)**

