



PROJ. REFERENCE NO.	SHEET NO.
U-2306 A	PM-1

FINAL PAVEMENT MARKING SCHEDULE

SYMBOL	DESCRIPTION	PAT ITEM QUANTITY BREAKDOWN	TOTAL QUANTITY
PAVEMENT MARKINGS			
THERMOPLASTIC (100MM, 3.1MM)			
TC	3 M. WHITE SKIP	497 M	
TD	0.5 M. WHITE MINISKIP	50 M	
TE	WHITE SOLID LANE LINE	450 M	
TF	3 M. YELLOW SKIP	140 M	
TH	YELLOW SINGLE CENTER	560 M	
TI	YELLOW DOUBLE CENTER	1886 M	
			TOTAL 3583 M
THERMOPLASTIC (150MM, 2.3MM)			
T7	YELLOW EDGELINE	250 M	
			TOTAL 250 M
THERMOPLASTIC (200MM, 2.3MM)			
TT	YELLOW DIAGONAL	68 M	
			TOTAL 68 M
THERMOPLASTIC (200MM, 3.1MM)			
TV	WHITE CROSSWALK LINE	264 M	
			TOTAL 264 M
THERMOPLASTIC (600MM, 3.1MM)			
T2	WHITE STOPBAR	150 M	
			TOTAL 150 M
THERMOPLASTIC PAVEMENT MARKING SYMBOLS (2.3MM)			
UA	LEFT TURN ARROW	40 EA	
UB	RIGHT TURN ARROW	15 EA	
UC	STRAIGHT ARROW	25 EA	
UE	COMBO. STRAIGHT/RIGHT	10 EA	
UG	LEFT/RIGHT/STRAIGHT	1 EA	
			TOTAL 91 EA

I7-OCT-2006 11:25 \\DOT\DFS\ROOT\NNSR\Projects-U\U2306a\traffic\top\pavement marking\U2306a_tc_pml_schedule.dgn
woolard AT WZTC224104

APPROVED:	DATE: 10/18/06	FINAL PAVEMENT MARKING SCHEDULE									
	SCALE: NONE										
	DATE: 2006 OCT 17										
	DWG. BY: MRM										
	DESIGN BY: MRM										
REVIEWED BY: JWW		<table border="1" style="width: 100%; border-collapse: collapse;"> <tr> <th colspan="2">REVISIONS</th> </tr> <tr> <td style="width: 50%;"> </td> <td style="width: 50%;"> </td> </tr> <tr> <td> </td> <td> </td> </tr> <tr> <td> </td> <td> </td> </tr> </table>		REVISIONS							
REVISIONS											



PROJ. REFERENCE NO.	SHEET NO.
U-2306 A	PM-2

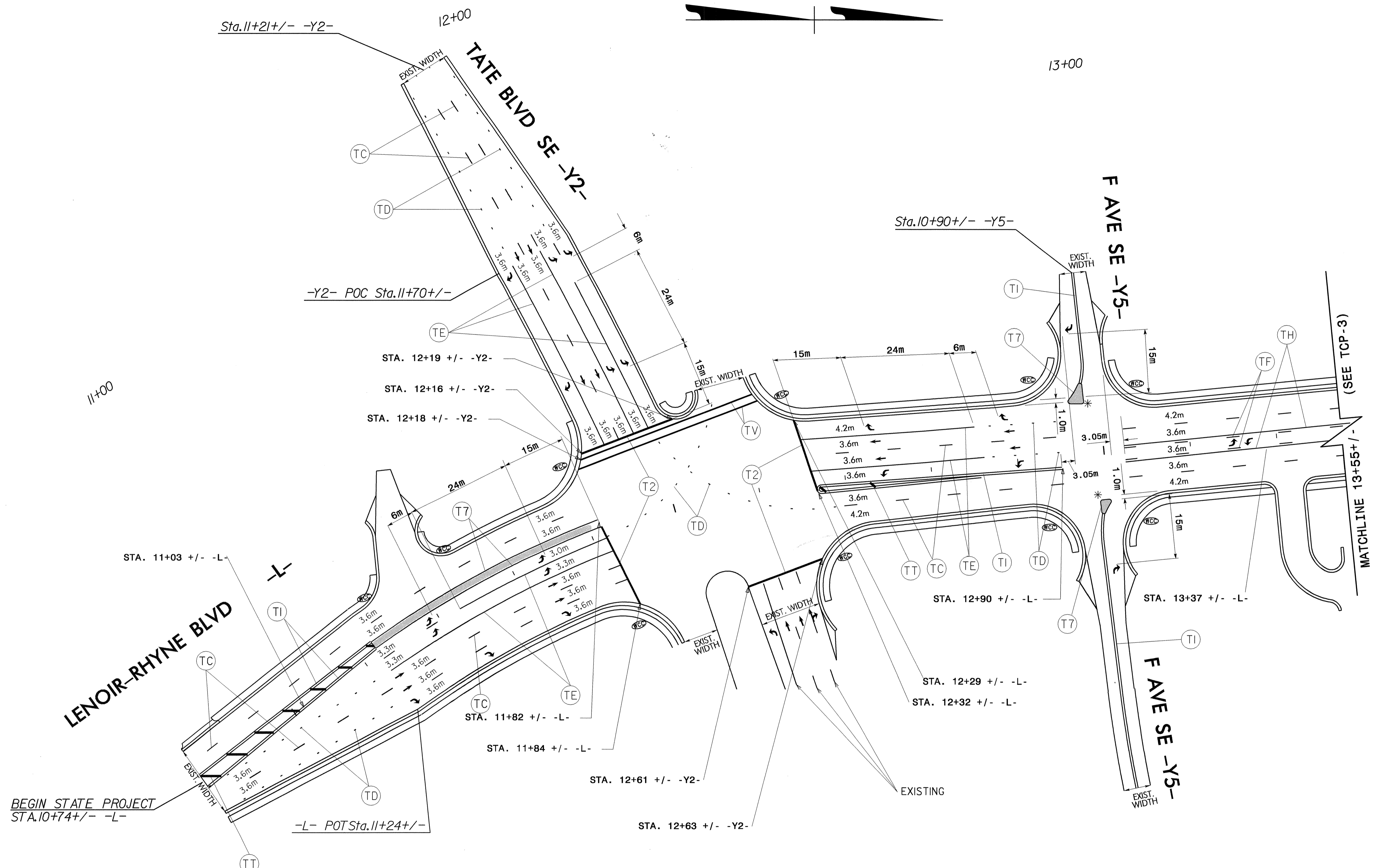

BEGIN STATE PROJECT
STA. 10+74 +/- -L-

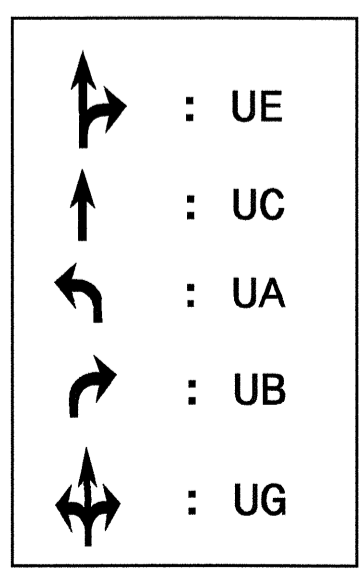

- PAVEMENT MARKERS SHALL BE PLACED ACCORDING TO RSD 1250.01, 1251.01 AND 1253.01.
 - FOR FINAL PAVEMENT MARKING SCHEDULE SEE SHEET PM-1.
 - PEDESTRIAN SIDEWALK SHALL BE PLACED ACCORDING TO RSD 1205.07
- * PROPOSED MONOLITHIC ISLAND

APPROVED: *[Signature]* DATE: 8/20/04

SEAL

FINAL PAVEMENT MARKINGS

SCALE: NONE		REVISIONS
DATE: 2004 AUG 19		
DWG. BY: MRM		
DESIGN BY: MRM		
REVIEWED BY: JWM		CADD FILE

19-AUG-2004 15:31 Mar-king\U2306A_TC.pm2_final.dgn
 T:\TCP\Pavement AT IETC095145
 csmozingo

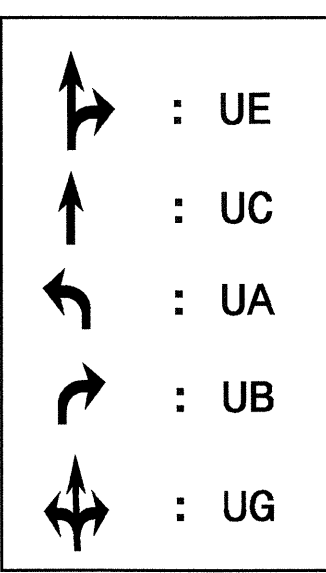
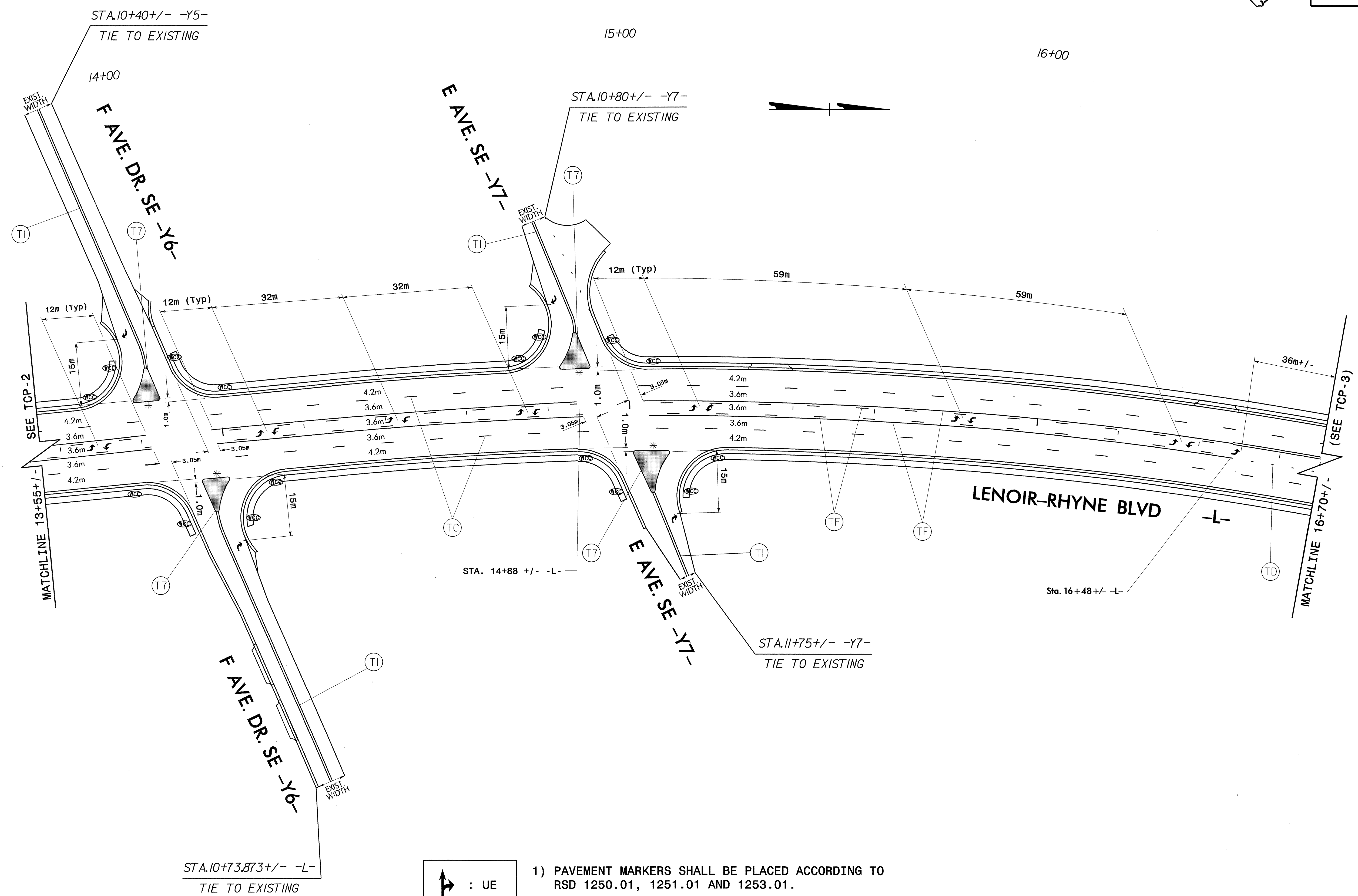

- 1) PAVEMENT MARKERS SHALL BE PLACED ACCORDING TO RSD 1250.01, 1251.01 AND 1253.01.
 - 2) FOR FINAL PAVEMENT MARKING SCHEDULE SEE SHEET PM-1.
 - 3) PEDESTRIAN SIDEWALK SHALL BE PLACED ACCORDING TO RSD 1205.07
- * OR MONOLITHIC ISLAND PROPOSAL

APPROVED: <i>J.W. Woolard</i> DATE: 8/4/04	FINAL PAVEMENT MARKINGS	
SCALE: NONE		REVISIONS
DATE: 2004 AUG 3		
DWG. BY: MRM		
DESIGN BY: MRM		
REVIEWED BY: JWW		CARD FILE

04-AUG-2004 07:39
 T:\TCP\pavement\working\2306A.TC.pm3 - final.dgn
 CSMozingo AT TETC9545



PROJ. REFERENCE NO.	SHEET NO.
U-2306 A	PM-4

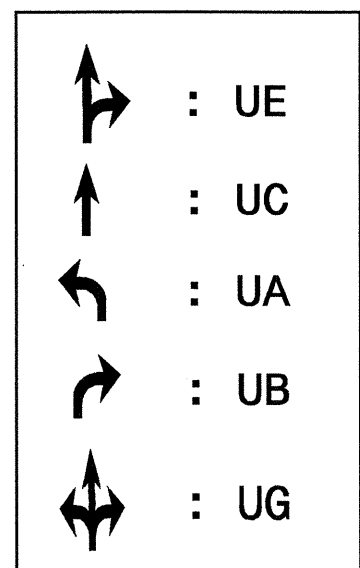
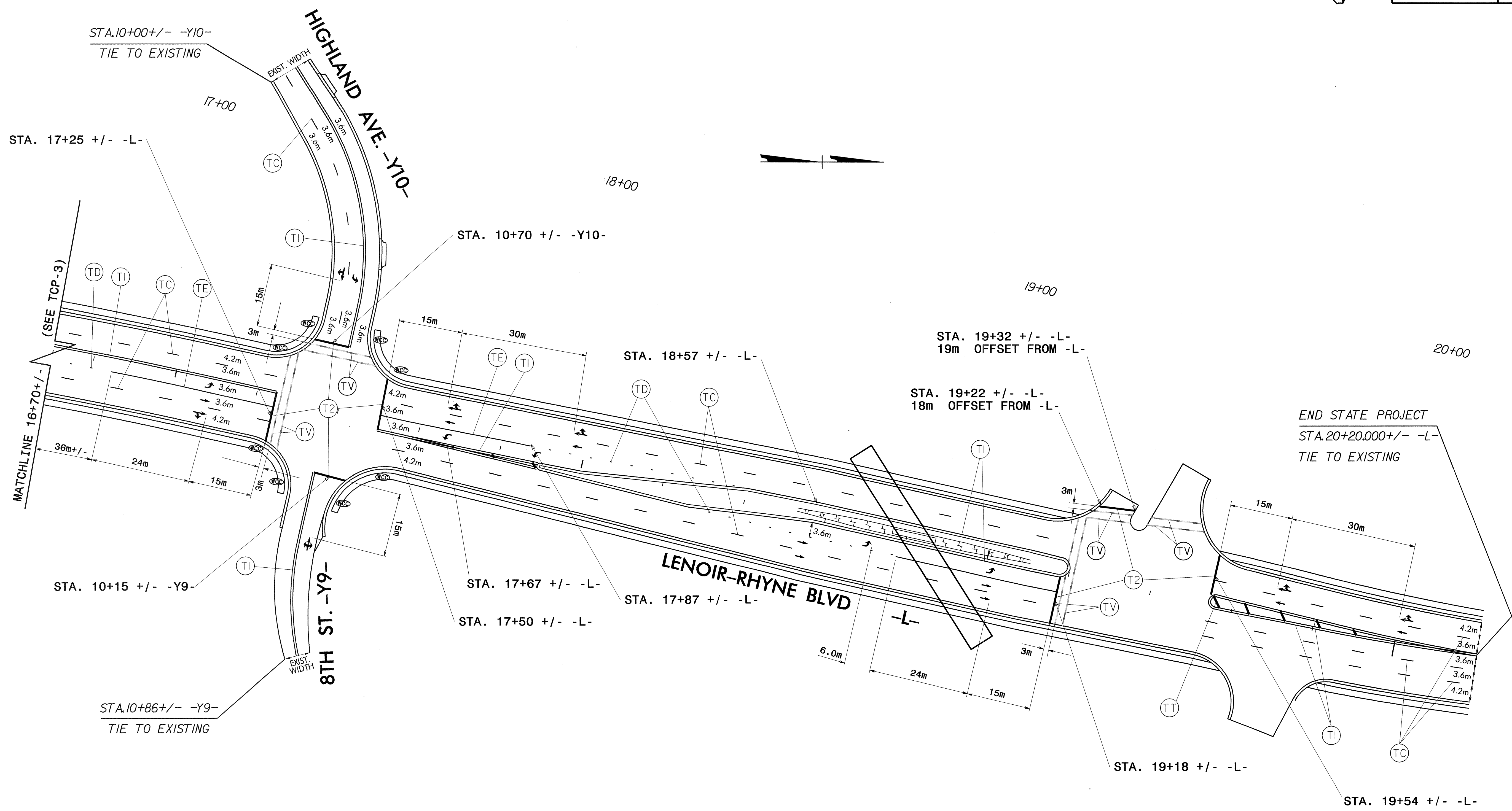

- 1) PAVEMENT MARKERS SHALL BE PLACED ACCORDING TO RSD 1250.01, 1251.01 AND 1253.01.
- 2) FOR FINAL PAVEMENT MARKING SCHEDULE SEE SHEET PM-1.
- 3) PEDESTRIAN SIDEWALK SHALL BE PLACED ACCORDING TO RSD 1205.07

APPROVED: *J.W. Wooldard* DATE: 8/1/04

SEAL:

FINAL PAVEMENT MARKINGS

SCALE: NONE		REVISIONS
DATE: 2004 AUG 3		
DWG. BY: MRM		
DESIGN BY: MRM		
REVIEWED BY: JWW		CADD FILE

04-AUG-2004 07:41
 T:\TCP\pavement\Marking\U2306A_TC.pm4_final.dgn
 CSMozingo AT TET09545