

Pavement Marking Schedule

SYMBOL	DESCRIPTION	PAY ITEM QUANTITY		TOTAL QUANTITY
		BREAKDOWN		
FINAL PAVEMENT MARKINGS				
THERMOPLASTIC (24", 120 MILS) Standard Glass Beads				
T2	WHITE STOPBAR	117	LF	
			TOTAL	117 LF
THERMOPLASTIC (4", 120 MILS) Standard Glass Beads				
TD	2 FT. WHITE MINISKIP	60	LF	
TE	WHITE SOLID LANE LINE	459	LF	
TF	10 FT. YELLOW SKIP	50	LF	
TH	YELLOW SINGLE CENTER	200	LF	
TI	YELLOW DOUBLE CENTER	2910	LF	
			TOTAL	3679 LF
THERMOPLASTIC (4", 90 MILS) Standard Glass Beads				
TA	WHITE EDGELINE	2476	LF	
TB	YELLOW EDGELINE	630	LF	
			TOTAL	3106 LF
THERMOPLASTIC (8", 90 MILS) Standard Glass Beads				
TT	YELLOW DIAGONAL	55	LF	
			TOTAL	55 LF
THERMOPLASTIC PAVEMENT MARKING SYMBOLS (90 MILS) Standard Glass Beads				
UA	LEFT TURN ARROW	5	EA	
UB	RIGHT TURN ARROW	1	EA	
UD	COMBO.STRAIGHT/LEFT	1	EA	
UE	COMBO.STRAIGHT/RIGHT	1	EA	
			TOTAL	8 EA
MARKERS PERMANENT RAISED PAVEMENT MARKERS				
MA	YELLOW & YELLOW	21	EA	
MB	CRYSTAL & RED	24	EA	
			TOTAL	45 EA

19-JAN-2007 11:24
 \\dot\dfs\oc\10\Proj\N\Tipp\projects-b\4299\Traffic\TrafficControl\Top\B4299pm1.dgn
 AT WZTC224102
 cwblissette

APPROVED: <i>Josica Kuse</i> DATE: 1/19/07	PAVEMENT MARKING SCHEDULE	
	SCALE: NONE	
	DATE: 01/07	
	DESIGN BY: DWB	
	REVIEWED BY: JDK	
	REVISIONS	

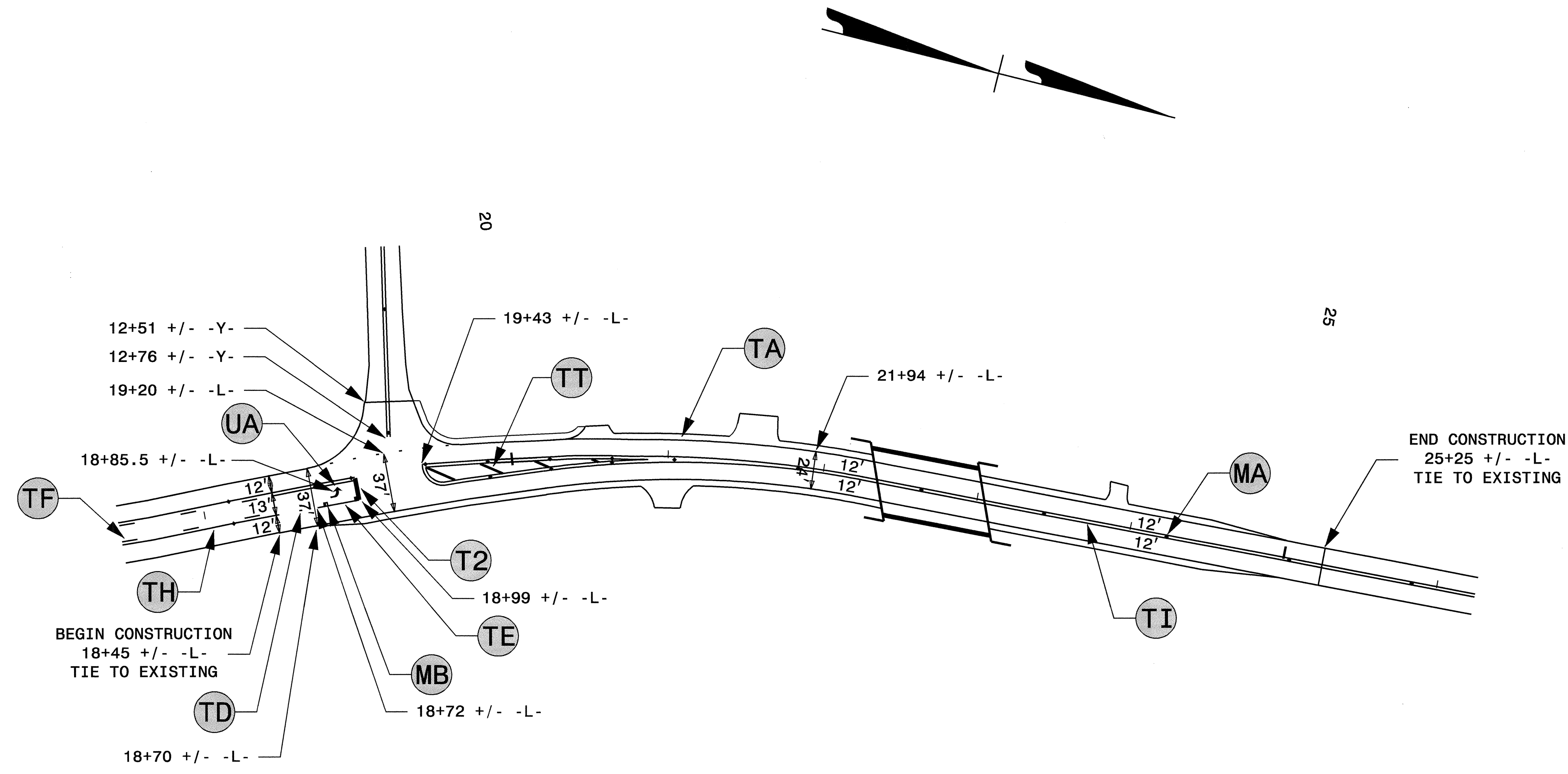

LOCAL NOTES

1. REAPPLY PAVEMENT MARKINGS UP TO 100' BEYOND CONSTRUCTION LIMITS IF NEEDED TO REPAIR DAMAGE AND/OR TRACKING FROM CONSTRUCTION.
2. ALL PAVEMENT MARKING LINES ARE 4" THERMOPLASTIC UNLESS OTHERWISE NOTED.
3. ALL PAVEMENT MARKING SYMBOLS ARE THERMOPLASTIC.
4. ADJUST PLACEMENT OF LINES AND SYMBOLS TO THE EXISTING STOP BAR LOCATION AND IN ACCORDANCE WITH RSD 1205.05 SHEET 1 OF 1.
5. SEE RSD 1205.09 SHEET 1 OF 1 FOR PLACEMENT OF DIAGONALS.

19-JAN-2007 10:08
 \\dot\dfsroot\proj\Tip\projects-b4299\traffic\trafficcontrol\top\b4299pm2.dgn
 awbissette AT WZ1C224102

APPROVED: <i>Jessica D. Kuse</i> DATE: 1/19/07	PAVEMENT MARKING - L -	
SEAL 	SCALE: NONE	
	DATE: 01/07	
	DWG. BY: DWB	
	DESIGN BY: DWB	
REVIEWED BY: JDK	REVISIONS	

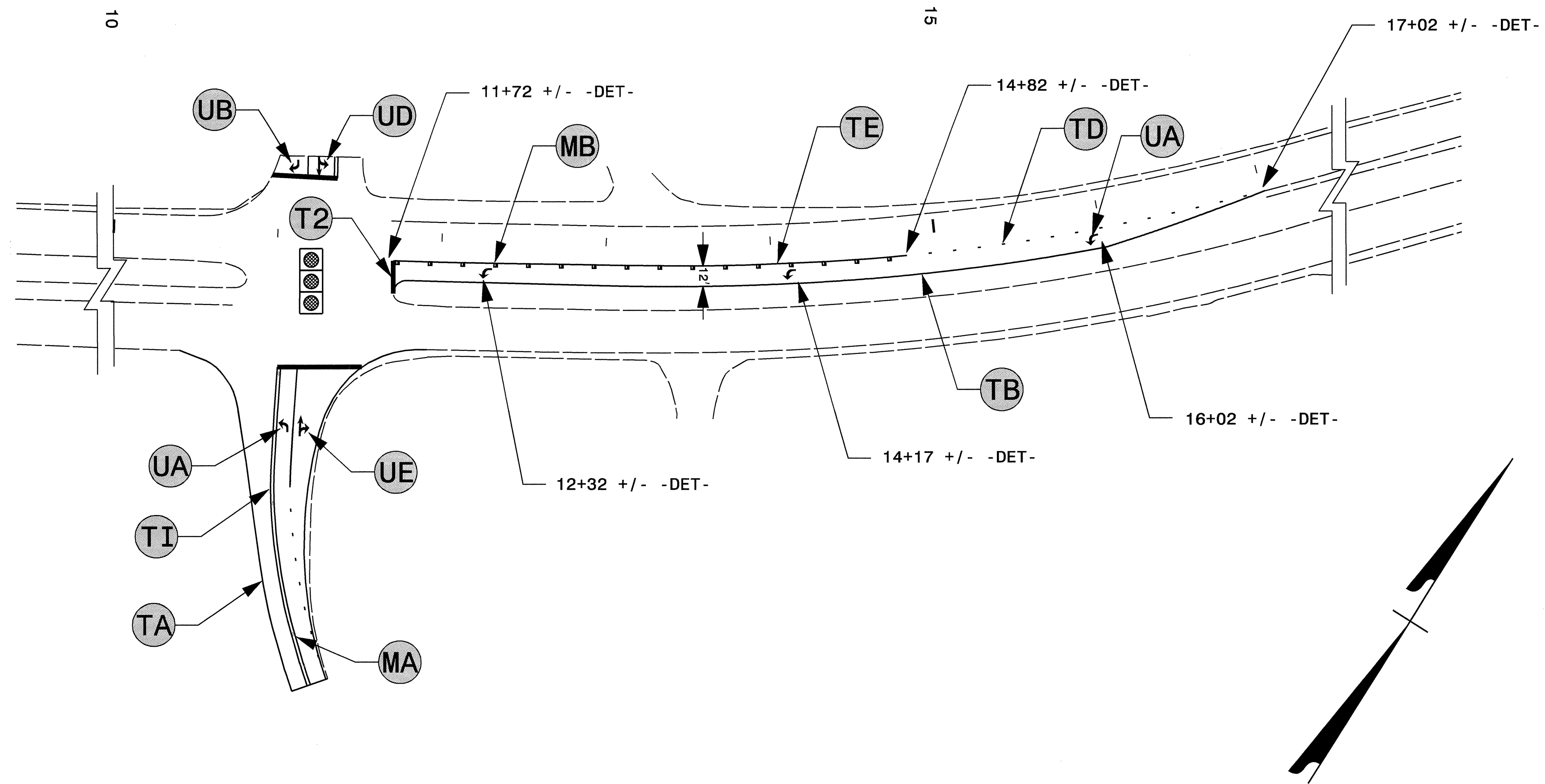

LOCAL NOTES

1. REAPPLY PAVEMENT MARKINGS UP TO 100' BEYOND CONSTRUCTION LIMITS IF NEEDED TO REPAIR DAMAGE AND/OR TRACKING FROM CONSTRUCTION.
2. ALL PAVEMENT MARKING LINES ARE 4" THERMOPLASTIC UNLESS OTHERWISE NOTED.
3. ALL PAVEMENT MARKING SYMBOLS ARE THERMOPLASTIC.
4. ADJUST PLACEMENT OF LINES AND SYMBOLS TO THE EXISTING STOP BAR LOCATION AND IN ACCORDANCE WITH RSD 1205.05 SHEET 1 OF 1.

19-JAN-2007 10:09
 \\dot\dfsroot\proj\proj\projects-b\4299\traffic\trafficcontrol\top\b4299pm3.dgn
 dwb\issette AT WJ1224102

APPROVED: <i>Jessica Kute</i> DATE: 1/19/07	PAVEMENT MARKING - DET -	
	SCALE: NONE	
	DATE: 01/07	
	DWG. BY: DWB	
	DESIGN BY: DWB	
REVIEWED BY: JDK	REVISIONS	