

STATE OF NORTH CAROLINA
DIVISION OF HIGHWAYS

STATE PROJECT REFERENCE NO.	SHEET NO.
B-4269	TCP-1

**PLAN FOR PROPOSED
TRAFFIC CONTROL, MARKING & DELINEATION**

SAMPSON COUNTY

B-4269

ROADWAY STANDARD DRAWINGS

THE FOLLOWING ROADWAY STANDARDS AS APPEAR IN "ROADWAY STANDARD DRAWINGS"- PROJECT SERVICES UNIT-N.C. DEPARTMENT OF TRANSPORTATION-RALEIGH, N.C., DATED JULY 2006 ARE APPLICABLE TO THIS PROJECT AND BY REFERENCE HEREBY ARE CONSIDERED A PART OF THESE PLANS:

STD. NO.	TITLE
1101.03	TEMPORARY ROAD CLOSURES
1101.05	WORK ZONE VEHICLE ACCESSES
1101.11	TRAFFIC CONTROL DESIGN TABLES
1110.01	STATIONARY WORK ZONE SIGNS
1145.01	BARRICADES
1205.01	PAVEMENT MARKINGS - LINE TYPES & OFFSETS
1205.02	PAVEMENT MARKINGS - 2 LANE & MULTILANE ROADWAYS
1205.12	PAVEMENT MARKINGS - BRIDGES
1250.01	PAVEMENT MARKER SPACING
1251.01	RAISED PAVEMENT MARKERS (TEMPORARY & PERMANENT)
1261.01	GUARDRAIL & BARRIER DELINEATOR SPACING
1261.02	GUARDRAIL & BARRIER DELINEATOR TYPES
1262.01	GUARDRAIL END DELINEATION

INDEX OF SHEETS

SHEET NO.	TITLE
TCP-1	LIST OF APPLICABLE ROADWAY STANDARD DRAWINGS, LEGEND, INDEX OF SHEETS AND FINAL PAVEMENT MARKING SCHEDULE
TCP-2	GENERAL NOTES AND PHASING
TCP-3	DETOUR MAP AND SIGNING

LEGEND

- GENERAL**
- DIRECTION OF TRAFFIC FLOW
 - NORTH ARROW
 - PROPOSED PVMT. EXIST. PVMT.
 - WORK AREA
 - REMOVAL OF EXISTING PAVEMENT

- TRAFFIC CONTROL DEVICES**
- TYPE I BARRICADE
 - TYPE II BARRICADE
 - TYPE III BARRICADE
 - CONE
 - DRUM SKINNY DRUM
 - FLASHING ARROW PANEL (TYPE C)
 - STATIONARY SIGN
 - PORTABLE SIGN
 - STATIONARY OR PORTABLE SIGN
 - WARNING FLAGS
 - CRASH CUSHION
 - CHANGEABLE MESSAGE SIGN
 - TRUCK MOUNTED IMPACT ATTENUATOR (TMIA)
 - POLICE
 - FLAGGER

- PAVEMENT MARKINGS**
- CRYSTAL/CRYSTAL PAVEMENT MARKER
 - YELLOW/YELLOW PAVEMENT MARKER
 - CRYSTAL/RED PAVEMENT MARKER
 - PAVEMENT MARKING SYMBOLS

FINAL PAVEMENT MARKING SCHEDULE			
SYMBOL	DESCRIPTION	PAY ITEM PAINT (4")	TOTAL
PA	WHITE EDGELINE (2X)	1,800 LF	3,600 LF
PI	DOUBLE YELLOW CENTERLINE (2X)	900 LF	3,600 LF
		TOTAL	7,200 LF
PERMANENT RAISED PAVEMENT MARKERS			
MA	YELLOW AND YELLOW		20 EA

NOTE: FOR EACH PAINT PAVEMENT MARKING ITEM, 1X IMPLIES A SINGLE APPLICATION, 2X IMPLIES TWO APPLICATIONS, AND 3X IMPLIES THREE APPLICATIONS.

APPROVED: _____ DATE: _____	PLAN PREPARED BY: N.C.D.O.T. WORK ZONE TRAFFIC CONTROL UNIT
	J. S. BOURNE, PE <u> </u> TRAFFIC CONTROL ENGINEER
	JOSEPH ISHAK, PE <u> </u> TRAFFIC CONTROL PROJECT ENGINEER
	HABIB A. LAWANDOS <u> </u> TRAFFIC CONTROL PROJECT DESIGN ENGINEER
	WALID R. DAKDUK <u> </u> TRAFFIC CONTROL DESIGN ENGINEER

22-FEB-2007 14:20 \\dot\dfs\oof\pco\Tipp\projects-b\4269\traffic\trafficcontrol\top\b-4269_tc_top.dgn wdk:dk

TIP PROJECT:

GENERAL NOTES

ADAPT THE TRAFFIC CONTROL PLANS, WHEN DIRECTED BY THE ENGINEER, TO MEET FIELD CONDITIONS TO PROVIDE SAFE AND EFFICIENT TRAFFIC MOVEMENT. CHANGES MAY BE REQUIRED WHEN PHYSICAL DIMENSIONS IN THE DETAIL DRAWINGS, STANDARD DETAILS AND ROADWAY DETAILS ARE NOT ATTAINABLE, OR RESULT IN DUPLICATE, OR UNDESIRED OVERLAPPING OF DEVICES. MODIFICATION MAY INCLUDE: MOVING, SUPPLEMENTING, COVERING OR REMOVAL OF DEVICES.

THE FOLLOWING GENERAL NOTES APPLY AT ALL TIMES FOR THE DURATION OF THE CONSTRUCTION PROJECT, EXCEPT WHEN OTHERWISE NOTED IN THE PLAN, OR DIRECTED BY THE ENGINEER.

LANE AND SHOULDER CLOSURE REQUIREMENTS

- A) REMOVE LANE CLOSURE DEVICES FROM THE LANE WHEN WORK IS NOT BEING PERFORMED BEHIND THE LANE CLOSURE OR WHEN A LANE CLOSURE IS NO LONGER NEEDED, OR AS DIRECTED BY THE ENGINEER.

TRAFFIC PATTERN ALTERATIONS

- B) NOTIFY THE ENGINEER TWENTY ONE (21) CALENDAR DAYS PRIOR TO ANY TRAFFIC PATTERN ALTERATION.

SIGNING

- C) STATE FORCES WILL INSTALL PERMANENT SIGNING.
 D) STATE FORCES WILL INSTALL DETOUR SIGNING WITHIN AND OFF THE PROJECT LIMITS.
 E) STATE FORCES WILL COVER OR REMOVE ALL DETOUR SIGNS WITHIN AND OFF THE PROJECT LIMITS WHEN A DETOUR IS NOT IN OPERATION.
 F) ENSURE ALL NECESSARY SIGNING IS IN PLACE PRIOR TO ALTERING ANY TRAFFIC PATTERN.

TRAFFIC CONTROL DEVICES

- G) PLACE TYPE III BARRICADES, WITH "ROAD CLOSED" SIGN R11-2 ATTACHED, OF SUFFICIENT LENGTH TO CLOSE ENTIRE ROADWAY. STAGGER OR OVERLAP BARRICADES TO ALLOW FOR INGRESS OR EGRESS.

PAVEMENT MARKINGS AND MARKERS

- H) INSTALL PAVEMENT MARKINGS AND PAVEMENT MARKERS ON THE FINAL SURFACE AS FOLLOWS:

ROAD NAME	MARKING	MARKER
SR 1214	PAINT	PERMANENT RAISED
BOYKIN BRIDGE RD.		

PHASING

NOTE: MAINTAIN VEHICULAR ACCESS TO DRIVEWAYS WITHIN PROJECT LIMITS THROUGHOUT THE DURATION OF THE PROJECT.

WORKING IN A CONTINUOUS MANNER, COMPLETE THE FOLLOWING:

STEP 1: NOTIFY STATE FORCES TO PERFORM THE FOLLOWINGS:

- REPLACE EXISTING "SHARP CURVE" SIGNS WITH HIGH INTENSITY WARNING SIGNS WITH FLAGS ATTACHED ON SR 1217.
- PLACE THE PAVEMENT MARKINGS (PAINT) ON SR 1217, SR 1240, AND SR 1212).
- CLEAR VEGETATION AT THE INTERSECTION OF SR 1240 AND SR 1217 TO IMPROVE SIGHT DISTANCE AT THAT LOCATION.

STEP 2: NOTIFY STATE FORCES TO INSTALL DETOUR SIGNING WITHIN AND OFF THE PROJECT LIMITS PRIOR TO CLOSING SR 1214.

STEP 3: USING RSD 1101.03 SHEET 1 OF 9 AND SHEET TCP-3 INSTALL BARRICADES TO CLOSE SR 1214 (BOYKIN BRIDGE RD.) TO THRU TRAFFIC AND SHIFT TRAFFIC ONTO OFFSITE DETOUR. (SEE TCP-3)

STEP 4: -AWAY FROM TRAFFIC, CONSTRUCT -L- FROM STA 13+50.00 TO STA 22+00.00 INCLUDING PROPOSED STRUCTURE, UP TO AND INCLUDING THE FINAL LAYER OF SURFACE COURSE.

- PLACE FINAL PAVEMENT MARKING (PAINT), AND PERMANENT PAVEMENT MARKERS (RAISED) ON -L- (SR 1214), FROM -L- STA 13+50.00 TO -L- STA 22+00.00.

STEP 5: -REMOVE ALL TRAFFIC CONTROL DEVICES AND OPEN SR 1214 TO TRAFFIC, AND AT THE SAME TIME INFORM ENGINEER TO HAVE STATE FORCES REMOVE ALL DETOUR SIGNING OFF AND WITHIN THE PROJECT LIMITS.

22-FEB-2007 10:42
 \dot\sr\0010\proj\traffic\trafficcontrol\tcp-b-4269_tcp-2.dgn
 AT W71c224165
 wdek.duk

APPROVED: _____	DATE: _____	GENERAL NOTES AND PHASING	
	SCALE: NONE		REVISIONS
	DATE: 12/06		
	DWG. BY: WRD		
	DESIGN BY: WRD		
REVIEWED BY: HAL			

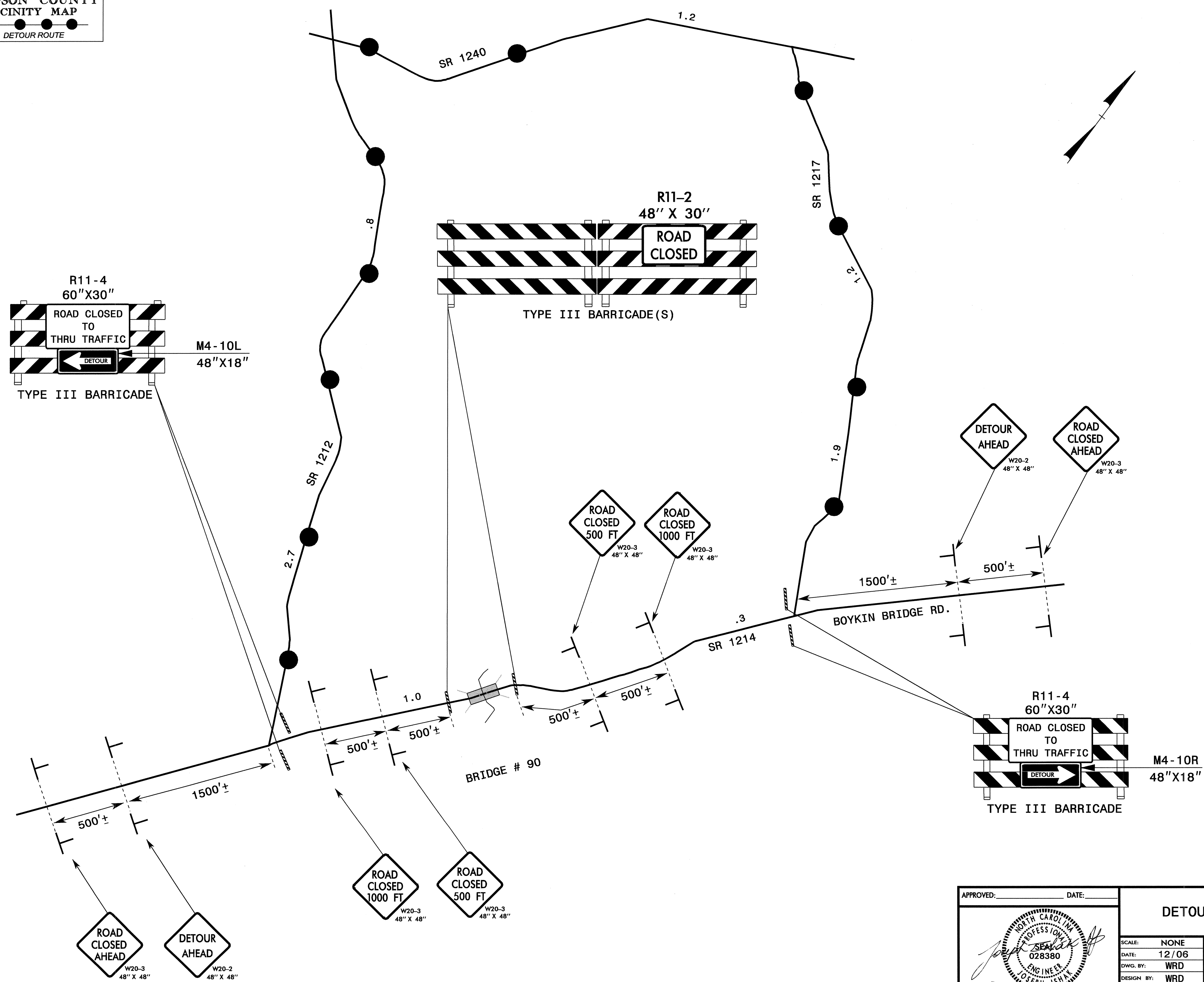

02-FEB-2007 08:21
 \\dot\dfsroot\01\proj\projects-b\4269\tr\affic\tr\affic\tr\top\top-b-4269_top-3.dgn
 AT W2TC224165
 wdakduk

APPROVED: _____ DATE: _____	DETOUR MAP AND SIGNING	
SCALE: NONE		REVISIONS
DATE: 12/06		
DWG. BY: WRD		
DESIGN BY: WRD		
REVIEWED BY: HAL		CADD FILE