

STATE OF NORTH CAROLINA
DIVISION OF HIGHWAYS

STATE PROJECT REFERENCE NO.	SHEET NO.
B-3672	TCP-1

**PLAN FOR PROPOSED
TRAFFIC CONTROL, MARKING & DELINEATION**

JOHNSTON COUNTY

B-3672

ROADWAY STANDARD DRAWINGS

THE FOLLOWING ROADWAY STANDARDS AS APPEAR IN "ROADWAY STANDARD DRAWINGS"-PROJECT SERVICES UNIT-N.C. DEPARTMENT OF TRANSPORTATION-RALEIGH, N.C., DATED JULY 2006 ARE APPLICABLE TO THIS PROJECT AND BY REFERENCE HEREBY ARE CONSIDERED A PART OF THESE PLANS:

STD. NO.	TITLE
1101.03	TEMPORARY ROAD CLOSURES
1101.11	TRAFFIC CONTROL DESIGN TABLES
1110.01	STATIONARY WORK ZONE SIGNS
1130.01	DRUM
1135.01	CONES
1145.01	BARRICADES
1205.01	PAVEMENT MARKINGS - LINE TYPES & OFFSETS
1205.02	PAVEMENT MARKINGS - 2 LANE & MULTILANE ROADWAYS
1205.12	PAVEMENT MARKINGS - BRIDGES
1250.01	PAVEMENT MARKER SPACING
1251.01	RAISED PAVEMENT MARKERS (TEMPORARY & PERMANENT)
1261.01	GUARDRAIL & BARRIER DELINEATOR SPACING
1261.02	GUARDRAIL & BARRIER DELINEATOR TYPES
1262.01	GUARDRAIL END DELINEATION

INDEX OF SHEETS

SHEET NO.	TITLE
TCP-1	LIST OF APPLICABLE ROADWAY STANDARD DRAWINGS, LEGEND AND INDEX OF SHEETS
TCP-2	GENERAL NOTES, PHASING AND FINAL PAVEMENT MARKING SCHEDULE
TCP-3	DETOUR SIGNING AND BARRICADE PLACEMENT
TCP-4	DETOUR ROUTE AND SIGN DESIGNS

LEGEND

- GENERAL**
- DIRECTION OF TRAFFIC FLOW
 - NORTH ARROW
 - PROPOSED PVMT. EXIST. PVMT.
 - WORK AREA
 - REMOVAL OF EXISTING PAVEMENT
- TRAFFIC CONTROL DEVICES**
- TYPE I BARRICADE
 - TYPE II BARRICADE
 - TYPE III BARRICADE
 - CONE
 - DRUM SKINNY DRUM
 - FLASHING ARROW PANEL (TYPE C)
 - STATIONARY SIGN
 - PORTABLE SIGN
 - STATIONARY OR PORTABLE SIGN
 - CRASH CUSHION
 - CHANGEABLE MESSAGE SIGN
 - TRUCK MOUNTED IMPACT ATTENUATOR (TMIA)
 - POLICE
 - FLAGGER
- PAVEMENT MARKINGS**
- CRYSTAL/CRYSTAL PAVEMENT MARKER
 - YELLOW/YELLOW PAVEMENT MARKER
 - CRYSTAL/RED PAVEMENT MARKER
 - PAVEMENT MARKING SYMBOLS

TIP PROJECT:

\$\$\$\$ SYSTEMS \$\$\$
\$\$\$ CONSULTING \$\$\$
\$\$\$ DESIGN \$\$\$
\$\$\$ SURVEYING \$\$\$
\$\$\$ ENVIRONMENTAL \$\$\$

APPROVED: <i>Michelle R. Brame</i> DATE: <i>12/5/06</i>	PLAN PREPARED FOR N.C.D.O.T. BY: KCI Associates of North Carolina, P.A. <small>SUITE 220, LANDMARK CENTER II, 460 SIX FORKS RD., RALEIGH, NC 27609-5200 *ENGINEERS * PLANNERS * ECOLOGISTS</small>
SEAL 	MICHELLE R. BRAME P.E. TRAFFIC CONTROL ENGINEER MICHELLE R. BRAME P.E. TRAFFIC CONTROL PROJECT ENGINEER MICHELLE R. BRAME P.E. TRAFFIC CONTROL PROJECT DESIGN ENGINEER JENNIFER M. SPOHN TRAFFIC CONTROL DESIGN ENGINEER / TECHNICIAN

GENERAL NOTES

- A) ADAPT THE TRAFFIC CONTROL PLANS, WHEN DIRECTED BY THE ENGINEER, TO MEET FIELD CONDITIONS TO PROVIDE SAFE AND EFFICIENT TRAFFIC MOVEMENT. CHANGES MAY BE REQUIRED WHEN PHYSICAL DIMENSIONS IN THE DETAIL DRAWINGS, STANDARD DETAILS AND ROADWAY DETAILS ARE NOT ATTAINABLE, OR RESULT IN DUPLICATE, OR UNDESIRE OVERLAPPING OF DEVICES. MODIFICATION MAY INCLUDE: MOVING, SUPPLEMENTING, COVERING OR REMOVAL OF DEVICES.

THE FOLLOWING GENERAL NOTES APPLY AT ALL TIMES FOR THE DURATION OF THE CONSTRUCTION PROJECT, EXCEPT WHEN OTHERWISE NOTED IN THE PLAN, OR DIRECTED BY THE ENGINEER.

TRAFFIC PATTERN ALTERATIONS

- B) NOTIFY THE ENGINEER TWENTY ONE (21) CALENDAR DAYS PRIOR TO ANY TRAFFIC PATTERN ALTERATION.

SIGNING

- C) PROVIDE PERMANENT SIGNING.
D) PROVIDE DETOUR SIGNING WITHIN AND OFF THE PROJECT LIMITS.
E) COVER OR REMOVE ALL DETOUR SIGNS WITHIN AND OFF THE PROJECT LIMITS WHEN A DETOUR IS NOT IN OPERATION.
F) ENSURE ALL NECESSARY SIGNING IS IN PLACE PRIOR TO ALTERING ANY TRAFFIC PATTERN.

TRAFFIC CONTROL DEVICES

- G) PLACE TYPE III BARRICADES, WITH "ROAD CLOSED XX MILES AHEAD LOCAL TRAFFIC ONLY" SIGN R11-3 ("ROAD CLOSED TO THRU TRAFFIC" SIGN R11-4 IF 1 MILE OR LESS TO ROAD CLOSURE) AND "DETOUR" SIGN M4-10 ATTACHED, OF SUFFICIENT LENGTH TO CLOSE ENTIRE ROADWAY. STAGGER OR OVERLAP BARRICADES TO ALLOW FOR INGRESS OR EGRESS.

PAVEMENT MARKINGS AND MARKERS

- H) INSTALL PAVEMENT MARKINGS AND PAVEMENT MARKERS ON THE FINAL SURFACE AS FOLLOWS:

ROAD NAME	MARKING	MARKER
1. STOTT'S MILL ROAD SR 1718	PAINT	PERMANENT RAISED

- I) PLACE AT LEAST TWO APPLICATIONS OF PAINT PAVEMENT MARKINGS ON THE FINAL WEARING SURFACE ON NEW ASPHALT PAVEMENT. PLACE ADDITIONAL APPLICATIONS OF PAINT UPON SUFFICIENT DRYING TIME, AS DETERMINED BY THE ENGINEER.
J) TIE PROPOSED PAVEMENT MARKING LINES TO EXISTING PAVEMENT MARKING LINES.

PHASING

NOTE: MAINTAIN ACCESS TO DRIVES AT ALL TIMES

- STEP 1: USING SHEETS TCP-3 AND TCP-4, INSTALL DETOUR SIGNS AND PLACE BARRICADES TO CLOSE SR 1718 (STOTT'S MILL ROAD) TO THRU TRAFFIC. DETOUR TRAFFIC ONTO PROPOSED DETOUR.
- STEP 2: AWAY FROM TRAFFIC, REMOVE EXISTING STRUCTURE NO. 415 AND CONSTRUCT PROPOSED STRUCTURE.
CONSTRUCT PROPOSED ROADWAY AND GUARDRAIL FROM STA. 13+45 +/- TO STA. 21+65 +/- UP TO AND INCLUDING FINAL SURFACE COURSE.
PLACE PERMANENT PAVEMENT MARKINGS (PAINT) AND PERMANENT RAISED MARKERS ON THE -L- LINE AND TIE INTO EXISTING MARKINGS AND MARKERS AT STA. 13+45 +/- AND STA. 21+20 +/-.
- STEP 3: REMOVE ALL TRAFFIC CONTROL DEVICES AND REMOVE ALL DETOUR SIGNING.
OPEN SR 1718 (STOTT'S MILL ROAD) TO TRAFFIC.

FINAL PAVEMENT MARKING SCHEDULE

SYMBOL	DESCRIPTION	PAY ITEM	QUANTITY	
			BREAKDOWN	TOTAL QUANTITY
PAVEMENT MARKINGS				
PAINT (4")				
PA	WHITE EDGELINE(2X)		3340 LF	
PI	YELLOW DOUBLE CENTER(2X)		3340 LF	
			TOTAL	6680 LF
MARKERS				
PERMANENT RAISED PAVEMENT MARKERS				
MA	YELLOW & YELLOW		19 EA	
			TOTAL	19 EA

NOTE: FOR EACH PAINT PAVEMENT MARKING ITEM, 2X IMPLIES TWO APPLICATIONS.

APPROVED: *Michelle R. Brann* DATE: 12/7/06

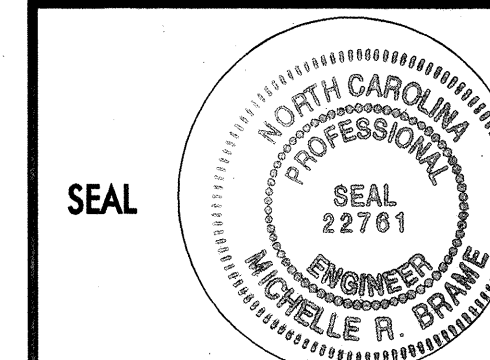

GENERAL NOTES, PHASING AND FINAL PAVEMENT MARKING SCHEDULE

SCALE: NONE
DATE: 11-21-06
DWG. BY: JMS
DESIGN BY: MRB
REVIEWED BY: MRB

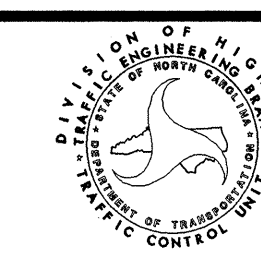

REVISIONS

NO.	DESCRIPTION

NOTE: SEE SHEET TCP-4 FOR DETOUR SIGNING AND DETOUR SIGN DESIGN

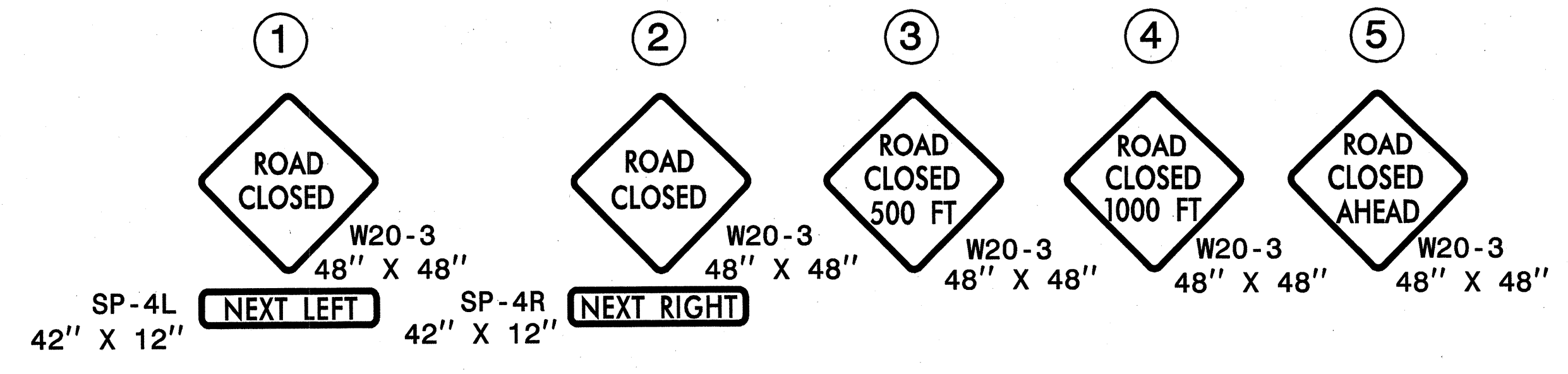
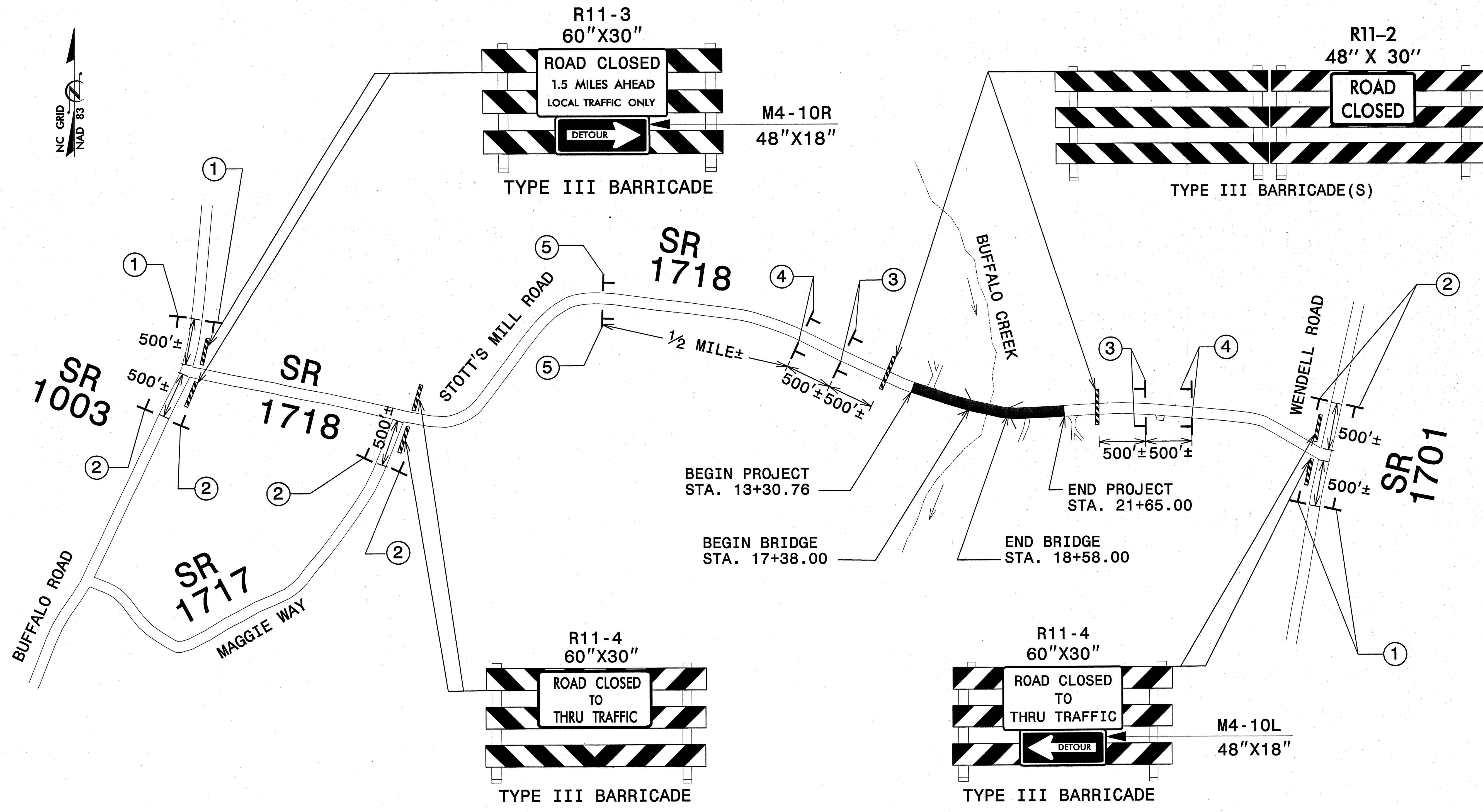

APPROVED: *Michelle Brance* DATE: *12/5/06*

DETOUR SIGNING AND BARRICADE PLACEMENT

SCALE: NONE		REVISIONS
DATE: 11-21-06		
DWG. BY: JMS		
DESIGN BY: MRB		
REVIEWED BY: MRB		

\$\$\$\$\$SYTIME\$\$\$\$\$
\$\$\$\$\$EDGNS\$\$\$\$\$
\$\$\$\$\$USERNAME\$\$\$\$\$

B-3672 OFF-SITE DETOUR

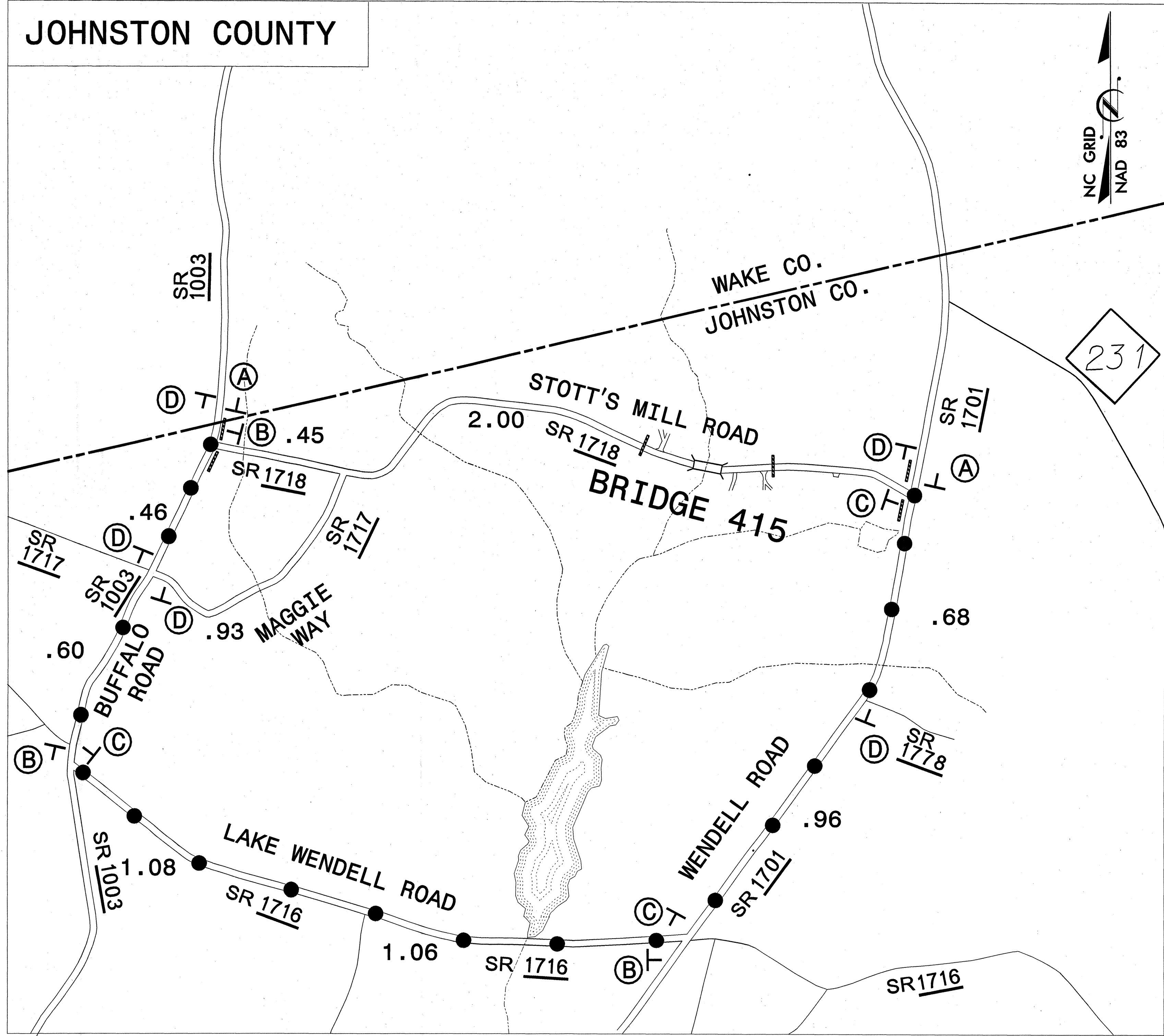

NC GRID
 NAD 83

Sign Number: Type: D Ground Quantity: 1	Design By: DME Project ID: B-3672	Check By: DIV: 4	STD #: N/A Date: Nov 01, 2006
---	--------------------------------------	---------------------	----------------------------------

Background Color: Fluorescent Orange
 Legend & Border Color: Black

Sign Width: 3'-0"
 Height: 2'-0"
 Total Area: 6.0 Sq.Ft.

Border Type: Recessed
 Recess: 0.38"
 Width: 0.63"
 Radius: 1.5"

Backing Material: 0.080 in. Aluminum
 0.079 in. Composite

NOTES:
 1. Legend and border shall be direct applied non-reflective sheeting.
 2. Background shall be Type VII, VIII, or IX (prismatic) retroreflective sheeting.

Letter spacings are to start of next letter										Series/Size
										Text Length
S	T	O	T	T	S					C
5.1	4.3	4	4.5	3.3	4.3	2.1	3.3	5.1		26.8
M	I	L	L	R	D					C
4.9	5.2	2.1	4	3	4	4.6	3.3	4.9		26.1

Spacing Factor is 1 unless specified otherwise

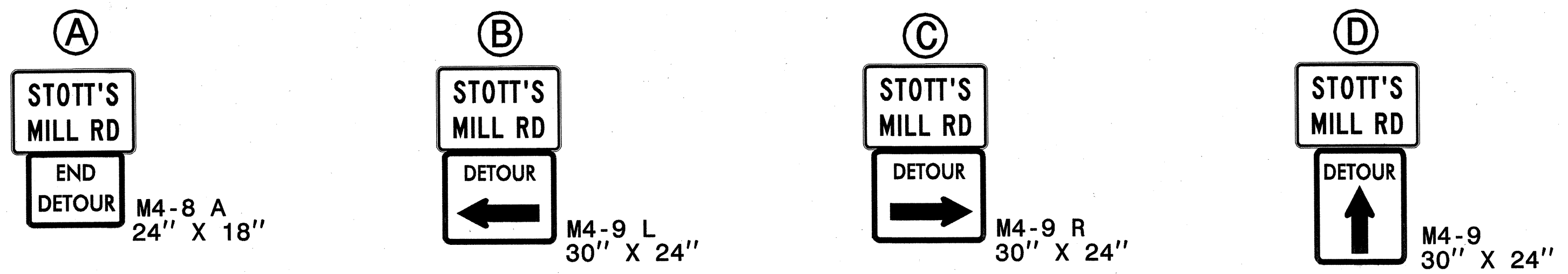
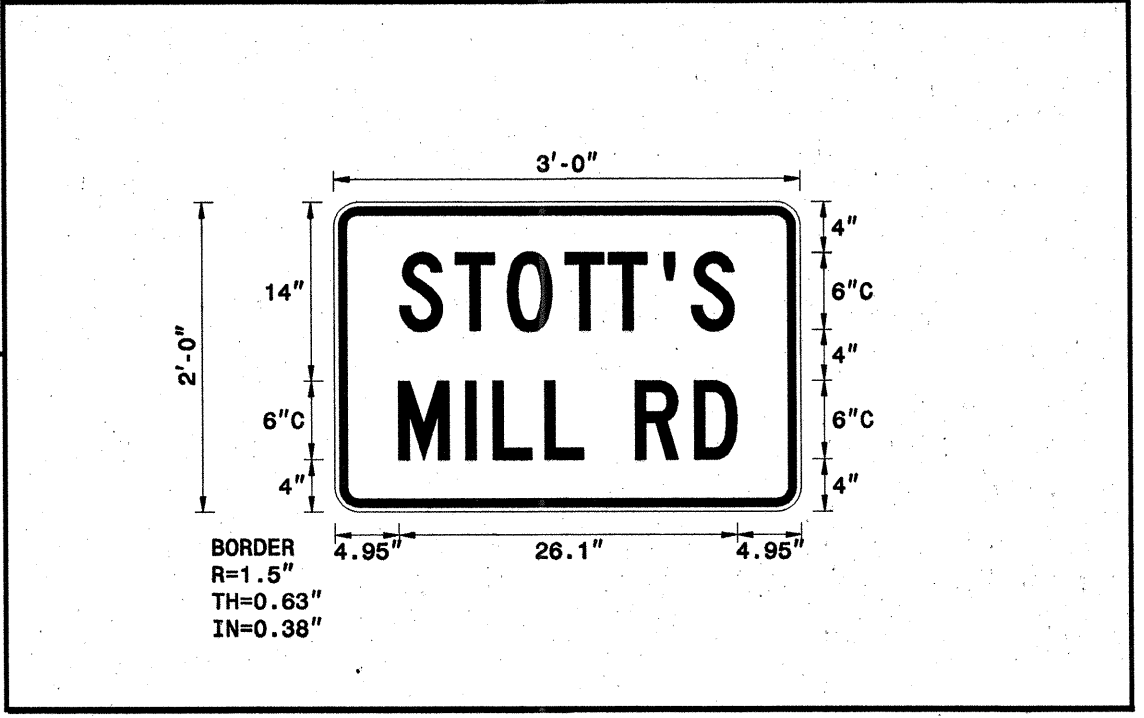

APPROVED: *Michelle R. Brant* DATE: 12/5/06

SEAL:

DETOUR ROUTE AND SIGN DESIGN

SCALE: NONE		REVISIONS
DATE: 11-21-06		
DWG. BY: JMS		
DESIGN BY: MRB		

REVIEWED BY: MRB

\$\$\$\$\$SYTIME\$\$\$\$\$
 \$\$\$USERNAME\$\$\$