

**PROJECT SPECIAL PROVISIONS**  
**PERMITS**

The Contractor's attention is directed to the following permits, which have been issued to the Department of Transportation by the authority granting the permit.

**PERMIT****AUTHORITY GRANTING THE PERMIT**

Dredge and Fill and/or  
Work in Navigable Waters (404)

U. S. Army Corps of Engineers

Water Quality (401)

Division of Environmental Management, DENR,  
State of North Carolina

The Contractor shall comply with all applicable permit conditions during construction of this project. Those conditions marked by \* are the responsibility of the department and the Contractor has no responsibility in accomplishing those conditions.

Agents of the permitting authority will periodically inspect the project for adherence to the permits.

The Contractor's attention is also directed to Articles 107-10 and 107-14 of the Standard Specifications and the following:

Should the Contractor propose to utilize construction methods (such as temporary structures or fill in waters and/or wetlands for haul roads, work platforms, cofferdams, etc.) not specifically identified in the permit (individual, general, or nationwide) authorizing the project it shall be the Contractor's responsibility to coordinate with the Engineer to determine what, if any, additional permit action is required. The Contractor shall also be responsible for initiating the request for the authorization of such construction method by the permitting agency. The request shall be submitted through the Engineer. The Contractor shall not utilize the construction method until it is approved by the permitting agency. The request normally takes approximately 60 days to process; however, no extensions of time or additional compensation will be granted for delays resulting from the Contractor's request for approval of construction methods not specifically identified in the permit.

**Where construction moratoriums are contained in a permit condition which restricts the Contractor's activities to certain times of the year, those moratoriums will apply only to the portions of the work taking place in the waters or wetlands provided that activities outside those areas is done in such a manner as to not affect the waters or wetlands.**

107 6.4311  
U.S. ARMY CORPS OF ENGINEERS  
WILMINGTON DISTRICT

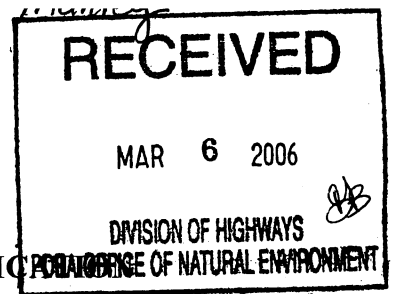

Action ID: 200610532

County: Wayne

USGS Quad: Kenly East

**GENERAL PERMIT (REGIONAL AND NATIONWIDE) VERIFICATION**

Property Owner / Authorized Agent: North Carolina Department of Transportation

Address: Attn: Gregory J. Thorpe  
1548 Mail Service Center  
Raleigh, North Carolina 27699-1548

Telephone No.: 919-733-3147

Size and location of property (water body, road name/number, town, etc.): Bridge No. 21 over Great Swamp on NC 222, east of the Town of Kenly. Great Swamp connects to Black Creek which connects to Contentnea Creek which connects to the Neuse River.

Description of projects area and activity: Replace existing bridge with a new bridge at the same location. Project will result in permanent impacts of 0.059 acres to riparian wetlands. Refer to Special Conditions for mitigation requirement.

Applicable Law:  Section 404 (Clean Water Act, 33 USC 1344)  
 Section 10 (Rivers and Harbors Act, 33 USC 403)

Authorization: Regional General Permit Number: \_\_\_\_\_  
Nationwide Permit Number: 23

Your work is authorized by the above referenced permit provided it is accomplished in strict accordance with the attached conditions and your submitted plans. Any violation of the attached conditions or deviation from your submitted plans may subject the permittee to a stop work order, a restoration order and/or appropriate legal action.

This verification is valid until the NWP is modified, reissued, or revoked. All of the existing NWPs are scheduled to be modified, reissued, or revoked prior to March 18, 2007. It is incumbent upon you to remain informed of changes to the NWPs. We will issue a public notice when the NWPs are reissued. Furthermore, if you commence or are under contract to commence this activity before the date that the relevant nationwide permit is modified or revoked, you will have twelve (12) months from the date of the modification or revocation of the NWP to complete the activity under the present terms and conditions of this nationwide permit. If, prior to the expiration date identified below, the nationwide permit authorization is reissued and/or modified, this verification will remain valid until the expiration date identified below, provided it complies with all new and/or modified terms and conditions. The District Engineer may, at any time, exercise his discretionary authority to modify, suspend, or revoke a case specific activity's authorization under any NWP.

Activities subject to Section 404 (as indicated above) may also require an individual Section 401 Water Quality Certification. You should contact the NC Division of Water Quality (telephone (919) 733-1786) to determine Section 401 requirements.

For activities occurring within the twenty coastal counties subject to regulation under the Coastal Area Management Act (CAMA), prior to beginning work you must contact the N.C. Division of Coastal Management.

This Department of the Army verification does not relieve the permittee of the responsibility to obtain any other required Federal, State or local approvals/permits.

If there are any questions regarding this verification, any of the conditions of the Permit, or the Corps of Engineers regulatory program, please contact William Wescott at 252-975-1616 extension 31.

Corps Regulatory Official William Wescott, P.W.S. Date: 02/27/2006

Expiration Date of Verification: 03/18/2007

**Determination of Jurisdiction:**

- A.  Based on preliminary information, there appear to be waters of the US including wetlands within the above described project area. This preliminary determination is not an appealable action under the Regulatory Program Administrative Appeal Process ( Reference 33 CFR Part 331).
- B.  There are Navigable Waters of the United States within the above described project area subject to the permit requirements of Section 10 of the Rivers and Harbors Act and Section 404 of the Clean Water Act. Unless there is a change in the law or our published regulations, this determination may be relied upon for a period not to exceed five years from the date of this notification.
- C.  There are waters of the US and/or wetlands within the above described project area subject to the permit requirements of Section 404 of the Clean Water Act (CWA)(33 USC § 1344). Unless there is a change in the law or our published regulations, this determination may be relied upon for a period not to exceed five years from the date of this notification.
- D.  The jurisdictional areas within the above described project area have been identified under a previous action. Please reference jurisdictional determination issued \_\_\_\_\_. Action ID \_\_\_\_\_

**Basis of Jurisdictional Determination:** Area meets the three parameters specified in the 1987 USACE Wetlands Delineation Manual and is adjacent to Great Swamp which connects to Black Creek which connects to Contentnea Creek which connects to the Neuse River.

**Appeals Information:** (This information does not apply to preliminary determinations as indicated by paragraph A. above)

This correspondence constitutes an approved jurisdictional determination for the above described site. If you object to this determination, you may request an administrative appeal under Corps regulations at 33 CFR part 331. Enclosed you will find a Notification of Appeal Process (NAP) fact sheet and request for appeal (RFA) form. If you request to appeal this determination you must submit a completed RFA form to the South Atlantic Division, Division Office at the Following address:

Mr. Michael F. Bell, Administrative Appeal Review Officer  
 CESAD-ET-CO-R  
 U.S. Army Corps of Engineers, South Atlantic Division  
 60 Forsyth Street, Room 9M15  
 Atlanta, Georgia 30303-8801

In order for an RFA to be accepted by the Corps, the Corps must determine that it is complete, that it meets the criteria for appeal under 33 CFR part 331.5, and that it has been received by the Division Office within 60 days of the date of the NAP. Should you decide to submit an RFA form, it must be received at the above address by 4/27/2006.

\*\*It is not necessary to submit an RFA form to the Division Office if you do not object to the determination in this correspondence.\*\*

Corps Regulatory Official: William W. W. P.W.S.

Date 02/27/2006

Copy Furnished:  
 NCDOT, Division 4 Environmental Officer  
 NCDWQ, John Hennessy, Wetlands/401 Unit

## Additional Special Conditions

Action I.D. # 200610532 - NCDOT, Division 4, NC 222 (Bridge Replacement # 21)

a) All measures will be taken to avoid any temporary fill from entering into Great Swamp from bridge demolition. Bridge demolition shall follow NCDOT best management practices for construction and maintenance activities dated August 2003 and incorporate NCDOT policy entitled "Bridge Demolition and Removal in Waters of the United States" dated September 20, 1999.

b) All in-water work must be completed outside an in-water work moratorium from February 15 through June 15.

c) The permittee will follow NCDOT adopted anadromous fish stream crossing guidelines.

## Pre-Construction

d) Prior to commencing construction within jurisdictional waters of the United States, the permittee shall forward the latest version of project construction drawings to the USACE, Raleigh Regulatory Field Office NCDOT Regulatory Project Manager. Half-size drawings are acceptable.

e) The permittee shall schedule an environmental preconstruction meeting between its representatives, the contractor's representatives, and the USACE, Raleigh Regulatory Field Office NCDOT Regulatory Project Manager, prior to any work within jurisdictional waters and wetlands to ensure that there is a mutual understanding of all of the terms and conditions contained within this Department of the Army Permit. The permittee shall provide the USACE, Washington Regulatory Field Office NCDOT Regulatory Project Manager, with a copy of the final plans at least two weeks prior to the preconstruction meeting along with a description of any changes that have been made to the project's design, construction methodology or construction timeframe. The permittee shall schedule the environmental preconstruction meeting for a time when the USACE and North Carolina Division of Water Quality (NCDWQ) Project Managers can attend. The permittee shall invite the USACE and NCDWQ Project Managers a minimum of four weeks in advance of the scheduled meeting in order to provide those individuals with ample opportunity to schedule and participate in the required meeting.

f) Except as authorized by this permit or any USACE approved modification to this permit, no excavation, fill, or mechanized land-clearing activities shall take place at any time in the construction or maintenance of this project, within waters or wetlands, or any activities that cause the degradation of waters or wetlands, except as authorized by this

permit, or any modification to this permit. This permit does not authorize temporary placement or double handling of excavated or fill material within waters or wetlands outside the permitted area. There shall be no excavation from, waste disposal into, or degradation of, jurisdictional waters or wetlands associated with this permit without appropriate modification of this permit, including appropriate compensatory mitigation. This prohibition applies to all borrow and fill activities connected with this project.

g) To ensure that all borrow and waste activities occur on high ground and do not result in the degradation of adjacent wetlands and streams, except as authorized by this permit, the permittee shall require its contractors and/or agents to identify all areas to be used to borrow material, or to dispose of dredged, fill, or waste material. The permittee shall provide the USACE with appropriate maps indicating the locations of proposed borrow or waste sites as soon as the permittee has that information. The permittee will coordinate with the USACE before approving any borrow or waste sites that are within 400 feet of any streams or wetlands. The permittee shall ensure that all such areas comply with condition (f) of this permit, and shall require and maintain documentation of the location and characteristics of all borrow and disposal sites associated with this project. This information will include data regarding soils, vegetation and hydrology sufficient to clearly demonstrate compliance with the preceding condition (f). All information will be available to the USACE upon request. NCDOT shall require its contractors to complete and execute reclamation plans for each waste and borrow site and provide written documentation that the reclamation plans have been implemented and all work is completed. This documentation will be provided to the Corps of Engineers within 30 days of the completion of the reclamation work.

#### Mitigation

\*h) The unavoidable impacts to 0.059 acres of riparian cypress-gum swamp associated with this project shall be mitigated by NCDOT by providing 0.118 acres of restoration equivalent riparian wetlands in the Neuse River basin (Hydrologic Cataloging Unit 03020203). For wetlands, a minimum of 1:1 (impact to mitigation) must be in the form of wetland restoration. It is recommended that NCDOT provide this mitigation in accordance with the procedures suggested in our letter dated 1 September 13, 2004 from Mr. Ken Jolly to Dr. Gregory J. Thorpe

Action ID Number: 200610532

110-A

County: Wayne

Permittee: NCDOT

Date Permit Issued: 2/27/2006

Project Manager: William Wescott

✗ Upon completion of the activity authorized by this permit and any mitigation required by the permit, sign this certification and return it to the following address:

US ARMY CORPS OF ENGINEERS  
WILMINGTON DISTRICT  
WASHINGTON REGULATORY FIELD OFFICE  
Post Office Box 1000  
Washington, North Carolina 27889

Please note that your permitted activity is subject to a compliance inspection by a U. S. Army Corps of Engineers representative. If you fail to comply with this permit you are subject to permit suspension, modification, or revocation.

I hereby certify that the work authorized by the above referenced permit has been completed in accordance with the terms and condition of the said permit, and required mitigation was completed in accordance with the permit conditions.

\_\_\_\_\_  
Signature of Permittee

\_\_\_\_\_  
Date

110-B

## MEMORANDUM FOR RECORD

SUBJECT: Consideration of Compensatory Mitigation and Potential Impacts to Endangered Species, Cultural Resources and Essential Fish Habitat.

1. Action ID. 200610532

2. Project Name and Location: NCDOT, B-4319 on NC 222 east of Kenly

3. Mitigation [Section 404(b)(1) Guidelines].

a. Has applicant avoided and minimized impacts to the maximum practicable extent? YES

If NO, Explain: \_\_\_\_\_

b. Is compensatory mitigation necessary? YES

Explain: Compensatory mitigation for 0.059 acres of riparian wetland impact will be provided by NCEEP at a 2:1 restoration to impact ratio within the CU 03020203 of the Neuse River Basin.

4. Endangered Species (Section 7 of the ESA).

a. Will any threatened or endangered species or their critical habitats be affected by this project? NO

If YES, describe steps taken to address concerns: \_\_\_\_\_

5. Cultural Resources (Section 106 of the NHPA).

a. Will any Cultural Resources be impacted by this project? NO

b. If YES, describe steps taken to address concerns: \_\_\_\_\_

6. Essential Fish Habitat (50 CFR Part 600, Magnuson-Stevens Act).

a. Is this a project that "may adversely affect essential fish habitat"? NO

b. If YES, describe steps taken to address concerns: \_\_\_\_\_

Corps Regulatory Official: William Wercel, P.W.S.

**JURISDICTIONAL DETERMINATION (Revised 8/13/04)**  
**U.S. Army Corps of Engineers**

**DISTRICT OFFICE:** CESAW-RG-W  
**FILE NUMBER:** 200610532

110-C

**PROJECT LOCATION INFORMATION:**

State: North Carolina  
County: Wayne  
Center coordinates of site (latitude/longitude): 35.5611 N 78.0218 W  
Approximate size of area (parcel) reviewed, including uplands: 13 acres.  
Name of nearest waterway: Great Swamp  
Name of watershed: Neuse River Basin

**JURISDICTIONAL DETERMINATION**

**Completed:** Desktop determination  Date: 2/27/2006  
Site visit(s)  Date(s):

**Jurisdictional Determination (JD):**

- Preliminary JD - Based on available information,  *there appear to be* (or)  *there appear to be no* "waters of the United States" and/or "navigable waters of the United States" on the project site. A preliminary JD is not appealable (Reference 33 CFR part 331).
- Approved JD - An approved JD is an appealable action (Reference 33 CFR part 331).  
Check all that apply:
- There are* "navigable waters of the United States" (as defined by 33 CFR part 329 and associated guidance) within the reviewed area.  
Approximate size of jurisdictional area: .
- There are* "waters of the United States" (as defined by 33 CFR part 328 and associated guidance) within the reviewed area.  
Approximate size of jurisdictional area: .
- There are* "isolated, non-navigable, intra-state waters or wetlands" within the reviewed area.  
 Decision supported by SWANCC/Migratory Bird Rule Information Sheet for Determination of No Jurisdiction.

**BASIS OF JURISDICTIONAL DETERMINATION:**

**A. Waters defined under 33 CFR part 329 as "navigable waters of the United States":**

- The presence of waters that are subject to the ebb and flow of the tide and/or are presently used, or have been used in the past, or may be susceptible for use to transport interstate or foreign commerce.

**B. Waters defined under 33 CFR part 328.3(a) as "waters of the United States":**

- (1) The presence of waters, which are currently used, or were used in the past, or may be susceptible to use in interstate or foreign commerce, including all waters which are subject to the ebb and flow of the tide.
- (2) The presence of interstate waters including interstate wetlands<sup>1</sup>.
- (3) The presence of other waters such as intrastate lakes, rivers, streams (including intermittent streams), mudflats, sandflats, wetlands, sloughs, prairie potholes, wet meadows, playa lakes, or natural ponds, the use, degradation or destruction of which could affect interstate commerce including any such waters (check all that apply):
- (i) which are or could be used by interstate or foreign travelers for recreational or other purposes.
- (ii) from which fish or shellfish are or could be taken and sold in interstate or foreign commerce.
- (iii) which are or could be used for industrial purposes by industries in interstate commerce.
- (4) Impoundments of waters otherwise defined as waters of the US.
- (5) The presence of a tributary to a water identified in (1) - (4) above.
- (6) The presence of territorial seas.
- (7) The presence of wetlands adjacent<sup>2</sup> to other waters of the US, except for those wetlands adjacent to other wetlands.

**Rationale for the Basis of Jurisdictional Determination (applies to any boxes checked above).** *If the jurisdictional water or wetland is not itself a navigable water of the United States, describe connection(s) to the downstream navigable waters. If B(1) or B(3) is used as the Basis of Jurisdiction, document navigability and/or interstate commerce connection (i.e., discuss site conditions, including why the waterbody is navigable and/or how the destruction of the waterbody could affect interstate or foreign commerce). If B(2, 4, 5 or 6) is used as the Basis of Jurisdiction, document the rationale used to make the determination. If B(7) is used as the Basis of Jurisdiction, document the rationale used to make adjacency determination: Area meets the three parameters specified in the 1987 USACE Wetlands Delineation Manual and is adjacent to Great Swamp which connects to Black Creek which connects to Contentnea Creek which connects to the Neuse River.*



**Lateral Extent of Jurisdiction:** (Reference: 33 CFR parts 328 and 329)

- |  |  |
|--|--|
| <input checked="" type="checkbox"/> Ordinary High Water Mark indicated by: | <input checked="" type="checkbox"/> High Tide Line indicated by:   |
| <input type="checkbox"/> clear, natural line impressed on the bank         | <input type="checkbox"/> oil or scum line along shore objects      |
| <input type="checkbox"/> the presence of litter and debris                 | <input type="checkbox"/> fine shell or debris deposits (foreshore) |
| <input type="checkbox"/> changes in the character of soil                  | <input type="checkbox"/> physical markings/characteristics         |
| <input type="checkbox"/> destruction of terrestrial vegetation             | <input type="checkbox"/> tidal gages                               |
| <input type="checkbox"/> shelving  | <input type="checkbox"/> other:                                    |
| <input type="checkbox"/> other:  |  |
- Mean High Water Mark indicated by:  
 survey to available datum;  physical markings;  vegetation lines/changes in vegetation types.

Wetland boundaries, as shown on the attached wetland delineation map and/or in a delineation report prepared by: Lochner, Inc.

**Basis For Not Asserting Jurisdiction:**

- The reviewed area consists entirely of uplands.  
 Unable to confirm the presence of waters in 33 CFR part 328(a)(1, 2, or 4-7).  
 Headquarters declined to approve jurisdiction on the basis of 33 CFR part 328.3(a)(3).  
 The Corps has made a case-specific determination that the following waters present on the site are not Waters of the United States:
- Waste treatment systems, including treatment ponds or lagoons, pursuant to 33 CFR part 328.3.
  - Artificially irrigated areas, which would revert to upland if the irrigation ceased.
  - Artificial lakes and ponds created by excavating and/or diking dry land to collect and retain water and which are used exclusively for such purposes as stock watering, irrigation, settling basins, or rice growing.
  - Artificial reflecting or swimming pools or other small ornamental bodies of water created by excavating and/or diking dry land to retain water for primarily aesthetic reasons.
  - Water-filled depressions created in dry land incidental to construction activity and pits excavated in dry land for the purpose of obtaining fill, sand, or gravel unless and until the construction or excavation operation is abandoned and the resulting body of water meets the definition of waters of the United States found at 33 CFR 328.3(a).
  - Isolated, intrastate wetland with no nexus to interstate commerce.
  - Prior converted cropland, as determined by the Natural Resources Conservation Service. Explain rationale:
  - Non-tidal drainage or irrigation ditches excavated on dry land. Explain rationale:
  - Other (explain):

**DATA REVIEWED FOR JURISDICTIONAL DETERMINATION (mark all that apply):**

- Maps, plans, plots or plat submitted by or on behalf of the applicant.  
 Data sheets prepared/submitted by or on behalf of the applicant.  
 This office concurs with the delineation report, dated 1/25/2006, prepared by (company): Lochner, Inc.  
 This office does not concur with the delineation report, dated \_\_\_\_\_, prepared by (company): \_\_\_\_\_
- Data sheets prepared by the Corps.  
 Corps' navigable waters' studies:  
 U.S. Geological Survey Hydrologic Atlas:  
 U.S. Geological Survey 7.5 Minute Topographic maps: Kenly East  
 U.S. Geological Survey 7.5 Minute Historic quadrangles:  
 U.S. Geological Survey 15 Minute Historic quadrangles:  
 USDA Natural Resources Conservation Service Soil Survey:  
 National wetlands inventory maps:  
 State/Local wetland inventory maps:  
 FEMA/FIRM maps (Map Name & Date):  
 100-year Floodplain Elevation is: \_\_\_\_\_ (NGVD)  
 Aerial Photographs (Name & Date):  
 Other photographs (Date):  
 Advanced Identification Wetland maps:  
 Site visit/determination conducted on:  
 Applicable/supporting case law:  
 Other information (please specify):

<sup>1</sup>Wetlands are identified and delineated using the methods and criteria established in the Corps Wetland Delineation Manual (87 Manual) (i.e., occurrence of hydrophytic vegetation, hydric soils and wetland hydrology).

<sup>2</sup>The term "adjacent" means bordering, contiguous, or neighboring. Wetlands separated from other waters of the U.S. by man-made dikes or barriers, natural river berms, beach dunes, and the like are also adjacent.

**NOTIFICATION OF ADMINISTRATIVE APPEAL OPTIONS AND PROCESS AND  
REQUEST FOR APPEAL**

Applicant: NCDOT	File Number: 200610532	Date: 2/27/2006
Attached is:		See Section below
<input type="checkbox"/> INITIAL PROFFERED PERMIT (Standard Permit or Letter of permission)		A
<input type="checkbox"/> PROFFERED PERMIT (Standard Permit or Letter of permission)		B
<input type="checkbox"/> PERMIT DENIAL		C
<input type="checkbox"/> APPROVED JURISDICTIONAL DETERMINATION		D
<input checked="" type="checkbox"/> PRELIMINARY JURISDICTIONAL DETERMINATION		E

**SECTION I -** The following identifies your rights and options regarding an administrative appeal of the above decision. Additional information may be found at <http://www.usace.army.mil/inet/functions/cw/cecwo/reg> or Corps regulations at 33 CFR Part 331.

**A: INITIAL PROFFERED PERMIT:** You may accept or object to the permit.

- **ACCEPT:** If you received a Standard Permit, you may sign the permit document and return it to the district engineer for final authorization. If you received a Letter of Permission (LOP), you may accept the LOP and your work is authorized. Your signature on the Standard Permit or acceptance of the LOP means that you accept the permit in its entirety, and waive all rights to appeal the permit, including its terms and conditions, and approved jurisdictional determinations associated with the permit.
- **OBJECT:** If you object to the permit (Standard or LOP) because of certain terms and conditions therein, you may request that the permit be modified accordingly. You must complete Section II of this form and return the form to the district engineer. Your objections must be received by the district engineer within 60 days of the date of this notice, or you will forfeit your right to appeal the permit in the future. Upon receipt of your letter, the district engineer will evaluate your objections and may: (a) modify the permit to address all of your concerns, (b) modify the permit to address some of your objections, or (c) not modify the permit having determined that the permit should be issued as previously written. After evaluating your objections, the district engineer will send you a proffered permit for your reconsideration, as indicated in Section B below.

**B: PROFFERED PERMIT:** You may accept or appeal the permit

- **ACCEPT:** If you received a Standard Permit, you may sign the permit document and return it to the district engineer for final authorization. If you received a Letter of Permission (LOP), you may accept the LOP and your work is authorized. Your signature on the Standard Permit or acceptance of the LOP means that you accept the permit in its entirety, and waive all rights to appeal the permit, including its terms and conditions, and approved jurisdictional determinations associated with the permit.
- **APPEAL:** If you choose to decline the proffered permit (Standard or LOP) because of certain terms and conditions therein, you may appeal the declined permit under the Corps of Engineers Administrative Appeal Process by completing Section II of this form and sending the form to the division engineer. This form must be received by the division engineer within 60 days of the date of this notice.

**C: PERMIT DENIAL:** You may appeal the denial of a permit under the Corps of Engineers Administrative Appeal Process by completing Section II of this form and sending the form to the division engineer. This form must be received by the division engineer within 60 days of the date of this notice.

**D: APPROVED JURISDICTIONAL DETERMINATION:** You may accept or appeal the approved JD or provide new information.

- **ACCEPT:** You do not need to notify the Corps to accept an approved JD. Failure to notify the Corps within 60 days of the date of this notice, means that you accept the approved JD in its entirety, and waive all rights to appeal the approved JD.
- **APPEAL:** If you disagree with the approved JD, you may appeal the approved JD under the Corps of Engineers Administrative Appeal Process by completing Section II of this form and sending the form to the division engineer. This form must be received by the division engineer within 60 days of the date of this notice.

**E: PRELIMINARY JURISDICTIONAL DETERMINATION:** You do not need to respond to the Corps regarding the preliminary JD. The Preliminary JD is not appealable. If you wish, you may request an approved JD (which may be appealed), by contacting the Corps district for further instruction. Also you may provide new information for further consideration by the Corps to reevaluate the JD.

**SECTION II - REQUEST FOR APPEAL or OBJECTIONS TO AN INITIAL PROFFERED PERMIT**

**REASONS FOR APPEAL OR OBJECTIONS:** (Describe your reasons for appealing the decision or your objections to an initial proffered permit in clear concise statements. You may attach additional information to this form to clarify where your reasons or objections are addressed in the administrative record.)

**ADDITIONAL INFORMATION:** The appeal is limited to a review of the administrative record, the Corps memorandum for the record of the appeal conference or meeting, and any supplemental information that the review officer has determined is needed to clarify the administrative record. Neither the appellant nor the Corps may add new information or analyses to the record. However, you may provide additional information to clarify the location of information that is already in the administrative record.

**POINT OF CONTACT FOR QUESTIONS OR INFORMATION:**

If you have questions regarding this decision and/or the appeal process you may contact:  
 US Army Corps of Engineers  
 Attn: William Wescott  
 Post Office Box 1000  
 Washington, NC 27889

If you only have questions regarding the appeal process you may also contact:  
 Mr. Michael F. Bell, Administrative Appeal Review Officer  
 CESAD-ET-CO-R  
 U.S. Army Corps of Engineers, South Atlantic Division  
 60 Forsyth Street, Room 9M15  
 Atlanta, Georgia 30303-8801

**RIGHT OF ENTRY:** Your signature below grants the right of entry to Corps of Engineers personnel, and any government consultants, to conduct investigations of the project site during the course of the appeal process. You will be provided a 15 day notice of any site investigation, and will have the opportunity to participate in all site investigations.

_____ Signature of appellant or agent.	Date:	Telephone number:
---	-------	-------------------

**DIVISION ENGINEER:**  
**Commander**  
**U.S. Army Engineer Division, South Atlantic**  
**60 Forsyth Street, Room 9M15**  
**Atlanta, Georgia 30303-3490**

**NATIONWIDE PERMIT 23**  
DEPARTMENT OF THE ARMY  
CORPS OF ENGINEERS  
FINAL NOTICE OF ISSUANCE AND MODIFICATION OF NATIONWIDE PERMITS  
FEDERAL REGISTER  
AUTHORIZED MARCH 18, 2002

**Approved Categorical Exclusions:** Activities undertaken, assisted, authorized, regulated, funded, or financed, in whole or in part, by another Federal agency or department where that agency or department has determined, pursuant to the Council on Environmental Quality Regulation for Implementing the Procedural Provisions of the National Environmental Policy Act (NEPA) (40 CFR part 1500 et seq.), that the activity, work, or discharge is categorically excluded from environmental documentation because it is included within a category of actions which neither individually nor cumulatively have a significant effect on the human environment, and the Office of the Chief of Engineers (ATTN: CECW-OR) has been furnished notice of the agency's or department's application for the categorical exclusion and concurs with that determination. Before to approval for purposes of this nationwide permit of any agency's categorical exclusions, the Chief of Engineers will solicit public comment. In addressing these comments, the Chief of Engineers may require certain conditions for authorization of an agency's categorical exclusions under this nationwide permit. (Sections 10 and 404)

**NATIONWIDE PERMIT GENERAL CONDITIONS**

The following General Conditions must be followed in order for any authorization by a NWP to be valid:

1. Navigation. No activity may cause more than a minimal adverse effect on navigation.
2. Proper Maintenance. Any structure or fill authorized shall be properly maintained, including maintenance to ensure public safety.
3. Soil Erosion and Sediment Controls. Appropriate soil erosion and sediment controls must be used and maintained in effective operating condition during construction, and all exposed soil and other fills, as well as any work below the ordinary high water mark or high tide line, must be permanently stabilized at the earliest practicable date. Permittees are encouraged to perform work within waters of the United States during periods of low-flow or no-flow.
4. Aquatic Life Movements. No activity may substantially disrupt the necessary life-cycle movements of those species of aquatic life indigenous to the waterbody, including those species that normally migrate through the area, unless the activity's primary purpose is to impound water. Culverts placed in streams must be installed to maintain low flow conditions.
5. Equipment. Heavy equipment working in wetlands must be placed on mats, or other measures must be taken to minimize soil disturbance.
6. Regional and Case-By-Case Conditions. The activity must comply with any regional conditions that may have been added by the Division Engineer (see 33 CFR 330.4(e)) and with any case specific conditions added by the Corps or by the state or tribe in its Section 401 Water Quality Certification and Coastal Zone Management Act consistency determination.
7. Wild and Scenic Rivers. No activity may occur in a component of the National Wild and Scenic River System; or in a river officially designated by Congress as a 'study river' for possible inclusion in the system, while the river is in an official study status; unless the appropriate Federal agency, with direct management responsibility for such river, has determined in writing that the proposed activity will not adversely affect the Wild and Scenic River designation, or study status. Information on Wild and Scenic Rivers may be obtained from the appropriate Federal land management agency in the area (e.g., National Park Service, U.S. Forest Service, Bureau of Land Management, U.S. Fish and Wildlife Service).
8. Tribal Rights. No activity or its operation may impair reserved tribal rights, including, but not limited to, reserved water rights and treaty fishing and hunting rights.
9. Water Quality.

a. In certain states and tribal lands an individual 401 Water Quality Certification must be obtained or waived (See 33 CFR 330.4(c)).

b. For NWPs 12, 14, 17, 18, 32, 39, 40, 42, 43, and 44, where the state or tribal 401 certification (either generically or individually) does not require or approve water quality management measures, the permittee must provide water quality management measures that will ensure that the authorized work does not result in more than minimal degradation of water quality (or the Corps determines that compliance with state or local standards, where applicable, will ensure no more than minimal adverse effect on water quality). An important component of water quality management includes stormwater management that minimizes degradation of the downstream aquatic system, including water quality (refer to General Condition 21 for stormwater management requirements). Another important component of water quality management is the establishment and maintenance of vegetated buffers next to open waters, including streams (refer to General Condition 19 for vegetated buffer requirements for the NWPs).

This condition is only applicable to projects that have the potential to affect water quality. While appropriate measures must be taken, in most cases it is not necessary to conduct detailed studies to identify such measures or to require monitoring.

10. Coastal Zone Management. In certain states, an individual state coastal zone management consistency concurrence must be obtained or waived (see 33 CFR 330.4(d)).

#### 11. Endangered Species.

a. No activity is authorized under any NWP which is likely to jeopardize the continued existence of a threatened or endangered species or a species proposed for such designation, as identified under the Federal Endangered Species Act (ESA), or which will destroy or adversely modify the critical habitat of such species. Non-federal permittees shall notify the District Engineer if any listed species or designated critical habitat might be affected or is in the vicinity of the project, or is located in the designated critical habitat and shall not begin work on the activity until notified by the District Engineer that the requirements of the ESA have been satisfied and that the activity is authorized. For activities that may affect Federally-listed endangered or threatened species or designated critical habitat, the notification must include the name(s) of the endangered or threatened species that may be affected by the proposed work or that utilize the designated critical habitat that may be affected by the proposed work. As a result of formal or informal consultation with the FWS or NMFS the District Engineer may add species-specific regional endangered species conditions to the NWPs.

b. Authorization of an activity by a NWP does not authorize the "take" of a threatened or endangered species as defined under the ESA. In the absence of separate authorization (e.g., an ESA Section 10 Permit, a Biological Opinion with "incidental take" provisions, etc.) from the USFWS or the NMFS, both lethal and non-lethal "takes" of protected species are in violation of the ESA. Information on the location of threatened and endangered species and their critical

habitat can be obtained directly from the offices of the USFWS and NMFS or their World Wide Web pages at <http://www.fws.gov/r9endspp/endspp.html> and <http://www.nfms.noaa.gov/protres/overview/es.html> respectively.

12. Historic Properties. No activity that may affect historic properties listed, or eligible for listing, in the National Register of Historic Places is authorized, until the District Engineer has complied with the provisions of 33 CFR part 325, Appendix C. The prospective permittee must notify the District Engineer if the authorized activity may affect any historic properties listed, determined to be eligible, or which the prospective permittee has reason to believe may be eligible for listing on the National Register of Historic Places, and shall not begin the activity until notified by the District Engineer that the requirements of the National Historic Preservation Act have been satisfied and that the activity is authorized. Information on the location and existence of historic resources can be obtained from the State Historic Preservation Office and the National Register of Historic Places (see 33 CFR 330.4(g)). For activities that may affect historic properties listed in, or eligible for listing in, the National Register of Historic Places, the notification must state which historic property may be affected by the proposed work or include a vicinity map indicating the location of the historic property.

✱13. Notification.

a. Timing; where required by the terms of the NWP, the prospective permittee must notify the District Engineer with a preconstruction notification (PCN) as early as possible. The District Engineer must determine if the notification is complete within 30 days of the date of receipt and can request additional information necessary to make the PCN complete only once. However, if the prospective permittee does not provide all of the requested information, then the District Engineer will notify the prospective permittee that the notification is still incomplete and the PCN review process will not commence until all of the requested information has been received by the District Engineer. The prospective permittee shall not begin the activity:

1. Until notified in writing by the District Engineer that the activity may proceed under the NWP with any special conditions imposed by the District or Division Engineer; or

2. If notified in writing by the District or Division Engineer that an Individual Permit is required; or

3. Unless 45 days have passed from the District Engineer's receipt of the complete notification and the prospective permittee has not received written notice from the District or Division Engineer. Subsequently, the permittee's right to proceed under the NWP may be modified, suspended, or revoked only in accordance with the procedure set forth in 33 CFR 330.5(d)(2).

b. Contents of Notification: The notification must be in writing and include the following information:

1. Name, address and telephone numbers of the prospective permittee;

2. Location of the proposed project;

3. Brief description of the proposed project; the project's purpose; direct and indirect adverse environmental effects the project would cause; any other NWP(s), Regional General Permit(s), or Individual Permit(s) used or intended to be used to authorize any part of the proposed project or any related activity. Sketches should be provided when necessary to show that the activity complies with the terms of the NWP (Sketches usually clarify the project and when provided result in a quicker decision.);

4. For NWPs 7, 12, 14, 18, 21, 34, 38, 39, 40, 41, 42, and 43, the PCN must also include a delineation of affected special aquatic sites, including wetlands, vegetated shallows (e.g., submerged aquatic vegetation, seagrass beds), and riffle and pool complexes (see paragraph 13(f));

5. For NWP 7 (Cutfall Structures and Maintenance), the PCN must include information regarding the original design capacities and configurations of those areas of the facility where maintenance dredging or excavation is proposed;

6. For NWP 14 (Linear Transportation Projects), the PCN must include a compensatory mitigation proposal to offset permanent losses of waters of the US and a statement describing how temporary losses of waters of the US will be minimized to the maximum extent practicable;

7. For NWP 21 (Surface Coal Mining Activities), the PCN must include an Office of Surface Mining (OSM) or state-approved mitigation plan, if applicable. To be authorized by this NWP, the District Engineer must determine that the activity complies with the terms and conditions of the NWP and that the adverse environmental effects are minimal both individually and cumulatively and must notify the project sponsor of this determination in writing;

8. For NWP 27 (Stream and Wetland Restoration Activities), the PCN must include documentation of the prior condition of the site that will be reverted by the permittee;

9. For NWP 29 (Single-Family Housing), the PCN must also include:

i. Any past use of this NWP by the Individual Permittee and/or the permittee's spouse;

ii. A statement that the single-family housing activity is for a personal residence of the permittee;

iii. A description of the entire parcel, including its size, and a delineation of wetlands. For the purpose of this NWP, parcels of land measuring  $\frac{1}{4}$ -acre or less will not require a formal on-site delineation. However, the applicant shall provide an indication of where the wetlands are and the amount of wetlands that exists on the property. For parcels greater than



\1/4\ acre in size, formal wetland delineation must be prepared in accordance with the current method required by the Corps. (See paragraph 13(f));

iv. A written description of all land (including, if available, legal descriptions) owned by the prospective permittee and/or the prospective permittee's spouse, within a one mile radius of the parcel, in any form of ownership (including any land owned as a partner, corporation, joint tenant, co-tenant, or as a tenant-by-the-entirety) and any land on which a purchase and sale agreement or other contract for sale or purchase has been executed;

10. For NWP 31 (Maintenance of Existing Flood Control Facilities), the prospective permittee must either notify the District Engineer with a PCN prior to each maintenance activity or submit a five-year (or less) maintenance plan. In addition, the PCN must include all of the following:

i. Sufficient baseline information identifying the approved channel depths and configurations and existing facilities. Minor deviations are authorized, provided the approved flood control protection or drainage is not increased;

ii. A delineation of any affected special aquatic sites, including wetlands; and,

iii. Location of the dredged material disposal site;

11. For NWP 33 (Temporary Construction, Access, and Dewatering), the PCN must also include a restoration plan of reasonable measures to avoid and minimize adverse effects to aquatic resources;

12. For NWPs 39, 43 and 44, the PCN must also include a written statement to the District Engineer explaining how avoidance and minimization for losses of waters of the US were achieved on the project site;

13. For NWP 39 and NWP 42, the PCN must include a compensatory mitigation proposal to offset losses of waters of the US or justification explaining why compensatory mitigation should not be required. For discharges that cause the loss of greater than 300 linear feet of an intermittent stream bed, to be authorized, the District Engineer must determine that the activity complies with the other terms and conditions of the NWP, determine adverse environmental effects are minimal both individually and cumulatively, and waive the limitation on stream impacts in writing before the permittee may proceed;

14. For NWP 40 (Agricultural Activities), the PCN must include a compensatory mitigation proposal to offset losses of waters of the US. This NWP does not authorize the relocation of greater than 300 linear feet of existing serviceable drainage ditches constructed in non-tidal streams unless, for drainage ditches constructed in intermittent nontidal streams, the District Engineer waives this criterion in writing, and the District Engineer has determined that the project complies with all terms and conditions of this NWP, and that any adverse impacts of the project on the aquatic environment are minimal, both individually and cumulatively;

15. For NWP 43 (Stormwater Management Facilities), the PCN must include, for the construction of new stormwater management facilities, a maintenance plan (in accordance with state and local requirements, if applicable) and a compensatory mitigation proposal to offset losses of waters of the US. For discharges that cause the loss of greater than 300 linear feet of an intermittent stream bed, to be authorized, the District Engineer must determine that the activity complies with the other terms and conditions of the NWP, determine adverse environmental effects are minimal both individually and cumulatively, and waive the limitation on stream impacts in writing before the permittee may proceed;

16. For NWP 44 (Mining Activities), the PCN must include a description of all waters of the US adversely affected by the project, a description of measures taken to minimize adverse effects to waters of the US, a description of measures taken to comply with the criteria of the NWP, and a reclamation plan (for all aggregate mining activities in isolated waters and non-tidal wetlands adjacent to headwaters and any hard rock/mineral mining activities);

17. For activities that may adversely affect Federally-listed endangered or threatened species, the PCN must include the name(s) of those endangered or threatened species that may be affected by the proposed work or utilize the designated critical habitat that may be affected by the proposed work; and

18. For activities that may affect historic properties listed in, or eligible for listing in, the National Register of Historic Places, the PCN must state which historic property may be affected by the proposed work or include a vicinity map indicating the location of the historic property.

c. Form of Notification: The standard Individual Permit application form (Form ENG 4345) may be used as the notification but must clearly indicate that it is a PCN and must include all of the information required in (b) (1)-(18) of General Condition 13. A letter containing the requisite information may also be used.

d. District Engineer's Decision: In reviewing the PCN for the proposed activity, the District Engineer will determine whether the activity authorized by the NWP will result in more than minimal individual or cumulative adverse environmental effects or may be contrary to the public interest. The prospective permittee may submit a proposed mitigation plan with the PCN to expedite the process. The District Engineer will consider any proposed compensatory mitigation the applicant has included in the proposal in determining whether the net adverse environmental effects to the aquatic environment of the proposed work are minimal. If the District Engineer determines that the activity complies with the terms and conditions of the NWP and that the adverse effects on the aquatic environment are minimal, after considering mitigation, the District Engineer will notify the permittee and include any conditions the District Engineer deems necessary. The District Engineer must approve any compensatory mitigation proposal before the permittee commences work. If the prospective permittee is required to submit a compensatory mitigation proposal with the PCN, the proposal may be either conceptual or detailed. If the prospective permittee elects to submit a compensatory mitigation plan with the

PCN, the District Engineer will expeditiously review the proposed compensatory mitigation plan. The District Engineer must review the plan within 45 days of receiving a complete PCN and determine whether the conceptual or specific proposed mitigation would ensure no more than minimal adverse effects on the aquatic environment. If the net adverse effects of the project on the aquatic environment (after consideration of the compensatory mitigation proposal) are determined by the District Engineer to be minimal, the District Engineer will provide a timely written response to the applicant. The response will state that the project can proceed under the terms and conditions of the NWP.

If the District Engineer determines that the adverse effects of the proposed work are more than minimal, then the District Engineer will notify the applicant either:

1. That the project does not qualify for authorization under the NWP and instruct the applicant on the procedures to seek authorization under an Individual Permit;
2. that the project is authorized under the NWP subject to the applicant's submission of a mitigation proposal that would reduce the adverse effects on the aquatic environment to the minimal level; or
3. that the project is authorized under the NWP with specific modifications or conditions. Where the District Engineer determines that mitigation is required to ensure no more than minimal adverse effects occur to the aquatic environment, the activity will be authorized within the 45-day PCN period. The authorization will include the necessary conceptual or specific mitigation or a requirement that the applicant submit a mitigation proposal that would reduce the adverse effects on the aquatic environment to the minimal level. When conceptual mitigation is included, or a mitigation plan is required under item (2) above, no work in waters of the US will occur until the District Engineer has approved a specific mitigation plan.

e. Agency Coordination: The District Engineer will consider any comments from Federal and state agencies concerning the proposed activity's compliance with the terms and conditions of the NWPs and the need for mitigation to reduce the project's adverse environmental effects to a minimal level.

For activities requiring notification to the District Engineer that result in the loss of greater than 1/2-acre of waters of the US, the District Engineer will provide immediately (e.g., via facsimile transmission, overnight mail, or other expeditious manner) a copy to the appropriate Federal or state offices (USFWS, state natural resource or water quality agency, EPA, State Historic Preservation Officer (SHPO), and, if appropriate, the NMFS). With the exception of NWP 37, these agencies will then have 10 calendar days from the date the material is transmitted to telephone or fax the District Engineer notice that they intend to provide substantive, site-specific comments. If so contacted by an agency, the District Engineer will wait an additional 15 calendar days before making a decision on the notification. The District Engineer will fully consider agency comments received within the specified time frame, but will provide no response to the resource agency, except as provided below. The District Engineer will indicate in the administrative record associated with each notification that the resource agencies'

concerns were considered. As required by section 305(b)(4)(B) of the Magnuson-Stevens Fishery Conservation and Management Act, the District Engineer will provide a response to NMFS within 30 days of receipt of any Essential Fish Habitat conservation recommendations. Applicants are encouraged to provide the Corps multiple copies of notifications to expedite agency notification.

f. Wetland Delineations: Wetland delineations must be prepared in accordance with the current method required by the Corps (For NWP 29 see paragraph (b)(9)(iii) for parcels less than (1/4\ acre in size). The permittee may ask the Corps to delineate the special aquatic site. There may be some delay if the Corps does the delineation. Furthermore, the 45-day period will not start until the wetland delineation has been completed and submitted to the Corps, where appropriate.

✕14. Compliance Certification. Every permittee who has received NWP verification from the Corps will submit a signed certification regarding the completed work and any required mitigation. The certification will be forwarded by the Corps with the authorization letter and will include:

a. A statement that the authorized work was done in accordance with the Corps authorization, including any general or specific conditions;

b. A statement that any required mitigation was completed in accordance with the permit conditions; and

c. The signature of the permittee certifying the completion of the work and mitigation.

15. Use of Multiple Nationwide Permits. The use of more than one NWP for a single and complete project is prohibited, except when the acreage loss of waters of the US authorized by the NWPs does not exceed the acreage limit of the NWP with the highest specified acreage limit (e.g. if a road crossing over tidal waters is constructed under NWP 14, with associated bank stabilization authorized by NWP 13, the maximum acreage loss of waters of the US for the total project cannot exceed \ 1/3\ acre) .

16. Water Supply Intakes. No activity, including structures and work in navigable waters of the US or discharges of dredged or fill material, may occur in the proximity of a public water supply intake except where the activity is for repair of the public water supply intake structures or adjacent bank stabilization.

17. Shellfish Beds. No activity, including structures and work in navigable waters of the US or discharges of dredged or fill material, may occur in areas of concentrated shellfish populations, unless the activity is directly related to a shellfish harvesting activity authorized by NWP 4.

18. Suitable Material. No activity, including structures and work in navigable waters of the US or discharges of dredged or fill material, may consist of unsuitable material (e.g., trash,

debris, car bodies, asphalt, etc.) and material used for construction or discharged must be free from toxic pollutants in toxic amounts (see section 307 of the CWA).

19. Mitigation. The District Engineer will consider the factors discussed below when determining the acceptability of appropriate and practicable mitigation necessary to offset adverse effects on the aquatic environment that are more than minimal.

a. The project must be designed and constructed to avoid and minimize adverse effects to waters of the US to the maximum extent practicable at the project site (i.e., on site).

b. Mitigation in all its forms (avoiding, minimizing, rectifying, reducing or compensating) will be required to the extent necessary to ensure that the adverse effects to the aquatic environment are minimal.

c. Compensatory mitigation at a minimum one-for-one ratio will be required for all wetland impacts requiring a PCN, unless the District Engineer determines in writing that some other form of mitigation would be more environmentally appropriate and provides a project-specific waiver of this requirement. Consistent with National policy, the District Engineer will establish a preference for restoration of wetlands as compensatory mitigation, with preservation used only in exceptional circumstances.

d. Compensatory mitigation (i.e., replacement or substitution of aquatic resources for those impacted) will not be used to increase the acreage losses allowed by the acreage limits of some of the NWPs. For example,  $\frac{1}{4}$ -acre of wetlands cannot be created to change a  $\frac{3}{4}$ -acre loss of wetlands to a  $\frac{1}{2}$ -acre loss associated with NWP 39 verification. However,  $\frac{1}{2}$ -acre of created wetlands can be used to reduce the impacts of a  $\frac{1}{2}$ -acre loss of wetlands to the minimum impact level in order to meet the minimal impact requirement associated with NWPs.

e. To be practicable, the mitigation must be available and capable of being done considering costs, existing technology, and logistics in light of the overall project purposes. Examples of mitigation that may be appropriate and practicable include, but are not limited to: reducing the size of the project; establishing and maintaining wetland or upland vegetated buffers to protect open waters such as streams; and replacing losses of aquatic resource functions and values by creating, restoring, enhancing, or preserving similar functions and values, preferably in the same watershed.

f. Compensatory mitigation plans for projects in or near streams or other open waters will normally include a requirement for the establishment, maintenance, and legal protection (e.g., easements, deed restrictions) of vegetated buffers to open waters. In many cases, vegetated buffers will be the only compensatory mitigation required. Vegetated buffers should consist of native species. The width of the vegetated buffers required will address documented water quality or aquatic habitat loss concerns. Normally, the vegetated buffer will be 25 to 50 feet wide on each side of the stream, but the District Engineers may require slightly wider vegetated buffers to address documented water quality or habitat loss concerns. Where both wetlands and

open waters exist on the project site, the Corps will determine the appropriate compensatory mitigation (e.g., stream buffers or wetlands compensation) based on what is best for the aquatic environment or, a watershed basis. In cases where vegetated buffers are determined to be the most appropriate form of compensatory mitigation, the District Engineer may waive or reduce the requirement to provide wetland compensatory mitigation for wetland impacts.

g. Compensatory mitigation proposals submitted with the " notification" may be either conceptual or detailed. If conceptual plans are approved under the verification, then the Corps will condition the verification to require detailed plans be submitted and approved by the Corps prior to construction of the authorized activity in waters of the US.

h. Permittees may propose the use of mitigation banks, in-lieu fee arrangements or separate activity-specific compensatory mitigation. In all cases that require compensatory mitigation, the mitigation provisions will specify the party responsible for accomplishing and/or complying with the mitigation plan.

20. Spawning Areas. Activities, including structures and work in navigable waters of the US or discharges of dredged or fill material, in spawning areas during spawning seasons must be avoided to the maximum extent practicable. Activities that result in the physical destruction (e.g., excavate, fill, or smother downstream by substantial turbidity) of an important spawning area are not authorized.

21. Management of Water Flows. To the maximum extent practicable, the activity must be designed to maintain preconstruction downstream flow conditions (e.g., location, capacity, and flow rates). Furthermore, the activity must not permanently restrict or impede the passage of normal or expected high flows (unless the primary purpose of the fill is to impound waters) and the structure or discharge of dredged or fill material must withstand expected high flows. The activity must, to the maximum extent practicable, provide for retaining excess flows from the site, provide for maintaining surface flow rates from the site similar to preconstruction conditions, and provide for not increasing water flows from the project site, relocating water, or redirecting water flow beyond preconstruction conditions. Stream channelizing will be reduced to the minimal amount necessary, and the activity must, to the maximum extent practicable, reduce adverse effects such as flooding or erosion downstream and upstream of the project site, unless the activity is part of a larger system designed to manage water flows. In most cases, it will not be a requirement to conduct detailed studies and monitoring of water flow.

This condition is only applicable to projects that have the potential to affect waterflows. While appropriate measures must be taken, it is not necessary to conduct detailed studies to identify such measures or require monitoring to ensure their effectiveness. Normally, the Corps will defer to state and local authorities regarding management of water flow.

22. Adverse Effects From Impoundments. If the activity creates an impoundment of water, adverse effects to the aquatic system due to the acceleration of the passage of water, and/or the restricting its flow shall be minimized to the maximum extent practicable. This includes

structures and work in navigable waters of the US, or discharges of dredged or fill material.

23. Waterfowl Breeding Areas. Activities, including structures and work in navigable waters of the US or discharges of dredged or fill material, into breeding areas for migratory waterfowl must be avoided to the maximum extent practicable.

24. Removal of Temporary Fills. Any temporary fills must be removed in their entirety and the affected areas returned to their preexisting elevation.

25. Designated Critical Resource Waters. Critical resource waters include, NOAA-designated marine sanctuaries, National Estuarine Research Reserves, National Wild and Scenic Rivers, critical habitat for Federally listed threatened and endangered species, coral reefs, state natural heritage sites, and outstanding national resource waters or other waters officially designated by a state as having particular environmental or ecological significance and identified by the District Engineer after notice and opportunity for public comment. The District Engineer may also designate additional critical resource waters after notice and opportunity for comment.

a. Except as noted below, discharges of dredged or fill material into waters of the US are not authorized by NWP 7, 12, 14, 16, 17, 21, 29, 31, 35, 39, 40, 42, 43, and 44 for any activity within, or directly affecting, critical resource waters, including wetlands adjacent to such waters. Discharges of dredged or fill materials into waters of the US may be authorized by the above NWPs in National Wild and Scenic Rivers if the activity complies with General Condition 7. Further, such discharges may be authorized in designated critical habitat for Federally listed threatened or endangered species if the activity complies with General Condition 11 and the USFWS or the NMFS has concurred in a determination of compliance with this condition.

b. For NWPs 3, 8, 10, 13, 15, 18, 19, 22, 23, 25, 27, 28, 30, 33, 34, 36, 37, and 38, notification is required in accordance with General Condition 13, for any activity proposed in the designated critical resource waters including wetlands adjacent to those waters. The District Engineer may authorize activities under these NWPs only after it is determined that the impacts to the critical resource waters will be no more than minimal.

26. Fills Within 100-Year Floodplains. For purposes of this General Condition, 100-year floodplains will be identified through the existing Federal Emergency Management Agency's (FEMA) Flood Insurance Rate Maps or FEMA-approved local floodplain maps.

a. Discharges in Floodplain; Below Headwaters. Discharges of dredged or fill material into waters of the US within the mapped 100-year floodplain, below headwaters (i.e. five cfs), resulting in permanent above-grade fills, are not authorized by NWPs 39, 40, 42, 43, and 44.

b. Discharges in Floodway; Above Headwaters. Discharges of dredged or fill material into waters of the US within the FEMA or locally mapped floodway, resulting in permanent above-grade fills, are not authorized by NWPs 39, 40, 42, and 44.

c. The permittee must comply with any applicable FEMA-approved state or local

floodplain management requirements.

27. Construction Period. For activities that have not been verified by the Corps and the project was commenced or under contract to commence by the expiration date of the NWP (or modification or revocation date), the work must be completed within 12-months after such date (including any modification that affects the project).

For activities that have been verified and the project was commenced or under contract to commence within the verification period, the work must be completed by the date determined by the Corps.

For projects that have been verified by the Corps, an extension of a Corps approved completion date maybe requested. This request must be submitted at least one month before the previously approved completion date.

### **FURTHER INFORMATION**

1. District Engineers have authority to determine if an activity complies with the terms and conditions of a NWP.
2. NWPs do not obviate the need to obtain other Federal, State, or local permits, approvals, or authorizations required by law.
3. NWPs do not grant any property rights or exclusive privileges.
4. NWPs do not authorize any injury to the property or rights of others.
5. NWPs do not authorize interference with any existing or proposed Federal project.

### **DEFINITIONS**

***Best Management Practices (BMPs):*** BMPs are policies, practices, procedures, or structures implemented to mitigate the adverse environmental effects on surface water quality resulting from development. BMPs are categorized as structural or nonstructural. A BMP policy may affect the limits on a development.

***Compensatory Mitigation:*** For purposes of Section 10/404, compensatory mitigation is the restoration, creation, enhancement, or in exceptional circumstances, preservation of wetlands and/or other aquatic resources for the purpose of compensating for unavoidable adverse impacts, which remain, after all appropriate and practicable avoidance and minimization has been achieved.

***Creation:*** The establishment of a wetland or other aquatic resource where one did not formerly



exist.

Enhancement: Activities conducted in existing wetlands or other aquatic resources that increase one or more aquatic functions.

Ephemeral Stream: An ephemeral stream has *flowing* water only during and for a short duration after, precipitation events in a typical year. Ephemeral stream beds are located above the water table year-round. Groundwater is not a source of water for the stream. Runoff from rainfall is the primary source of water for stream flow.

Farm Tract: A unit of contiguous land under one ownership that is operated as a farm or part of a farm.

Flood Fringe: That portion of the 100-year floodplain outside of the floodway (often referred to as "floodway fringe").

Floodway: The area regulated by Federal, state, or local requirements to provide for the discharge of the base flood so the cumulative increase in water surface elevation is no more than a designated amount (not to exceed one foot as set by the National Flood Insurance Program) within the 100-year floodplain.

Independent Utility: A test to determine what constitutes a single and complete project in the Corps regulatory program. A project is considered to have independent utility if it would be constructed absent the construction of other projects in the project area. Portions of a multi-phase project that depend upon other phases of the project do not have independent utility. Phases of a project that would be constructed even if the other phases were not built can be considered as separate single and complete projects with independent utility.

*Intermittent Stream:* An intermittent stream has flowing water during certain times of the year, when groundwater provides water for stream flow. During dry periods, intermittent streams may not have flowing water. Runoff from rainfall is a supplemental source of water for stream flow.

*Loss of waters of the US:* Waters of the US that include the filled area and other waters that are permanently adversely affected by flooding, excavation, or drainage because of the regulated activity. Permanent adverse effects include permanent above-grade, at-grade, or below-grade fills that change an aquatic area to dry land, increase the bottom elevation of a waterbody, or change the use of a waterbody. The acreage of loss of waters of the US is the threshold measurement of the impact to existing waters for determining whether a project may qualify for a NWP; it is not a net threshold that is calculated after considering compensatory mitigation that may be used to offset losses of aquatic functions and values. The loss of stream bed includes the linear feet of stream bed that is filled or excavated. Waters of the US temporarily filled, flooded, excavated, or drained, but restored to preconstruction contours and elevations after construction, are not included in the measurement of loss of waters of the US. Impacts to ephemeral waters are only not included in the acreage or linear foot measurements of loss of waters of the US or loss of stream bed, for the purpose of determining compliance with the threshold limits of the NWPs.

*Non-tidal Wetland:* An area that, during a year with normal patterns of precipitation has standing or flowing water for sufficient duration to establish an ordinary high water mark. Aquatic vegetation within the area of standing or flowing water is either non-emergent, sparse, or absent. Vegetated shallows are considered to be open waters. The term “open water” includes rivers, streams, lakes, and ponds. For the purposes of the NWPs, this term does not include ephemeral waters.

*Perennial Stream:* A perennial stream has flowing water year-round during a typical year. The water table is located above the stream bed for the most of the year. Groundwater is the primary source of water for stream flow. Runoff from rainfall is a supplemental source of water for stream flow.

*Permanent Above-grade Fill:* A discharge of dredged or fill material into waters of the US, including wetlands, that results in a substantial increase in ground elevation and permanently converts part or all of the waterbody to dry land. Structural fills authorized by NWPs 3, 25, 36, etc. are not included.

*Preservation:* The protection of ecologically important wetlands or other aquatic resources in perpetuity through the implementation of appropriate legal and physical mechanisms. Preservation may include protection of upland areas adjacent to wetlands as necessary to ensure protection and/or enhancement of the overall aquatic ecosystem.

*Restoration:* Re-establishment of wetland and/or other aquatic resource characteristics and function(s) at a site where they have ceased to exist, or exist in a substantially degraded state.

*Riffle and Pool Complex:* Riffle and pool complexes are special aquatic sites under the

404(b)(1) Guidelines. Riffle and pool complexes sometimes characterize steep gradient sections of streams. Such stream sections are recognizable by their hydraulic characteristics. The rapid movement of water over a coarse substrate in riffles results in a rough flow, a turbulent surface and high dissolved oxygen levels in the water. Pools are deeper areas associated with riffles. A slower stream velocity, a streaming flow, a smooth surface, and a finer substrate characterize pools.

*Single and Complete Project:* The term “single and complete project” is defined at 33 CFR 330.2(i) as the total project proposed or accomplished by one owner/developer or partnership or other association of owners/developers (see definition of independent utility). For linear projects, the “single and complete project” (i.e., a single and complete crossing) will apply to each crossing of a separate water of the US (i.e., a single waterbody) at that location. An exception is for linear projects crossing a single waterbody several times at separate and distant locations; each crossing is considered a single and complete project. However, individual channels in a braided stream or river, or individual arms of a large, irregularly shaped wetland or lake, etc., are not separate waterbodies.

*Stormwater Management:* Stormwater management is the mechanism for controlling stormwater runoff for the purposes of reducing downstream erosion, water quality degradation, and flooding and mitigating the adverse effects of changes in land use on the aquatic environment.

*Stormwater Management Facilities:* Stormwater management facilities are those facilities, including but not limited to, stormwater retention and detention ponds and BMPs, which retain water for a period of time to control runoff and/or improve the quality (i.e., by reducing the concentration of nutrients, sediments, hazardous substances and other pollutants) of stormwater runoff.

*Stream Channelization:* The manipulation of a stream channel to increase the rate of water flow through the stream channel. Manipulation may include deepening, widening, straightening, armoring, or other activities that change the stream cross-section or other aspects of stream channel geometry to increase the rate of water flow through the stream channel. A channelized stream remains a water of the US, despite the modifications to increase the rate of water flow.

*Tidal Wetland:* A tidal wetland is a wetland (i.e., water of the US) that is inundated by tidal waters. The definitions of a wetland and tidal waters can be found at 33 CFR 328.3(b) and 33 CFR 328.3(f), respectively. Tidal waters rise and fall in a predictable and measurable rhythm or cycle due to the gravitational pulls of the moon and sun. Tidal waters end where the rise and fall of the water surface can no longer be practically measured in a predictable rhythm due to masking by other waters, wind, or other effects. Tidal wetlands are located channelward of the high tide line (i.e., spring high tide line) and are inundated by tidal waters two times per lunar month, during spring high tides.

*Vegetated Buffer:* A vegetated upland or wetland area next to rivers, streams, lakes, or other open waters, which separates the open water from developed areas, including agricultural land. Vegetated buffers provide a variety of aquatic habitat functions and values (e.g., aquatic habitat

for fish and other aquatic organisms, moderation of water temperature changes, and detritus for aquatic food webs) and help improve or maintain local water quality. A vegetated buffer can be established by maintaining an existing vegetated area or planting native trees, shrubs, and herbaceous plants on land next to openwaters. Mowed lawns are not considered vegetated buffers because they provide little or no aquatic habitat functions and values. The establishment and maintenance of vegetated buffers is a method of compensatory mitigation that can be used in conjunction with the restoration, creation, enhancement or preservation of aquatic habitats to ensure that activities authorized by NWP result in minimal adverse effects to the aquatic environment. (See General Condition 19.)

*Vegetated Shallows:* Vegetated shallows are special aquatic sites under the 404(b)(1) Guidelines. They are areas that are permanently inundated and under normal circumstances have rooted aquatic vegetation, such as seagrasses in marine and estuarine systems and a variety of vascular rooted plants in freshwater systems.

*Waterbody:* A waterbody is any area that in a normal year has water flowing or standing above ground to the extent that evidence of an ordinary high water mark is established. Wetlands contiguous to the waterbody are considered part of the waterbody.

### **FINAL REGIONAL CONDITIONS FOR NATIONWIDE PERMITS IN THE WILMINGTON DISTRICT**

1. Waters Excluded from NWP or Subject to Additional Notification Requirements:
  - a. The Corps identified waters that will be excluded from use of this NWP. These waters are:
    1. Discharges into Waters of the United States designated by either the North Carolina Division of Marine Fisheries (NCDMF) or the North Carolina Wildlife Resources Commission (NCWRC) as anadromous fish spawning area are prohibited during the period between February 15 and June 30, without prior written approval from NCDMF or NCWRC and the Corps.
    2. Discharges into Waters of the United States designated as sturgeon spawning areas are prohibited during the period between February 1 and June 30, without prior written approval from the National Marine Fisheries Service (NMFS).
  - b. The Corps identified waters that will be subject to additional notification requirements for activities authorized by this NWP. These waters are:
    1. Prior to the use of any NWP in any of the following North Carolina *designated waters*, applicants must comply with Nationwide Permit General Condition 13. In addition, the applicant must furnish a written statement of compliance with all of the conditions of the applicable Nationwide Permit. The North Carolina *designated waters* that require additional notification requirements are “Outstanding Resource Waters” (ORW) and “High Quality

Waters” (HQW) (as defined by the North Carolina Division of Water Quality), or “Inland Primary Nursery Areas” (IPNA) (as defined by the North Carolina Wildlife Resources Commission), or contiguous wetlands (as defined by the North Carolina Division of Water Quality), or “Primary Nursery Areas” (PNA) (as defined by the North Carolina Division of Marine Fisheries).

2. Applicants for any NWP in a designated “Area of Environmental Concern” (AEC) in the twenty (20) coastal counties of Eastern North Carolina covered by the North Carolina Coastal Area Management Act (CAMA), must also obtain the required CAMA permit. Construction activities may not commence until a copy of the approved CAMA permit is furnished to the appropriate Wilmington District Regulatory Field Office (Wilmington Field Office – P.O. Box 1890, Wilmington, NC 28402 or Washington Field Office – P.O. Box 1000, Washington, NC 27889) for authorization to begin work.

3. Prior to the use of any NWP on a Barrier Island of North Carolina, applicants must comply with Nationwide Permit General Condition 13. In addition, the applicant shall furnish a written statement of compliance with all of the conditions listed of the applicable Nationwide Permit.

4. Prior to the use of any NWP in a “Mountain or Piedmont Bog” of North Carolina, applicants shall comply with Nationwide Permit General Condition 13. In addition, the applicant shall furnish a written statement of compliance with all of the conditions listed of the applicable NWP.

Note: The following wetland community types identified in the N.C. Natural Heritage Program document, “Classification of Natural communities of North Carolina (Michael P. Schafale and Alan S. Weakley, 1990), are subject to this regional condition.

Mountain Bogs

Swamp Forest-Bog Complex  
Swamp Forest-Bog Complex (Spruce Subtype)  
Southern Appalachian Bog (Northern Subtype)  
Southern Appalachian Bog (Southern Subtype)  
Southern Appalachian Fen

Piedmont Bogs

Upland Depression Swamp Forest

5. Prior to the use of any NWP in Mountain Trout Waters within twenty-five (25) designated counties of North Carolina, applicants shall comply with Nationwide General Condition 13. In addition, the applicant shall furnish a written statement of compliance with all of the conditions listed of the applicable NWP. Notification will include a letter of comments and recommendations from the North Carolina Wildlife Resources Commission (NCWRC), the

location of work, a delineation of wetlands, a discussion of alternatives to working in the Mountain Trout Waters, why other alternatives were not selected, and a plan to provide compensatory mitigation for all unavoidable adverse impacts to the Mountain Trout Waters. To facilitate coordination with the NCWRC, the proponent may provide a copy of the notification to the NCWRC concurrent with the notification to the District Engineer. The NCWRC will respond both to the proponent and directly to the Corps of Engineers.

The twenty-five (25) designated counties are:

Alleghany	Ashe	Avery	Yancey
Buncombe	Burke	Caldwell	Wilkes
Cherokee	Clay	Graham	Swain
Haywood	Henderson	Jackson	Surry
Macon	Madison	McDowell	Stokes
Mitchell	Polk	Rutherford	
Transylvania	Watauga		

6. Applicants shall notify the NCDENR Shellfish Sanitation Section prior to dredging in or removing sediment from an area closed to shell fishing where the effluent may be released to an area open for shell fishing or swimming in order to avoid contamination of the disposal area and allow a temporary shellfish closure to be made. Any disposal of sand to the beach should occur between November 1 and April 30 when recreational usage is low. Only clean sand should be used and no dredged sand from closed shell fishing areas. If beach disposal was to occur at times other than stated above or if sand from a closed shell fishing area is to be used, a swim advisory shall be posted and a press release shall be made. NCDENR Shellfish Sanitation Section must be notified before commencing this activity.

## 2. List of Final Corps Regional Modifications and Conditions for All Nationwide Permits

a. Individual or multiple NWPs may not be used for activities that result in the cumulative loss or degradation of greater than 300 total linear feet of perennial streambed or intermittent streambed that exhibits important aquatic function(s).

b. Prior to the use of any NWP (except 13, 27, and 39) for any activity that has more than a total of 150 total linear feet of perennial streambed impacts or intermittent streambed impacts (if the intermittent stream has important aquatic function), the applicant must comply with Nationwide Permit General Condition 13. In addition, the applicant shall furnish a written statement of compliance with all of the conditions listed of the applicable NWP. Compensatory mitigation is typically required for any impact that requires such notification. [Note: The Corps uses the Intermittent Channel Evaluation Form, located with Permit Information on the Regulatory Program Web Site, to aid in the determination of the intermittent channel stream status. Also, NWPs 13, 27 and 39 have specific reporting requirements.]

c. For all Nationwide Permits which allow the use of concrete as a building material, measures will be taken to prevent live or fresh concrete, including bags of uncured concrete, from coming into contact with waters of the state until the concrete has hardened.

d. For all Nationwide Permits that allow for the use of riprap material for bank stabilization, filter cloth must be placed underneath the riprap as an additional requirement of its use in North Carolina waters.

e. For all NWP's that involve the construction of culverts, measures will be included in the construction that will promote the safe passage of fish and other aquatic organisms. All culverts in the 20 CAMA coastal counties must be buried to a depth of one foot below the

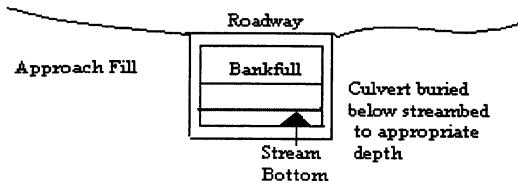

bed of the stream or wetland. For all culvert construction activities, the dimension, pattern, and profile of the stream, (above and below a pipe or culvert), should not be modified by widening the stream channel or by reducing the depth of the stream. Culvert inverts will be buried at least one foot below the bed of the stream for culverts greater than 48 inches in diameter. For culverts 48 inches in diameter or smaller, culverts must be buried below the bed of the stream to a depth equal to or greater than 20 percent of the diameter of the culvert. Bottomless arch culverts will satisfy this condition. A waiver from the depth specifications in this Regional Condition may be requested in writing. The waiver will only be issued if it can be demonstrated that the impacts of complying with this Regional Condition would result in more adverse impacts to the aquatic environment.

**NORTH CAROLINA DIVISION OF WATER QUALITY**  
**GENERAL CERTIFICATION CONDITIONS**  
**GC3361**

1. Proposed fill or substantial modification of wetlands or waters (including streams) under this General Certification requires notification to the Division of Water Quality. Two copies shall be submitted to DWQ at the time of notification in accordance with 15A NCAC 2H .0501(a).

Written concurrence from DWQ is not required unless any standard conditions of this Certification cannot be met;

2. Appropriate sediment and erosion control practices which equal or exceed those outlined in the most recent version of the "North Carolina Sediment and Erosion Control Planning and Design Manual" or the "North Carolina Surface Mining Manual" whichever is more appropriate (available from the Division of Land Resources (DLR) in the DENR Regional or Central Offices) shall be in full compliance with all specifications governing the proper design, installation and operation and maintenance of such Best Management Practices in order to assure compliance with the appropriate turbidity water quality standard;

3. In accordance with 15A NCAC 2H .0506 (h) compensatory mitigation may be required for impacts to 150 linear feet or more of streams and/or one acre or more of wetlands. In addition, buffer mitigation may be required for any project with Buffer Rules in effect at the time of application for buffer impacts resulting from activities classified as "allowable with mitigation" within the "Table of Uses" section of the Buffer Rules or require a variance under the Buffer Rules. A determination of buffer, wetland and stream mitigation requirements shall be made for any Certification for this Nationwide Permit. The most current design and monitoring protocols from DWQ shall be followed and written plans submitted for DWQ approval as required in those protocols. When compensatory mitigation is required for a project, the mitigation plans must be approved by DWQ in writing before the impacts approved by the Certification occur. The mitigation plan must be implemented and/or constructed before any permanent building or structure on site is occupied. In the case of public road projects, the mitigation plan must be implemented before the road is opened to the traveling public;
4. Compensatory stream mitigation shall be required at a 1:1 ratio for all perennial and intermittent stream impacts equal to or exceeding 150 feet and that require application to DWQ in watersheds classified as ORW, HQW, Tr, WS-I and WS-II;
5. All sediment and erosion control measures placed in wetlands or waters shall be removed and the original grade restored within two months after the Division of Land Resources has released the project;
6. Measures shall be taken to prevent live or fresh concrete from coming into contact with waters of the state until the concrete has hardened;
7. In accordance with North Carolina General Statute Section 143-215.3D(e), any request for written concurrence for a 401 Water Quality Certification must include the appropriate fee. If a project also requires a CAMA Permit, one payment to both agencies shall be submitted and will be the higher of the two fees;
8. Impacts to any stream length in the Neuse, Tar-Pamlico, Randleman and Catawba River Basins (or any other river basins with Riparian Area Protection Rules [Buffer Rules] in effect at the time of application) requires written concurrence from DWQ in accordance with 15A NCAC 2B.0200. Activities listed as "exempt" from these rules do not need to apply for written concurrence under this Certification. New development activities located in the protected 50-foot wide riparian areas (whether jurisdictional wetlands or not) within the Neuse, Tar-Pamlico, Randleman and Catawba River Basins shall be limited to "uses" identified within and constructed in accordance with 15A NCAC 2B .0200. All new development shall be located, designed, constructed, and maintained to have minimal disturbance to protect water quality to the maximum extent practicable through the use of best management practices;
9. Additional site-specific conditions may be added to projects for which written concurrence is required or requested under this Certification in order to ensure compliance with all applicable water quality and effluent standards;



10. Concurrence from DWQ that this Certification applies to an individual project shall expire three years from the date of the cover letter from DWQ or on the same day as the expiration date of the corresponding Nationwide and Regional General Permits, whichever is sooner;

11. When written concurrence is required, the applicant is required to use the most recent version of the Certification of Completion form to notify DWQ when all work included in the 401 Certification has been completed.

**NORTH CAROLINA DIVISION OF COASTAL MANAGEMENT**  
**STATE CONSISTENCY**

Consistent.

Citations:

2002 Nationwide Permits - Federal Register Notice 15 Jan 2002

2002 Nationwide Permits Corrections - Federal Register Notice 13 Feb 2002

2002 Regional Conditions – Authorized 17 May 2002

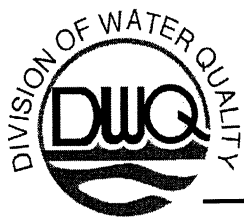

Manley

February 17, 2006  
Wayne County  
DWQ No. 060104  
TP No. 6-419

**APPROVAL of NEUSE RIVER BUFFER RULES AUTHORIZATION CERTIFICATE with ADDITIONAL CONDITIONS**

Dr. Gregory J. Thorpe, PhD., Manager  
Planning and Environmental Branch  
North Carolina Department of Transportation  
1548 Mail Service Center  
Raleigh, North Carolina, 27699-1548

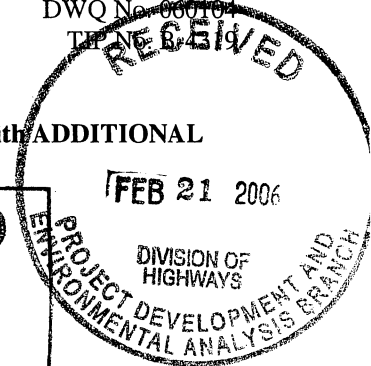
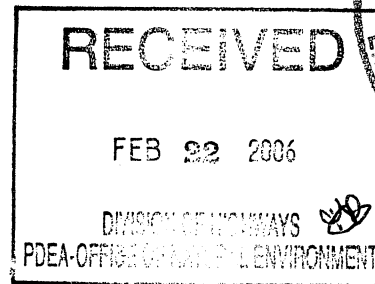

Dear Dr. Thorpe,

You have our approval, in accordance with the conditions listed below, for the following impacts for the purpose of replacement of Bridge No. 21 over Great Swamp on NC 222 in Wayne County:

**Wetland Impact Table**

Site	Wetland Impacts – Fill	Wetland Impacts – Excavation
	(ac)	(ac)
Site 1	0.034	0.025
<b>Total</b>	<b>0.034</b>	<b>0.025</b>
<b>Total Wetlands Impacted</b>	<b>0.059</b>	

**Neuse River Buffer Impact Table**

Site	Allowable	
	Zone 1 (sq. ft.)	Zone 2 (sq. ft.)
Site 1	3,954	2,219
<b>Totals</b>	<b>6,173</b>	

The project shall be constructed in accordance with your application dated received on January 20, 2006. After reviewing your application, we have decided that the stream impacts and riparian buffer impacts described are covered by General Water Quality Certification Numbers 3403. This certification corresponds to the Nationwide Permit 23 issued by the Corps of Engineers. This approval is also valid for the Neuse Buffer Rules (15A NCAC 2B .0233). In addition, you should acquire any other federal, state or local permits before you proceed with your project including (but not limited to) Sediment and Erosion Control, Non-Discharge and Water Supply Watershed regulations. This approval will expire with the accompanying 404 permit.

This approval is valid solely for the purpose and design described in your application (unless modified below). Should your project change, you must notify the DWQ and submit a new application. If the property is sold, the new owner must be given a copy of this Certification and approval letter, and is thereby responsible for complying with all the conditions. If total wetland fills for this project (now or in the future) exceed one acre, or of total impacts to streams (now or in the future) exceed 150 linear feet, compensatory mitigation may be required as described in 15A NCAC 2H .0506 (h) (6) and (7). For this approval to remain valid, you must adhere to the conditions listed in the attached certification.

- 1.) Upon completion of the project, the NCDOT shall complete and return the enclosed "Certification of Completion Form" to notify DWQ when all work included in the 401 Certification has been completed. The responsible party shall complete the attached form and return it to the 401/Wetlands Unit of the Division of Water Quality upon completion of the project.
- 2.) No in-water work is permitted between February 15 and June 15 of any year, without prior approval from the NC Division of Water Quality and the NC Wildlife Resources Commission. In addition, NCDOT shall conform with the most recent version of the officially adopted document entitled "Stream Crossing Guidelines for Anadromous Fish Passage at all times.
- 3.) All stormwater runoff shall be directed to sheetflow through stream buffers at nonerosive velocities, unless approved otherwise by this certification.
- 4.) During the construction of the project, no staging of equipment of any kind is permitted in waters of the U.S., or riparian buffers.
- 5.) Riparian vegetation must be reestablished within the construction limits of the project by the end of the growing season following completion of construction.
- X 6.) Compensatory mitigation for impacts to 0.059 acres of jurisdictional riverine wetlands shall be done. Total mitigation shall be provided as described below:

*Offsite Compensatory Mitigation*

Compensatory mitigation for the unavoidable impacts to 0.059 acres of riverine wetlands in the Neuse River Basin in the Hydrologic Cataloging Unit 03020203, associated with the proposed project shall be provided by the Ecosystem Enhancement Program (EEP), as outlined in the letter dated December 13, 2005, and in accordance with the Memorandum of Agreement (MOA) between the State of North Carolina and the US Army Corps of Engineers signed on July 22, 2003 and with Section X of the Tri-Party MOA.

- 7.) The dimension, pattern and profile of the stream above and below the crossing should not be modified by widening the stream channel or reducing the depth of the stream. Disturbed floodplains and streams should be restored to natural geomorphic conditions.
- 8.) Any riprap used must not interfere with thalweg performance and aquatic life passage during low flow conditions.
- 9.) All mechanized equipment operated near surface waters must be regularly inspected and maintained to prevent contamination of stream waters from fuels, lubricants, hydraulic fluids, or other toxic materials.
- 10.) Discharging hydroseed mixtures and washing out hydroseeders and other equipment in or adjacent to surface waters is prohibited.
- 11.) The outside buffer, wetland or water boundary located within the construction corridor approved by this authorization shall be clearly marked by highly visible fencing prior to any land disturbing activities. Impacts to areas within the fencing are prohibited unless otherwise authorized by this certification.
- 12.) There shall be no excavation from or waste disposal into jurisdictional wetlands or waters associated with this permit without appropriate modification of this permit. Should waste or borrow sites be located in wetlands or stream, compensatory mitigation will be required since it is a direct impact from road construction activities.
- 13.) Heavy equipment must be operated from the banks rather than in the stream channel in order to minimize sedimentation and reduce the likelihood of introducing other pollutants into the stream.

- 14.) No live or fresh concrete shall come into contact with waters of the state until the concrete has hardened
- 15.) The presence of equipment in the channels must be minimized. Under no circumstances must rock, sand or other materials be dredged from the wetted stream channel under authorization of this permit, except in the immediate vicinity of the culverts.
- 16.) All work shall be performed during low or normal flow conditions.
- 17.) A copy of this Water Quality Certification shall be posted on the construction site at all times. In addition, the Water Quality Certification and all subsequent modifications, if any, shall be maintained with the Division Engineer and the on-site project manager.
- 18.) All riparian buffers impacted by the placement of temporary fill or clearing activities shall be restored to the preconstruction contours and revegetated with native woody species upon completion of the project construction. A post-construction as-built with the restoration activities included shall be submitted to the DWQ no later than 60 days after the project is closed out by the Department of Transportation.
- 19.) Pursuant to NCAC15A 2B.0233(6) sediment and erosion control devices shall not be placed in Zone 1 of any Neuse Buffer without prior approval by the NCDWQ. At this time, the NCDWQ has approved no sediment and erosion control devices in Zone 1, outside of the approved project impacts, anywhere on this project. Moreover, sediment and erosion control devices shall be allowed in Zone 2 of the buffers provided that Zone 1 is not compromised and that discharge is released as diffuse flow.
- 20.) Erosion and sediment control practices must be in full compliance with all specifications governing the proper design, installation and operation and maintenance of such Best Management Practices in order to protect surface waters standards:
  - a. The erosion and sediment control measures for the project must be designed, installed, operated, and maintained in accordance with the most recent version of the *North Carolina Sediment and Erosion Control Planning and Design Manual*.
  - b. The design, installation, operation, and maintenance of the sediment and erosion control measures must be such that they equal, or exceed, the requirements specified in the most recent version of the *North Carolina Sediment and Erosion Control Manual*. The devices shall be maintained on all construction sites, borrow sites, and waste pile (spoil) projects, including contractor-owned or leased borrow pits associated with the project.
  - c. For borrow pit sites, the erosion and sediment control measures must be designed, installed, operated, and maintained in accordance with the most recent version of the *North Carolina Surface Mining Manual*.
  - d. The reclamation measures and implementation must comply with the reclamation in accordance with the requirements of the Sedimentation Pollution Control Act.
- 21.) The post-construction removal of any temporary bridge structures will need to return the project site to its preconstruction contours and elevations. The revegetation of the impacted areas with appropriate native species is required.
- 22.) If the old bridge is removed, no discharge of bridge material into surface waters is preferred. Strict adherence the Corps of Engineers guidelines for bridge demolition will be a condition of the 401 Water Quality Certification.
- 23.) This approval will expire with the accompanying 404 federal permit. This condition supercedes condition No. 10 in the General Certification 3403.

If you do not accept any of the conditions of this certification, you may ask for an adjudicatory hearing. You must act within 60 days of the date that you receive this letter. To ask for a hearing, send a written petition that conforms to Chapter 150B of the North Carolina General Statutes to the Office of Administrative Hearings, 6714 Mail Service Center, Raleigh, N.C. 27699-6714. This certification and its conditions are final and binding unless you ask for a hearing.

This letter completes the review of the Division of Water Quality under Section 401 of the Clean Water Act. If you have any questions, please contact Nicole Thomson at (919) 715-3415.

Sincerely,

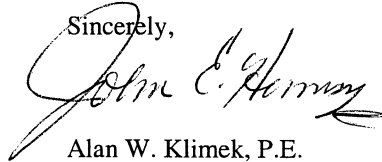
A handwritten signature in black ink, appearing to read "Alan W. Klimek". The signature is fluid and cursive, with a long horizontal stroke at the end.

Alan W. Klimek, P.E.

JH/njt

Attachment

cc: Wilmington District US Army Corps of Engineers  
Mr. William Wescott, US Army Corps of Engineers, Washington Field Office  
Mr. Tyler Stanton, PDEA-NEU  
Mr. Richard E. Greene, Jr., Division 4 Engineer, PO Box 3165, Wilson, NC 27895  
Division 4 Environmental Officer, PO Box 3165, Wilson, NC 27895  
Mr. Garcy Ward, NC DWQ Washington Regional Office  
File Copy

## WQC #3403

**GENERAL CERTIFICATION FOR PROJECTS ELIGIBLE FOR CORPS OF ENGINEERS NATIONWIDE PERMIT NUMBER 23 (APPROVED CATEGORICAL EXCLUSIONS) AND RIPARIAN AREA PROTECTION RULES (BUFFER RULES)**

This General Certification is issued in conformity with the requirements of Section 401, Public Laws 92-500 and 95-217 of the United States and subject to the North Carolina Division of Water Quality Regulations in 15A NCAC 2H, Section .0500 and 15A NCAC 2B .0200 for the discharge of fill material to waters and wetland areas as described in 33 CFR 330 Appendix A (B) (23) and for the Riparian Area Protection Rules (Buffer Rules) in 15A NCAC 2B .0200. This Certification replaces Water Quality Certification Number 2670 issued on January 21, 1992, Certification Number 2734 issued on May 1 1993, Certification Number 3107 issued on February 11, 1997 and Water Quality Certification Number 3361 issued March 18, 2002. This WQC is rescinded when the Corps of Engineers re-authorizes Nationwide Permit 23 or when deemed appropriate by the Director of the DWQ.

The State of North Carolina certifies that the specified category of activity will not violate applicable portions of Sections 301, 302, 303, 306 and 307 of the Public Laws 92-500 and 95-217 if conducted in accordance with the conditions hereinafter set forth.

**Conditions of Certification:**

1. Proposed fill or substantial modification of wetlands or waters (including streams) under this General Certification requires notification to the Division of Water Quality. Two copies shall be submitted to DWQ at the time of notification in accordance with 15A NCAC 2H .0501(a). Written concurrence from DWQ is not required unless any standard conditions of this Certification cannot be met;
2. Appropriate sediment and erosion control practices which equal or exceed those outlined in the most recent version of the "North Carolina Sediment and Erosion Control Planning and Design Manual" or the "North Carolina Surface Mining Manual" whichever is more appropriate (available from the Division of Land Resources (DLR) in the DENR Regional or Central Offices) shall be in full compliance with all specifications governing the proper design, installation and operation and maintenance of such Best Management Practices in order to assure compliance with the appropriate turbidity water quality standard;
3. In accordance with 15A NCAC 2H .0506 (h) compensatory mitigation may be required for impacts to 150 linear feet or more of streams and/or one acre or more of wetlands. In addition, buffer mitigation may be required for any project with Buffer Rules in effect at the time of application for buffer impacts resulting from activities classified as "allowable with mitigation" within the "Table of Uses" section of the Buffer Rules or require a variance under the Buffer Rules. A determination of buffer, wetland and stream mitigation requirements shall be made for any Certification for this Nationwide Permit. The most current design and monitoring protocols from DWQ shall be followed and written plans submitted for DWQ approval as required in those protocols. When compensatory mitigation is required for a project, the mitigation plans must be approved by DWQ in writing before the impacts approved by the Certification occur. The mitigation plan must be implemented and/or constructed before any permanent building or structure on

138  
WQC #3403

site is occupied. In the case of public road projects, the mitigation plan must be implemented before the road is opened to the travelling public;

4. Compensatory stream mitigation shall be required at a 1:1 ratio for not only perennial but also intermittent stream impacts equal to or exceeding 150 feet and that require application to DWQ in watersheds classified as ORW, HQW, Tr, WS-I and WS-II unless the project is a linear, publicly-funded transportation project, which has a 150-foot per-stream impact allowance;
5. All sediment and erosion control measures placed in wetlands or waters shall be removed and the original grade restored within two months after the Division of Land Resources has released the project;
6. Measures shall be taken to prevent live or fresh concrete from coming into contact with freshwaters of the state until the concrete has hardened;
7. In accordance with North Carolina General Statute Section 143-215.3D(e), any request for written concurrence for a 401 Water Quality Certification must include the appropriate fee. If a project also requires a CAMA Permit, one payment to both agencies shall be submitted and will be the higher of the two fees;
8. Impacts to any stream length in the Neuse, Tar-Pamlico, Randleman and Catawba River Basins (or any other river basins with Riparian Area Protection Rules [Buffer Rules] in effect at the time of application) requires written concurrence from DWQ in accordance with 15A NCAC 2B.0200. Activities listed as "exempt" from these rules do not need to apply for written concurrence under this Certification. New development activities located in the protected 50-foot wide riparian areas (whether jurisdictional wetlands or not) within the Neuse, Tar-Pamlico, Randleman and Catawba River Basins shall be limited to "uses" identified within and constructed in accordance with 15A NCAC 2B .0200. All new development shall be located, designed, constructed, and maintained to have minimal disturbance to protect water quality to the maximum extent practicable through the use of best management practices;
9. Additional site-specific conditions may be added to projects for which written concurrence is required or requested under this Certification in order to ensure compliance with all applicable water quality and effluent standards;
10. Concurrence from DWQ that this Certification applies to an individual project shall expire three years from the date of the cover letter from DWQ or on the same day as the expiration date of the corresponding Nationwide and Regional General Permits, whichever is sooner;
11. When written concurrence is required, the applicant is required to use the most recent version of the Certification of Completion form to notify DWQ when all work included in the 401 Certification has been completed.

Non-compliance with or violation of the conditions herein set forth by a specific fill project shall result in revocation of this Certification for the project and may result in criminal and/or civil penalties.

WQC #3403

139

The Director of the North Carolina Division of Water Quality may require submission of a formal application for individual certification for any project in this category of activity that requires written concurrence under this certification, if it is determined that the project is likely to have a significant adverse effect upon water quality or degrade the waters so that existing uses of the wetland, stream or downstream waters are precluded.

Public hearings may be held for specific applications or group of applications prior to a Certification decision if deemed in the public's best interest by the Director of the North Carolina Division of Water Quality.

Effective date: 28 March 2003

DIVISION OF WATER QUALITY

By

A handwritten signature in cursive script that reads "Alan Klimek".

Alan W. Klimek, P.E.

Director

WQC # 3403



140  
**Certification of Completion**

DWQ Project No.: \_\_\_\_\_ County: \_\_\_\_\_

Applicant: \_\_\_\_\_

Project Name: \_\_\_\_\_

Date of Issuance of Wetland Permit: \_\_\_\_\_

✱ **Certificate of Completion**

Upon completion of all work approved within the **401 Water Quality Certification and Buffer Rules**, and any subsequent modifications, the applicant is required to return this certificate to the 401/Wetlands Unit, North Carolina Division of Water Quality, 1650 Mail Service Center, Raleigh, NC, 27699-1650. This form may be returned to DWQ by the applicant, the applicant's authorized agent, or the project engineer. It is not necessary to send certificates from all of these.

***Applicant's Certification***

I, \_\_\_\_\_, hereby state that, to the best of my abilities, due care and diligence was used in the observation of the construction such that the construction was observed to be built within substantial compliance and intent of the **401 Water Quality Certification and Buffer Rules**, the approved plans and specifications, and other supporting materials.

Signature: \_\_\_\_\_ Date: \_\_\_\_\_

***Agent's Certification***

I, \_\_\_\_\_, hereby state that, to the best of my abilities, due care and diligence was used in the observation of the construction such that the construction was observed to be built within substantial compliance and intent of the **401 Water Quality Certification and Buffer Rules**, the approved plans and specifications, and other supporting materials.

Signature: \_\_\_\_\_ Date: \_\_\_\_\_

***If this project was designed by a Certified Professional***

I, \_\_\_\_\_, as a duly registered Professional \_\_\_\_\_ (i.e., Engineer, Landscape Architect, Surveyor, etc.) in the State of North Carolina, having been authorized to observe (periodically, weekly, full time) the construction of the project, for the Permittee hereby state that, to the best of my abilities, due care and diligence was used in the observation of the construction such that the construction was observed to be built within substantial compliance and intent of the **401 Water Quality Certification and Buffer Rules**, the approved plans and specifications, and other supporting materials.

Signature: \_\_\_\_\_ Registration No. \_\_\_\_\_ Date \_\_\_\_\_

141

# NORTH CAROLINA

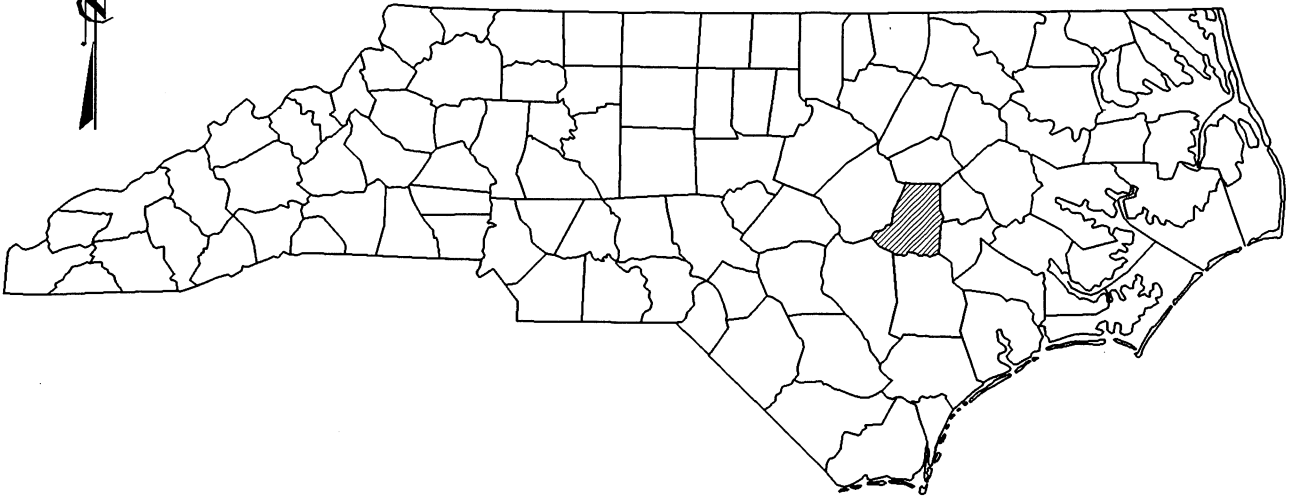

## PROJECT

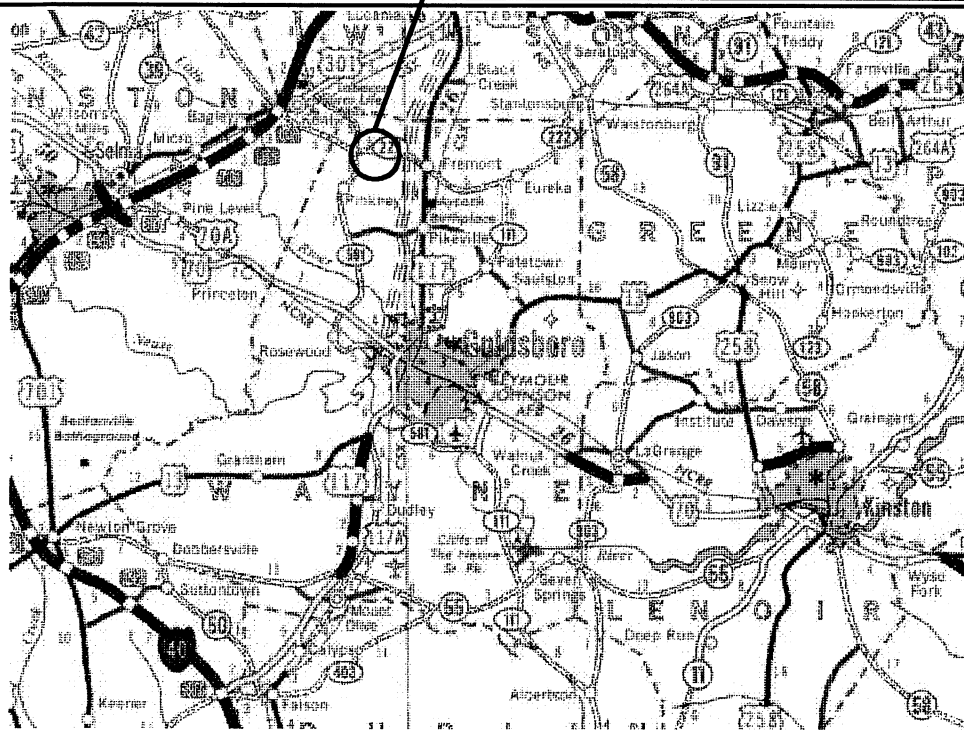

## VICINITY MAPS

**NCDOT**  
**DIVISION OF HIGHWAYS**  
**WAYNE COUNTY**  
**PROJECT: 33656.1.1 (B-4319)**  
**REPLACE BRIDGE NO. 21**  
**OVER GREAT SWAMP**  
**ALONG NC 222**

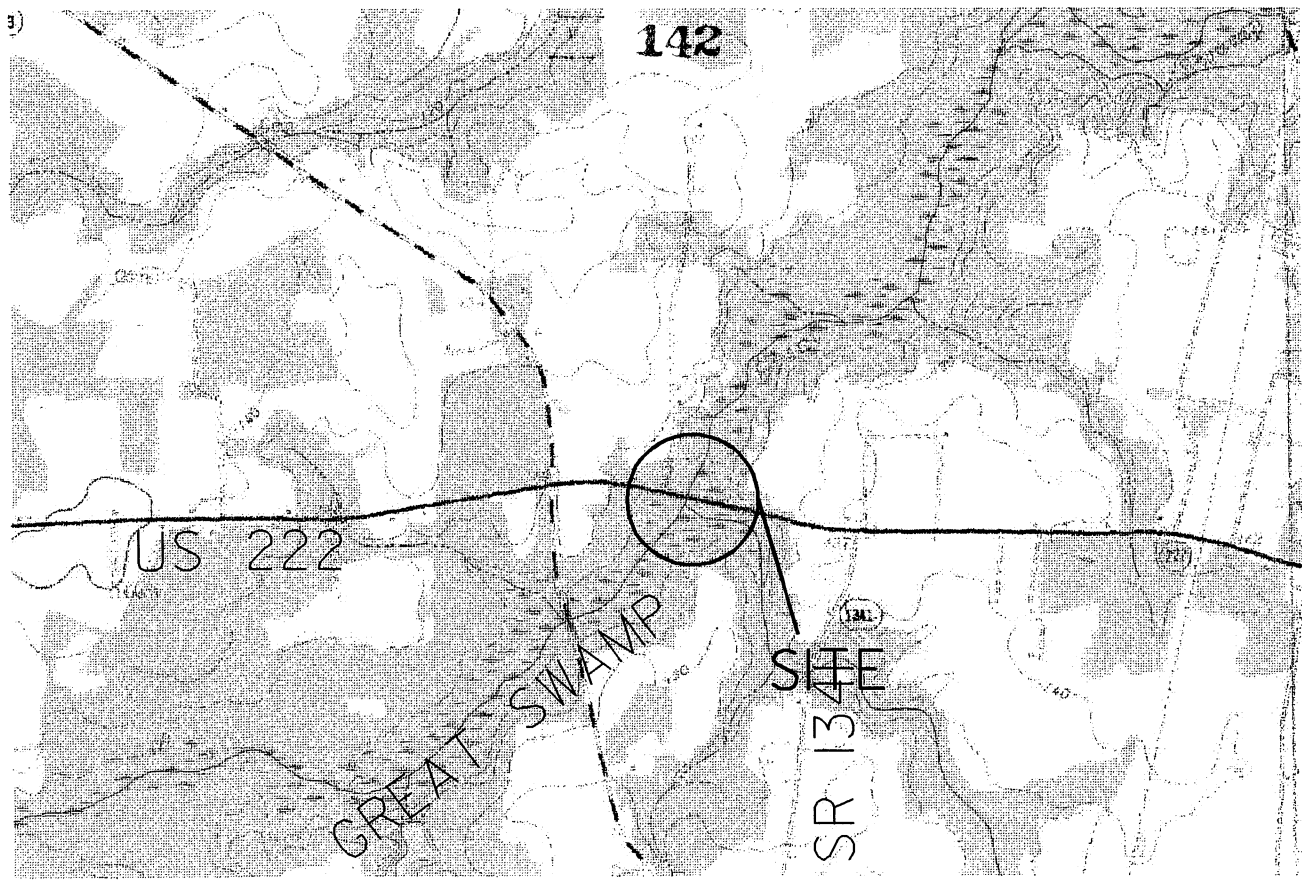

TOPOGRAPHIC  
MAPS

NCDOT

DIVISION OF HIGHWAYS

WAYNE COUNTY

PROJECT: 33656.1.1 (B-4319)

REPLACE BRIDGE NO. 21

OVER GREAT SWAMP

ALONG NC 222

SHEET 2 OF 10 04/05/05  
REV. 11/02/05



# Property Owner Contact Report

TIP # B-4319

Owner Last Name/ Business	Owner First Name	Address	City/Town	State	Zip Code	Contact/ Relationship	Home Phone	Contacted By	Contact Date	How Contacted	Comments
1	Byers James R.	129 Miller Road	Fremont	NC	27830	James R. Hooks Self		Stephen R. Wolfe	3/17/04	Letter	
2	Hollowell Wilbert Oscar	1681 NC 222 Hwy West	Fremont	NC	27830	Wilbert Oscar Hollowell Self		Stephen R. Wolfe	3/17/04	Letter	
4	Hooks James Edwin	211 Emerson Drive	Mebane	NC	27302	James Edwin Hooks Self		Stephen R. Wolfe	3/17/04	Letter	
	Hooks Kenneth Wayne	P.O. Box 155	Fremont	NC	27830	Kenneth Wayne Hooks Self		Stephen R. Wolfe	3/17/04	Letter	
3	Lukens Cynthia Fisher	168 Miller Road	Fremont	NC	27830	Cynthia F. Lukens Self		Stephen R. Wolfe	3/17/04	Letter	

143

WETLAND PERMIT IMPACT SUMMARY

Site No.	Station (From/To)	Structure Size / Type	WETLAND IMPACTS						SURFACE WATER IMPACTS						
			Fill In Wetlands (ac)	Temp. Fill In Wetlands (ac)	Excavation In Wetlands (ac)	Mechanized Clearing (Method III) (ac)	Fill In SW (Natural) (ac)	Fill In SW (Pond) (ac)	Temp. Fill In SW (ac)	Existing Channel Impacted (ft)	Natural Stream Design (ft)				
1	12+68 to 12+85 -L- RT	N/A	0.001	0	0	0	0	0	0	0	0	0	0	0	0
	13+67 TO 14+22 -L- RT	15" CMP	0.004	0	0.006	0	0	0	0	0	0	0	0	0	0
	14+48 TO 14+69 -L- LT	15" CMP	0	0	0.009	0	0	0	0	0	0	0	0	0	0
	15+83 TO 16+00 -L- RT	BRIDGE	0.003	0	0	0	0	0	0	0	0	0	0	0	0
	16+61 TO 19+90 -L- RT	BRIDGE	0.014	0	0	0	0	0	0	0	0	0	0	0	0
	17+20 TO 17+70 -L- LT	N/A	0.003	0	0	0	0	0	0	0	0	0	0	0	0
	18+00 TO 18+20 -L- LT	15" CMP	0	0	0.010	0	0	0	0	0	0	0	0	0	0
	18+70 TO 19+36 -L- LT	N/A	0.009	0	0	0	0	0	0	0	0	0	0	0	0
TOTALS:			0.034	0	0.025	0	0	0	0	0	0	0	0	0	0

NC DEPARTMENT OF TRANSPORTATION  
 DIVISION OF HIGHWAYS  
 WAYNE COUNTY  
 PROJECT: 33656.1.1 (B-4319)  
 SHEET 4 OF 10  
 REV. 11/02/05  
 4/10/2005

PROJECT REFERENCE NO. B-4319  
 SHEET NO. 5 OF 7  
 ROADWAY DESIGN ENGINEER  
 PRELIMINARY PLANS  
 DO NOT USE FOR CONSTRUCTION

BRIDGE APPROACH SLAB  
 FOR "L" PROFILE SEE SHEET 5  
 UNCLASSIFIED STRUCTURE  
 EXCAVATION  
 SEE SHEETS THRU S-7  
 FOR STRUCTURE PLANS

DENOTES FILL IN WETLAND  
 DENOTES EXCAVATION IN WETLAND  
 WETLAND PERMIT DRAWINGS 11/02/05  
 METHOD II CLEARING  
 TOP DOWN CONSTRUCTION

STA. 12+30 -L- BEGIN TIP PROJECT B-4319  
 STA. 20+30 -L- END TIP PROJECT B-4319

-L-  
 PI STA. 11+74.08  
 Δ = 1.05' 06.5" (FT)  
 D = 0.18' 42.2"  
 L = 74.08'  
 R = 18.3800'  
 SE = SEE PLANS

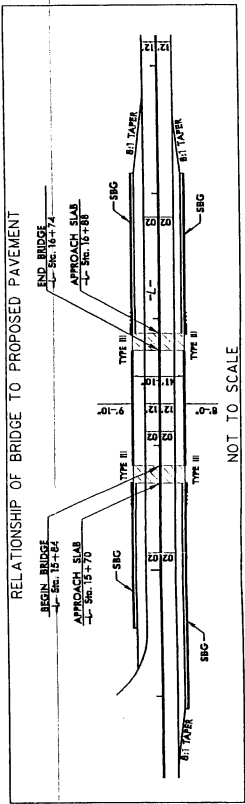
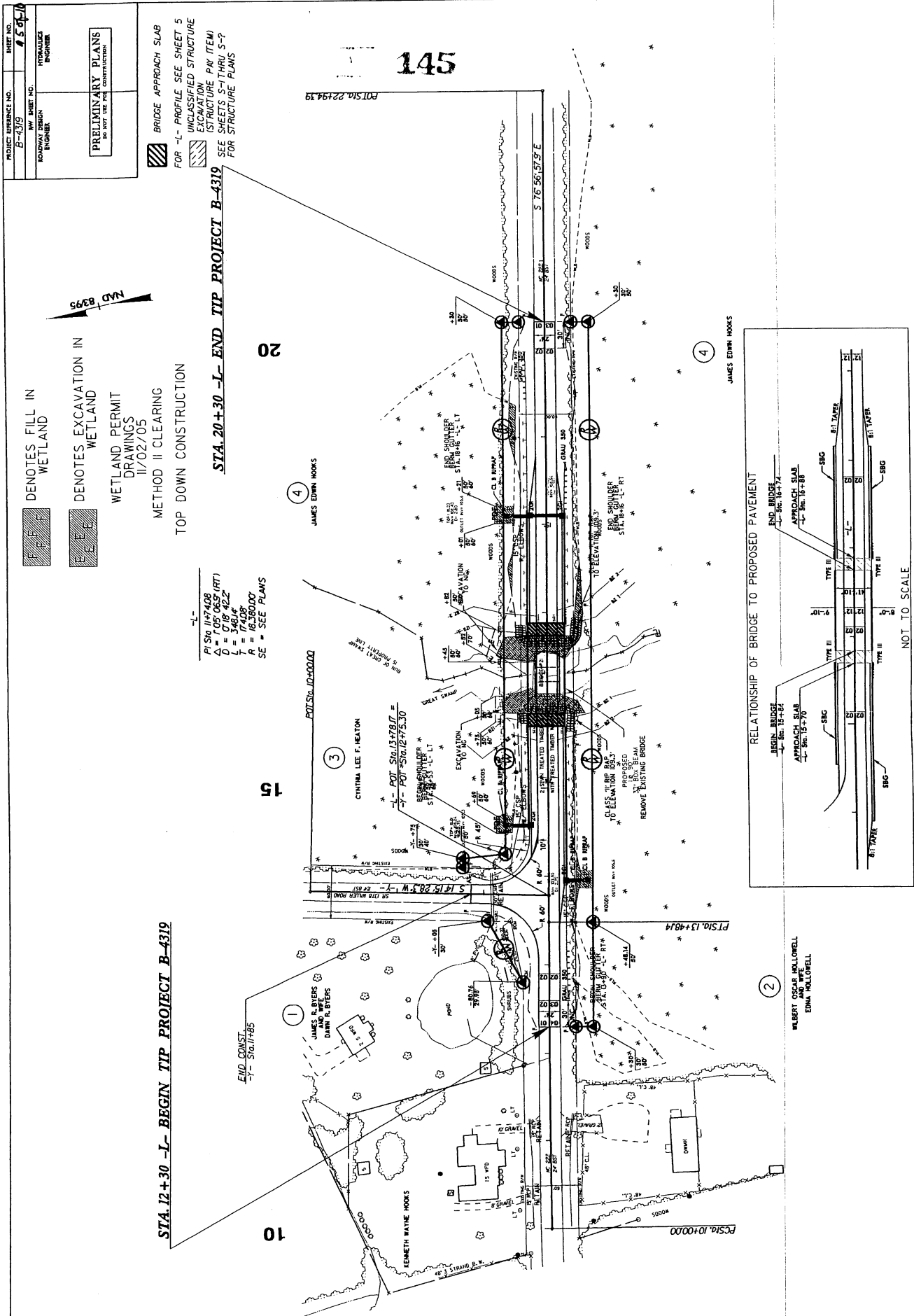

WLBRT  
 GUYAN MCELLOWELL  
 EDNA MCELLOWELL

NOT TO SCALE

REVISIONS

B/17/99

02-110V-2005 08/8  
 R:\Inch\proj\B-4319\110205.dwg  
 Checked: B/12/23/05

PROJECT REFERENCE NO. B-4319  
 SHEET NO. 16 OF 10  
 PREPARED BY: [Redacted]  
 CHECKED BY: [Redacted]  
 DATE: [Redacted]

**PRELIMINARY PLANS**  
 FOR THE PROPOSED BRIDGE

BRIDGE APPROACH SLAB  
 FOR -L- PROFILE SEE SHEET 5  
 UNCLASSIFIED STRUCTURE  
 EXCAVATION (STRUCTURE PAY ITEM)  
 SEE SHEETS S-1 THRU S-9  
 FOR STRUCTURE PLANS

DENOTES FILL IN WETLAND  
 DENOTES EXCAVATION IN WETLAND  
 WETLAND PERMIT DRAWINGS 11/02/05  
 METHOD II CLEARING  
 TOP DOWN CONSTRUCTION

STA. 12+30 -L- BEGIN TIP PROJECT B-4319  
 STA. 20+30 -L- END TIP PROJECT B-4319

END CONVT  
 -L- STA. 11+85

PI STA. 11+74.08  
 Δ = 1° 05' 06.9" (RT)  
 D = 0' 18" 42.2"  
 L = 348.14'  
 P = 174.93'  
 R = 174.93'  
 SE - SEE PLANS



NOT TO SCALE

WELBET OSCAR MALLOWELL  
 EDNA MALLOWELL

REVISIONS

02-REV-2005 0819  
 R:\Hyd-sites\BHM1\4319\w-c.plt 11/02/05.dgn  
 Project: B-4319

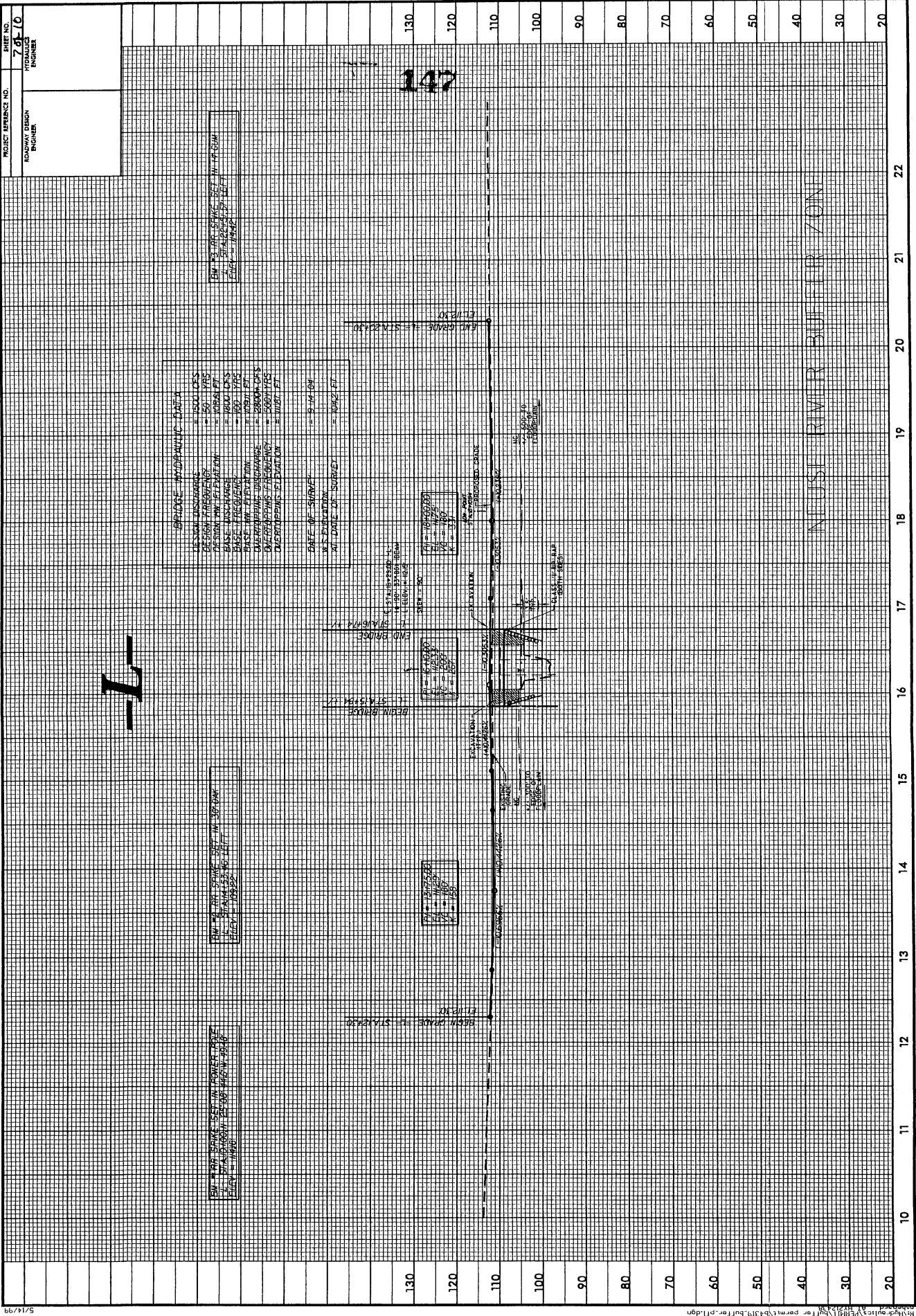

PROJECT REFERENCE NO. \_\_\_\_\_  
 DESIGN NUMBER \_\_\_\_\_  
 SHEET NO. **7 OF 10**  
 PROJECT NAME \_\_\_\_\_

**BRIDGE MODULUS DATA**

DESIGN SPEED = 50.00 FPS  
 DESIGN FREQ = 50 FPS  
 DESIGN PERIOD = 10.0000  
 DESIGN WIND VELOCITY = 100.00 FPS  
 DESIGN WIND DIRECTION = 0.0000  
 DESIGN WIND PERCENTILE = 100.00  
 DESIGN WIND PERCENTILE PERIOD = 10.0000  
 DESIGN WIND PERCENTILE PERIOD PERCENTILE = 100.00  
 DESIGN WIND PERCENTILE PERIOD PERCENTILE PERCENTILE = 100.00  
 DESIGN WIND PERCENTILE PERIOD PERCENTILE PERCENTILE PERCENTILE = 100.00

**DATE OF SURVEY** = 9-14-04  
 SURVEYOR = \_\_\_\_\_  
 CHECKED BY = \_\_\_\_\_

BRIDGE DATA  
 BRIDGE TYPE = \_\_\_\_\_  
 BRIDGE LENGTH = \_\_\_\_\_  
 BRIDGE WIDTH = \_\_\_\_\_  
 BRIDGE HEIGHT = \_\_\_\_\_  
 BRIDGE AREA = \_\_\_\_\_  
 BRIDGE PERIMETER = \_\_\_\_\_  
 BRIDGE VOLUME = \_\_\_\_\_

BRIDGE DATA  
 BRIDGE TYPE = \_\_\_\_\_  
 BRIDGE LENGTH = \_\_\_\_\_  
 BRIDGE WIDTH = \_\_\_\_\_  
 BRIDGE HEIGHT = \_\_\_\_\_  
 BRIDGE AREA = \_\_\_\_\_  
 BRIDGE PERIMETER = \_\_\_\_\_  
 BRIDGE VOLUME = \_\_\_\_\_

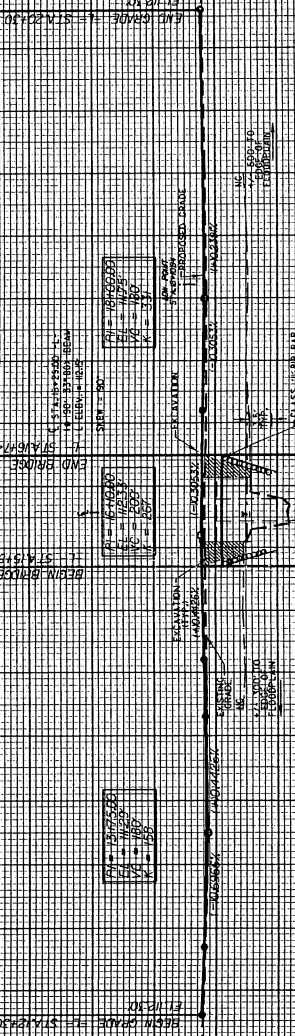

147





0 10 20 30 40 50 60 70 80 90 100 110 120 130 140 150

120 140 160 180 200 220 240 260 280 300 320 340 360 380 400 420 440 460 480 500 520 540 560 580 600 620 640 660 680 700 720 740 760 780 800 820 840 860 880 900 920 940 960 980 1000

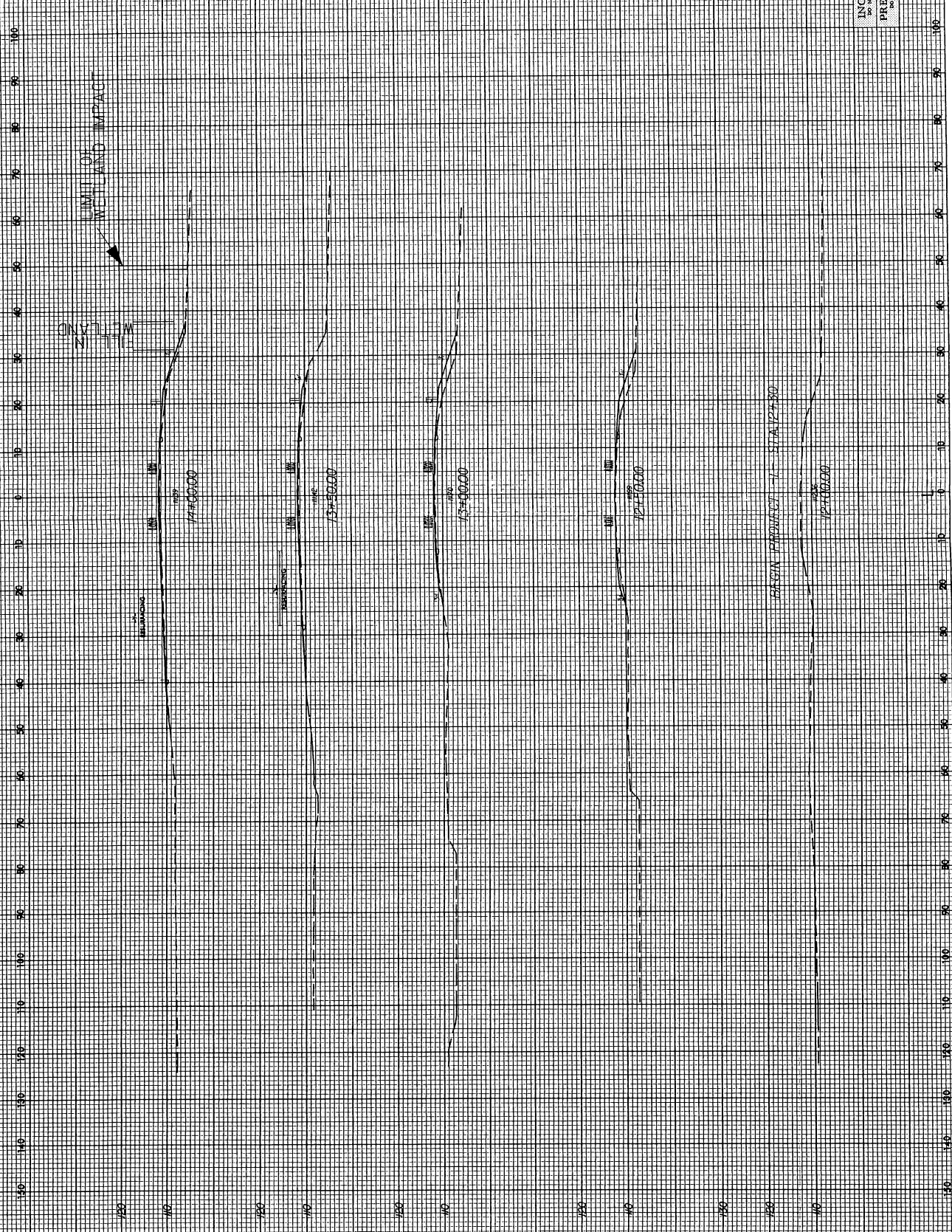

INCOMPLETE PLANS  
 PRELIMINARY PLANS  
 FOR THE PROJECT AT THE LOCATION

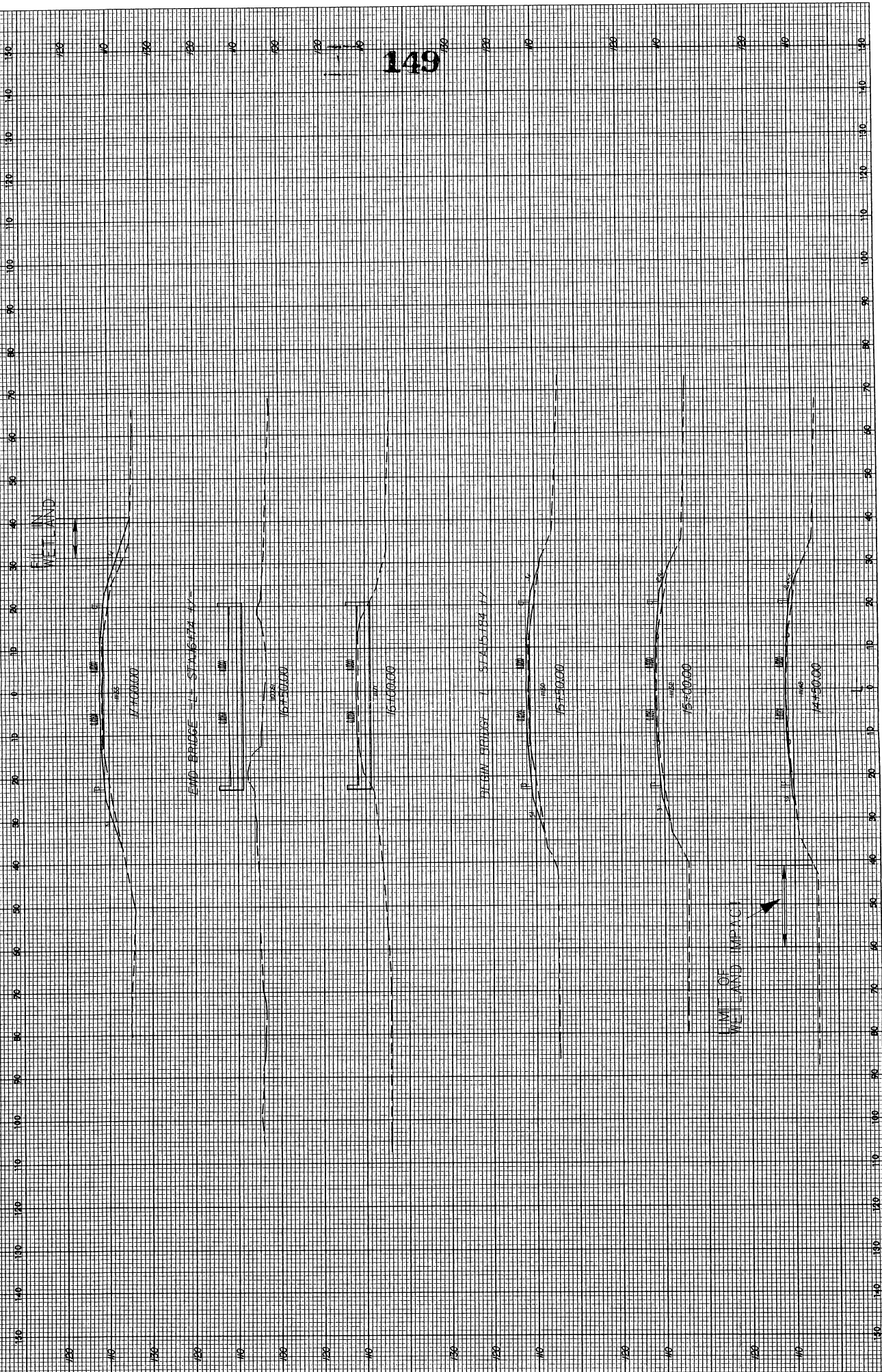

149

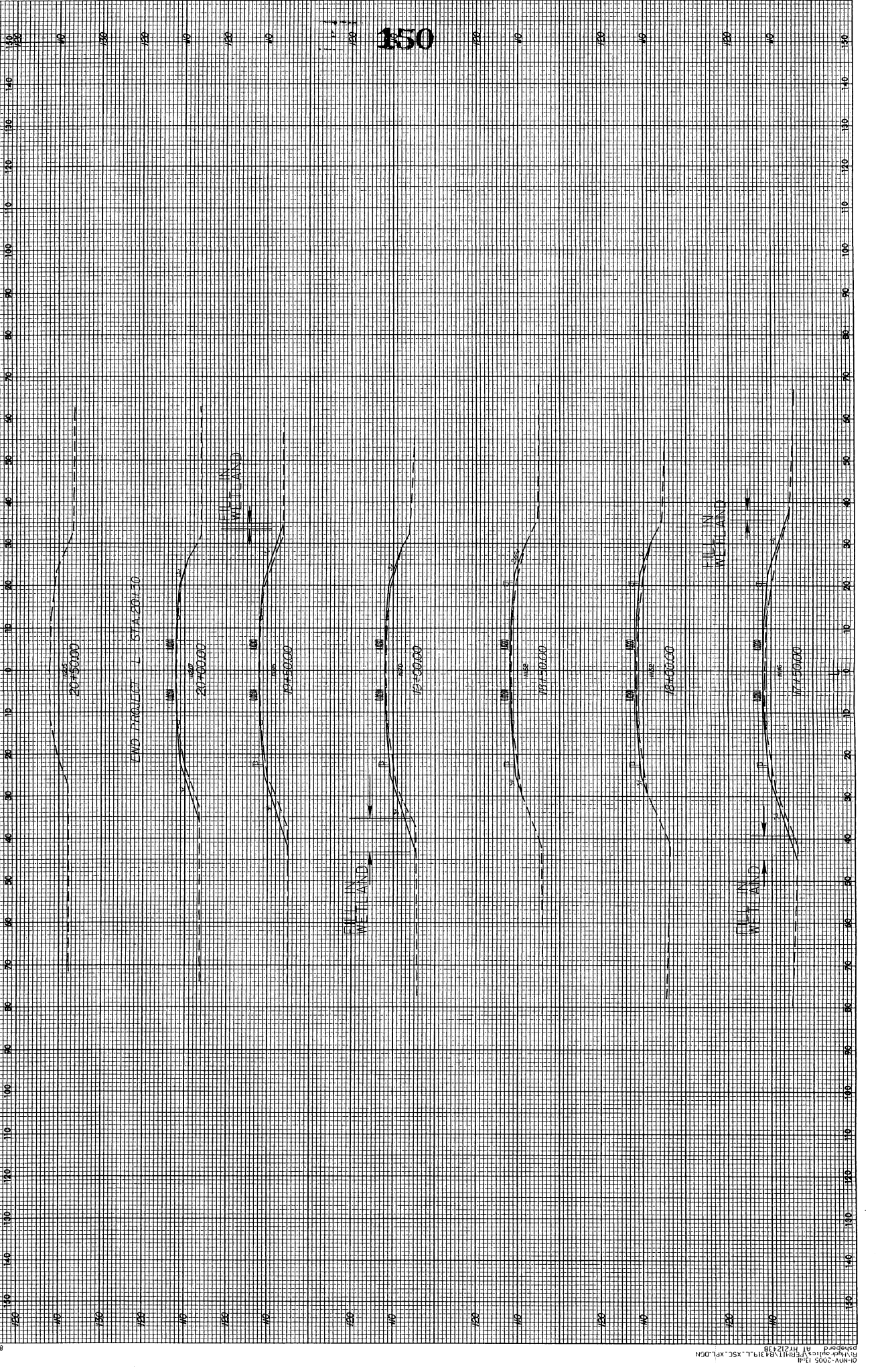

151

# NORTH CAROLINA

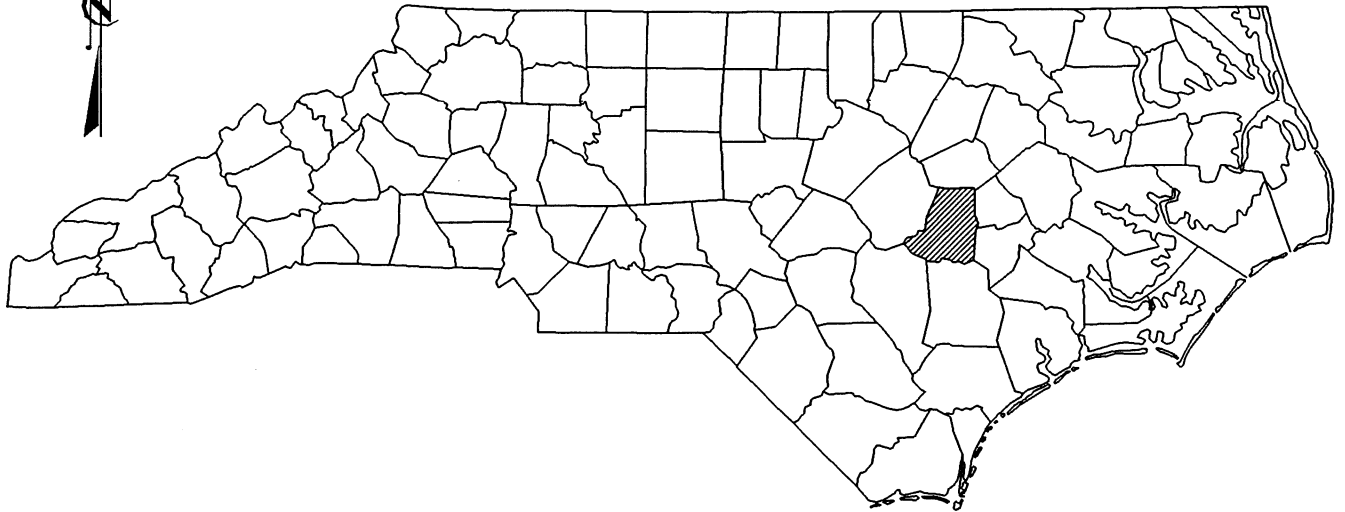

## PROJECT

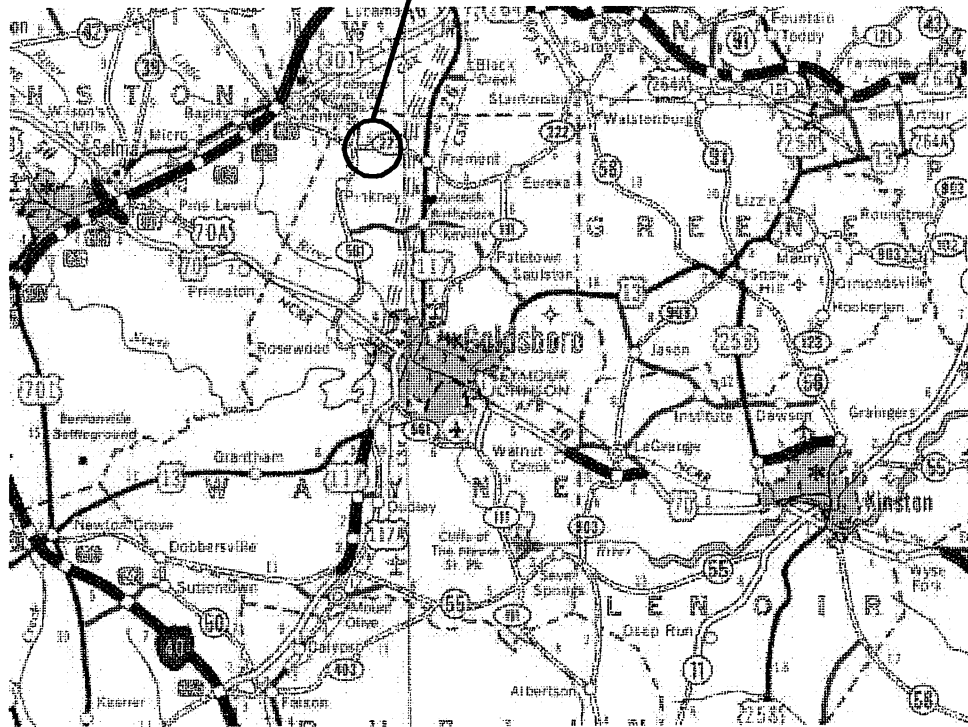

### VICINITY MAPS

NEUSE RIVER  
BUFFER ZONE

### NCDOT

DIVISION OF HIGHWAYS

WAYNE COUNTY

PROJECT: 33656.1.1 (B-4319)

REPLACE BRIDGE NO. 21

OVER GREAT SWAMP

ALONG NC 222

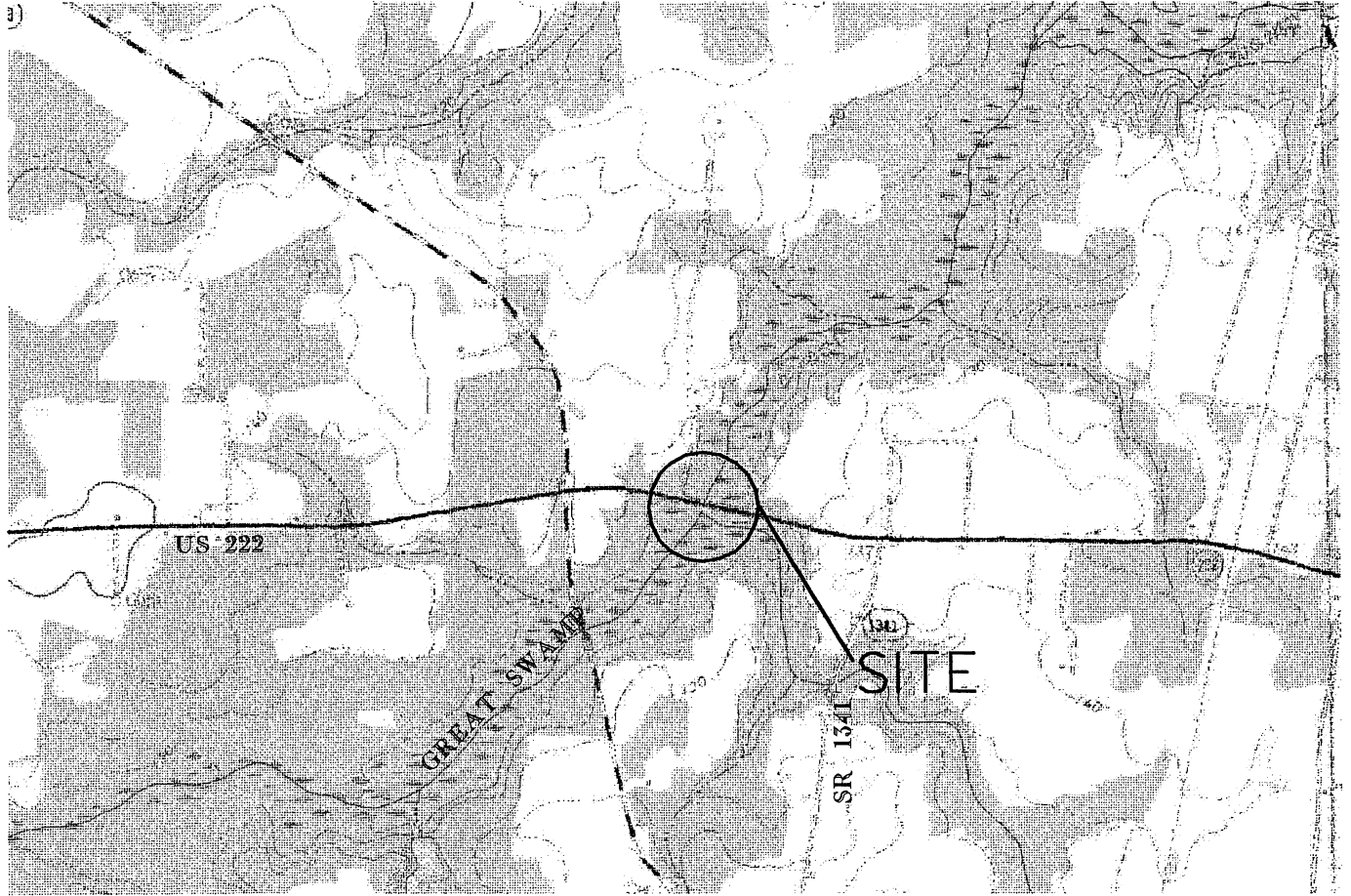

TOPOGRAPHIC  
MAPS

NEUSE RIVER  
BUFFER ZONE

NCDOT  
DIVISION OF HIGHWAYS  
WAYNE COUNTY  
PROJECT: 33656.1.1 (B-4319)  
REPLACE BRIDGE NO. 21  
OVER GREAT SWAMP  
ALONG NC 222



# Property Owner Contact Report

TIP # B-4319

Owner Last Name/ Business	Owner First Name	Address	City/Town	State	Zip Code	Contact/ Relationship	Home Phone	Contacted By	Contact Date	How Contacted	Comments
① Byers	James R.	129 Miller Road	Fremont	NC	27830	James R. Hooks Self		Stephen R. Wolfe	3/17/04	Letter	
② Hollowell	Wilbert Oscar	1681 NC 222 Hwy West	Fremont	NC	27830	Wilbert Oscar Hollowell Self		Stephen R. Wolfe	3/17/04	Letter	
④ Hooks	James Edwin	211 Emerson Drive	Mebane	NC	27302	James Edwin Hooks Self		Stephen R. Wolfe	3/17/04	Letter	
Hooks	Kenneth Wayne	P.O. Box 155	Fremont	NC	27830	Kenneth Wayne Hooks Self		Stephen R. Wolfe	3/17/04	Letter	
③ Lukens	Cynthia Fisher	168 Miller Road	Fremont	NC	27830	Cynthia F. Lukens Self		Stephen R. Wolfe	3/17/04	Letter	



PROJECT REFERENCE NO. **B-4319**  
 SHEET NO. **155**  
 ROADWAY DESIGN ENGINEER  
 HYDRAULIC ENGINEER  
 PRELIMINARY PLANS  
 DO NOT USE FOR CONSTRUCTION

BRIDGE APPROACH SLAB  
 FOR -L- PROFILE SEE SHEET 5  
 UNCLASSIFIED STRUCTURE  
 EXCAVATION (STRUCTURE PAY ITEM)  
 SEE SHEETS S-1 THRU S-2  
 FOR STRUCTURE PLANS

04/05/05  
 REV. 11/02/05

NEUSE RIVER BUFFER ZONE  
 PERMIT DRAWINGS

STA. 20+30 -L- END TIP PROJECT B-4319

-L-  
 PI STA 11+74.08  
 Δ = 7°05'06.5" (RT)  
 D = 578.422'  
 T = 174.08'  
 R = 16.38000'  
 SE = SEE PLANS

STA. 12+30 -L- BEGIN TIP PROJECT B-4319



20

15

10

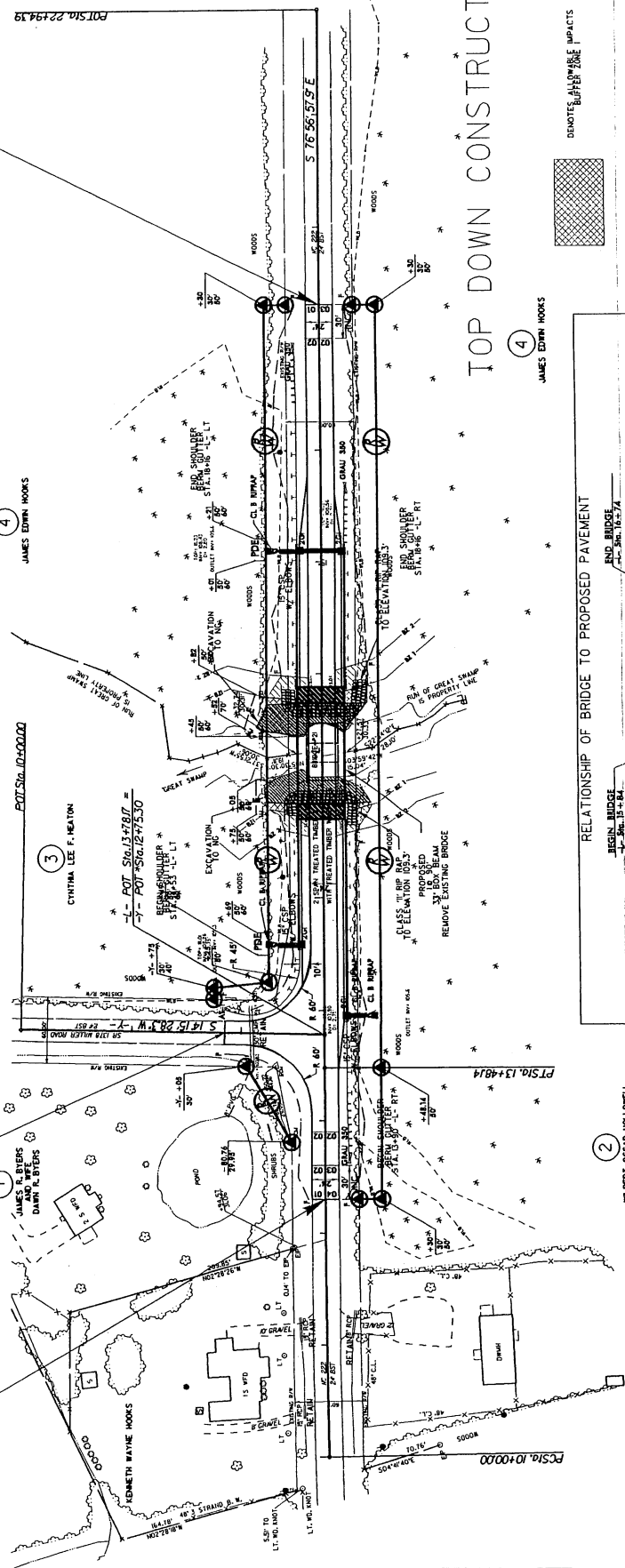

TOP DOWN CONSTRUCTION

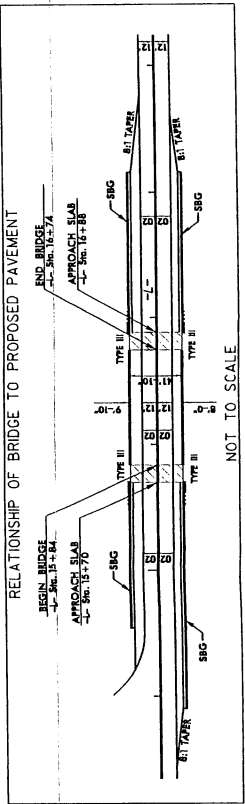
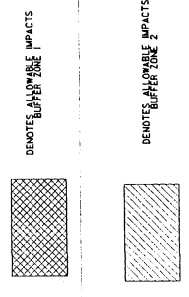

METHOD II CLEARING

NOT TO SCALE

8/17/99

REVISIONS

8-REV-2005 10-27  
 R:\hwy\mtd\mtd\11\hwy\perm\hwy\h4319\bufr\p-m1110205.dgn  
 sheeted 11/12/12/13



PROJECT REFERENCE NO.	B-4319	SHEET NO.	156
DESIGNING ENGINEER	OSCAR HOLLOWELL	DATE	04/05/05
APPROVING ENGINEER	EDNA HOLLOWELL	REV.	11/02/05

PRELIMINARY PLANS  
DO NOT USE FOR CONSTRUCTION

BRIDGE APPROACH SLAB  
FOR "L" PROFILE SEE SHEET 5  
UNCLASSIFIED STRUCTURE  
EXCAVATION  
STRUCTURE PER ITEM  
SEE SHEETS S-THRU S-P  
FOR STRUCTURE PLANS

04/05/05  
REV. 11/02/05

NEUSE RIVER BUFFER ZONE  
PERMIT DRAWINGS

PI STA 11+74.08  
Δ = 1.05' 06.5" (RT)  
D = 0.18' 42.2"  
L = 348.00'  
R = 14.00'  
SE = SEE PLANS

STA. 12+30 -L- BEGIN TIP PROJECT B-4319

STA. 20+30 -L- END TIP PROJECT B-4319

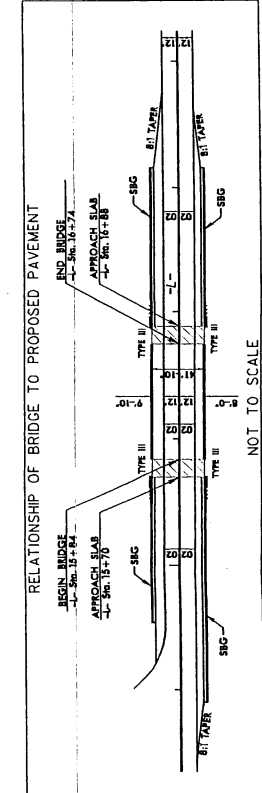
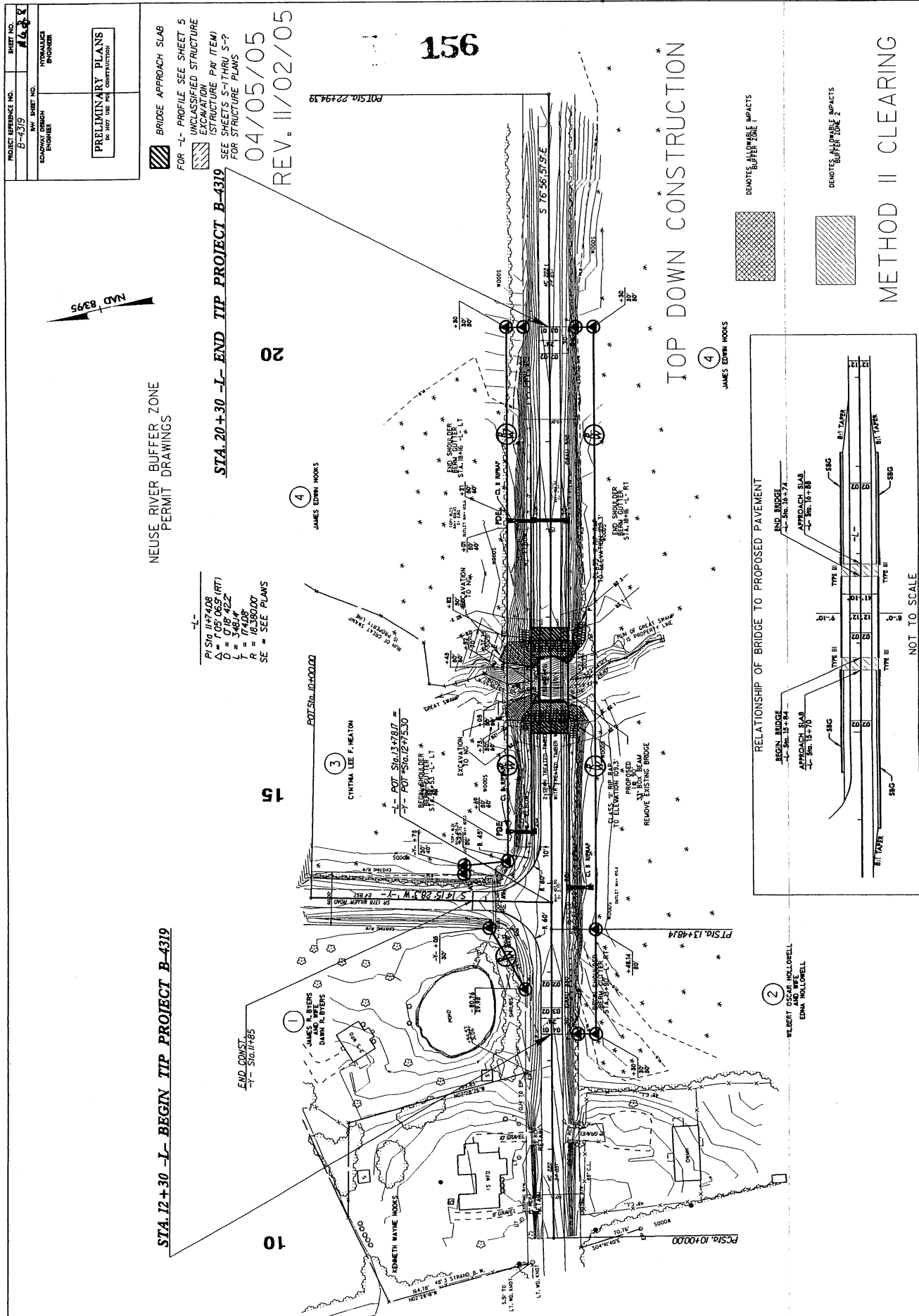

DEMOTES ALLOWABLE IMPACTS  
DEMOTES BUFFER ZONE IMPACTS

METHOD II CLEARING

NOT TO SCALE

PROJECT REFERENCE NO.	SHEET NO.
B-4319	7
BY	DATE
ROADWAY DESIGN ENGINEER	HYDRAULICS ENGINEER

NEUSE RIVER  
BUFFER ZONE  
PERMIT DRAWINGS

04/05/05  
REV. 11/02/05

157

REVISIONS
-----------

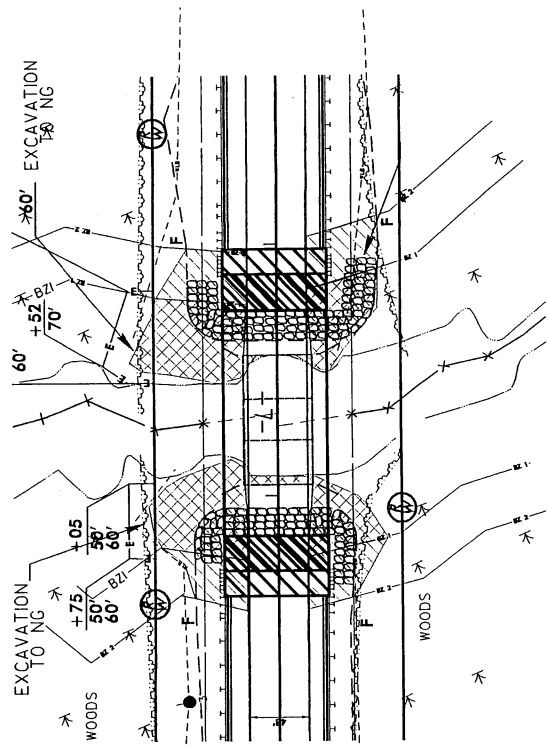

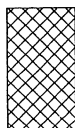
 DENOTES ALLOWABLE IMPACTS BUFFER ZONE 1  
 DENOTES ALLOWABLE IMPACTS BUFFER ZONE 2





STATE	N.C.	PROJECT NUMBER	B-4319	SHEET	1	TOTAL SHEETS	7
FED. AID PROJ. NO.		FED. AID DIVISION		DATE			
33456.1.1		BISTP-222(2)		DESIGNER	PE		
33456.2.1		BISTP-222(2)		BY	R.W. UTL.		

STATE OF NORTH CAROLINA  
DIVISION OF HIGHWAYS  
**WAYNE COUNTY**

LOCATION: BRIDGE NO. 21 OVER GREAT SWAMP ON NC 222

TYPE OF WORK: GRADING, PAVING, DRAINAGE, AND STRUCTURE

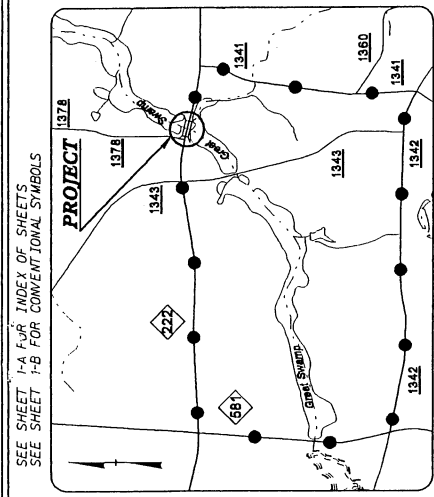

VICINITY MAP  
DENOTES PROPOSED DETOUR ROUTE

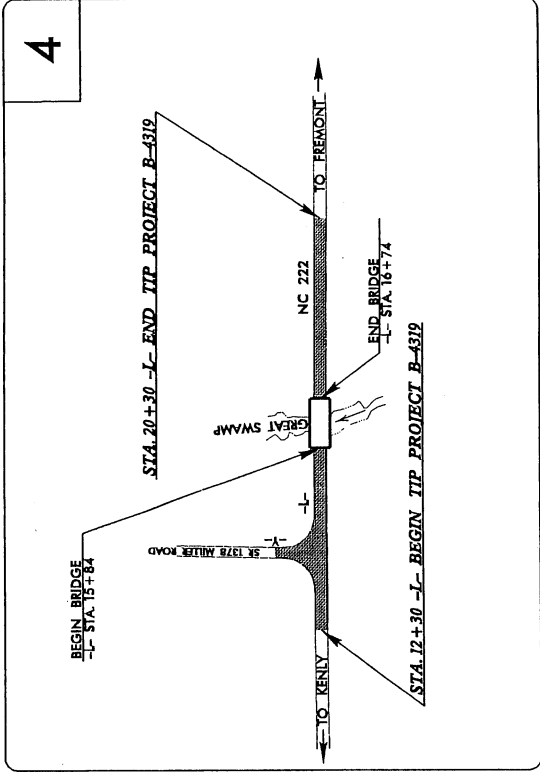

4



159

PRELIMINARY PLANS  
DO NOT USE FOR CONSTRUCTION

THIS PROJECT IS NOT WITHIN ANY MUNICIPAL BOUNDARIES. CLEARING ON THIS PROJECT SHALL BE PERFORMED TO THE LIMITS ESTABLISHED BY METHOD II.

<p>GRAPHIC SCALES</p> <p>PLANS: 1" = 50'</p> <p>PROFILE (HORIZONTAL): 1" = 100'</p> <p>PROFILE (VERTICAL): 1" = 20'</p>	<p>DESIGN DATA</p> <p>ADT 2006 = 1412</p> <p>ADT 2026 = 2452</p> <p>DHV = 10 %</p> <p>D = 60 %</p> <p>T = 5 %</p> <p>FUNC. CLASS = RURAL</p> <p>COLLECTOR</p> <p>* TTST = 3% DUAL = 2%</p>	<p>PROJECT LENGTH</p> <p>LENGTH OF ROADWAY TIP PROJECT B-4319 = 0.135 MI</p> <p>LENGTH OF STRUCTURE TIP PROJECT B-4319 = 0.017 MI</p> <p>TOTAL LENGTH OF TIP PROJECT B-4319 = 0.152 MI</p>	<p>Prepared in the Office of:</p> <p><b>DIVISION OF HIGHWAYS</b></p> <p>1000 Birch River Dr., Raleigh NC, 27610</p> <p>PROJECT ENGINEER: GARY LOVERING, PE</p> <p>PROJECT ENGINEER: RON MCCOLLUM, PE</p>	<p>HYDRAULICS ENGINEER</p> <p>ROADWAY DESIGN ENGINEER</p>	<p>DIVISION OF HIGHWAYS STATE OF NORTH CAROLINA</p> <p>STATE DESIGN ENGINEER: PE</p> <p>DEPARTMENT OF TRANSPORTATION FEDERAL HIGHWAY ADMINISTRATION</p> <p>STATE DESIGN ENGINEER: PE</p> <p>FEDERAL HIGHWAY ADMINISTRATION</p>

TIP PROJECT: B-4319

CONTRACT:

PAVEMENT SCHEDULE FINAL DESIGN	
C1	PROP. APPROX. 1.25" ASPHALT CONCRETE SURFACE COURSE, TYPE SFB.5A, AT AN AVERAGE RATE OF 137.5 LBS. PER SQ. YD.
C2	PROP. APPROX. 2.5" ASPHALT CONCRETE SURFACE COURSE, TYPE SFB.5A, AT AN AVERAGE RATE OF 137.5 LBS. PER SQ. YD. IN EACH OF TWO LAYERS.
C3	PROP. VAR. DEPTH ASPHALT CONCRETE SURFACE COURSE, TYPE SFB.5A, BE PLACED IN LAYERS NOT TO EXCEED 2" IN DEPTH.
E1	PROP. APPROX. 5.5" ASPHALT CONCRETE BASE COURSE, TYPE B25.0B, AT AN AVERAGE RATE OF 627 LBS. PER SQ. YD.
E2	PROP. VAR. DEPTH ASPHALT CONCRETE BASE COURSE, TYPE B25.0B, AT AN AVERAGE RATE OF 114 LBS. PER SQ. YD. PER 1" DEPTH, TO A MINIMUM OF 3" IN DEPTH OR GREATER THAN 6" IN DEPTH.
T	EARTH MATERIAL.
U	EXISTING PAVEMENT.
W	VARIABLE DEPTH ASPHALT PAVEMENT (SEE WEDGING DETAIL).

NOTE: PAVEMENT EDGE SLOPES ARE 1:1 UNLESS SHOWN OTHERWISE.

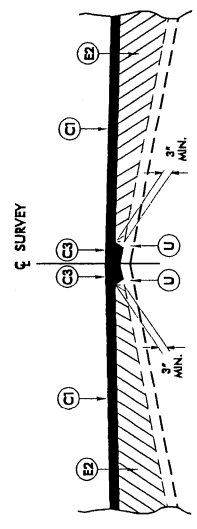

WEDGING DETAIL

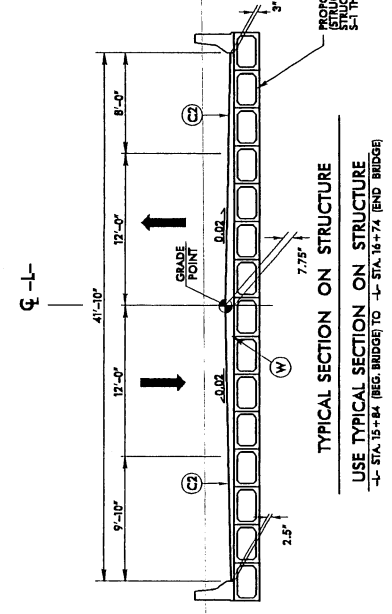

TYPICAL SECTION ON STRUCTURE

USE TYPICAL SECTION ON STRUCTURE  
 -+ STA. 15+64 (BEGIN BRIDGE) TO -+ STA. 16+74 (END BRIDGE)

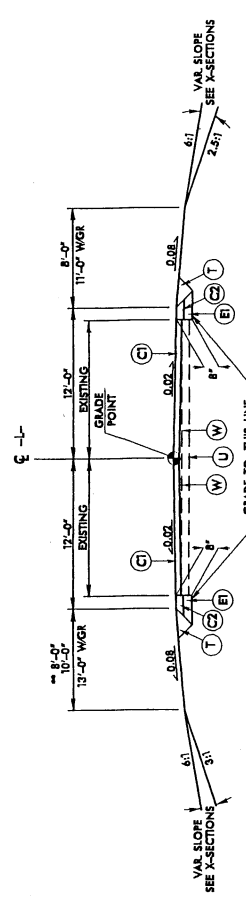

TYPICAL SECTION NO. 1

USE TYPICAL SECTION NO. 1  
 -+ STA. 12+80 TO -+ STA. 15+34  
 -+ STA. 17+24 TO -+ STA. 20+30  
 -+ STA. 12+30 TO -+ STA. 13+78.17

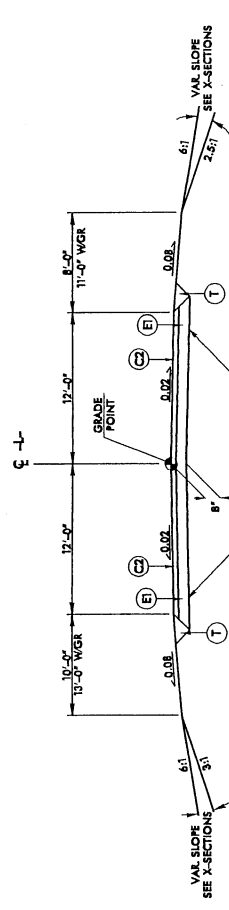

TYPICAL SECTION NO. 2

USE TYPICAL SECTION NO. 2  
 -+ STA. 15+34 TO -+ STA. 15+84 (BEGIN BRIDGE)  
 -+ STA. 16+74 (END BRIDGE) TO -+ STA. 17+24

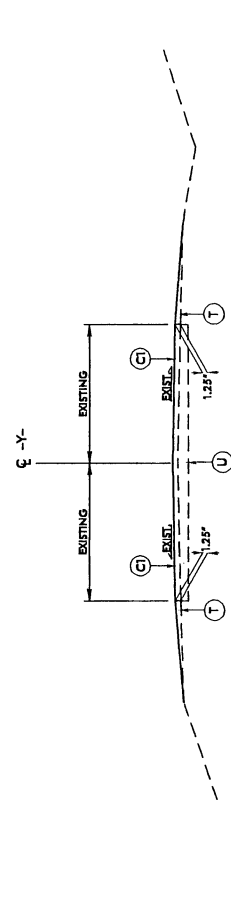

TYPICAL SECTION NO. 3

USE TYPICAL SECTION NO. 3  
 -+ STA. 11+85 TO -+ STA. 12+63.30

CONCRETE OR ASPHALT OVERLAY  
 FOR UNDER REINFORCING PER EARLY MURRAY  
 05-23-05

PROPOSED BOX BEAM BRIDGE  
 STRUCTURE PLANS  
 S-1 THRU S-3

PROJECT REFERENCE NO.	B-4319	SHEET NO.	22
ROADWAY DESIGN ENGINEER	NORMALLICES BRUNNER		
PRELIMINARY PLANS DO NOT USE FOR CONSTRUCTION			

BRIDGE APPROACH SLAB  
FOR -L- PROFILE SEE SHEET 5  
UNCLASSIFIED STRUCTURE  
STRUCTURE - PAY ITEM  
SEE SHEETS S-THRU S-9  
FOR STRUCTURE PLANS



**STA. 12+30 -L- BEGIN TIP PROJECT B-4319**

**STA. 20+30 -L- END TIP PROJECT B-4319**

-L-  
P/Sig 1147408  
Δ = 05.0852 (RT)  
L = 348.4' ΔZ = 1.22  
T = 174.08'  
R = 163.8000'  
SE = SEE PLANS

-BY- 5 POT 5+00.00

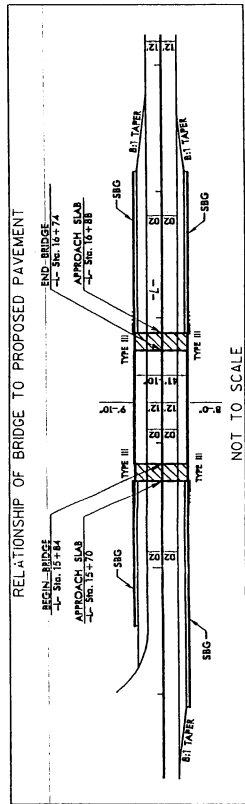
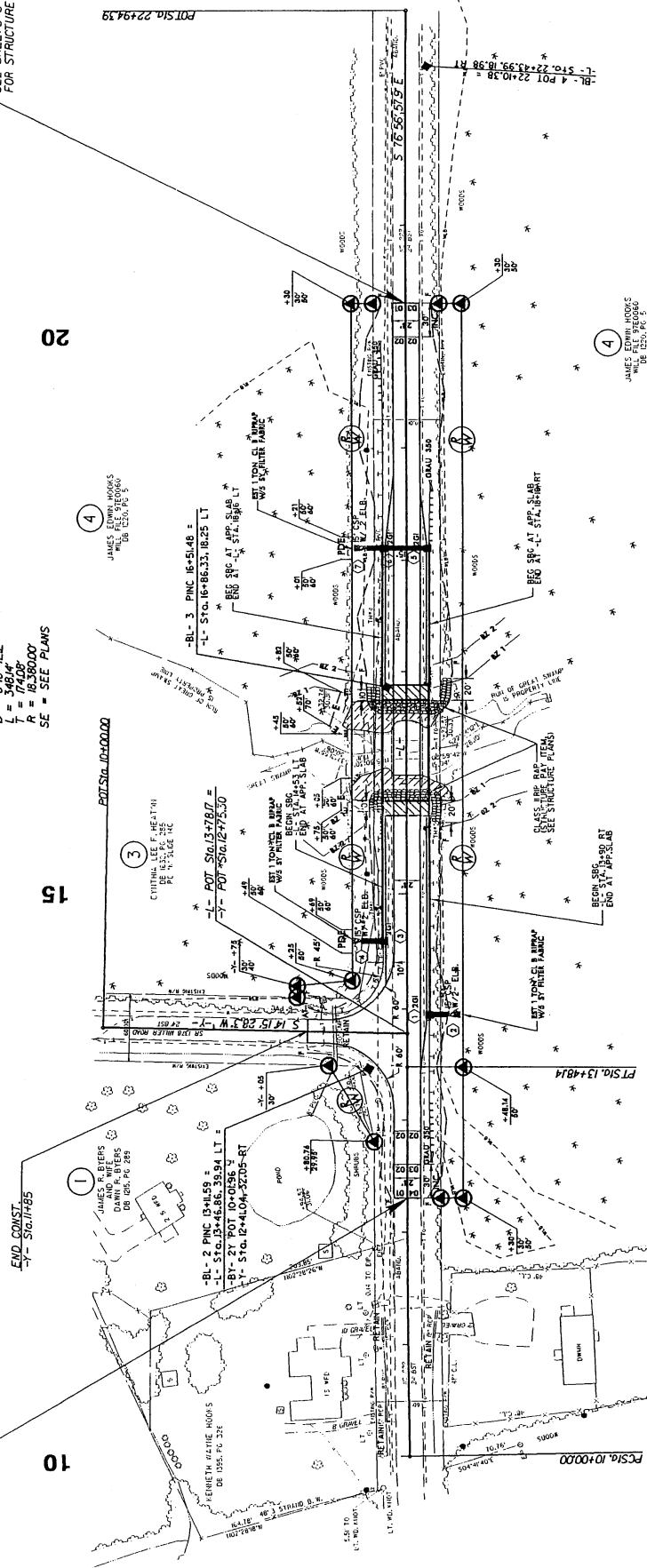

NOT TO SCALE

PROJECT REFERENCE NO. 6-519  
 COUNTY OF SAN JOAQUIN  
 ENGINEER

PRELIMINARY PLANS  
 DO NOT USE FOR CONSTRUCTION

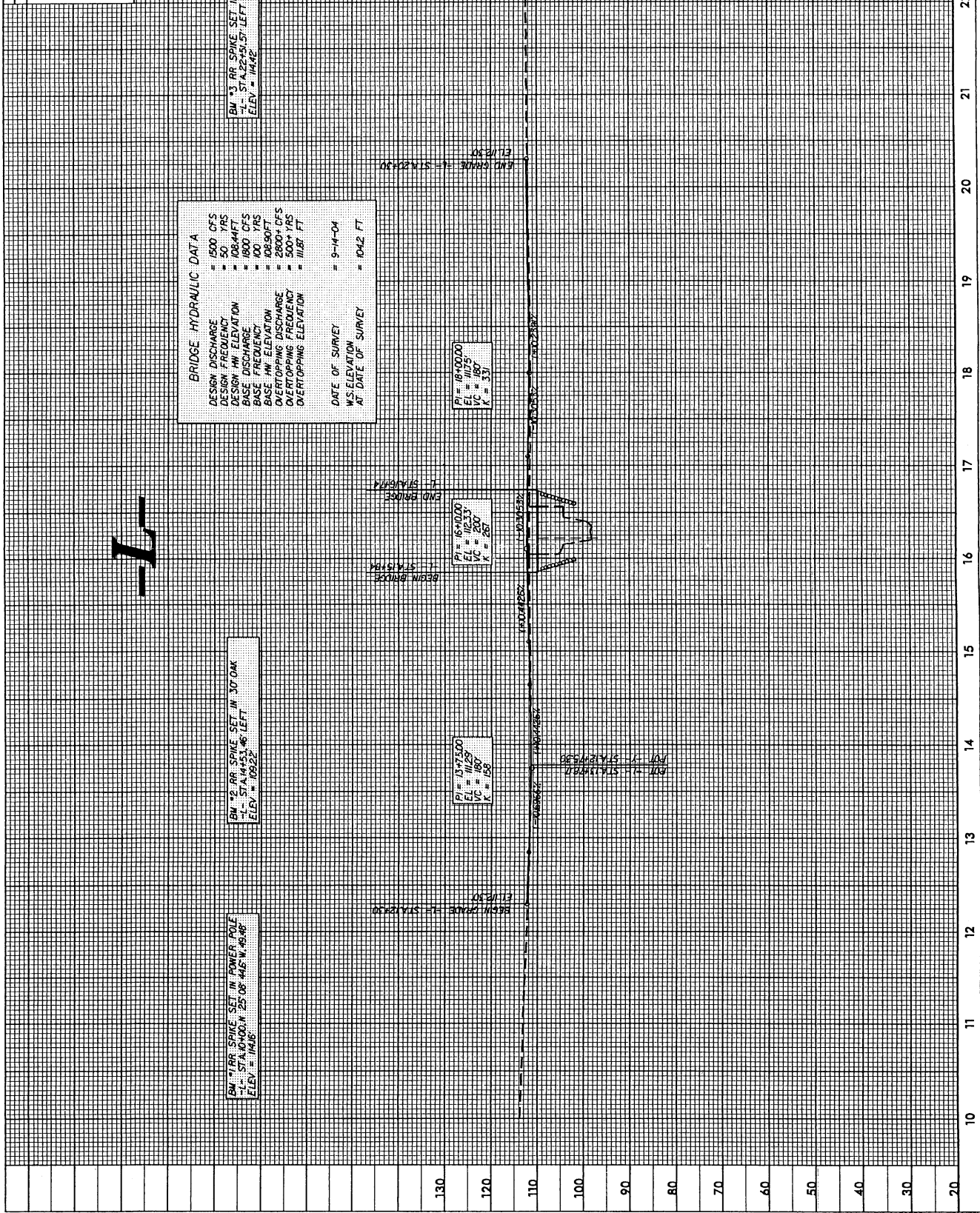

**BRIDGE HYDRAULIC DATA**

DESIGN DISCHARGE = 1500 CFS  
 DESIGN FREQUENCY = 50 YRS  
 DESIGN HW ELEVATION = 1000 CFS  
 BASE FREQUENCY = 100 YRS  
 BASE HW ELEVATION = 108.90 FT  
 OVERTOPPING DISCHARGE = 2800+ CFS  
 OVERTOPPING FREQUENCY = 500+ YRS  
 OVERTOPPING ELEVATION = 111.87 FT

DATE OF SURVEY = 9-14-04  
 W.S. ELEVATION AT DATE OF SURVEY = 104.2 FT

BM #2 RR SPIKE SET IN 30 OAK  
 +L- STA. 14+51.46 LEFT  
 ELEV. = 109.22'

BM #1 RR SPIKE SET IN POWER POLE  
 +L- STA. 10+00.00 N 25.08 DEG 41E W 40.87  
 ELEV. = 114.87'

BM #3 RR SPIKE SET IN 14 OAK  
 +L- STA. 22+41.51 LEFT  
 ELEV. = 114.42'

130  
120  
110  
100  
90  
80  
70  
60  
50  
40  
30  
20

10 11 12 13 14 15 16 17 18 19 20 21 22

152

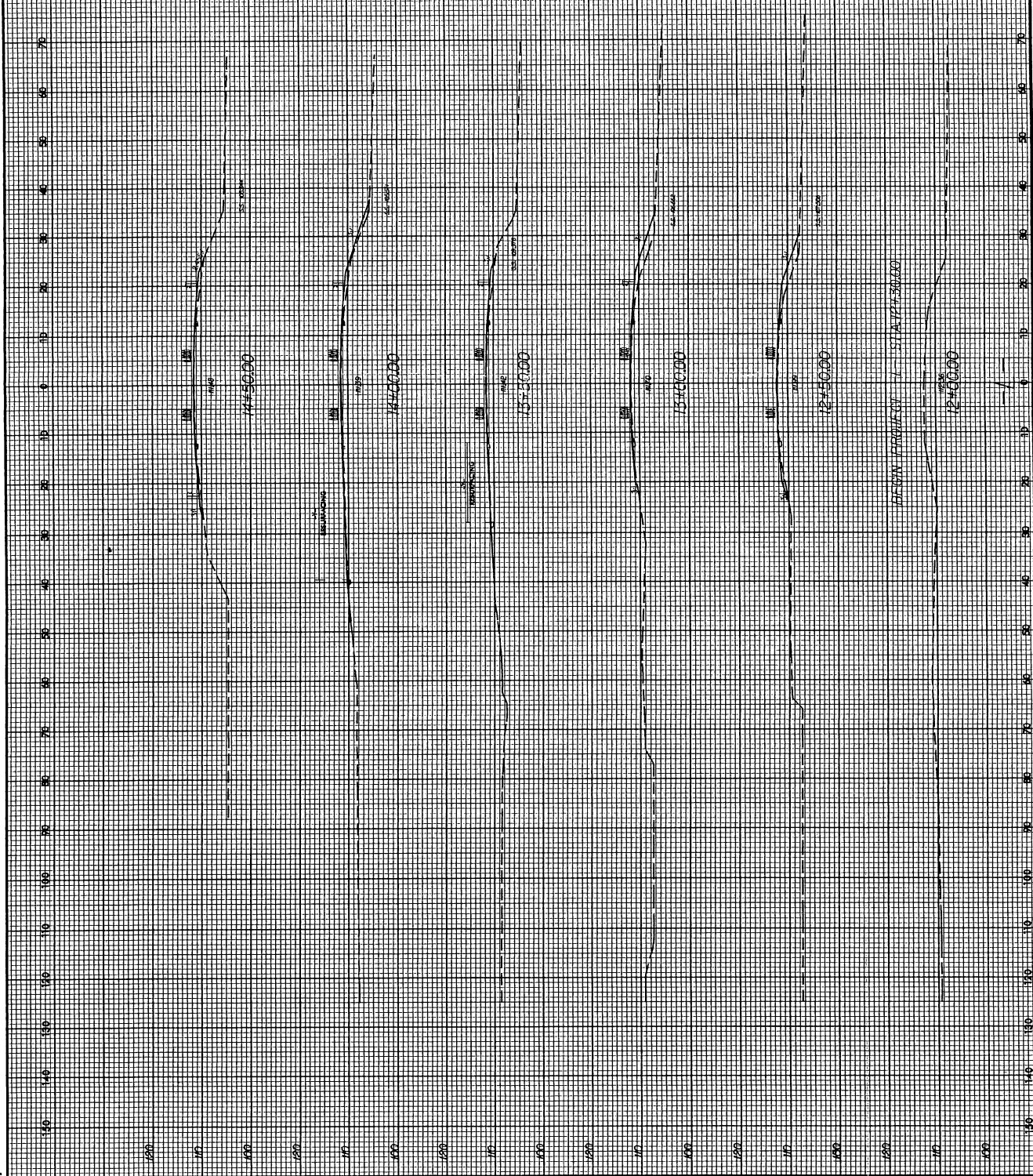

PRELIMINARY PLANS  
DO NOT USE FOR CONSTRUCTION



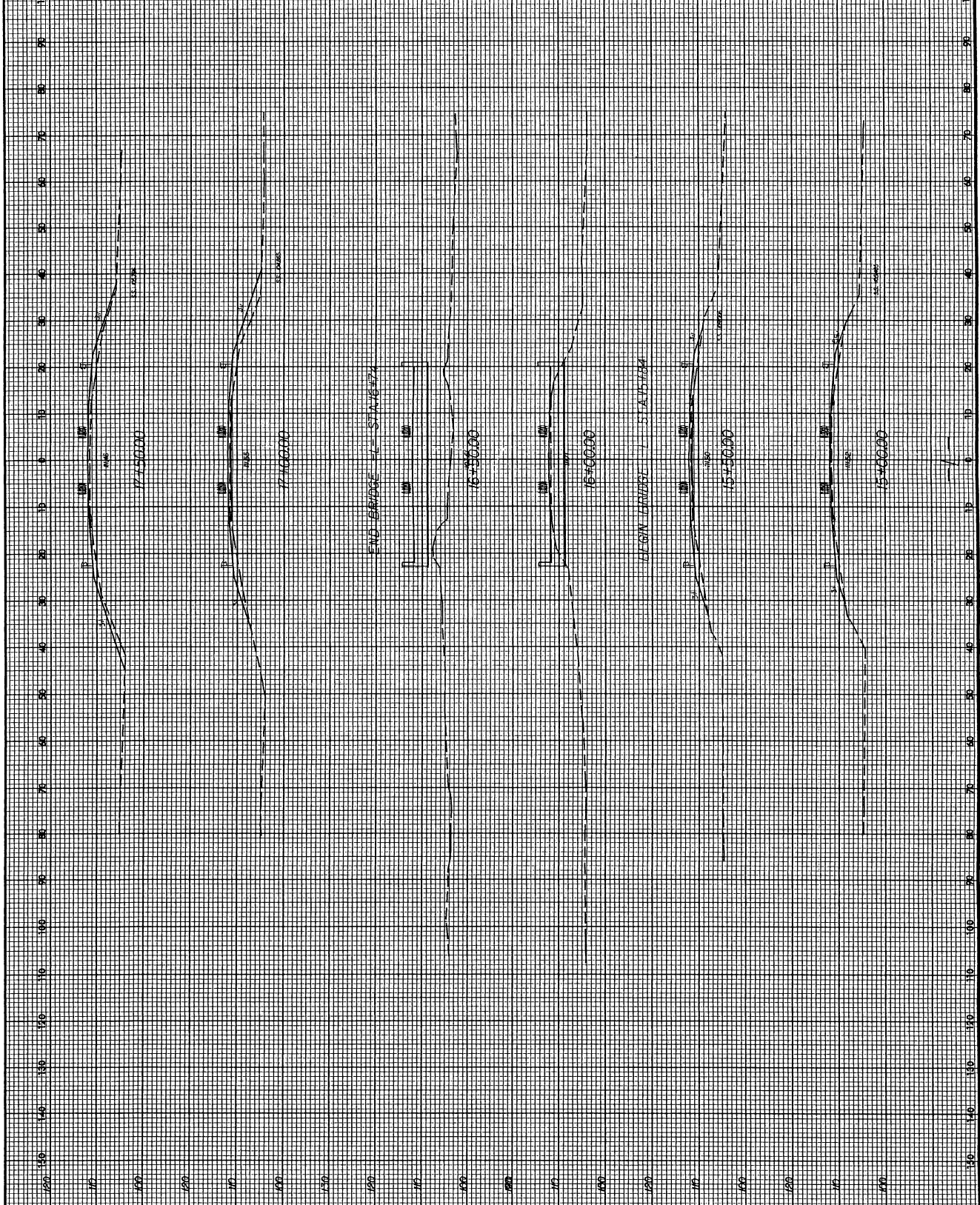

164

