

7/2/99

REVISIONS

PROJECT REFERENCE NO. B-3349	SHEET NO. 4
R/W SHEET NO.	HYDRAULICS
ROADWAY DESIGN ENGINEER 	HYDRAULICS PROFESSIONAL ENGINEER 

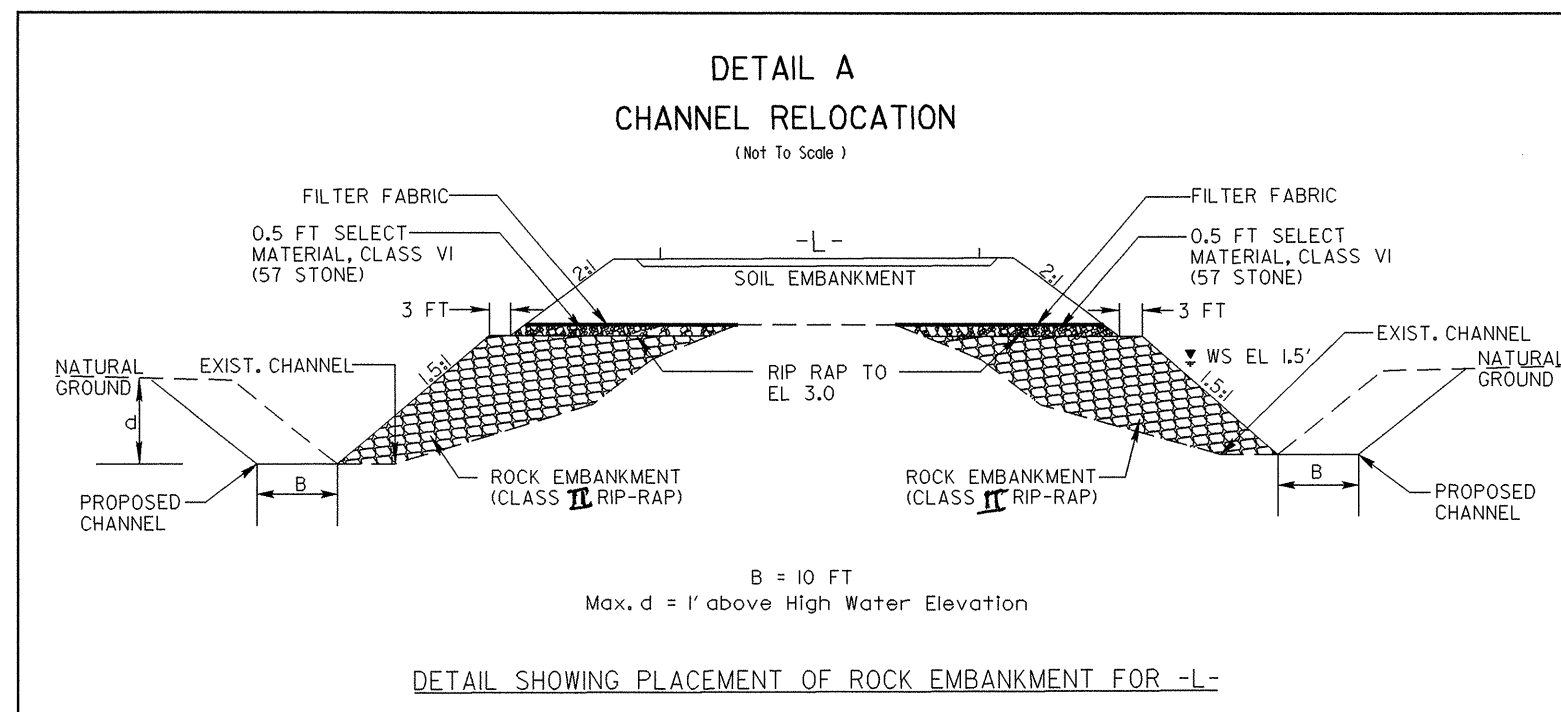

STA 14+50 -L- TO STA 15+30 -L- RT  
STA 14+50 -L- TO STA 15+30 -L- LT

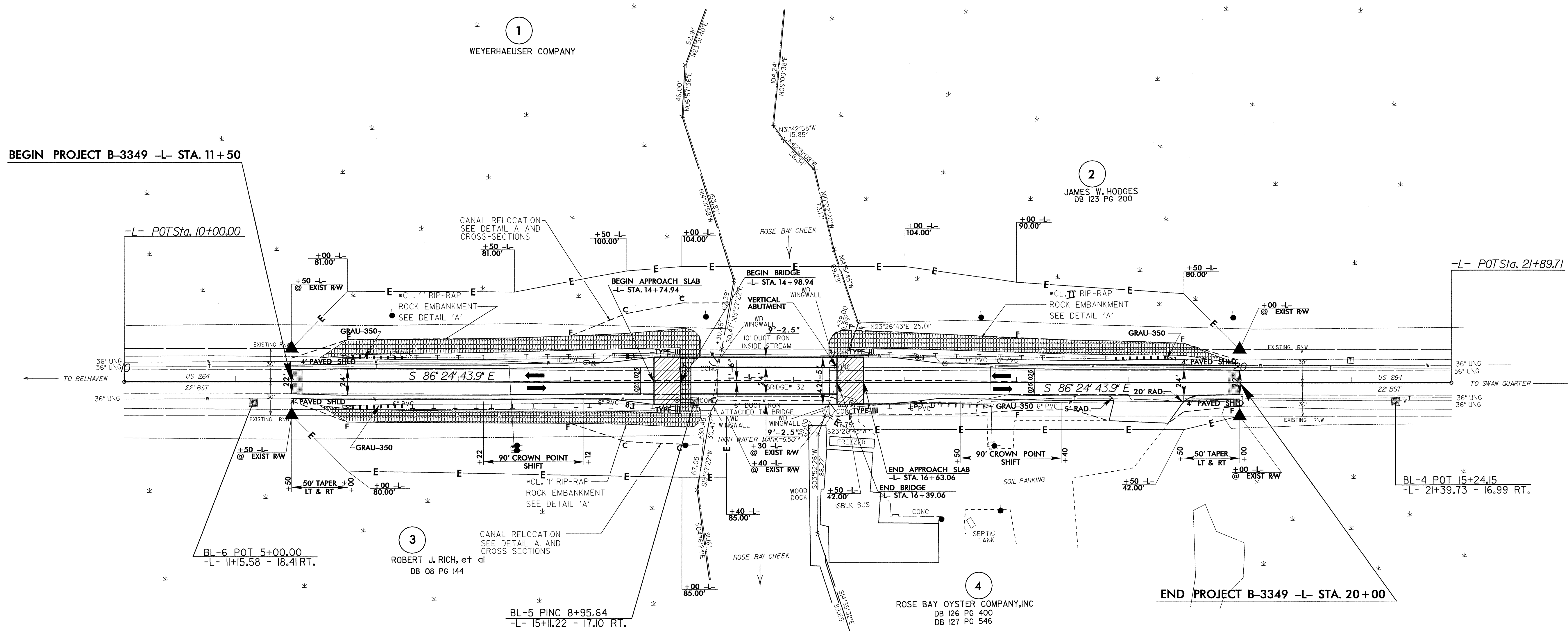
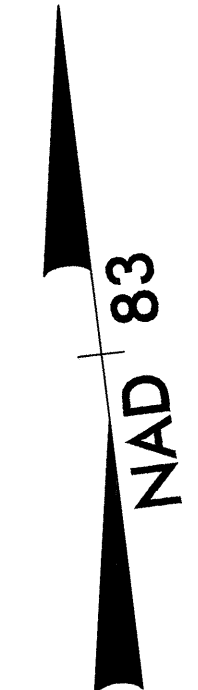

**DATUM DESCRIPTION**

THE LOCALIZED COORDINATE SYSTEM DEVELOPED FOR THIS PROJECT IS BASED ON THE STATE PLANE COORDINATES ESTABLISHED BY MOGS FOR MONUMENT "DRILL".

WITH NAD 83 STATE PLANE GRID COORDINATES OF NORTHING: 633232676(11) EASTING: 2775751374(11) THE AVERAGE COMBINED GRID FACTOR USED ON THIS PROJECT (GROUND TO GRID) IS: 0.9998791

THE N.C. LAMBERT GRID BEARING AND LOCALIZED HORIZONTAL GROUND DISTANCE FROM "DRILL" TO -L- POT STATION 11+50 IS N 86° 29' 52.92" W 3131.11 FT

ALL LINEAR DIMENSIONS ARE LOCALIZED HORIZONTAL DISTANCES VERTICAL DATUM USED IS NGVD 29

SKETCH SHOWING PAVEMENT IN RELATIONSHIP TO STRUCTURE (NTS)

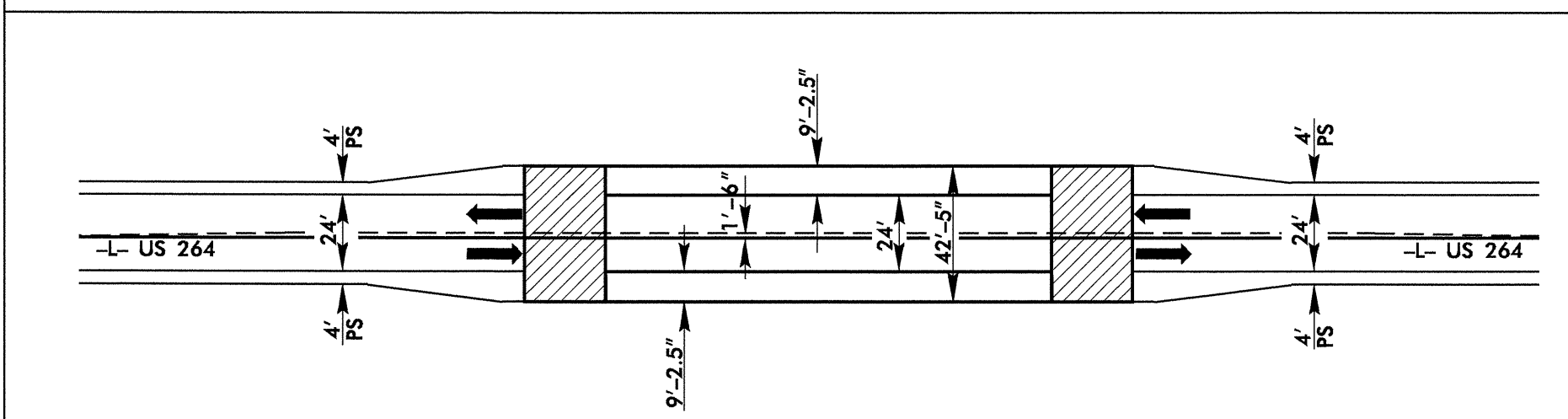

DESIGN EXCEPTION REQUIRED FOR -L- LINE SHOULDER WIDTHS.

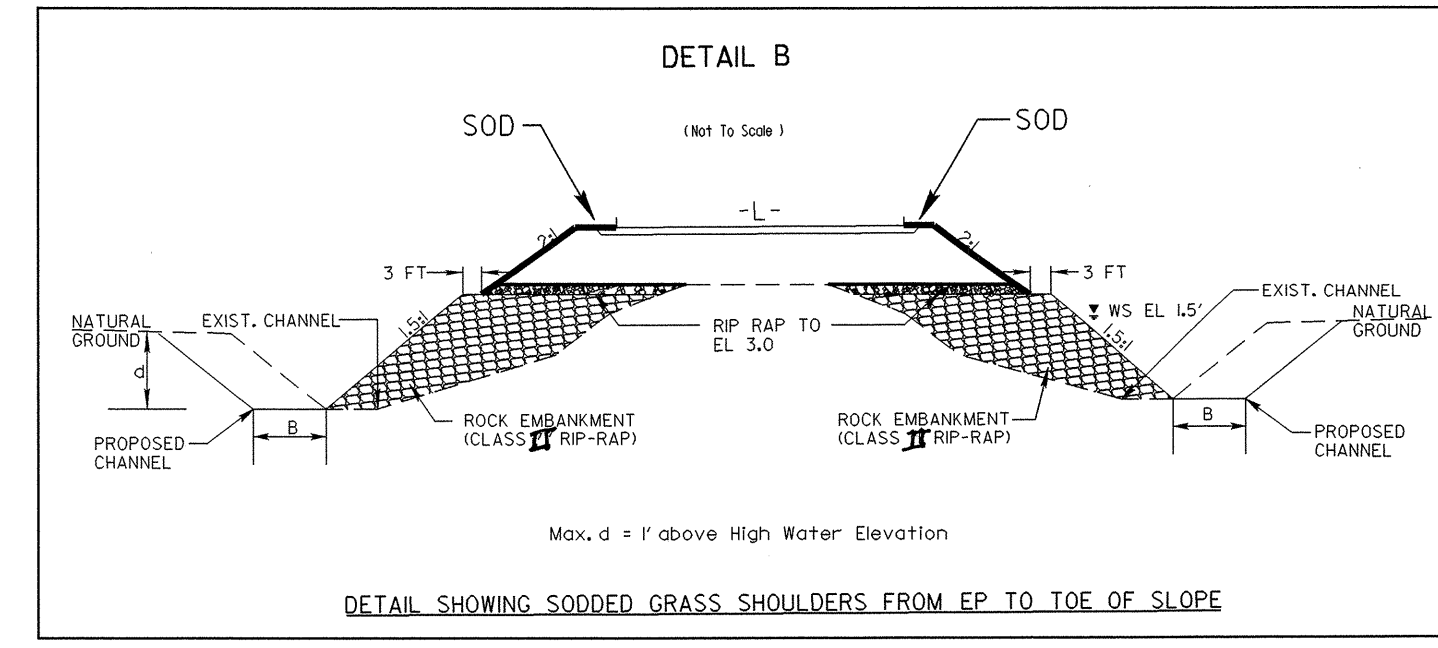

STA 11+50 -L- TO STA 20+00 -L- RT & LT

NOTE: SEE SHEET 5 FOR -L- PROFILE  
SEE SHEETS S-1 THRU S-44 FOR STRUCTURE PLANS  
SEE SHEET 4A FOR DETOUR ALIGNMENT

23-FEB-2005 10:47  
DWG Gardner rd-07oce34  
RD212399