

8/17/99
SYSTEMS/DESIGN/CONSTRUCTION/UTILITY/ENGINEERING

REVISIONS

MAP #1 AND #2 US 64 / SR 2098

W RALPH WHITEHEAD ASSOCIATES
CONSULTING ENGINEERS
P.O. BOX 35624
CHARLOTTE, NORTH CAROLINA 28255

PROJECT REFERENCE NO. 37618, ETC.	SHEET NO. 4
RAW SHEET NO.	
ROADWAY DESIGN ENGINEER	HYDRAULICS ENGINEER

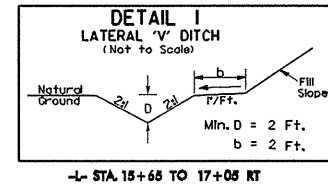
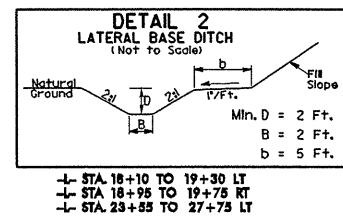
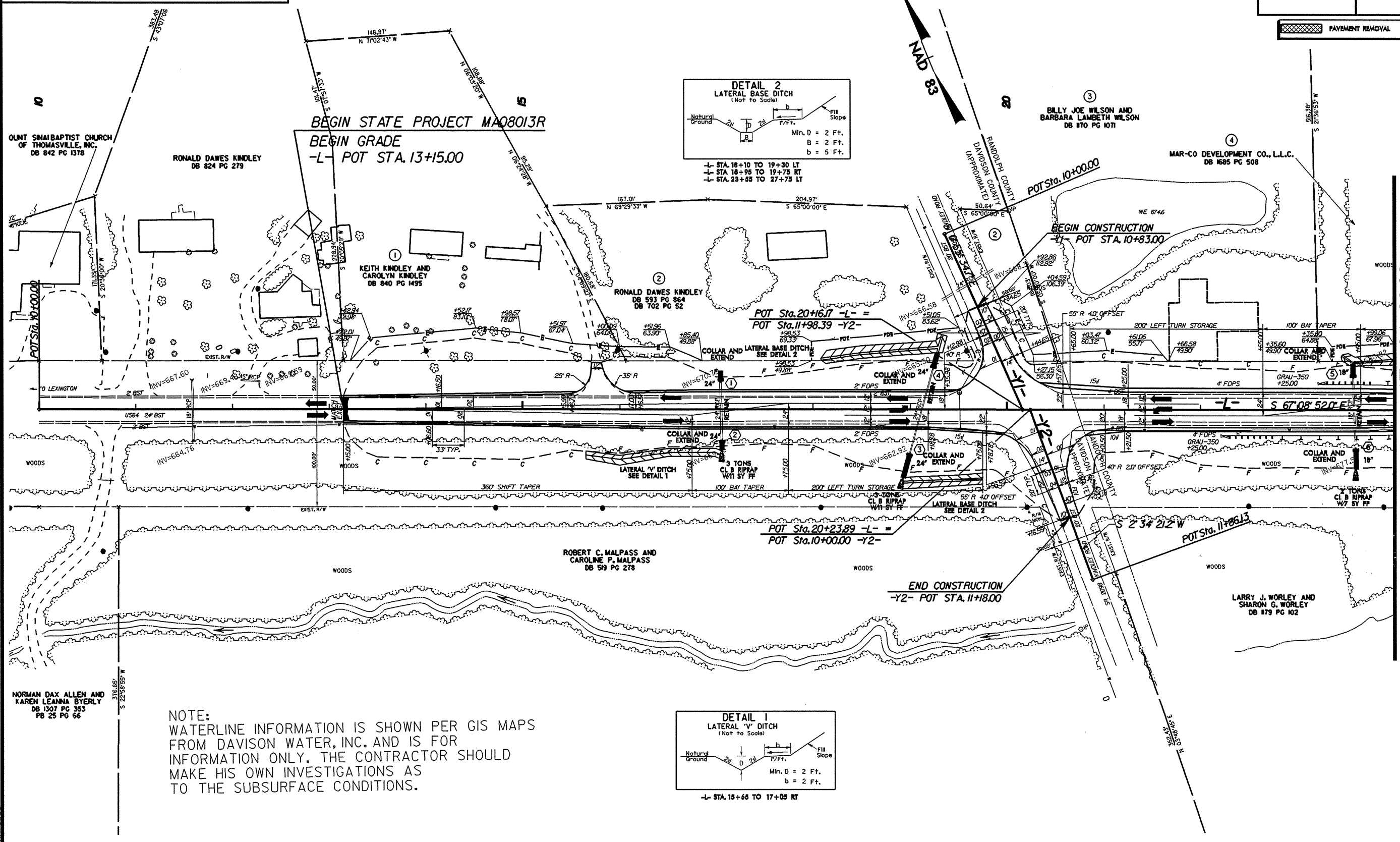

NOTE:
WATERLINE INFORMATION IS SHOWN PER GIS MAPS
FROM DAVISON WATER, INC. AND IS FOR
INFORMATION ONLY. THE CONTRACTOR SHOULD
MAKE HIS OWN INVESTIGATIONS AS
TO THE SUBSURFACE CONDITIONS.

NOTE: DITCH WIDTH REDUCED TO 6' ON -YI-

SEE SHEET 6 FOR -L- PROFILE.
SEE SHEET 6 FOR -Y- PROFILES.

MATCHLINE -L- STA. 24+00.00
SEE SHEET 5